

[Skip to content](#)

Manuals+

User Manuals Simplified.

Amaran 100x User Manual



[Home](#) » [amaran](#) » [Amaran 100x User Manual](#)



Contents [hide](#)

[1 Foreword](#)

[2 FCC Compliance Statement](#)

[3 Product Details](#)

[4 Installations](#)

[5 The power supply](#)

[6 Operations](#)

[7 Specifications](#)

[8 Photometrics](#)

[9 Service Warranty](#)

[10 Documents / Resources](#)

[10.1 References](#)

[11 Related Posts](#)

Foreword

Thank you for purchasing the Aputure “Amaran” series of LED photography lights – Amaran 100X.

Amaran 100x is Amaran series of newly designed high-cost performance lamps. Compact structure design, compact and light, excellent texture. Has a high-performance level, such as high brightness, high indication, can adjust the brightness, etc. It can be used with the existing Bowsens Mount lighting accessories to achieve a variety of lighting effects and enrich product usage patterns. So that the product to meet the needs of different occasions lights control, easy to achieve professional-level photography.

IMPORTANT SAFETY INSTRUCTIONS

When using this unit, basic safety precautions should always be followed, including the following:

1. Read and understand all instructions before using.
2. Close supervision is necessary when any fixture is used by or near children. Do not leave the fixture unattended while in use.
3. Care must be taken as burns can occur from touching hot surfaces.
4. Do not operate the fixture if a cord is damaged, or if the fixture has been dropped or damaged, until it has been examined by qualified service personnel.
5. Position any power cables such that they will not be tripped over, pulled, or put into contact with hot surfaces.
6. If an extension cord is necessary, a cord with an amperage rating at least equal to that of the fixture should be used. Cords rated for less amperage than the fixture may overheat.
7. Always unplug the lighting fixture from the electrical outlet before cleaning and servicing, or when not in use. Never yank the cord to remove the plug from the outlet. Detailed product manual can be found on www.aputure.com
8. Let the lighting fixture cool completely before storing.
9. To reduce the risk of electric shock, do not immerse this fixture in water or any other liquids.
10. To reduce the risk of fire or electric shock, do not disassemble this fixture. Contact cs@aputure.com or take it to qualified service personnel when service or repair work is required. Incorrect reassembly may cause electric shock when the lighting fixture is in use.
11. The use of an accessory attachment not recommended by the manufacturer may increase the risk of fire, electric shock, or injury to any persons operating the fixture.
12. Power this fixture by connecting it to a grounded outlet.
13. Please remove the protective cover before powering on the light.
14. Please remove the protective cover before using the reflector.
15. Please do not block the ventilation and do not look at the light directly when it is powered on.



16. Please do not place the LED lighting fixture near any liquids or other flammable objects.
17. Only use a dry microfiber cloth to clean the product.
18. Please have the product checked by an authorized service personnel agent if your product has a problem.
19. The malfunctions caused by unauthorized disassembly are not covered under the warranty.
20. We recommend only using the original Aputure cable accessories. Please note that our warranty for this product does not apply to any repairs required due to any malfunctions of unauthorized Aputure accessories, although you may request such repairs for a fee.
21. This product is certified by RoHS, CE, KC, PSE, and FCC. Please operate the product in full compliance with the operation standards. Please note that this warranty does not apply to repairs arising from malfunctions, although you may request such repairs on a chargeable basis.
22. The instructions and information in this manual are based on thorough, controlled company testing procedures. Further notice will not be given if the design or specifications change.

SAVE THESE INSTRUCTIONS

FCC Compliance Statement

This device complies with Part 15 of the FCC Rules. Operation is subject to the following two conditions:

1. This device may not cause harmful interference.
2. This device must accept any interference received, including interference that may cause undesired operation.

Warning: Changes or modifications not expressly approved by the party responsible for compliance could void the user's authority to operate the equipment.

NOTE: This equipment has been tested and found to comply with the limits for a Class B digital device, pursuant to Part 15 of the FCC Rules. These limits are designed to provide reasonable protection against harmful interference in a residential installation.

This equipment generates, uses, and can radiate radio frequency energy and, if not installed and used in accordance with the instructions, may cause harmful interference to radio communications. However, there is no guarantee that interference will not occur in a particular installation. If this equipment does cause harmful interference to radio or television reception, which can be determined by turning the equipment off and on, the user is encouraged to try to reorient or relocate the receiving antenna.

- Increase the separation between the equipment and receiver.
- Connect the equipment to an outlet on a different circuit than the receiver is connected to.
- Consult the dealer or an experienced radio/TV technician for help.

RF Warning Statement:

This device has been evaluated to meet general RF exposure requirements.

Check list

When you unbox the product, please make sure all the items listed below are included. Otherwise, please contact the seller immediately

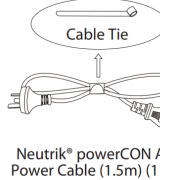
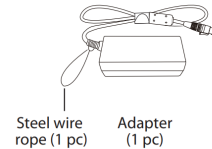
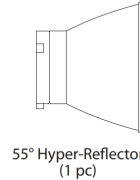
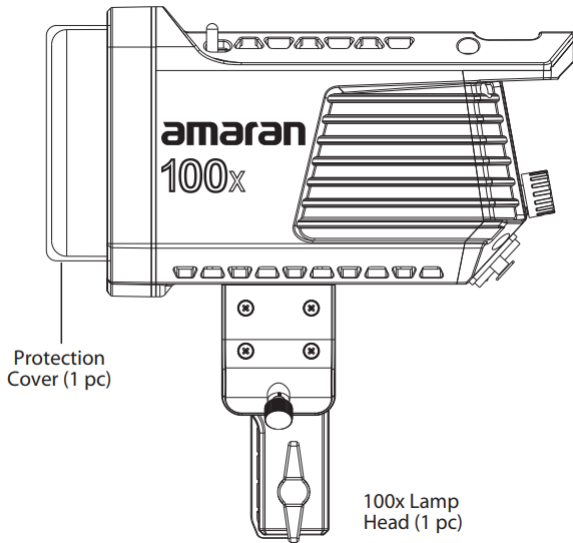

Product Details

1. Light

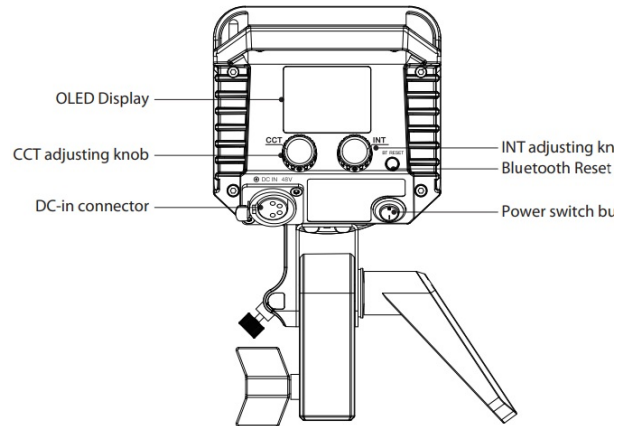
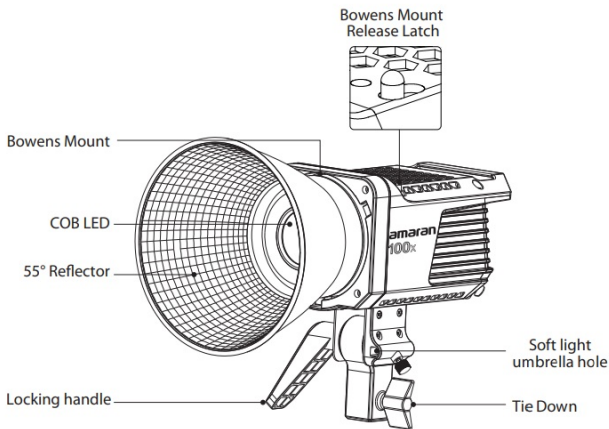

Installations

1. Attaching/detaching the protection cover

Push the handle of the lever in the direction of the arrow shown in the picture, and rotate the cover to pull it out. Reverse rotation will put the protective cover into.

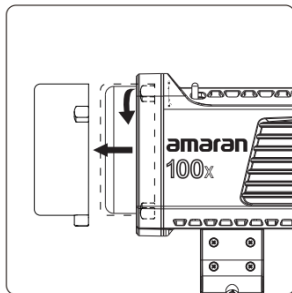
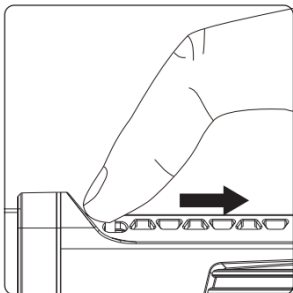

*** Notice:** Always remove the protection cover prior to turning on the light. Always re-install the cover when packing it away.

2. Installation and removal of 55° Reflector

Push the lever handle according to the arrow direction shown in the picture, and rotate the 55° Reflector into it. Rotating in the opposite direction pulls out the 55° Reflector.

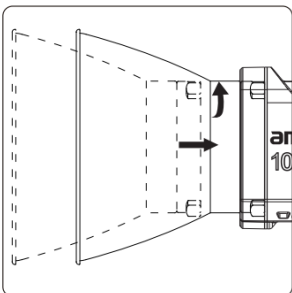
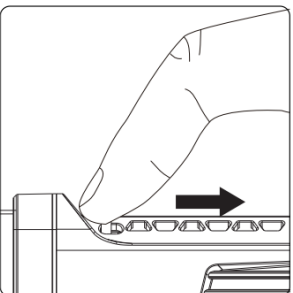

3. Setting up the Light

Adjust the lamp body to the appropriate height, rotate tie-down to fix the lamp body on the tripod, then adjust the lamp body to the required angle, and tighten the lock handle.

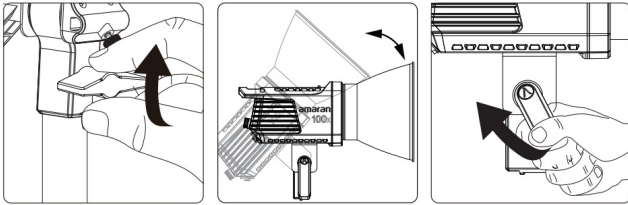

4. Soft light umbrella installation

Insert the soft light handle into the hole and lock the lock knob on the hole.

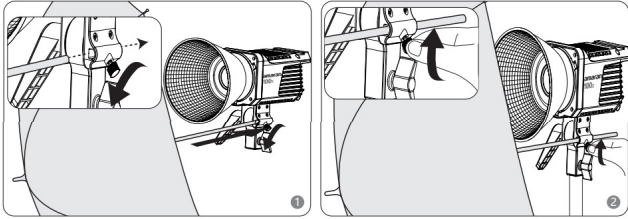

5. Adapter mounting

Run the wire rope through the adapter clasp and hang it on the bracket.

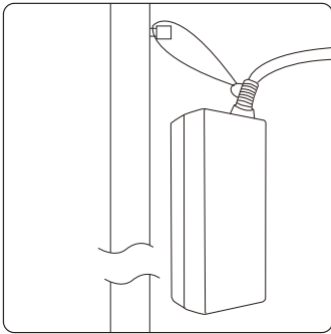

The power supply

Powered by AC

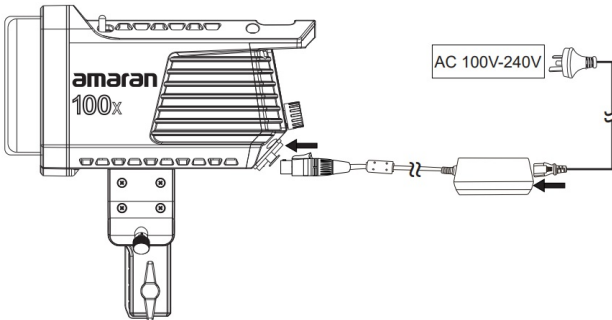

* Please press the spring-loaded lock button on the power cord to remove the power cord.
Do not pull it out forcibly.

Operations

1. Press the power button to turn the light on and off

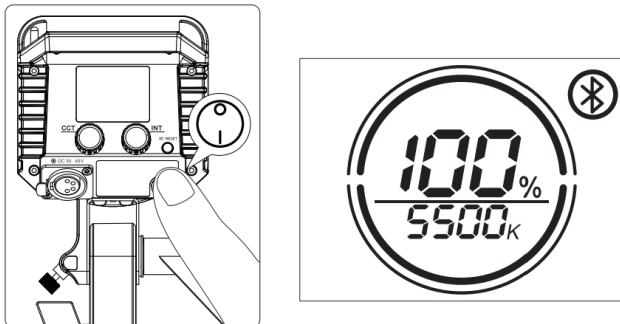

2. Manual control

2.1 Brightness adjustment

- Rotate the INT adjusting knob to adjust the brightness with 1% variable, and the brightness change range is (0-100) %, and display the change of (0-100) % in real-time on the LIGHT body OLED display;
- Click the INT adjustment knob to quickly switch the brightness level: 20%→40%→60%→80%→100%→20%→40%→60%→80%→80%→40%→60%→80%→100% cycle switch.



2.2 CCTS adjustment

- Rotate the CCT adjusting knob to increase or decrease with 100K as the change amount to change the current CCT value (2700K-6500K), and display (2700K-6500K) CCT value in real-time on the light body display screen.
- Click the CCT adjustment knob to quickly switch the color temperature shift: 2700K→3200K →4300K→5500K→6500K→2700K→3200K→4300K→5500K→6500K cycle switch.



3. Wireless mode adjustment

The user can connect the light body named Amaran 100x-xxxxxx through the Bluetooth of the mobile phone or tablet (Bluetooth serial number). At this time, the light body can be controlled wirelessly through the mobile phone or tablet. When the light effect is controlled by APP, the word "FX" is displayed in the upper left corner of the LCD. In wireless mode, 9 lighting effects can be controlled through App: paparazzi, fireworks, faulty bulb, lightning, TV, pulse, flash, explosion, and Fire. And App can control all kinds of light effect CCT, brightness, frequency.

4. Reset Bluetooth

4.1 Long press the Bluetooth Reset button to reset Bluetooth.

4.2 During the Reset process, the LCD displays BT Reset and the Bluetooth icon is flashing, and the percentage shows the current Reset progress (1%-50%-100%).

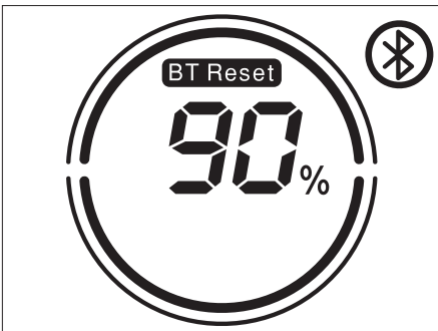

4.3 The LCD will display [Success] 2 seconds after the Bluetooth reset is successful.

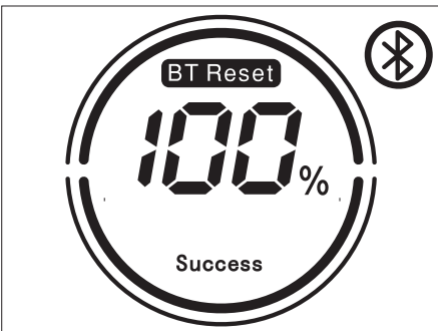

4.4 If the Bluetooth reset is unsuccessful, the LCD will display [Failure] and disappear after 2 seconds.

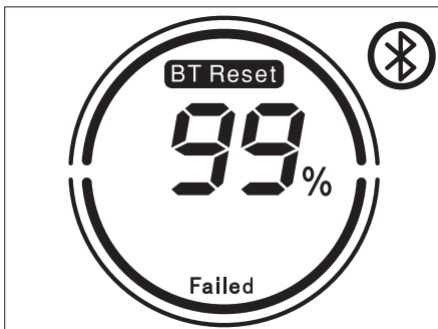

light.

4.5 After resetting the light's Bluetooth connection, your mobile phone or tablet will be able to connect to and control the



5. OTA mode

Firmware updates can be updated online via the Sidus Link app for OTA updates.

6. Using the Sidus Link APP

You can download the Sidus Link app from the iOS App Store or Google Play Store for enhancing the functionality of the light. Please visit sidus.link/app/help for more details regarding how to use the app to control your Aputure lights.



<https://sidus.link/app/help>



<https://m.sidus.link>

Specifications

Ughl operating Cutter*	2.7A	Power Consumption	130W maximum
Light POMO supply	OC 4Y	Cooling Mode	AM< coding
Adaplef Paolo Supply	AC 100-240Y XV60112	CRI	≥95
TLCI	x90	APP Control Type	Bluetooth
Color Tempeense	2700K-6500K	Remote Ability	slClOrn
RaoFtequency	2.44Hz		
Sizes (L*W*H)	207.5x154x164.8mm		

Photometrics

CCT	Distance\Illumination	1m	3m	5m
2700K		229 k	27 k	10 fc
	Bare Bulb	2470 lux	290 lux	110 lux
	Hyper-Reflector	2090 k	214 k	74 fc
		22500 lux	2300 lux	800 lux
3200K		279 k	33 k	12 fc
	Bare Bulb	3000 lux	350 lux	130 lux
	Hyper-Reflector	2587 fc	264 k	93 k
		27850 lux	2840 lux	1000 lux
5600K		344 k	40 fc	16 fc
	Bare Bulb	3700 lux	430 lux	170 lux
	Hyper-Reflector	3187 fc	325 fc	114 k
		34300 lux	3500 lux	1230 lux
6500K		307 k	36 k	14 fc
	Bare Bulb	3300 lux	390 lux	150 lux
	Hyper-Reflector	2889 fc	293 fc	102 fc
		31100 lux	3150 lux	1100 lux

* This is an averaged result, the number might be slightly different on each light.



GUARANTEE CARD

Serial No.
Item Name
Purchase Date
Buyer Name
Buyer Phone
Buyer Add
Franchiser Seal



Aputure Imaging Industries Co., Ltd.

Inspection: Qualified

Add F/3. Building 21. Longjun Industrial Estate. Heping West Road, Shenzhen, Guangdong

Service Warranty

Aputure Imaging Industries Co., Ltd. warrants the original consumer purchaser from defects in material and workmanship for a period of one (1) year after the date of purchase. For more details of warranty visit www.aputure.com

Important:

Keep your original sales receipt. Be sure the dealer has written on it the date, serial No. of the product. This information is required for warranty service.

This warranty does not cover:

- Damage that is the result of misuse, abuse, accident (including but not limited to damage by water), faulty connection, defective or maladjusted associated equipment, or the use of the product with equipment for which it was not intended.
- Cosmetic defects that appear more than thirty (30) days after the date of purchase. Cosmetic damage caused by improper handling is also excluded.
- Damage occurs while the product is being shipped to whoever will service it.

This warranty is void if:

- The product identification or serial No. label is removed or defaced in any way.
- The product is serviced or repaired by anyone other than Aputure or an authorized Aputure dealer or service agency.

Aputure Imaging Industries Co., Ltd.

Add: F/3, Building 21, Longjun industrial estate, HePing West Road, Shenzhen, Guangdong

E-MAIL: cs@aputure.com

Sales Contact: (86)0755-83285569-613

Documents / Resources



[Amaran Amaran 100x](#) [pdf] User Manual
Amaran, 100x, Bi-color, LED, Light

References

- [Aputure - LED Lighting for Filmmakers](#)

[Manuals+](#)

- [home](#)
- [privacy](#)