



## Amana WFC8090GX Front-Loading Washer User Guide

[Home](#) » [Amana](#) » Amana WFC8090GX Front-Loading Washer User Guide

### Amana WFC8090GX Front-Loading Washer



**NOTE:** See your Use and Care Guide for more information.  
Not all settings and options are available on each cycle.



**WARNING**



**Fire Hazard**

- Never place items in the washer that are dampened with gasoline or other flammable fluids.
- No washer can completely remove oil.
- Do not dry anything that has ever had any type of oil on it (including cooking oils).
- Doing so can result in death, explosion, or fire.

## Contents [ [hide](#)

- [1 Usage Instructions](#)
- [2 BEFORE FIRST USE:](#)
- [3 DOING LAUNDRY:](#)
- [4 MAINTENANCE](#)
- [5 Documents / Resources](#)
- [6 Related Posts](#)

## Usage Instructions

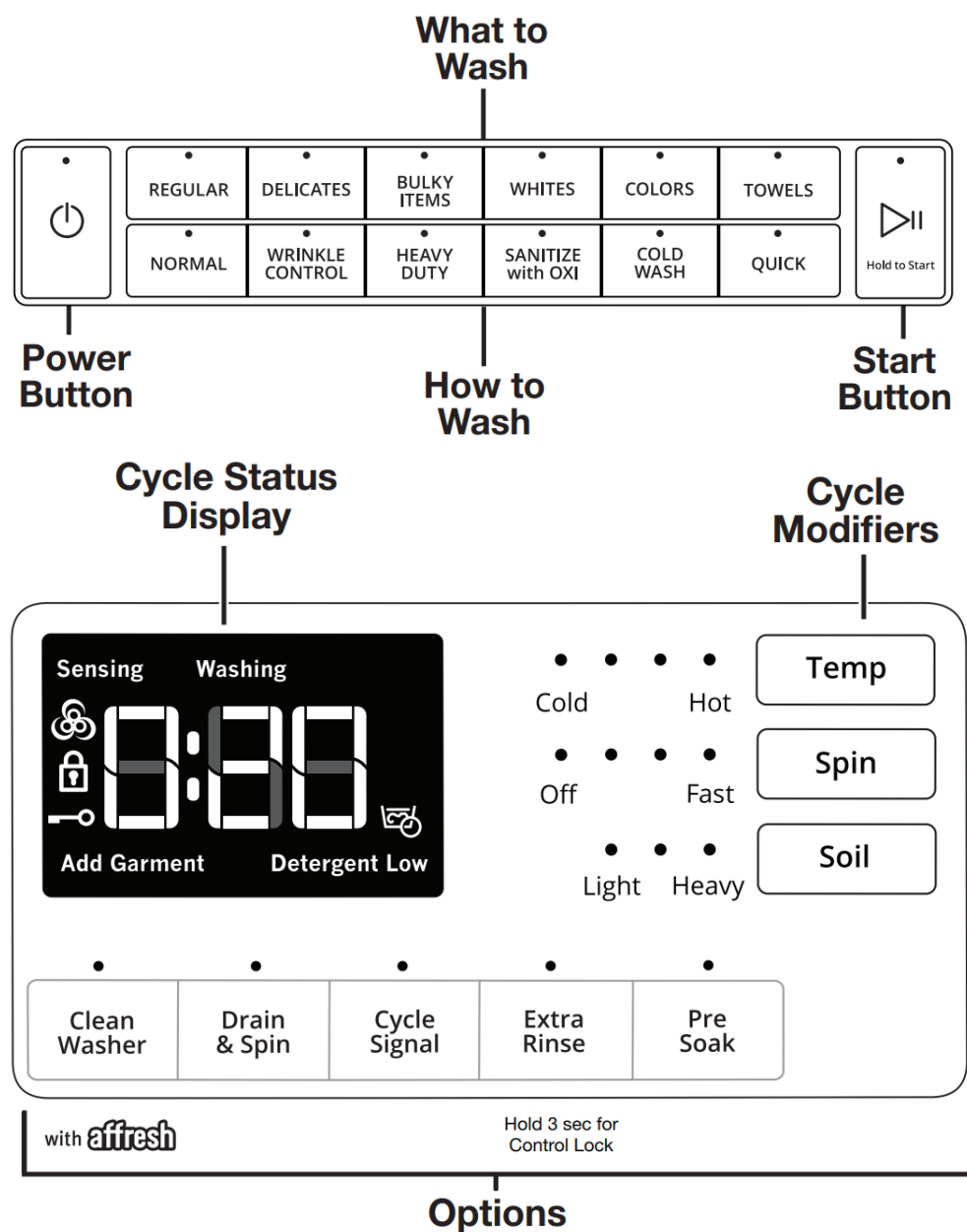



**TOUCH POWER TO TURN ON WASHER**

## **BEFORE FIRST USE:**

### **RUN WASH CYCLE WITHOUT LAUNDRY**

Before washing clothes for the first time, choose the Quick cycle and run it without clothes. This initial cycle serves to ensure the interior is clean before washing clothes.

## **DOING LAUNDRY:**

### **ADD LAUNDRY PRODUCTS, IF DESIRED**

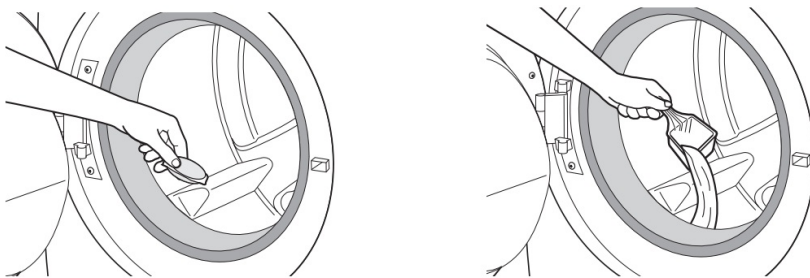

Single-dose laundry packets, Oxi-type boosters, color-safe bleach, or scented crystals can be added to the drum prior to adding laundry.

### **LOAD LAUNDRY**

Place a load of sorted items loosely in the washer.

**IMPORTANT:** Push load fully into the washer. Make sure no items are resting on the rubber seal to avoid trapping them between the seal and the door window.

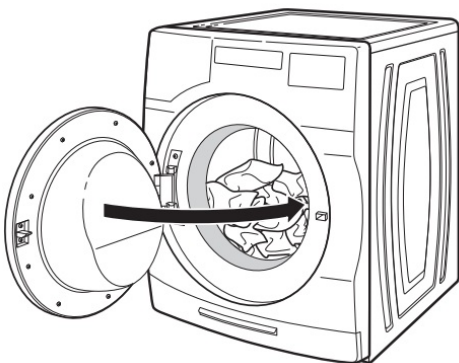

### **ADD HE DETERGENT, IF DESIRED**

If you choose to use the Single Load Dispenser, add detergent to the appropriate compartment at this time.

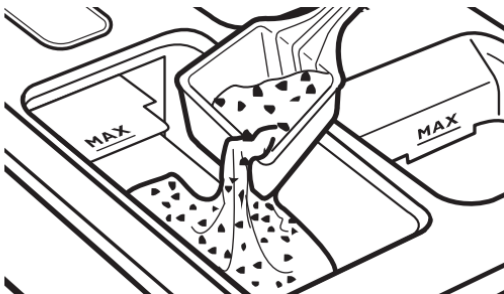
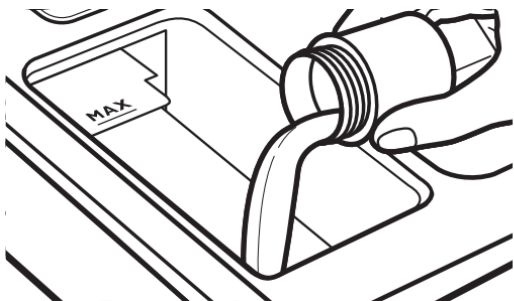

**ADD LIQUID FABRIC SOFTENER AND CHLORINE BLEACH TO SINGLE LOAD DISPENSER, IF DESIRED**

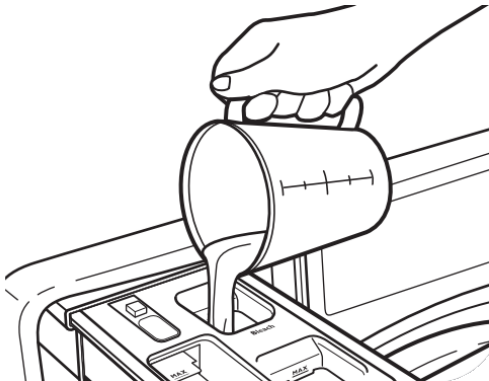
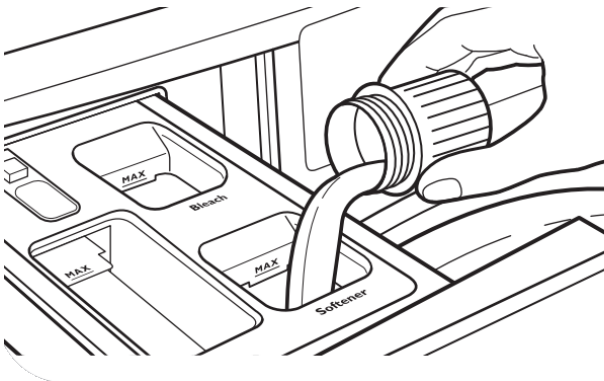

**SELECT A CYCLE**

• REGULAR	• DELICATES	• BULKY ITEMS	• WHITES	• COLORS	• TOWELS
• NORMAL	• WRINKLE CONTROL	• HEAVY DUTY	• SANITIZE with OXI	• COLD WASH	• QUICK

**NOTE:** Normal cycle is recommended for washing normally soiled cotton or linen clothes. This clothes washer's government energy certifications were based on the Regular + Normal cycle with Fast Spin, Medium Soil Level and all Wash Temperature selections offered in the cycle. It was tested as an Adaptive Automatic Water Fill Control System clothes washer. The settings as shipped are Regular + Normal cycle, Warm Wash Temp and Auto Water level.

**ADJUST CYCLE MODIFIERS, IF DESIRED**

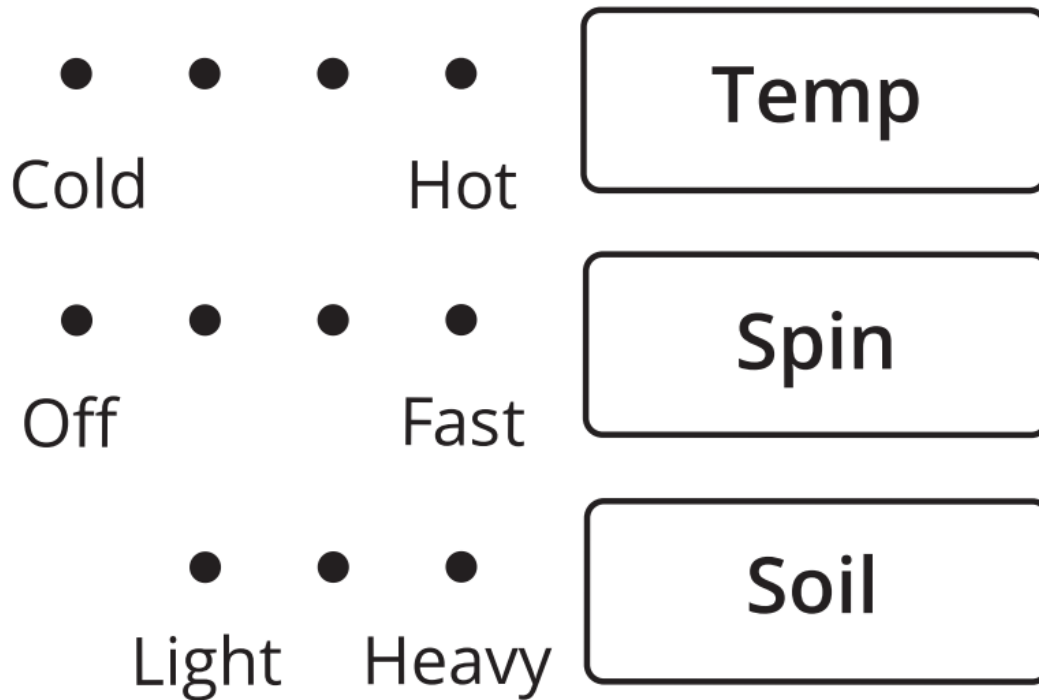

**SELECT ANY ADDITIONAL OPTIONS**

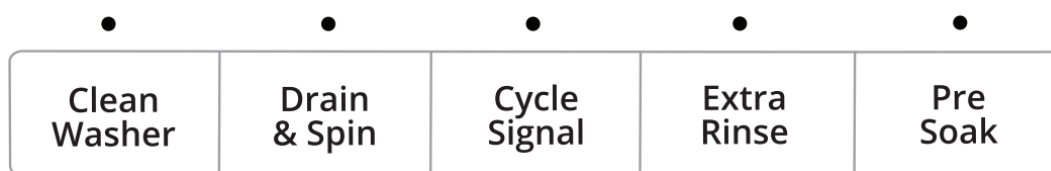

with **affresh**

Hold 3 sec for  
Control Lock

Additional options available:

- Cycle Signal
- Extra Rinse
- Pre-Soak

**TOUCH AND HOLD START TO BEGIN WASH CYCLE**



Touch and hold START for 3 seconds to start the wash cycle.

To add 1-2 additional garments, pause the cycle by Touching START once to add garments; then touch and hold START again to continue the cycle. To cancel a cycle, touch and hold POWER.

**MAINTENANCE**

- Run Clean Washer cycle every 30 loads.

The washer will also give you a reminder.

- Leave door open for ventilation when machine is not in use.
- Check door seal between cycles. Clean out small items and/or debris if present.

## Documents / Resources

	<p><a href="#">Amana WFC8090GX Front-Loading Washer</a> [pdf] User Guide WFC8090GX, YWFC8090GX, WFC8090GX Front-Loading Washer, WFC8090GX, Front-Loading Washer, Washer</p>
---	---