

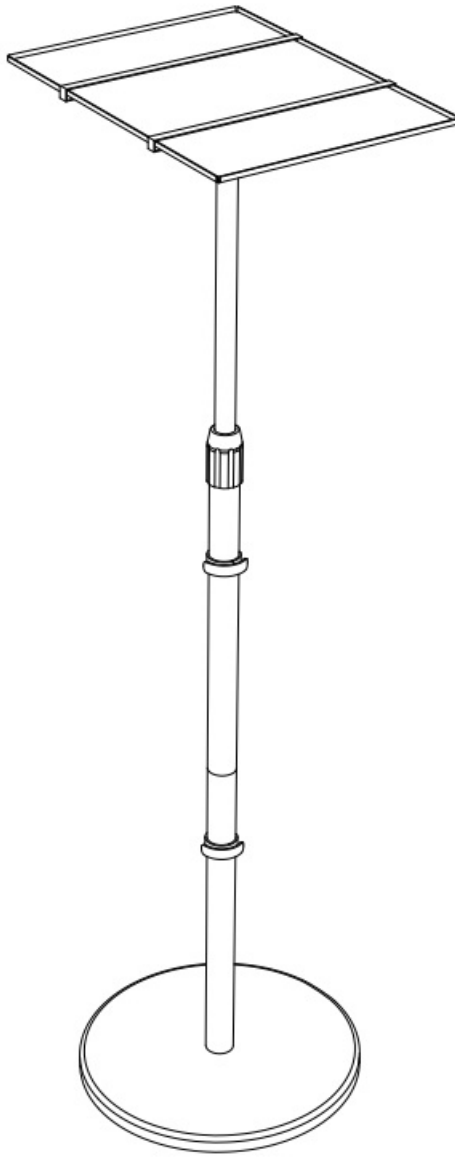

Amada AMPS04 Height Adjustable Projector Stand Instruction Manual

[Home](#) » [AMADA](#) » Amada AMPS04 Height Adjustable Projector Stand Instruction Manual 





Projector Stand

Contents

- [1 Choose Your Configuration](#)
- [2 IMPORTANT SAFETY INFORMATION](#)
- [3 Supplied Parts and Hardware](#)
- [4 Documents / Resources](#)
 - [4.1 References](#)

Choose Your Configuration

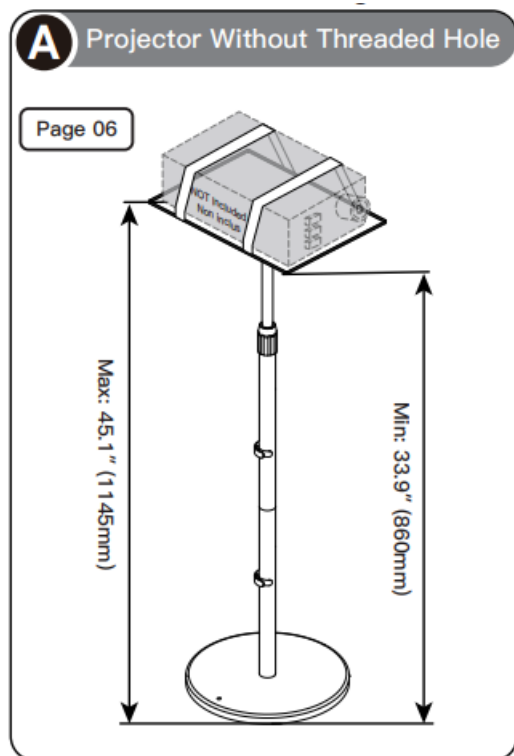

Pages 04, 05, 06

Pages 04, 05, 07

Pages 04, 05, 08

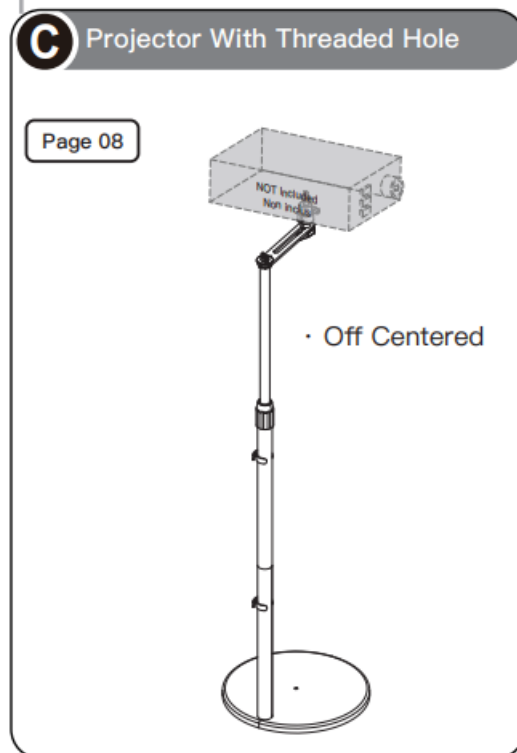
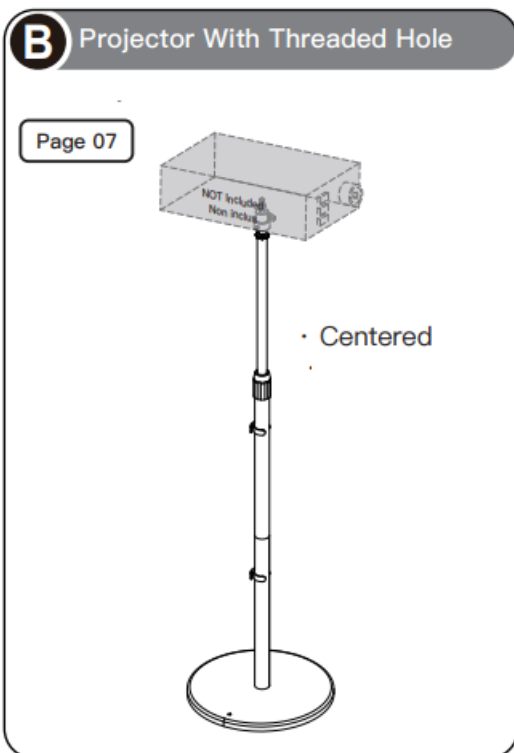

IMPORTANT SAFETY INFORMATION

Projector Stand Weight Capacity

Do not exceed weight capacity.



- Check package contents against supplied parts and hardware list to ensure that all components were received and undamaged. DO NOT use damaged or defective parts.

If you require replacement parts, please contact technical support at 877-200-3259 (US/CA) / 44-808-178-0934 (UK) or customer service at support@amadahome.com.

- Carefully read all instructions before attempting installation. If you have any questions or concerns, please contact please contact technical support at 877-200-3259 (US/CA) / 44-808-178-0934 (UK) or customer service at support@amadahome.com.
- DO NOT use this product for any purpose that is NOT explicitly specified in this manual. We are not liable for damage or injury caused by incorrect assembly or inappropriate use. Thank you for your understanding.
- WARNING: For use on flat, level surfaces only. Do not use on surfaces that are uneven or sloping.

Supplied Parts and Hardware

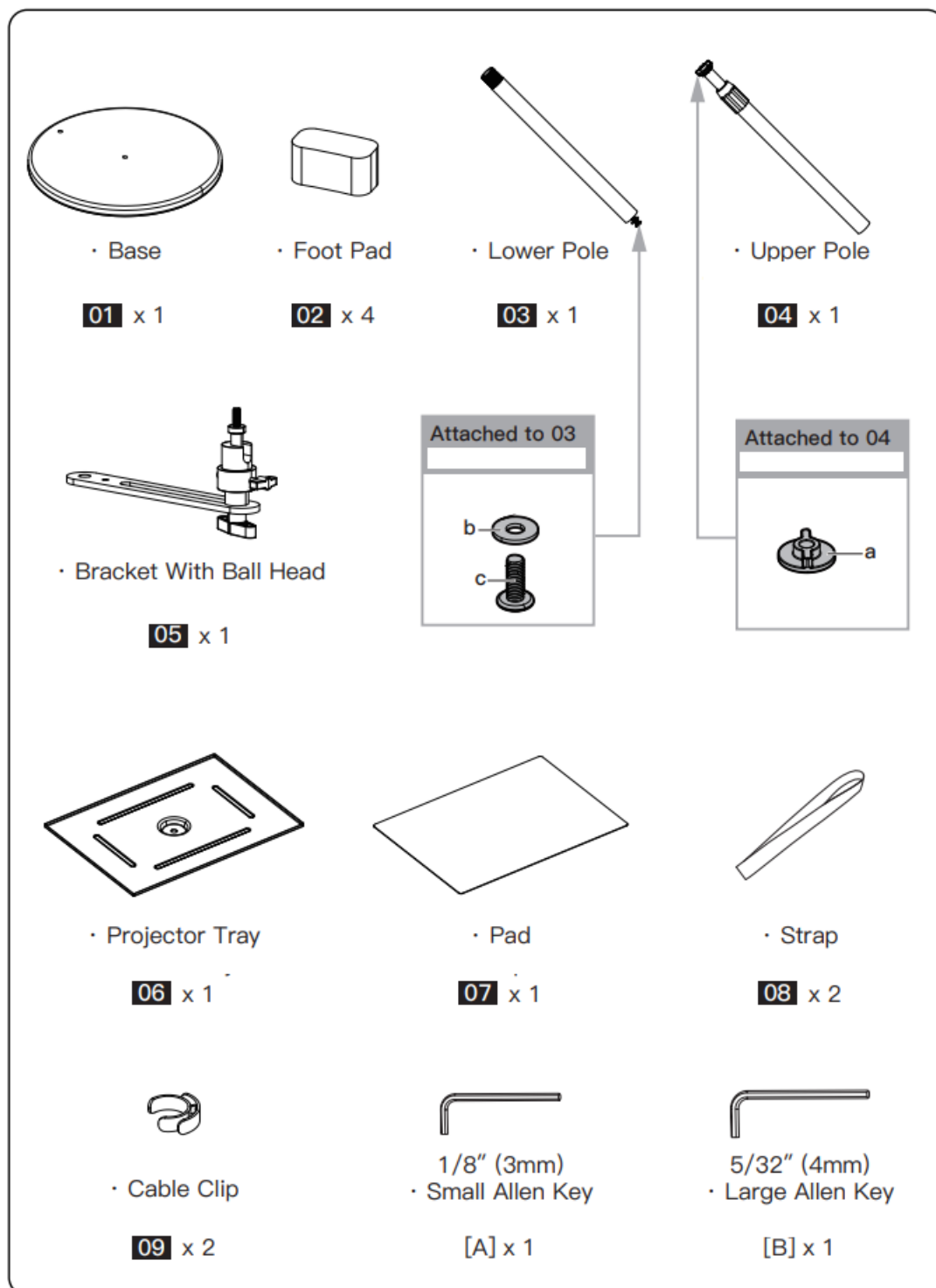

Step 1 Attach Foot Pads to Base

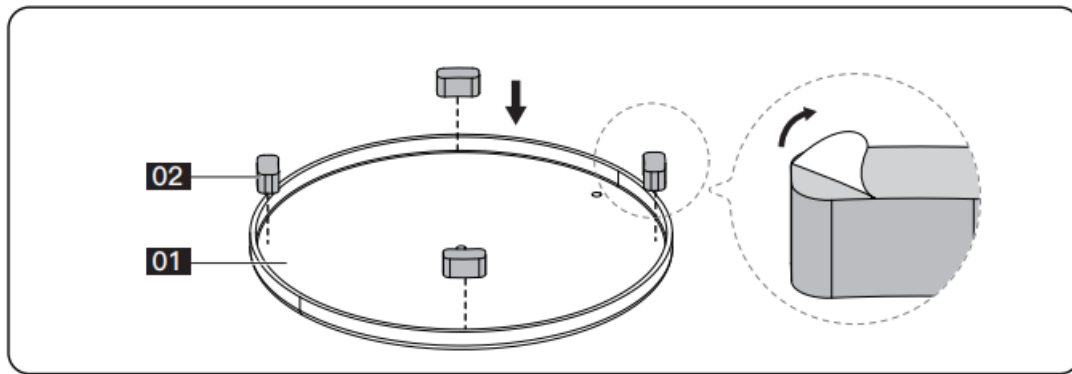

Step 2 Connect Poles to Base and Attach Other Parts to Pole End

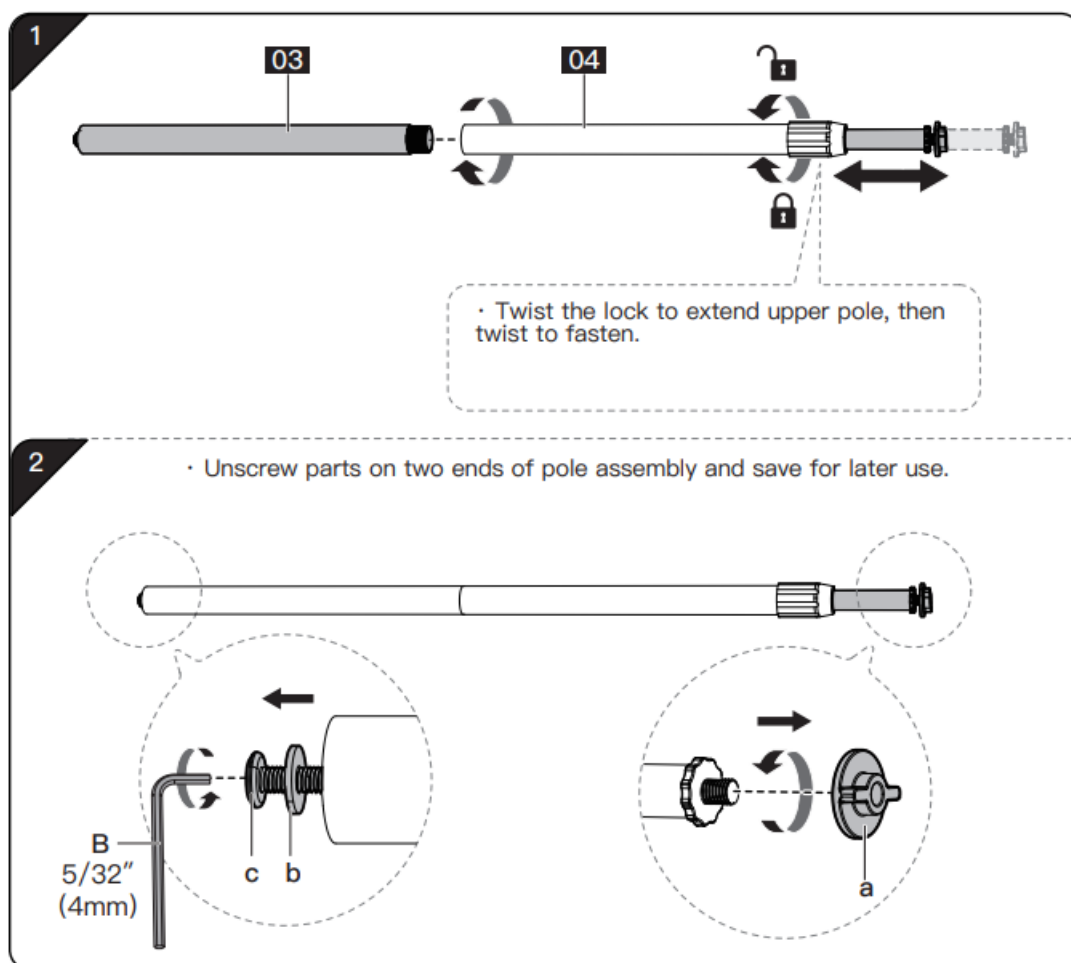

Projector Without Threaded Hole

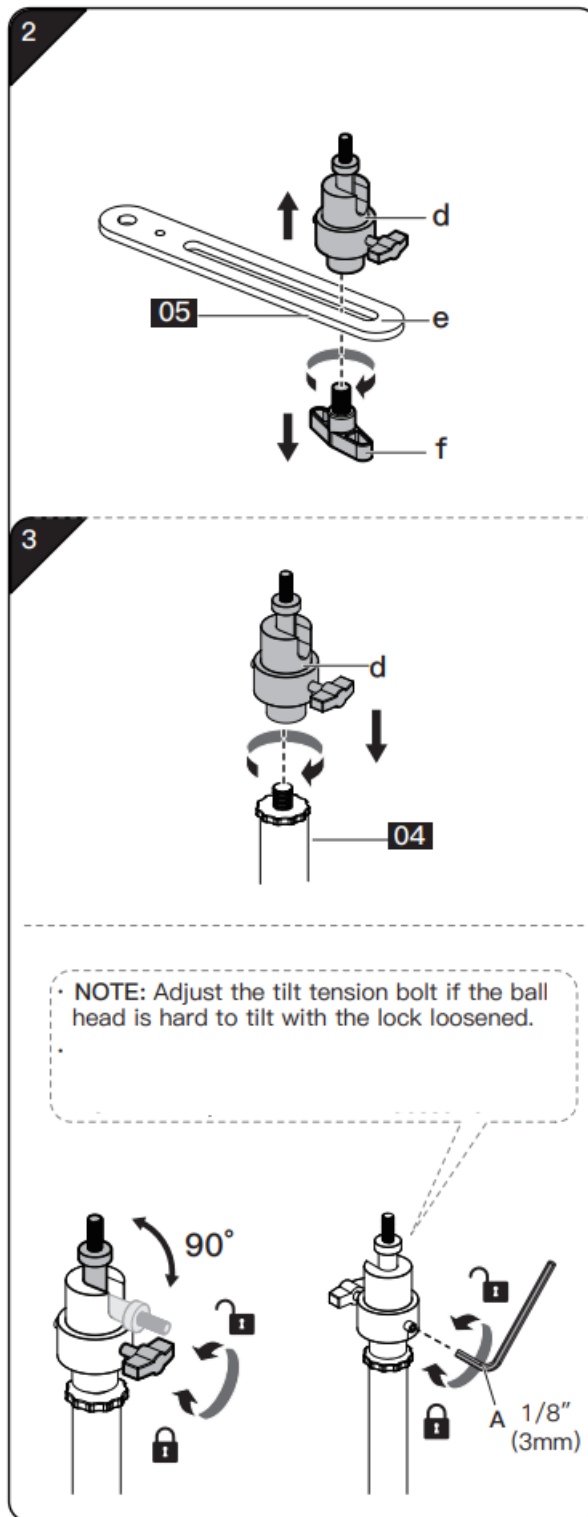
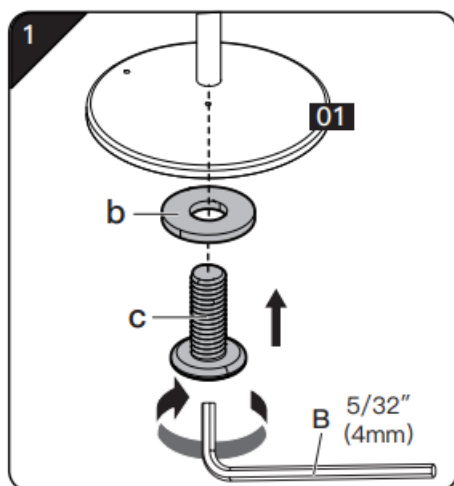
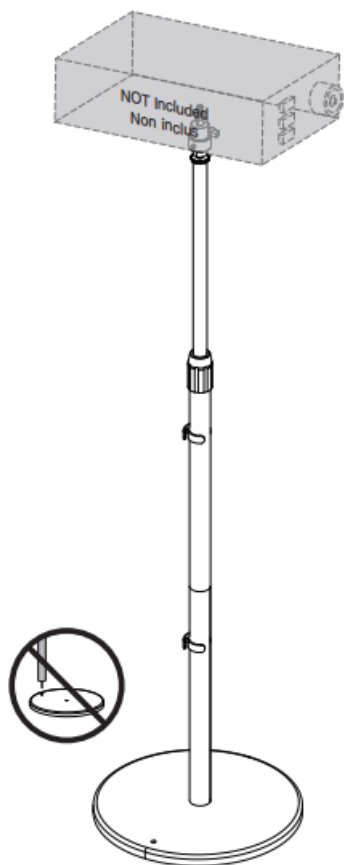

Projector With Threaded Hole

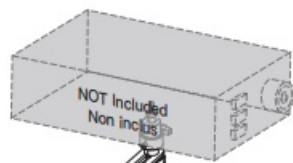

• NOTE: Position the bracket with ball head toward the center of base for stability.

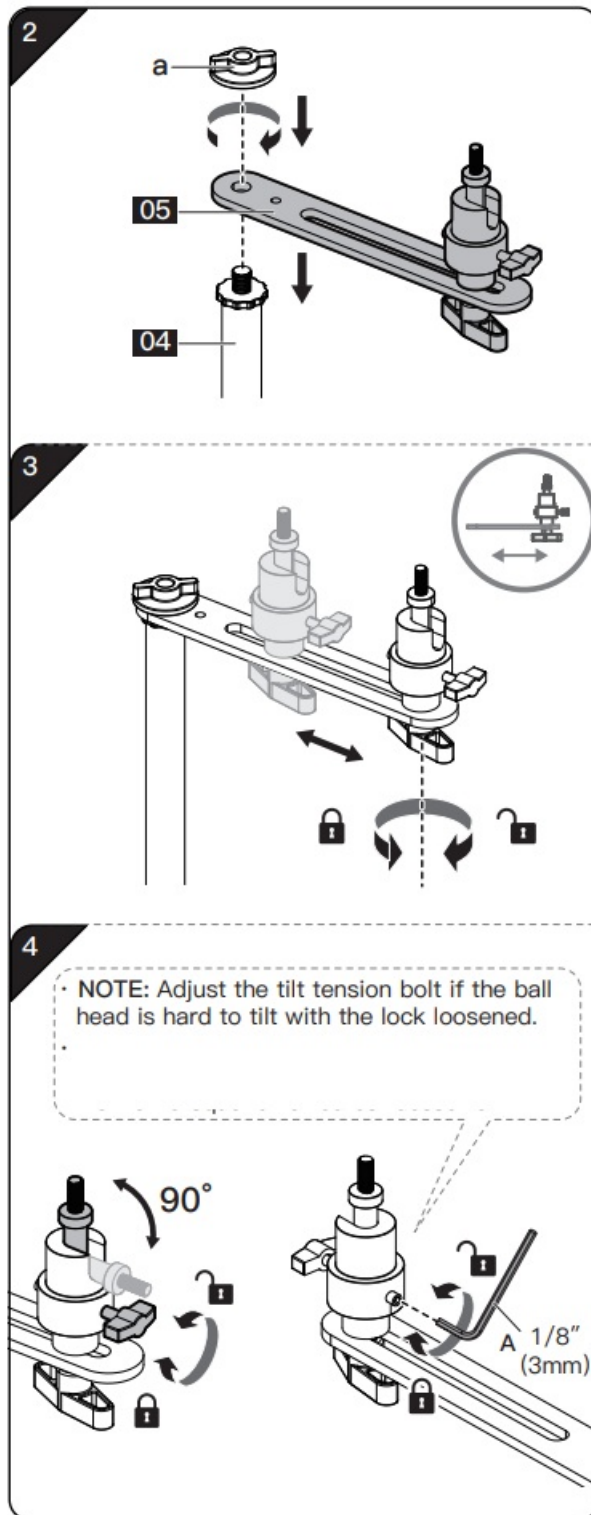
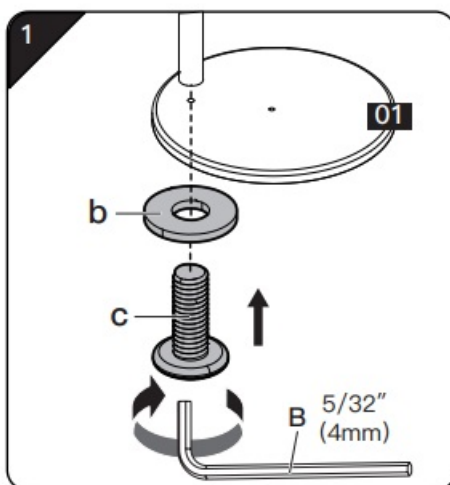

Step 3 Adjust the Height

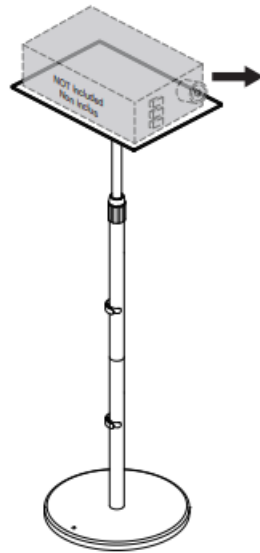

• NOTE: Remove the projector before height adjustment.

2

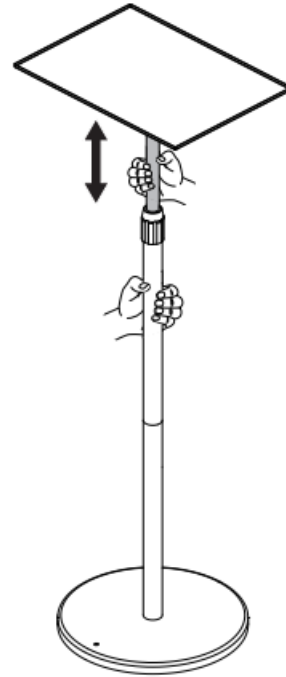

1

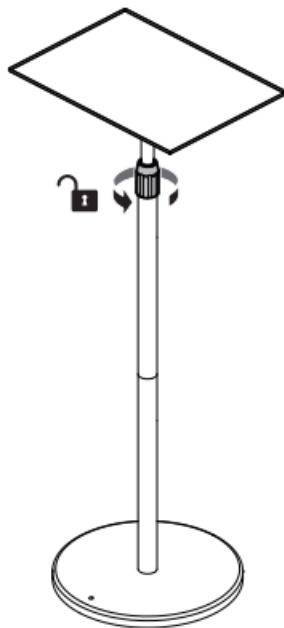

3



Step 4 Attach Cable Clips

Documents / Resources

 <p>The image shows the cover of the instruction manual for the Amada AMPS04 Height Adjustable Projector Stand. The cover is white with black text and a line drawing of the stand. The text includes 'INSTRUCTION MANUAL', 'MODEL CONFIGURATION', 'AMPS04', and 'Projector Stand'. It also lists the manufacturer 'AMADA CORPORATION' and provides contact information for technical support.</p>	<p>Amada AMPS04 Height Adjustable Projector Stand [pdf] Instruction Manual</p> <p>AMPS04 Height Adjustable Projector Stand, AMPS04, Height Adjustable Projector Stand, Adjustable Projector Stand, Projector Stand, Stand</p>
--	---

References

- [User Manual](#)