

## AMADA AMFS17 Floating Shelf Instruction Manual

[Home](#) » [AMADA](#) » AMADA AMFS17 Floating Shelf Instruction Manual 



### Contents

- [1 AMADA AMFS17 Floating Shelf Instruction Manual](#)
- [2 IMPORTANT SAFETY INFORMATION](#)
- [3 Tools Needed \(Not included\)](#)
- [4 Supplied Parts and Hardware](#)
- [5 For Option A Installation](#)
- [6 For Option B Installation](#)
- [7 Documents / Resources](#)
- [8 Related Posts](#)

**AMADA AMFS17 Floating Shelf Instruction Manual**



**Model: AMFS17**

Thank you for choosing this AMADA product! At AMADA we strive to provide you with the best quality products and services in the industry. Should you have any issues, please don't hesitate to contact us at [amada\\_supportus@163.com](mailto:amada_supportus@163.com).

## **IMPORTANT SAFETY INFORMATION**

- Check package contents against supplied parts and hardware list to assure that all components were received undamaged. Do not use damaged or defective parts. If you require replacement parts, please contact customer service at [amada\\_supportus@163.com](mailto:amada_supportus@163.com).
- Carefully read all instructions before attempting installation. If you do not understand the instructions or have any concerns or questions, please contact customer service at [amada\\_supportus@163.com](mailto:amada_supportus@163.com).
- Not all parts and hardware included will be used.
- Do not use this product for any purpose that is not explicitly specified in this manual.
- Do not exceed weight capacity. We cannot be liable for damage or injury caused by improper mounting, incorrect assembly or inappropriate use. Thank you for your understanding.

## **Tools Needed (Not included)**



Stud Finder



Level

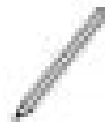

Pencil



Phillips  
Screwdriver



Drill



5/64 in. (2mm)  
Wood Drill



13/64 in. (5mm)  
Concrete Drill



Hammer

## Supplied Parts and Hardware



**01** (x3)



**02** (x3)



**03** (x1)

**04**  
Wood Board



Small



Screw  
M4x15mm  
**A** x16



Short Lag Screw  
M4x30mm  
**B** x12



Long Lag Screw  
M4x50mm  
**C** x12



Middle



Large

Wall Anchor



M13x42mm  
**D** x12

### ⚠ CAUTION!

This wall anchor **[D]** is for drywall ONLY. DO NOT use them in concrete / brick / wood studs wall.

Wall Anchor



ø6x30mm  
**E** x12

### ⚠ CAUTION!

This wall anchor **[E]** is for concrete or brick walls ONLY. DO NOT use them in drywall or wood studs.

### Step 1 Secure the Metal Frame [01], [02] and [03] to the Wood Board [04]

There are 2 installation options while attaching the metal frame on the wood board, you can choose the installation method according to your needs.

Option A:

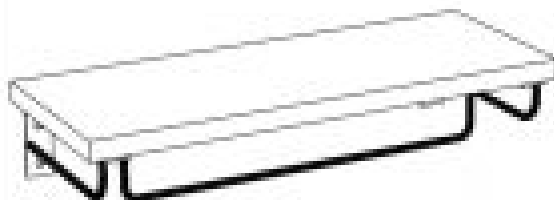

Option B:

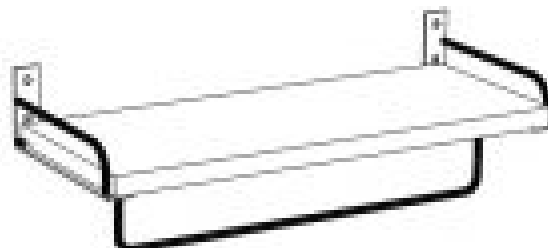

#### For Option A Installation

Option A-1:

##### Caution:

The metal frame [01] and [02] should be secured along the side of the wood board. Otherwise the towel rack [03] can not be fixed on the large wood board.

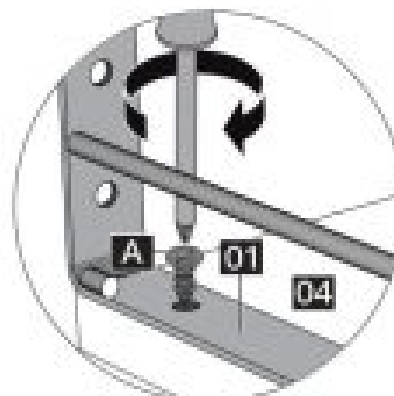
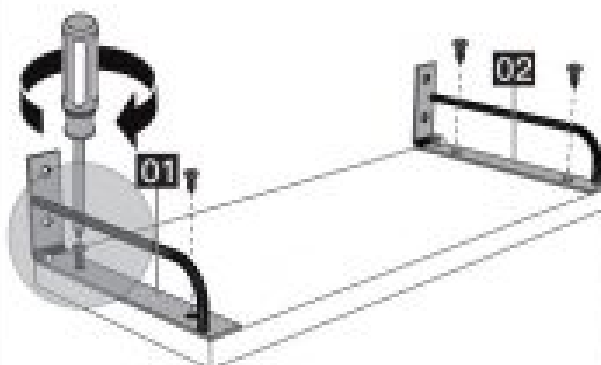

Option A-2:

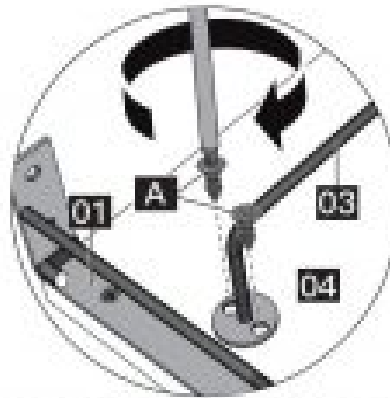
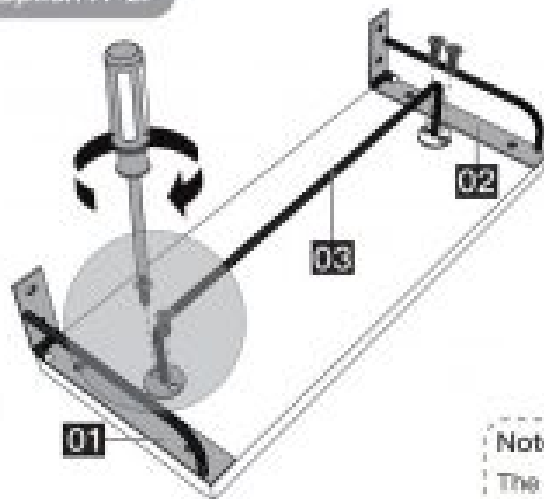

Please refer to method of the Option A-1 to secure the towel rack [03] on the wood board

Note:

The towel rack [03] is only suitable for the largest wood board. For better to install the wood board on wall, you need to attach the towel rack [03] on the center location of the largest wood board.

For Option B Installation

Option B-1:

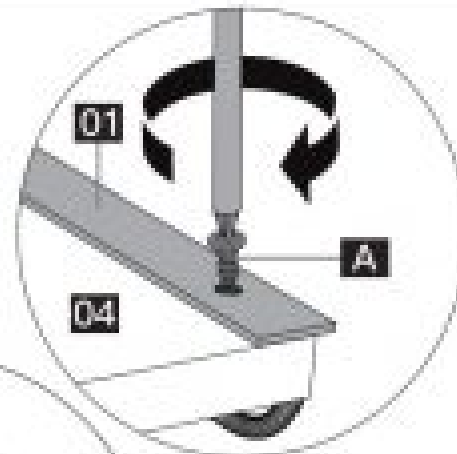
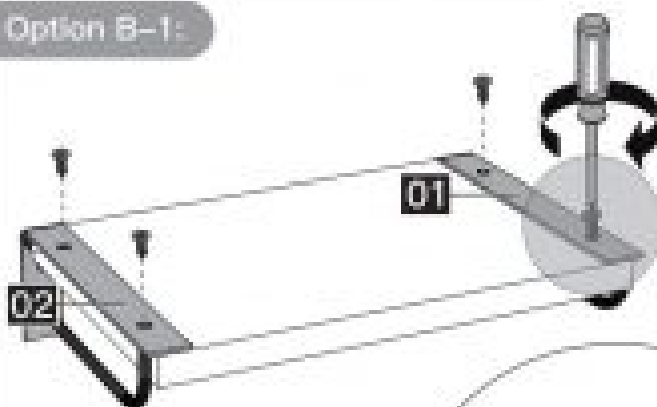

Electric screw driver  
is recommended  
[Not Included]

### Option B-2:

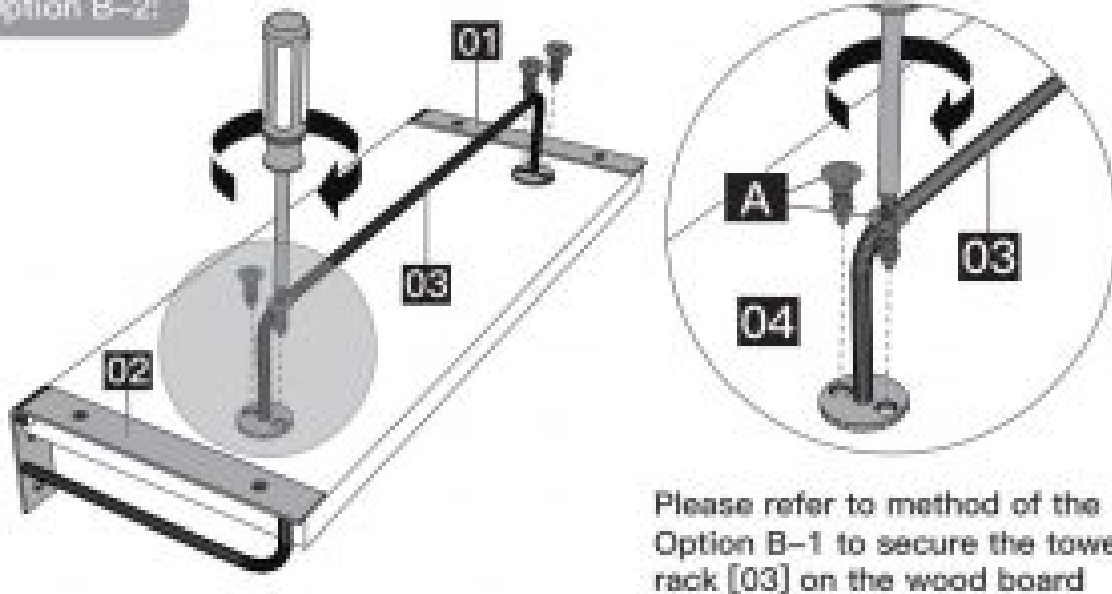

## Step 2 Secure Metal Frame with Wood Board on Wall

Before installation, please identify your wall type.

For wood stud installation, follow the step 2A.

For drywall installation, follow the step 2B.

For solid concrete and concrete block walls installation, follow the step 2C

### Step 2A For Wood Stud

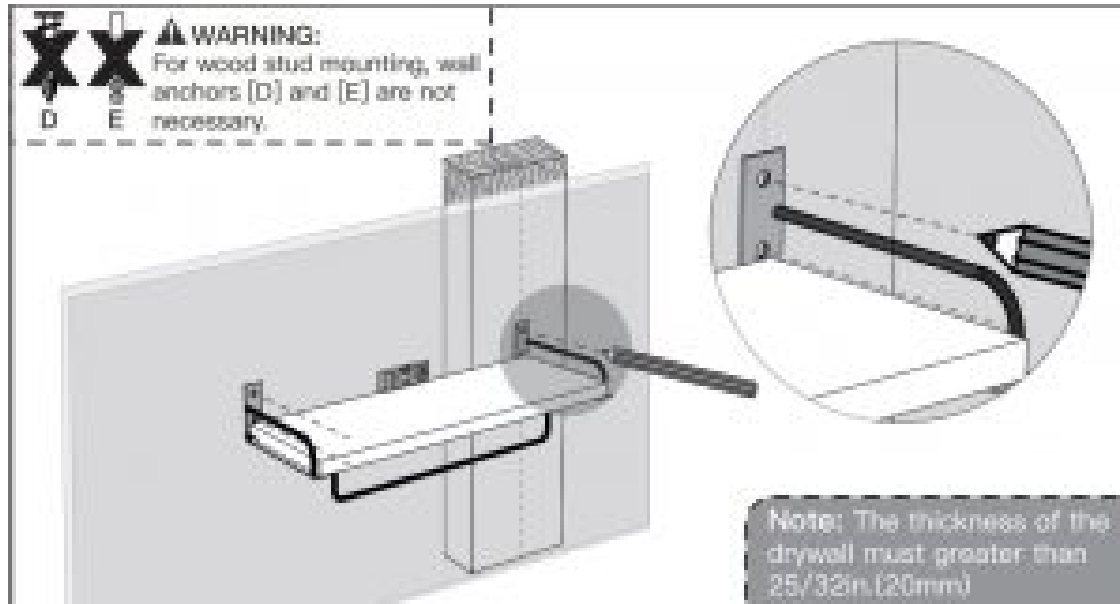

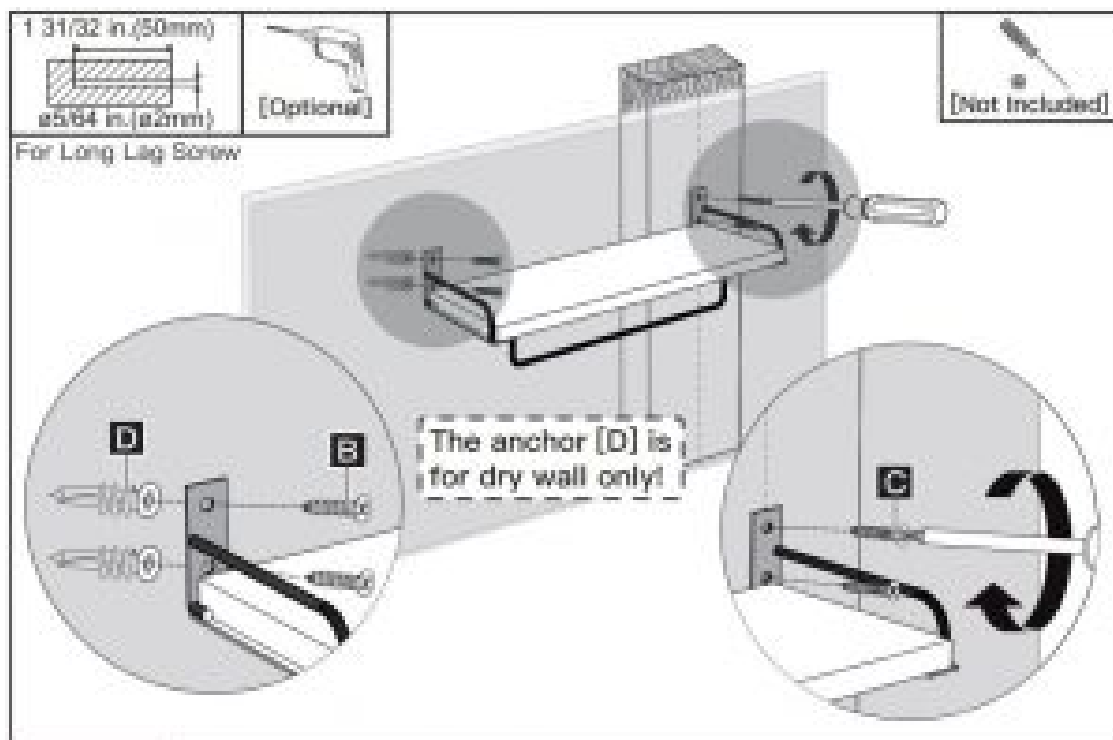

## Step 2B For Drywall

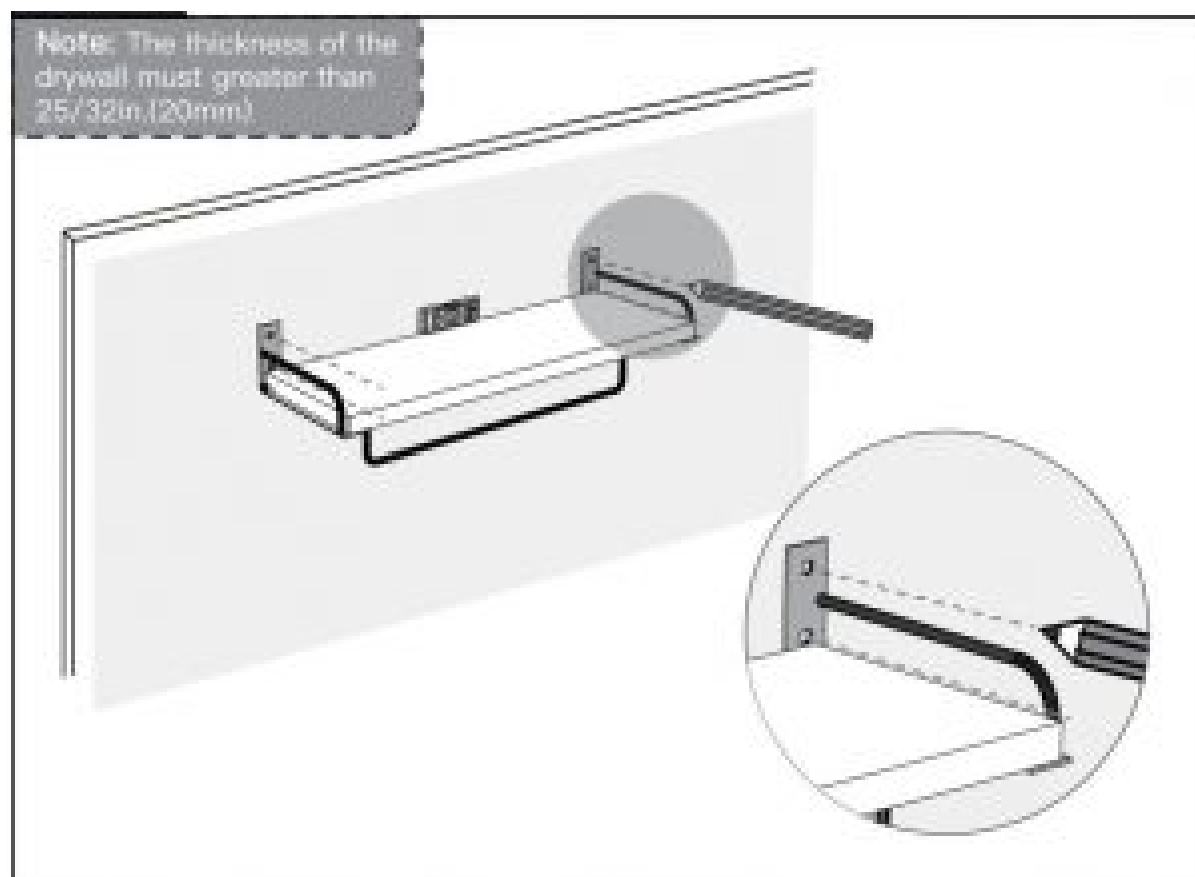

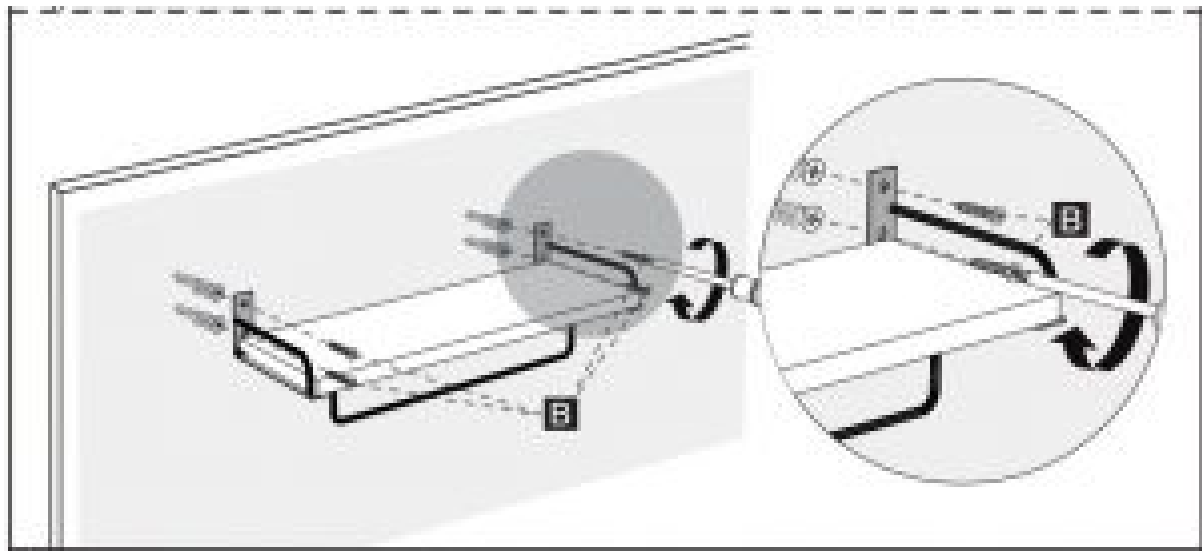
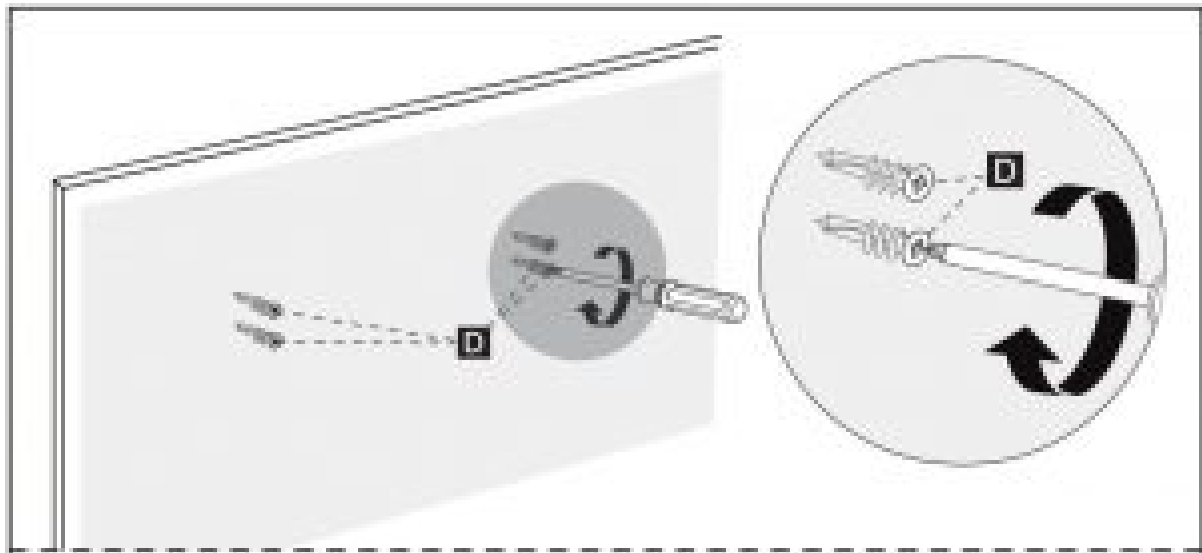

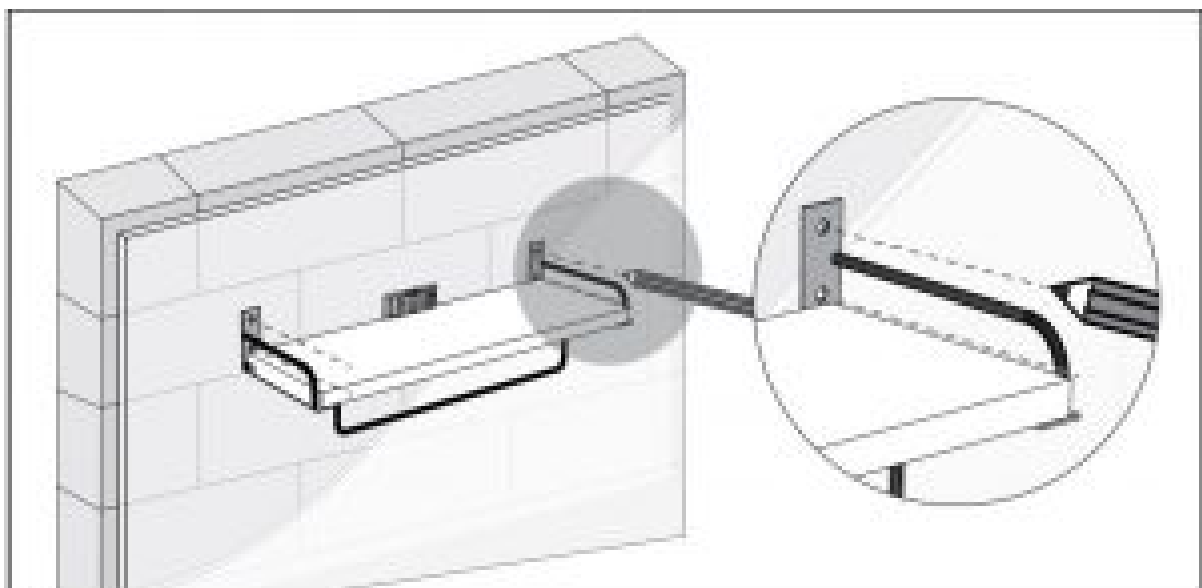

**Step 1C** For Solid Concrete and Concrete Block Walls



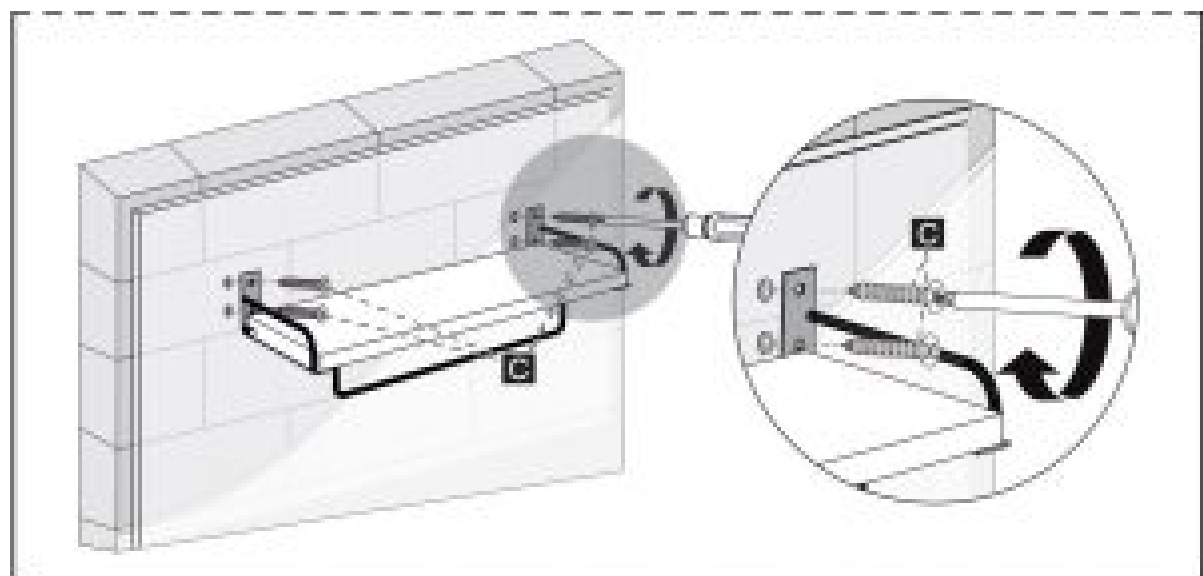
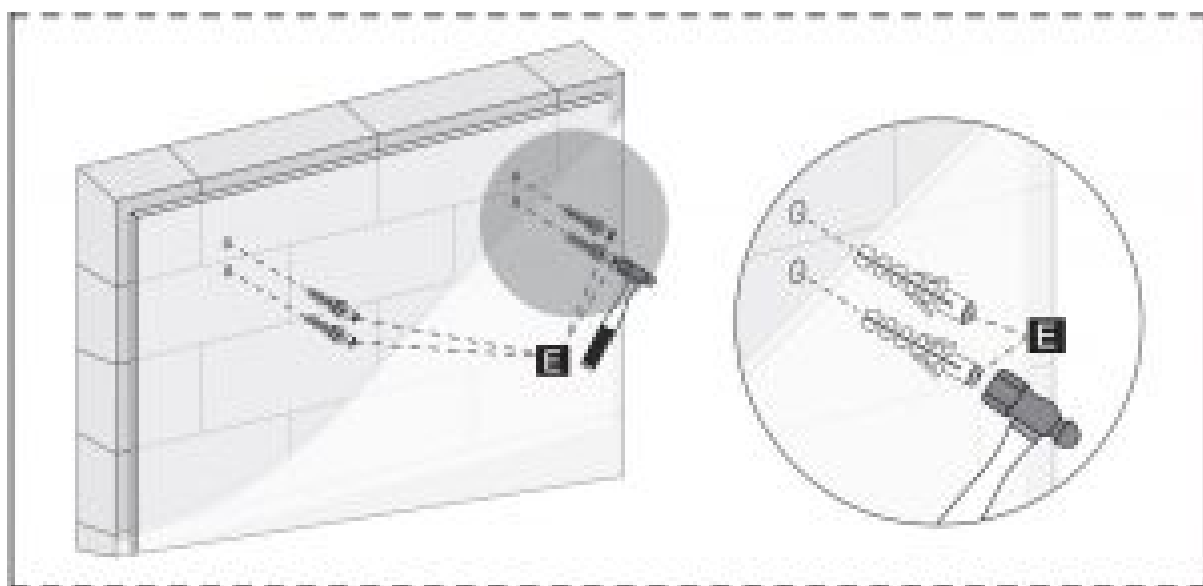
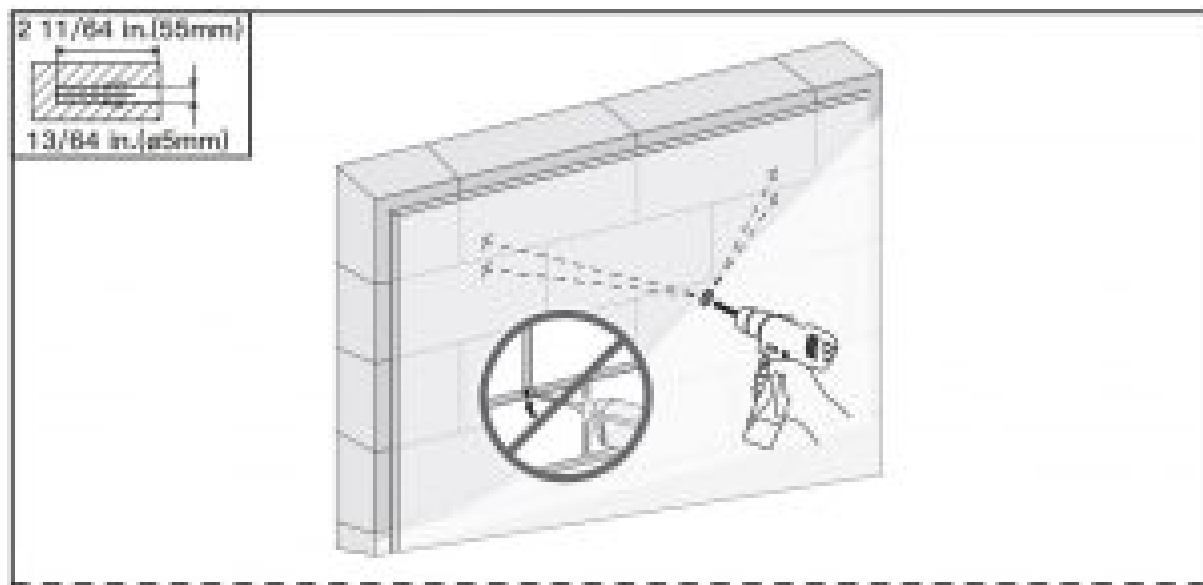



 <p>AMADA Floating Shelf Instruction Manual</p> <p>Model: AMFS17</p> <p><small>Thank you for choosing the AMADA product. At AMADA we strive to provide you with the best quality products and services in the industry. Should you have any inquiry, please don't hesitate to contact us at <a href="mailto:amada_support@102.com">amada_support@102.com</a>.</small></p>	<p><a href="#">AMADA AMFS17 Floating Shelf</a> [pdf] Instruction Manual</p> <p>AMFS17, Floating Shelf</p>
--	---