



alula RE663 LED Keypad Instruction Manual

[Home](#) » [alula](#) » alula RE663 LED Keypad Instruction Manual 

Contents

- [1 alula RE663 LED Keypad](#)
- [2 OVERVIEW](#)
- [3 Feature](#)
- [4 Operate](#)
- [5 Keypad Mounting Options](#)
- [6 Wall Mounting](#)
- [7 Pro Tips](#)
- [8 Specifications](#)
- [9 Documents / Resources](#)
 - [9.1 References](#)
- [10 Related Posts](#)



alula RE663 LED Keypad

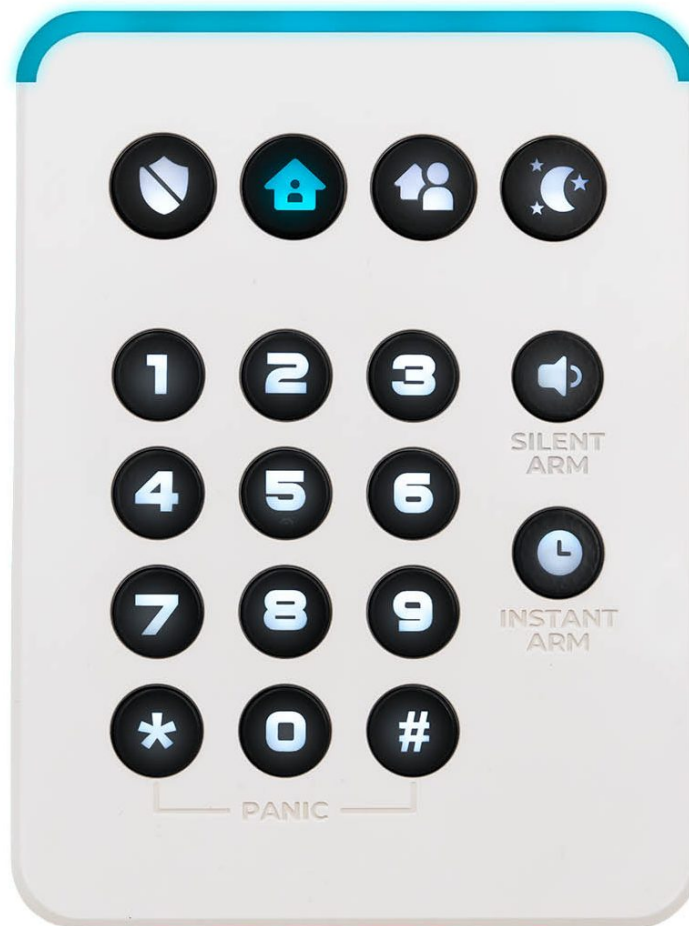

OVERVIEW

LED Keypad is a table or wall-mounted interface that chimes and uses lit keys and an LED light bar to provide visual arming status. The LED Keypad can be battery operated or AC powered for flexible installs.



Feature

- Displays real-time status
- Wall or table mount
- AC or battery primary power
- 1-year battery life for battery primary power
- User-replaceable AA batteries

Enroll by placing the panel and LED Keypad into wireless enrollment mode. Press the enroll button on the side of the panel to put the panel into a wireless enrollment mode. Hold 1 and 3 simultaneously for 3 seconds on the Keypad to put the Keypad into wireless enrollment mode.

Operate

Using the LED Keypad buttons.

Lightbar

- Indicates arming level with color (Disarm – Green, Stay – Cyan, Away – Red, Night – Blue).
- Amber corners indicate trouble conditions.
- The AC-powered operation uses full light bar. Light bar “breathes” if zones are open.
- Battery operation uses light bar corners. The light bar blinks periodically and will double blink periodically if zones are open.

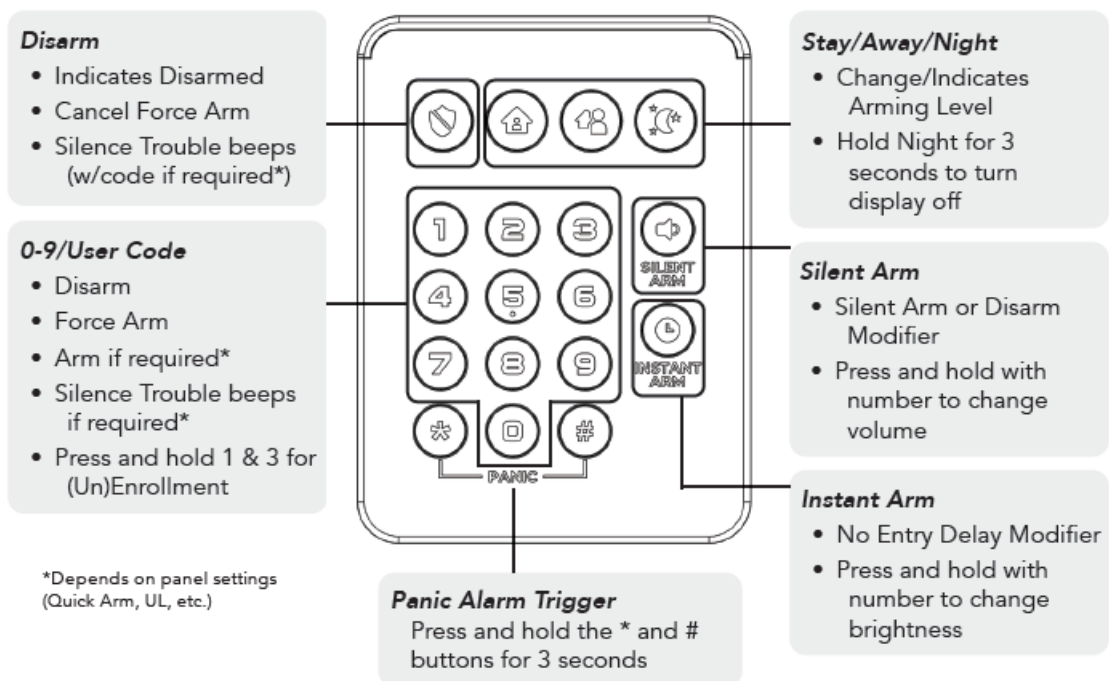

Keypad Mounting Options

Table Top Mounting

- Insert batteries into Keypad following polarity markings.
- Route power cable through wire window in table stand. Connect the power supply by inserting the barrel plug into the black port. Orient the barrel plug as shown.

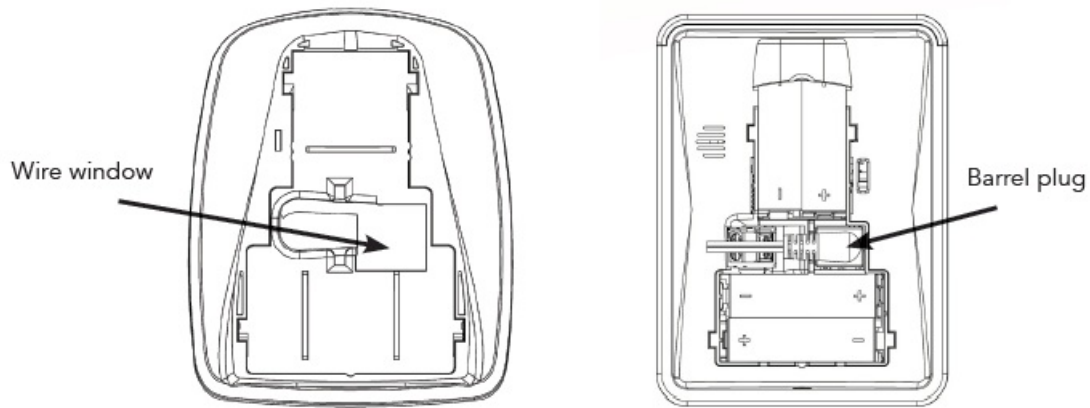

- Insert the Keypad into the table stand. Push any extra wire into the stand before inserting it into stand. Slide the Keypad on stand until it “clicks” into place.

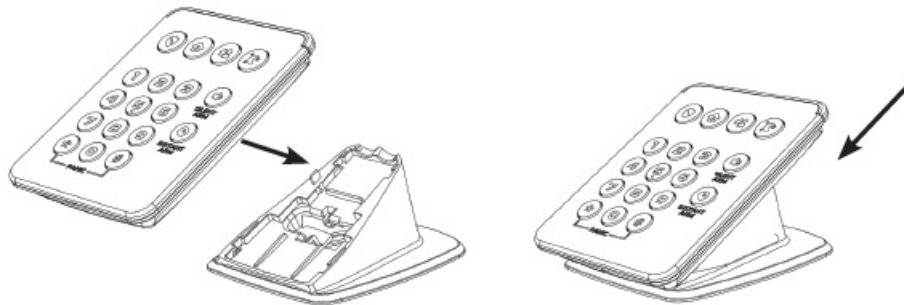

- Coil up the excess power wire into the stand. Insert wire into wire holder and close stand cover to contain excess wires.

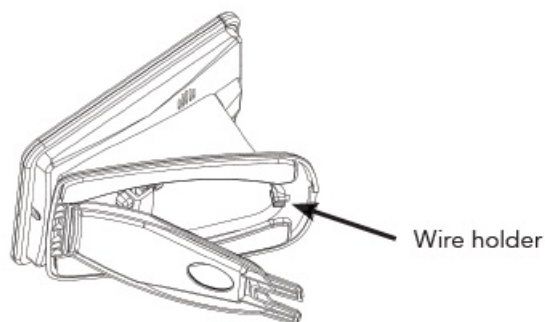

Wall Mounting

- **Insert batteries** into Keypad following polarity markings.
- **Fasten to the wall** by screwing the screws through the two holes into the wall. Screws should be fastened to a stud, a single gang box, or with wall anchors into drywall. Ensure power supply wires are routed through wire window and seated in wire channel if wire does not run behind drywall.

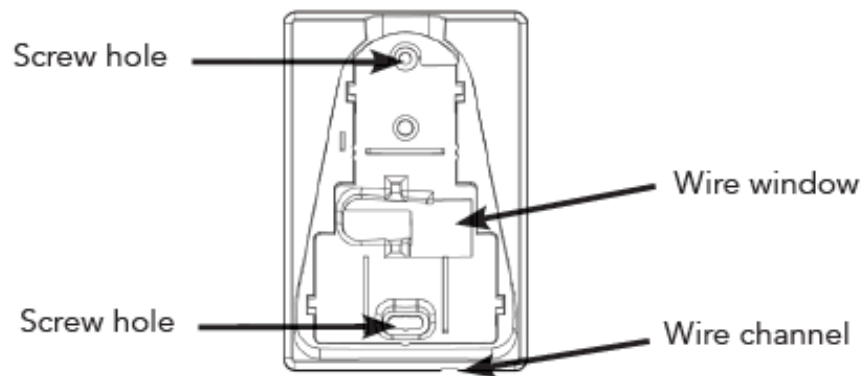

- **Route power cable using one of two methods.**

A. Wires to Terminal Block: Connect one end of the wires to the terminal block. Splice the other end of the wires to the provided power supply. Polarity does not matter. **MUST USE PROVIDED POWER SUPPLY.** Wire lengths must not exceed lengths listed below.

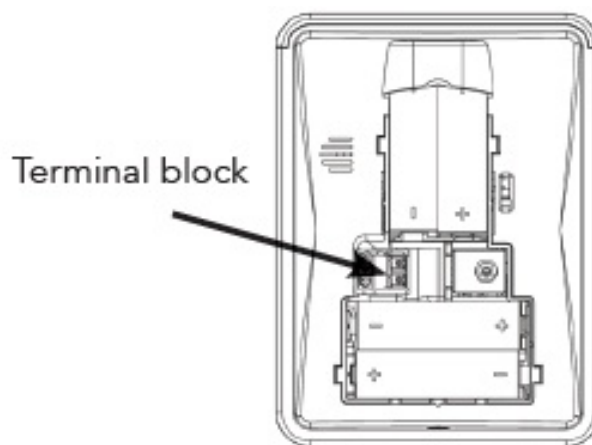

WIRE GAUGE	MAXIMUM LENGTH BETWEEN POWER SUPPLY AND KEYPAD
#24	Up to 50 feet
#22	Up to 100 feet
#20	Up to 150 feet
#18	Up to 250 feet
#16	Up to 400 feet

- **Barrel Plug:** Connect the power supply by inserting the barrel plug into the black port. Orient the connector as shown.

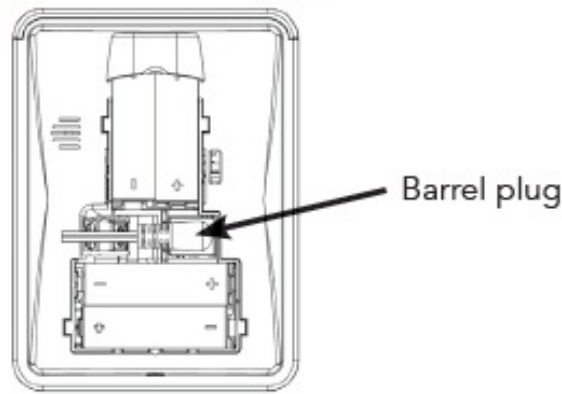

- Insert the Keypad into the mounting plate. Push any extra wire behind wall plate before inserting into mounting plate. Slide the Keypad on plate until it “clicks” into place.

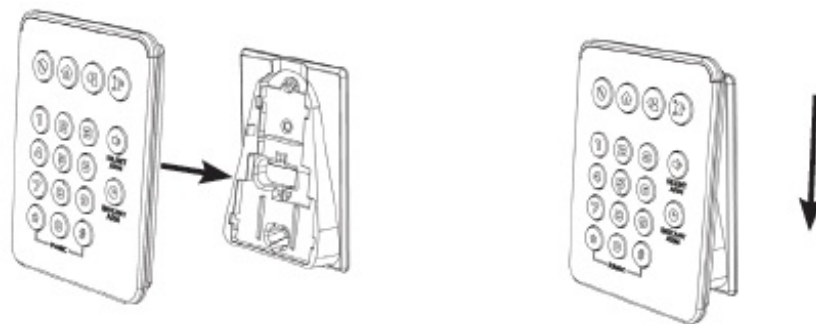

- **Plug in power supply.**

Pro Tips

- Wire can be hidden by running the wires through a hole behind the wall mounting plate and along the back side of the drywall to a location with an outlet.
- Switching to battery primary power can be done by restarting the keypad with the battery power. First, remove wall power supply and batteries. Wait 10 seconds. Then, power the keypad back up with only batteries.
- Unenrollment can be done by following the same steps as enrollment.
- Force unenroll can be done when no panel is present. Hold the 1 and 3 keys simultaneously to enter unenrollment mode. After the keypad fails to unenroll, hold the 1 and 3 keys simultaneously again to force unenroll.

Specifications

Physical

<p>Wall Dimensions Table Top Footprint Weight</p> <p>Mounting Fasteners</p> <p>Pilot Hole for Screw into Wood</p> <p>Pilot Hole for Wall Anchor</p>	<p>3.81 x 5.10 x 1.55 inches (9.68 x 12.94 x 3.94 cm)</p> <p>3.81 x 5.47 x 3.17 inches (9.68 x 13.89 x 8.05 cm)</p> <p>1.49 lb (675 g)</p> <p>#6 screws & 2 wall anchors (included) Ø 1/8 in (3 mm)</p> <p>Ø 3/16 in (4.7 mm)</p>
Environmental	
<p>Operating Temperature</p> <p>Maximum Humidity</p>	<p>32 to 120°F (0 to 49°C)</p> <p>85% relative humidity non-condensing</p>
Device Specifications	
<p>Frequency</p> <p>Power Transformer Input</p> <p>Output</p> <p>Part Number Replacement Battery Nominal Battery Life Current Draw Transmitted Indications</p>	<p>2.4 GHz</p> <p>100-240VAC, 50/60Hz, 0.5A</p> <p>12VDC, 1A RE012-6</p> <p>4 AA batteries</p> <p>1 year (Battery operation under normal use)</p> <p>350mA (Maximum)</p> <p>Low Battery, Supervision, Tamper, AC Fail</p>
Certification	
RE663	FCC, IC

This device complies with Industry Canada license-exempt RSS standard(s). Operation is subject to the following two conditions:

- This device may not cause interference, and
- This device must accept any interference, including interference that may cause undesired operation of the device.

FCC NOTICE

This device complies with Part 15 of the FCC rules. Operation is subject to the following two conditions:

- This device may not cause harmful interference.
- This device must accept any interference that may be received, including interference that may cause undesired operation.

Changes or modifications not expressly approved by Alula could void the user's authority to operate this equipment.

FCC ID: U5X-RE663

Documents / Resources

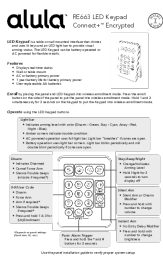
	<p>alula RE663 LED Keypad [pdf] Instruction Manual RE663, U5X-RE663, U5XRE663, RE663 LED Keypad, LED Keypad, Keypad</p>
--	---

References

- [Professional Smart Security System | Home Security Dealer Program | Alula](#)