



# Altronix TM400 Power Distribution and Mercury-LenelS2 Boards Installation Guide

[Home](#) » [Altronix](#) » Altronix TM400 Power Distribution and Mercury-LenelS2 Boards Installation Guide 

## Contents

- [1 Altronix TM400 Power Distribution and Mercury-LenelS2 Boards](#)
- [2 Overview](#)
- [3 Specifications](#)
- [4 Enclosure Accommodates a Combination of the Following](#)
- [5 Hardware and Accessories](#)
- [6 Installation Instructions](#)
- [7 Installation Instructions for Power Supply and Sub-Assemblies](#)
- [8 Access Controller Position Chart for the Following Models](#)
- [9 TM400 Enclosure Dimensions](#)
- [10 Documents / Resources](#)
  - [10.1 References](#)
- [11 Related Posts](#)



**Altronix TM400 Power Distribution and Mercury-LenelS2 Boards**



## Overview

Altronix TM400 enclosure lets you easily integrate Altronix power distribution with Mercury/LenelS2 access controllers and accessories. TM400 simplifies board layout and wire management, reduces installation time and labor costs.

## Specifications

- Agency Listings:
  - CE European Conformity.
- Features:
  - 16 Gauge black enclosure with ample knockouts for convenient access.
    - Twelve (12) double knockouts 1.125" (3/4" Conduit) / 1.375" (1" Conduit).
  - Enclosure Dimensions (H x W x D): 15.5" x 12.0" x 4.5" (393.7mm x 304.8mm x 114.3mm).
  - Includes tamper switch (Altronix Model TS112 or equivalent), cam lock and mounting hardware.

## Enclosure Accommodates a Combination of the Following

### Altronix:

- One AL400ULXB2, AL400ULXB2V, AL600ULXB, AL600XB220, AL1012ULXB, AL1012XB220, eFlow4NB, eFlow4NBV, eFlow6NB, eFlow6NBV, eFlow102NB, eFlow102NBV.

### Mercury:

- Up to three (3) MR50 (LNL-1300).
- One (1) LP1501 (LNL-2210) or MR62e (LNL-1300e).

- One (1) LP1502 (LNL-2220), LP4502 (LNL-4420), MR52 (LNL-1320), MR16IN (LNL-1100) or MR16OUT (LNL-1200).

## Hardware and Accessories



## Installation Instructions

Wiring methods shall be in accordance with the National Electrical Code/NFPA 70/ANSI, and with all local codes and authorities having jurisdiction. Product is intended for indoor use only.

1. Mark and predrill holes on the wall to line up with the top two keyholes in the enclosure. Install two upper fasteners and screws in the wall with the screw heads protruding. Place the enclosure's upper keyholes over the two upper screws; level and secure. Mark the position of the lower two holes. Remove the enclosure. Drill the lower holes and install the two fasteners.  
Place the enclosure's upper keyholes over the two upper screws. Install the two lower screws and make sure to tighten all screws.
2. Mount included UL Listed tamper switch (Altronix Model TS112 or equivalent) in desired location, opposite hinge. Slide the tamper switch bracket onto the edge of the enclosure approximately 2" from the right side (Fig. 1, pg. 1). Connect tamper switch wiring to the Access Control Panel input or the appropriate UL Listed reporting device. To activate alarm signal open the door of the enclosure.

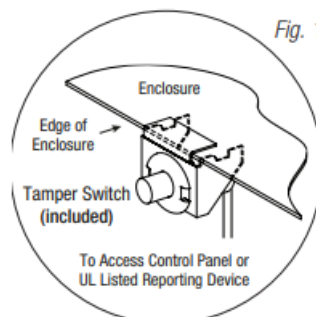

3. Mount Altronix and Mercury (LenelS2) boards to enclosure, refer to page 3.

## Installation Instructions for Power Supply and Sub-Assemblies

### Altronix Power Supplies/Chargers and/or Sub-Assemblies:

1. Fasten 5/8" spacers (provided) to pems that match the hole pattern for Altronix Power Supply/Charger or Altronix Sub-Assembly boards (Fig. 2, pg. 3). Fasten metal spacers in the correct locations to provide proper grounding (Fig. 2, pg. 3).
2. Mount boards to spacers utilizing 5/16" pan head screws (provided) (Fig. 2, 2a, pg. 3).

### LenelS2 Sub-Assemblies:

3. Fasten spacers onto metal pems configuration (C), (D) or (E) of enclosure depending on the sub-assembly module (Fig. 2, pg. 2).
4. Position access controller module over corresponding spacers and depress onto snap on spacers (Fig. 2a, pg. 2).

5. Fasten backplane to Trove1 enclosure utilizing lock nuts (provided).

## Access Controller Position Chart for the Following Models

AL400ULXB2, AL400ULXB2V, AL600ULXB, AL600XB220, AL1012ULXB, AL1012XB220,  eFlow4NB, eFlow4NBV, eFlow6NB, eFlow6NBV, eFlow102NB, eFlow102NBV	A
ACM4, ACM4CB, LINQ8PD, LINQ8PDCB, MOM5, PD4UL, PD4ULCB, PD8UL, PD8ULC B, PDS8, PDS8CB, VR6	B
MR50 (LNL-1300)	C
LP1501 (LNL-2210), MR62e (LNL-1300e)	D
LP1502 (LNL-2220), LP4502 (LNL-4420), MR52 (LNL-1320), MR16IN (LNL-1100), MR16 OUT (LNL-1200)	E

Fig. 2 - Altronix and Mercury configurations

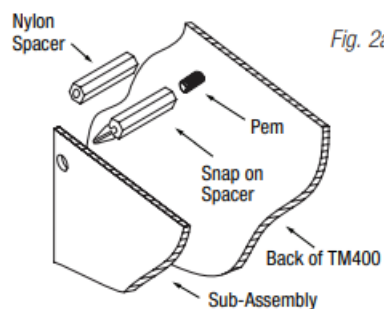
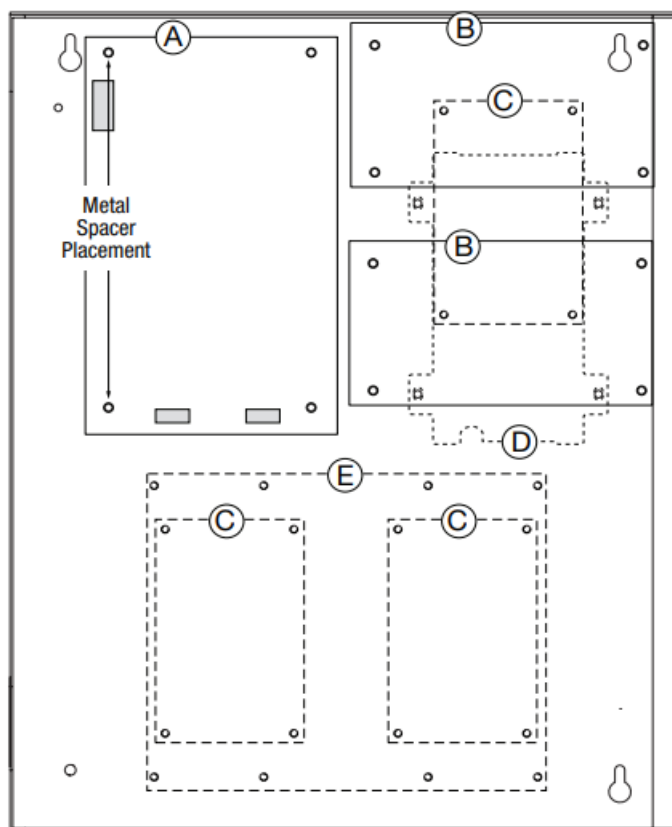
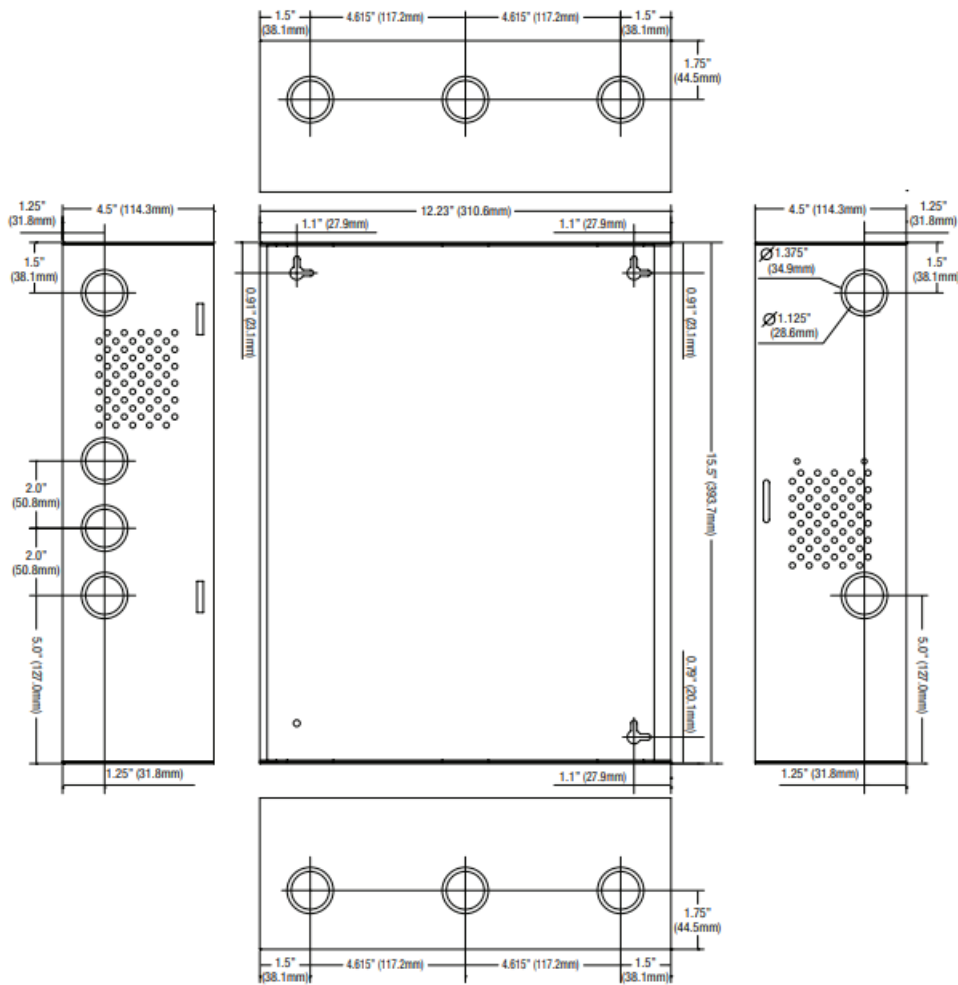

Fig. 2a



## TM400 Enclosure Dimensions

15.5" x 12.0" x 4.5" (393.7mm x 304.8mm x 114.3mm)



Altronix is not responsible for any typographical errors. 140 58th Street, Brooklyn, New York 11220 USA | phone: 718-567-8181 | fax: 718-567-9056  
website: [www.altronix.com](http://www.altronix.com) | e-mail: [info@altronix.com](mailto:info@altronix.com) IITM400

Documents / Resources

 <b>TM400</b> Compact enclosure for Altronix power distribution and Mercury-LenelS2 boards  Installation Guide  CE 	<a href="#">Altronix TM400 Power Distribution and Mercury-LenelS2 Boards [pdf] Installation Guide</a> TM400 Power Distribution and Mercury-LenelS2 Boards, TM400, Power Distribution and Mercury-LenelS2 Boards, Mercury-LenelS2 Boards, Boards
--	--

References

-  [Altronix Home](#)