



Altimus 230V AC Timer with Changeover Switch Owner's Manual

[Home](#) » [Altimus](#) » Altimus 230V AC Timer with Changeover Switch Owner's Manual 

Contents

- 1 Altimus 230V AC Timer with Changeover Switch
- 2 Overview
- 3 Model specification
- 4 Three functions combine into a timer
- 5 Buttons
- 6 Technical Data
- 7 Wiring for 3 models
- 8 Setting method
 - 8.1 Adjustment of the present time
 - 8.2 Timer setting
- 9 Dimensions
- 10 Installation combination diagram
- 11 Documents / Resources



Altimus 230V AC Timer with Changeover Switch



Overview

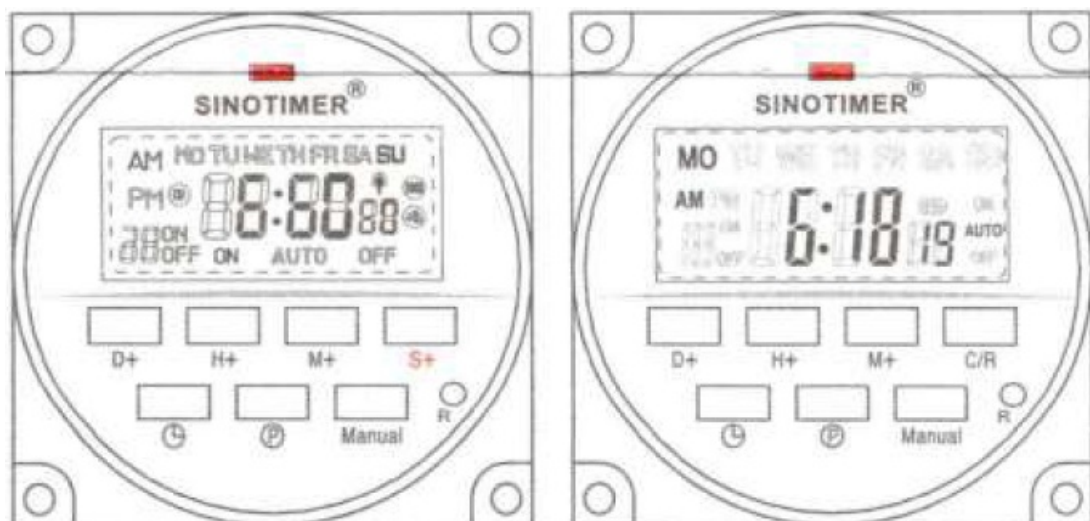

Model specification

- Volt-Free Contact, 250Vac/16Amp Rating, 1NO+1NC
- **N**: Volt-Free Output, 250Vac/16Amp Rating, 1NO
- **H**: Volt Output, 250Vac/16Amp Rating, 1NO

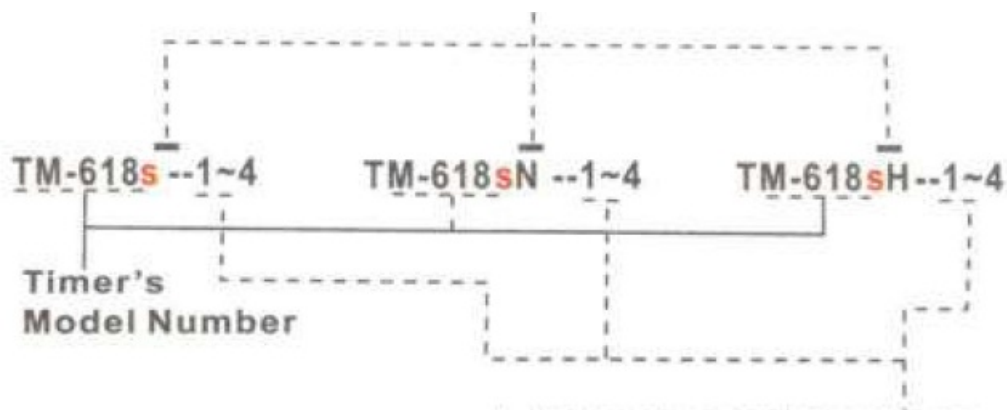

T Power supply for Timer

1. 120Vac main supply
2. 240Vac main supply
3. 24Vac/Vdc
4. 12Vac/Vdc

T: Universal Input from 85VAC to 265VAC

Three functions combine into a timer

1. Clock display (12hr/24hr format)
2. Timer
3. Countdown

Buttons

- **Manual**: Manual
- **P**: Timer
- : Clock
- **D+**: Week
- **H***: Hour
- **Mt**: Minute
- **S**: Second

Technical Data

- **Power Supply**: 200-250Vac, 50/60Hz (Customised Voltage: 6VDC,12VDC,24VDC,110VAC)
- **Capacity**: Resistive 16AMP, Inductive 8AMP
- Power consumption: <5VA
- **Timing Range**: 1second-168hrs
- **Black-out**: 90 days
- **Programs**: 8ON/OFF per day
- **Average error**: < #2 sec/day
- **Temperature range**: 10-50 C

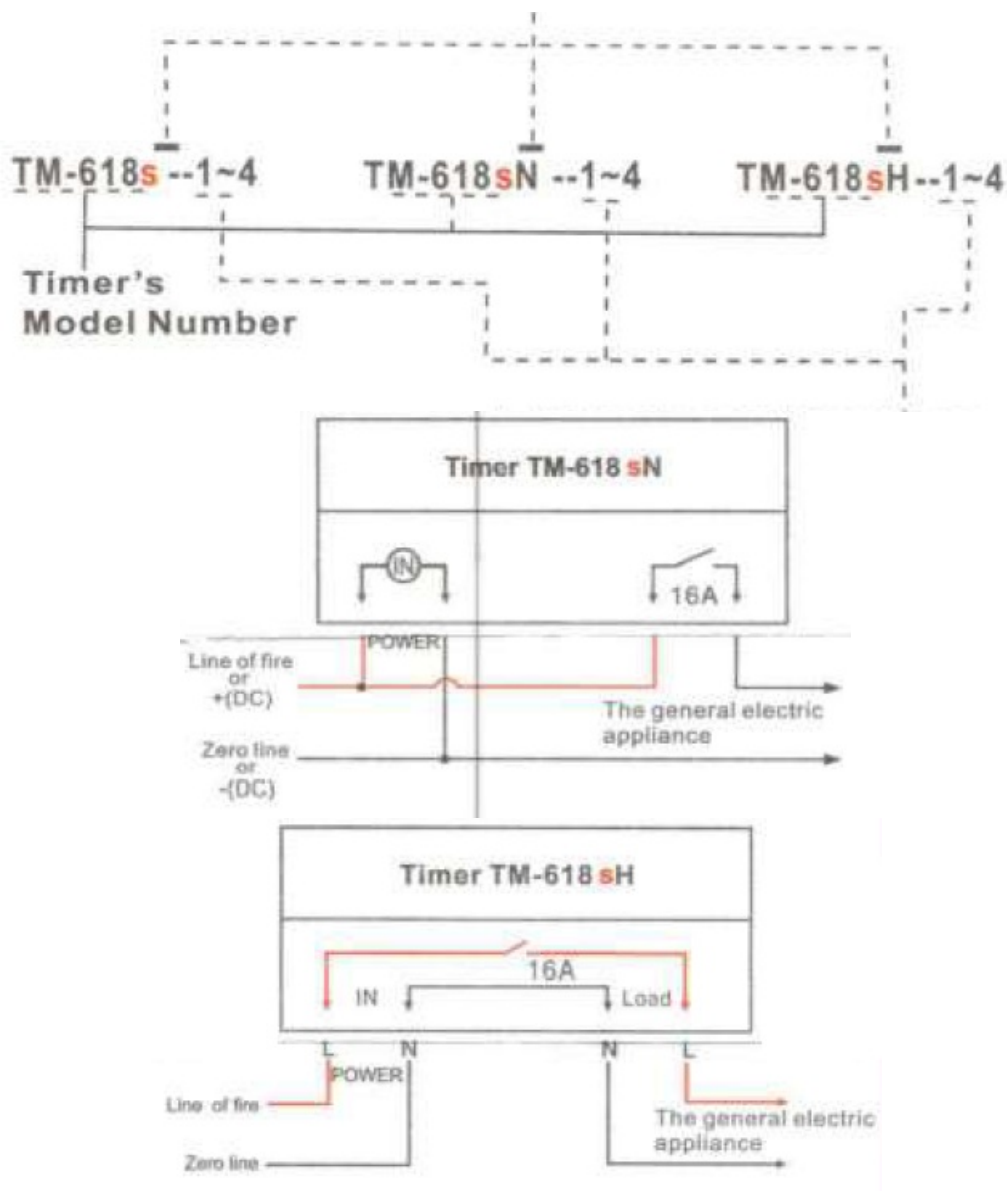

- **Humidity:** <95%
- **Installation:** panel/wall mounted
- **Dimensions:** 60×60×30mm
- **Net. Weight:** 0.12kg

Wiring for 3 models



Setting method

Adjustment of the present time

Steps	Operation	States
1	Press  and H+ together	Configuração da hora atual
2	Press  and M+ together	Configuração do minuto atual
3	Press  and D+ together	Configuração da semana atual

Hold St and Mt over 3 seconds, it can shift from 24hr to 12hr format.

Timer setting

Steps	Operation	States
1	Press P	Enter the 1st timer format (LCD Shows 1ON)
2	Press H+ M+ and S+ separately	Set 1st ON time
3	Press D+	Set the days of 1st ON time, it can be set on same setting every day, different settings in a week, MO.WE.FR, TU.TH.SA, SA.SU, MO. TU.WE, TH.FR.SA, MO. TU.WE.TH.FR, MO.TU, WE.TH.FR.SA etc 15 kinds of combinatons
4	Press P	LCD shows 1OFF
5	Press H+ M+ and S+ separately	Set 1st OFF time
6	Press D+	Set the day of 1st OFF day in a week
7	Repeat step 2~6	If nececarry, it can set 2nd to 8th ON/OFF

Cancel or recall the programs you set by pressing. MANUAL buttons in programming status.

Dimensions

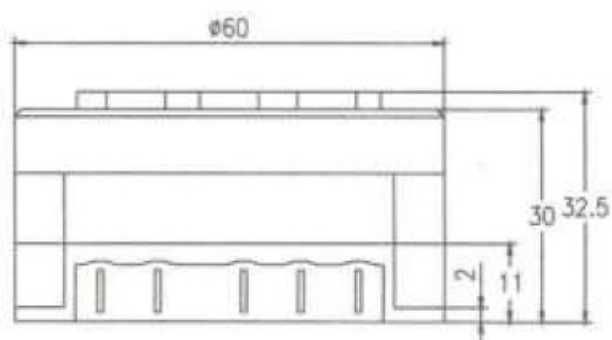

Installation combination diagram

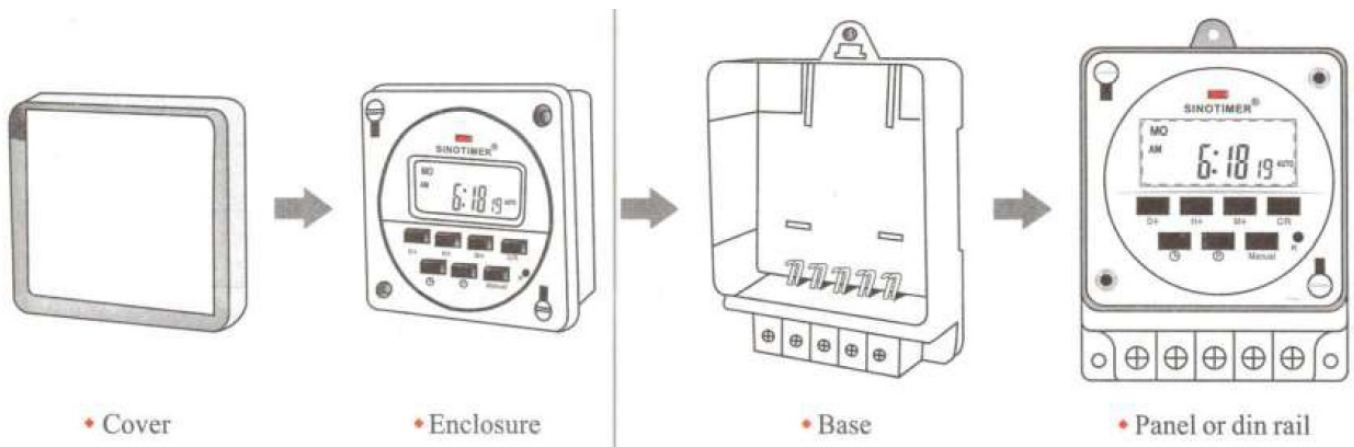

Documents / Resources

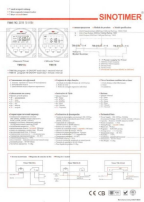
	<p>Altimus 230V AC Timer with Changeover Switch [pdf] Owner's Manual 230V AC Timer with Changeover Switch, 230V, AC Timer with Changeover Switch, Timer with Changeover Switch, with Changeover Switch, Changeover SwitchSwitch</p>
--	--

Manuals+.