



Altimus 12V DC Timer with Changeover Switch Owner's Manual

[Home](#) » [Altimus](#) » Altimus 12V DC Timer with Changeover Switch Owner's Manual 

Contents

- [1 Altimus 12V DC Timer with Changeover Switch](#)
- [2 Model specification](#)
- [3 Technical Data](#)
- [4 Wiring for 3 models](#)
- [5 Dimensions](#)
- [6 Installation combination diagram](#)
- [7 Documents / Resources](#)
- [8 Related Posts](#)



Altimus 12V DC Timer with Changeover Switch



Model specification

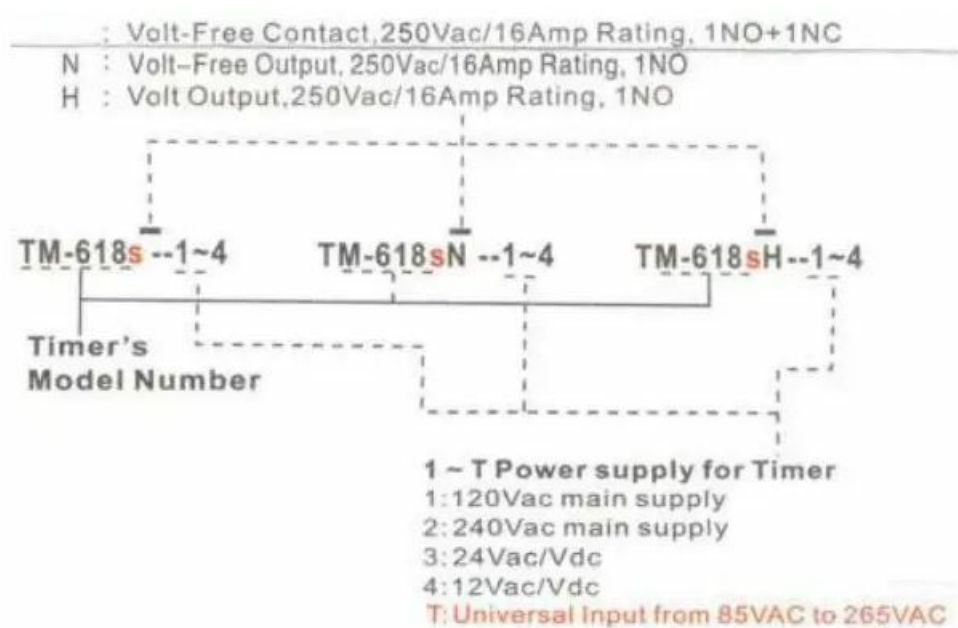

Three functions combine into a timer

- Buttons
- **Manual:** Manual
- : Timer
- : Clock
- D+: Week
- H+: Hour
- M+: Minute
- St: Second

Technical Data

- **Power Supply:** 200-250Vac, 50/60Hz
- **(Customised Voltage:** 6VDC,12VDC,24VDC,110VAC)
- **Capacity:** Resistive 16AMP, Inductive 8AMP
- **Power consumption:** <5VA
- **Timing Range:** 1second-168hrs
- **Black-out:** 90 days
- **Programs:** 8ON/OFF per day
- **Average error:** < ±2 sec/day
- **Temperature range:** 10-50 C
- **Humidity:** <95%
- **Installation:** pannel/wall mounted
- **Dimensions:** 60×60×30mm
- **Net. Weight:** 0.12kg

Wiring for 3 models

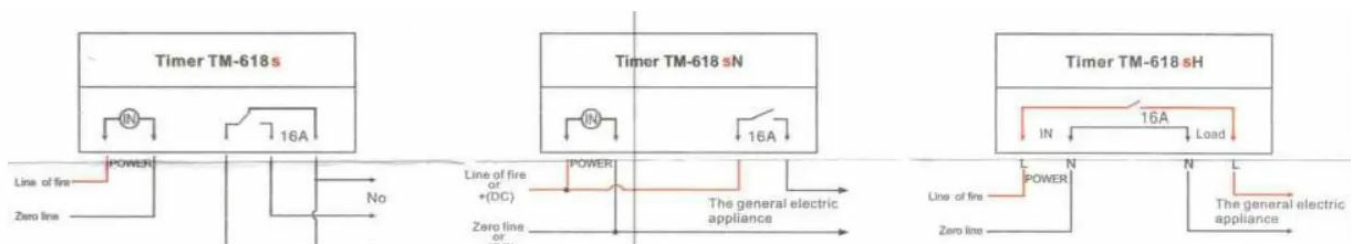

Setting method

- Adjustment of the present time

| Steps | Operation | States |
|-------|------------------------|------------------------------|
| 1 | Press and H+ together | Configuração da hora atual |
| 2 | Press and M+ together | Configuração do minuto atual |
| 3 | Press and D+ together | Configuração da semana atual |

Hold St and Mt for over 3 seconds, it can shift from 24hr to 12hr forms.

Timer setting

| Steps | Operation | States |
|-------|-------------------------------|--|
| 1 | Press P | Enter the 1st timer format (LCD Shows 1ON) |
| 2 | Press H+ M+ and S+ separately | Set 1st ON time |
| 3 | Press D+ | Set the days of 1st ON time, it can be set on same setting every day, different settings in a week, MO.WE.FR., TU.TH.SA., SA.SU., MO. TU.WE., TH.FR.SA., MO. TU.WE.TH.FR., MO.TU. WE.TH.FR.SA etc 15 kinds of combinations |
| 4 | Press P | LCD shows 1OFF |
| 5 | Press H+ M+ and S+ separately | Set 1st OFF time |
| 6 | Press D+ | Set the day of 1st OFF day in a week |
| 7 | Repeat step 2~6 | If necessary, it can set 2nd to 8th ON/OFF |

Cancel or recall the programs you set by pressing MANUAL buttons in programming status.

Dimensions

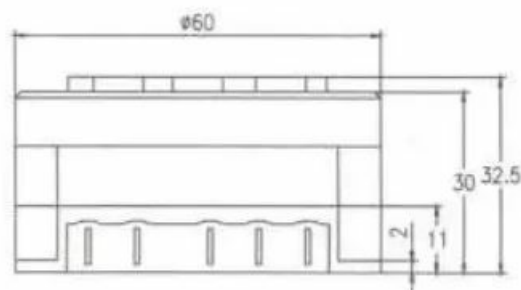

Installation combination diagram

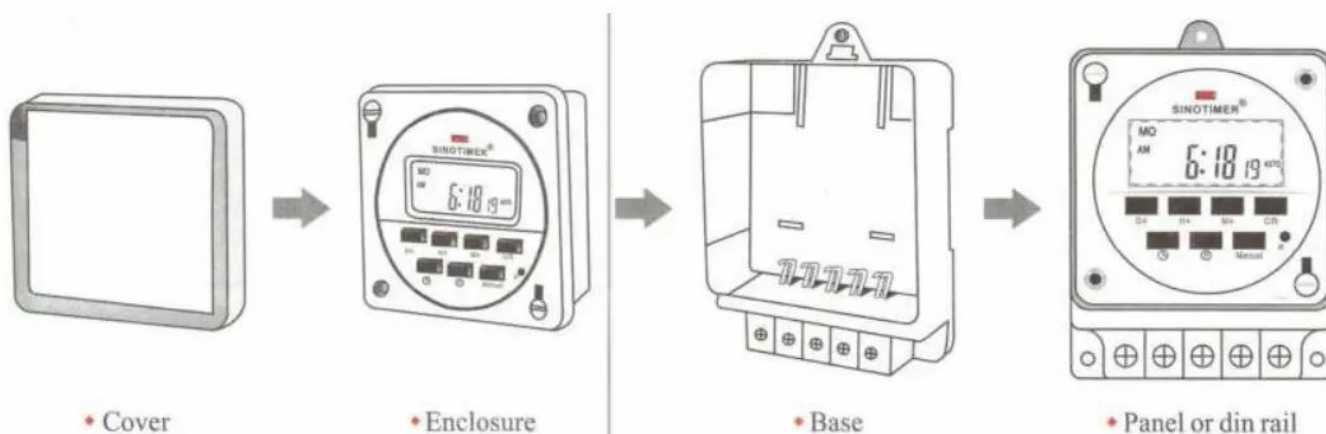

Manufactured by SINOTIMER

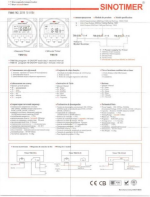

Documents / Resources

| | |
|---|--|
|  | <p>Altimus 12V DC Timer with Changeover Switch [pdf] Owner's Manual 12V DC Timer with Changeover Switch, 12V, DC Timer with Changeover Switch, Timer with Changeover Switch, with Changeover Switch, Changeover Switch, Switch</p> |
|---|--|