



Alpkit Brukit All-In-One Cooking System Instructions

[Home](#) » [Alpkit](#) » Alpkit Brukit All-In-One Cooking System Instructions 

Contents

- 1 Alpkit Brukit All-In-One Cooking System
 - 1.1 IF YOU SMELL LEAKING GAS
- 2 SPECIFICATION
- 3 CARE AND MAINTENANCE
 - 3.1 CARBON MONOXIDE HAZARD
- 4 GET TO KNOW YOUR STOVE
 - 4.1 OPTIONAL PAN SUPPORT
- 5 PRE-FLIGHT CHECKS
- 6 ATTACH POT AND COOK
- 7 CONNECT CANISTER AND IGNITE
- 8 TURNING OFF THE STOVE
- 9 Documents / Resources
 - 9.1 References
- 10 Related Posts

ALPKIT

Alpkit Brukit All-In-One Cooking System



WARNING

IF YOU SMELL LEAKING GAS

- Confirm that the Control Valve is closed and that the fuel canister is screwed on tightly.
- If still leaking DO NOT LIGHT. Remove stove to a well ventilated, flame free location and disconnect from the canister. Do not use a flame to detect leaks, or detach canister when hot as the gas vapour may ignite. Listen, smell or apply soapy water to detect leaking gas
- If the stove is already lit extinguish flames with a fire blanket or dry powder extinguisher

SPECIFICATION

- **Gas category:** Butane under vapour pressure
- **Jet size:** 0.22 mm,
- **Power:** 1200 W,
- **Consumption** 86g/h
- **Compatibility:** 100g/230g/450g Butane-Propane gas canisters conforming to EN417 standard. It may be hazardous to attempt to fit other types of gas container. CE / UKCA certified

Introducing your new Brukit cooking system, ideal for making yourself a brew or heating up a hearty soup when you're out on the hill. Please read this manual to ensure the safe and long term use of this stove.

IMPORTANT:

Do not use this stove until you have read, understood and complied with all instructions and warnings in this manual, failure to do so can result in fire, burns, severe injury or death. I have read and understood these instructions:

- Signed
- Date

CARE AND MAINTENANCE

Never modify this appliance or attempt any repair or maintenance other than those described in these instructions. Contact Alpkit if you need further help.

- After use, inspect and clean the stove; moisture, dust or debris may cause clogging and rust. Remove handles and Neoprene Cosy, wash pot by hand in soapy water. Never use a dishwasher or abrasive compounds, they will damage the pot.
- Store canisters in well-ventilated space, below 40°C and away from heat or ignition sources and out of reach of children. Never store stove with the gas canister attached.
- If you find this stove to be defective do not use it, contact Alpkit immediately.

WARNING

CARBON MONOXIDE HAZARD

FOR OUTDOOR USE ONLY

- This appliance can produce carbon monoxide which has no odour.
- Never use this appliance in an enclosed space such as a camper van, tent, vestibule, vehicle, or home.
- Using it in an enclosed space can kill you.

Failure to comply with these instructions can result in fire, burns, severe injury or death.

DO NOT USE THIS STOVE IF:

- You detect escaping gas when the Control Valve is closed.
- It is worn, damaged, leaking, missing seals or parts, or does not operate properly.
- You don't have adequate ventilation or are indoors.

GET TO KNOW YOUR STOVE

POT

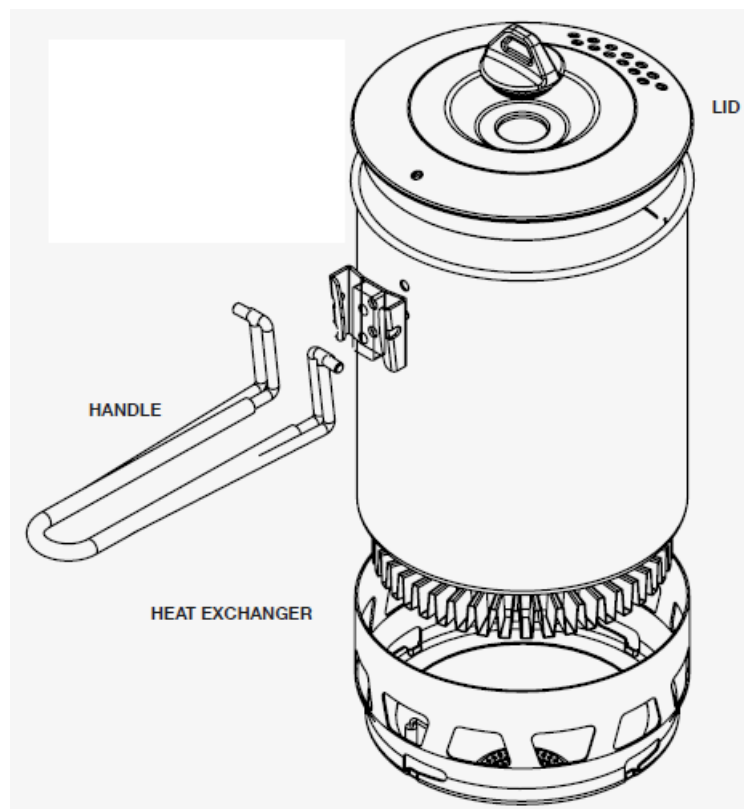

BURNER

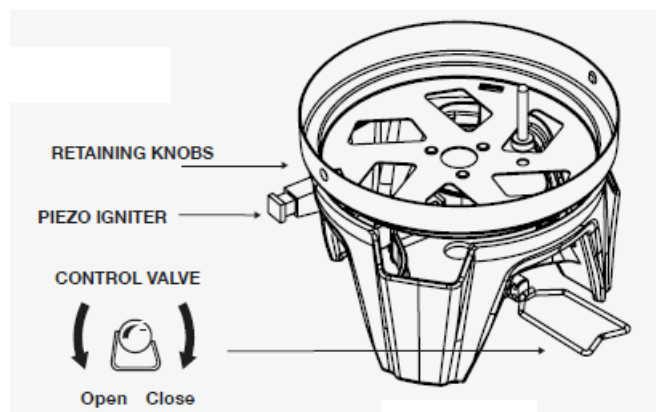

GAS CANISTER

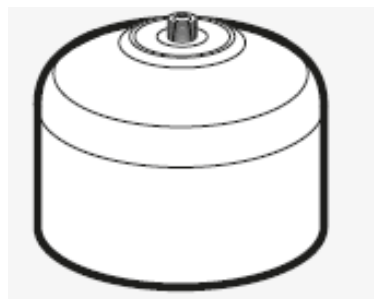

OPTIONAL PAN SUPPORT

WARNING:

WHEN USING A PAN THAT WAS NOT SUPPLIED WITH THE BRUKIT YOU MUST USE THE PAN SUPPORT. NEVER PLACE A POT DIRECTLY ON THE BURNER AS THIS WILL CAUSE THE STOVE TO OVERHEAT.

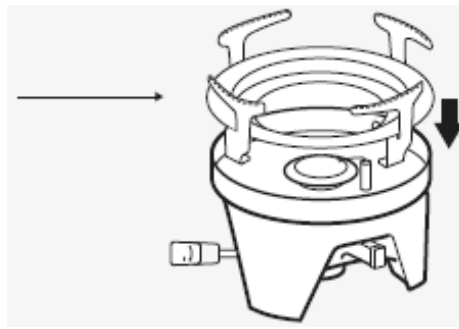

PRE-FLIGHT CHECKS

- Check the O-ring is seated in the valve and is in good condition: if damaged, worn or missing it should not be used.

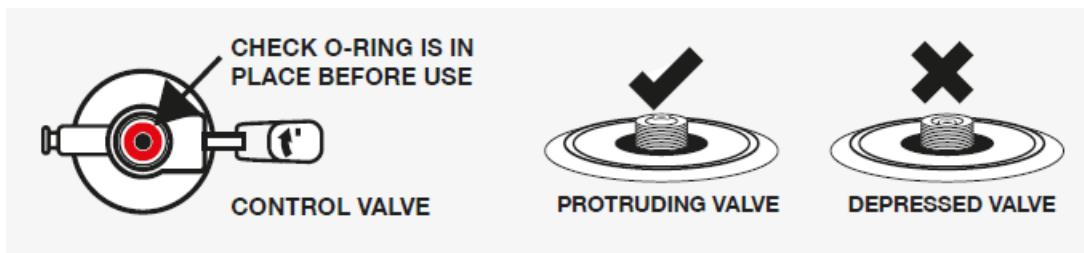

- Check the gas canister valve is not damaged or depressed. Caused by over-tightening, the valve will appear hollow and result in a weak flame.
- Check the neoprene cosy is secure and not obstructing the heat exchanger vents.
- Clear area of combustible materials and flammable liquids or vapours at least 1 metre from your stove. Place on a horizontal, stable and even surface. Unfold the three legs of the canister stand and attach to the canister for increased stability.

ATTACH POT AND COOK

1. Place the cooking pot on the burner and twist to lock in place.
2. Add liquid to the cooking pot immediately, do not heat pan empty. If melting snow, always add water to the pan first to prevent overheating.

WARNING

- Never place any pots other than the pot provided directly on the burner. Failure to do so will cause the canister to overheat and explode.
- Always use the pot support supplied when using B Vother pots.
- Do not exceed the MAX line on the internal volume measurements, this can cause contents to boil over.
- Do not fry or cook foods with low moisture content.
- Never move, lift, tip or tilt when lit, flaring may occur.
- Do not use in windy conditions without a wind shield.
- Keep away from children at all times, parts get hot.
- Never leave the stove unattended when lit.

CONNECT CANISTER AND IGNITE

1. Ensure that the control valve on the burner is closed by twisting it clockwise.
2. Hold burner firmly and screw canister on. You will hear a small amount of gas escaping, continue tightening until no more gas escapes. (approx. 4 rotations). DO NOT OVER-TIGHTEN.
3. To light, press the igniter button whilst slowly opening the control valve anti-clockwise to a medium setting.
4. If the burner does not light, close the control valve and ventilate area thoroughly before trying again

WARNING

- Never overtighten the burner onto the canister, this will cause a weak flame and can permanently seal the canister valve.
- Only attach / detach canisters when the burner is cool and in a well-ventilated location, away from other people and any sources of ignition.
- Keep the burner at arm's length, away from your face: the flame can erupt and flare during ignition.

TURNING OFF THE STOVE

1. Turn the control valve clockwise to extinguish the flame.
2. Wait for the stove to cool, exposed parts will be hot.
3. When cool twist burner anti-clockwise to detach from the canister.

WARNING

- Always check the burner is extinguished before disconnecting the fuel canister.
- Always extinguish burner and remove pot before eating or pouring the pot contents.
- Hold the pot by its handle until it and its contents reach a comfortable temperature.
- When the burner is cool, pack away by placing the burner in the bottom of the cooking pot, put the canister upright on top of overturned burner base, replace the lid

If this product does not meet your expectations upon delivery or does not live up to the demands placed upon it, please return it within 3 years of purchase for repair, replacement or refund. If the problem is our fault then we will do this to your satisfaction, if it's your fault we will help the best we can!

- Email: support@alpkit.com
- Phone: 01773 417007
- Website: www.alpkit.com/support

Documents / Resources

	<p>Alpkit Brukit All-In-One Cooking System [pdf] Instructions Brukit, All-In-One Cooking System, Brukit All-In-One Cooking System</p>
---	---

References

-  [Ask us about Outdoor Equipment, Clothing and Bikes | Alpkit](#)

Manuals+.