



# ALPINE X121-12EV 2 Way Component Speaker System Instruction Manual

[Home](#) » [Alpine](#) » ALPINE X121-12EV 2 Way Component Speaker System Instruction Manual 

## Contents

- [1 ALPINE X121-12EV 2 Way Component Speaker System](#)
- [2 Product Information](#)
- [3 Product Usage Instructions](#)
- [4 FAQ](#)
- [5 Operation Instructions](#)
- [6 Components](#)
- [7 Specifications](#)
- [8 Product Dimensions](#)
- [9 Documents / Resources](#)
  - [9.1 References](#)



**ALPINE X121-12EV 2 Way Component Speaker System**



## Product Information

### Specifications

- Woofer: 6.5" (165mm) Woven carbon fibre cone
- Tweeter: 1" (25mm) Teteron soft-dome
- Single body diameter: Woofer – 165mm, Tweeter – 41mm
- Alto screw hole spacing: 1 – 132mm, 2 – 169mm
- Installation diameter: Woofer – 196mm, Tweeter – 46mm
- Installation depth/plug-in installation: Woofer – 30mm, Tweeter – 2.3mm
- Installation height: Woofer – 42mm, Tweeter – 15.7mm
- Unit weight: Woofer – 959g, Tweeter – 52g
- Maximum rated power (RMS): 50W
- Maximum peak power (Peak): 200W
- Impedance: 4Ohm
- Sensitivity: 89dB SPL (1W @ 1m)
- Frequency response: 65Hz – 20kHz
- Resonance frequency: 65Hz

### Product Usage Instructions

#### Precautions

#### Prohibited Actions:

- Do not perform any actions indicated as prohibited.
- Do not disassemble the product.

#### Mandatory Actions:

- Perform any actions indicated as mandatory.

**Warning:**

- If you encounter any problems with the product, stop using it immediately.
- Continued use may result in personal injury or product damage.
- Contact the authorized Alpine dealer or nearby Alpine service center for repair.

**Caution:**

- Only use the product with 12V negative-grounded vehicles.
- Using the product with other types of vehicles may cause fire or electrical hazards.
- Contact a professional for wiring and installation.
- Do not disassemble or refit the product.
- Keep small items like bolts or screws out of the reach of children. Ingestion may result in serious injury.

**Driving Safety:**

- Avoid using any functions that may distract you while driving.
- Use device functions only when the vehicle is completely stopped in a safe area.
- Maintain the volume at a level that allows outside noise to remain audible.
- Not hearing emergency vehicle alarms or road warning signals may result in an accident.
- Excessively loud volume may cause permanent hearing damage or loss.

**Product Maintenance**

To clean the product, regularly wipe it with a soft, dry cloth. For tough stains, dampen the cloth with water only. Do not use solvents as they may dissolve the product.

**Installation**

This product is specially designed for Tesla cars and is not suitable for other vehicles. Please contact the dealer from whom you bought the product to safely install it. Professional expertise is required for wiring and installation.

**Repair**

In case of any problems, do not attempt to repair the product yourself. Return it to the authorized Alpine dealer or Alpine service center for repair.

**FAQ**

**Q: Can I use this speaker system with other vehicles?**

A: No, this speaker system is specially designed for Tesla cars and is not suitable for other vehicles.

**Q: What should I do if I encounter problems with the product?**

A: If you encounter any problems, please stop using the product immediately. Continued use may result in personal injury or product damage. Please return the product to the authorized Alpine dealer or nearby Alpine service center for repair.

**Q: Can I disassemble or refit the product?**

A: No, disassembling or refitting the product may result in product damage, fire, or electrical hazards. Please do not attempt to disassemble or refit it.

For iPhone users, please search “Alpine Music” in APP Store to download and install the tuning software; for Android users, please scan the QR code on the right to download and install the software directly.



Alpine Music

## Operation Instructions

### Types of Precautions

- Prohibited  
Indicates a prohibited action (must not be performed).
- Prohibited  
Indicates that disassembly is prohibited.
- Mandatory  
Indicates a mandatory operation (must be performed).
- Indicates that it should draw your close attention.

### Warning

- **In case of problems, please stop using the device immediately.**  
Continued use may result in personal injury or damage to the product. Please return the product to the authorised Alpine dealer or nearby Alpine service center for repair.
- **The product is only suitable for 12V negative-grounded vehicles.**  
Use within other types of vehicles may create a fire or electrical hazard.
- **Please contact a professional for wiring and installation.**  
This product requires professional expertise to wire and install. Please contact the dealer from whom you bought the product to install it safely.
- **Please do not disassemble or refit.**  
Doing so may result in product damage, fire or electrical hazard.
- **Small items like bolts or screws must be kept out of the reach of children.**  
If ingested, please seek Immediate medical attention to avoid serious injury.
- **Please do NOT use functions that may distract you while driving.**  
Any device function that may influence your attention must be used only when the vehicle is stopped

completely. To use these functions, make sure to stop your vehicle in a safe area first. Otherwise, it may result in an accident.

- **While driving, you must maintain the volume at a level that allows outside noise to remain audible.**

It is very dangerous not to hear an emergency vehicle alarm or road warning signal (such as a railway crossing) and may result in an accident. Moreover, excessively loud volume may create permanent hearing damage or hearing loss.

## Caution

- **Product maintenance**

Please regularly clean the item with a soft, dry cloth. For tough stains, use only water to dampen the cloth as other solvents may result in dissolution.

- **Temperature**

Before starting the device, please ensure that the temperature inside the vehicle is between +60°C and -20°C.

- **Repair**

In the case of a problem, please do not attempt to repair the product yourself. Please return the product to the authorised Alpine dealer or Alpine service center.

- **System matching**

This product is specially designed for Tesla cars and is not suitable for other vehicles.

- **Installation environment**

The device cannot be installed at the following locations:

- Under direct sunlight or near a source of heat.
- With high humidity or near a source of water.
- Dusty environments.
- Environments with violent vibration.

## Components

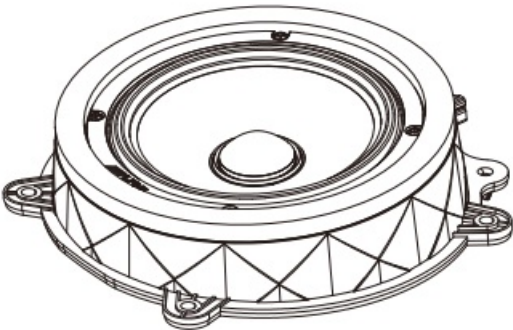
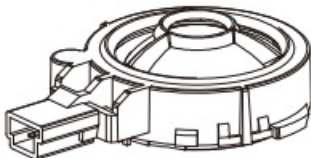
Woofers	Tweeters
 × 2	 × 2

## Specifications

Woofers	6.5" (165mm) Woven carbon fibre cone
Tweeter	1" (25mm) Teteron soft-dome
Single body diameter	Woofers: 165mm Tweeter: 41mm
Alto screw hole spacing	1: 132mm 2: 169mm
Installation diameter	Woofers: 196mm Tweeter: 46mm
Installation depth/plug-in installation	Woofers: 30mm Tweeter: 2.3mm
Installation height	Woofers: 42mm Tweeter: 15.7mm
Unit weight	Woofers: 959g Tweeter: 52g
Maximum rated power (RMS)	50W
Maximum peak power (Peak)	200W
Impedance	4Ohm
Sensitivity	89dB SPL (1W @ 1m)
Frequency response	65Hz – 20kHz
Resonance frequency	65Hz

## Product Dimensions

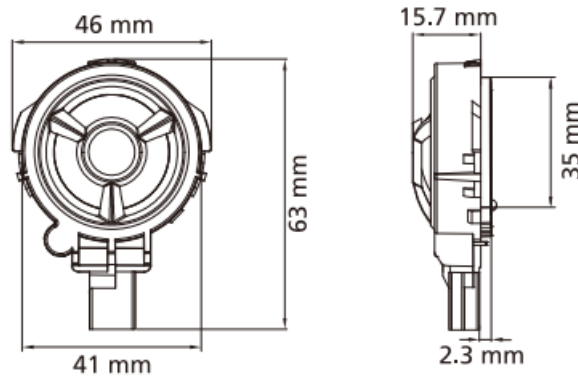
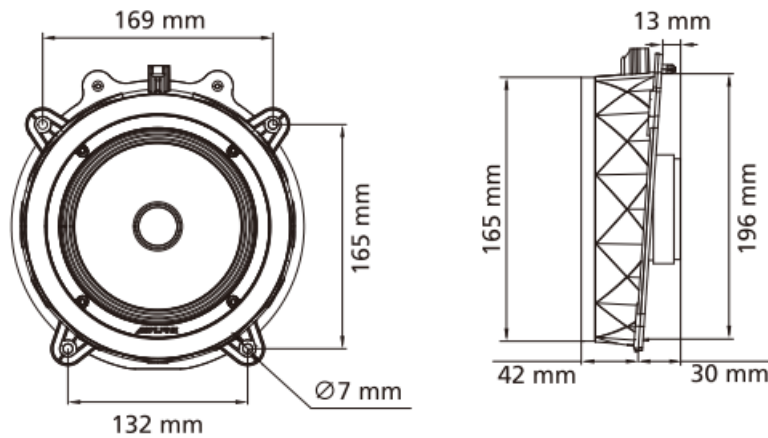

## Documents / Resources

ALPINE  
EV-65CF-T  
6.5" 2-Way Component  
Speaker System for Trucks



ALPINE EV-65CF-T 6.5" 2-Way Component Speaker System for Trucks

[ALPINE X121-12EV 2 Way Component Speaker System](#) [pdf] Instruction Manual  
X121-12EV 2 Way Component Speaker System, X121-12EV, 2 Way Component Speaker System, Component Speaker System, Speaker System

## References

- [User Manual](#)

