

ALPINE
ALPINE
S-Series
2-way
Component
Speakers
System



ALPINE S-Series 2-way Component Speakers System Installation Guide

[Home](#) » [Alpine](#) » ALPINE S-Series 2-way Component Speakers System Installation Guide 

Contents

- [1 ALPINE S-Series 2-way Component Speakers System](#)
- [2 Specifications](#)
- [3 Contents](#)
- [4 Woofer Installation](#)
- [5 Tweeter Installation](#)
- [6 Height Adjustment](#)
- [7 Wiring Connection](#)
- [8 External Dimensions](#)
- [9 FAQ's](#)
- [10 Documents / Resources](#)
 - [10.1 References](#)

ALPINE

ALPINE S-Series 2-way Component Speakers System



Specifications

Component	Specification
Woofer	69.8mm diameter, 58.8mm depth, 17.5mm height
Tweeter	Swivel flush mount or stealth mount
Network	Standard wiring connections

Contents

Woofer

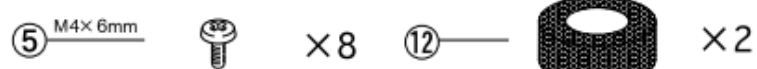
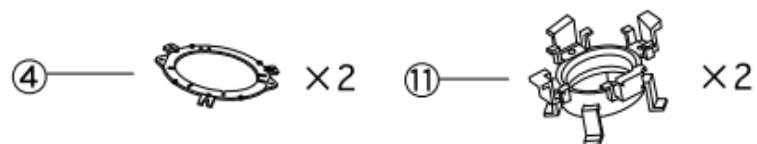
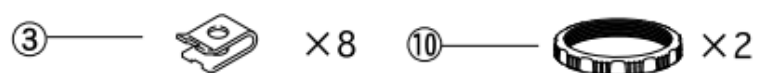
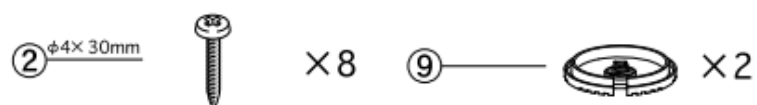

Tweeter

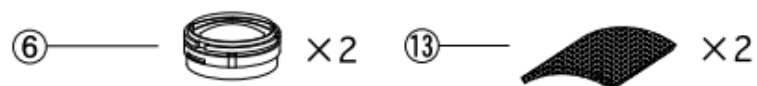

Network

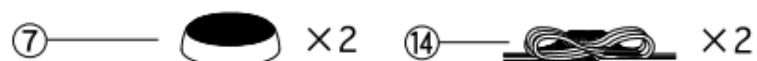

Component	Quantity
Woofer	2
4x30mm Screws	8
Mounting Clips	8
Mounting Rings	2
4x6mm Screws	8
Tweeter	2
Network	2
Flush Mounts	2
Stealth Mounts	2
Mounting Brackets	2
Height Adjustment Rings	2
Wire Mesh	2
Wiring	2

Woofer Installation

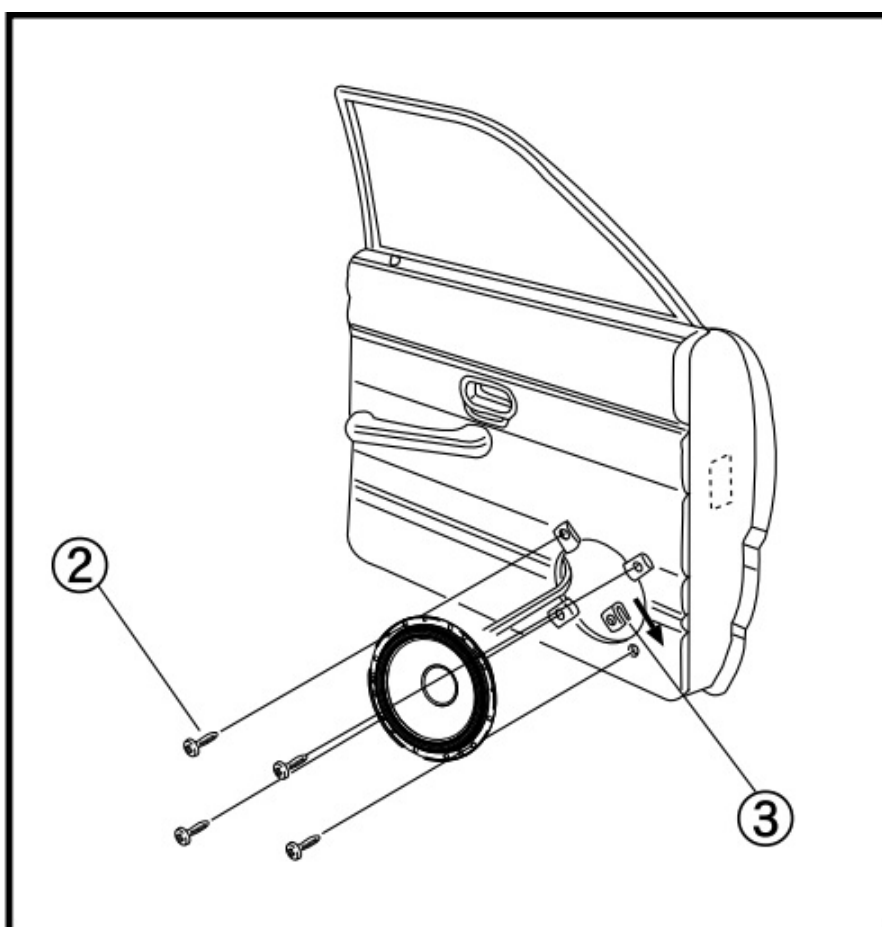

1. Use the provided screws (4x30mm) and mounting clips to secure the woofer in place.
2. **Factory/size-down/stealth**

Follow the diagram for factory/size-down/stealth installation.

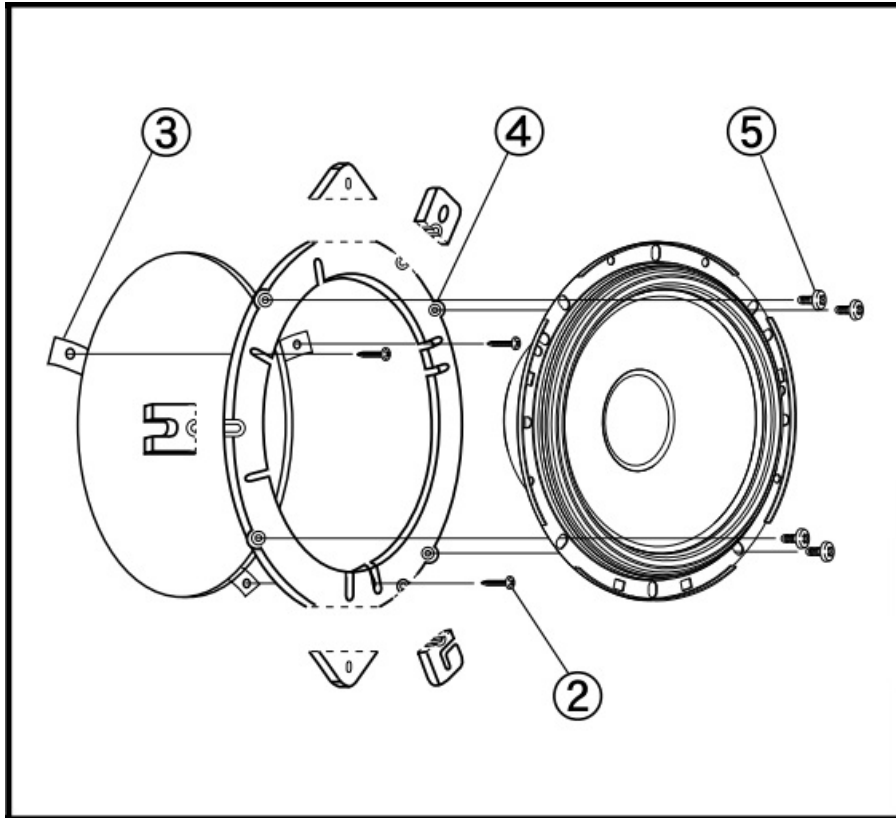

3. Factory/OEM custom fit/stealth

For factory/OEM custom fit/stealth installation, refer to the specific diagram.

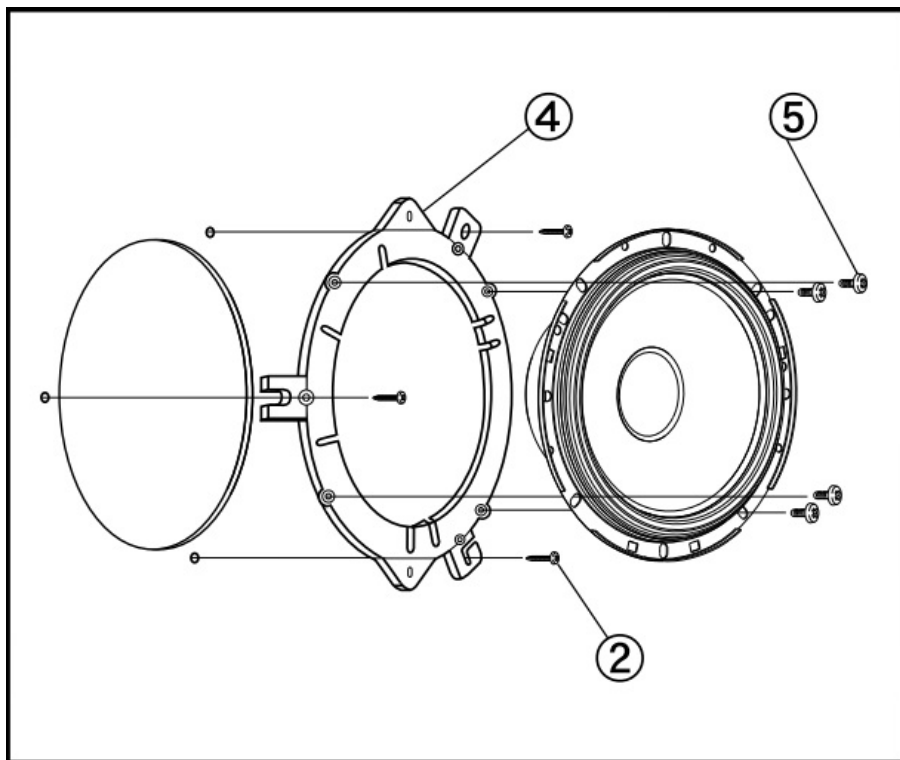

Tweeter Installation

Swivel Flush Mount

1. Insert the tweeter into the flush mount.
2. Secure the assembly as shown in the diagram.

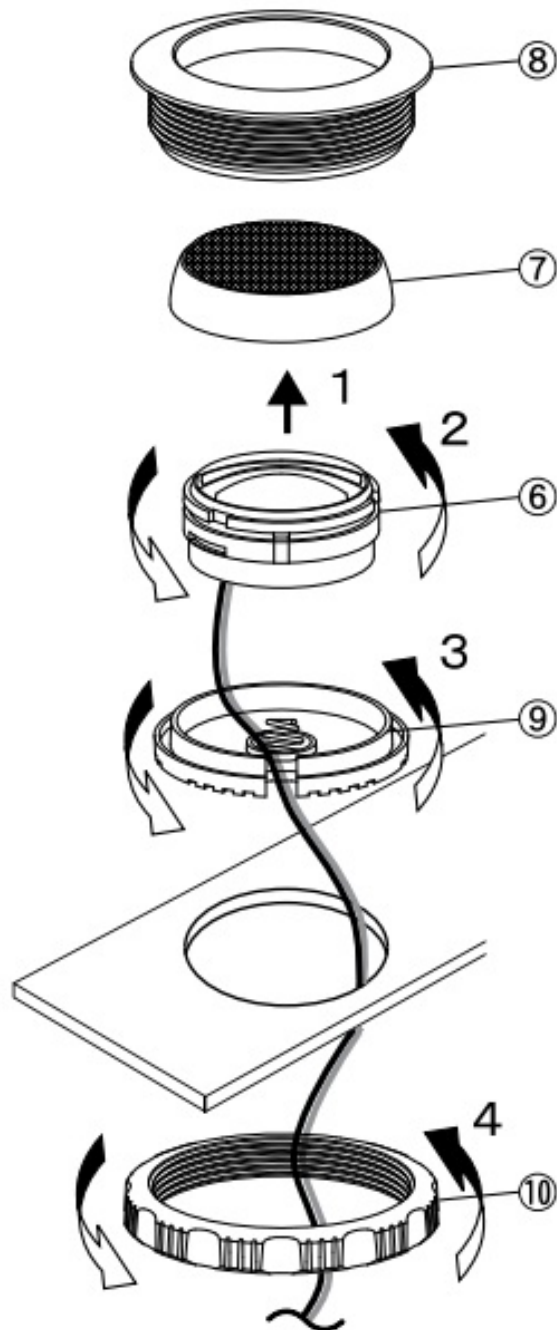

Stealth (May require gluing)

1. Insert the tweeter into the stealth mount.
2. Secure the assembly and glue if necessary.

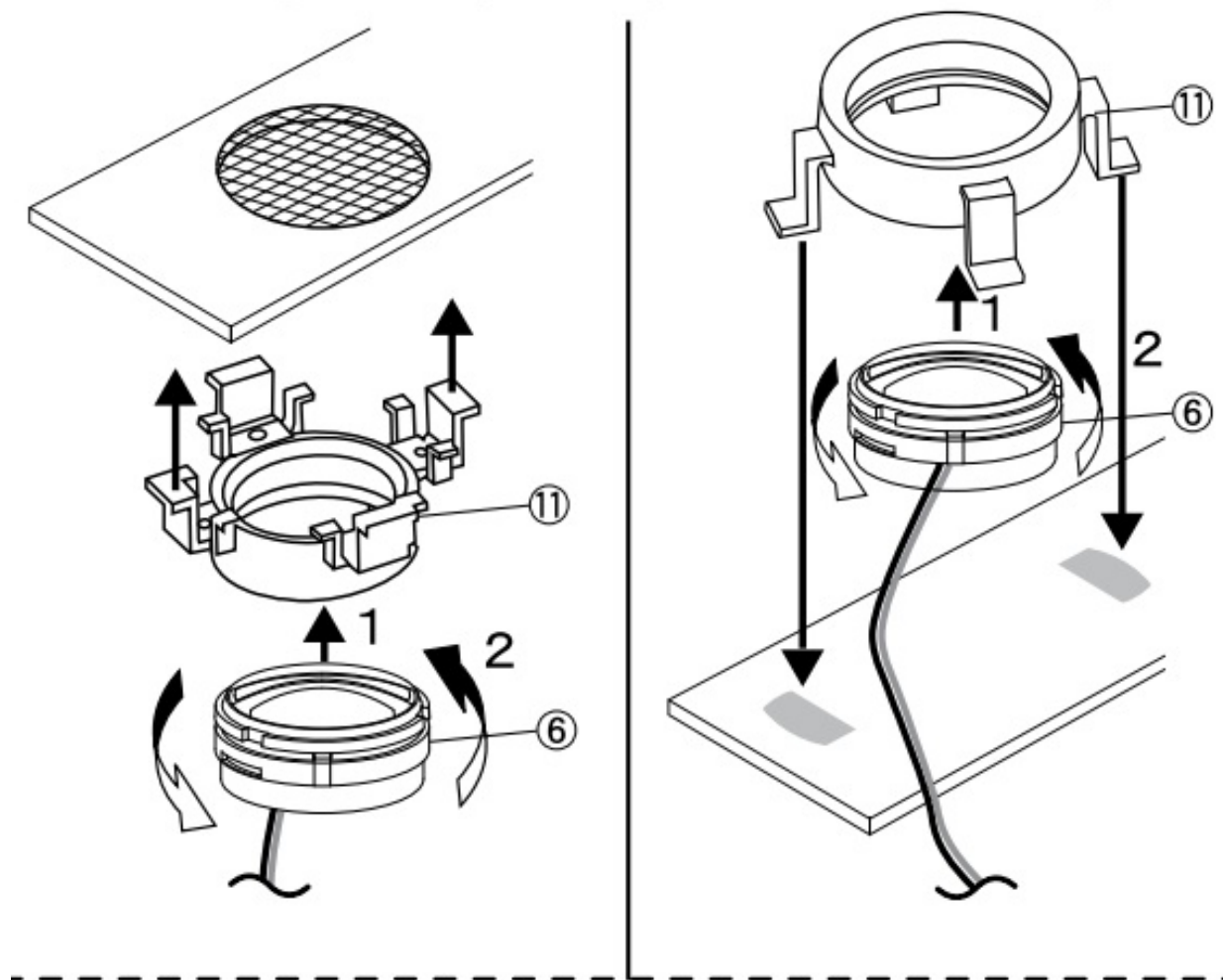

Height Adjustment

Use the height adjustment rings to achieve the desired height.

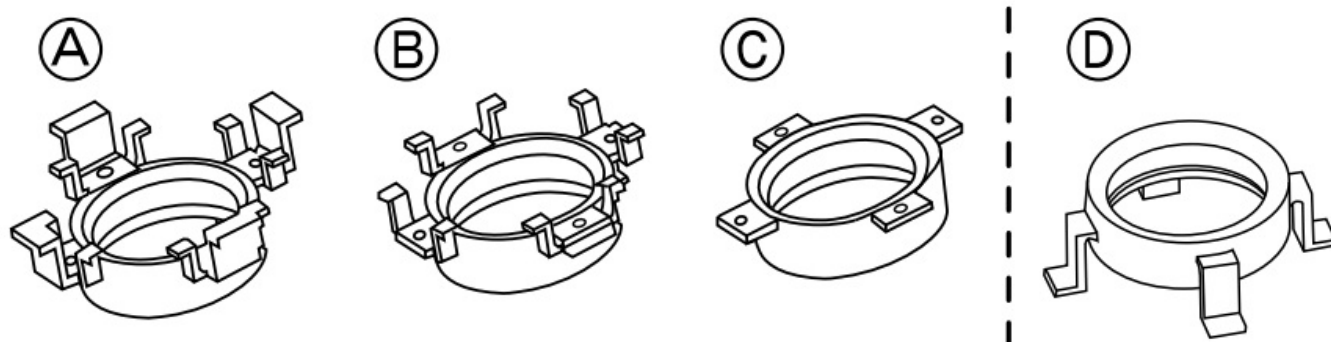

Wiring Connection

Follow the wiring diagram to connect the components:

- Connect the positive and negative terminals of the woofer to the corresponding terminals on the amplifier.
- Connect the tweeter to the network and then to the amplifier.

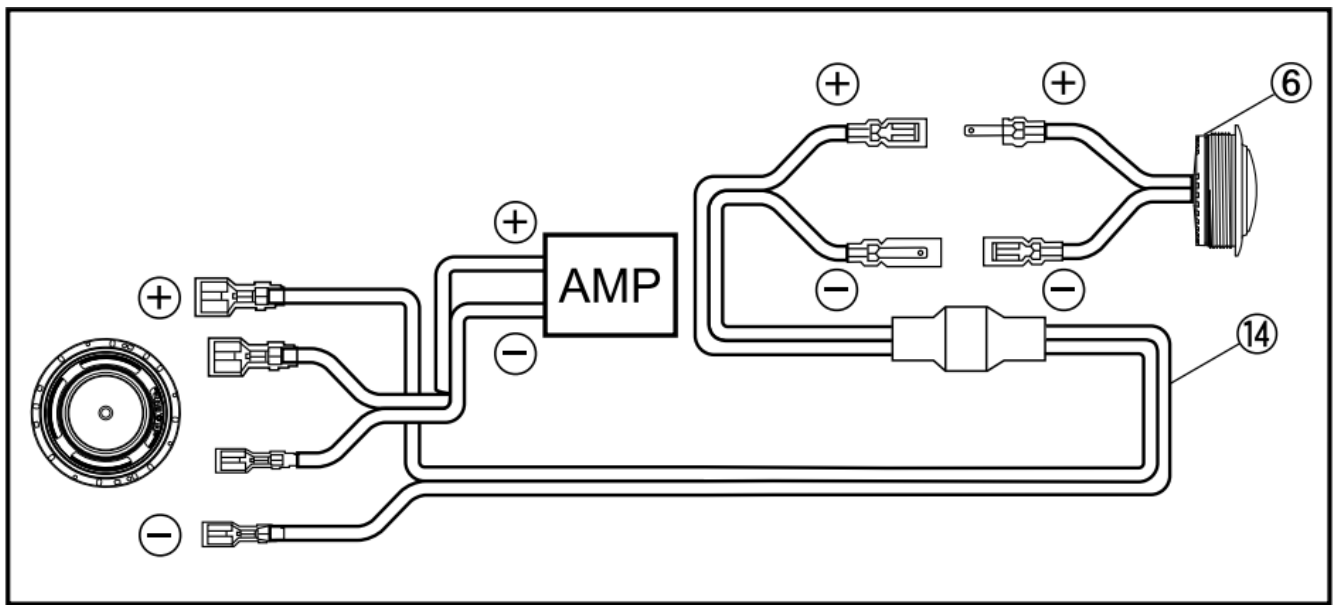

External Dimensions

The external dimensions of the components are as follows:

- **Woofer diameter:** 69.8mm (2-3/4")
- **Mounting depth:** 58.8mm (2-5/16")
- **Height:** 17.5mm (11/16")

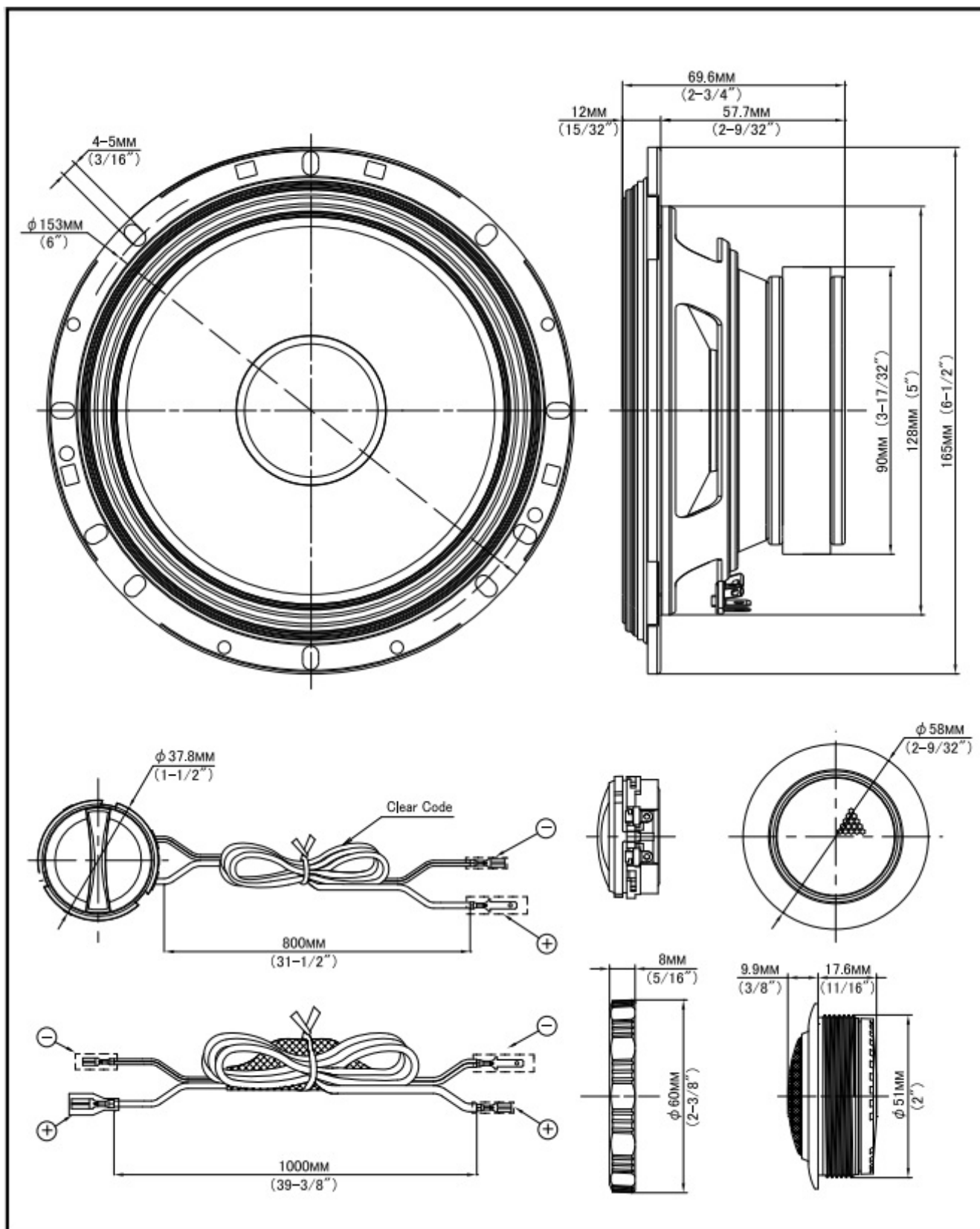

FAQ's

Q: What tools are required for installation?

A: A screwdriver and possibly glue for the stealth mount.

Q: Can I install the tweeter without the flush mount?

A: Yes, you can use the stealth mount instead.

Q: How do I adjust the height of the tweeter?

A: Use the height adjustment rings provided in the kit.

Q: Are the wiring connections complicated?

A: No, follow the wiring diagram for straightforward connections.

Documents / Resources

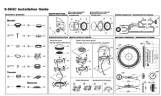

[ALPINE S-Series 2-way Component Speakers System](#) [pdf] Installation Guide
S-Series 2-way Component Speakers System, S-Series, 2-way Component Speakers System,
Component Speakers System, Speakers System, System

References

- [User Manual](#)

Manuals+. [Privacy Policy](#)

This website is an independent publication and is neither affiliated with nor endorsed by any of the trademark owners. The "Bluetooth®" word mark and logos are registered trademarks owned by Bluetooth SIG, Inc. The "Wi-Fi®" word mark and logos are registered trademarks owned by the Wi-Fi Alliance. Any use of these marks on this website does not imply any affiliation with or endorsement.