



ALPINE Map and Navi Firmware Update Procedure Instructions

[Home](#) » [Alpine](#) » **ALPINE Map and Navi Firmware Update Procedure Instructions** 



INE-F904DC / X903DC / X803DC / INE-W720DC Series map 2020/12 and Navi firmware update procedure

Contents

- [1 Map and Navi Firmware Update Procedure](#)
- [2 Connection](#)
- [3 Install Navi firmware and map update](#)
- [4 Documents / Resources](#)
- [5 Related Posts](#)

Map and Navi Firmware Update Procedure

Please check the Audio Firmware Version on your device first. If your Audio Firmware Version is NOT 1.4001.1.4001.1.4001 or higher, please update your Audio Firmware before. Check Audio "Firmware Version" in Setup: General About Firmware Version. The map 2020/12 and Navi firmware can be updated with only one USB device. First, please download the "2020-12_camperMAP.zip" and follow the instructions. The INE-F904DC / X903DC / X803DC / INE-W720DC can be updated via USB connection (see connection diagram below). Before starting the update, please check the following notes. The download file is compressed in zip format. The contents of the download need to be extracted to a freshly formatted USB device (FAT32). The update takes 40 to 50 minutes.

Update file contents/storage place (for all types of units)

Name	Größe	Typ	Änderungsdatum
NE000000		Dateiordner	04.08.2021 16:29
NE00035A		Dateiordner	04.08.2021 12:31
NE00036A		Dateiordner	04.08.2021 12:31
NE00040A		Dateiordner	04.08.2021 12:31
NE00041A		Dateiordner	04.08.2021 12:31

Notes

- Do NOT use the compressed file for updates, otherwise, the Unit cannot recognize the files.
- Do NOT change folder names and file names, otherwise, the Unit cannot recognize the files.
- Do NOT store the folder inside another folder.
- Do NOT store any other folders files on the USB device.
- Do NOT remove the USB device while
- Do NOT update while
- Do NOT press any buttons while updating.
- Do NOT turn off the vehicle's ignition or head unit's power switch while updating.

Modern vehicles will shut down the ignition (ACC) after some time if the engine is not running. If you are not sure if this applies to your car, leave the engine idling while the update is in progress.

Connection

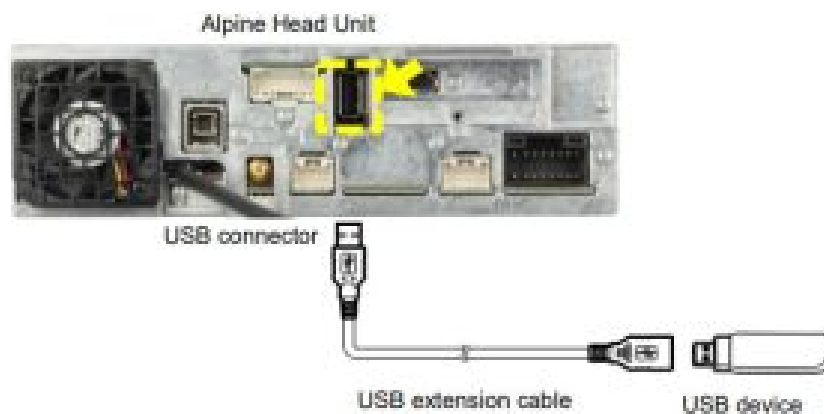

Install Navi firmware and map update

1. Store the downloaded and extracted files -2020-12_camperMap2Ip" on the empty USB device in the Root Folder (see left figure).
2. Connect the USB device to the USB connector of the Alpine Head Unit. Please see the lower left figure.



3. Press the “OK” button when an update message appears on the screen. The process will now install the new map data to your Alpine Head Unit.

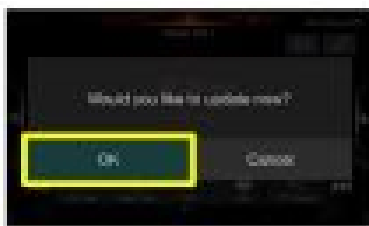

Update will be completed in around 40 minutes.

4. The new map data and navigation application is loaded successfully when your Alpine Head Unit restarts automatically.



5. Remove the USB device from Alpine Head Unit.

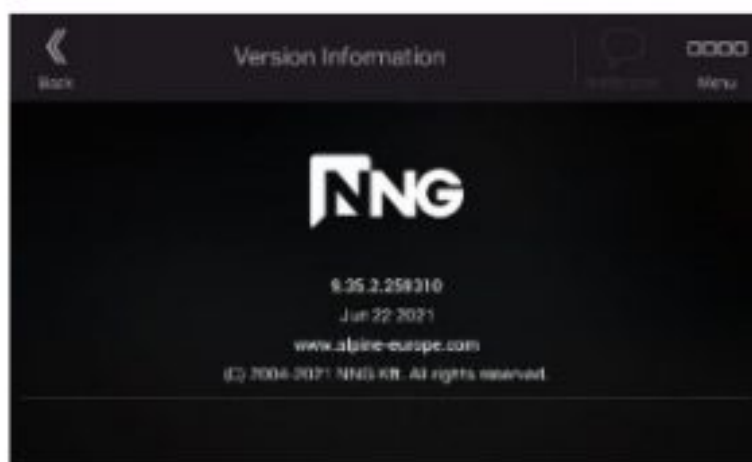

6. Check the “Nay! Firmware” version by pushing Navigation: 4 Information 4 About 4 Version Information. The new Navi Firmware version is 9.35.2.259310, Jun 22, 2021
7. Check “Map-Version” by pushing Navigation: 4 Information 4 About 4 Content 4 Maps. If ‘Map-Version’ has

changed to: "... 2020.12", this map update procedure has been successful.

ALPS ALPINE Europe GmbH, Alpine Brand

Documents / Resources

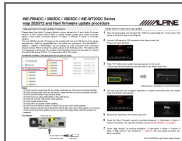

[ALPINE Map and Navi Firmware Update Procedure](#) [pdf] Instructions

ALPINE, INE-F904DC, X903DC, X803DC, INE-W720DC Series, Map, and, Navi, Firmware, Up
date, Procedure

[Manuals+.](#)