



ALPINE EL-E65C 6-1/2 Component Speaker System Owner's Manual

[Home](#) » [Alpine](#) » ALPINE EL-E65C 6-1/2 Component Speaker System Owner's Manual 

ALPINE EL-E65C 6-1/2 Component Speaker System Owner's Manual



Contents

- [1 CONTENTS](#)
- [2 WOOFER INSTALLATION](#)
- [3 TWEETER INSTALLATION](#)
- [4 WIRING CONNECTION](#)
- [5 EXTERNAL DIMENSIONS](#)
- [6 SPECIFICATIONS](#)
- [7 Documents / Resources](#)
 - [7.1 References](#)
- [8 Related Posts](#)

CONTENTS

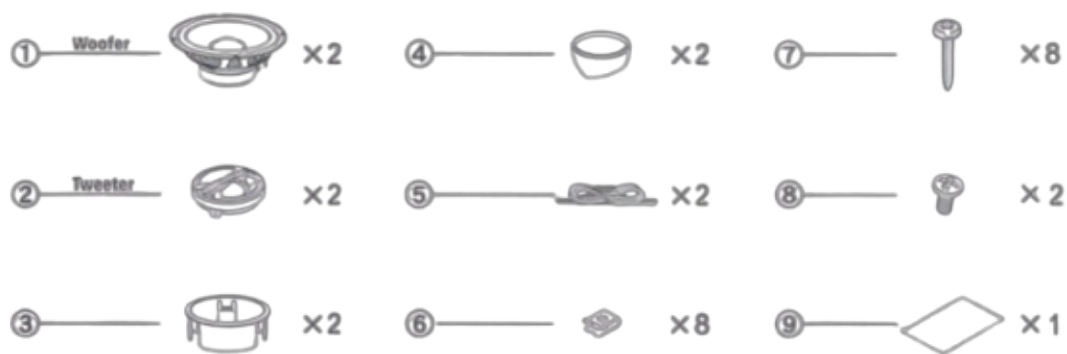

WOOFER INSTALLATION

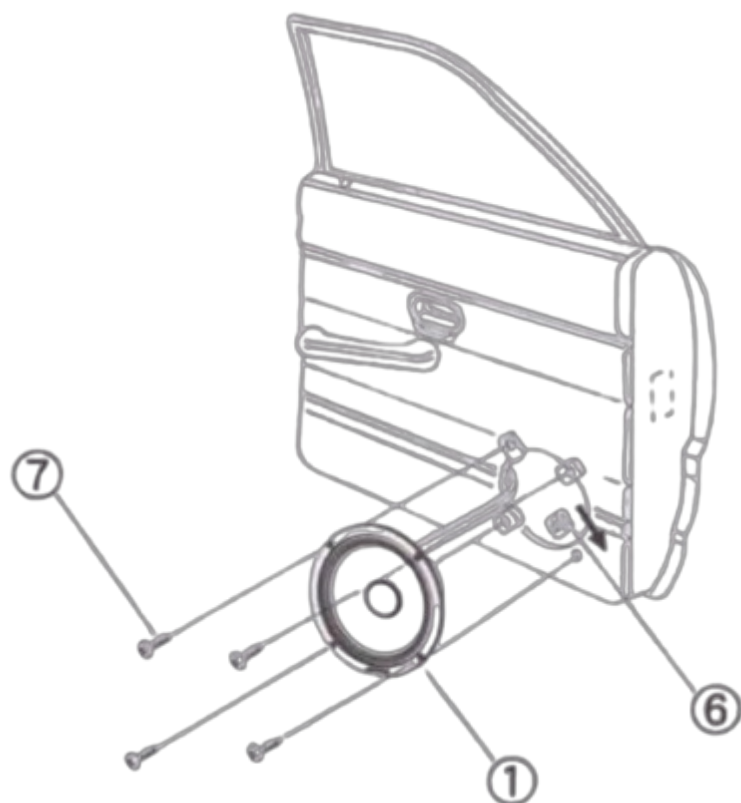

TWEETER INSTALLATION

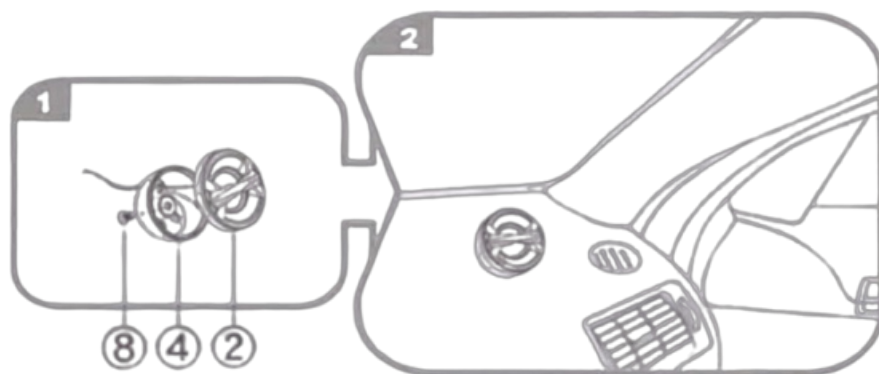

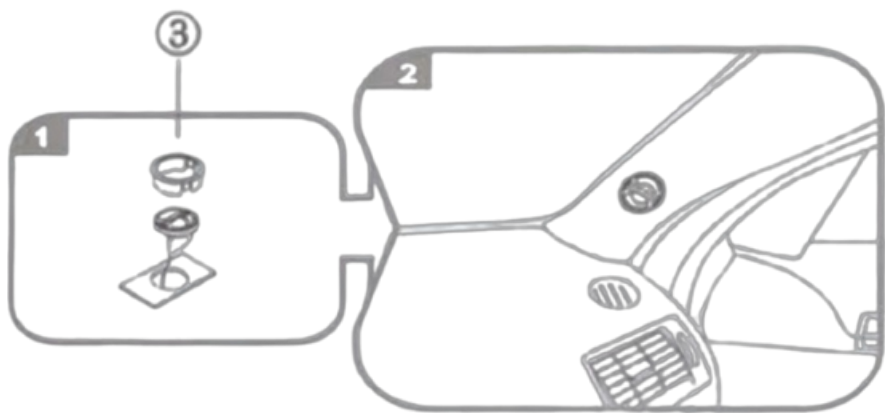

WIRING CONNECTION

Connection diagram of original car player

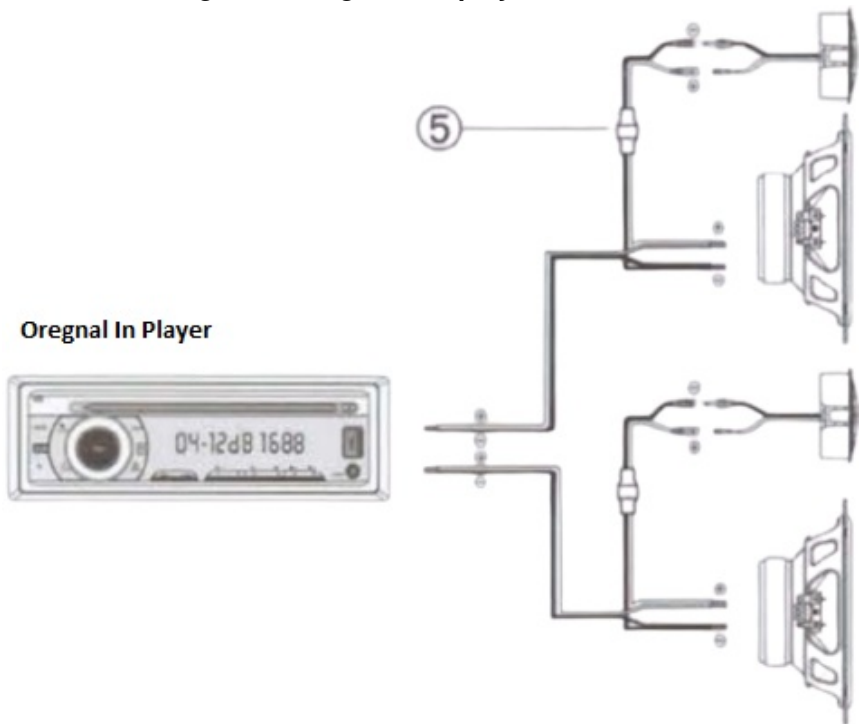

Schematic diagram of power amplifier connection
Original engine or Alpine Media player (Sold separately)

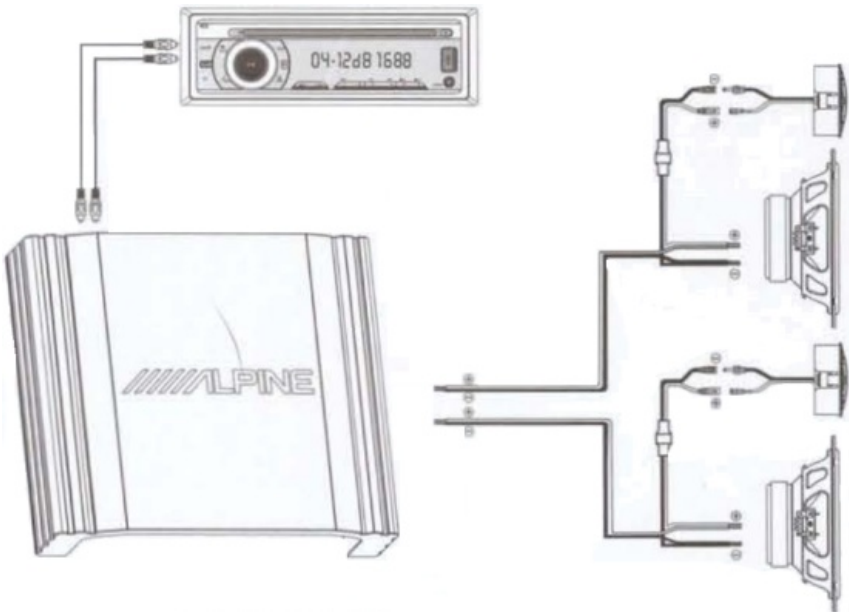

External power amplifier(Sold separately)

EXTERNAL DIMENSIONS

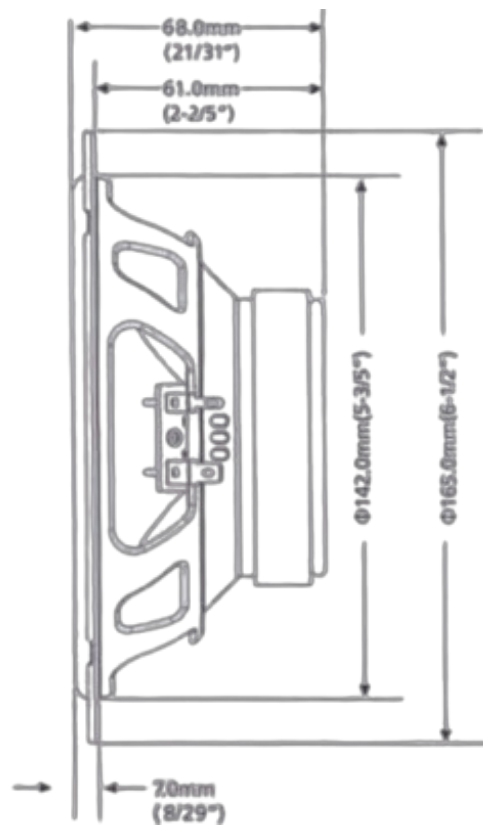
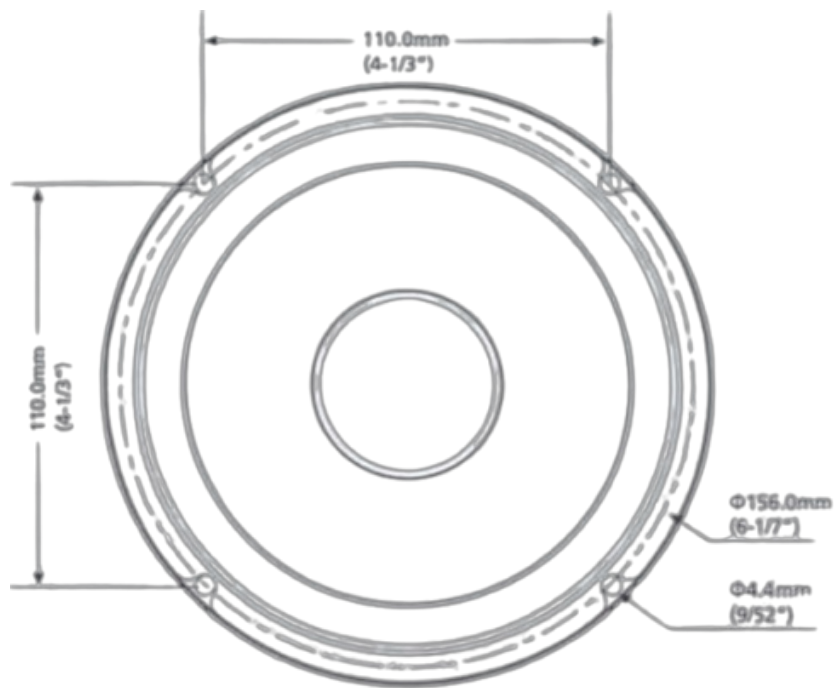

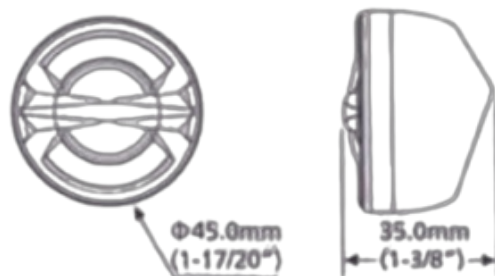
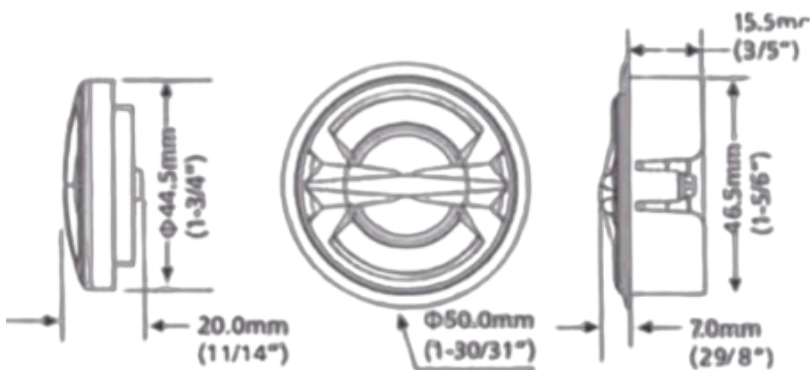
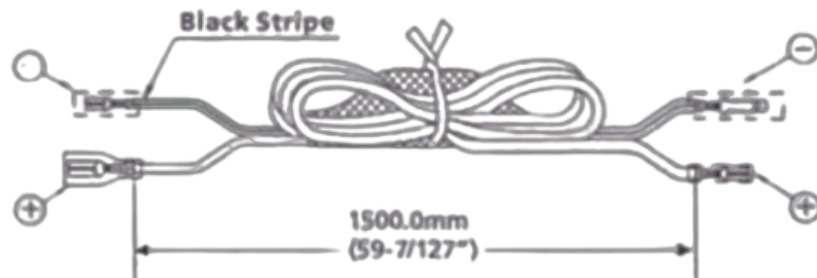
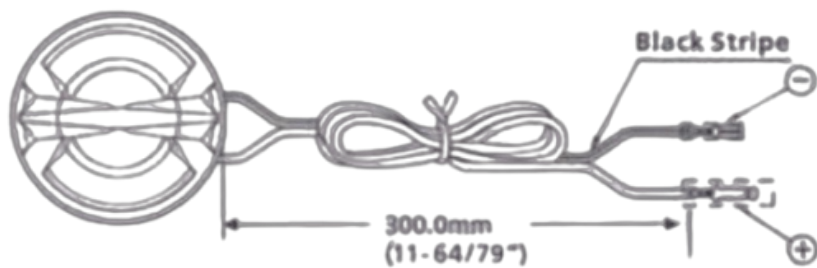

SPECIFICATIONS

- **Units Type:**

Woofer: 6.5" (16.5cm) PP Cone

Tweeter: 0.8" (2.0cm) Teteron Dome

- **Maximum RMS Power:** 45W

- **Maximum Peak Power:** 180W

- **Impedance:** 4ohms (DCR3.6ohms)

- **Sensitivity:** 90dB SPL (1W @ 1m)

- **Frequency Response:** 70Hz-20KHz

- **Mounting Depth/Droyal-in Mounting:** 2-2/5" (6.1cm)

- **Cutout Diameter:** 5-3/5" (14.2cm)circle

- **Design and specifications are subject to change without notice.**

Warning

This product contains a high performance tweeter.

If there is a tweeter already installed in your car. then you must disconnect its terminals.

If you leave the original tweeter connected and connect this product in parallel, then a fault may develop in this product, so you are strongly recommended not to do so.



COMPONENT 2-WAY SPEAKER SYSTEM

HAUT-PARLEURS 2 VOIES SEPARÉES

6.53%:J75%3)145/6%

1 PAIR UK CA CE    

ALPINE®

Documents / Resources



[ALPINE EL-E65C 6-1/2 Component Speaker System](#) [pdf] Owner's Manual
EL-E65C-G, 500EL65CG, EL-E65C 6-1 2 Component Speaker System, EL-E65C, 6-1 2 Component Speaker System, Component Speaker System, Speaker System, System

References

- [User Manual](#)

[Manuals+](#), [Privacy Policy](#)

This website is an independent publication and is neither affiliated with nor endorsed by any of the trademark owners. The "Bluetooth®" word mark and logos are registered trademarks owned by Bluetooth SIG, Inc. The "Wi-Fi®" word mark and logos are registered trademarks owned by the Wi-Fi Alliance. Any use of these marks on this website does not imply any affiliation with or endorsement.