



alphacool RX 7900XT Reference with Backplate User Manual

[Home](#) » [ALPHACOOOL](#) » alphacool RX 7900XT Reference with Backplate User Manual 



alphacool

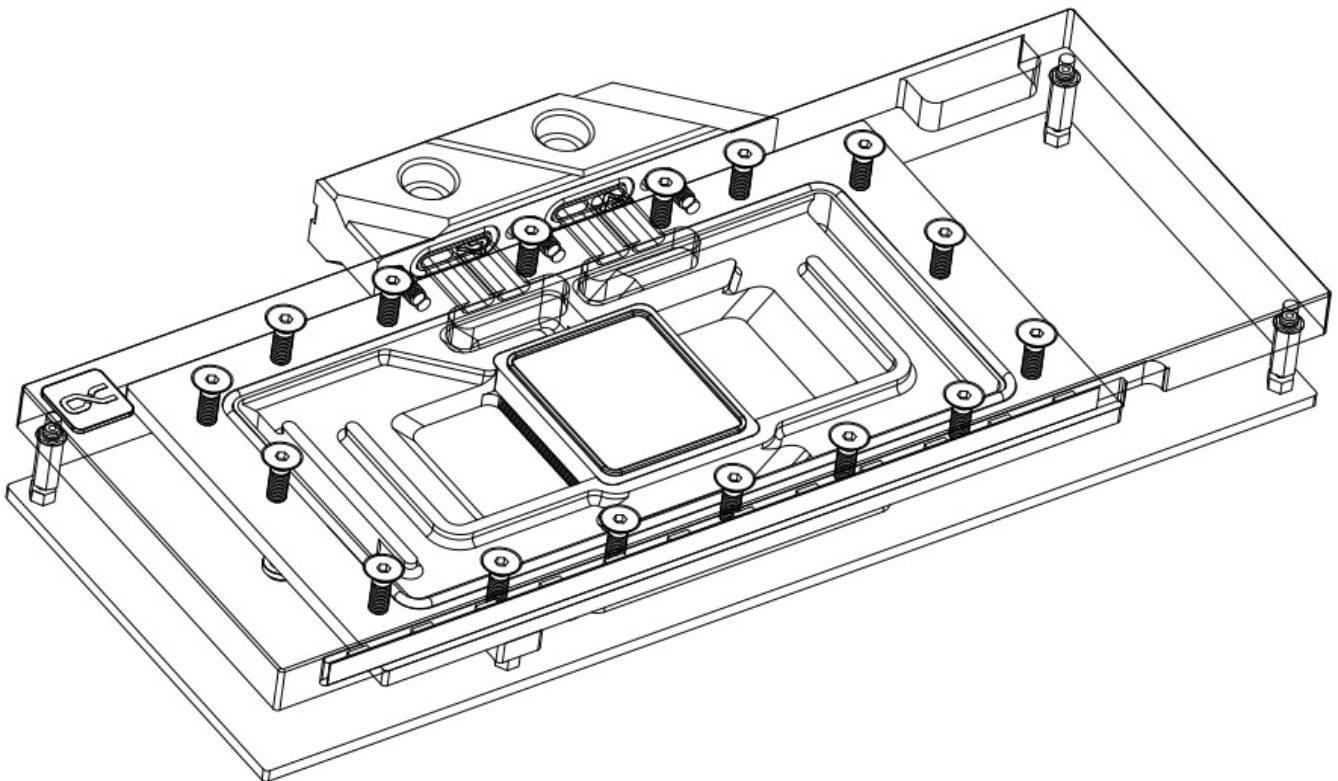

Alphacool
Eisblock Aurora Acryl RX 7900XT Reference
with Backplate



Safety instructions



<https://www.alphacool.com/m/safety.pdf>



Digital guide



<https://www.alphacool.com/m/?acg=1024>

Contents

- [1 Accessories](#)
- [2 Place thermal pads on cooling block](#)
- [3 Apply Thermal Grease](#)
- [4 Install PCB](#)
- [5 Documents / Resources](#)
- [6 Related Posts](#)

Accessories

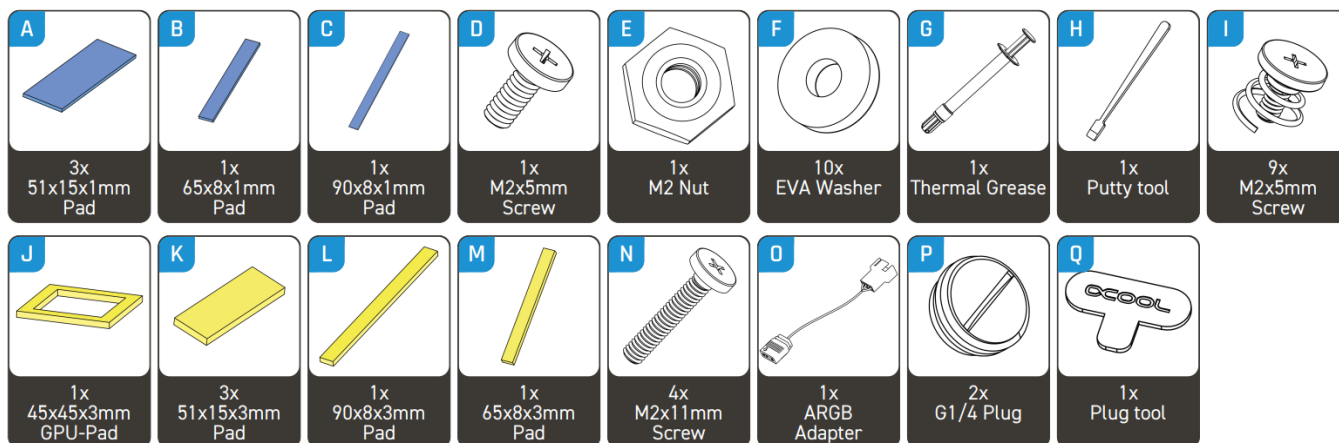

Check compatibility and prepare graphics card

Check compatibility

Before starting the cooler assembly, compare your card with the pictures in our configurator. To do so, visit <https://www.hwconfig.com> and search for your graphics card or cooler model. For a definitive identification, you can also compare the PCB number. The cooler was designed for a special PCB layout. Occasionally, graphics card manufacturers may revise the design of their card slightly, causing the cooler not to fit on later models. During assembly, please make sure taller parts have enough space around them and that the cooler does not damage your graphics card.

Alphacool International GmbH is not liable for assembly errors occurring due to negligence, such as selecting an incompatible cooler.

Prepare graphics card

Put the hardware on an antistatic mat. Begin dismantling the original cooler. Depending on the structure of the cooler, remove the screws at the back of the card and carefully unhook the fan connector first. If the original cooler uses thermal glue, extreme care should be taken as you can easily damage parts. Pick up all the items carefully. Next, clean the hardware of thermal paste or pad residues with a solvent (e.g. isopropanol alcohol).

Place thermal pads on cooling block

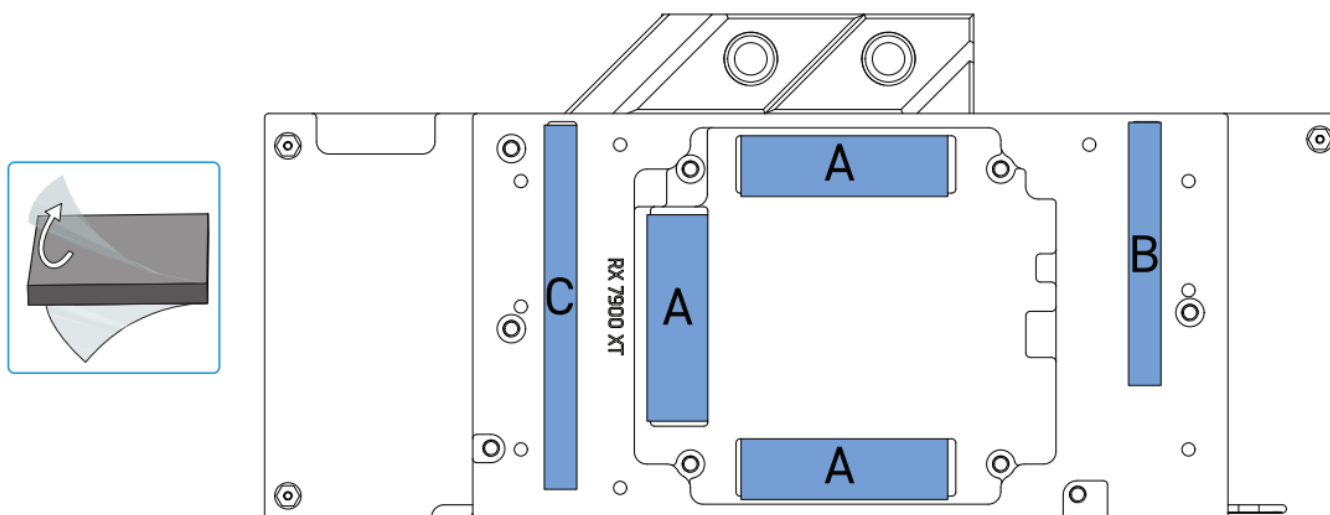

Mount PCI bracket

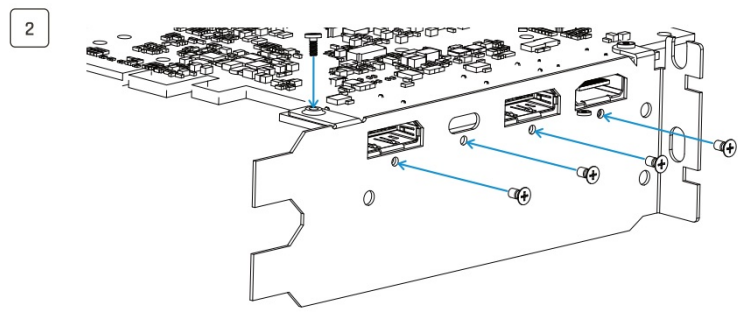
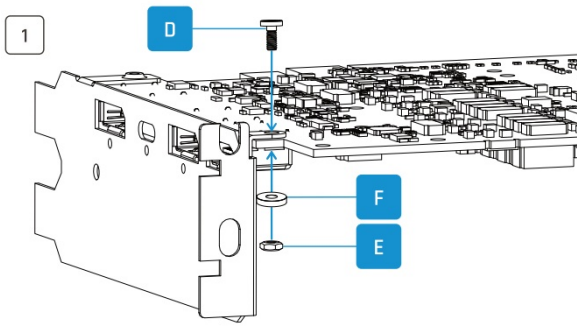

Use the screws supplied in the accessories (1) and the original screws of the graphics card (2).

Apply Thermal Grease

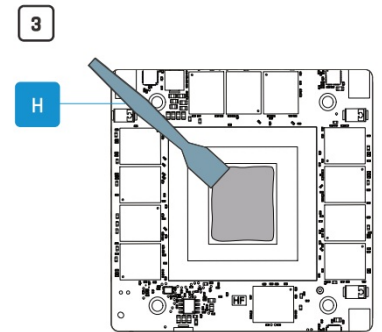
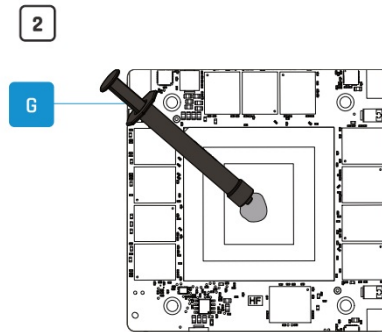
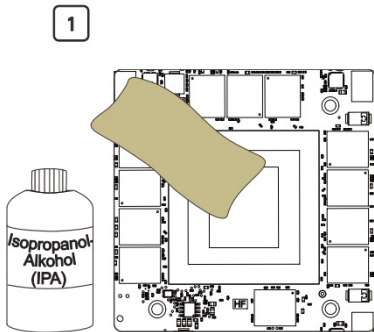

Install PCB

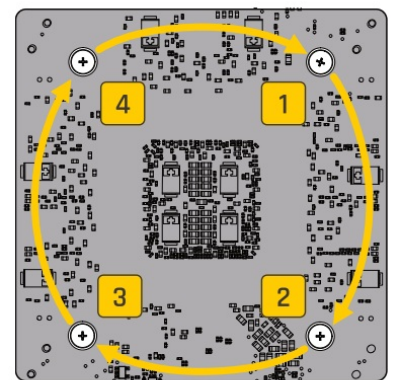
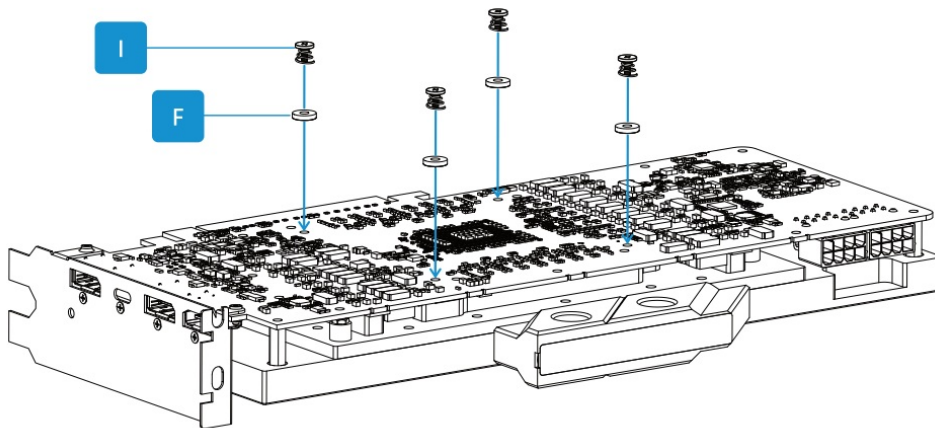

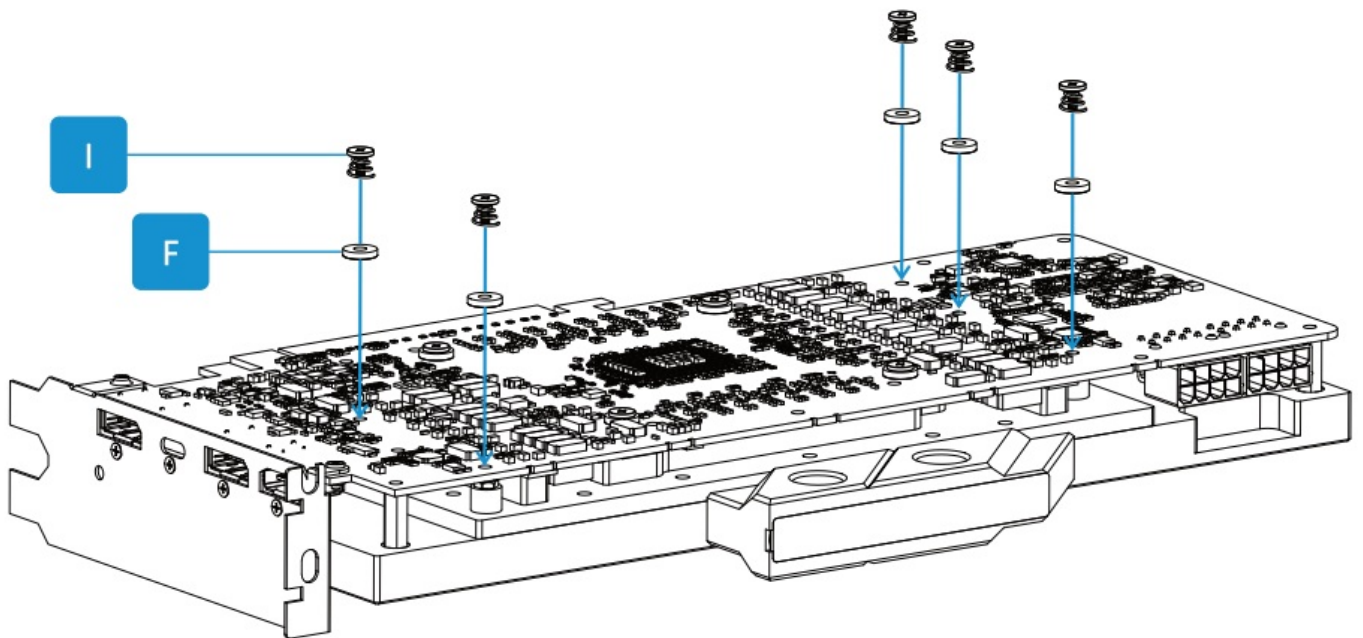

Place thermal pads on PCB backside

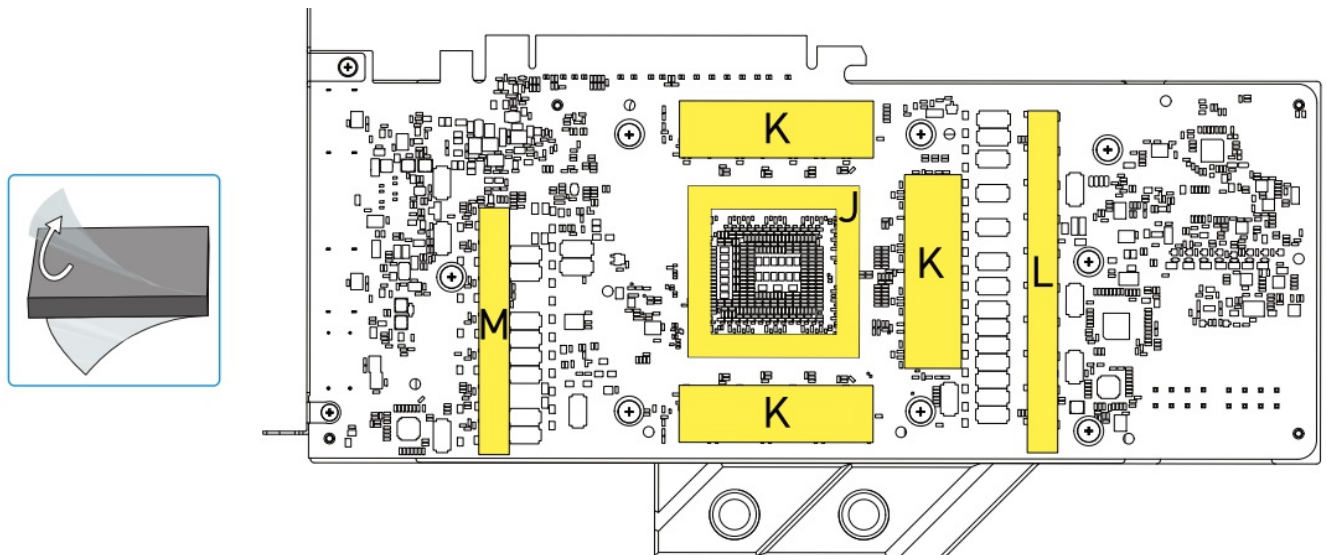

Mount backplate

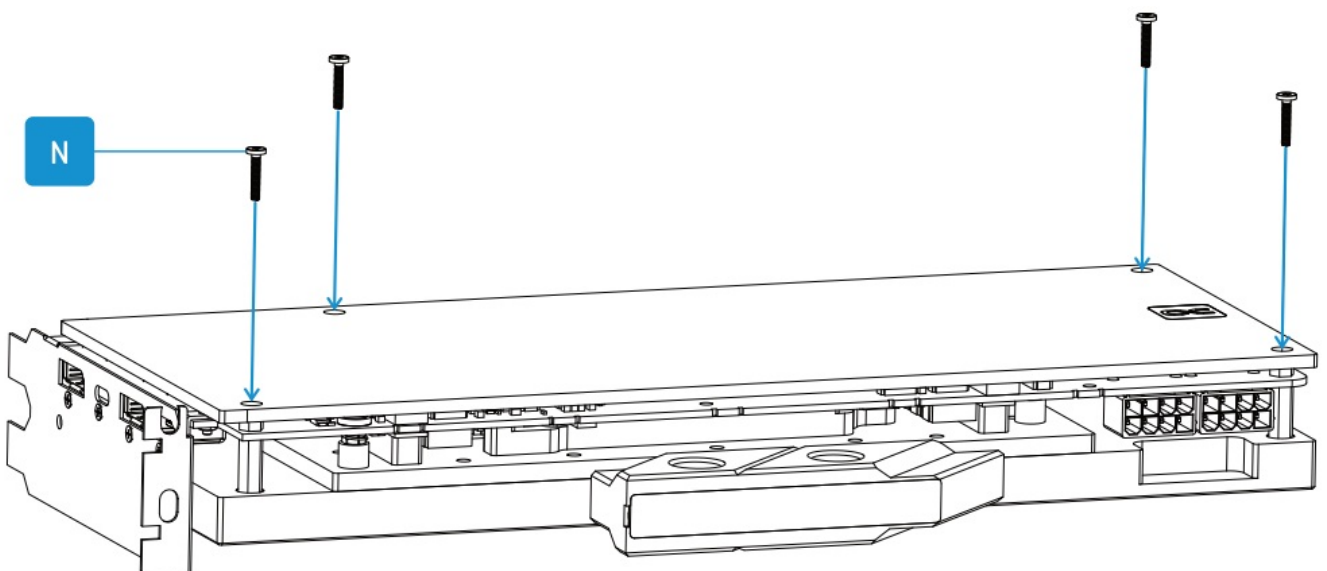

Connect ARGB lighting

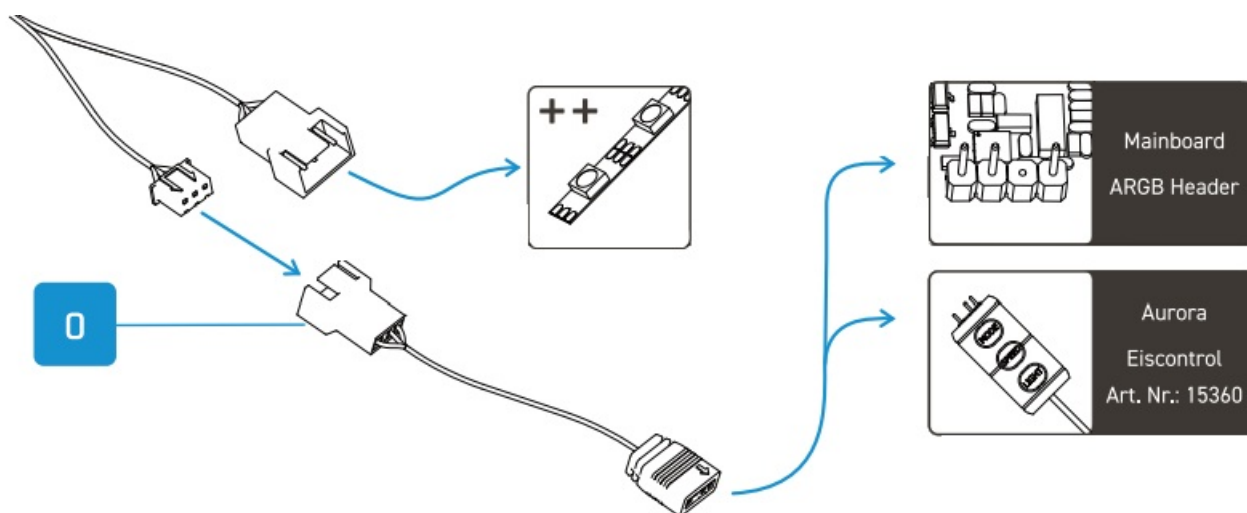

Screw in screw plugs with the tool

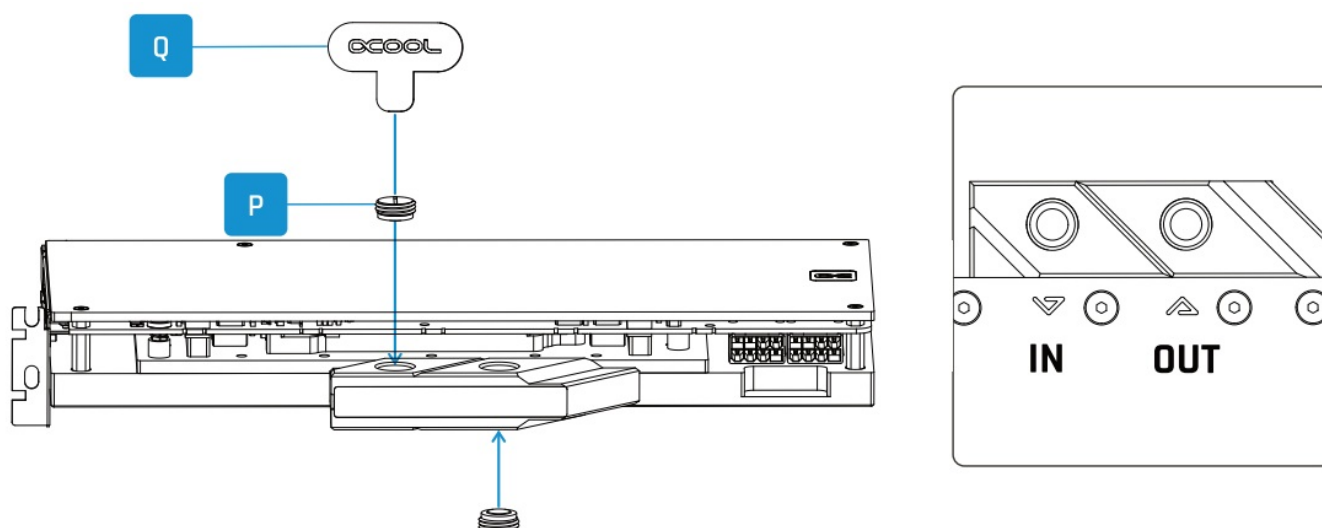

Need help?



Alphacool International GmbH
Marienberger Str. 1
D-38122 Braunschweig
Germany

Support: +49 (0) 531 28874-0

Fax: +49 (0) 531 28874 – 22

E-Mail: info@alphacool.com

<https://www.alphacool.com>

We care!

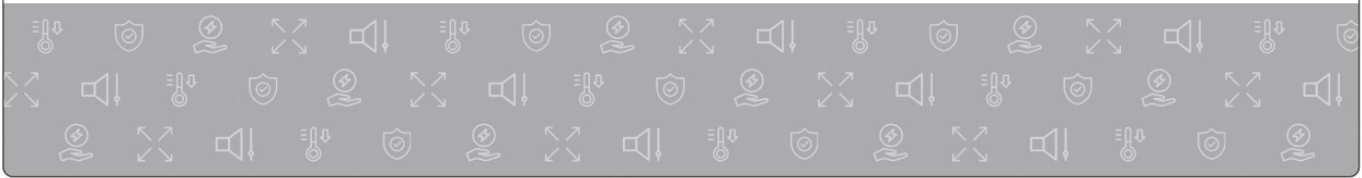

Documents / Resources

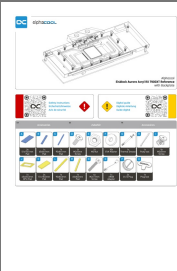
	<p>alphacool RX 7900XT Reference with Backplate [pdf] User Manual</p> <p>RX 7900XT Reference with Backplate, RX 7900XT, Reference with Backplate, Backplate</p>
---	---

Manuals+.