



## alphacool ES Orbiter 360 TS External Water Cooling Instruction Manual

[Home](#) » [ALPHACOOL](#) » alphacool ES Orbiter 360 TS External Water Cooling Instruction Manual 

alphacool ES Orbiter 360 TS External Water Cooling



## Contents

- 1 Accessories
- 2 Dimensions in mm
- 3 Parts identification
- 4 Technical specifications
- 5 Installation of the water connections
- 6 Fill coolant
- 7 Connect to the power source
- 8 Check minimum filling level
- 9 Error messages and fault corrections
- 10 CUSTOMER SUPPORT
- 11 Documents / Resources
  - 11.1 References
- 12 Related Posts

## Accessories

- 1x Funnel G1/4

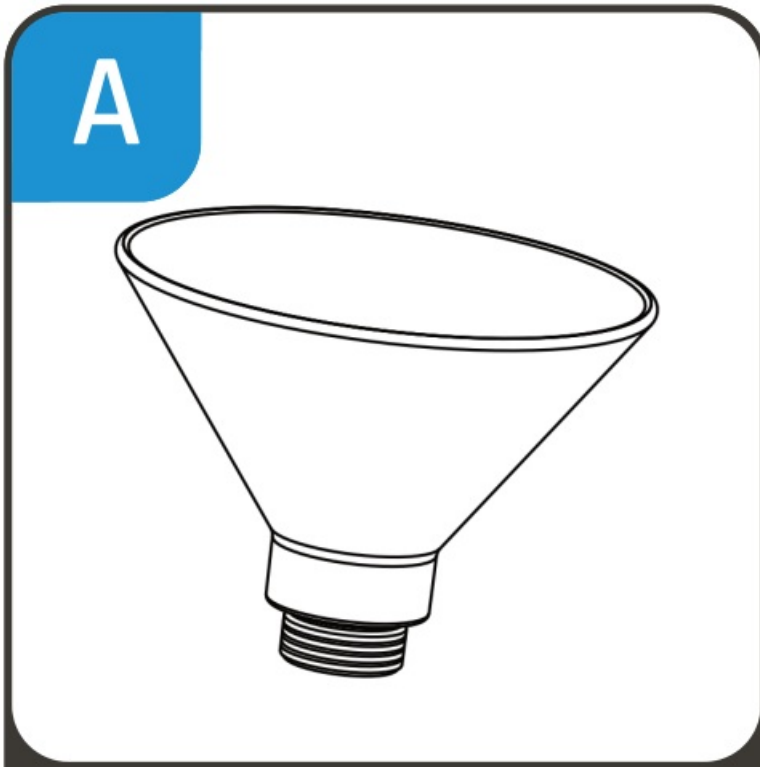

- 1x Power Supply 120cm

B

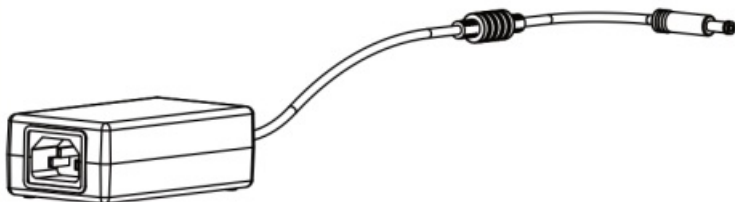

- 1x Power Plug 50cm

C

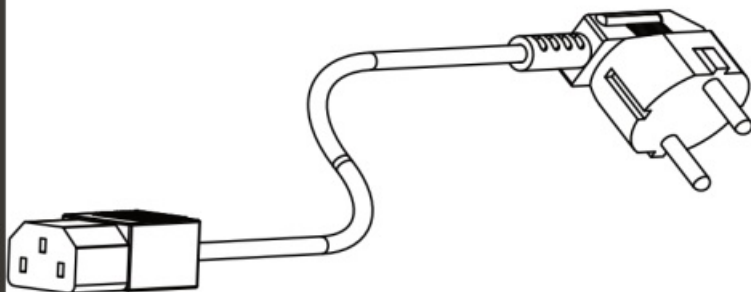

Dimensions in mm

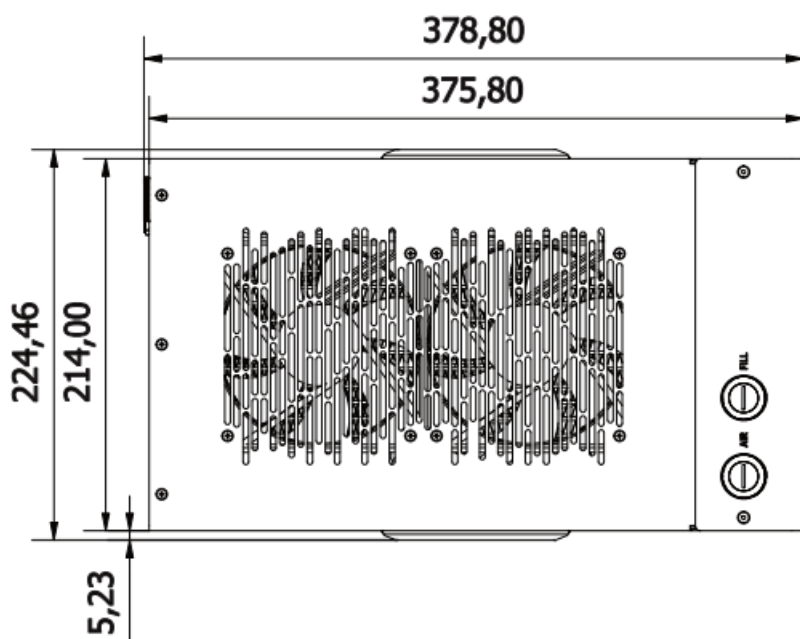
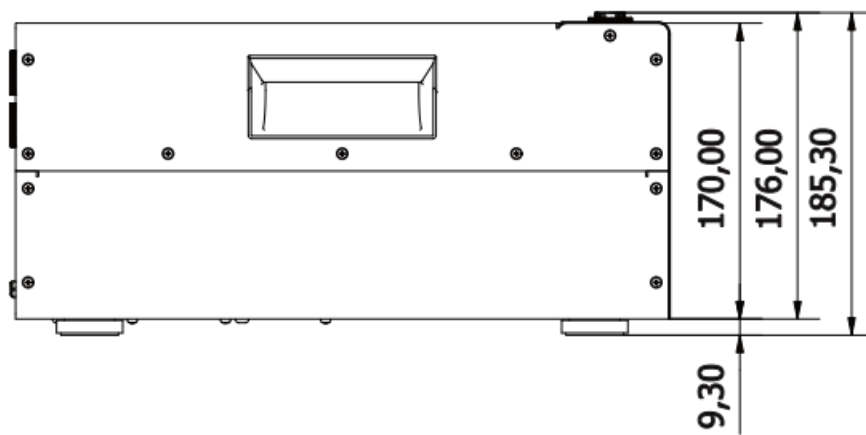

## Parts identification

1. Water inlet and outlet (G ¼")
2. Ergonomically shaped handle
3. Air vents
4. Input power plug
5. Supporting feet
6. Fillport

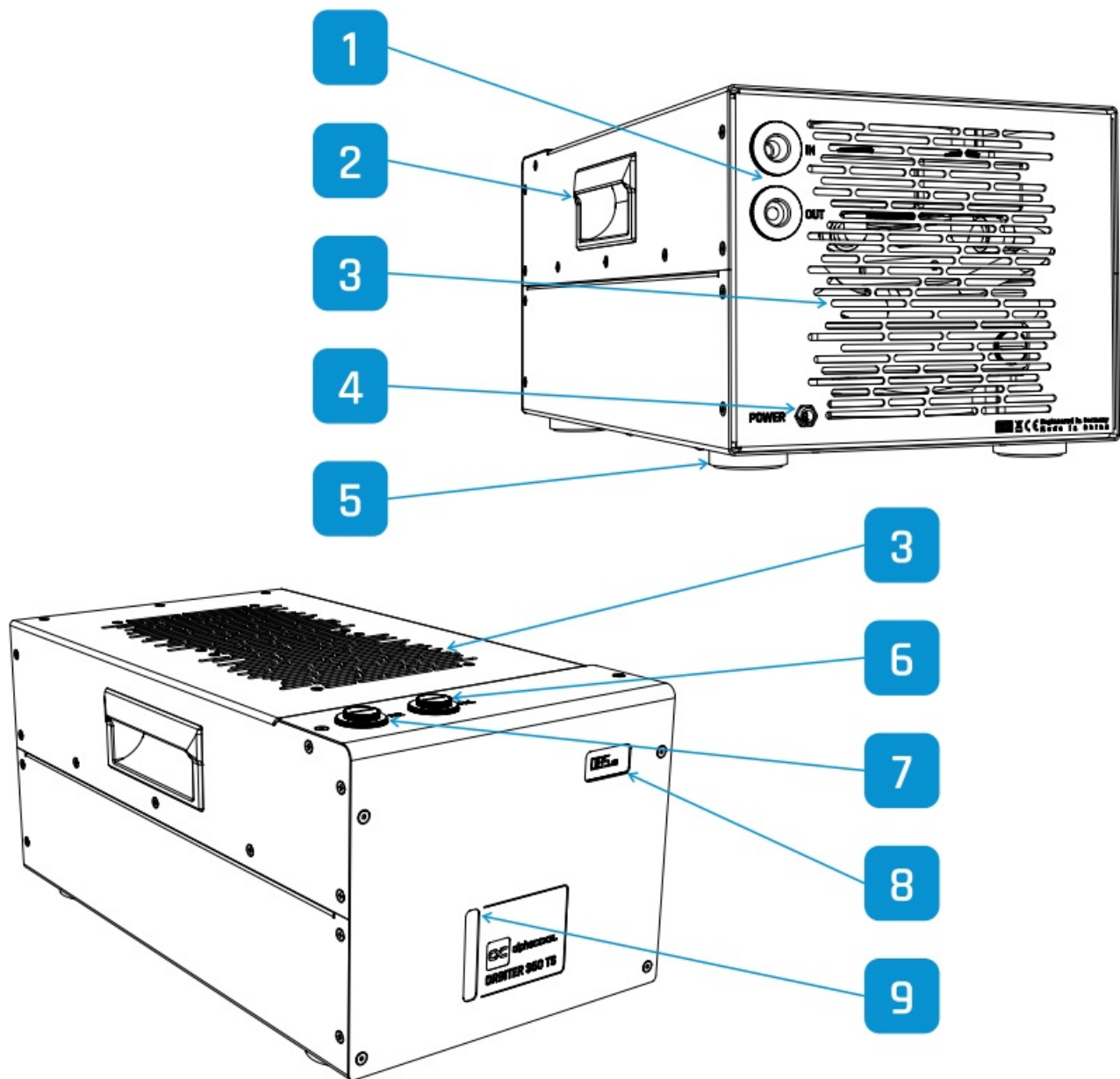

## Technical specifications

- **Approved liquids**  
Water, Water/Glycol mixture
- **Cooling capacity**  
1300W [at 23' ambient temperature)
- **Voltage**  
12V DC
- **Approved water pressure**  
0,8 Bar
- **pumping height max,**  
3,125m
- **Fillport**  
1x G1/ 4"
- **Approved operating temperature**  
75 'C

- **Water connections**

2x G1/ 4"

- **Air balance**

1x G1/ 4"

- **Power consumption**

17,7W

Alphacool NexXoS HPE-30 Full Copper 240mm Radiator

Art.Nr, 14376

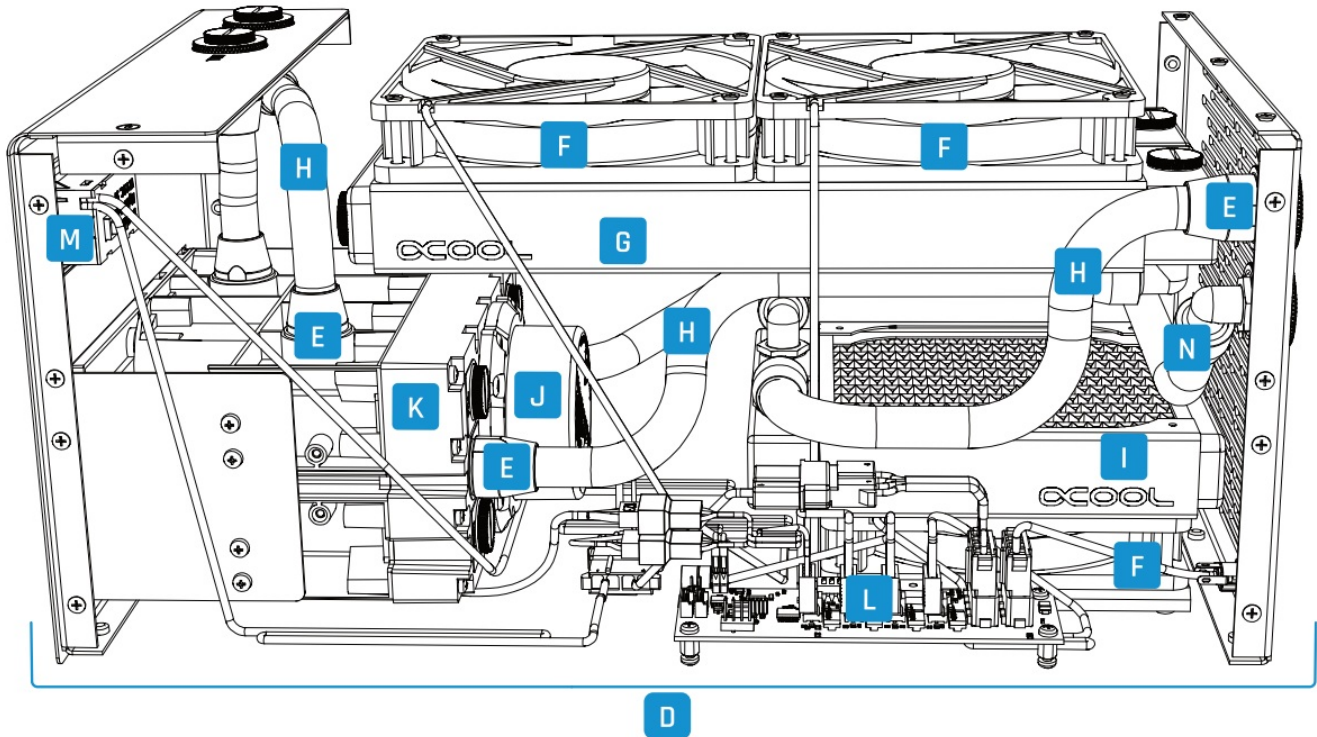

## Installation of the water connections

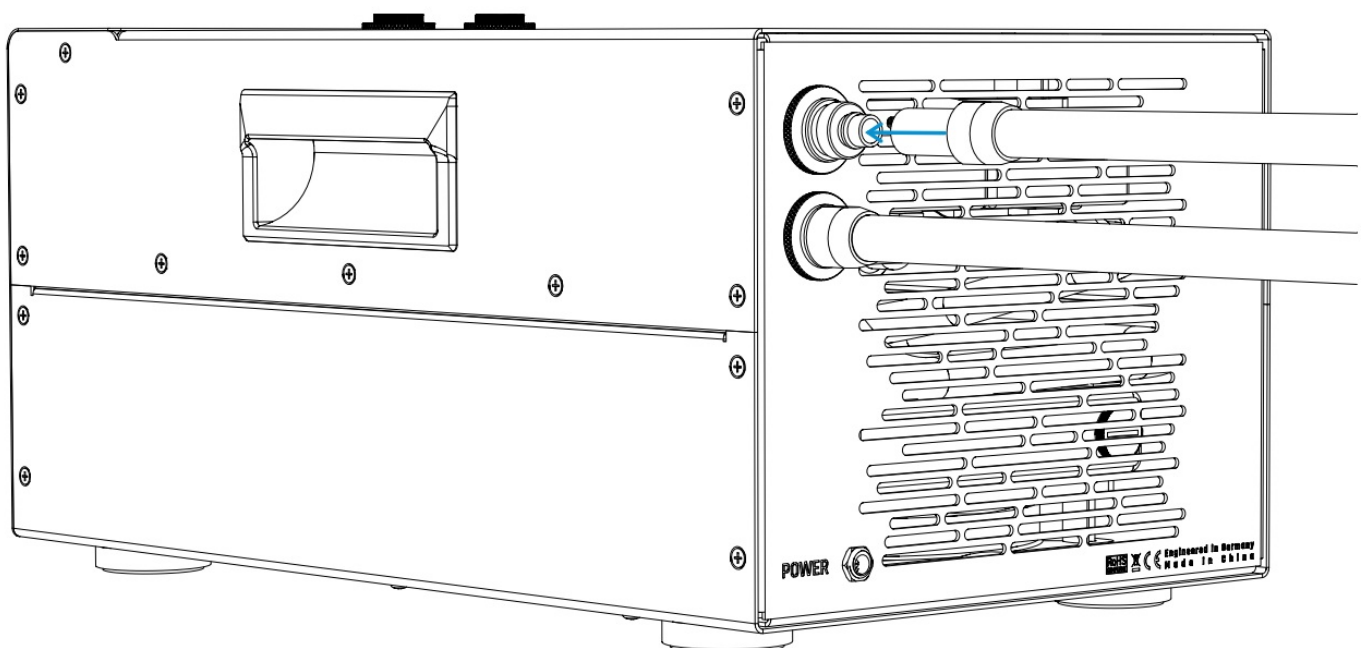

## Fill coolant

Do not operate the orbiter without coolant!

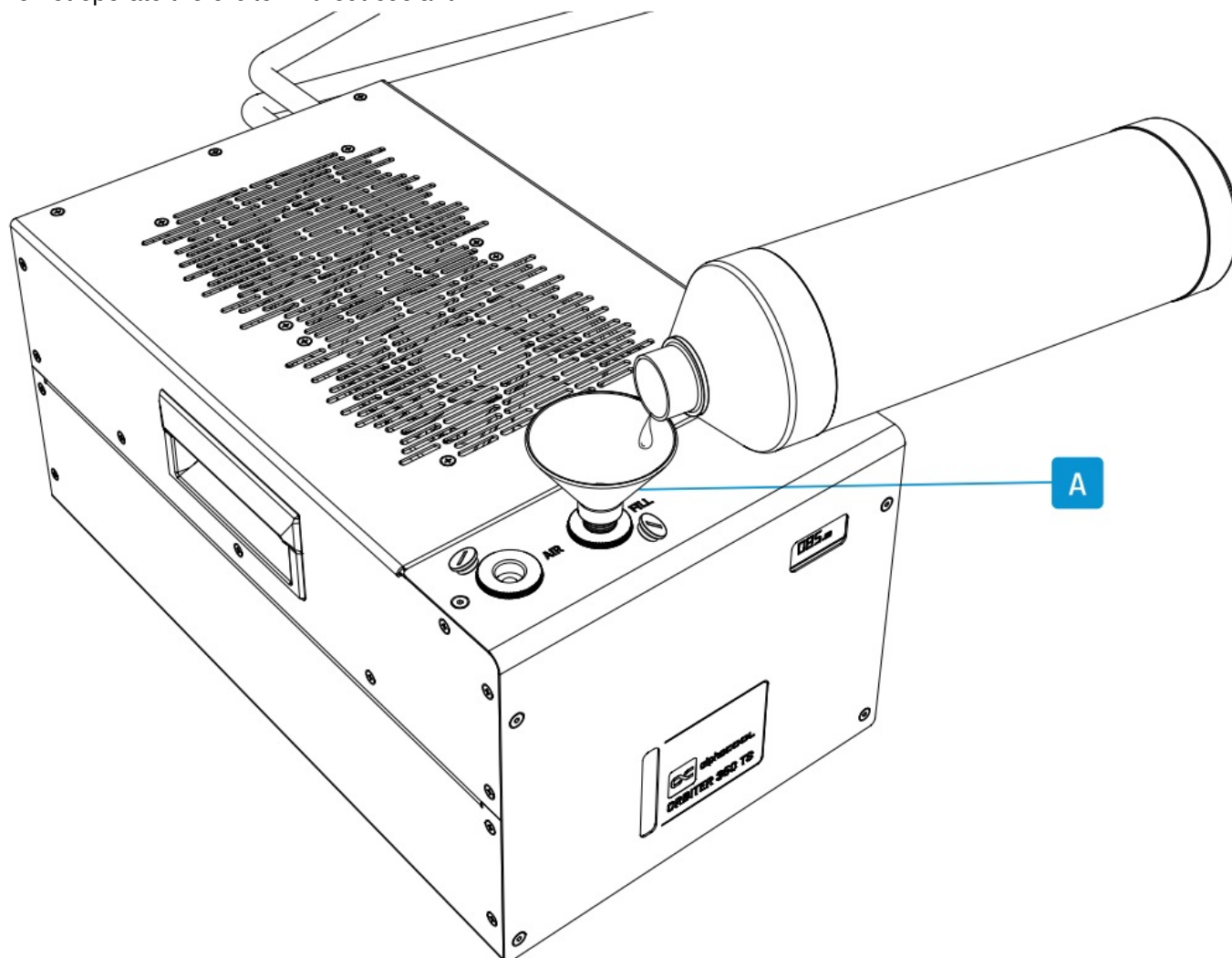

## Connect to the power source

The Orbiter starts as soon as it is connected to the power supply.

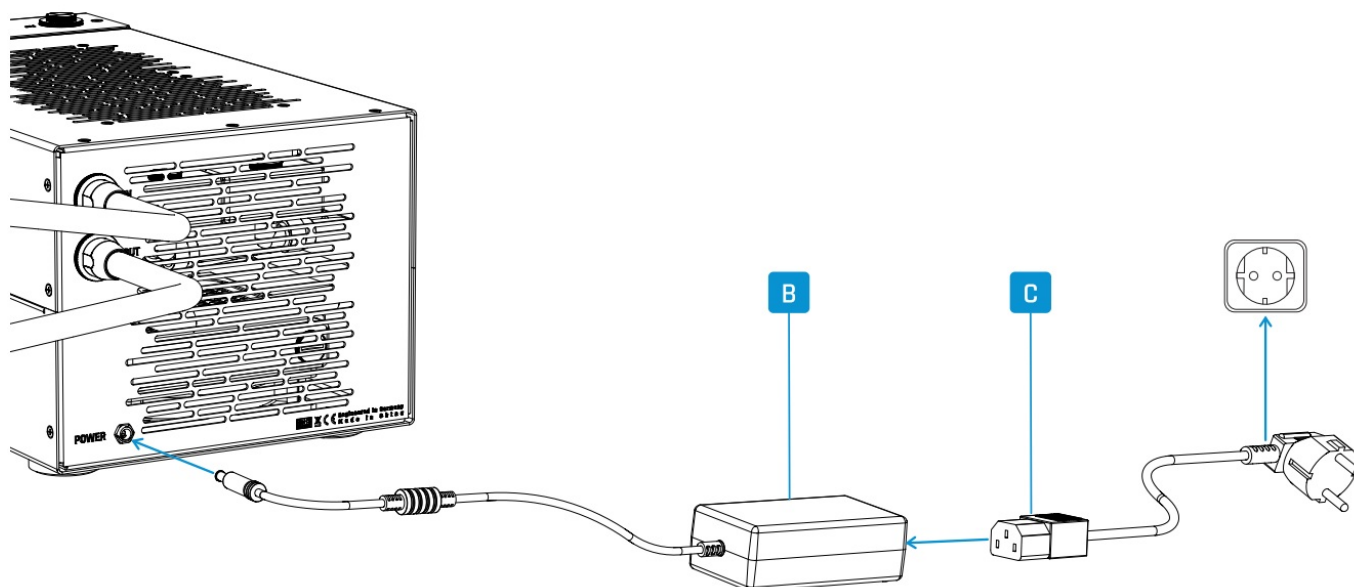

## Check minimum filling level

During first commissioning, the filling level may drop because air escapes from the individual components.



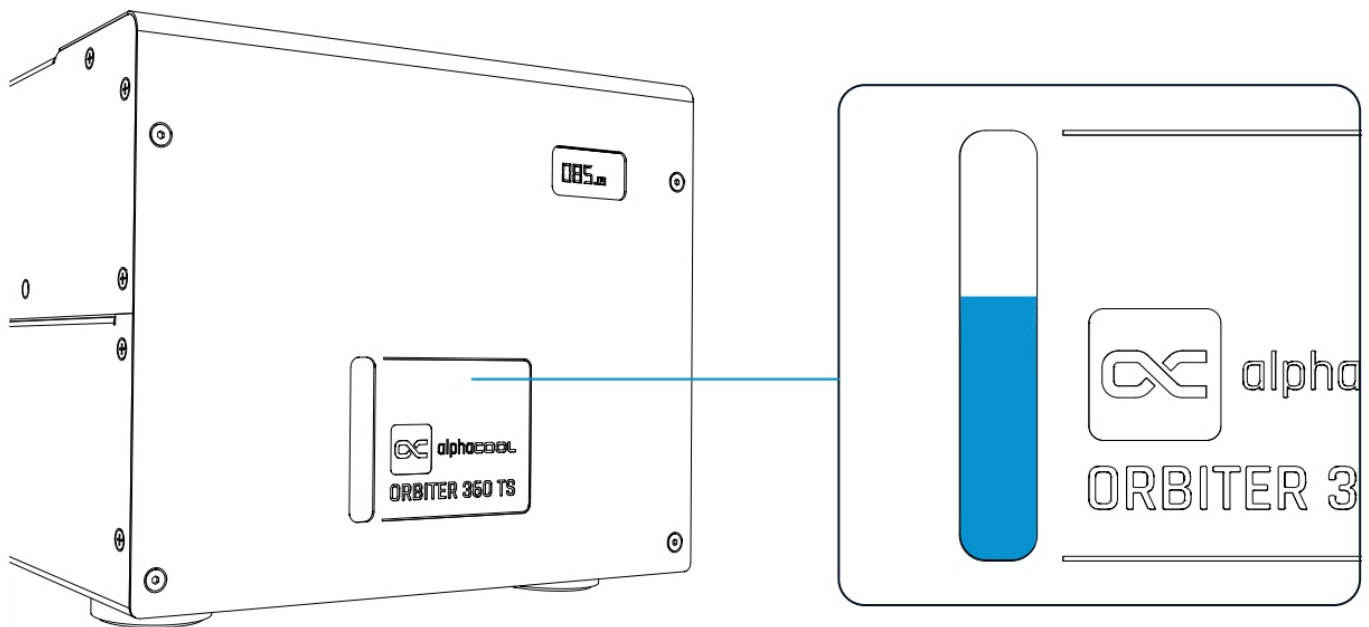

Watch the fill level and refill with coolant if necessary.

## Error messages and fault corrections

### The pump makes noticeable noises?

#### Fault Cause

There are air volumes in the system or cooling liquid is missing.

#### Approach

Open the vent port, refill with coolant if necessary.  
Observe the minimum filling level.

### The warning signal sounds?

#### Fault Cause

The pump and/or a fan has failed.

#### Approach

Drain the water, check the unit by a qualified technician and/or return the failed part.

### The system does not pump water?

#### Fault Cause

The pump is defective.

#### Approach

Check the pump by a qualified technician and/or return the pump.

### Water leaks from the system?

#### Fault Cause

The connections and/or the hoses are incorrectly mounted and/or defective.



**Approach**

Switch off the device, check the connections and/or the hoses, tighten if necessary or return the parts.

**The Orbiter does not start?****Fault Cause**

The power supply is defective and/or the power plug is not connected properly.

**Approach**

Replace the power supply and/or check the power supply.

**The temperature is too high?****Fault Cause**

The air supply is impeded and/or the power to be cooled of 1500 watt is exceeded.

**Approach**

Clean the ventilation from dust and/or reduce the power of the heat sources, connect a second orbiter if necessary.

**CUSTOMER SUPPORT**

Safety instructions



Digital guide

**Need help?**

Alphacool International GmbH  
Marienberger Str. 1  
D-38122 Braunschweig  
Germany

**Support:** +49 (0) 531 28874-0

**Fax:** +49 (0) 531 28874 – 22

**E-Mail:** [info@alphacool.com](mailto:info@alphacool.com)

<https://www.alphacool.com>

We care!



# alphacool

---

## Documents / Resources



[alphacool ES Orbiter 360 TS External Water Cooling](#) [pdf] Instruction Manual  
ES Orbiter 360 TS, ES Orbiter 360 TS External Water Cooling, External Water Cooling, Water Cooling, Cooling

## References

- [User Manual](#)