

# ALPHACOOL 7900XTX Eisblock Aurora Acryl Reference Instruction Manual

[Home](#) » [ALPHACOOL](#) » ALPHACOOL 7900XTX Eisblock Aurora Acryl Reference Instruction Manual 

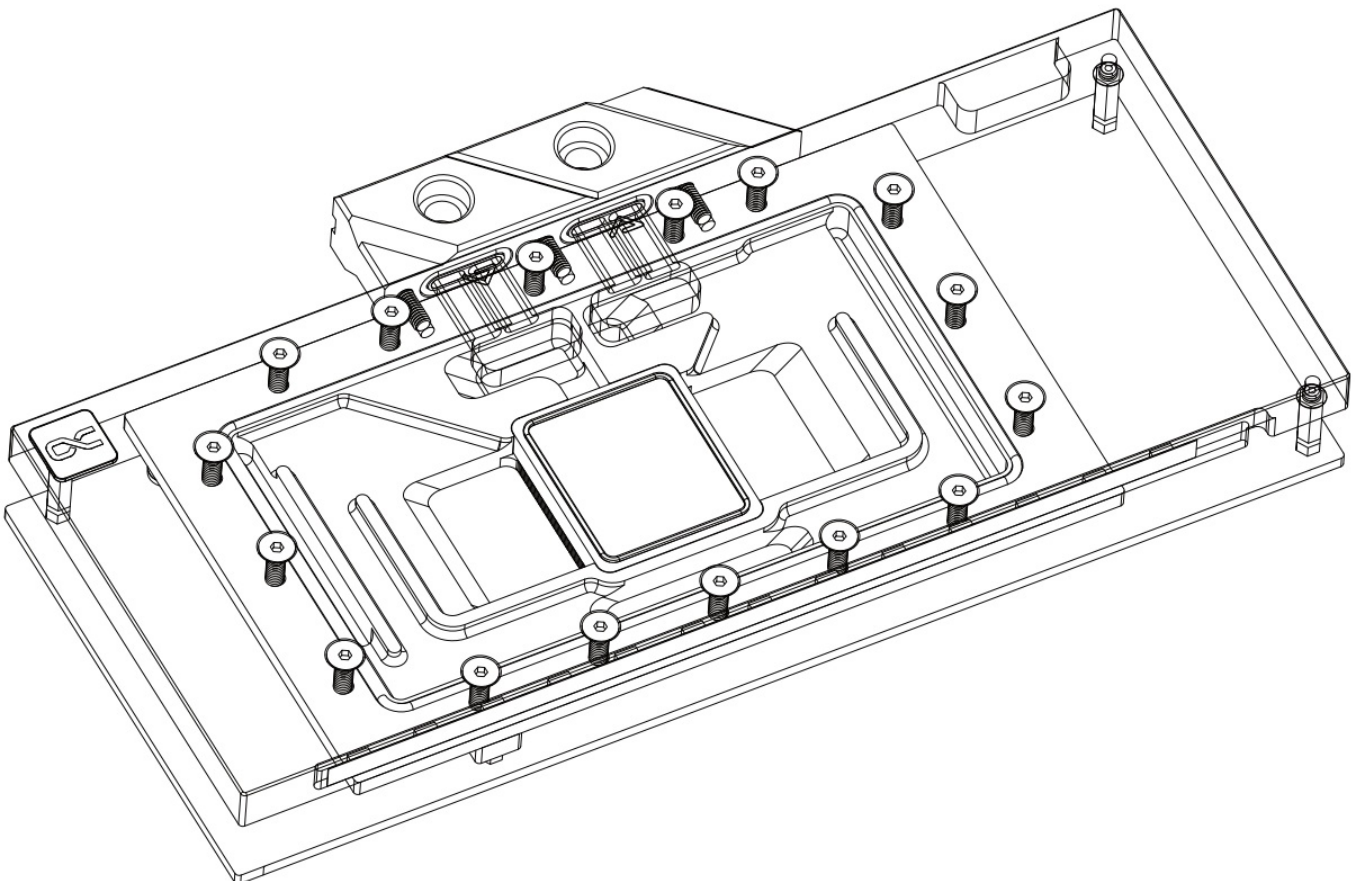

## 7900XTX Eisblock Aurora Acryl Reference Instruction Manual



Alphacool  
Eisblock Aurora Acryl RX 7900XTX Reference  
with Backplate

## Contents

- [1 7900XTX Eisblock Aurora Acryl Reference](#)
- [2 Accessories](#)
- [3 Check compatibility](#)
- [4 Prepare graphics card](#)
- [5 Install PCB](#)
- [6 Mount backplate](#)
- [7 Documents / Resources](#)
- [8 Related Posts](#)

## 7900XTX Eisblock Aurora Acryl Reference



Safety instructions



<https://www.alphacool.com/m/?acg=1021>



Digital guide



<https://www.alphacool.com/m/safety.pdf>

## Accessories

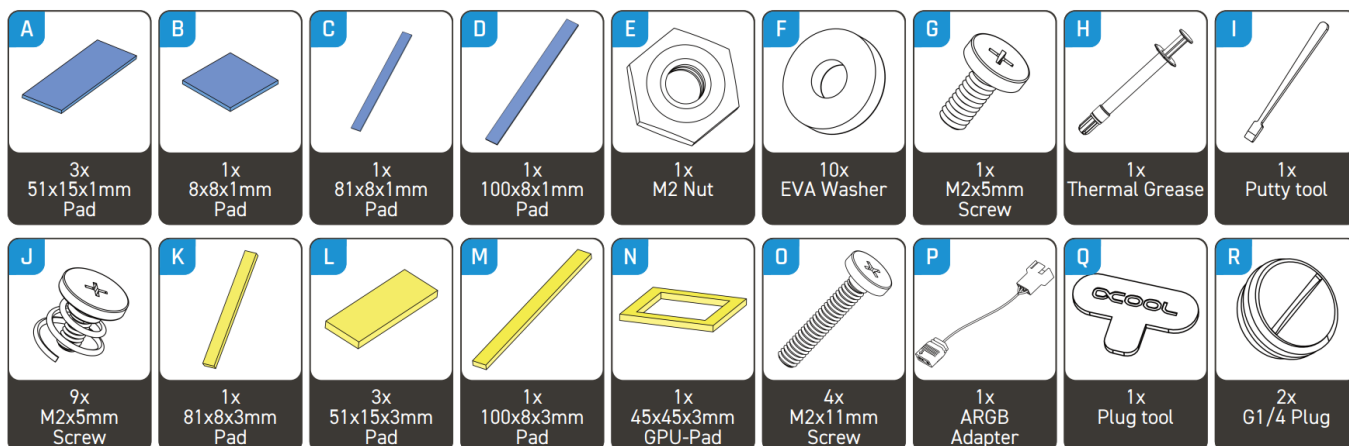

## Check compatibility and prepare graphics card

### Check compatibility

Before starting the cooler assembly, compare your card with the pictures in our configurator. To do so, visit <https://www.hwconfig.com> and search for your graphics card or cooler model. For a definitive identification, you can also compare the PCB number. The cooler was designed for a special PCB layout. Occasionally, graphics card manufacturers may revise the design of their card slightly, causing the cooler not to fit on later models. During assembly, please make sure taller parts have enough space around them and that the cooler does not damage your graphics card.

Alphacool International GmbH is not liable for assembly errors occurring due to negligence, such as selecting an incompatible cooler.

### Prepare graphics card

Put the hardware on an antistatic mat. Begin dismantling the original cooler. Depending on the structure of the cooler, remove the screws at the back of the card and carefully unhook the fan connector first. If the original cooler uses thermal glue, extreme care should be taken as you can easily damage parts. Pick up all the items carefully. Next, clean the hardware of thermal paste or pad residues with a solvent (e.g. isopropanol alcohol).

#### Place thermal pads on cooling block

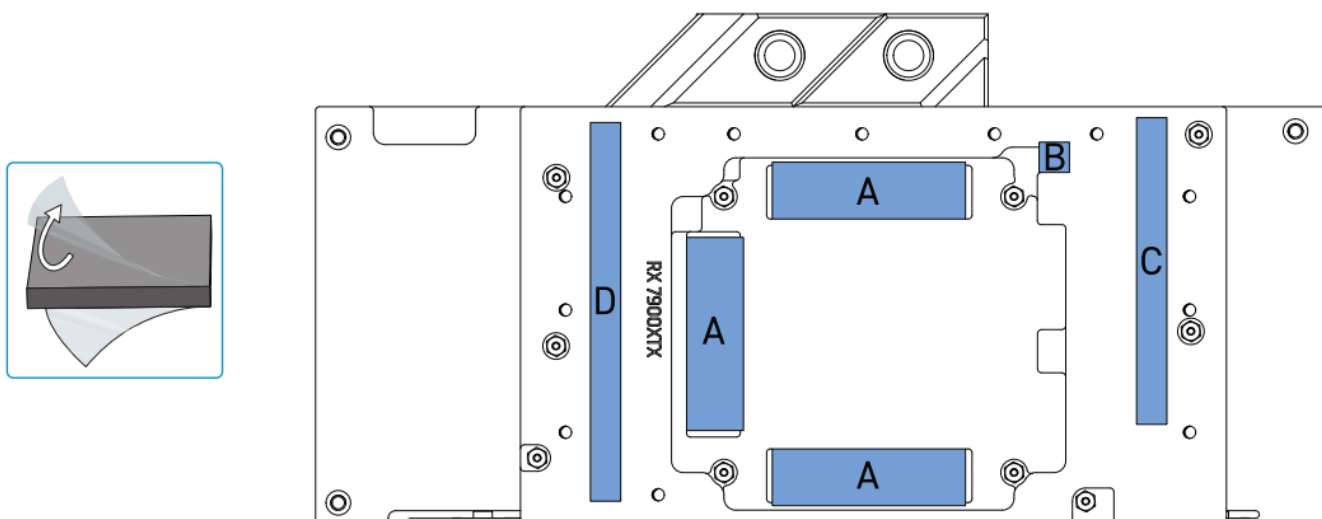

#### Mount PCI bracket

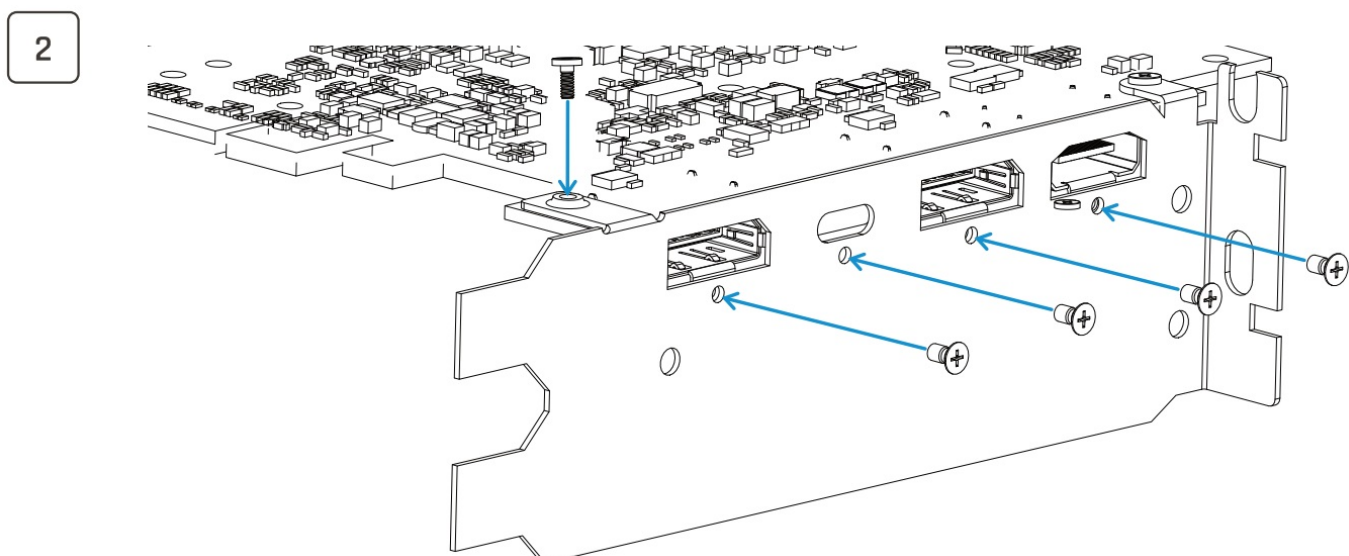
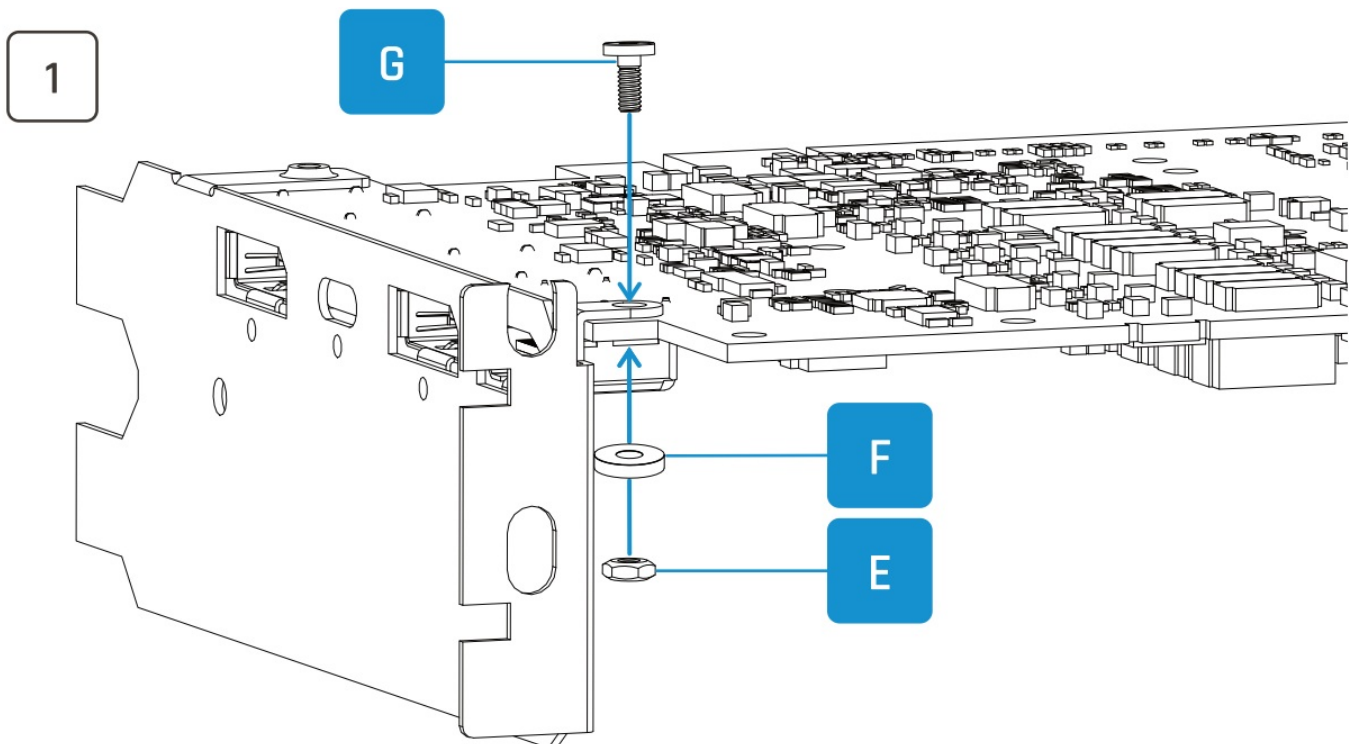

Use the screws supplied in the accessories (1) and the original screws of the graphics card (2).

### Apply Thermal Grease

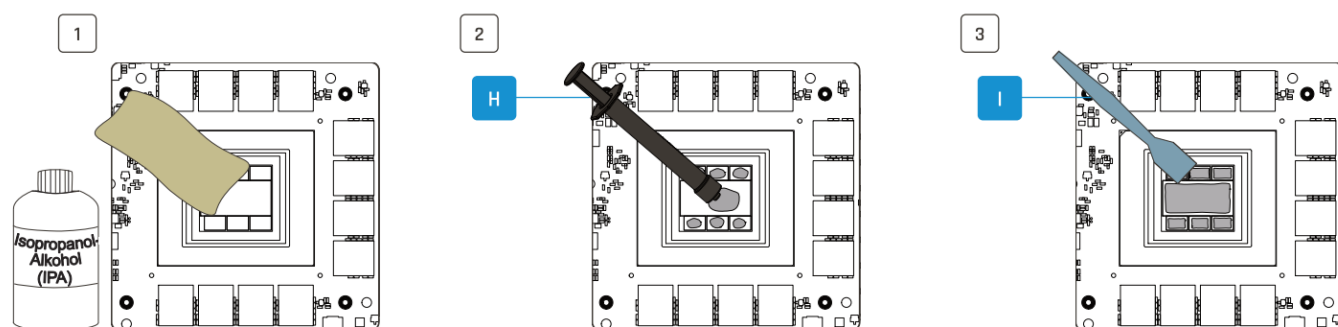

### Install PCB

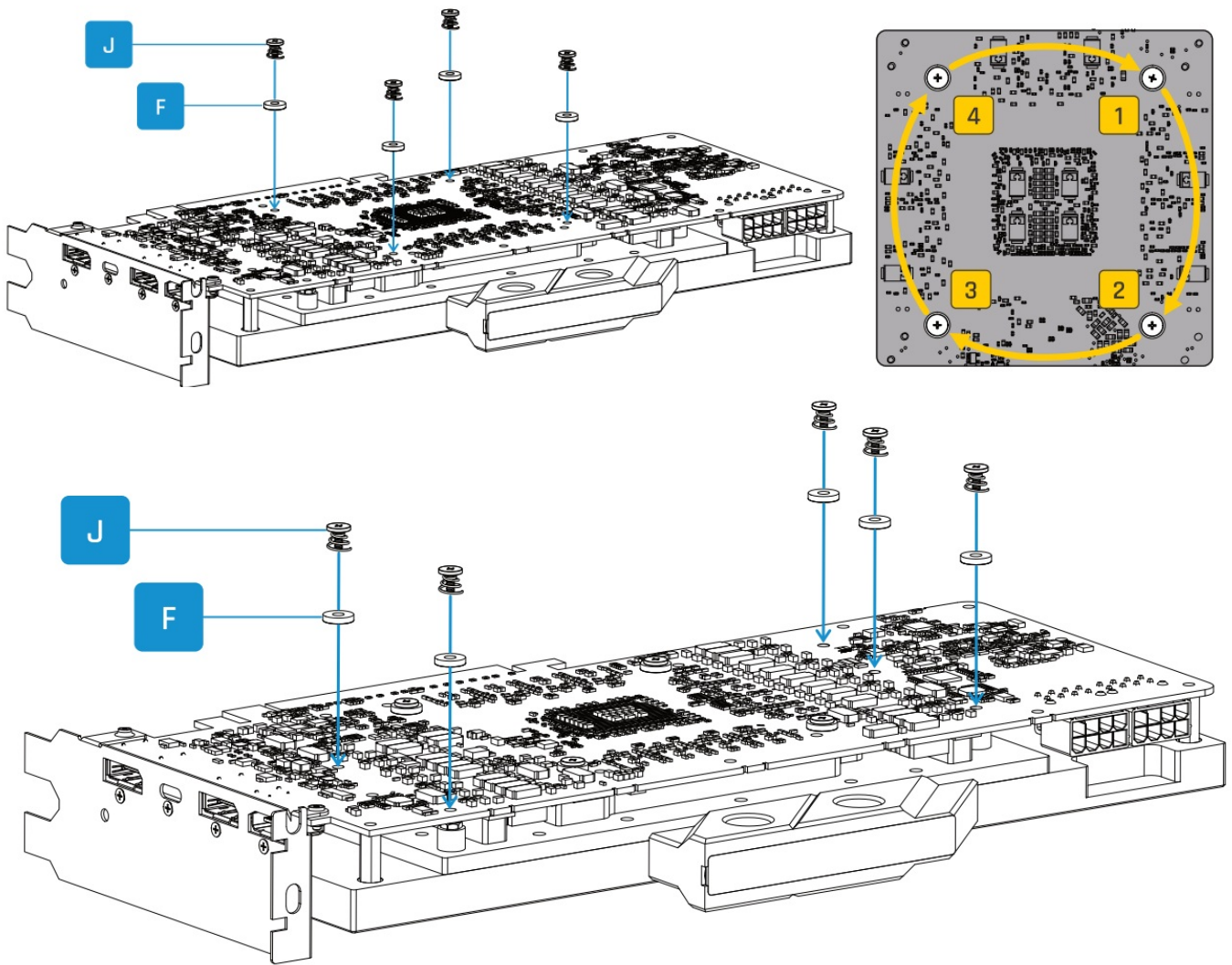

**Place thermal pads on PCB backside**

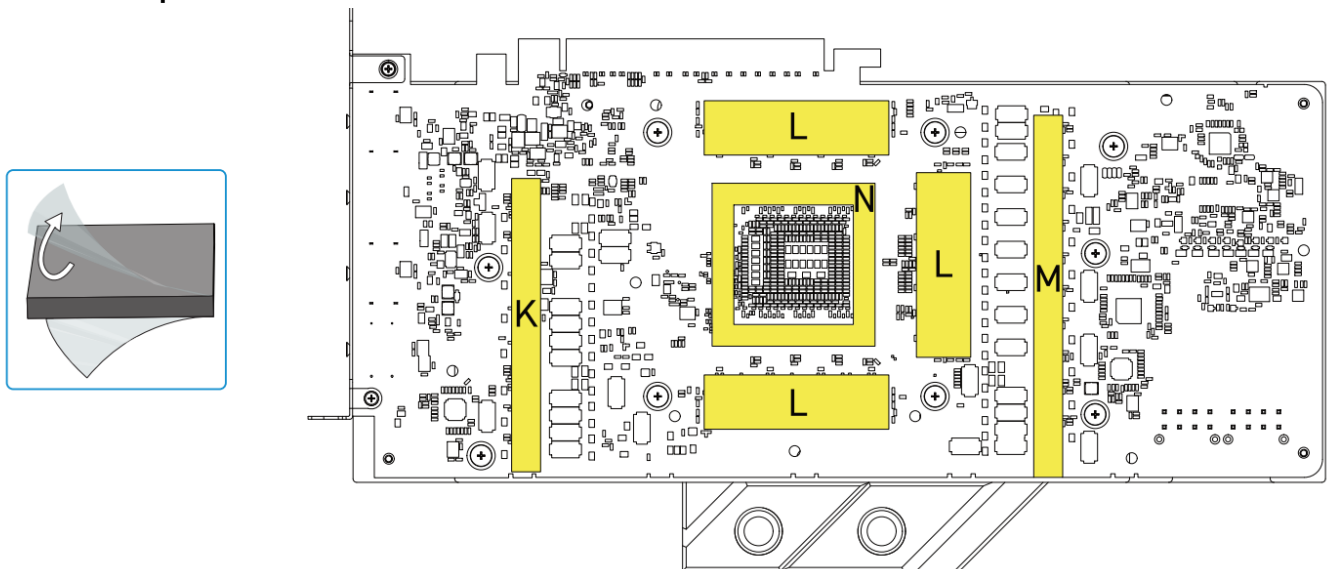

**Mount backplate**



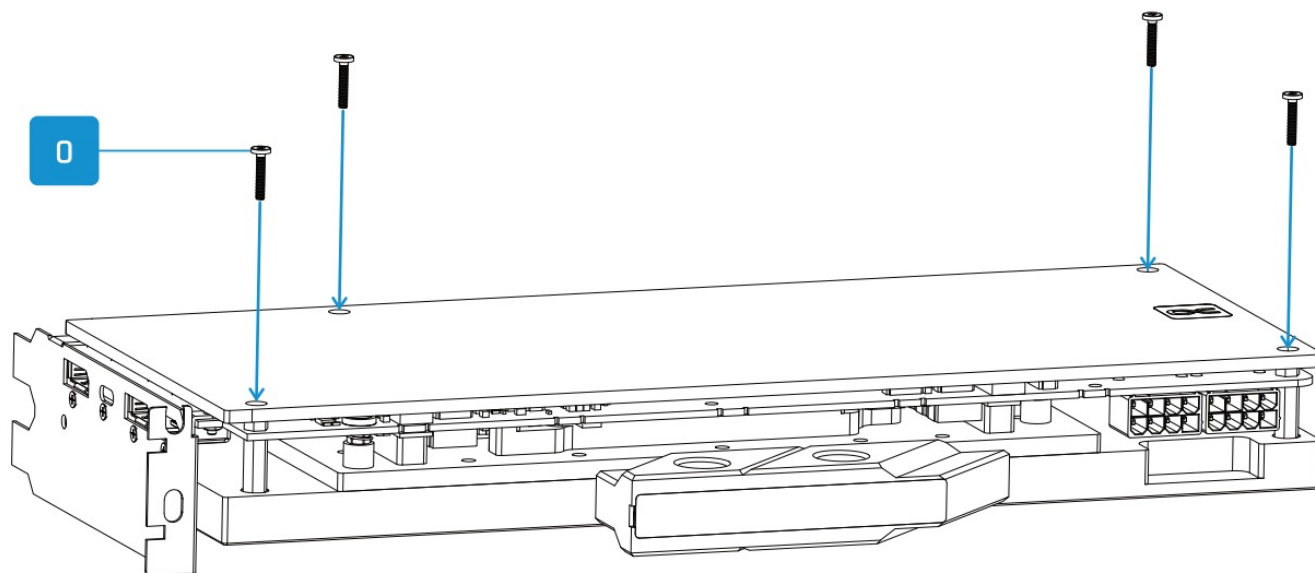

**Connect ARGB lighting**

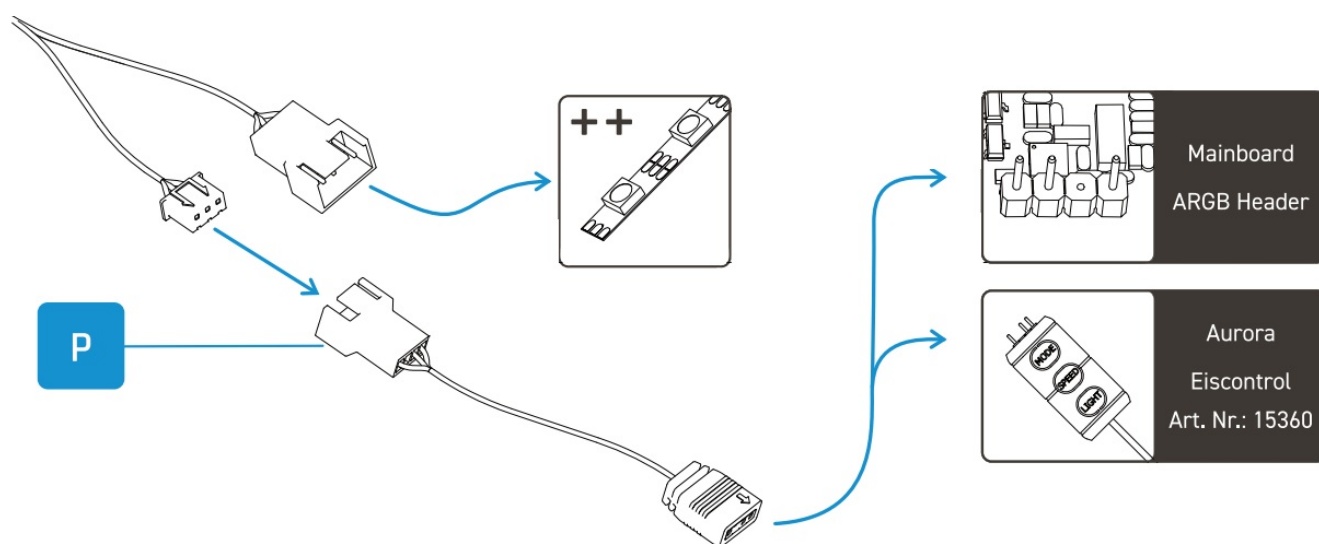

**Screw in screw plugs with the tool**

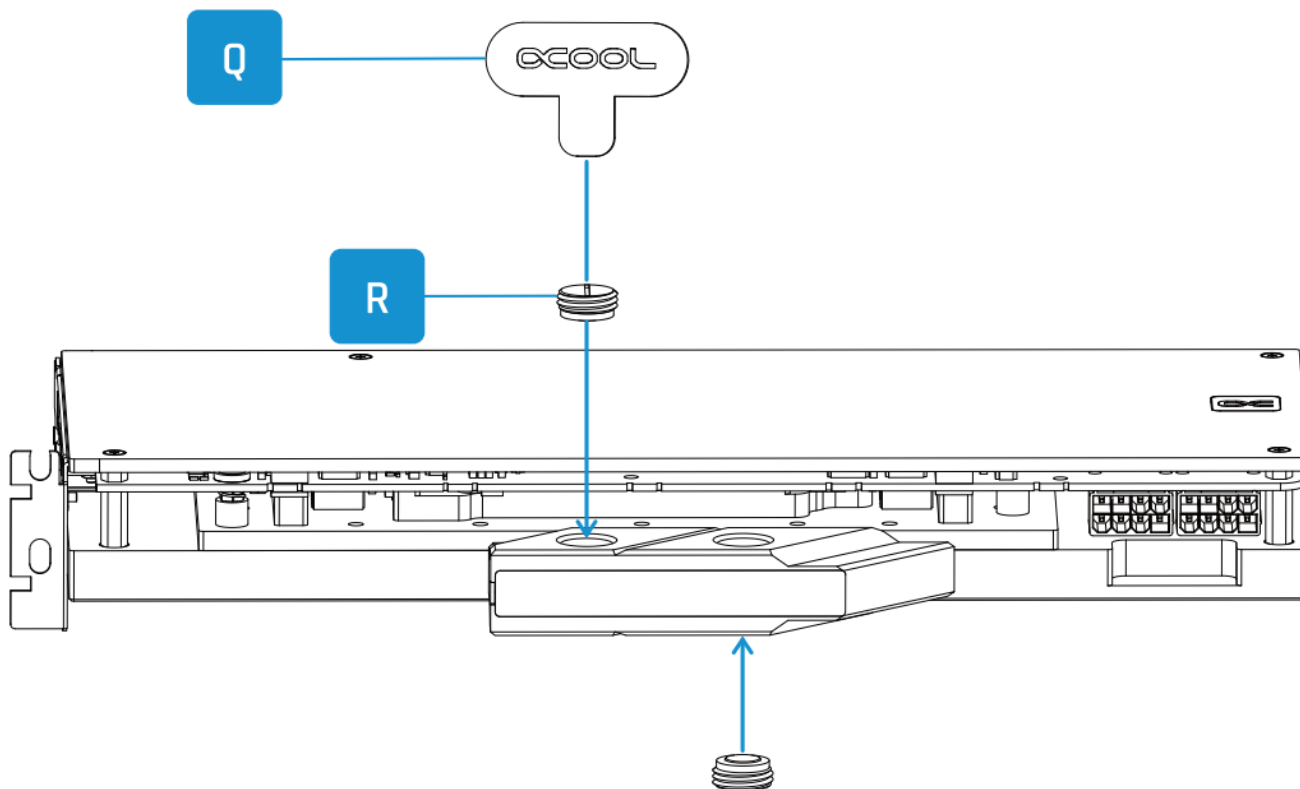

Alphacool International GmbH  
 Marienberger Str. 1  
 D-38122 Braunschweig  
 Germany

Support: +49 (0) 531 28874-0

Fax: +49 (0) 531 28874 – 22

E-Mail: [info@alphacool.com](mailto:info@alphacool.com)

<https://www.alphacool.com>

We care!

## Documents / Resources

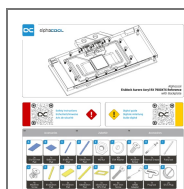

**[ALPHACOOL 7900XTX Eisblock Aurora Acryl Reference](#)** [pdf] Instruction Manual  
 7900XTX Eisblock Aurora Acryl Reference, 7900XTX, Eisblock Aurora Acryl Reference, Aurora  
 Acryl Reference, Acryl Reference, Reference