



alpha series Add-on Wireless Motion Sensor Spotlight with Remote Control Instruction Manual

[Home](#) » [alpha series](#) » alpha series Add-on Wireless Motion Sensor Spotlight with Remote Control Instruction Manual 

alpha series Add-on Wireless Motion Sensor Spotlight with Remote Control Instruction Manual



Contents

- 1 OVERVIEW
- 2 BATTERY INSTALLATION
- 3 USING THE REMOTE CONTROL
- 4 PAIRING WITH THE INDOOR ALARM RECEIVER
- 5 MOUNTING THE SPOTLIGHT
- 6 LIMITED WARRANTY TERMS & CONDITIONS
- 7 FCC Statement
- 8 Battery Safety Information
- 9 Documents / Resources
- 10 Related Posts

OVERVIEW

Spotlight

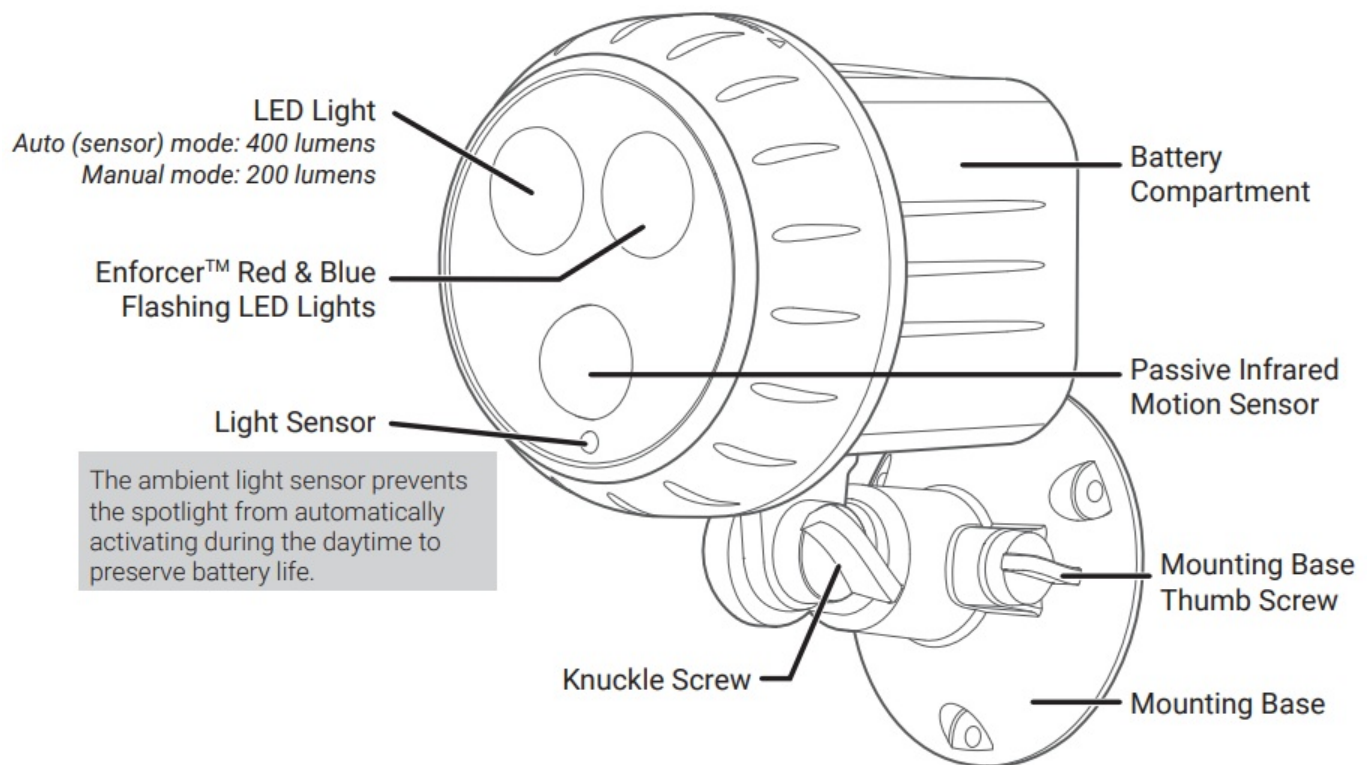

Remote Control

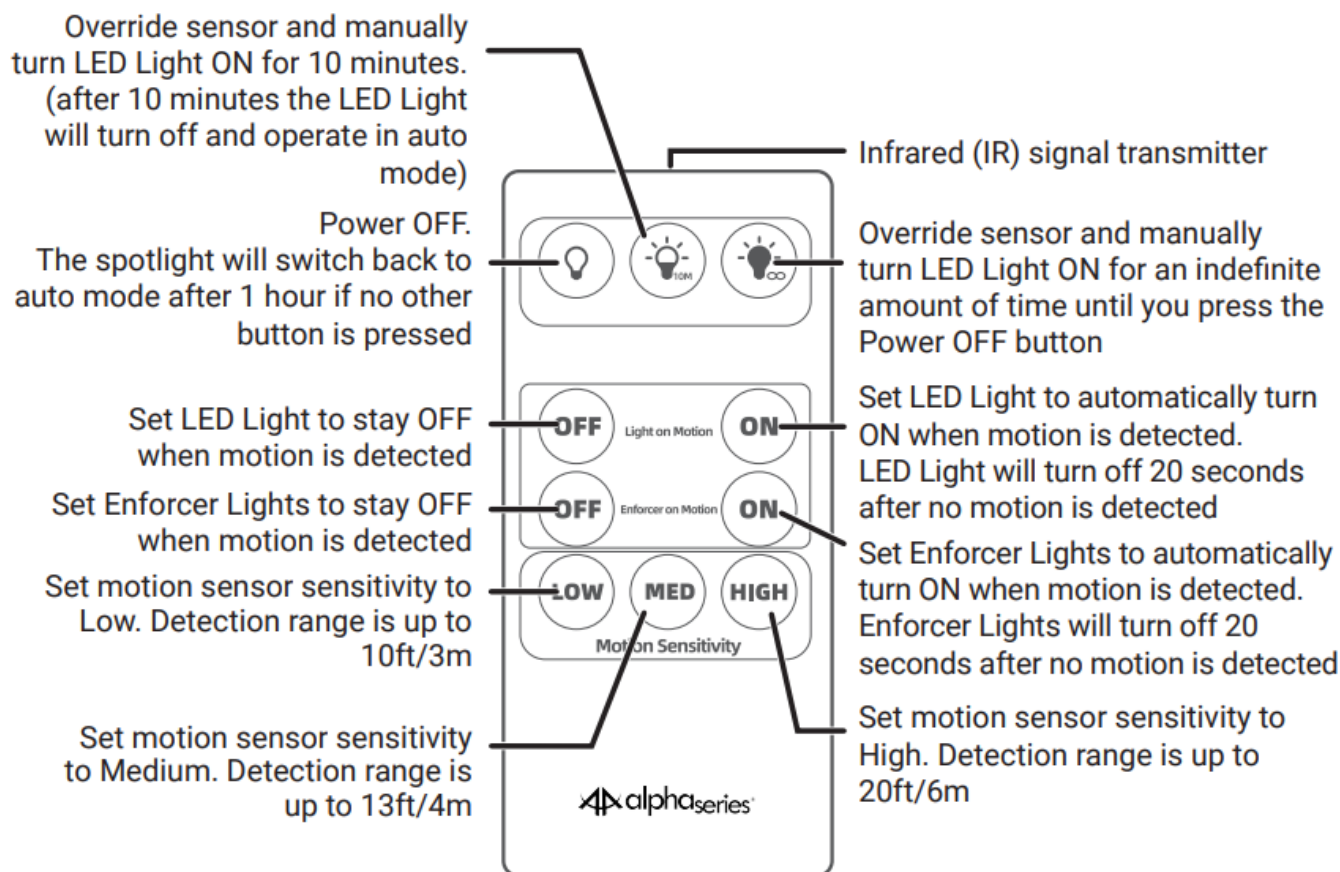

Keeping the LED Light on continuously for prolonged periods of time will significantly shorten battery lifespan and reduce operating time.

BATTERY INSTALLATION

Spotlight

The spotlight requires four D size batteries (not supplied). For reliable, long-lasting performance, use only high quality alkaline batteries. To install batteries:

1. Turn the front cover of the spotlight counter-clockwise to the unlock position ▲ (see Figure 1) to release and remove the cover.
2. Insert batteries according to the polarity markings (+ and -) indicated inside the battery compartment (see Figure 2).
3. Align the ▲ marks then turn the front cover clockwise to the lock position ▤ to secure the battery compartment (see Figure 3).

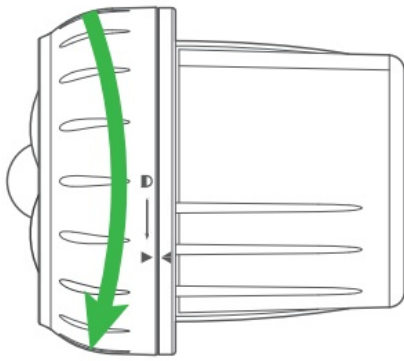

Figure 1

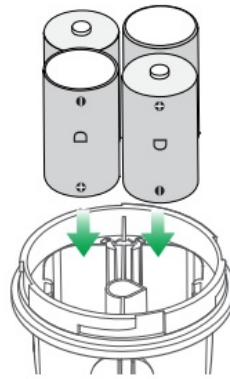

Figure 2

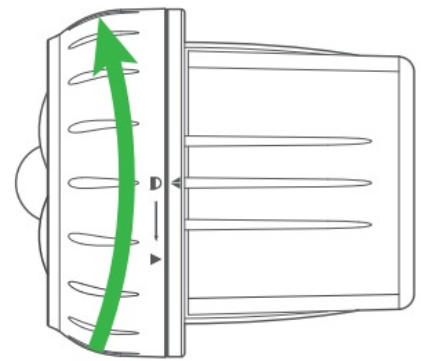

Figure 3

Remote Control



WARNING! This product contains a button/coin cell battery. If the button/coin cell battery is swallowed, it can cause internal chemical burns in as little as two hours and lead to death. Dispose of used batteries immediately. Keep new and used batteries away from children. If the battery compartment does not close securely, stop using the product. If you think batteries might have been swallowed or placed inside any part of the body, seek immediate medical attention.

Australia: If you think batteries might have been swallowed or placed inside any part of the body, immediately call the 24-hour Poisons Information Centre on 13 11 26 for fast, expert advice and go straight to the nearest hospital emergency room.

The remote control is powered by a CR2025 battery which comes pre-installed.

- To activate the battery, simply pull the plastic film out from the bottom of the remote control.
- To replace the battery, remove the locking screw on the back of the remote control using a small Phillips screwdriver, then push the tab on the left of the battery tray towards the right and pull out the battery tray from the remote control (see Figure 4). Place a new “CR2025” battery on the tray with the positive (+) side facing up. Insert the tray back into the remote control and secure with the locking screw.

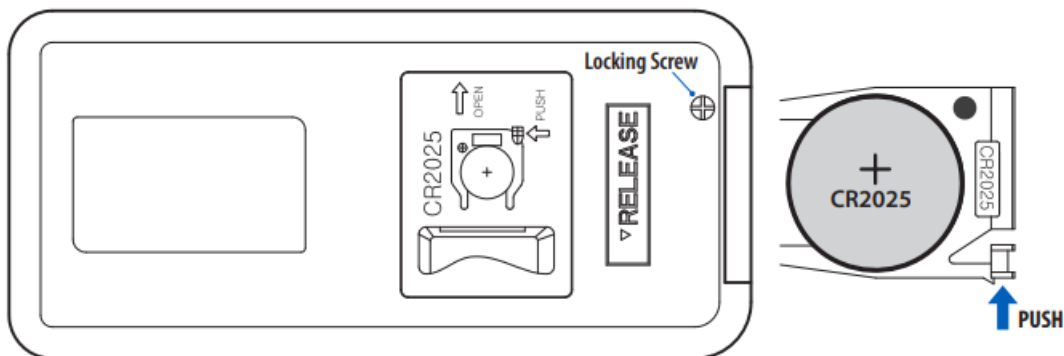







Figure 4

USING THE REMOTE CONTROL

- Point the remote control in the direction of the spotlight to operate it. Ensure the distance is within 5 meters/16 ft and there is no obstruction between the remote control and the spotlight.
- If you have more than one spotlight unit in the vicinity, the remote control should be pointed, as close as

possible, to the spotlight you want to operate. This will prevent other spotlights from receiving unwanted IR signals. IR signals emitted by the remote control may interfere with the operation of other nearby electronic devices.

- When pressing any button on the remote control, the spotlight will flash the red Enforcer LED light once to confirm it has received the command.
- If you set both “Light on Motion” and “Enforcer on Motion” to , the spotlight will temporarily stop detecting motion for 1 hour. After 1 hour, the spotlight will revert to automatic mode (i.e., spotlight will activate when motion is detected). You can reenable the motion sensor at any time by pressing the “Light on Motion”  button.
- If you want the spotlight to activate only the red and blue Enforcer lights when motion is detected, perform the steps below in the following order:
 1. Press the “Light on Motion”  button.
 2. Press the “Enforcer on Motion”  button.
 3. Press the “Light on Motion”  button.

PAIRING WITH THE INDOOR ALARM RECEIVER

You can pair the spotlight with your existing Indoor Alarm Receiver to get sound alerts when motion is detected.

1. Turn the front cover of the spotlight counter-clockwise to the unlock position  (see Figure 1 on previous page) so it is no longer powered. Leave the batteries inside the battery compartment.
2. Decide which Sensor Channel (1, 2 or 3) you want to assign to the spotlight, then press and hold the desired Sensor Channel Number button on the side of the Indoor Alarm Receiver until the corresponding Sensor Channel LED indicator lights up and a beep is heard.

The Indoor Alarm Receiver is now in pairing mode.

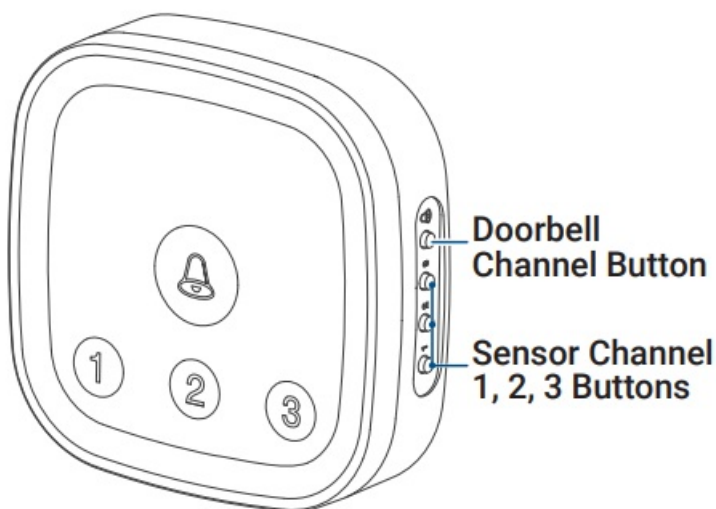

3. Within 25 seconds, power up the spotlight by turning the front cover clockwise to the lock position  to secure the battery compartment (see Figure 3 on previous page). The Sensor Channel melody sounds with the corresponding Sensor Channel LED indicator blinking on the Indoor Alarm Receiver to confirm successful pairing.
4. If pairing is not completed within 25 seconds, the Sensor Channel LED indicator goes off and the Indoor Alarm

Receiver is no longer in pairing mode. Repeat steps above to pair the spotlight again.

TIP: For more information on operating the Indoor Alarm Receiver such as adjusting the volume, refer to the instruction manual that came with your alarm system.

MOUNTING THE SPOTLIGHT

- The spotlight can be deployed outdoors, for example near the entry to your driveway or garage, or mount it near a likely access point such as the front door/ entrance to your home or business.
- For optimal coverage, mount the spotlight approximately 2 meters/6.5 ft above the ground, pointing slightly downwards at an angle where the most likely approach path of visitors and vehicles is across the front of the spotlight. Motion detection is less effective when movement is directly towards or away from the front of the spotlight (see Figure 5).
- You can adjust the detection range of the spotlight using the Motion Sensitivity – Low/Med/High buttons on the remote control. In general, the higher the Motion Sensitivity setting, the greater the possibility of false triggering. To reduce false triggering, choose a lower Motion Sensitivity setting.

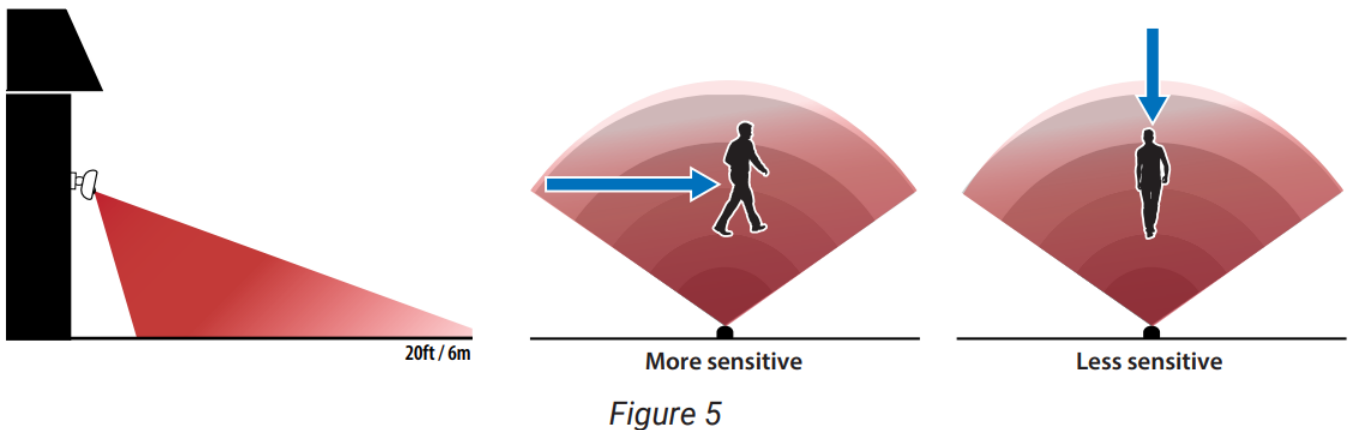

To mount the spotlight (see Figure 6):

1. Remove the mounting base from the stem by turning the thumb screw A counterclockwise.
2. Attach the mounting base to the mounting surface using the supplied screws (if mounting on drywall/masonry, install wall anchors first).
3. Insert the stem back into the mounting base and turn the thumbscrew A clockwise until it is secured tightly.
4. To adjust the angle of the spotlight, loosen the knuckle screw B . Aim the spotlight in the desired direction then tighten the knuckle screw B to hold it in place.

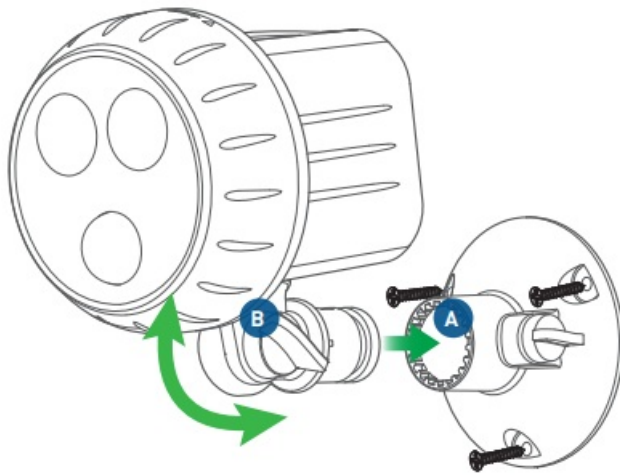

Figure 6

LIMITED WARRANTY TERMS & CONDITIONS

Swann Communications warrants this product against defects in workmanship and material for a period of one (1) year from its original purchase date. You must present your receipt as proof of date of purchase for warranty validation. Any unit which proves defective during the stated period will be repaired without charge for parts or labour or replaced at the sole discretion of Swann. The end user is responsible for all freight charges incurred to send the product to Swann's repair centres. The end user is responsible for all shipping costs incurred when shipping from and to any country other than the country of origin.

The warranty does not cover any incidental, accidental or consequential damages arising from the use of or the inability to use this product. Any costs associated with the fitting or removal of this product by a tradesman or other person or any other costs associated with its use are the responsibility of the end user. This warranty applies to the original purchaser of the product only and is not transferable to any third party.

Unauthorized end user or third party modifications to any component or evidence of misuse or abuse of the device will render all warranties void.

By law some countries do not allow limitations on certain exclusions in this warranty.

Where applicable by local laws, regulations and legal rights will take precedence.

Have Questions?

We are here to help! Visit us at

<http://support.swann.com>. You can also email us at

any time via: tech@swann.com

FCC Statement

This equipment has been tested and found to comply with the limits for Class B digital device, pursuant to part 15 of the FCC Rules. These limits are designed to provide reasonable protection against harmful interference in a residential installation. This equipment generates, uses and can radiate radio frequency energy and, if not installed and used in accordance with the instructions, may cause harmful interference to radio communications. However, there is no guarantee that interference will not occur in a particular installation. If this equipment does cause harmful interference to radio or television reception, which can be determined by turning the equipment off and on, the user is encouraged to try to correct the interference by one or more of the following measures:

- Reorient or relocate the receiving antenna.
- Increase the separation between the equipment and the receiver.
- Connect the equipment into an outlet on a circuit different from that to which the receiver is connected.
- Consult the dealer or an experienced radio/TV technician for help.

Battery Safety Information

- Install only new batteries of the same type in your product.
- Failure to insert batteries in the correct polarity, as indicated in the battery compartment, may shorten the life of the batteries or cause batteries to leak.
- Do not mix old and new batteries.
- Do not mix alkaline, standard (Carbon-Zinc), rechargeable (Nickel Cadmium/Nickel Metal Hydride) or lithium batteries.
- Batteries should be recycled or disposed of as per state and local guidelines.

This device complies with Part 15 of the FCC Rules.
 Operation is subject to the following two conditions:

1. This device may not cause harmful interference, and
2. This device must accept any interference received, including interference that may cause undesired operation.

This device complies with Industry Canada licence-exempt RSS standard(S).
 Operation is subject to the following two conditions

1. this device may not cause interference, and
2. this device must accept any interference, including interference that may cause undesired operation of the device.

Documents / Resources

	<p>alpha series Add-on Wireless Motion Sensor Spotlight with Remote Control [pdf] Instruction Manual</p> <p>B400G2W, VMIB400G2W, Add-on Wireless Motion Sensor Spotlight with Remote Control, Add-on Wireless Sensor, Motion Sensor Spotlight with Remote Control, Sensor Spotlight, Spotlight Remote Control, Remote Control</p>
---	---