



ALOGIC MX2 USB-C Dual Display Dock User Guide

[Home](#) » [ALOGIC](#) » ALOGIC MX2 USB-C Dual Display Dock User Guide 

ALOGIC MX2 USB-C Dual Display Dock User Guide



Contents

- [1 Package Content](#)
- [2 Description](#)
- [3 Specifications](#)
- [4 Instructions](#)
- [5 Resolution Support Table](#)
- [6 USB-C Port Video and Charging Support](#)
- [7 Troubleshooting](#)
- [8 FCC Compliance Statement](#)
- [9 Documents / Resources](#)
- [10 Related Posts](#)

Package Content

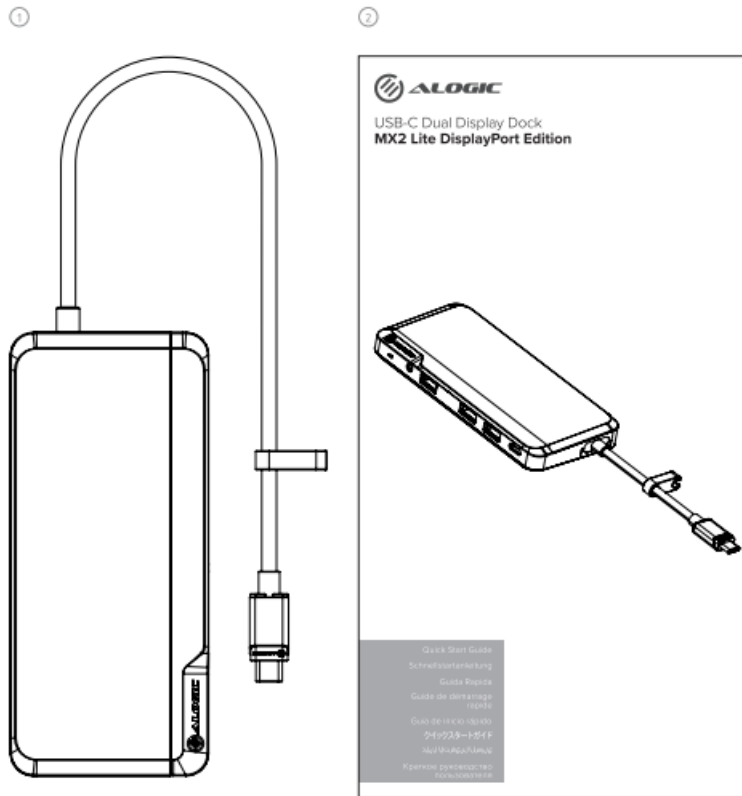

1. USB-C Dual DisplayPort Docking Station -9 in 1
2. User Manual

Description

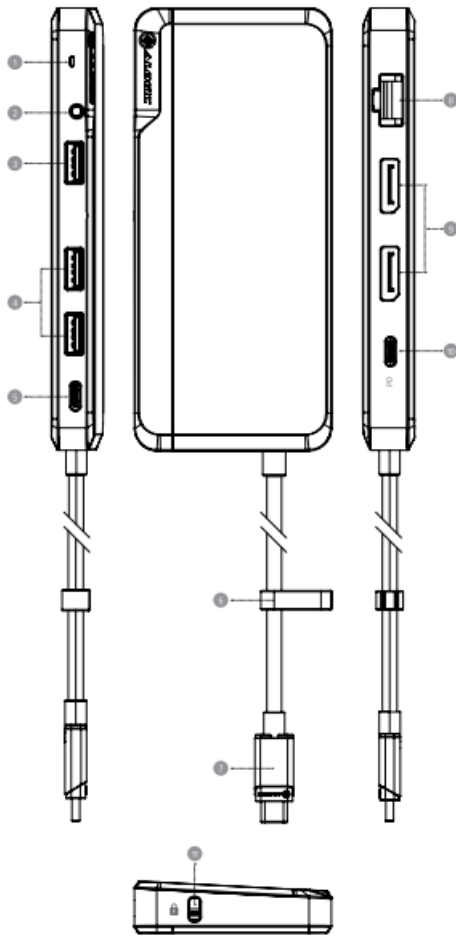

1. LED Indicator
2. Audio/Microphone Jack
3. USB-A with 7.5W Charging
4. USB-A with 4.5W Charging
5. USB-A Port (Data + Power Delivery)
6. Cable Holder
7. USB-C Connector (to computer)
8. Gigabit Ethernet
9. DisplayPort Video (to Monitor)
10. USB-C Port (Data + Power Delivery)
11. Security Lock Slots

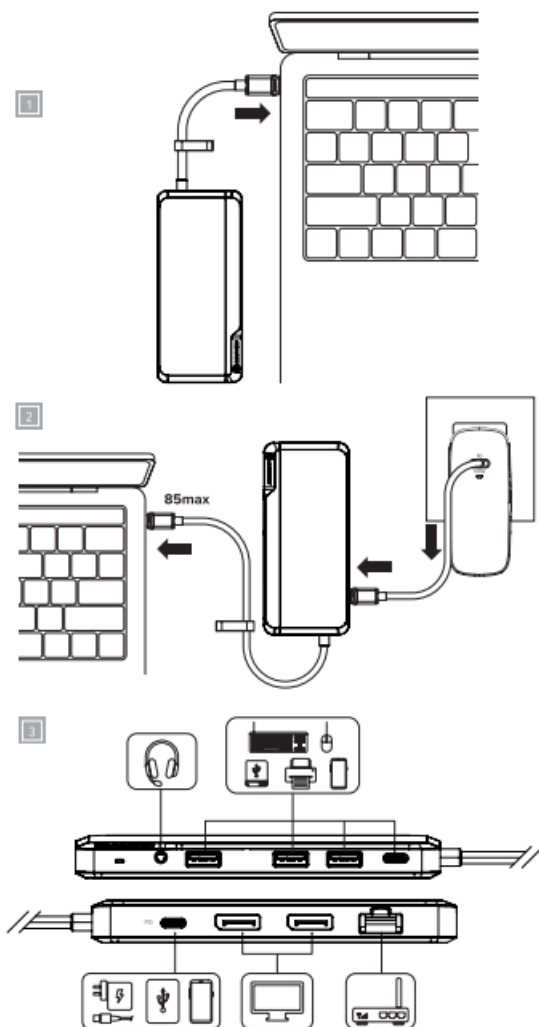

Specifications

Model

U1CAD-SGR

Dimensions

139 x 62 x 16.32mm (L x W x H)

Weight

138g

Output

1 2x DisplayPort
1 x Gigabit Ethernet
3x USB-A (USB 3.2Gen 1)
2x USB-C (85W Power Delivery & USB 3.2Gen 1 Data)
1 x 3.5mm Audio Jack

Input

1 x USB-C Male

Data Rate

5Gbps

Power

Bus powered from host

Supports USB PD 3.0 Power Delivery passthrough from an external power adapter (optional) up to 85W

Power

Video Resolution

Single Display 1920×1080:460Hz

Dual Display 1920x108060Hz

Device Compatibility

Compatible with Windows computers with a USB-C or Thunderbolt 3/4 port which supports video output.

Compliance

CE, FC

DE CE, FCC CE, FCC FR CE, FCC CE; FCC JP CE, FCC CE, FCC RU CE, FCC CE, FCC

Warranty

2 Year

Thank you for purchasing this quality ALOGIC product. ALOGIC USB-C Dual 4K DisplayPort Docking Station —9 in 1 is a next generation mobile dock designed to turn your notebook into a portable workstation.

Instructions

(Refer to the images on the previous pages)

1. Connecting the Dock to the Laptop

Connect the USB-C cable attached to the dock to your computer. The device is Plug and Play compatible and will be detected and configured by your computer automatically. This process will take a few seconds the first time you plug the device into your laptop. You may receive a notification that it has been installed and is ready for use.

Once the device has been recognised and set up by your computer you can connect other devices as desired such as monitors, USB devices and a network cable.

2. Connecting a Power Adapter (Optional)

When the dock is connected to a computer that supports charging using USB Power Delivery (USB PD) it can pass up to 85W of power from an external power adapter (not included) to charge the computer. To charge the laptop through the dock, connect a USB-C PD power adapter to the USB-C port On the end of the dock and connect the power adapter to a mains power outlet.

3. Connecting Devices to the Dock

Connect external devices such as monitors, USB devices, Ethernet network cable and headphone/mic to the dock, as necessary. Refer to Page 4 and 5 of these instructions for an outline of the available ports and their functions.

Resolution Support Table

The quantity and resolutions of video outputs supported depend on the capability of the connected computer.

This table provides the maximum output resolutions available for Windows computers based on the version of DisplayPort Alternate Mode supported on their USB-C ports.

Single Display	Dual Display
DisplayPort 1- FHD (1920×1080)@60Hz	2 x FHD (1920×1080)(460Hz)
DisplayPort 2 – FHD (1920×1080)@60Hz	

USB-C Port Video and Charging Support

Not all USB-C ports on laptops support video output and/or charging using USB PD. Many Windows computers have multiple USB-C ports, but only support video output and charging on one or two of them.

If using a Windows machine it is important to ensure that you plug the device into a port which supports video output for it to be able to show video on external monitors. If you usually use a particular USB-C port to connect your laptop's USB charger, it is likely that this port also supports video output and we suggest trying the dock with this port.



Many USB-C ports that have no labelling support video output, however USB-C ports which have a DisplayPort logo or Intel Thunderbolt logo printed next to them almost certainly support video output and you should look for these icons next to the ports on your computer.

If in doubt about whether a USB-C port supports video output, consult the user manual for your computer or the support information on the manufacturer's website. References made to a USB-C port having DisplayPort, DP or Alt Mode capabilities is a strong indicator that the USB-C port supports video output.

Troubleshooting

Symptom	Solution
Video doesn't show on external display	<p>Check that the cable is connected securely between the monitor and the computer</p> <p>Check that the external monitor is turned on and set to the correct input</p> <p>Check that your computer is detecting the external display and is set to show video on it</p> <p>Check that the USB-C port on the computer that you have connected the cable to supports video output using DisplayPort Alternate Mode</p> <p>If the computer doesn't detect the external monitor or output video after checking the above, restart your computer and attempt again</p>
Video drops out intermittently	<p>Check that the video cable is connected securely between the display and computer and there is no strain on the connectors</p>
Laptop doesn't charge when a USB PD power adapter is connected to the USB-C port on the dock	<p>Check that the USB PD power adapter is plugged in at the wall and switched on</p> <p>Verify that the cable is plugged into a USB-C port on the computer which supports USB PD charging by plugging the cable from the power adapter directly into the USB-C port on the laptop</p> <p>Check that the cable between the USB PD power adapter and the dock is connected securely</p> <p>Ensure that the USB PD power adapter has a sufficient power output rating to charge the laptop</p>

Warning

- This device is designed for indoors use only.
- Do not deliberately damage the device or expose it to damp, direct sunlight, or high temperature conditions.
- Disassembling or failing to properly use and care for your device will void the warranty on the product.
- ALOGIC bears no responsibility for damage to the device or incidental damages arising from improper use or lack of care and is not liable for repair/replacement of the device or other damages in these circumstances.

FCC Compliance Statement

This device complies with Part 15 of the FCC Rules. Operation is subject to the following two conditions:

1. this device may not cause harmful interference, and
2. this device must accept any interference received, including interference that may cause undesired operation.

Changes or modifications not expressly approved by the party responsible for compliance could void the user's authority to operate the equipment.

This equipment has been tested and found to comply with the limits for a Class B digital device, pursuant to Part 15 of the FCC Rules. These limits are designed to provide reasonable protection against harmful interference in a residential installation. This equipment generates, uses and can radiate radio frequency energy and, if not installed and used in accordance with the instructions, may cause harmful interference to radio communications. However, there is no guarantee that interference will not occur in a particular installation.

If this equipment does cause harmful interference to radio or television reception, which can be determined by turning the equipment of and on, the user is encouraged to try to correct the interference by one or more of the following measures:

- Reorient or relocate the receiving antenna.
- Increase the separation between the equipment and receiver.
- Connect the equipment into an outlet on a circuit different from that to which the receiver is connected.
- Consult the dealer or an experienced radio/TV technician for help.

Responsible Party – U.S. Contact Information

ALOGIC USA LLC
3730 Parish Ave
Fremont CA 94536 USA

EU Declaration of Conformity

Hereby, ALOGIC Corporation declares that this product is in compliance with Directive 2014/53/EU. The full text of the EU declaration of conformity is available at the following internet address by clicking on the Compliance Documentation link at: www.alogic.co

Documents / Resources

	ALOGIC MX2 USB-C Dual Display Dock [pdf] User Guide MX2 USB-C Dual Display Dock, MX2, USB-C Dual Display Dock, Display Dock, Dock
-------------------------------------------------------------------------------------	------------------------------------------------------------------------------------------------------------------------------------------------------