



ALOGIC LDWAV-SGR USB C Dock Wave 3 In 1 Hub Powerbank and Wireless Charger User Guide

[Home](#) » [ALOGIC](#) » **ALOGIC LDWAV-SGR USB C Dock Wave 3 In 1 Hub Powerbank and Wireless Charger User Guide** 



**USB-C
Dock Wave 3-in-1
USB-C DOCK + POWER BANK + WIRELESS CHARGER**

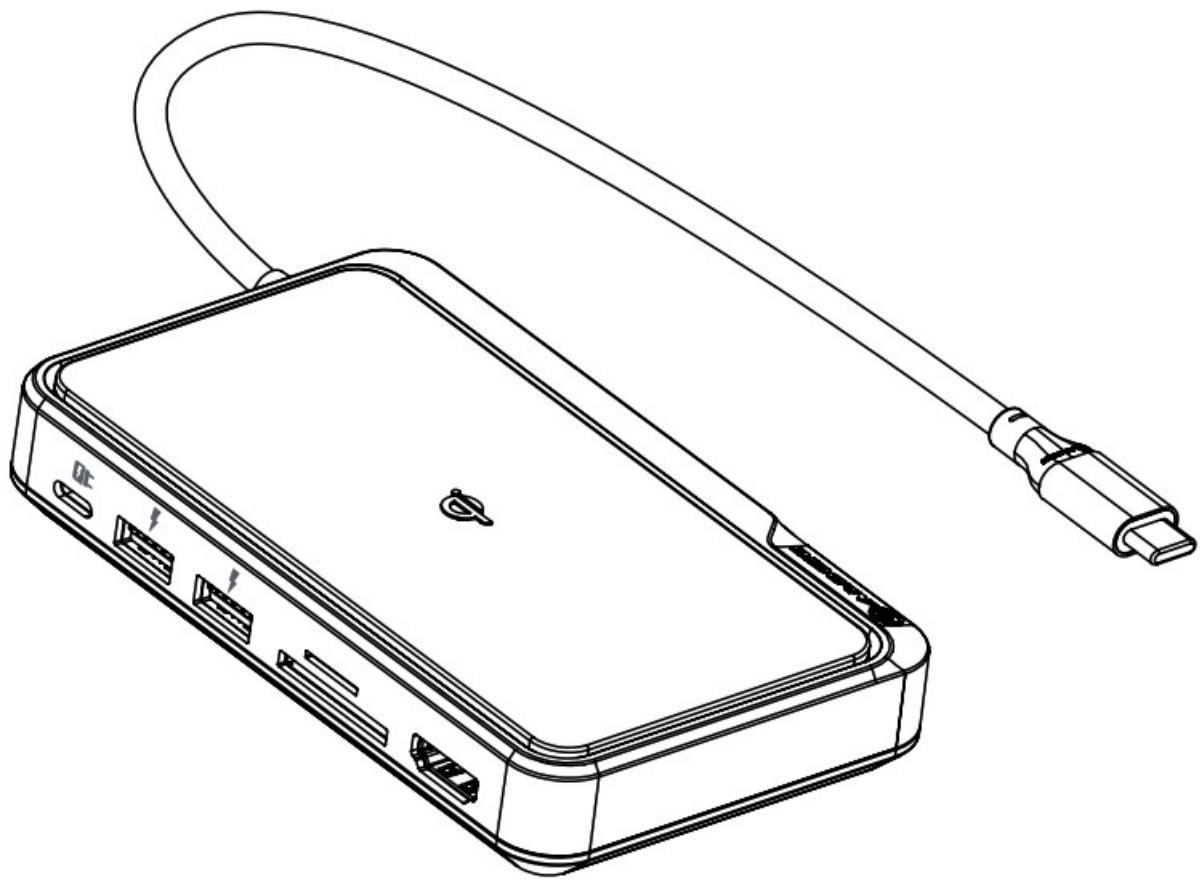

Quick Start Guide

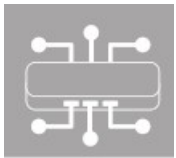

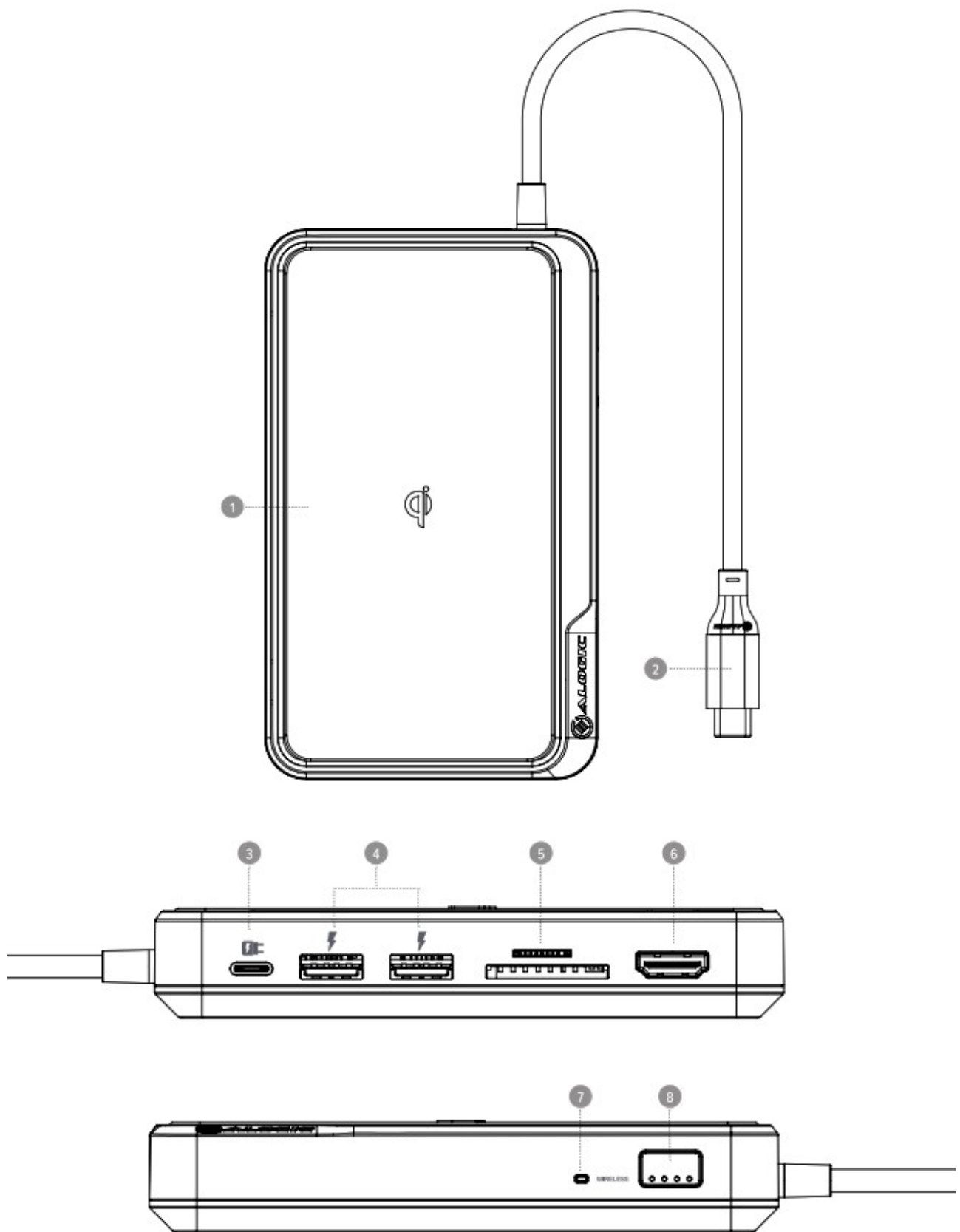

1	Qi Wireless Charging	5	SD & Micro SD Card Slot
2	USB-C Connector	6	HDMI Port
3	USB-C with Power Delivery	7	LED indicators
4	USB-A (USB 3.0) Port	8	Power Button

Contents

- [1 Specifications](#)
- [2 Package Contents](#)
- [3 User Instructions](#)
- [4 Troubleshooting](#)
- [5 FCC Compliance Statement](#)
- [6 Documents / Resources](#)
- [7 Related Posts](#)



Specifications

Model	ULDWAV-SGR
Dimension	125 x 70 x 20.5mm (Lx Wx H)
Weight	300g
Output	1x 4K HDMI 1x SD and Micro SD card reader 1x USB-C with 60W Power Delivery
Input	USB-C 3.2 Gen 15 Gps
Power	USB-C power adapter (not included – 60W or greater recommended). Supports up to 60W USB Power Delivery pass-through.
Battery Capacity	5000mAh
Video Resolution	4L@30Hz
Device Compatibility	Compatible with Windows, Mac and Chromebook-based machines
Compliance	CE, FCC
Warranty	2 Years



Package Contents

①

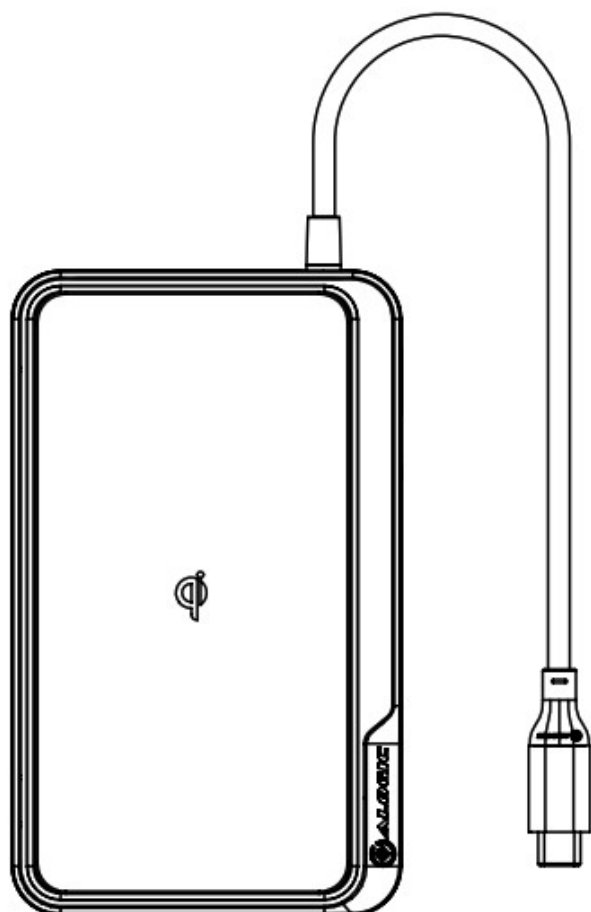

②

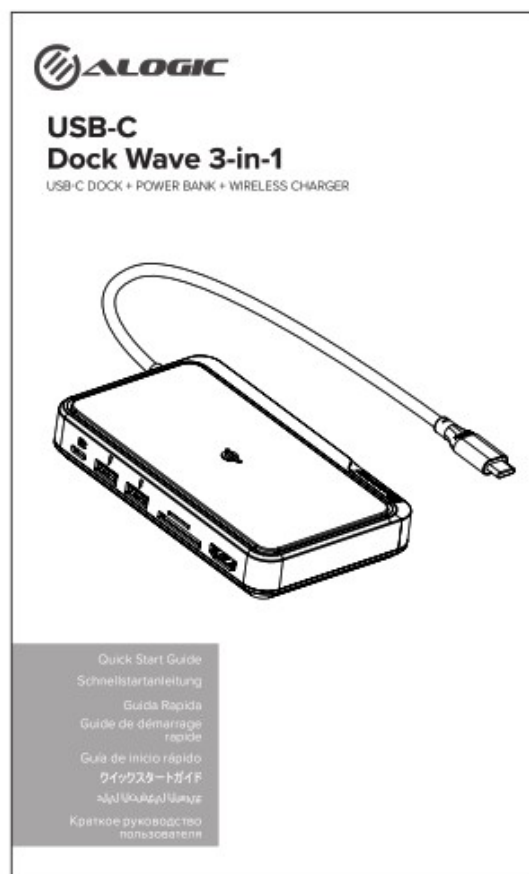

1. USB-C Dock Wave

2. User Manual



User Instructions

Thank you for purchasing this quality ALOGIC product. Please take the time to read these instructions to make sure you get the most from the device.

The ALOGIC Dock Wave is the first device of its kind, combining a USB-C docking station, power bank, and wireless charging pad for mobile devices.

The Dock Wave has been designed to be a versatile device for people on-the-go who need a compact, portable, and all-in-one solution to support their computing needs on the move.

Charging the Power Bank

When no power source is connected to the device, pressing the button **8** on the power bank briefly will cause the lights on the button to illuminate showing the charge level of the power bank in 25% increments.

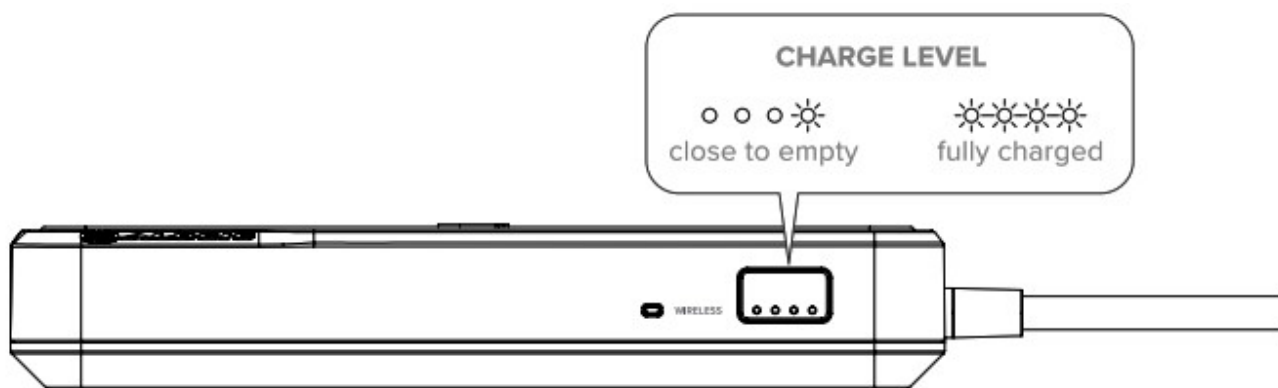

To charge the power bank, connect a USB power source to the USB-C charging port 3 on the device. The lights on the button will flash indicating that the device is charging as well as showing the charge level of the device. When the device is fully charged, the four lights on the button will stop flashing.

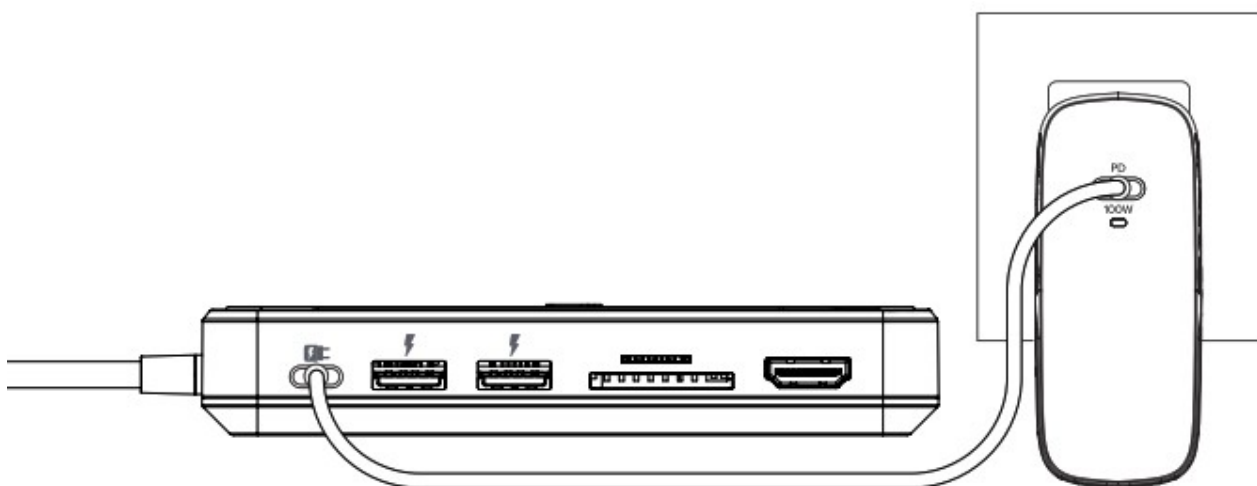

A power adapter is not included with the Dock Wave. USB-C power adapters that support USB Power Delivery (PD) will charge the Dock Wave at a faster rate than older USB power adapters (including power adapters with USB-A outputs). It is recommended that you use a USB-C PD power adapter with an output of 30W or above to charge the device for the fastest charging times.

Note

- The power bank cannot be charged by connecting the USB-C flylead 0 attached to the device to a USB power source. A USB power adapter must be connected to the USB-C input on the rear of the device so for the device to charge.
- The device must be charged in order to act as a power bank and supply power to other devices or act as a wireless charger. The device will not charge other devices when the batteries are flat.

Using the Device as a Docking Station

To use the device as a docking station, connect the flylead 2 on the Dock Wave to a USB-C port on a notebook, tablet or mobile phone. The Dock Wave will be detected as a Plug and Play device and be automatically configured for use — there is no need to install drivers. This process may take a few seconds the first time you connect the device to a USB-C port on the computer.

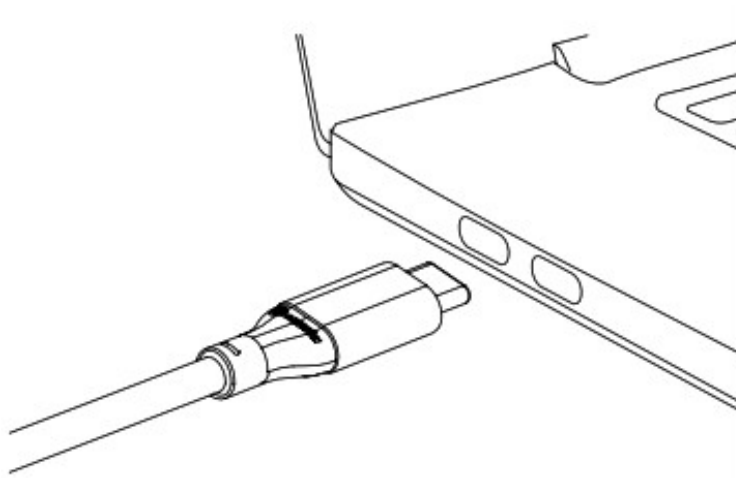

A monitor, memory cards and USB-A peripherals may be connected to the computer via the Dock Wave. The USB-C port on the Dock Wave is only used for charging and does not support data transfer. To use USB-C peripherals with the host computer, connect them to one of the USB-A ports on the Dock Wave using a USB-C to USB-A adapter or cable. The dock portion of the device receives power from the host computer and can operate even when the onboard power bank is flat.

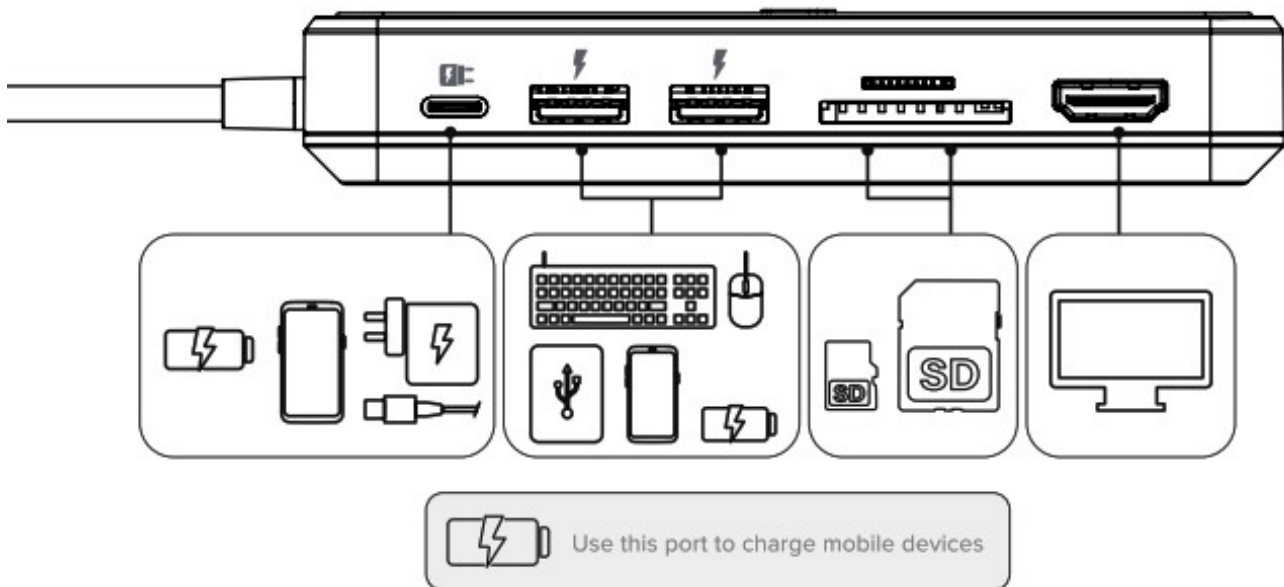

It is safe to connect the Dock Wave to a computer to use as a dock while the Dock Wave is being recharged. While a USB PD power adapter is connected to the Dock Wave, the Dock Wave can also provide up to 60W of power to the computer at the same time it is recharging (dependent on the output capacity of the power adapter). To power your laptop through the Dock Wave, ensure that you use a USB PD power adapter which has the same or higher Wattage as the power adapter that came with your laptop.

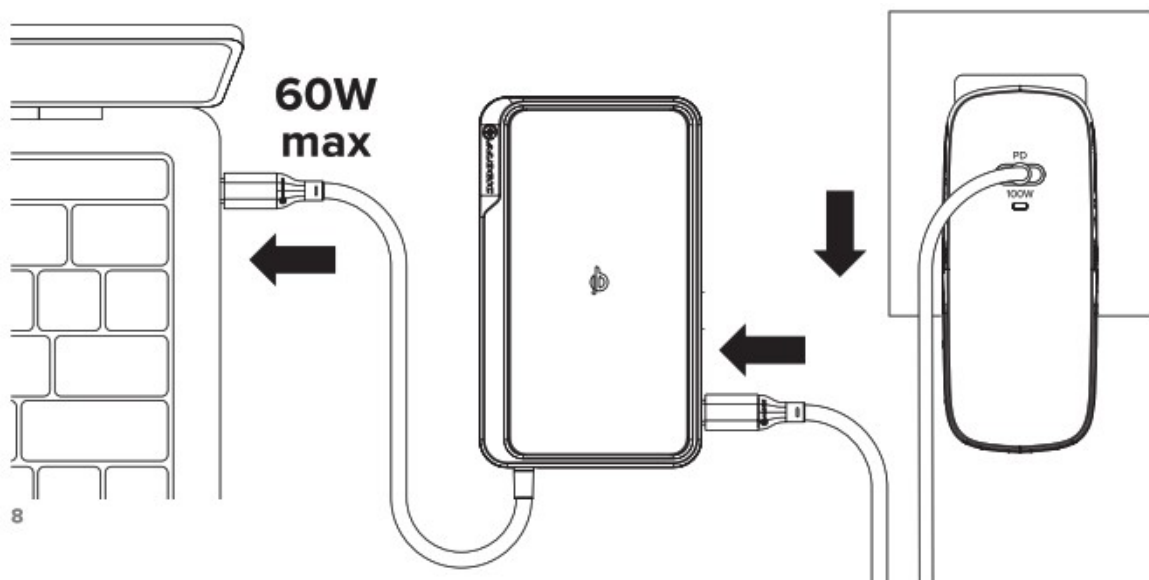

USB-C Port Video and Charging Support

Not all USB-C ports on laptops support video output and/or charging using USB PD. Many Windows and Chromebook computers have multiple USB-C ports, but only support video output and charging on one or two of them.

If using a Windows or Chromebook machine it is important to ensure that you plug the device into a port which supports video output for it to be able to show video on external monitors. If you usually use a particular USB-C port to connect your laptop's USB charger, it is likely that this port also supports video output and we suggest trying the cable with this port.

Many USB-C ports that have no labelling support video output, however USB-C ports which have a DisplayPort logo or Intel Thunderbolt logo printed next to them almost certainly support video output and you should look for these icons next to the ports on your computer.

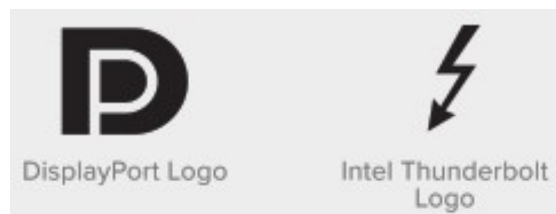

MacBook devices are equipped with Thunderbolt USB-C ports and support video output and charging on all ports. If in doubt about whether a USB-C port supports video output, consult the user manual for your computer or the support information on the manufacturer's website. References made to a USB-C port having DisplayPort, DP or Alt Mode capabilities is a strong indicator that the USB-C port supports video output.

Charging USB Accessories

To charge accessories with USB charging ports such as mobile phones connect them to one of the USB-A ports [4](#) or the USB-C port [3](#) on the rear of the Dock Wave. The Dock Wave will sense that the device is connected to the USB port and turn on the lights on the button to indicate that it is providing power to the device.

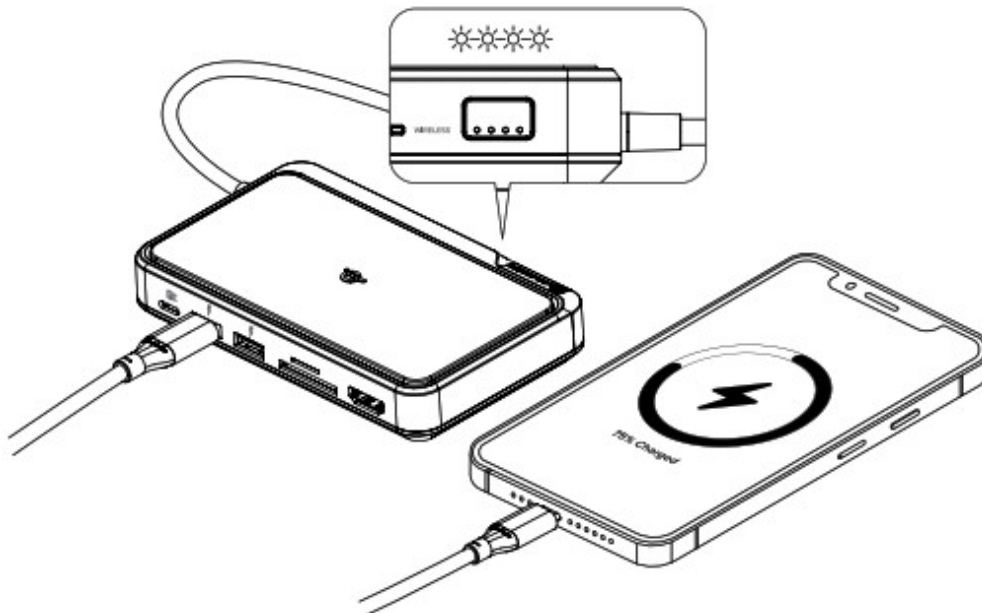

The number of lights lit at any time indicates the level of power remaining in the Dock Wave batteries.



The Dock Wave constantly senses whether a device is connected to one of the USB ports and turns on power when it sees a device connected. Some USB cables include circuitry which would drain power from the power bank if left connected without a device to charge on the other end. To conserve power, the Dock Wave will shut down USB ports which have a cable attached which is draining power after around 1 minute and won't be able to sense if a device is eventually connected to the other end. If you plug a mobile device into a cable which is plugged into the Dock Wave and it doesn't start charging, simply unplug and reconnect the cable from the USB port on the Dock Wave to reset the port and start charging. This behavior is common to many power banks and ensures that the power bank isn't drained when it isn't actually in use and has power and is ready to use when you need it.

Note

The USB-C flylead attached to Dock Wave is only used to connect the Dock Wave to a computer as a docking station. You cannot use the flylead to charge a device from the power bank. To charge a USB device from the Dock Wave, ensure that you connect the device to one of the USB ports on the rear of the device using a suitable cable.

Charging Wireless Devices

The fabric top surface of the Dock Wave is a wireless charging pad ¹ which can charge mobile devices that support the Qi wireless charging standard. Many recent devices such as mobile phones and wireless earphone charging cases support Qi wireless charging. If in doubt as to whether your devices support the Qi standard please check the manufacturer documentation for the devices.

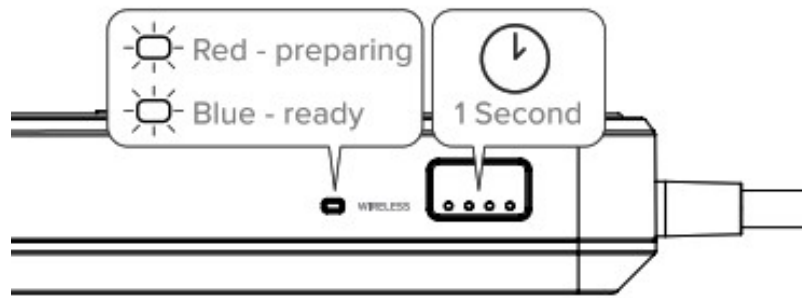

To turn on wireless charging connect a USB power source to the USB-C charging port 6 or press and hold the button on the device for one second. The wireless indicator will illuminate red to indicate that wireless charging is being prepared and then turn blue to show that the device is ready to charge a device wirelessly.



To initiate charging place your device on the wireless charging pad, centring the device on the Qi logo printed on the charging pad. When the accessory device is correctly positioned, the wireless charging indicator will begin to “breathe” to show that the Dock Wave has sensed the device and has started charging it wirelessly.

If the Dock Wave is running on batteries and is unable to communicate with a mobile device wirelessly within 2 minutes it will shut down wireless charging to conserve power. Press the button again if you need to reinitiate wireless charging. Wireless charging is always active when a power adapter is connected to the Dock Wave.

It is normal for the Dock Wave and mobile device to warm up slightly while charging. Some situations, such as using phone cases with foil imprints or metal being detected in the charging area, will cause more heat build-up. If the Dock Wave senses high temperatures or metal in the charging region wireless charging will be shut down and the wireless charging indicator will change from blue to red to indicate there is a problem. Wireless charging can be restarted by removing the mobile device from the charging pad, allowing the device and the Dock Wave to cool down if necessary, and placing the mobile device back on the charging pad.

Note

- It is important to correctly align the wireless charging receiving coil on the mobile device with the Qi logo on the charging pad. The receiving coil in the mobile device may not be in the centre of the housing — you may need to adjust the position of the device until charging commences to determine where the receiver is located in the device.
- Wireless charging only works over a very short distance. Some bulky phone cases may place the phone too far away from the charging surface and cause charging to be unreliable. If this occurs you may need to remove the phone from its case or use a slimmer case.

Troubleshooting

Symptom	Solution
Dock Wave isn't detected when plugged into a computer for use as a dock	<ul style="list-style-type: none"> • Ensure that you have plugged the flylead attached to the Dock Wave into a USB-C port on the computer. The Dock Wave cannot be connected to a computer by plugging a USB-C cable into the charging port on the rear of the device. • Try plugging into a different port on your computer and restarting the computer
Video doesn't show on external display when using the Dock Wave as a dock	<ul style="list-style-type: none"> • Check that the cable is connected securely between the device and the monitor • Check that the external monitor is turned on and set to the correct input • Check that your computer is detecting the external display and is set to show video on it • Check that the USB-C port on the computer that you have connected the cable to supports video output using DisplayPort Alternate Mode • If the computer doesn't detect the external monitor or output video after checking the above, restart your computer and attempt again
Video drops out intermittently	<ul style="list-style-type: none"> • Check that the video cable is connected securely between the display and computer and there is no strain on the connectors
Laptop doesn't charge when a USB PD power adapter is connected to the Dock Wave	<ul style="list-style-type: none"> • Check that the USB PD power adapter is plugged in at the wall and switched on • Verify that the Dock Wave flyleaf is plugged into a USB-C port on the computer which supports USB PD charging by plugging the cable from the power adapter directly into the same port on the laptop • Ensure that the USB PD power adapter has a sufficient power output rating to charge the laptop
USB device doesn't charge when plugged into a USB port on the Dock Wave	<ul style="list-style-type: none"> • Check that the Dock Wave has sufficient charge • Ensure that the USB device is plugged into a USB port on the rear of the Dock Wave housing, not the flylead permanently attached to Dock Wave • Try unplugging the cable from the Dock Wave port and reconnecting it to reset charging on that port
Wireless charging is unreliable or drops out	<ul style="list-style-type: none"> • Try removing phone from case and placing directly on charging pad
Phone becomes hot while charging	<ul style="list-style-type: none"> • It is normal for the phone to become slightly warm while charging, but the presence of metal in the charging area will cause more heat to build up than normal and should be avoided • High temperatures can cause damage to the phone. If the phone becomes alarmingly hot while charging wirelessly, remove the phone from the charging pad immediately • Don't use phone cases with metal or metal foil printing in the area that is placed on the charging coil to avoid heat building up. Remove the phone from the case when using wireless charging if necessary.

FCC Compliance Statement

This device complies with Part 15 of the FCC Rules. Operation is subject to the following two conditions:

1. this device may not cause harmful interference, and
2. this device must accept any interference received, including interference that may cause undesired operation.

Changes or modifications not expressly approved by the party responsible for compliance could void the user's authority to operate the equipment.

This equipment has been tested and found to comply with the limits for a Class B digital device, pursuant to Part 15 of the FCC Rules. These limits are designed to provide reasonable protection against harmful interference in a residential installation. This equipment generates, uses and can radiate radio frequency energy and, if not installed and used in accordance with the instructions, may cause harmful interference to radio communications. However, there is no guarantee that interference will not occur in a particular installation.

If this equipment does cause harmful interference to radio or television reception, which can be determined by turning the equipment of and on, the user is encouraged to try to correct the interference by one or more of the following measures:

- Reorient or relocate the receiving antenna.
- Increase the separation between the equipment and receiver.
- Connect the equipment into an outlet on a circuit different from that to which the receiver is connected.
- Consult the dealer or an experienced radio/TV technician for help.

Responsible Party – U.S. Contact Information

ALOGIC USA LLC
3730 Parish Ave
Fremont CA 94536 USA

EU Declaration of Conformity

Hereby, ALOGIC Corporation declares that this product is in compliance with Directive 2014/53/EU. The full text of the EU declaration of conformity is available at the following internet address by clicking on the Compliance Documentation link at: www.alogic.co



Designed in Australia. Manufactured in China

Documents / Resources

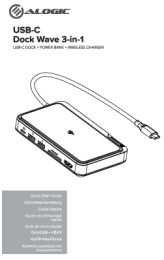
	<p>ALOGIC LDWAV-SGR USB C Dock Wave 3 In 1 Hub Powerbank and Wireless Charger [pdf] User Guide</p> <p>LDWAV-SGR, USB C Dock Wave 3 In 1 Hub Powerbank and Wireless Charger, LDWAV-SGR USB C Dock Wave 3 In 1 Hub Powerbank and Wireless Charger, Dock Wave 3 In 1 Hub Powerbank and Wireless Charger, 3 In 1 Hub Powerbank and Wireless Charger, Powerbank and Wireless Charger, Wireless Charger</p>
---	---