

**ALOGIC**  
**ASKBT3M-US**  
**Echelon Wireless**  
**Keyboard for**  
**MacOS**



# ALOGIC ASKBT3M-US Echelon Wireless Keyboard for MacOS User Manual

[Home](#) » [ALOGIC](#) » ALOGIC ASKBT3M-US Echelon Wireless Keyboard for MacOS User Manual 

## Contents

- [1 ALOGIC ASKBT3M-US Echelon Wireless Keyboard for MacOS](#)
- [2 Product Usage Instructions](#)
- [3 FAQ](#)
- [4 What In The Box](#)
- [5 Package Contents](#)
- [6 Specifications](#)
- [7 Overview](#)
- [8 Connecting via Bluetooth](#)
- [9 Fcc Statement](#)
- [10 Documents / Resources](#)
  - [10.1 References](#)



## ALOGIC ASKBT3M-US Echelon Wireless Keyboard for MacOS



## Product Usage Instructions

- Ensure Bluetooth is turned on on your device.
- Turn on the ALG Keyboard and Mouse by pressing the power button.
- Pair the devices by following the on-screen instructions on your device.
- The ALG Keyboard and Mouse provide a seamless typing and navigation experience. Here are some tips for optimal usage:
- Use the keyboard for typing emails, documents, and other text input tasks.
- Utilize the mouse for precise cursor movements and clicking actions.
- Customize keyboard shortcuts and mouse settings to suit your preferences.

## FAQ

- **Q:** How do I change the batteries in the keyboard and mouse?
- **A:** The ALG Keyboard and Mouse are rechargeable via USB. Simply connect them to a power source using the provided cables.
- **Q:** Can I use the keyboard and mouse with multiple devices?
- **A:** Yes, you can pair the ALG Keyboard and Mouse with multiple devices, but ensure only one device is actively connected at a time.

## What In The Box

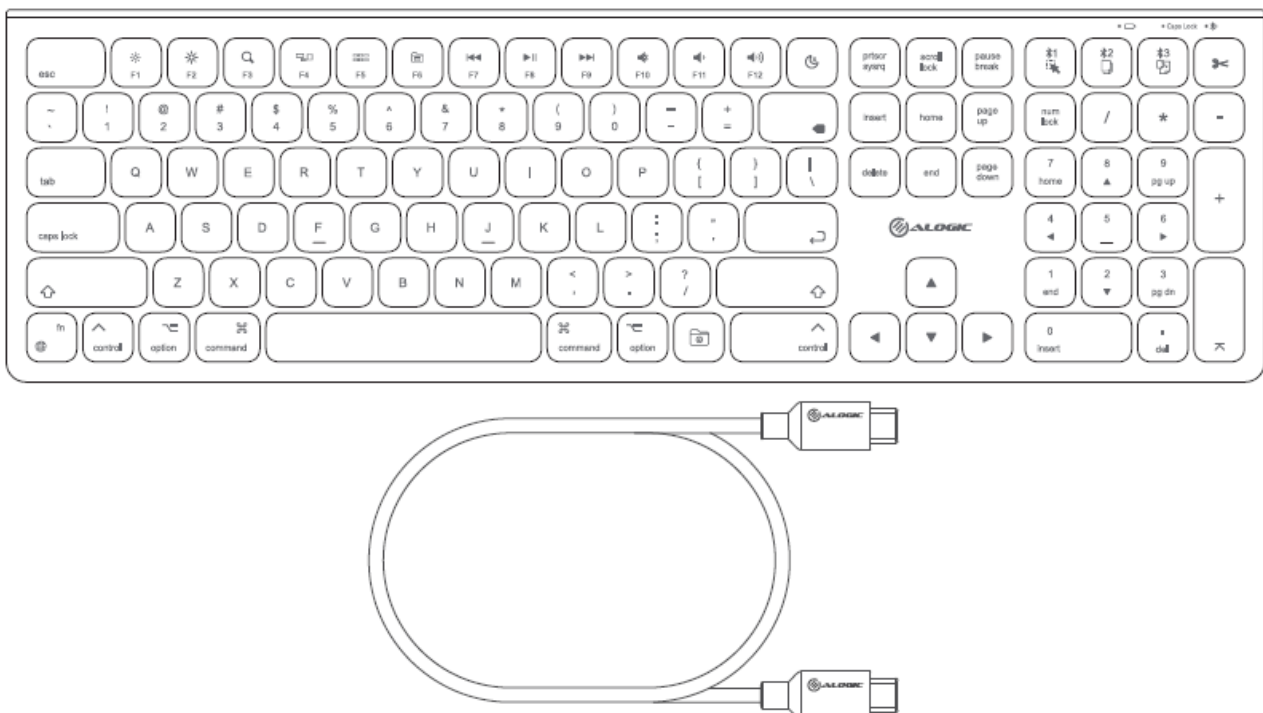

## Package Contents

1. Wireless Keyboard
2. USB-C Charging Cable

## Specifications

- **Model:** ASKBT3M-US (Mac)

- **Device Compatibility:** Windows, macOS, Chromebook, iOS, Android
- **Connection:** Bluetooth (3.0 and 5.0), Max Range: 10m
- **Warranty:** 2 Years



## Overview

### macOS Shortcuts

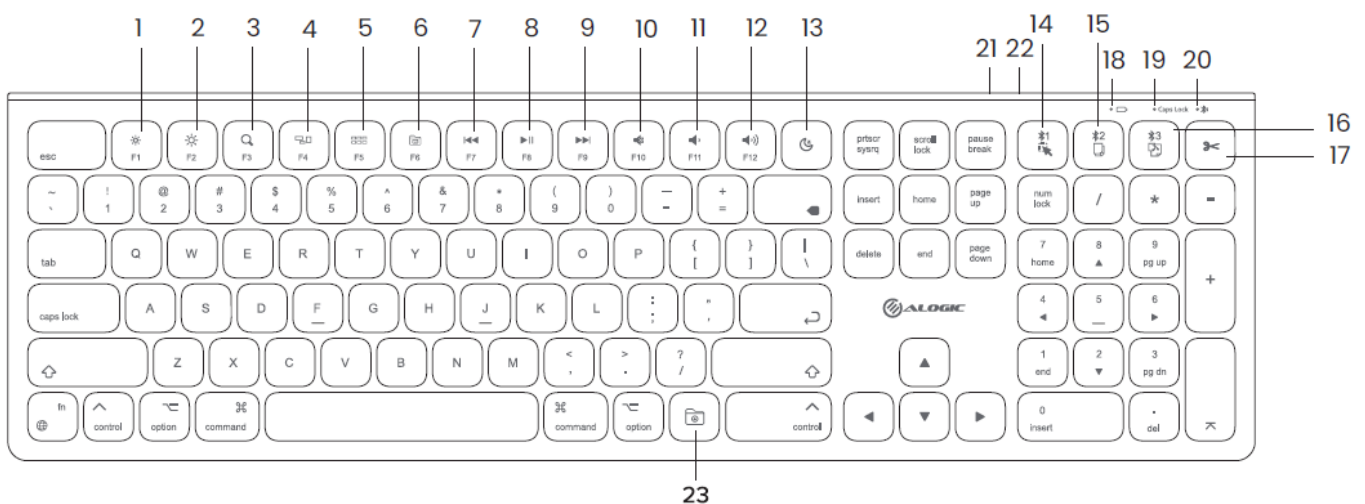
1. Decrease Brightness
2. Increase Brightness
3. Spotlight
4. Mission Control
5. Launchpad
6. Home Folder
7. Previous Track
8. Play/Pause
9. Next Track
10. Mute
11. Volume Down
12. Volume Up
13. Lock/Power Options
14. Select All | 2.4Ghz Connection
15. Copy | Bluetooth 1
16. Paste | Bluetooth 2
17. Cut
18. Battery Indicator
19. Caps Lock Indicator
20. Connection Indicator
21. On/Off Switch
22. Charging Port (USB-C)
23. Download Folders



## Connecting via Bluetooth

1. Press and hold FN + the (  )1 or (  )2 keys until the connection light begins flashing green.
2. From your device's Bluetooth menu, pair with ALG\_KEYBOARD.

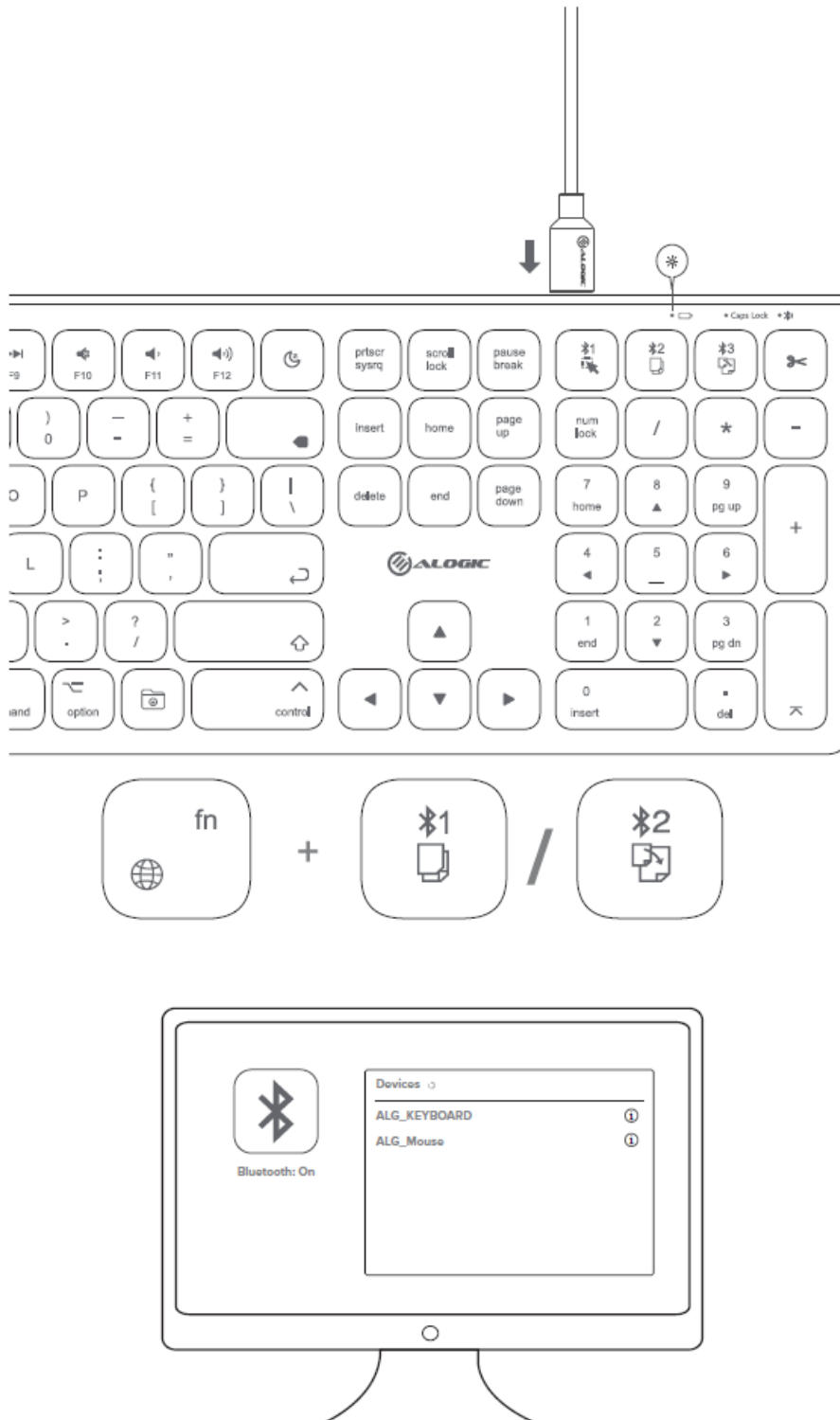

## Fcc Statement

This device complies with Part 15 of the FCC Rules. Operation is subject to the following two conditions:

1. this device may not cause harmful interference, and
2. this device must accept any interference received, including interference that may cause undesired operation.

**NOTE:** Changes or modifications not expressly approved by the party responsible for compliance could void the user's authority to operate the equipment.

Responsible Party – U.S. Contact Information

ALOGIC USA LLC  
37524 Marsten DR  
Newark CA 94560 USA

**EU Declaration of Conformity**

- Hereby, ALOGIC Corporation declares that this product complies with Directive 2014/53/EU.
- The full text of the EU Declaration of Conformity is available at the following internet address by clicking on the Compliance Documentation link: [www.alogic.co](http://www.alogic.co).

Designed in Australia. Manufactured in China

**Documents / Resources**

	<a href="#">ALOGIC ASKBT3M-US Echelon Wireless Keyboard for MacOS</a> [pdf] User Manual ASKBT3M-US Echelon Wireless Keyboard For MacOS, ASKBT3M-US, Echelon Wireless Keyboard For MacOS, Wireless Keyboard For MacOS, Keyboard For MacOS, For MacOS, MacOS
---	---

**References**

- [User Manual](#)

Manuals+, Privacy Policy

This website is an independent publication and is neither affiliated with nor endorsed by any of the trademark owners. The "Bluetooth®" word mark and logos are registered trademarks owned by Bluetooth SIG, Inc. The "Wi-Fi®" word mark and logos are registered trademarks owned by the Wi-Fi Alliance. Any use of these marks on this website does not imply any affiliation with or endorsement.