



## Allflex AWR300 Stick Reader User Guide

[Home](#) » [Allflex](#) » Allflex AWR300 Stick Reader User Guide 



**AWR300 Reader  
Quick Start Up Guide**

## Contents

- 1 Allflex AWR300 Stick Reader
- 2 What is in the Box
- 3 Getting Started
- 4 Initial Configuration
- 5 Device Properties
- 6 Display
- 7 Keypad
- 8 Quick Reading Steps
- 9 Documents / Resources
  - 9.1 References

## Allflex AWR300 Stick Reader

The Allflex AWR250 Stick Reader is a high-quality, economical, yet powerful solution for quickly and reliably reading large numbers of animals' EID tags and managing animal events. It provides outstanding reading performance, long-lasting batteries, robust design, unique data collection features, and extended connectivity options.



## What is in the Box

USB-A Magnetic-Connector Cable

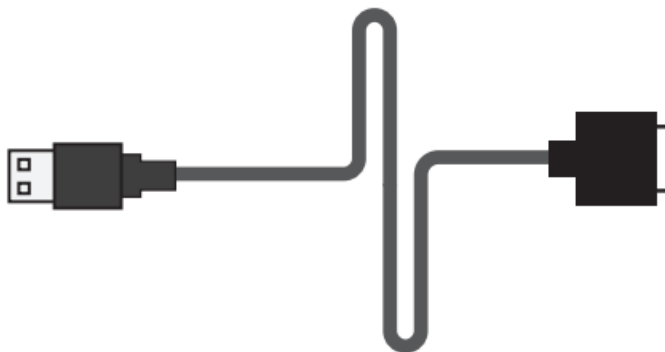

AWR250 Reader device





Introducing Allflex Connect – a universal mobile APP to connect your EID readers with an on-farm management platform, external identification systems, and the Allflex cloud.

With Allflex Connect, you can create and edit customized animal cards and lists, share records with your herd management system, upload data to the cloud for actionable insights, connect your reader to your mobile via Bluetooth, and keep your readers up to date with regular firmware updates.

Downloading the App and pairing it with your reader before first use is recommended.

To download, please visit Google Play or the Apple Store.



## Getting Started

### Battery Charge

The device should be fully charged before the first use

To charge, use the provided Magnetic-USB power source

Connecting the USB cable: The magnetized connectors “find” the proper orientation almost automatically by attracting each other in the appropriate order

Note: DO NOT FORCE a connection to the reader. If it does not insert smoothly, verify that it is correctly oriented.

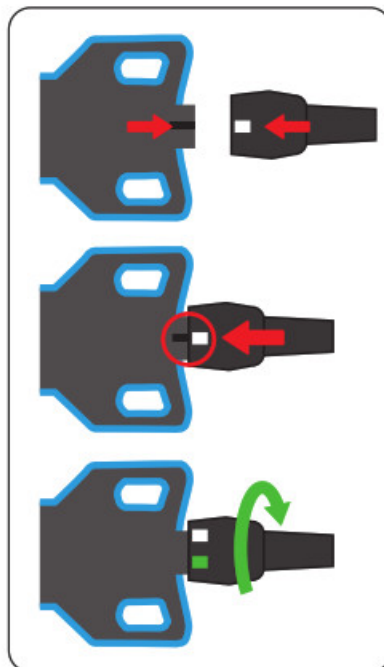

Charging is complete if no bars are flashing anymore

To disconnect, pull the connector away from the device

When charged, the battery info will show the percentage of the battery as well as a rough estimation of operating time

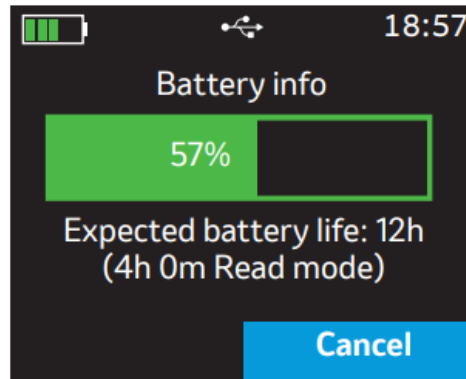

## Initial Configuration

### Set Language:

The default display language will be English at first start-up. You can change the language by accessing Menu>>Setup>>Display>>Set Language. Navigating the options, you can then select your language preference

by pressing ENTER .

**Note:** It is possible to upload up to 29 custom languages. Contact your local distributor for further details.

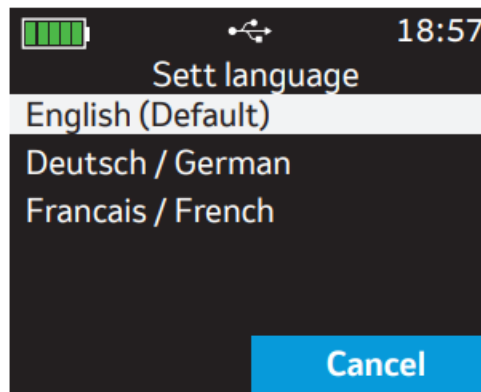

### Set Read mode:

By default, the reader is set to 'Single Read' - one scan click per animal.

Choosing the 'Continuous mode' enables batch reading.

**Note:** The 'Auto' setting starts a Single

Read on a short press of the ENTER  key and Continuous Read mode with a long press (> one second).

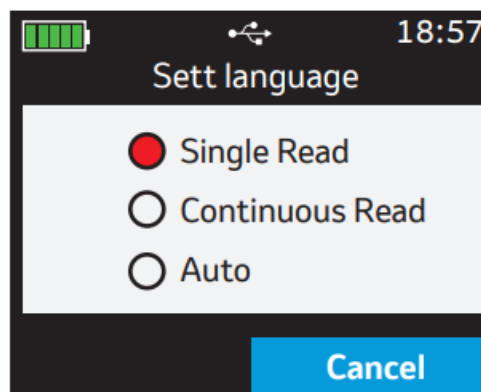

## Device Properties



### Multi-Color Status Led

At the top of the reader, an indication of the read status of the tag

### Multi-Color Status Led

The color changes according to the charging status when the display is switched off

### Blue Status Led

Used to indicate the connection status when the display is switched off



## Display

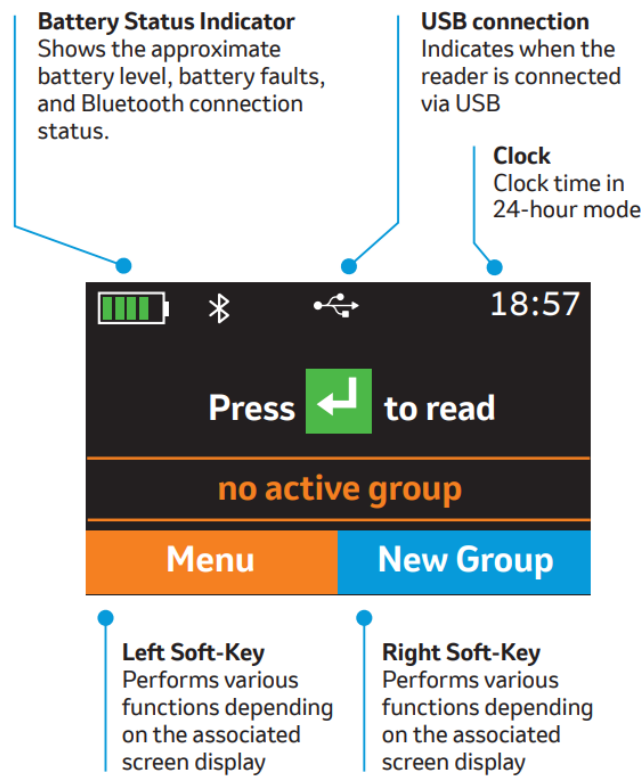

## Keypad

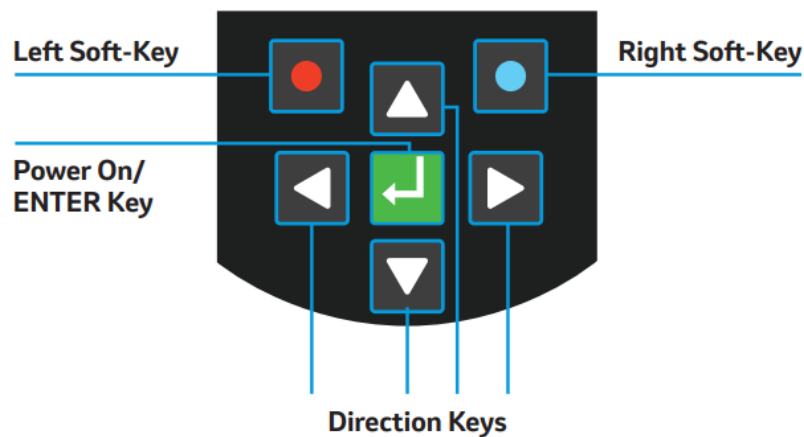

For navigation, scrolling, and character selection in input fields

**NOTE:** Press the down button key for >2 seconds to switch off the device

## Quick Reading Steps

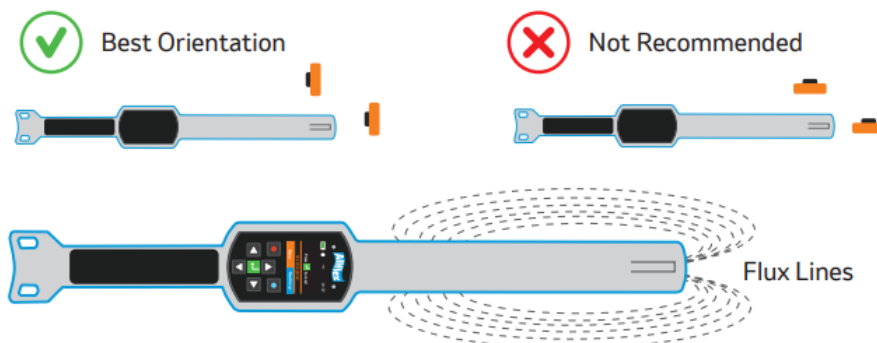





“While a reader is actively scanning for an EID tag, it creates an electromagnetic field. This is what determines a

range and best orientation of a tag for a successful reading”

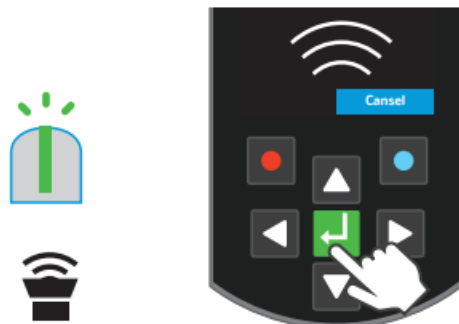
### Reading EID Tags:

1. Press  to Read
2. Scan the EID tag near the field lines of the reader
3. The device's RGB LED signal will turn on, as well as the signalization motors (sound and vibration)



	Flashing slowly RF is activated, ready to read tags
	Flashing fast Tag was successfully read
	Flashing fast Tag has been read repeatedly (duplicate)

4. The tag will be shown on the display screen when successfully read

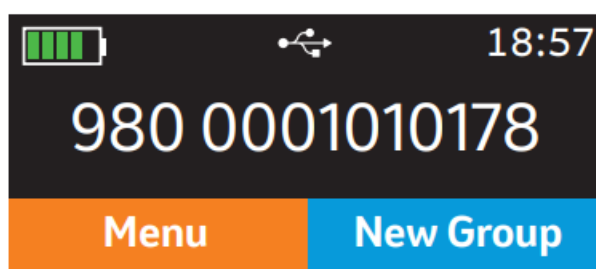

5. A 'No Tag' message will appear on the screen if the reading fails

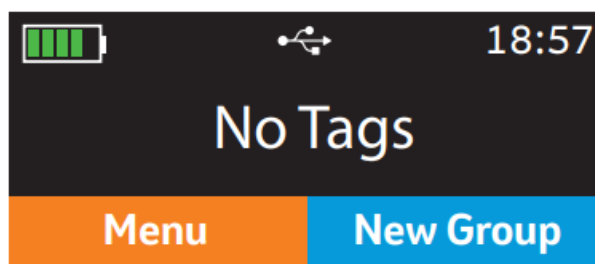

### Assigning Tags:

1. At the home display, press the **New Group** button

2. Insert Group Name using the direction keys to navigate the letters, numbers, or symbols
3. When finished, press **Close** to exit the keyboard, and confirm the name by pressing .
4. To assign tags to the group created, enter the group and start reading.

**NOTE:** After 10.000 records within one group, the device will force the user to create a new group New Group close

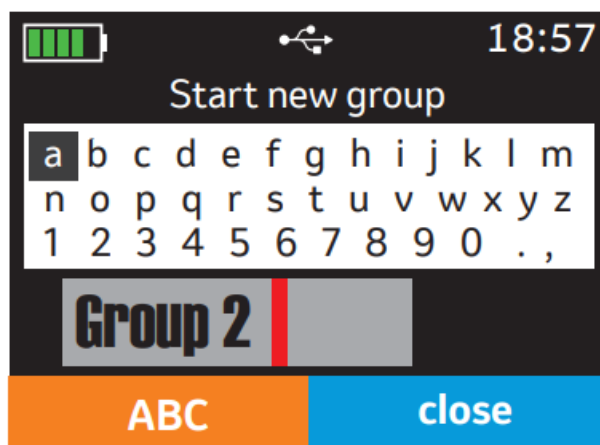
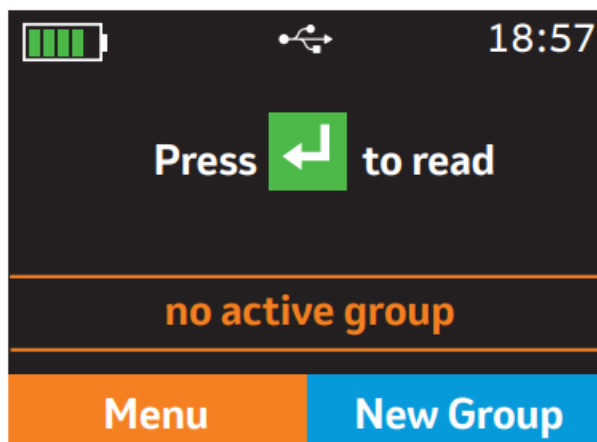

For more information visit [www.allflex.global/allflex-awr-250/](http://www.allflex.global/allflex-awr-250/)



<http://www.allflex.global/allflex-apr-250/>



This product is not intended to diagnose, treat, cure, or prevent any disease in animals. For the diagnosis, treatment, cure, or prevention of disease in animals, you should consult your veterinarian. The accuracy of the data collected and presented through this product is not intended to match that of medical devices or scientific measurement devices.

Copyright© 2023 Merck & Co., Inc., Rahway, NJ, USA and its affiliates.





## Documents / Resources

 <p><b>AWR300 Reader</b> Quick Start Up Guide</p> <p><small>Allflex, a division of Merck Animal Health, is a high-performance reader device for fast, high-volume reading of electronic identification (EID) tags used for animal groups and farms all around the world. The AWR300 provides outstanding reading performance with very long battery life, robust design, simple data collection, memory and powerful connectivity options. Visit <a href="http://ah.allflex.com">ah.allflex.com</a> at the top of the reader, the reading status is easily visible in the bottom when using the device connected app.</small></p> 	<p><a href="#">Allflex AWR300 Stick Reader</a> [pdf] User Guide AWR300, AWR300 Stick Reader, Stick Reader, Reader</p>
---	---

## References

- [User Manual](#)

[Manuals+](#), [Privacy Policy](#)

This website is an independent publication and is neither affiliated with nor endorsed by any of the trademark owners. The "Bluetooth®" word mark and logos are registered trademarks owned by Bluetooth SIG, Inc. The "Wi-Fi®" word mark and logos are registered trademarks owned by the Wi-Fi Alliance. Any use of these marks on this website does not imply any affiliation with or endorsement.