



# ALLEN HEATH DT02 Dante Output Expander User Guide

[Home](#) » [ALLEN HEATH](#) » ALLEN HEATH DT02 Dante Output Expander User Guide 

## Contents

- [1 ALLEN HEATH DT02 Dante Output Expander](#)
- [2 DT02](#)
- [3 Surface mounting](#)
- [4 Software](#)
- [5 Rack mounting](#)
- [6 Specification](#)
- [7 Front panel](#)
- [8 Documents / Resources](#)
  - [8.1 References](#)
- [9 Related Posts](#)

# ALLEN & HEATH

## ALLEN HEATH DT02 Dante Output Expander



## DT02

The DT02 is a portable, PoE enabled, rugged Dante I/O unit. It can be used to complement Allen & Heath digital mixing systems, or any other system on a Dante network. It provides 2 balanced line-level outputs via a pair of XLR connectors. It connects to the Dante network over a single Cat cable.

The DT02 can be ordered in either of two versions:

- DT02 – standard version with rubber feet and 12V power supply.
- DT02-M – version for fixed installation with brackets for surface mounting and no external power supply.

## Surface mounting

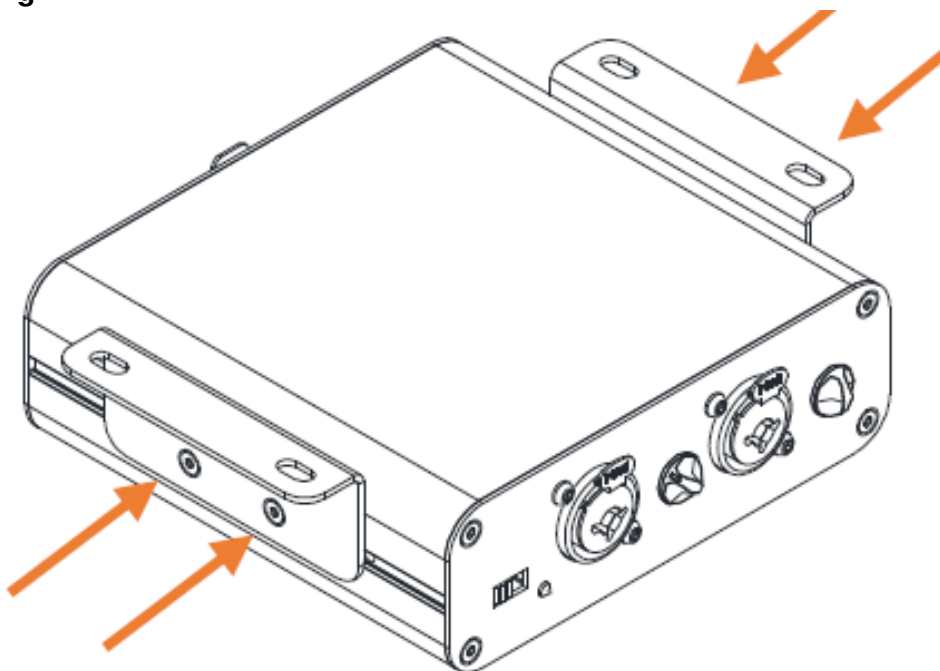

The surface mounting ears allow the device to be mounted on top or under a surface, desktop or podium, or vertically on a wall or partition. They can be installed to face either the top or bottom of the unit.

The DT02-M comes with surface mounting ears and preassembled insert bars. Position the ears centrally on each side of the unit, aligned with the threaded holes on the insert bars, facing either up or down as required, and secure them using the 4x M3x6mm screws provided in the package.

For surface mounting of a standard DT02, the optional surface mounting kit DT-SMK is available.

## Software

Visit the Audinate website to learn more about Dante, and download Dante Controller to route audio and configure devices on a Dante network: <https://www.audinate.com/>

## Rack mounting

Up to two units can be rack-mounted in a single 1U rack space with the optional rack kit DT-RK19.

Read the Safety Instructions Sheet included with the product and the information printed on the panel before operating.

A limited one year manufacturer's warranty applies to this product, the conditions of which can be found at: [www.allen-heath.com/legal](http://www.allen-heath.com/legal) Register your product with Allen & Heath <http://www.allen-heath.com/support/register-product/>

## Specification

- XLR Outputs Balanced, relay protected
- Output Impedance <75Ω
- Nominal Output +4dBu = 0dB meter reading

- Maximum Output Level +22dBu
- Dante 48kHz/96kHz
- Power and Temperature
- DC Input +12V DC 1.25A
- Power Consumption 10W max
- Operating Temperature Range
- 0°C to 40°C (32°F to 104°F)
- PoE Requirements 802.3af 15W
- Dimensions and Weight Width x Depth x Height x Weight DT02 130 x 131 x 43 mm, 0.5kg (5.1" x 5.2" x 1.7", 1lbs)

## Front panel

### Output sockets

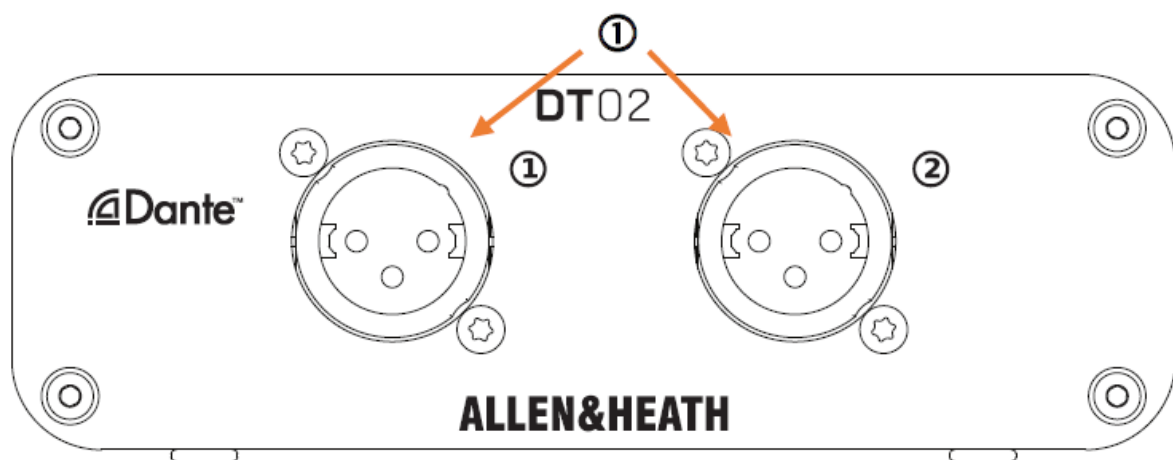

Balanced line-level XLR outputs.

## Rear panel

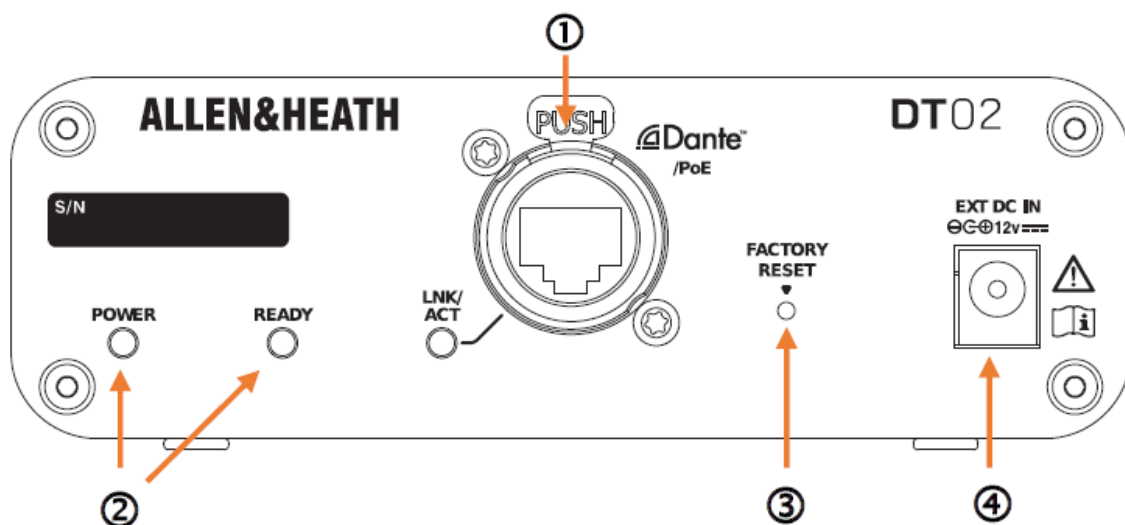

- Dante EtherCon port for connection to the Dante network and Link / Activity LED indicator. Use a PoE Ethernet switch or PoE injector to power the unit via this port.
- Power LED indicator and Ready indicator. Ready lights up when the unit is successfully booted and ready to

pass audio.

- Factory Reset Hold down the recessed switch while powering up. After at least 10 seconds, remove power then power up again normally to reset the network settings and name. This will delete any static IP address and revert to factory default (DHCP / zero-conf).
- DC input DC 12V connector. Only use with the power supply provided with the unit.

## Documents / Resources

	<p><a href="#">ALLEN HEATH DT02 Dante Output Expander</a> [pdf] User Guide DT02 Dante Output Expander, DT02, Dante Output Expander</p>
---	--

## References

- [& Legal | Allen & Heath](#)
- [& Register a Product | Allen & Heath](#)
- [Audinate - Maker of Dante, Pro AV's Leading Networking Technology](#)