



**4001797 Variable
Message Sign**



ALL TRAFFIC SOLUTIONS 4001797 Variable Message Sign Instructions

[Home](#) » [ALL TRAFFIC SOLUTIONS](#) » ALL TRAFFIC SOLUTIONS 4001797 Variable Message Sign Instructions 

Contents

- [1 ALL TRAFFIC SOLUTIONS 4001797 Variable Message Sign](#)
- [2 InstAlert 24 Variable Message Sign](#)
- [3 InstAlert Messages](#)
- [4 InstAlert Programming](#)
- [5 ATS PC Sign Manager](#)
- [6 PRODUCT SPECIFICATIONS](#)
- [7 PREMIER CARE PLAN](#)
- [8 FAQ](#)
- [9 Documents / Resources](#)
 - [9.1 References](#)
- [10 Related Posts](#)



ALL TRAFFIC SOLUTIONS 4001797 Variable Message Sign



InstAlert 24 Variable Message Sign

- Open dimensions: 1.63" x 28" x 60"
- Folded dimensions: 3.25" x 28" x 30"
- Folded sign fits in vehicle trunk, SUV hatch
- Full matrix display: 26 x 96 pixels, 0.6"x 1" pitch
- LED pixels: Amber 590nm, 30-degree viewing angle, 100,000 hrs, black background, universal display modules
- MUTCD compliant
- On-board message selector buttons for quick selection of 25 internal messages and modes with anti-tamper lockout
- Local and remote management and monitoring options
- Integral active cell modem allowing TrafficCloud Web-Based Management Services for remote management
- Integral camera for awareness and alert-driven images
 - 640 x 480 daylight images
- Power-saving circuitry and automatic dimming for ambient light conditions with adjustable dimming range and manual display brightness override
- Conformal coating on all circuit boards
- Integral case handles and nylon web handles
- Weight: 43 pounds
- Weatherproof, inherently sealed design
- 1/8" tinted, non-glare, UV-stabilized polycarbonate face
- The entire face is removable for service
- Aluminum chassis, 12 ga., with black powder coat finish
- Mounting provisions for permanent applications,
 - (12) 1/4-20 threaded holes
- -40 to 160°F operating temperature range, 95%humidity, non-condensing (-20°F for Bluetooth communication)
- Withstands up to 70-mph winds

InstAlert Operation Modes

- **Message Mode:** Display one message, up to six screens
- **All Messages:** Sequence all messages in sign memory
- **Schedule:** Change message and/or mode up to 13 times/day
- Speed-based modes available in the
- SpeedAlert 24 configuration
- Sign returns to the last configuration when power applied

InstAlert Messages

1–3 line messages

- 1 line: 24" H x 12.5" W characters, 4/line
- 2 lines: 10.25" H x 5.75" W characters, 8/line
- 3 lines: 7" H x 4" W characters, 12 per line
- 2 lines: (1) 7" char, 12/line, (1) 10.25" char, 8/line
- Up to six screens per message
- Message power efficiency calculator in software
- Variable display time, flash, and reverse rates
- for each screen
- Full graphics capability, each LED is individually controllable, programmable from a PC, PDA, or remotely
- Ability to link multiple messages for up to
- 144 screen animation
- Scroll through 25 users defined on-board messages using selector buttons built into a sign, no training necessary; buttons on the unit become inactive after a timeout to prevent tampering, reactivate by reapplying power
- Unlimited message storage on a PC, Android device or remote server
- Messages on the sign are not erased when power is removed
- Sign returns to the last message when power applied
- Actual sign preview on PC, Android, or TraffiCloud

InstAlert Programming

Program and monitor the sign in three ways: On-Board Programming (standard on all units)

- Select a message from the sign's memory
- Select operation mode

TraffiCloud® Web-Based Management Services

Using integral cell modem for remote management

(See TraffiCloud specification for more information):

- A turnkey system with remote sign connection functional out of the box. The unit connects to the TraffiCloud system when the sign is powered

- Fully hosted web-based management system
 - Internet-connected computer with browsers provides anywhere access on all browser-capable, connected devices.
 - No IT involvement or support is necessary. The system bypasses the customer network eliminating access issues
 - Cellular service provided by ATS, no separate cellular charges
 - A hosted database requires no setup or maintenance by the customer
- **Apps:** All apps included in Message Suite:
 - Equipment Management: Change messages and settings remotely, monitor sign online
 - Image Management: Online image retrieval and management of images from internal camera
- **Alerts:** Email/SMS notifications for low battery and tampering, alerts can include images
- **Mapping:** Visually manage equipment and data
- Premier Care Perpetual Warranty

ATS PC Sign Manager

Local Management using PC with USB connection standard on all signs

- PC-based client software
- Connect to sign via USB or Bluetooth (optional) ATS
- **Android App:** Local management (optional):
- Android OS wireless Bluetooth control local to unit
- Android devices can be phones or WiFi devices with Bluetooth

Local Management Features

- Create and change messages, modes, and settings
- Local image retrieval and management from internal camera
- Manage all unit settings, automatic sync with TrafficCloud Web-Based Management
- All traffic data and messages can be saved for online management and backup with optional

TrafficCloud Message Suite

- Create messages and save them to the TrafficCloud library, messages available on all ATS Android App or PC Sign Manager devices
- Sign firmware field and remotely upgradeable

InstAlert Settings

- Configure the following parameters via PC, Android or TrafficCloud Web-Based Management System:
 - Load message using the “Display Now” feature
 - Load 24 messages into the sign’s memory
 - Scroll messages in the sign’s memory

- Display signs from the server or local device memory
- Set sign mode
- Upload schedule
- Set automatic dimming range minimum and maximum levels or manually override display brightness
- Internal real-time clock, time maintained with power disconnected
- Set time via local device or sync with cell signal

Scheduling

- All days, multiple messages: schedule up to
- 50 different messages or modes for up to 13 different time periods in a 24-hour day, repeats in each 24-hour cycle
- 7-day, multiple messages: schedule different messages or modes for up to 13 different time periods in each 24-hour day for each of 7 days, repeats in each 7 day cycle; up to 50 different messages can be used over the 7-day period
- All messages and scheduling reside on the sign – no external hardware is necessary
- Program schedule via TrafficCloud Web, ATS Android app or ATS PC Sign Manager. Save to load onto multiple signs
- Camera activation is controlled in scheduled windows
- Internal real-time clock, time, and schedule maintained with power disconnected Data Logging Option for InstAlert units with the optional internal radar option – SpeedAlert 24
- Upgrade to the SpeedAlert 24, adding traffic radar to the InstAlert to enable the collection of traffic data and speed display functionality
- See SpeedAlert 24 Specification Sheet
- Power-saving circuitry and automatic dimming for ambient light conditions with adjustable dimming range and manual display brightness override

SpeedAlert 24 Power

- 12VDC locking plug, 30A capacity: Compatible power supplies include:
 - Vehicles' power port, with optional adapter
 - Trailer wiring adapter for hitch mount
 - POWERcase portable power supply, PC26 or PC36
 - 120 or 220 VAC Power supply in NEMA 4 enclosure
 - ATS 5 Trailer (batteries with optional solar assist: 235 or 470 Ah, 60W solar option)
 - Pole battery box: 156Ah battery with solar assist
- Battery level indicator on sign, ATS Android app, ATS PC Sign Manager or TrafficCloud Remote Management
- Auto recovery for battery with solar
- Power cable customer replaceable, gold-plated connector contacts, high visibility yellow cable
- Options using the InstAlert mounting bracket
- Hitch mount
 - Sign height: 25" to bottom, 53" to top of sign from receiver tube (final height dependent on receiver height, flip mounting bracket for an additional 12")
 - Fits 1.25" or 2" receiver, adapter included

- ½" hitch pin
- Locking rotation adjustment on 15-degree increments over 180 degrees,
- ± 5-degree tilt to adjust LED aim for maximum brightness
- White powder coat finish with rear reflector
- Not intended for operation above 15 mph
- Telescoping Hitch Mount
 - All features of standard hitch mount, plus
 - Sign height: 53" to bottom, 81" to top of sign from receiver tube (final height dependent on receiver height, flip mounting bracket for an additional 12")
- Standard Folding Portable Post:
 - Folds for easy storage and portability
 - 42" to 55" to bottom, 70" to 83" to top of sign depending on leg positions, rotate bracket for additional 12"

Optional InstAlert Sign Components and Features

- TraffiCloud Web-Based Remote Management Service
- ATS Android App, Bluetooth connectivity
- Padded carrying case with accessory pockets, shoulder strap
- Mounting bracket
 - Mounts to pole or any surface using any hardware, no tools required
 - Tamper-resistant hardware compartment
 - Rotate the bracket for an additional 12" of mounting height
 - Aluminum with black powder coat
 - Sign can be locked into a bracket
 - Bolt sign to mounting bracket for additional security
 - Mounting hardware supplied
- Internal radar allowing for speed display, speed-dependent messaging and speed and volume data collection – SpeedAlert 24 radar message sign
- Drive Times sensor-free Time to Destination Service
 - Travel time data sent to sign every minute

Warranty

- PremierCare Perpetual Warranty available with current TraffiCloud subscription. Includes hardware defect repairs for the entire lifespan of your ATS products and discounts on accessories and other repairs
- ATS 3-year Manufacturer's Warranty comes standard on all InstAlert variable message signs

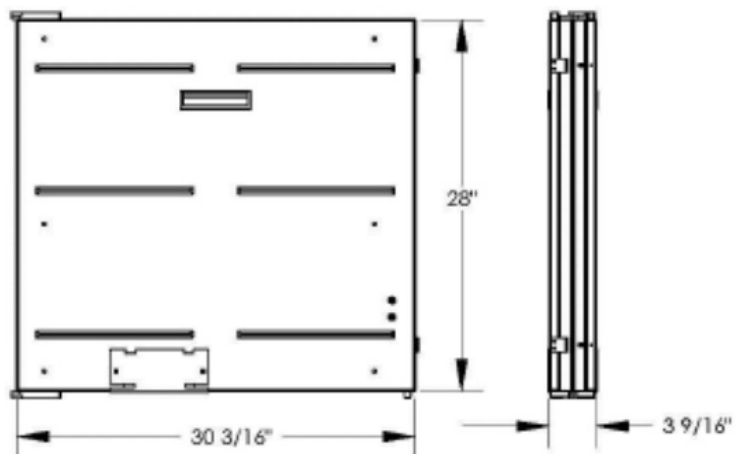

INSTALERT DIMENSIONS: FOLDED

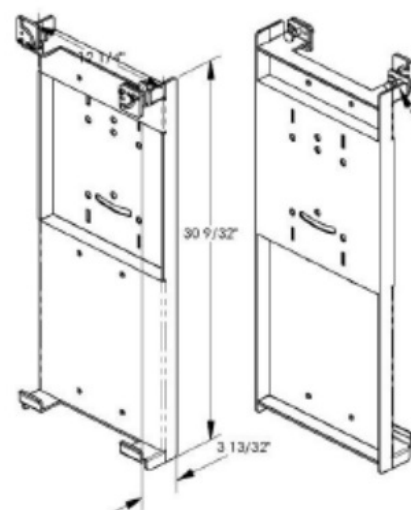

DIMENSIONS: MOUNTING PLATE

Product Specifications: InstAlert 24 Variable Message Sign

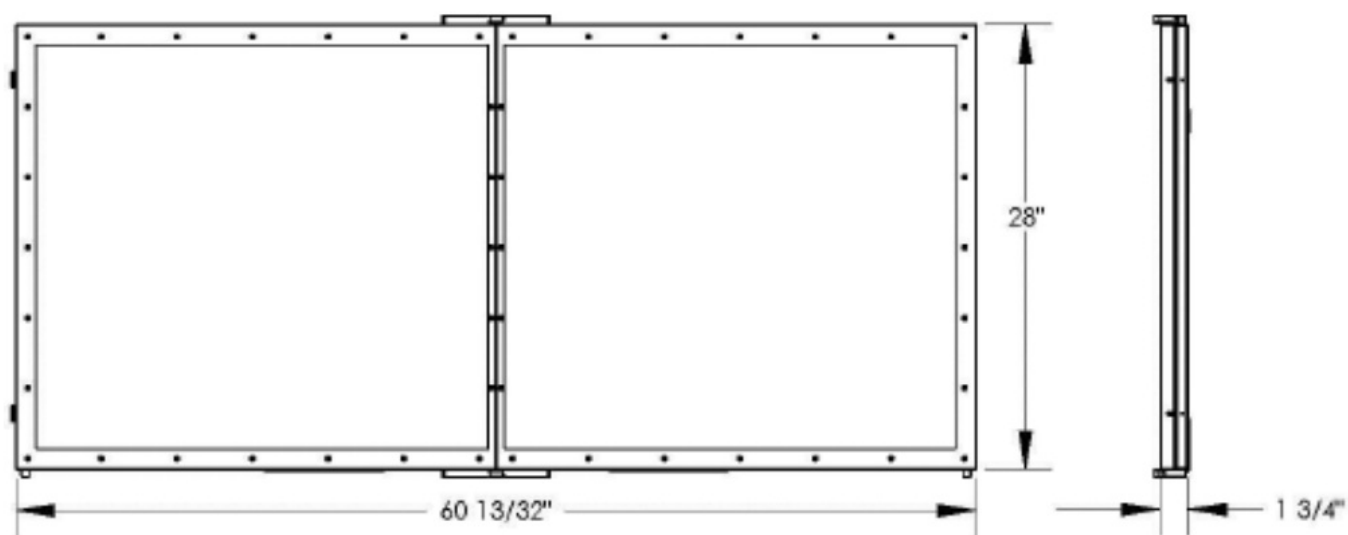

INSTALERT 24 DIMENSIONS: OPEN

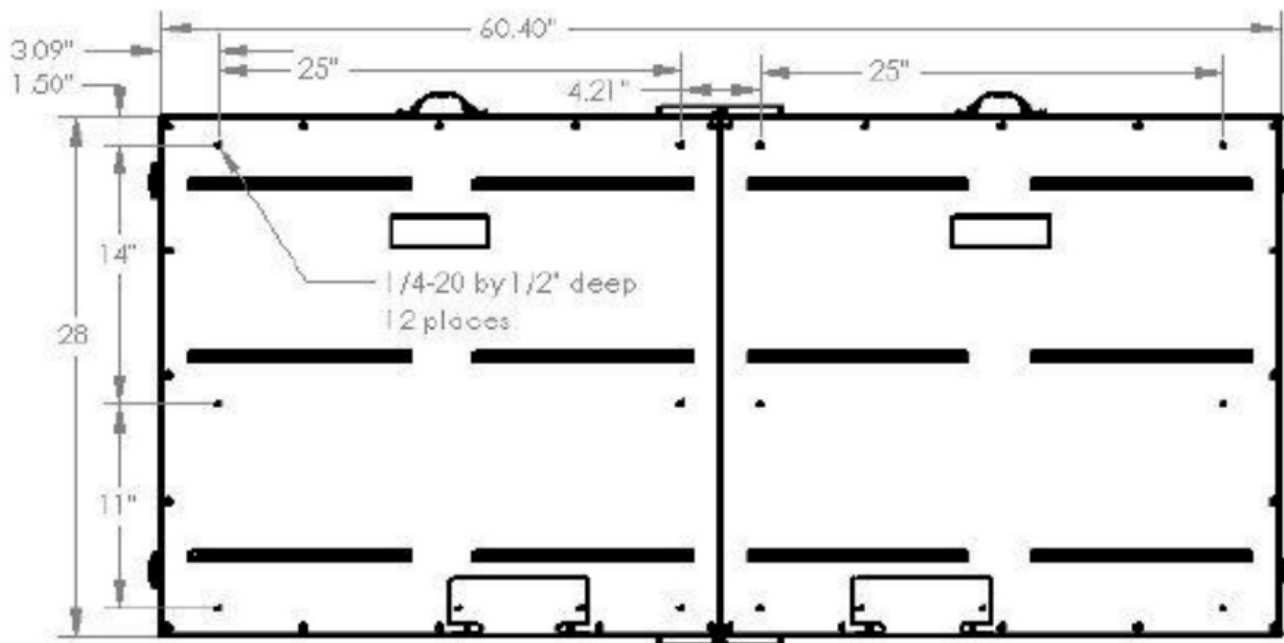



MOUNTING HOLE POSITIONS

SAVE TIME & MAXIMIZE RESOURCES

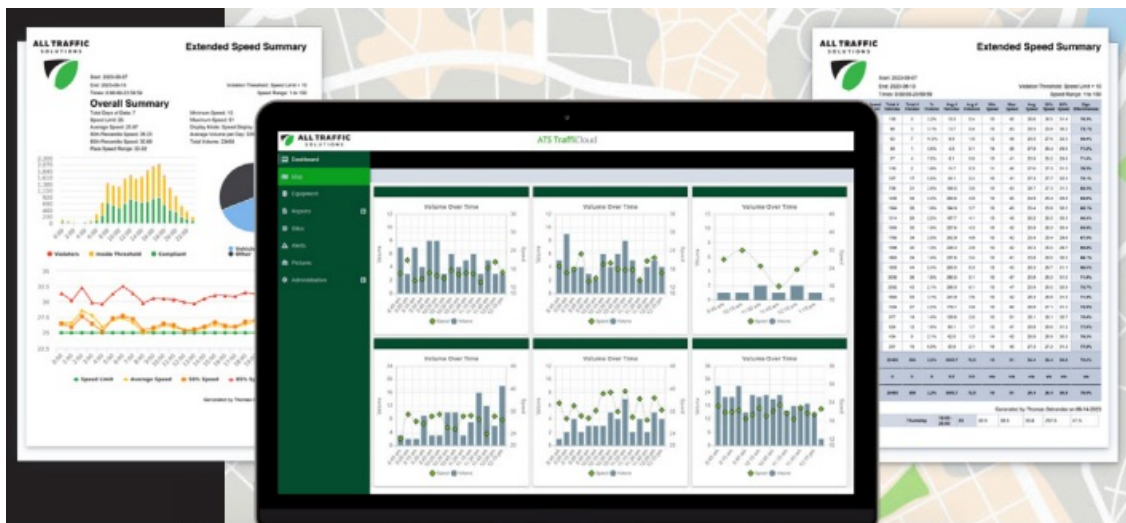
TrafficCloud is a secure and user-friendly cloud-based portal for remote equipment management. Securely access, monitor, and manage all your traffic devices, messaging, and data from any Internet-connected computer or smartphone.



- 
 Access customizable dashboards to get up to 6 ready-made reports of data and analytics.
- 
 Remotely oversee and control devices. Collect data and real-time alerts, quickly change and schedule messages to adapt to changing situations.
- 
 Save time gathering and sharing data, enabling insights to optimize resource allocation and address speeding issues effectively.



- Receive ongoing hardware defect repairs and remote diagnostics. Plus 50% off accidental damage or vandalism repairs and 50% off additional accessories throughout your product's lifespan.



- Receive unlimited, personalized, one-on-one training, guides and an on-demand video library for subscribers.

ATS TrafficCloud®

“For us, the data is really priceless. It is truly a force-multiplier.”

– Sgt. Cooley, Cedar Hill Police Department

User-friendly Portal and Intuitive Mapping

- Quickly oversee your entire program with an intuitive overview of all collected data or specific traffic devices.
- Review your equipment location, location history, and statuses through our system's interactive maps.

Ready-made Reports

- Get up to 6 ready-made reports of data and analytics including an Enforcement Priorities report of speeds, vehicle counts, and more. Schedule recurring reports to designated specified users.

Remote Equipment Management

- Control and configure your equipment and its settings from anywhere with an internet-connected computer or smartphone.

Dynamic Messaging

- Create and modify messages and custom images either individually or in bulk.
- Schedule messages in advance or make updates within minutes.

Sign and Device Modes

Tailor your traffic management approach based on your specific needs. Choose from our versatile sign and device modes, including:

- Stealth Mode
- Speed-Dependent Messaging Mode

Real-time Alerts

- Stay informed via email or text with updates on low batteries, high-risk speeding, new equipment sites, and more. Assign recipients by unit and alert type for seamless communication.

“TraffiCloud has been invaluable to us. It's the tool we will always use. Everybody's town is different, and there are many ways to use TraffiCloud for your particular traffic challenges.” – Sgt. Finrock, Clarendon Hills Police Department



For more information visit us online at AllTrafficSolutions.com sales@alltrafficsolutions.com Call us at 866.366.6602 All Traffic Solutions. 14201 Sullyfield Circle, Suite 300, Chantilly, VA 20151 ©All Traffic Solutions TrafficCloud leverages our patented technology (US Patents 8417442; 8755990; 9070287; 9411893) to deliver unique cloud-based management, features and functionality. TrafficCloud is a registered trademark of All Traffic Solutions.



PRODUCT SPECIFICATIONS

The ATS 5 Trailer is compatible with the following products:

- Shield 15 (Sh15) Radar Speed Display
- SpeedAlert 18 or 24 (SA18 and SA24) Radar Message Sign
- InstAlert 18 or 24 (IA18 and IA24) Variable Message Sign
- 5' minimum to bottom of sign

Features

- 620 lbs with 225Ah battery capacity and SpeedAlert/ installers 18
- 760 lbs with 450Ah battery capacity SpeedAlert/ InstAlert 24
 - Add 130 lbs for additional battery pair (145 lbs for AGM)
 - Add 60 lbs for a 120W solar panel
 - Add 40 lbs for 65W solar panel
- Tongue weight: 20 lbs
- Dimensions: 61.5 inches long x 62.5 inches wide x 64 inches high (stowed)
- Simple manual lever lift system for one-person setup
- Removable tongue for the 2-inch ball, lockable
- Storage for tongue and lift bar in locked battery compartment
- 16 ga. steel locking battery compartment with vented battery chamber, charger/accessories chamber, and 1/8-inch aluminum diamond plate lid
- Continuous-weld steel frame, white marine grade powder coat finish
- Wheels: 12 inches, five-bolt steel rims with a 4.5-inch bolt circle
- Replaceable steel fenders, weight-supporting
- Locking wheel lug bolts, one per wheel, with removal tool
- Axle: 2000-lb leaf spring
- Ground Clearance: 9.75 inches under axle, 19 inches under chassis
- Jacks: 4, retractable crank type, fully adjustable at each corner, 1500-lb capacity each
- Recessed tail lights and DoT-approved lighting
- Safety chains, 30 inches with hooks
- DoT-approved red/white reflective tape
- License plate holder with light

Power

- 12 VDC system, standard four-pin wiring plug
- 225Ah or 450Ah batteries, (2) 6VDC batteries in series, deep cycle marine (130 lbs per pair, two pair max)
- 20A time delay fuse on battery supply
- 120W solar assist with 10A solar controller to prevent overcharging, other solar wattages available
- Solar panels charge while a sign is stowed or deployed
- 10A 120VAC automatic charger with externally accessible AC connection
- Switch to control power to sign

Options

- 30 in x 36 in speed limit sign and interchangeable digits for 5-65 mph display and locking hitch pin for display and stowing; digit storage in battery compartment
- Red and Blue violator strobe light bar, set to flash above user-set speed
- Low voltage disconnect solar controller to turn off sign if power falls below 11.5VDC (decreases run time)
- 2 and 5/16-in ball or pintle hook, adjustable height, on removable tongue
- Orange powder coat finish (minimum order quantity)
- AGM sealed batteries for lower temperature use, – 40F (185Ah per pair, 370Ah max)
- Tamper alarm with adjustable sensitivity
- Wheel lock bar
- 14-inch wheels and fenders
- Speed-dependent messaging option

Warranty

- 1-year warranty (three months on batteries)

Compatible with these ATS Products

1. SpeedAlert 24 (optional light bar)
2. SpeedAlert 18
3. InstAlert 18
4. InstAlert 24
5. Shield 15



ATS Trailer: Deployed with SpeedAlert 24

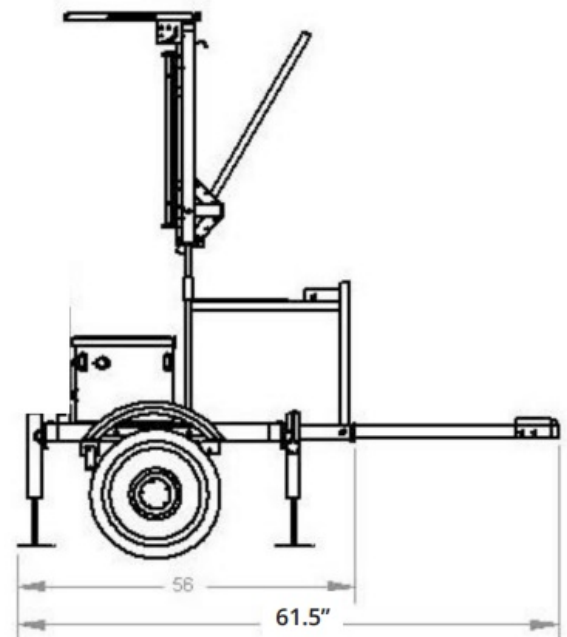
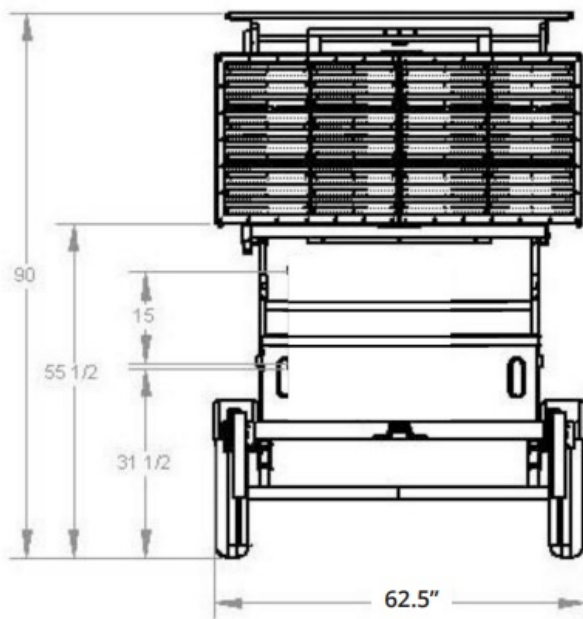

ATS Trailer: Stowed with SpeedAlert 24

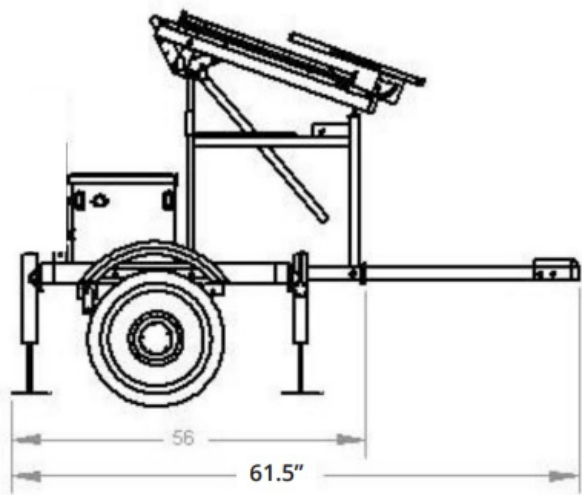
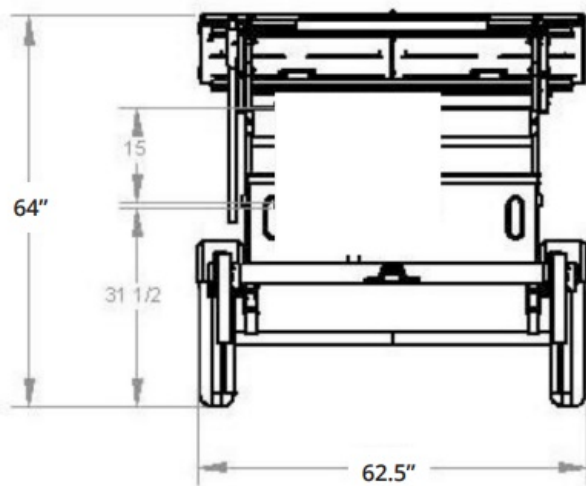

PREMIER CARE PLAN

PREMIER CARE COVERS ANY MANUFACTURING DEFECT ON AN ATS-MANUFACTURED UNIT DURING ITS LIFESPAN, PROVIDED THE UNIT IS SUBSCRIBED TO TRAFFICLOUD®. In cases of a manufacturing defect, ATS will pay for shipping to and from the Customer. ATS reserves the right to repair or replace the warranted part or parts at its sole discretion. Units will be repaired expeditiously, however, repairs on older units may be delayed due to the availability of parts. If ATS deems the issue not to be caused by a manufacturing defect, the Customer will be notified and given the option to proceed with product repairs at standard ATS repair rates.

Premier Care does not include the use of a loaner unit while the unit is being serviced. As an additional Premier Care benefit, the following items are covered at 50% of standard ATS repair rates:

- LFP batteries
- Damage resulting from misuse or abuse that includes using the product in ways for which it was not intended
- Vandalism
- Accidents
- Damage due to incorrect installation or operation
- Acts of nature
- Normal wear and tear such as frayed cords or cables, broken connectors, scratched or broken enclosures

The following items are not covered by Premier Care:

- SLA (sealed lead acid) and trailer batteries
- Trailers are not covered under Premier Care, only the display units on the trailers are covered

ATS is not responsible for any consequential damages that result from violent maneuvers, collisions, or other circumstances, even though the device(s) is/are used according to instructions. ATS specifically disclaims any liability for injury caused by the product in all such circumstances. As an expressed warning, the user should be aware that ATS specifically disclaims any liability for injury caused by the product in all such circumstances involving harmful personal contact.

Visit our support page at: <https://www.alltrafficsolutions.com/support>.

All Traffic Solutions 14201 Sullyfield Circle, Suite 300, Chantilly, VA 20151. ©All Traffic Solutions.

FAQ

How do I power the InstAlert 24 Variable Message Sign?

The sign can be powered using a 12VDC locking plug with a 30A capacity. Various compatible power supplies are available including vehicle power ports, trailer wiring adapters, portable power supplies, and AC power supplies

Can I adjust the height of the sign?

Yes, the sign height is adjustable from 25 inches to the bottom and 53 inches to the top of the sign. Mounting brackets can be flipped for an additional 12 inches in height.

Documents / Resources

	<p>ALL TRAFFIC SOLUTIONS 4001797 Variable Message Sign [pdf] Instructions InstALERT 24 - ATS-5 Trailer Cloud Model 4001797, 4001797 Variable Message Sign, 4001797, Variable Message Sign, Message Sign, Sign</p>
---	---

References

- [🌐 Traffic Management Solutions | All Traffic Solutions](#)
- [User Manual](#)

[Manuals+](#), [Privacy Policy](#)

This website is an independent publication and is neither affiliated with nor endorsed by any of the trademark owners. The "Bluetooth®" word mark and logos are registered trademarks owned by Bluetooth SIG, Inc. The "Wi-Fi®" word mark and logos are registered trademarks owned by the Wi-Fi Alliance. Any use of these marks on this website does not imply any affiliation with or endorsement.