



ALIYUN S2 Time Lapse Camera User Guide

[Home](#) » [ALIYUN](#) » **ALIYUN S2 Time Lapse Camera User Guide** 

ALIYUN S2 Time Lapse Camera



The user guide is for reference only. Screenshots displayed in this user's guide of the "FWSCam GO" app may appear differently than those currently featured in your app as frequent updates and improvements.

Contents

- 1 Package Contents
- 2 Product Structure
- 3 How To Acitivate The Fill Light
- 4 APP Installation
- 5 Connect the Camera with App
- 6 Lens Focusing
- 7 APP Introduction
- 8 Configuration of Four Shooting Modes
 - 8.1 Time-Lapse Photography Configuration
 - 8.2 Motion Detection Configuration
 - 8.3 Timed Capture Configuration
- 9 Other Settings from Time Lapse Camera Via App
- 10 Customer Support
- 11 Documents / Resources
 - 11.1 References
- 12 Related Posts

Package Contents

- Camera



- LED Fill Light



- Tripod for Camera



- Cables of LED Fill Light



- Charging Cable



- User Guide



Product Structure

No.	Indicator Light Status	Device Status
1	Red light ON	Camera is charging
2	Red light Off	Camera is fully charged
3	Blue light flash	The LED fill light is charging
4	Blue light ON	The LED fill light is fully charged
5	Blue light ON, auto turn off	Camera is power on
6	Blue light flash quickly	Camera is connecting with phone via Wi-Fi
7	Blue light ON	Successfully connected

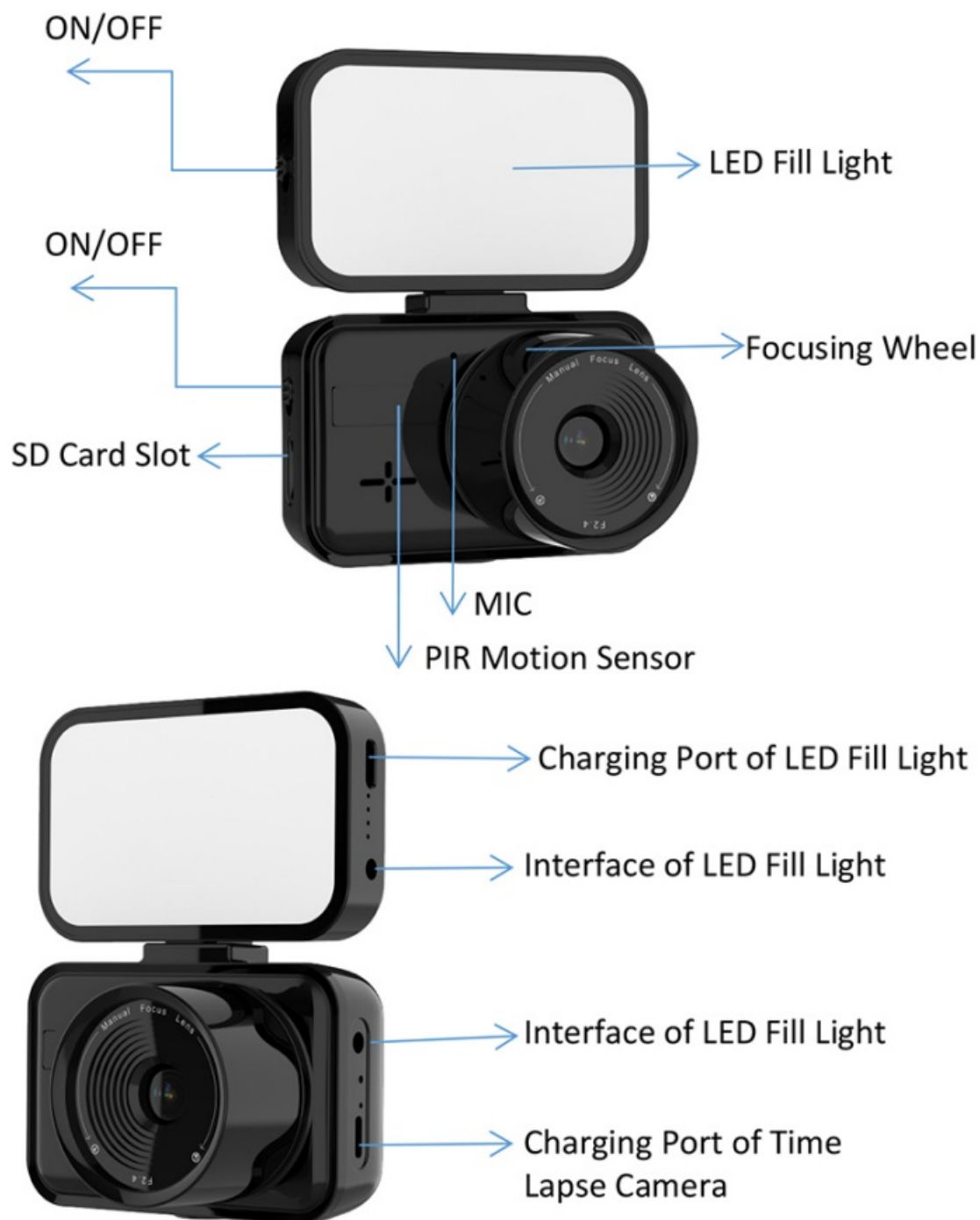

How To Activate The Fill Light

Step 1. Activate the fill light switch to the “ON” position.

Step 2. Connect the camera and fill light using the provided short/long AV cable.

Step 3. Access the app to configure the camera for recording and shooting in 3 different modes, ensuring to save the settings.

Step 4. Exit the settings once the device begins shooting and recording as per the specific time.

Notice: During nighttime operation, the white light will activate and illuminate during work, automatically turning off upon completion. In well-lit daytime conditions, the fill light will remain inactive.

APP Installation

Search for “FWSCam GO” in Apple Store and Google Play, download and install it, Or scan the QR code below to download the app

- Android



- iOS



Connect the Camera with App

Step 1: Please go to the setting of your smartphone to enable the function of Wi-Fi, Bluetooth and Location Services of Privacy.

Step 2: Start up the app and click the “+” icon to add the device as below displayed.

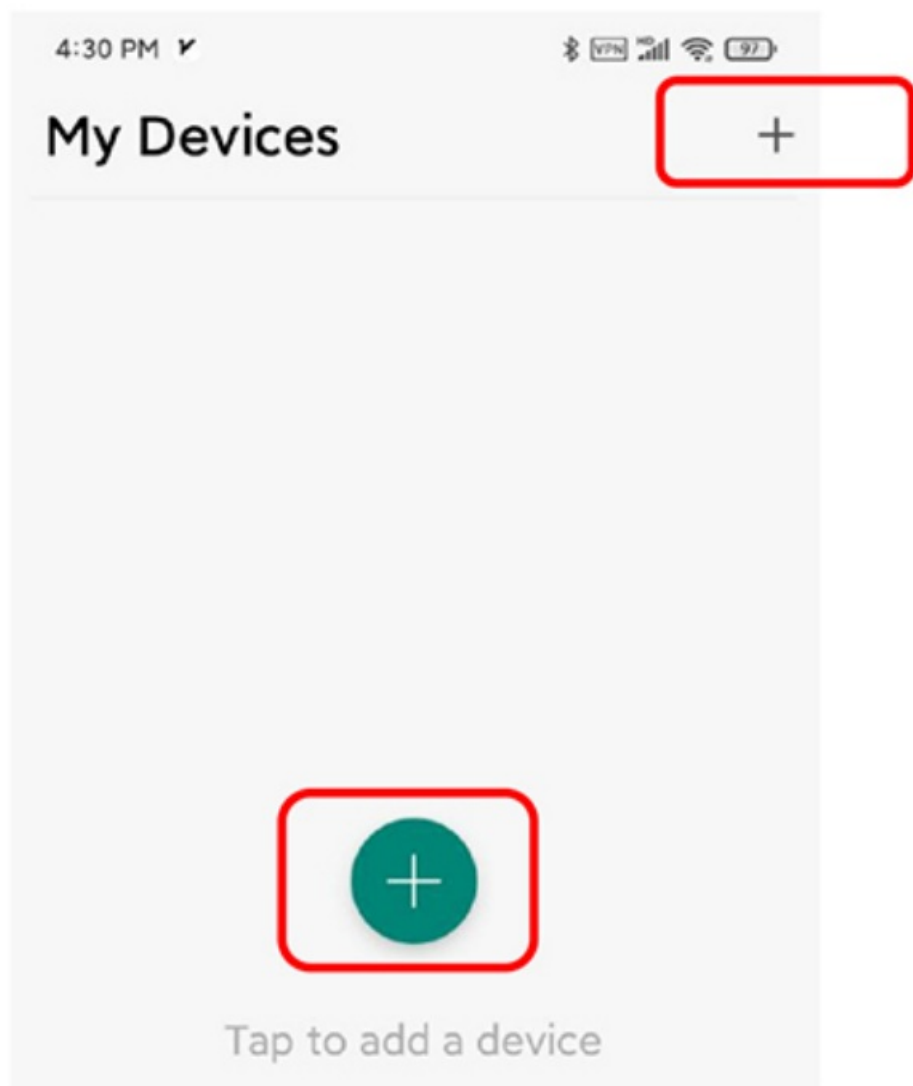

Step 3: Power on the camera, click on the WiFi camera, and follow in-app instruction to add the camera as below displayed.

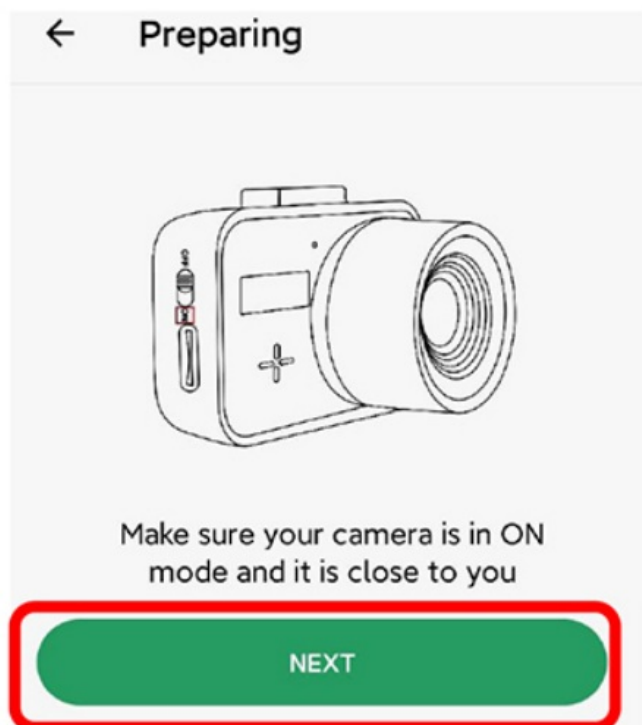
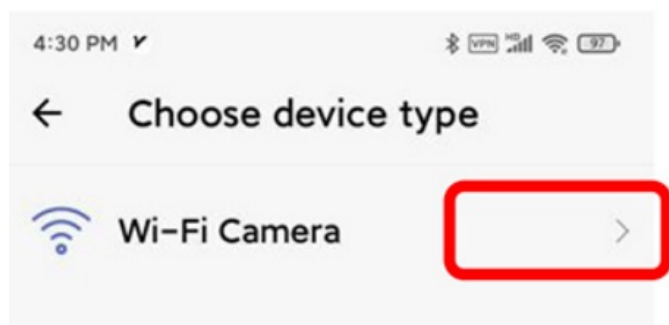

Step 4: Search for the hotspot with the connected device name: S2-XXXX.once it is connected successfully, Please enter a name of the camera as below displayed.

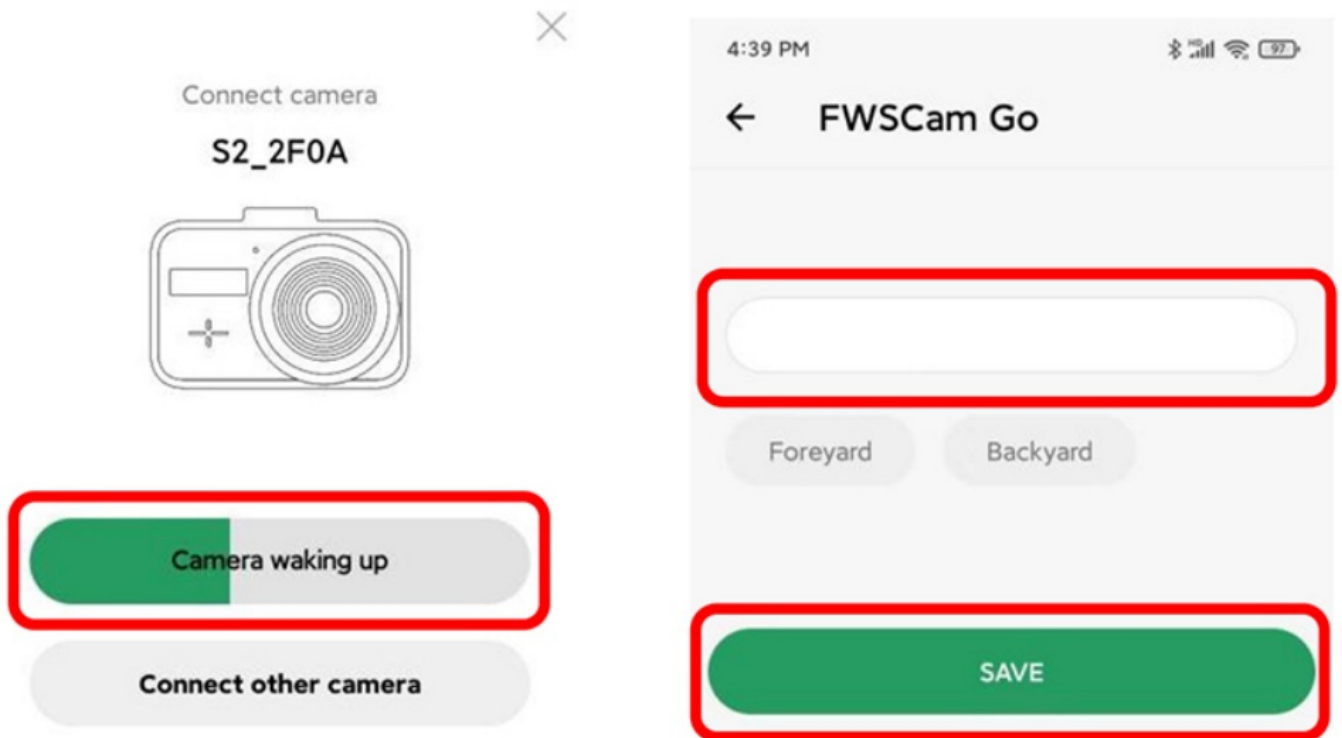

Lens Focusing

It can manually rotate the Focusing Wheel (Refer to the Product Structure) to adjust the best focal length according to the actual shooting distance until the image is clear through live view of APP directly.



Remark: Rotate the focusing gear towards the “” icon until it reaches the end, and you will be able to see objects at a distance of approximately 2.5cm



Remark: Rotate the focusing gear towards the “” icon to a certain angle, and you will be able to see objects beyond a distance of 2.5cm clearly.

APP Introduction

4:39 PM

Bluetooth HD 4G LTE Wi-Fi 97%

My Devices



Connection status

Device name

Add the camera



demo



Not

SD card status

FWSCam Go



80%

Battery status

Last update:2023-09-26 16:39:14



Last open time

Delete the camera



Home

Device management



Map



Camera location

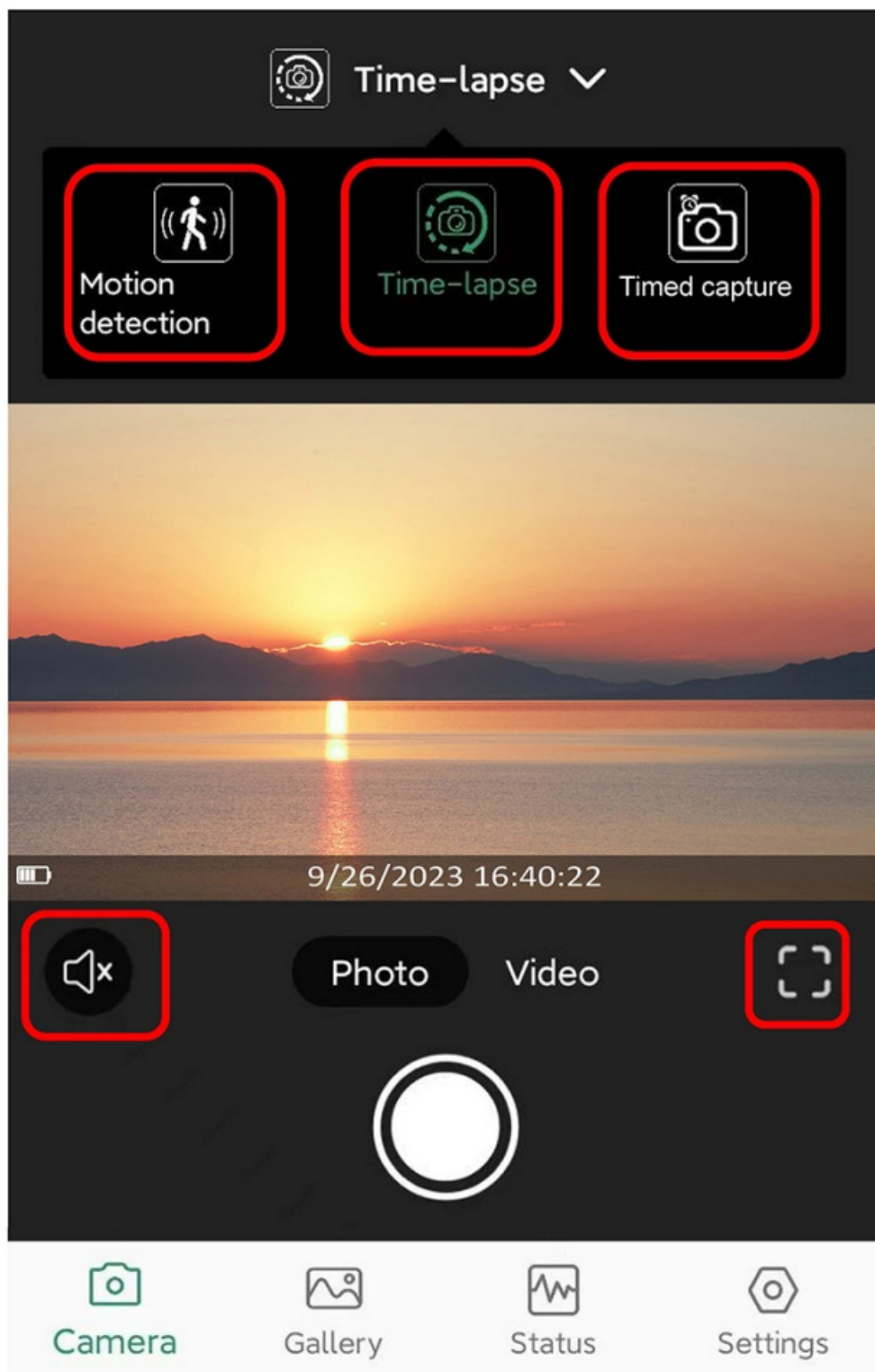

Account

APP Setting



- **Motion Detection:** PIR will be triggered to take a picture/ video when an object is moved
- **Time Lapse:** Generate 3-minute time-lapse videos automatically each time
- **Timed capture:** Capture the photos at a set time
- **Photo:** Manually take photos and save into the micro SD card
- **Video:** Manual start video recording and save into the micro SD card Enable microphone to listen Full screen display horizontally
-  Enable microphone to listen
-  Full screen display horizontally
- **Gallery:** The videos and photos saved manually

- **Status:** Camera status details
- **Settings:** The settings of camera

Configuration of Four Shooting Modes

Time-Lapse Photography Configuration

Step 1: Navigate to the “Settings” section of the app. Enter the device settings menu and choose “Working Mode.”

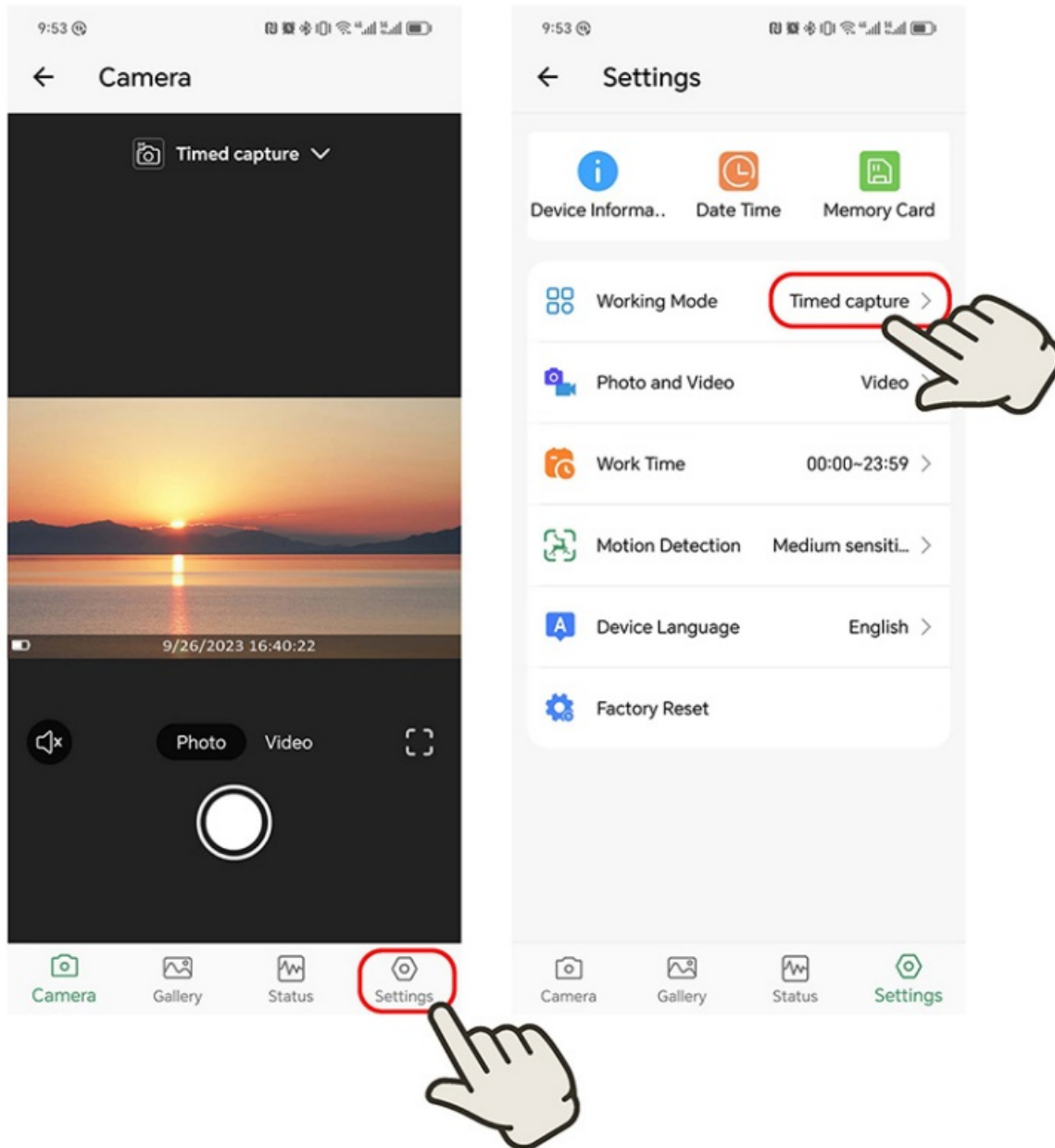

Step 2: Select “Time-Lapse Photography” from the “Mode” options. Choose the desired capture interval by selecting the appropriate time. Ensure you tap the “Confirm” button once all settings are configured.

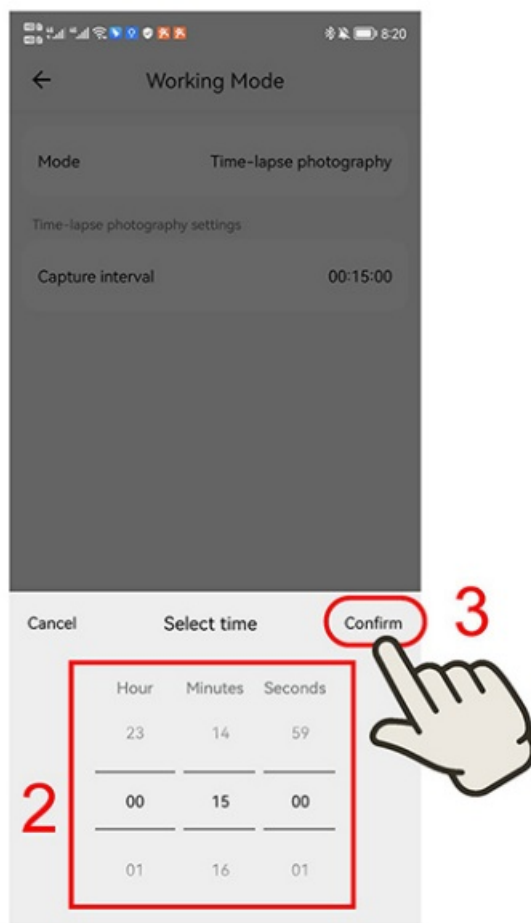
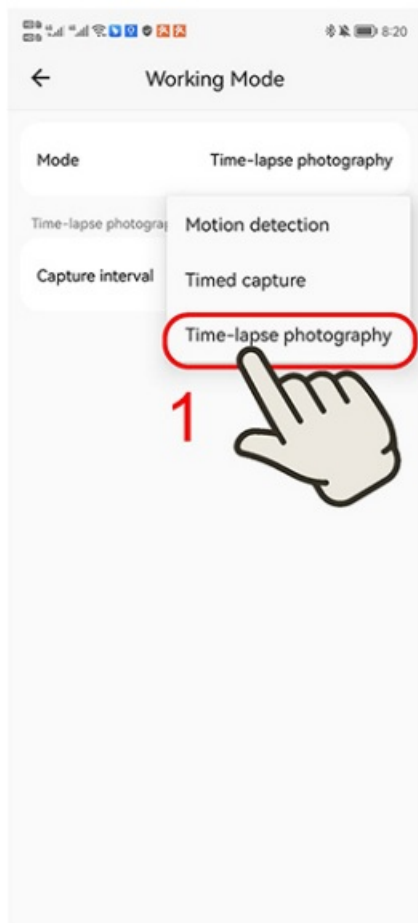

Notice:

1. In Time-Lapse Photography mode, the camera captures photos at regular intervals, creating a video saved on the micro SD card. The maximum video file duration is 3 minutes. Changing resolutions or modes will generate a new video file.
2. Settings for photo-only, video-only, or combined photo and video, as well as video duration, are not applicable in this mode.

Motion Detection Configuration

Step 1: Place the camera in your preferred location.



Step 2: Navigate to “Settings,” click on “Working Mode,” and choose “Motion Detection.” Then, select the “Detection Interval” option to set the recording duration, ranging from 5 seconds to 1 hour.

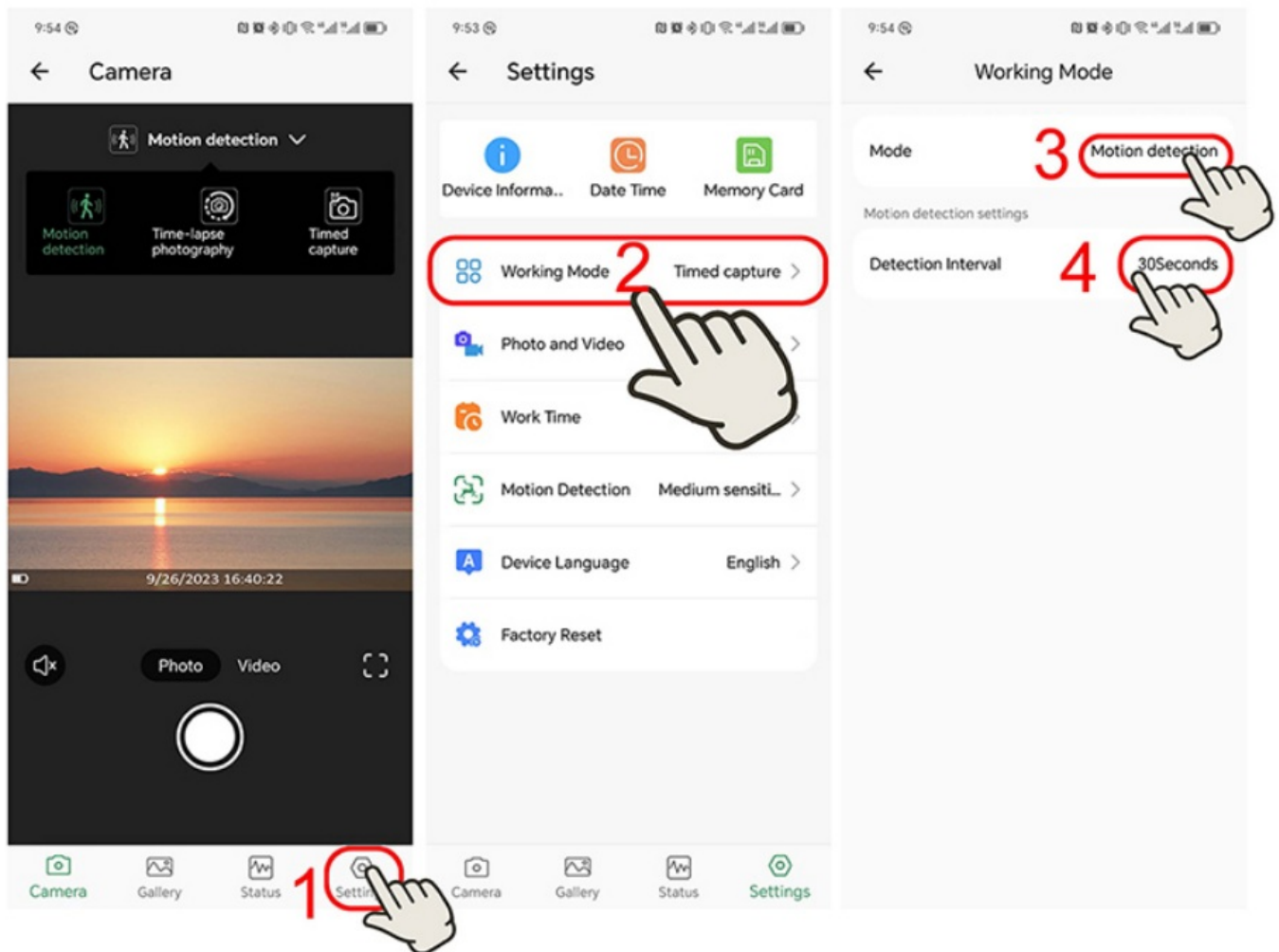

Step 3: Return to the “Settings” menu, choose “Photo and Video,” and access the three working modes (Photo-Only, Video-Only, Photo and Video Combined). Select the desired mode accordingly.

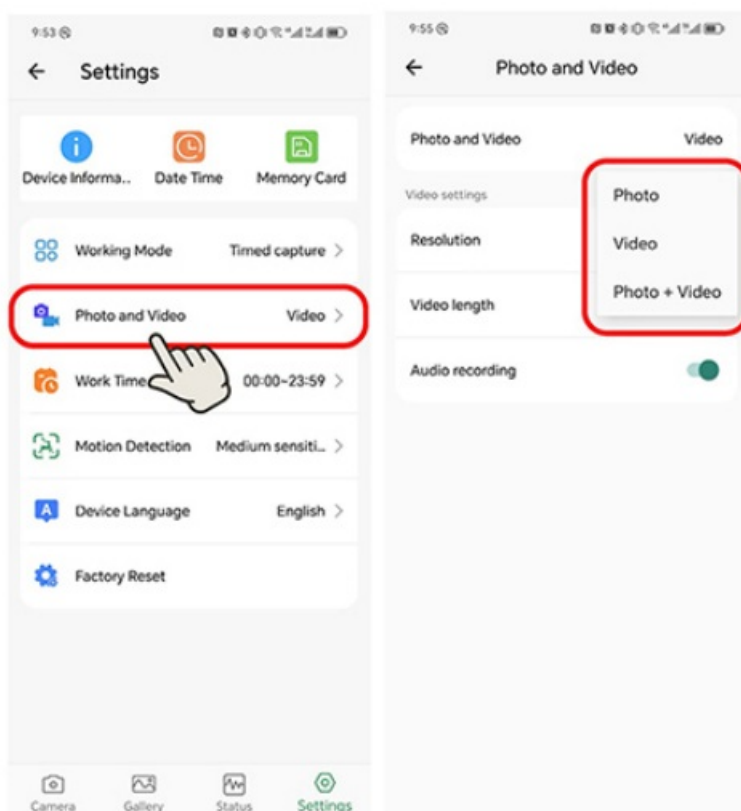

1. Selecting Photo Mode

Configure photo resolutions from 2MP to 32MP and adjust the Photo Burst from 1P to 5P using the “Photo Settings” option. Once all settings are confirmed, return to the main “Settings” menu.

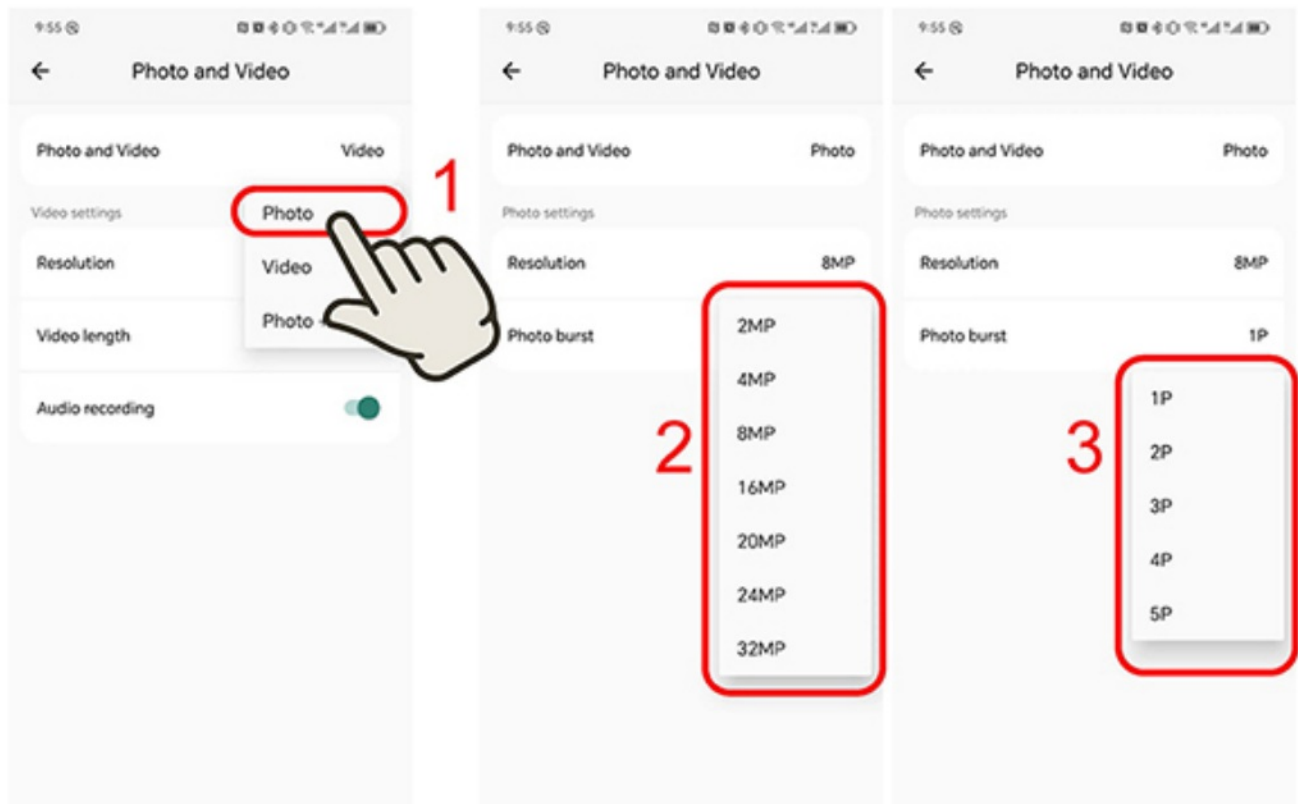

2. Select Video Mode

Configure video resolutions (720P, 1080P, and 2.7K), video recording length (5 seconds to 10 minutes), and choose to enable or disable audio recording.

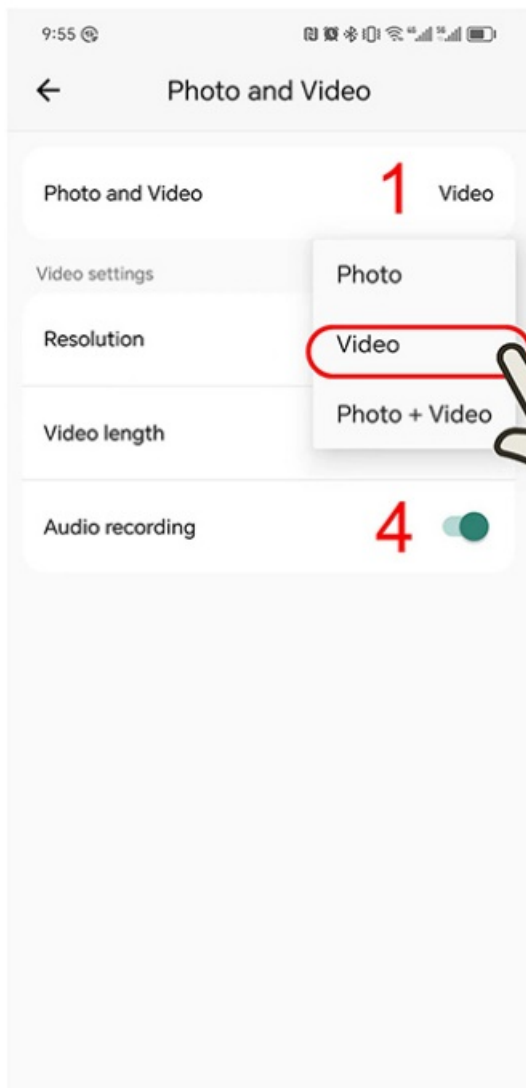

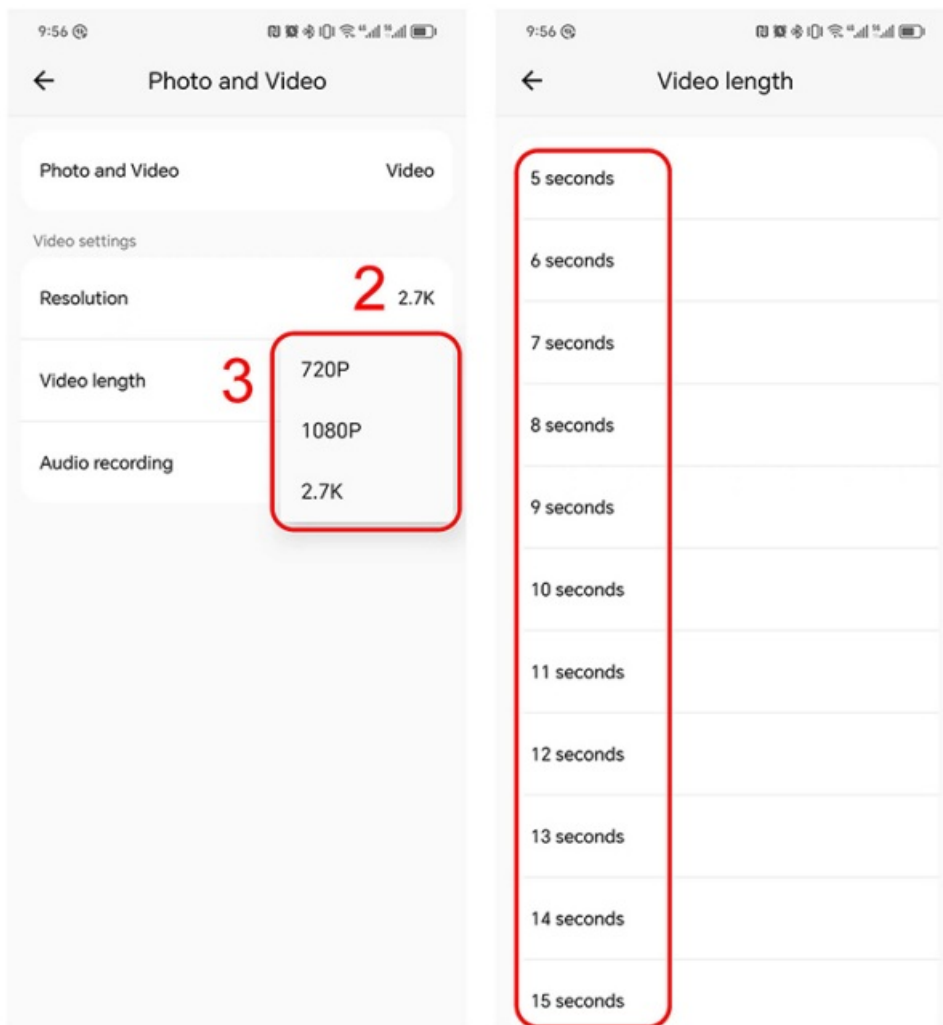

3. Select Photo and Video Mode

1. Configure photo resolutions from 2MP to 32MP and adjust Photo Burst from 1P to SP through "Photo Settings." Return to the main Settings once everything is confirmed.
2. Configure video resolutions (720P, 1080P, and 2.7K), video recording length (5 seconds to 10 minutes), and choose to enable or disable audio recording.

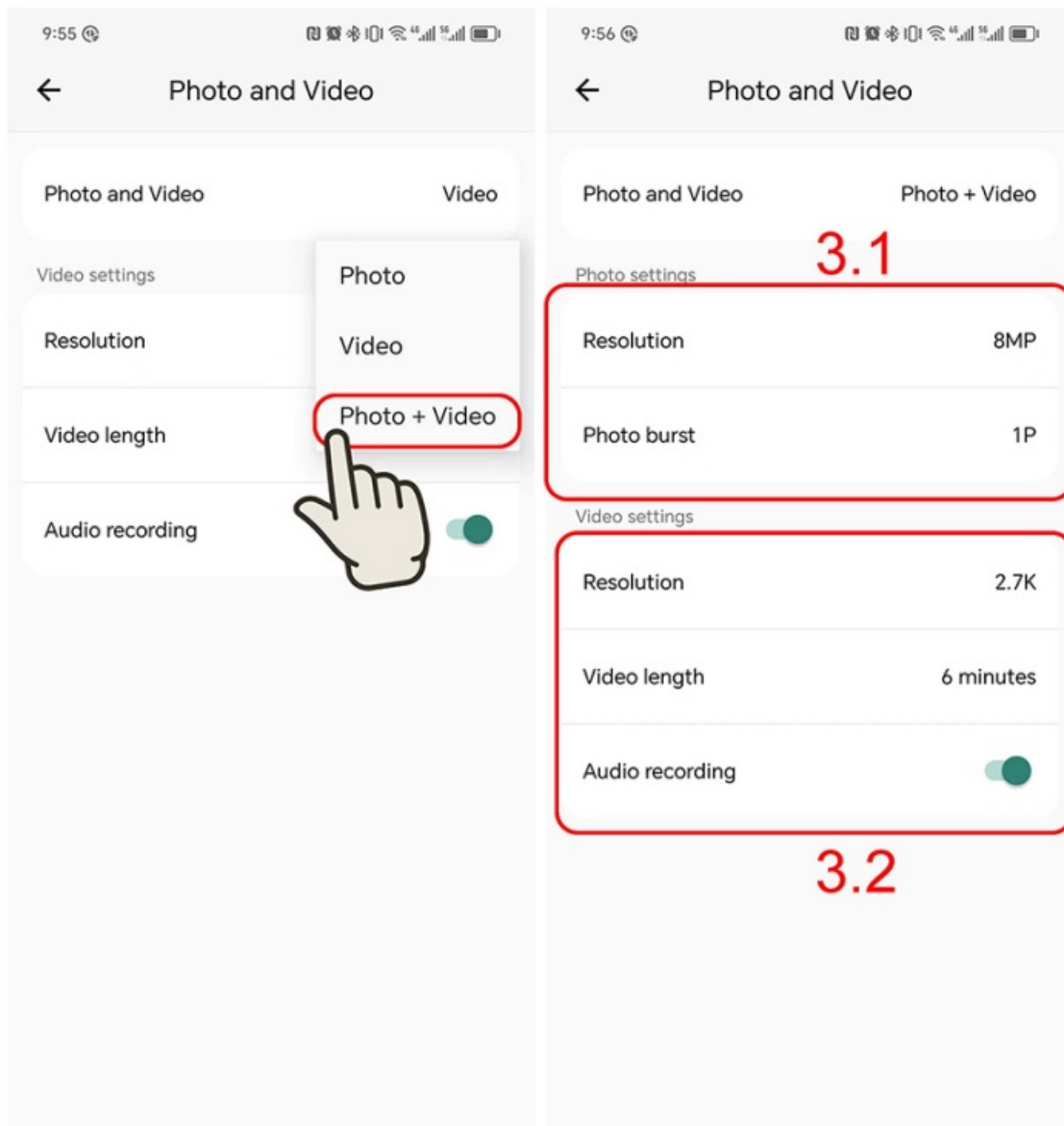

Step 4: Return to “Settings,” choose “Motion Detection,” and fine-tune the camera’s detection sensitivity. Select from three levels: Low sensitivity (range approximately 3 meters), Medium sensitivity (range approximately 4-5 meters), High sensitivity (range approximately 7-8 meters). Choose the “Detection Interval” from 5 seconds to 1 hour, enable “Motion Detection Filter,” then tap “Detection Area” to add the activity zone for motion detection. Finally, click “Save” to apply the changes.

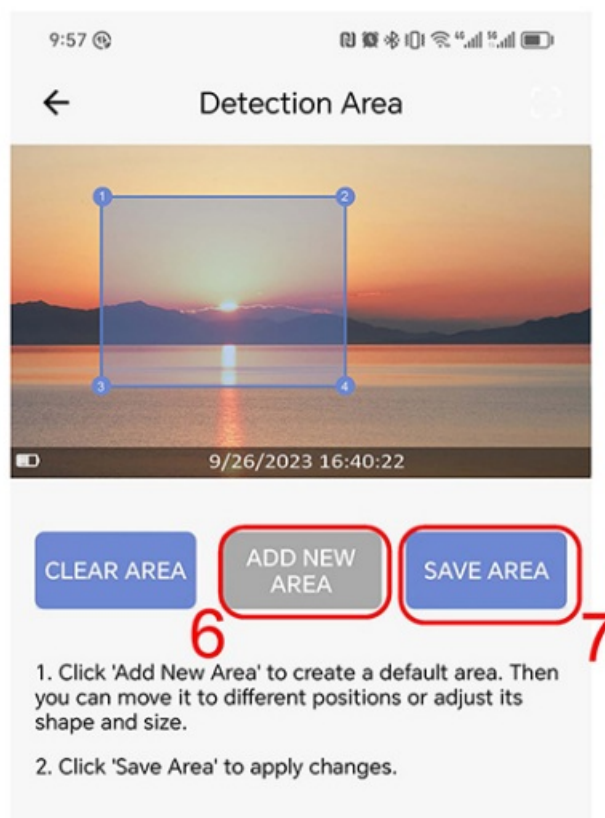
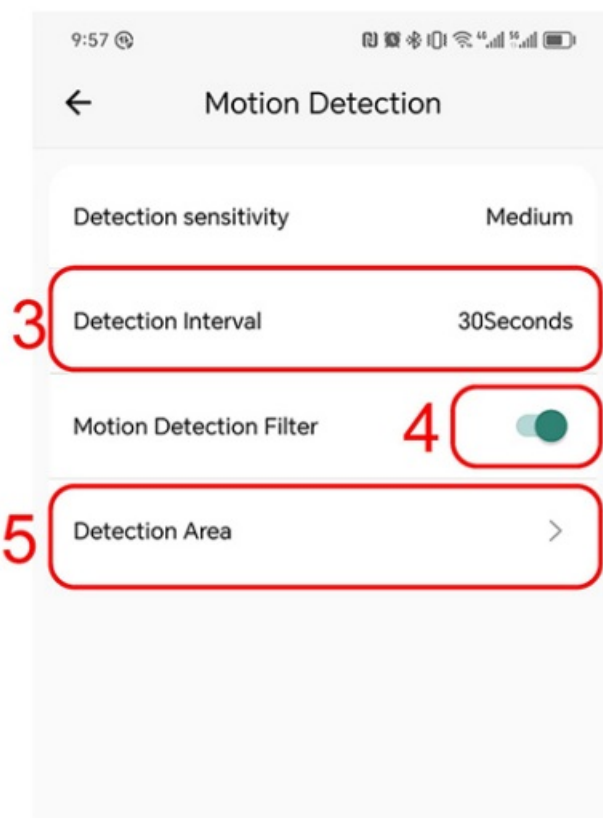
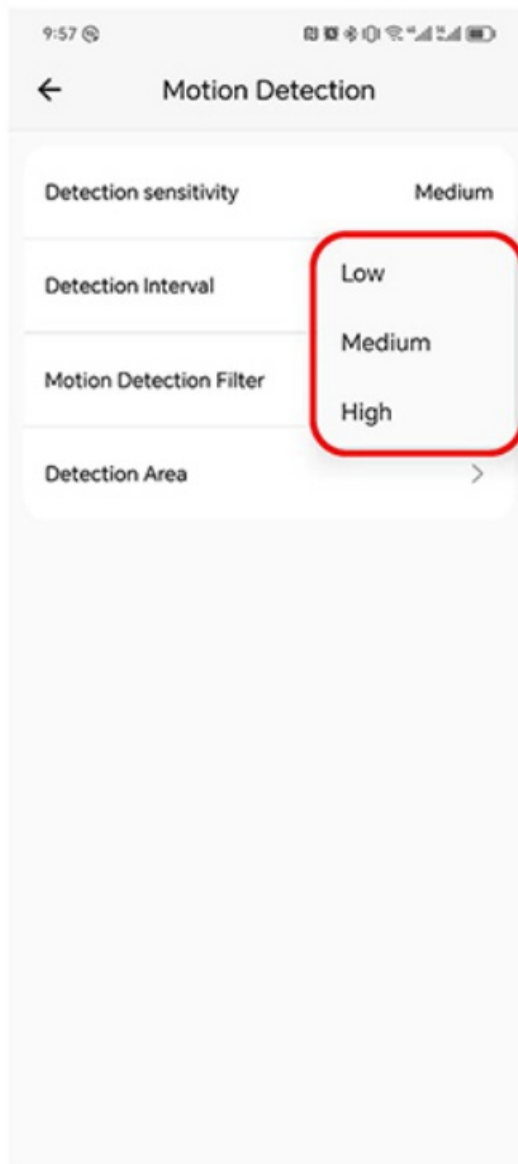
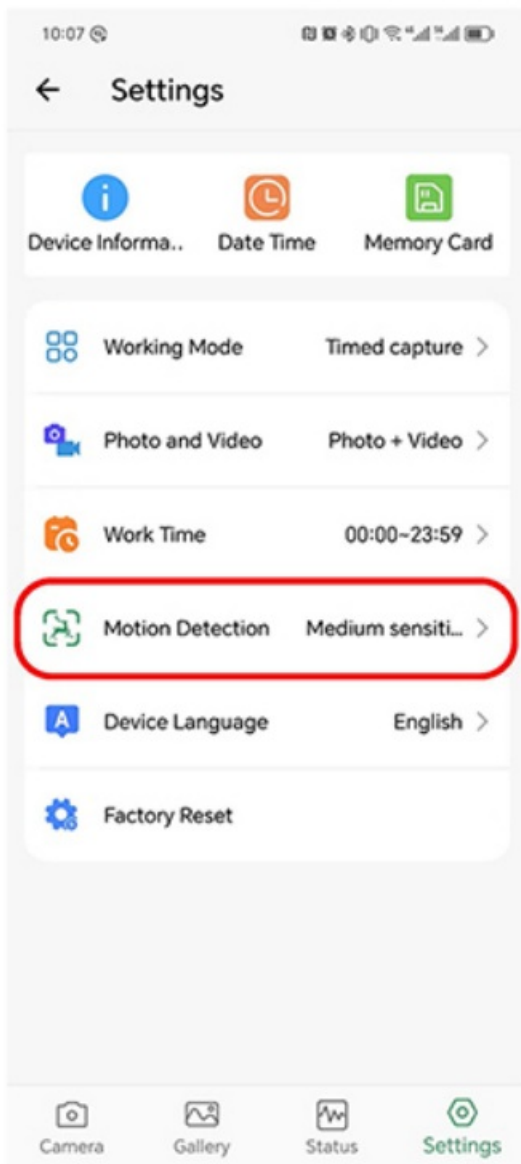

Remark: In the settings, you can choose how often the camera detects motion, anywhere from 5 seconds to 1 hour. For example, with a 30-second interval, after taking a photo or recording a video, the camera waits for 30 seconds. To capture another photo or video, there needs to be movement by a person, warm object, or animal within the specified distance during this 30-second waiting period. It's important to note that if there is no movement within the first 30 seconds, the camera won't trigger. This logic applies according to the chosen interval duration..

Timed Capture Configuration

Step 1: Navigate to the “Settings” in the App and enter the device’s settings menu. Select “Working Mode.”

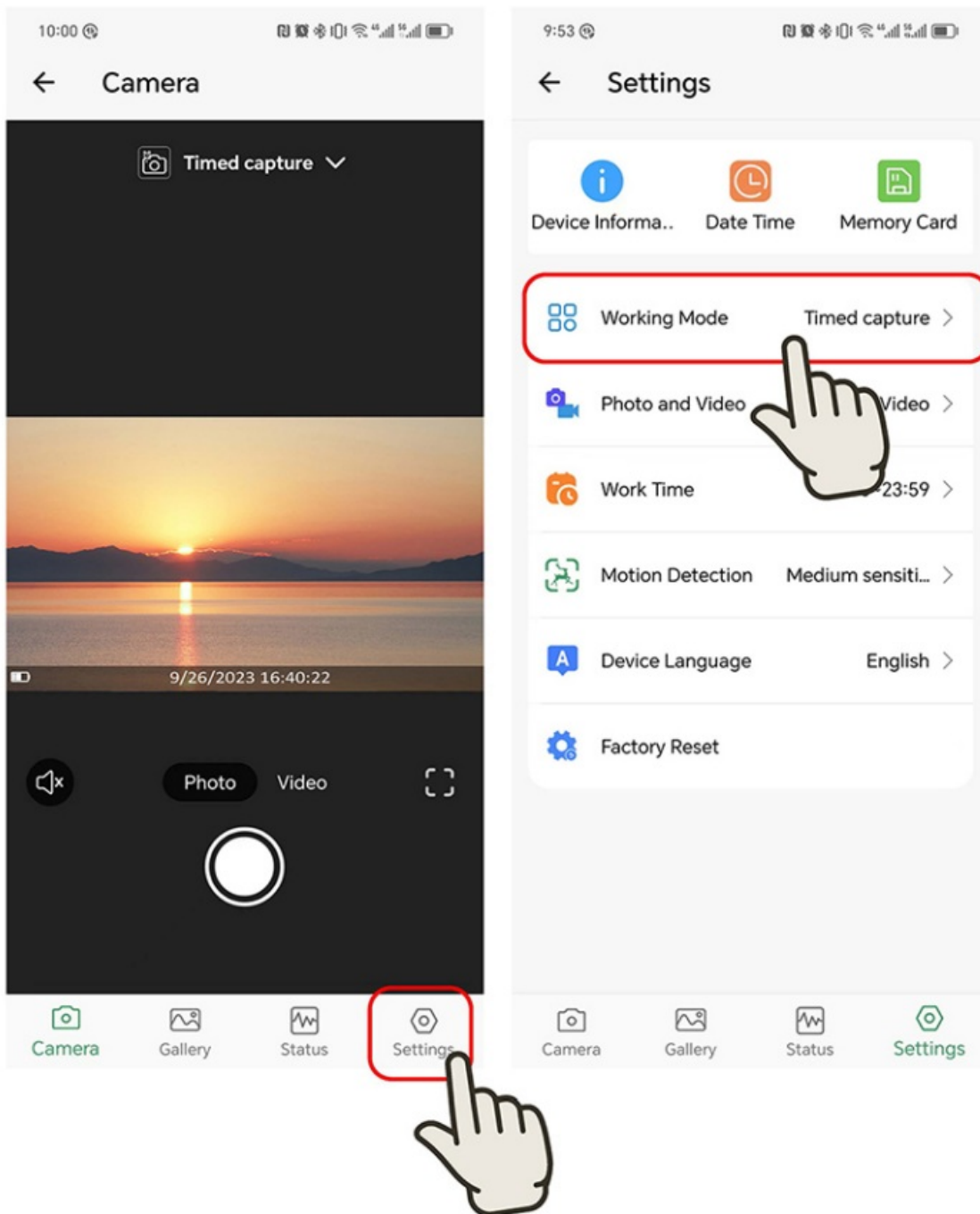

Step 2: Select “Timed Capture” from the “Mode” options. Choose the capture interval by specifying the desired time. Ensure to tap the “Confirm” button once all settings are configured.

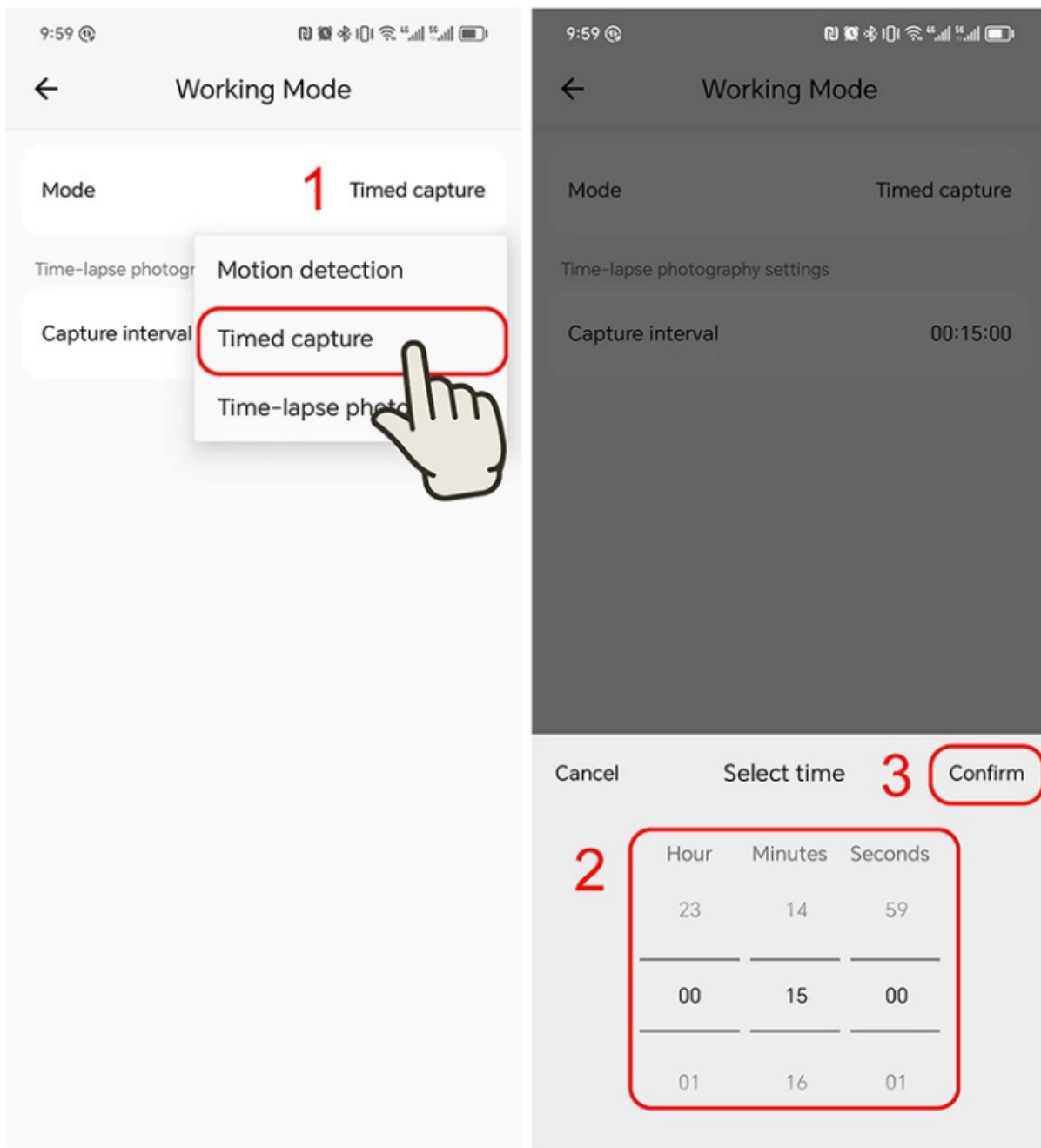

Step 3: Return to “Settings” and choose “Photo and Video” to access the three working modes (Photo-Only, Video-Only, Photo and Video Combined). Select the mode that suits your requirements.

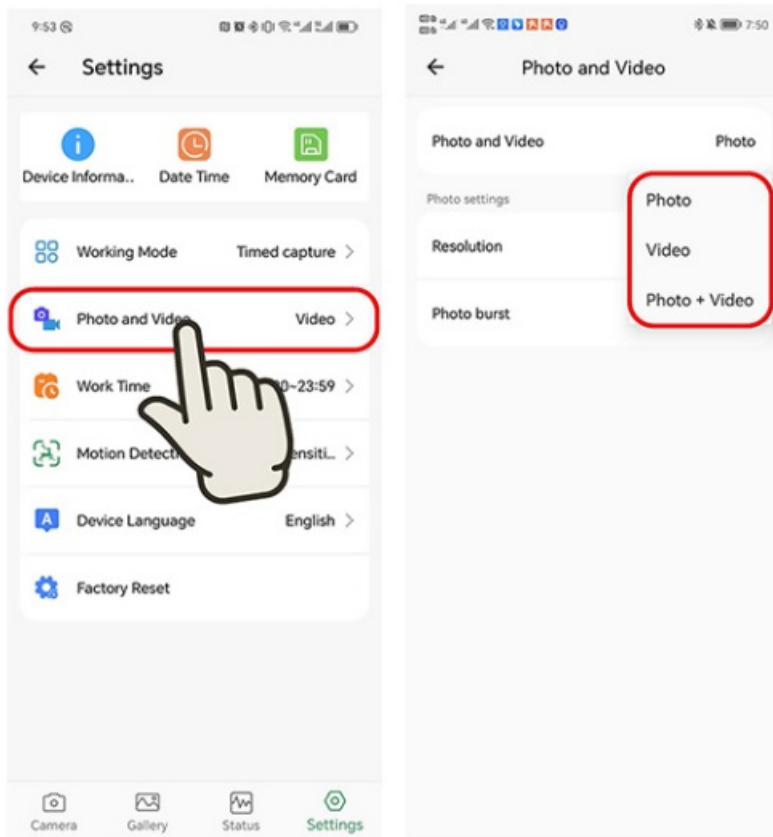

1. **Select Photo Mode:**

Configure photo resolutions ranging from 2MP to 32MP and set the Photo Burst from IP to SP through the "Photo Settings." Return to the Settings menu once all configurations are confirmed.

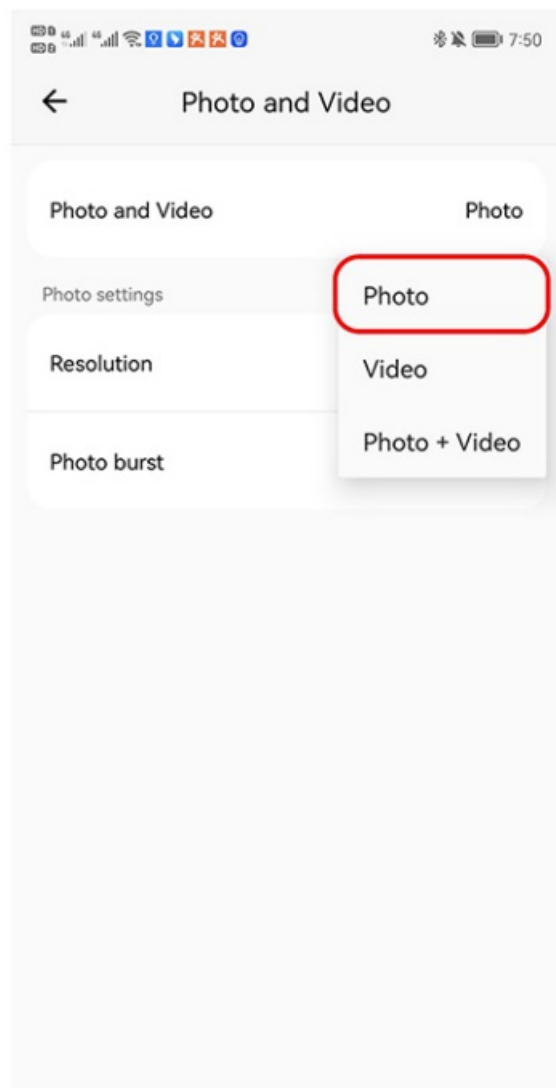

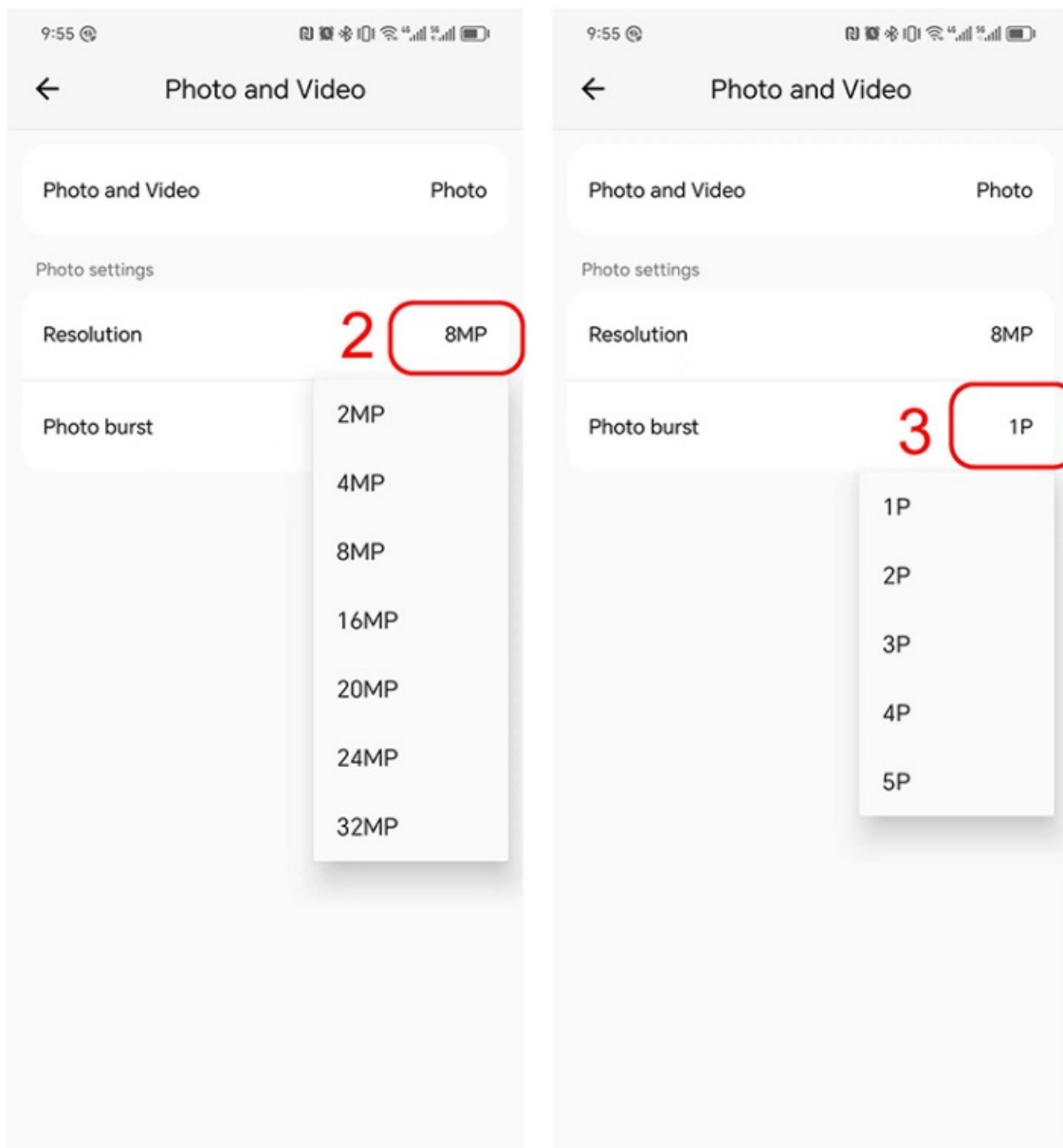

2. Select Video Mode:

Configure video resolutions, choosing from 720P, 1080P, and 2.7K. Adjust video recording length from 5 seconds to 10 minutes and enable/disable audio recording as needed.

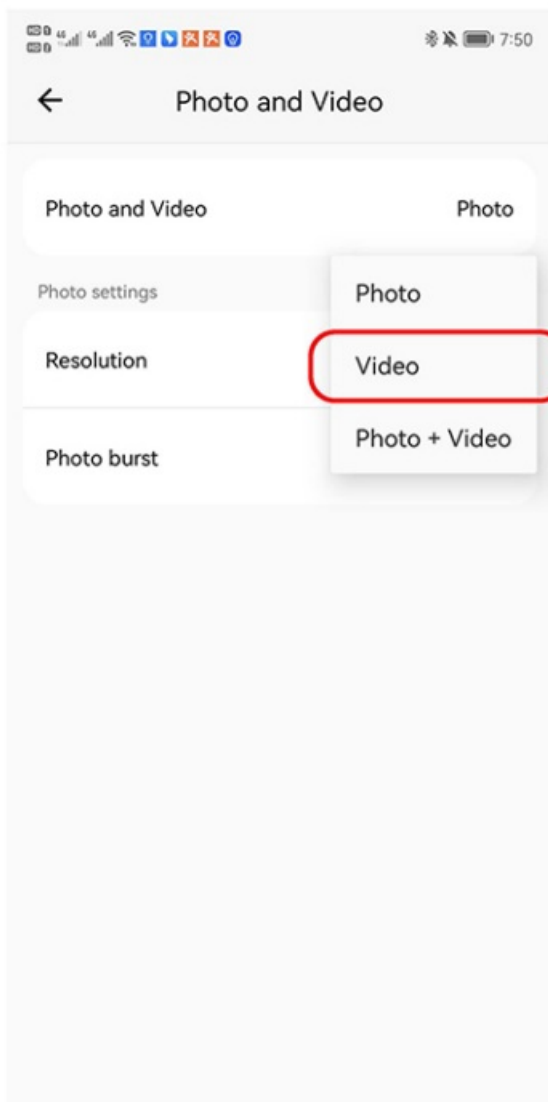

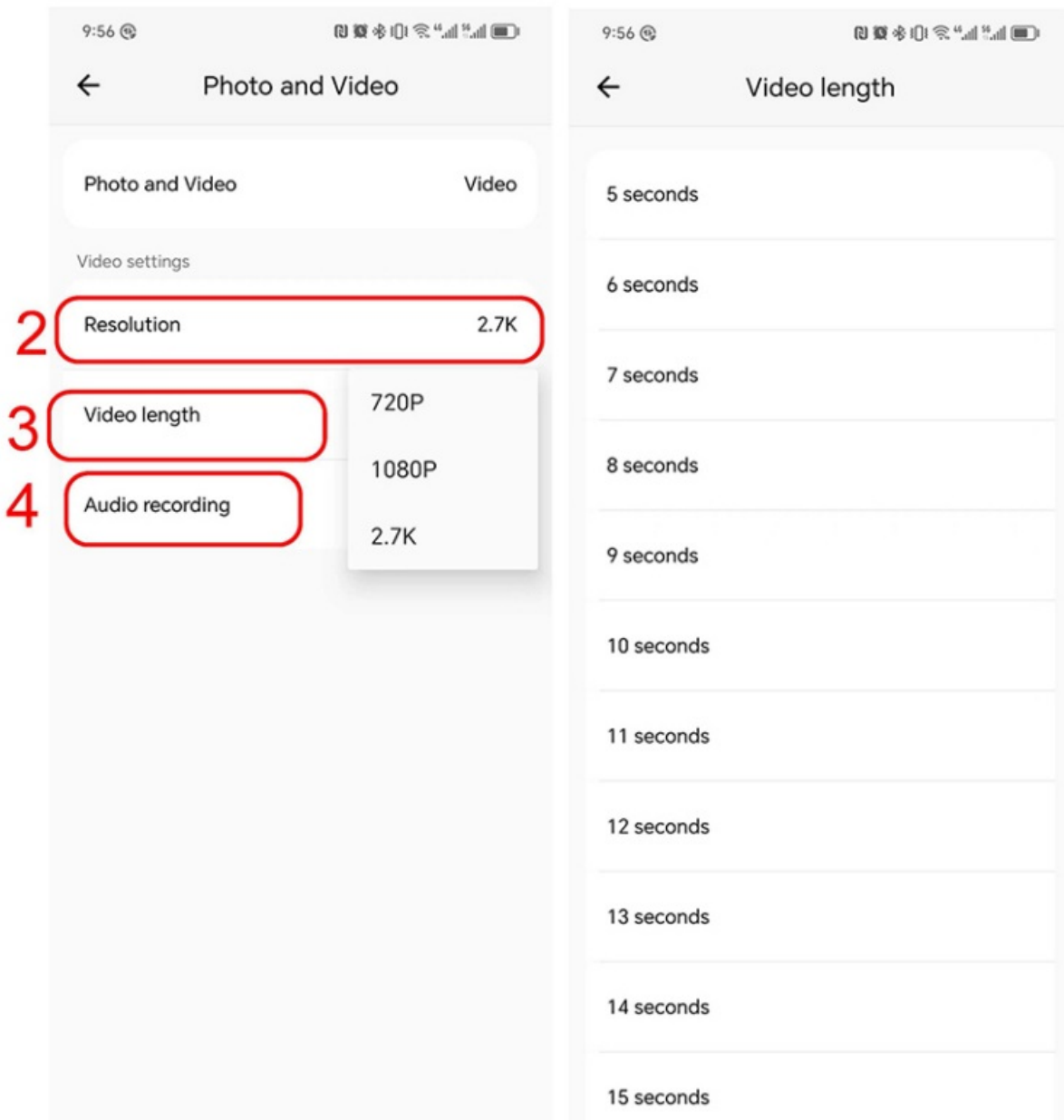

3. Select Photo and Video:

1. Configure photo settings, including resolutions (2MP-32MP) and burst mode (1P to SP). Confirm settings and return to the main menu.
2. Set up video preferences, choosing resolutions (720P, 1080P, 2.7K), recording duration {5 seconds to 10 minutes), and audio recording options. Adjust as needed and confirm changes.

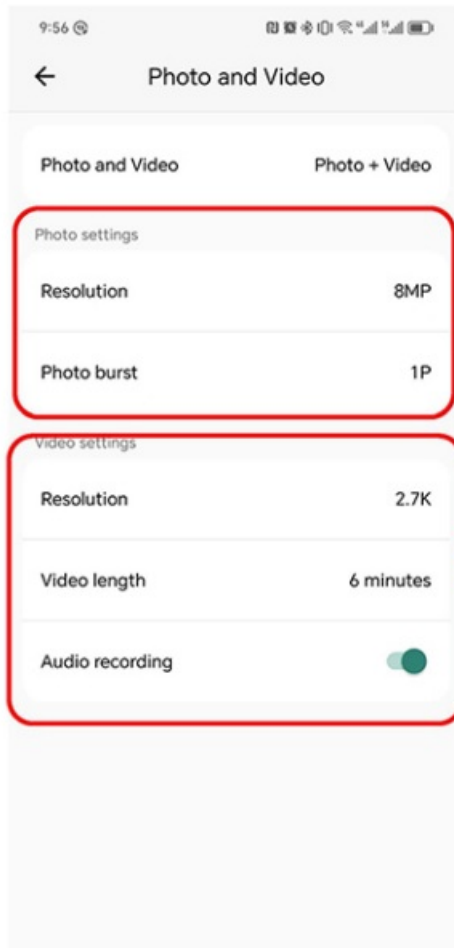
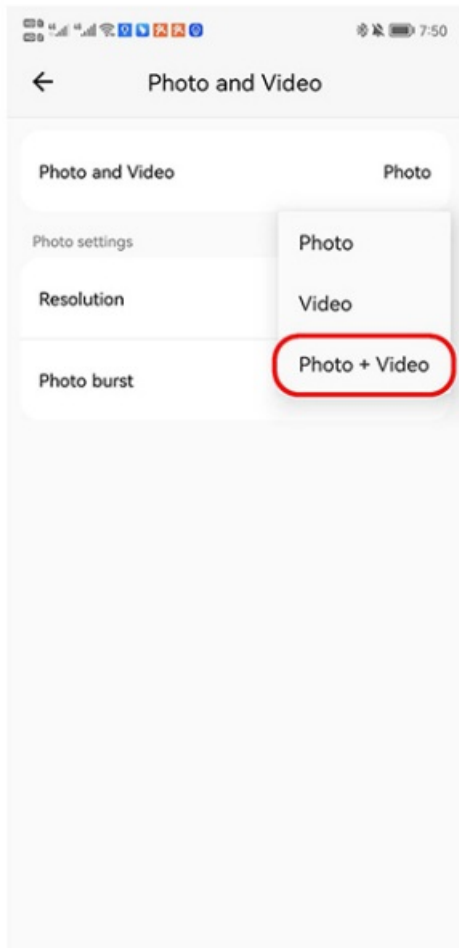

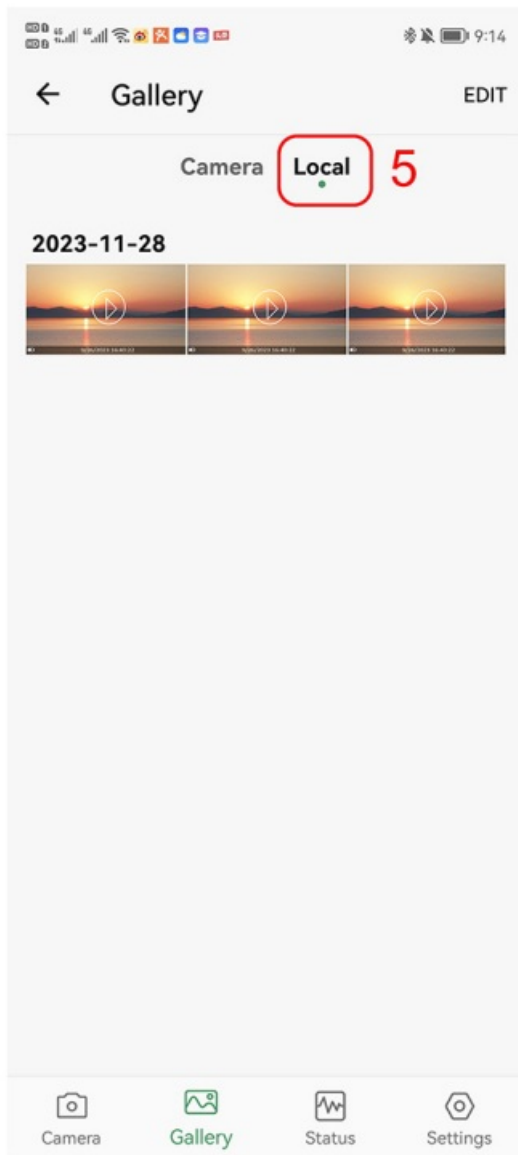

Other Settings from Time Lapse Camera Via App

1. **Device Info:** Displays current details and version information of the camera
2. **Date & Time:** Allows for the configuration of time format settings.
3. **Memory Card:** Shows the capacity of the micro SD card, with an option to format the card.
4. **Work Time:** Can be set for continuous use throughout the day or specific time periods.
5. **Device Language:** Offers a choice of 11 languages: Chinese, English, French, Spanish, Dutch, Italian, Polish, Russian, Korean, Japanese, and Polish.
6. **Factory Reset:** Resets the device to its factory default settings.

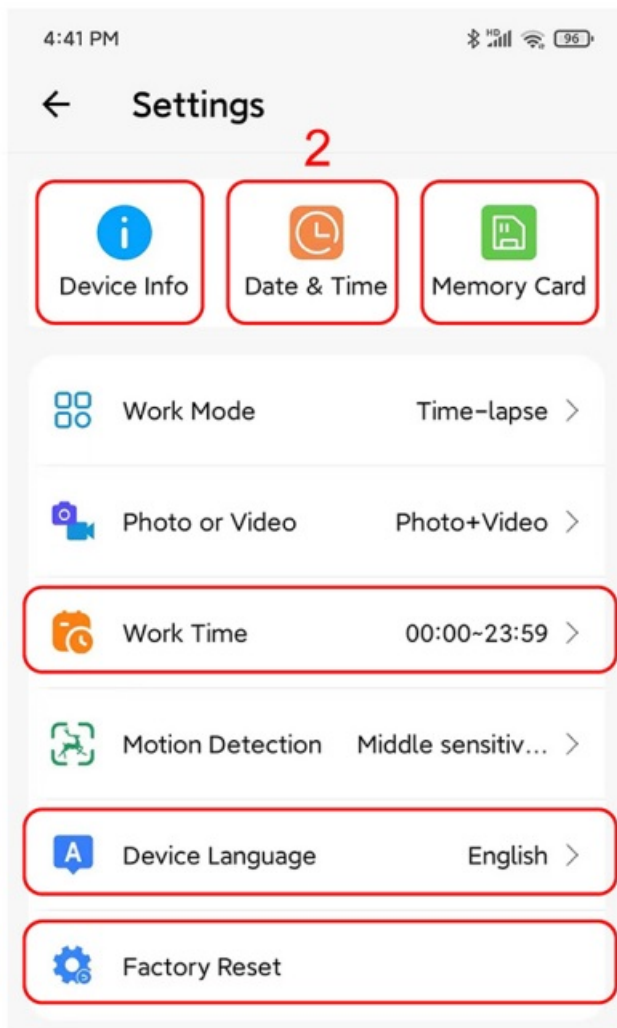

Thank you very much for purchasing our products.

Customer Support



<https://www.ipcamerasolar.com>



fuvision@aliyun.com

Documents / Resources

	<p>ALIYUN S2 Time Lapse Camera [pdf] User Guide S2 Time Lapse Camera, S2, Time Lapse Camera, Lapse Camera, Camera</p>
--	-------------------------------------------------------------------------------------------------------------------------------------------

References

- [User Manual](#)

[Manuals+](#), [Privacy Policy](#)