

ALESIS
LDMFCore
Drum
Module

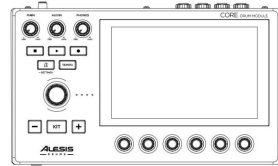

ALESIS LDMFCore Drum Module User Guide

[Home](#) » [Alesis](#) » ALESIS LDMFCore Drum Module User Guide 

Contents

- 1 ALESIS LDMFCore Drum Module
- 2 Product Specifications
- 3 Product Usage Instructions
- 4 Frequently Asked Questions (FAQ)
- 5 GETTING STARTED
- 6 CONNECTION DIAGRAM
- 7 OPERATION
- 8 USING INSTRUCTION
- 9 Important Safety Instructions
- 10 Safety Notices
- 11 FCC NOTE
- 12 ABOUT COMPANY
- 13 Documents / Resources
 - 13.1 References

ALESIS

ALESIS LDMFCore Drum Module

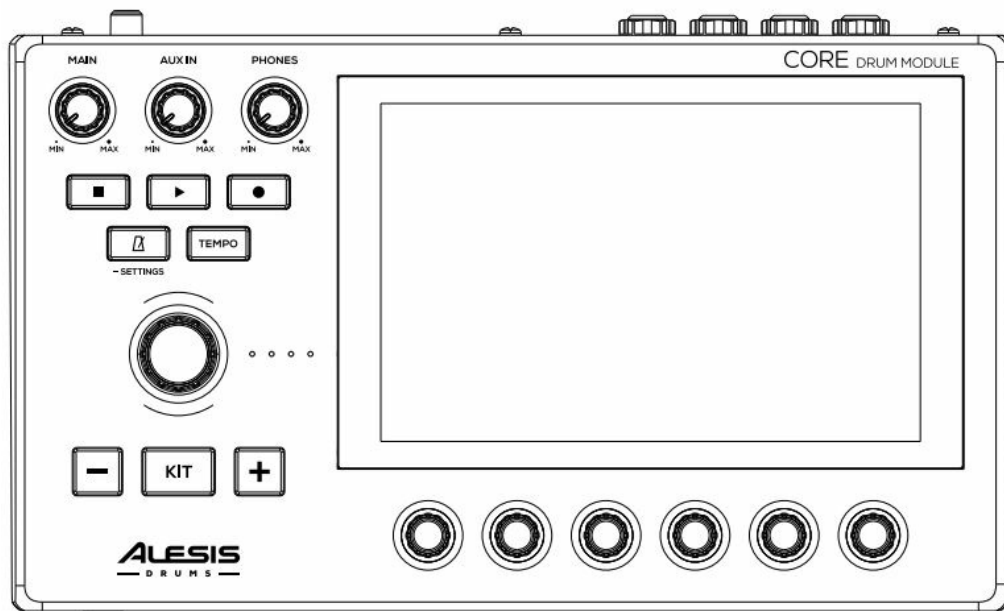

Product Specifications

- **Model:** LDMF
- **Power Adapter:** 12V, 2A center positive
- **Main Output:** 1/4 [6.35 mm] TRS
- **Aux Input:** 1/8 [3.5 mm] TRS
- **USB-A Port:** exFAT or FAT32 formatted

Product Usage Instructions

Connection Setup:

1. Connect the power adapter to the designated port.
2. For importing samples, connect a USB drive to the USB-A port.
3. Use the USB-B port to connect to a computer for MIDI data transfer.
4. Connect external MIDI devices to the MIDI Input/Output ports.
5. Attach trigger cables to the Trigger Inputs for additional drum pad/cymbal signals.
6. Connect monitors, mixers, etc., to the Main Output port.
7. For audio sources, use the Aux Input port.

Operation:

1. Interact with the touchscreen display for control and information.
2. Adjust the Main Outputs level using the Main knob.
3. Use Aux In knob to adjust the Aux Input level.
4. Control headphone outputs level with the Phones knob.
5. Utilize transport controls for playback and recording functions.
6. Turn on/off the metronome and adjust the settings.
7. Change kits, edit parameters, and navigate menus using the Main Encoder.

Using the Touch Screen:

Tap buttons or options on the touch screen for selection.

Triggering Sounds:

1. Securely mount drum pads to the rack on a stable surface.
2. Connect drum pads to trigger inputs.
3. Connect speakers/headphones to CORE.
4. Power on CORE and hit a pad to trigger sounds.

Selecting a Kit:

1. To access the Kit selection mode, press the Kit button.
2. Navigate through kits using buttons or touch screens.
3. Select a kit by tapping on the touch screen or pressing the Main Encoder.

Frequently Asked Questions (FAQ)

- **How do I import samples using a USB drive?**

Connect a USB drive formatted as exFAT or FAT32 to the USB-A port for sample import.

- **Can I connect headphones directly to the module?**

Yes, you can connect standard stereo headphones to the front panel outputs of the module.

- **What is the recommended power adapter specification for this product?**

The recommended power adapter is 12V, 2A center positive.

GETTING STARTED

Package Contents: Core Drum Module, Power Cable, Quickstart Guide, Box Contents and Assembly Guide, Safety & Warranty Manual

- [ALESIS.COM](https://www.alesis.com)
- REGISTER YOUR PRODUCT
- DOWNLOAD THE USER GUIDE
- DOWNLOAD INCLUDED SOFTWARE
- WATCH TUTORIAL VIDEOS



CONNECTION DIAGRAM

1. **Power:** Connect the included power adapter (12V, 2A center positive) here.
2. **USB-A Port:** Connect a USB drive (exFAT or FAT32 formatted) to import samples.
3. **USB-B Port:** Connect to a computer's USB port to send/receive MIDI data.
4. **MIDI Input/Output:** Connect to external MIDI devices (synthesizer, drum machine, etc.).
5. **Trigger Inputs (1/4" [6.35 mm] TRS):** Connect trigger cables here to receive signals from an additional connected drum pad and cymbal.
6. **Main Output (1/4" [6.35 mm] TRS):** Connect your monitors, mixer, etc. here.
7. **Aux Input (1/8" [3.5 mm] TRS):** Connect to an audio source (phone, mixer, synthesizer, sampler, etc.).
8. **Module Mount:** Connect the included module mount to CORE's bottom panel using the 2 supplied screws to secure the rack. Use the supplied screws only.

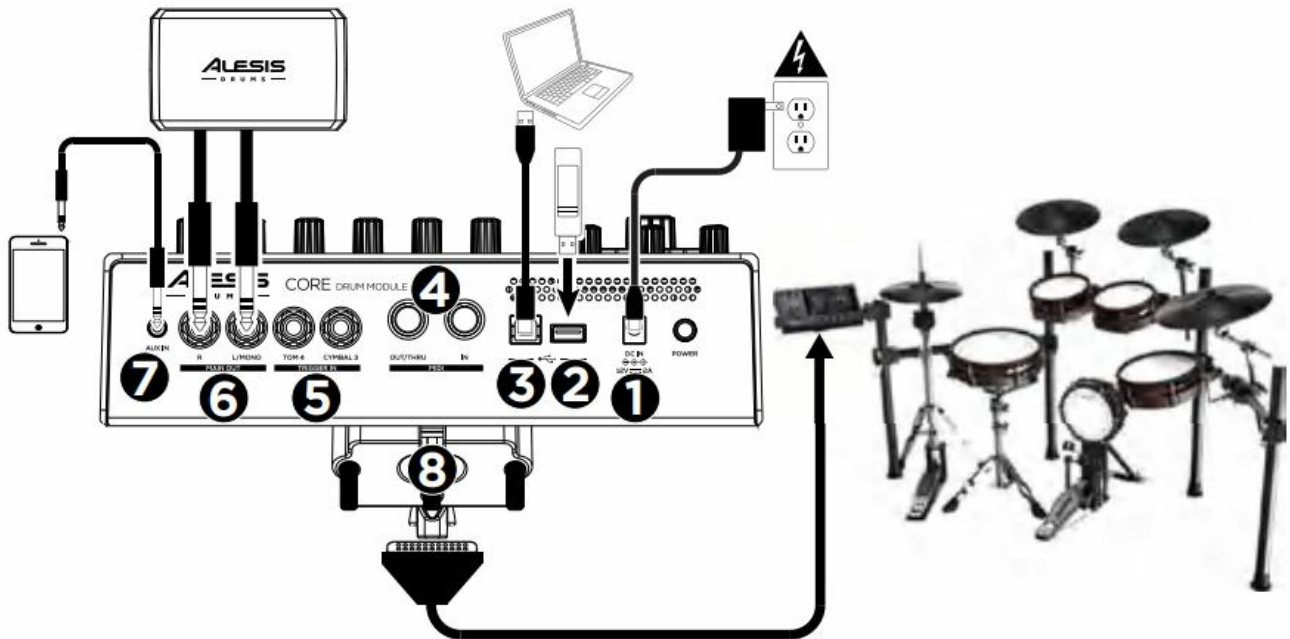

OPERATION

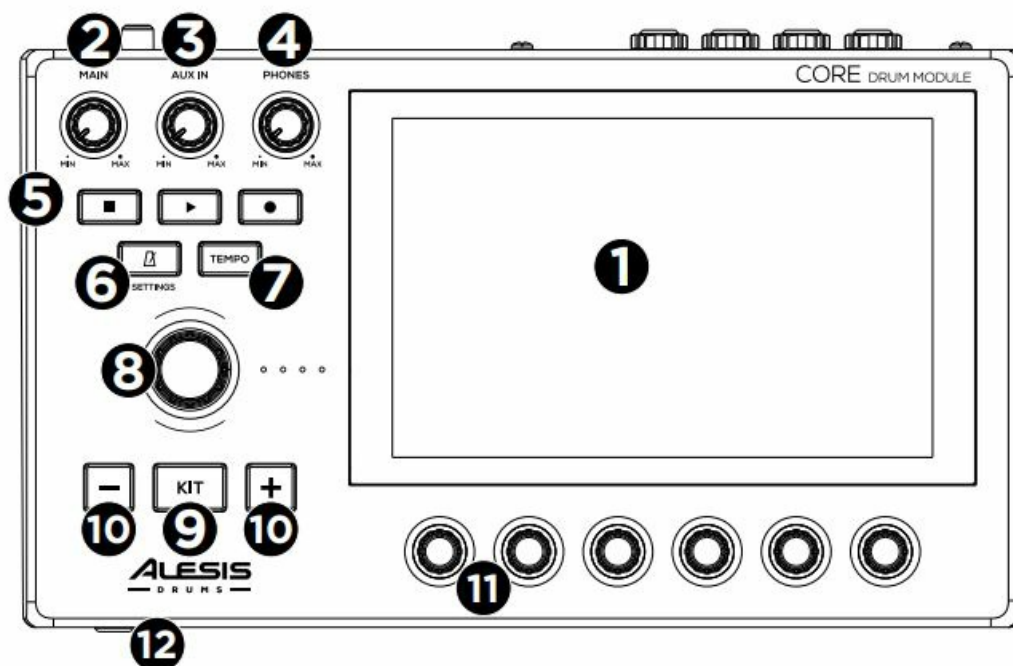

1. **Touch Screen Display:** The full-color 7" multi-touch display shows information relevant to the current

operation. Touch the display (and use the hardware controls) to control the interface.

2. **Main:** Turn this knob to adjust the level of the Main Outputs.
3. **Aux In:** Turn this knob to adjust the level of the Aux Input.
4. **Phones:** Turn this knob to adjust the level of the headphone outputs.
5. **Transport Controls:** Use these controls to start/stop playback and recording.
6. **Metronome:** Press to turn the metronome on/o. Press and hold to open the Metronome menu.
7. **Tap Tempo:** Tap this button to manually enter a tempo.
8. **Main Encoder (with push functionality):** Turn this to change kits, edit on-screen parameters, navigate menus, and more.
9. **Kit Button:** Press to toggle between Kit mode and the other current active mode (Kit Edit, Mixer, Backing Track, Trigger Edit, and Settings).
10. **Selection Up/Down:** Press these buttons to move your selection up or down. The functionality of these buttons depends on what current mode is active.
11. **Small Encoders:** Turn these to adjust parameters in the menus such as volume levels, panning, etc.
12. **Headphone Output (Front panel, 1/8" [3.5 mm] or 1/4" [6.35 mm] stereo):** Connect standard stereo headphones to one of these front panel outputs.

USING INSTRUCTION

Using the Touch Screen

Tap a button or option to enable it or select it on the Touch Screen.

Triggering a Sound

1. Ensure the drum pads are mounted securely to the rack. Place the rack on a carpet or drum rug to reduce vibration and prevent it from moving.
2. Connect drum pads to the applicable trigger inputs.
3. Connect speakers or headphones to CORE.
4. Power on CORE.
5. Hit a pad to trigger a sound.

Selecting a Kit

To enter Kit selection mode, (if the Kits menu is not shown), press the Kit button to list the kits on-screen. Press the +/- buttons, use the Touch Screen to scroll up/down, or use the Main Encoder to view the list of kits. Tap the kit on the Touch Screen or press the Main Encoder to select the kit.

Editing a Kit

To edit a Kit, from the Kit mode press the Kit Edit button. Touch a drum trigger slot to select it for editing. Swipe up/down, use the +/- buttons, or scroll with the Main Encoder to assign the selected Instrument to that zone.

Removing Crosstalk Issues

If you are experiencing crosstalk (striking one drum will trigger another), from the Kit mode go to the Trigger Edit menu, select the Zone (KD, SD, T1, etc.) that's causing the crosstalk, and select Learn XTalk. Follow the on-screen instructions. Once changes have been made, press Save. Repeat this process for any other drums or cymbals you're experiencing crosstalk with.

Adjusting the Hi-Hat Pedal

To optimize performance for your particular hi-hat stand, run the hi-hat calibration found in the Trigger Edit menu

and tap the HH Setup button. Follow the on-screen instructions to complete the calibration. To fine-tune the hi-hat performance, in the Trigger Edit mode tap the HH trigger slot, then tap the Advanced tab. Adjust the Pedal Bottom parameter until you are comfortable with the performance of the open and closed hi-hat sounds.

DOWNLOAD THE FULL USER GUIDE TO LEARN MORE [ALESIS.COM](https://www.alesis.com)

Important Safety Instructions

1. Read and keep these instructions. Heed all warnings and followed all Instructions.
2. Warning (if applicable): Please refer to any important information (e.g., electrical, safety, etc.) printed on the exterior bottom enclosure or rear panel before installing or operating the product.
3. Clean only with a dry cloth.
4. Water and Moisture (if applicable): Do not use this apparatus near water. The apparatus shall not be exposed to dripping or splashing and no objects filled with liquids, such as vases, shall be placed on the apparatus. Electrical equipment should NEVER be kept or stored in damp environments.
5. (If applicable) Do not block any ventilation openings. Install it by the manufacturer's instructions. Do not install this equipment in a confined or "boxed-in" space such as a bookcase or similar unit, and maintain good ventilation conditions. The ventilation should not be impeded by covering the ventilation openings with items such as newspapers, tablecloths, curtains, etc.
6. Do not install near any heat sources such as radiators, heat registers, stoves, or other apparatus (including amplifiers) that produce heat. Do not place exposed flame sources such as lighted candles on the apparatus.
7. (If applicable) This product should be connected to a power supply only of the type described in these operating instructions, or as marked on the unit.
8. (If applicable) Be careful not to damage the power cord. When moving or not using the appliance, secure the power cord (e.g., wrap it with a cable tie). Before using it again, make sure the power cord has not been damaged. If the power cord has been damaged at all, bring the unit and cord to a qualified service technician for repair or replacement as specified by the manufacturer.
9. Unplug this apparatus during lightning storms or when unused for long periods.
10. Only use attachmentst/accessories specified by the manufacturer.
11. (If applicable) Use only the cart, stand, tripod, bracket, or table specified by the manufacturer, or sold with the apparatus. When a cart is used, use caution when moving the cart/apparatus combination to avoid injury from tip-over.
12. Internal/External Voltage Selectors (if applicable): Internal or external voltage selector switches, if any, should only be reset and re-equipped with a proper plug for alternative voltage by a qualified service technician. Do not attempt to alter this yourself.
13. Caution (if applicable): Danger of explosion if the battery is incorrectly replaced. Replace only with the same or equivalent type. Batteries (a battery pack or an installed battery) shall not be exposed to excessive heat such as sunshine, fire, etc.
14. (If applicable) Do not defeat the safety purpose of the polarized or grounding-type plug.
15. Protective earthing terminal (if applicable): The apparatus should be connected to a main socket outlet with a protective earthing connection.
 - Denmark (Danmark): Apparatets stikprop skal tilsluttes en stikkontakt med jord, som giver forbindelse til stikproppens jord.
 - Finland (Suomi): Laite on liitettävä suojakoskettimilla varustettuun pistorasiaan.
 - Norway (Norge): Apparatet må tilkoples jordet stikkontakt.
 - Sweden (Sverige): Apparatens skall anslutas till jordat uttag.

16. For Class II apparatus only: This symbol means the equipment is a Class II or double-insulated electrical appliance. It has been designed in such a way that it does not require a safety connection to electrical earth. When servicing use only identical replacement parts installed by an instructed person or with the use of ready-made leads or cords.
17. Warning (if applicable): Provide an earthing connection before the mains plug is connected to the mains. When disconnecting the earthing connection, be sure to disconnect it after pulling the mains plug out from the mains.
18. (If applicable) Where the mains plug or an appliance coupler is used as the disconnect device, the disconnect device shall remain readily operable.
19. Warning (if applicable): To prevent possible hearing damage, do not listen at high volume levels for long periods.
20. This apparatus is for professional use only. Intended operational climate: moderate.

Safety Notices

- **CAUTION:** TO REDUCE THE RISK OF ELECTRIC SHOCK, DO NOT REMOVE ANY COVER. NO USER-SERVICEABLE PARTS INSIDE. REFER SERVICING TO QUALIFIED SERVICE PERSONNEL ONLY.
- **DANGEROUS VOLTAGE:** The lightning flash with the arrowhead symbol within the equilateral triangle is intended to alert the user to the presence of un-insulated “dangerous voltage” within the product’s enclosure that may be of sufficient magnitude to constitute a risk of electric shock.
- **INSTRUCTIONS:** The exclamation point within the equilateral triangle is intended to alert the user to the presence of important operating and maintenance (servicing) instructions in the literature accompanying this appliance.
- **CAUTION (for U.S.A. & CANADIAN models only):** TO PREVENT ELECTRIC SHOCK DO NOT USE THIS (POLARIZED) PLUG WITH AN EXTENSION CORD, RECEPTACLE OR OTHER OUTLET UNLESS THE BLADES CAN BE FULLY INSERTED TO PREVENT BLADE EXPOSURE.
- **NOTICE CONCERNING LASER PRODUCTS:** DANGER: INVISIBLE LASER RADIATION WHEN OPEN AND INTERLOCK FAILED OR DEFEATED. AVOID DIRECT EXPOSURE TO BEAM. USE OF CONTROLS OR ADJUSTMENTS OTHER THAN THOSE SPECIFIED HEREIN MAY RESULT IN HAZARDOUS RADIATION EXPOSURE.
- **NOTICE CONCERNING FCC REGULATIONS:** You are cautioned that changes or modifications not expressly approved by the party responsible for compliance could void the user’s authority to operate the equipment. This equipment has been tested and found to comply with the limits for a Class B digital device, under Part 15 of the FCC rules. These limits are designed to provide reasonable protection against harmful interference in a residential installation. This equipment generates uses and can radiate radio frequency energy and, if not installed and used by the instructions, may cause harmful interference to radio communications. However, there is no guarantee that interference will not occur in a particular installation. If this equipment does cause harmful interference to radio or television reception, which can be determined by turning the equipment off and on, the user is encouraged to try to correct the interference by one or more of the following measures:
 - reorient or relocate the receiving antenna;
 - move this unit; (c) increase the separation between the equipment and receiver;
 - connect the equipment to an outlet on a circuit different from that to which the receiver is connected;
 - be sure that all cables are properly shielded, using a choke or ferrite where appropriate;
 - consult the dealer or an experienced radio/television technician for help. This equipment (if applicable)

should be installed and operated with a minimum distance of 20 cm between the radiator and your body.

- **RF Warning Statement (if applicable):** The device has been evaluated to meet general RF exposure requirements. Avoid using this device in a high RF-radiated environment.

FCC NOTE

For Canadian models: This device contains license-exempt transmitters/receivers that comply with Innovation, Science and Economic Development (ISED) Canada's license-exempt RSS(s). Operation is subject to the following two conditions:

1. this device may not cause interference
2. this device must accept any interference, including interference that may cause undesired operation of the device.

Under ISED regulations, this radio transmitter may only operate using an antenna of a type and maximum (or lesser) gain approved for the transmitter by ISED. To reduce potential radio interference to other users, the antenna type and its gain should be so chosen that the equivalent isotropically radiated power (e.i.r.p.) is not more than that necessary for successful communication. This radio transmitter (identify the device by certification number, or model number if Category I) has been approved by ISED to operate with the antenna types listed below with the maximum permissible gain and required antenna impedance for each antenna type indicated. Antenna types not included in this list, having a gain greater than the maximum gain indicated for that type, are strictly prohibited for use with this device. This unit does not exceed the Class B limits for radio noise emission from digital apparatus set out in the radio interference regulations of the Canadian Department of Communications. This device operates on a no-protection, no-interference basis. Should the user seek to obtain protection from other radio services operating in the same TV bands, a radio license is required. For further details, consult Innovation, Science and Economic Development Canada's document Client Procedures Circular CPC-2-1-28, Voluntary Licensing of Licence-Exempt Low-Power Radio Apparatus in the TV Bands.

Radiation Exposure Statement: This equipment complies with ISED radiation exposure limits set forth for an uncontrolled environment. This equipment (if applicable) should be installed and operated with greater than 20 cm between the radiator & your body.

For wireless products supporting the 5.15-5.35 GHz frequency band (if applicable):

Usage of the 5.15- 5.35 GHz band is restricted to indoor operation only. This applies to the following countries: AT, BE, BG, CZ, DK, EE, FR, DE, IS, IE, IT, EL, ES, CY, LV, LI, LT, LU, HU, MT, NL, NO, PL, PT, RO, SI, SK, TR, FI, SE, CH, UK, HR.

For 240-volt use in the U.S., use a NEMA-style 240-volt plug. For other countries use the proper plug for a local outlet.

- **ESD/EFT Warning:** This unit may contain a microcomputer for signal processing and control functions. In very rare situations, severe interference, noise from an external source, or static electricity may cause it to lock up. In the unlikely event that this should happen, turn off the unit, wait at least five seconds, and then turn it back on again. The pins of connectors identified with this ESD warning symbol should not be touched.
- **Correct Disposal of This Product:** This marking indicates that this product should not be disposed of with other household wastes throughout the EU. To prevent possible harm to the environment or human health from uncontrolled waste disposal, recycle it responsibly to promote the sustainable reuse of material resources. To return your used device, please use the return and collection systems or contact the retailer where the product was purchased. They can take this product for environmentally safe recycling.

If the product or remote control contains a button cell or coin battery (CR1220, CR2025, or CR2032; 3.0 VDC):

WARNING

- **INGESTION HAZARD:** This product contains a button cell or coin battery.
 - **DEATH** or serious injury can occur if ingested. A swallowed button cell or coin battery can cause Internal Chemical Burns in as little as 2 hours.
 - **KEEP** new and used batteries **OUT OF REACH** of **CHILDREN**.
 - Seek immediate medical attention if a battery is suspected to be swallowed or inserted inside any part of the body. Call a local poison control center for treatment information.
- Button cell or coin batteries located inside the product are non-replaceable.
- Do not force discharge, recharge (non-rechargeable batteries are not to be recharged), disassemble, heat above the manufacturer's specified temperature rating or incinerate. Doing so may result in injury due to venting, leakage, or explosion resulting in chemical burns.

Disposal of Batteries (if applicable):

Remove and immediately recycle or dispose of used batteries according to local regulations and keep them away from children. Even used batteries may cause severe injury or death. Do NOT dispose of batteries in household trash or incinerate them. Overheated batteries can rupture or explode. If you are unsure of how or where to dispose of a battery, refer to your local ordinances for the proper location, method, etc.

- **Alkaline batteries & lithium button cell batteries:** You can safely dispose of alkaline and lithium button cell batteries with normal household waste. They do not pose a health or environmental risk during normal use or disposal. (Alkaline batteries are composed primarily of common metals like steel, zinc, and manganese.) Do not dispose of large amounts of alkaline or lithium button cell batteries in a group. Used batteries are often not completely "dead." Grouping them can bring these "live" batteries into contact with one another, creating safety risks. To avoid this, insulate each battery with tape or other non-conductive material to ensure it does not discharge. Proven cost-effective and environmentally safe recycling processes are not yet universally available for alkaline and lithium button cell batteries. Some communities offer recycling or collection of these batteries. For more information, refer to your local ordinances or contact your local government.
- **Lead-acid batteries:** Dispose of lead-acid batteries by bringing them to an electronic waste center or recycling center, or dispose of them by your local ordinances. (Rechargeable lead-acid batteries are the same type used in automobiles and should be disposed of similarly.)

General Note on the Declaration of Conformity:

We hereby declare that this device is by the essential requirements of the European Directive 2014/53/EU or 2014/30/EU (LVD: 2014/35/EU; GPSD: 2001/95/EC). The full EU declaration of conformity can be requested at the address shown here or at alesis.com/safety

General Note on the Declaration of Conformity:

We hereby declare that this device is in accordance with the UK Legislation as Electromagnetic Compatibility Regulations 2016, Electrical Equipment (Safety) Regulations 2016, or Radio Equipment Regulations 2017. Please note that the applicable regulation differs according to the specification of the product. The full UK declaration of conformity can be provided upon request.

ABOUT COMPANY

- **World Headquarters**
 - inMusic Brands, Inc.

- inMusic Europe, Ltd.
- 200 Scenic View Drive

- **U.K. Office**

- Unit 3, Nexus Park
- Cumberland, RI 02864
- Lysons Avenue
- USA
- Ash Vale
- HAMPSHIRE
- GU12 5QE
- UNITED KINGDOM

- **Germany Office**

- inMusic GmbH
- Hans-Günther-Sohl-Str. 4a
- 47807 Krefeld
- GERMANY

Documents / Resources

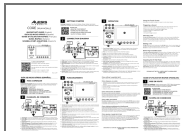

[ALESIS LDMFCore Drum Module](#) [pdf] User Guide
LDMFCore Drum Module, LDMFCore, Drum Module, Module

References

- [A Alesis](#)
- [User Manual](#)

[Manuals+](#), [Privacy Policy](#)

This website is an independent publication and is neither affiliated with nor endorsed by any of the trademark owners. The "Bluetooth®" word mark and logos are registered trademarks owned by Bluetooth SIG, Inc. The "Wi-Fi®" word mark and logos are registered trademarks owned by the Wi-Fi Alliance. Any use of these marks on this website does not imply any affiliation with or endorsement.