



AlcoTrx FCA30 Test Meter User Manual

[Home](#) » [AlcoTrx](#) » AlcoTrx FCA30 Test Meter User Manual 

AlcoTrx

FCA30
USER MANUAL

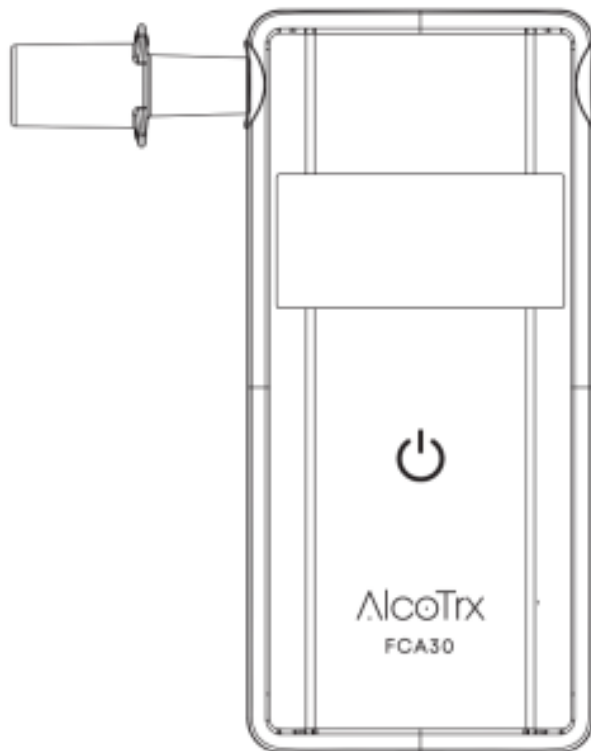

CE **RoHS**

Please read the user's manual carefully before use.

Contents

- [1 Important Safety Information](#)
- [2 Contents](#)
- [3 Name of each part](#)
- [4 Preparation](#)
- [5 MOUTHPIECE](#)
- [6 Performing the measurement](#)
- [7 DRINK DRIVING LIMIT OF EUROPEAN COUNTRIES](#)
- [8 Display message & Troubleshooting guide](#)
- [9 Technical specification](#)
- [10 Warranty](#)
- [11 Customer service](#)
- [12 Documents / Resources](#)
- [13 Related Posts](#)

Important Safety Information

- Before using the alcohol tester, read all instruction manuals carefully and perform the test.
- Recommended to have calibration service every 12 months or 500 tests (whichever comes first) by experts.
The use without periodic calibration service may result in invalid results.
- The test should be performed after 30 minutes after eating, drinking, or smoking. Failure to wait 30 minutes may result in invalid results or incorrect results.
- Residual alcohol in the mouth can distort the measurement.
- Do not immerse in water.
- Aromatic drinks or mouth sprays containing alcohol can interfere with measurements. In this case, wait for 30 minutes or rinse the mouth with pure water.
- Do not permit to blow cigarette smoke into the tester which may damage the sensor.
- Don't do drunk driving and even a small amount of alcohol may cause impairment in normal driving operation.
- Do not use this device as a tool to determine "drink and drive". The manufacturer and the sellers will not take any legal responsibility for the test results.
- When not used for a long time, keep the device after taking out the batteries. In the case of testing after long-term storage, there might be high tolerance of test results for the first test.
- Replace the batteries when the battery indicator icon reaches empty for accuracy reasons.
- In case the test result is higher than 0.100 %BAC (1.00 g/L / 0.50 mg/L) and you try again without interval, then the warm-up time might be delayed. – Perform a test within the operating temperature, which is specified in the instruction manual.
- Blowing hard may cause damage to the sensor as saliva flows into the sensor.
- Do not store the device in a place where the temperature and humidity are high. Recommended to store at room temperature.
- Do not suck in the air during the test.
- Recommended using a clean mouthpiece during the test for accurate measurements.
- The device including mouthpieces should be kept out of reach of children under 12 years of age.

Contents

- Two AAA size Batteries
- 3 pieces of the mouthpiece
- Instruction manual
- Digital Breathalyzer

Name of each part

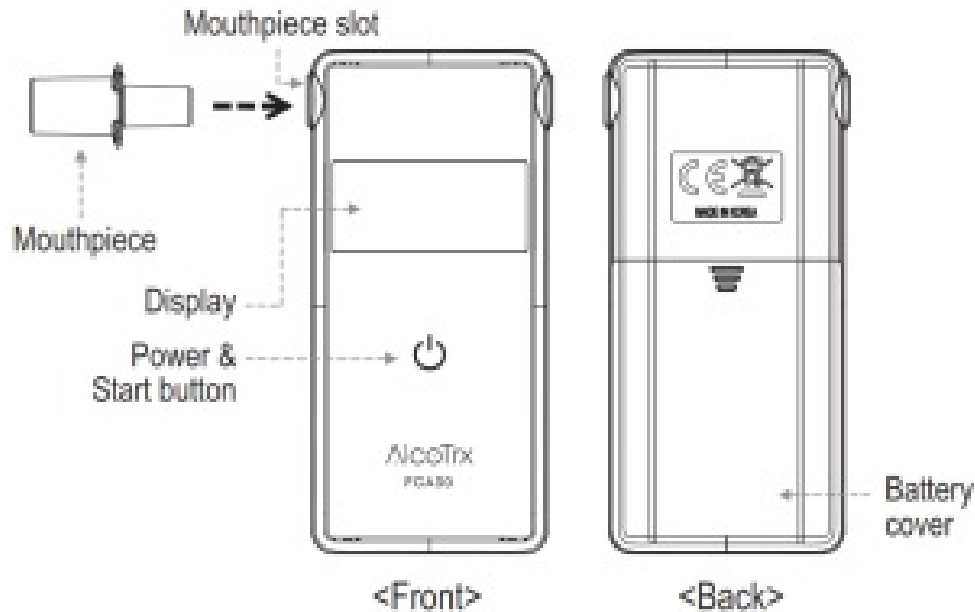

Preparation

1) BATTERY

Insert two batteries in the battery compartment by paying attention to the battery polarity.

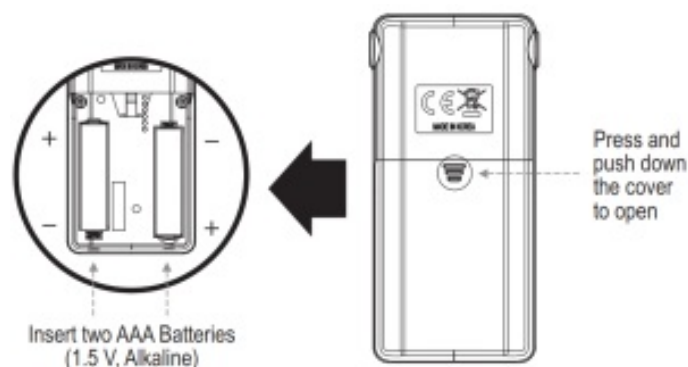

MOUTHPIECE

1. Tear the part of a plastic bag containing the narrow part of the mouthpiece.
2. Hold the part of a plastic bag containing the tick part of the mouthpiece, and take the narrow part of the mouthpiece out of the plastic bag.
3. Withholding the tick part of the plastic bag, insert the narrow part of the mouthpiece into the mouthpiece slot on the side of the alcohol tester. Do not touch the tick part of mouthpiece for the sanitary reasons as it is a blowing part.
4. Ensure whether it securely fits or not. It is highly recommended to replace a mouthpiece with a new one at each test.

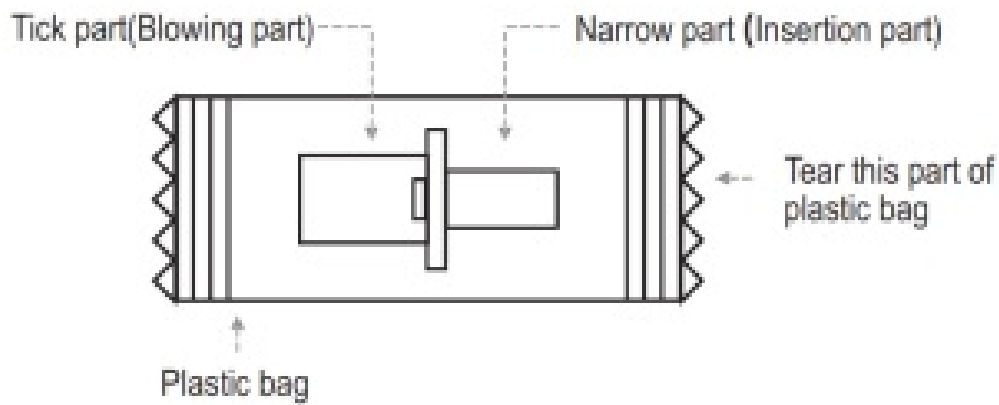

It is highly recommended to use a new mouthpiece for each test for hygienic causes.
The mouthpiece should be discarded at a recycling center after use

Performing the measurement



Step 1. Press the Power button for 1 second. The screen will display the total number of tests performed first, and then the previous test result will be shown.

Note. If you press and hold down the button for more than 5 seconds, the device will be turned off.



Step 2. The countdown will be started automatically.



Step 3. When the countdown reaches zero with a double beep sound, “BLOW” will flash and the screen will display three dashes (—) Blow through the mouthpiece for 4 seconds until there is a double beep sound.

Note. The blowing time may be longer or shorter depending on the intensity of blowing.

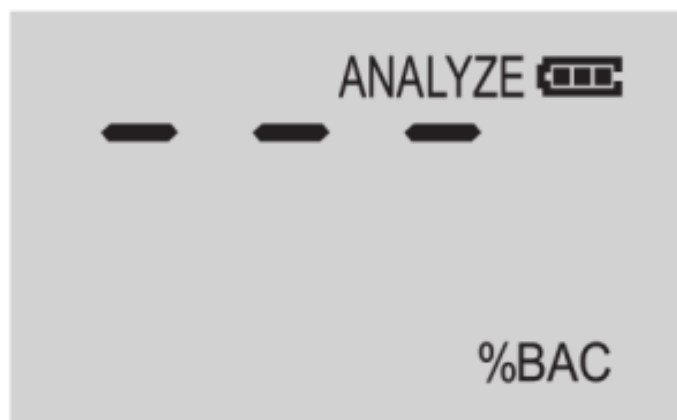

Step 4. When the sampling is successful, LCD outer lines will be turning along the edge of the LCD as you can see from the picture.



Step 5. The estimated BAC (Blood Alcohol Concentration) will flash for 10 seconds, and the button will be deactivated during this time. After waiting for this time, press the power button for 1 second if you want to test again.

- The tester will be turned off automatically in 3 minutes if there is no input signal.
- The forced turn-off will be available in Step 2, Step 3, and Step 5. Press and hold the power button for more than 3 seconds to turn off the tester.

Wait at least 30 minutes after eating, drinking, or smoking before measurement.

DRINK DRIVING LIMIT OF EUROPEAN COUNTRIES

0.0 g/l	Czech Republic, Hungary, Romania, Slovakia
0.2 g/l	Cyprus, Estonia, Norway, Poland, Sweden
0.4 g/l	Lithuania
0.5 g/l	Austria, Belgium, Bulgaria, Croatia, Denmark, Finland, France, Germany, Greece, Ireland, Italy, Latvia, Luxembourg, Netherlands, Portugal, Slovenia, Spain, Switzerland
0.8 g/l	Malta, UK

Display message & Troubleshooting guide

MESSAGE	WHAT IT MEANS	ACTION
	The battery is empty.	Replace with new batteries.
BAt	The testing cannot be performed because the battery is low.	Replace with new batteries.
FLO	The sampling volume or blow power is not enough to analyze the breath sample.	Press the power button to repeat the countdown cycle and retest.
OUT	No breath sample was blown within 3 minutes.	Press the power button to restart the countdown cycle and retest.
OUTC	The testing cannot be performed because the device is turned on outside of the operating temperature.	Repeat the test after the unit has reached a temperature within the operation range (10°C ~ 40°C).
Err2	If the LCD displays "Err2" after Step 4, it means the excessive saliva went into the sensor during the test.	Wait 20 mins, and then try again. If "Err2" is displayed for a long time, contact your seller for customer service.
500	The total number of tests has reached 500 times and the calibration service is needed.	Contact your seller for calibration service.
HI	The test results will be shown as HI if the result is over 1.00 ‰ (0.50 mg/L) according to the requirements of EN Standard.	

* The periodic calibration service every 12 months is highly recommended for maintaining accurate results.

Technical specification

Indication of B.A.C	0.000 ~ 0.100 %BAC 0.00 ~ 1.00 ‰ 0.00 ~ 0.50 mg/L * 0.100 %BAC = 1.00 ‰ = 0.50 mg/L
Accuracy	± °C) 0.0075 %BAC(at 0.1 %BAC, at 25 ±0.075 ‰(at 1.0 ‰, at 25°C) ±0.0375 mg/L(at 0.50 mg/L, at 25°C)
Warm uptime	15 ~ 20 seconds(at 0.05 %BAC, at 25 Warm-up time may vary depending on the BAC measured. °C)
Sensor type	Fuel cell
Power supply	Two AAA-size alkaline batteries
Battery life	Approx. 1000 tests
Dimensions(WxHxD)	51 mm x 109 mm x 18 mm
Weight	84 g (including batteries)
Calibration period	500 tests, or at least every 12 months
Operating temperature	10 ~ 40°C

Warranty

The manufacturer warrants the product to be free from defects in workmanship or material (excluding calibration) under normal use either for one year from the date of purchase or 500 breath tests whichever comes earlier.

The manufacturer's obligation under this warranty is limited to replacing, adjusting, or repairing the unit at the manufacturer's option if returned along with proof of purchase.

For any defects due to natural disasters or customer's negligence, misuse, reconstruction, and repair by an unauthorized person, the reasonable cost shall be charged for repair or part replacement.

Customer service

For any questions about after-sales service, product calibration or to purchase additional mouthpieces, please kindly contact the nearest distributor or seller. Infor for calibration www.ttmicro.no under service.

Supplier: TT Micro AS / Olaf Helsetsvei 6, 0694 Oslo, Norway Manufacturer: DA Tech Co., Ltd. / South Korea

Documents / Resources

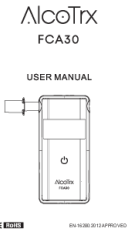
 The image shows the front cover of the AlcoTrx FCA30 User Manual. It features the AlcoTrx logo at the top, followed by 'FCA30' and 'USER MANUAL'. Below this is a small illustration of the FCA30 test meter. At the bottom left, there is a CE mark and the text 'EN 15288:2015 PROVED'.	AlcoTrx FCA30 Test Meter [pdf] User Manual FCA30, Test Meter
-------------------------------------------------------------------------------------------------------------------------------------------------------------------------------------------------------------------------------------------------------------------------------------------------------------------------------------------------------------------------------	---------------------------------------------------------------------------------