



ALC SightHD Video Doorbell Upgrade Procedure Instructions

[Home](#) » [ALC](#) » ALC SightHD Video Doorbell Upgrade Procedure Instructions 

ALC SightHD Video Doorbell Firmware Upgrade Procedure

Contents

- [1 Doorbell Firmware Upgrade](#)
- [2 Doorbell Firmware Upgrade \(cont.\)](#)
- [3 Documents / Resources](#)
- [4 Related Posts](#)

Doorbell Firmware Upgrade

- To upgrade your ALC SightHD Video Doorbell, you will need to remove the microSD card from the Doorbell.
(see next page)
- Download or copy the file to your computer
- v1.3.4.22.zip

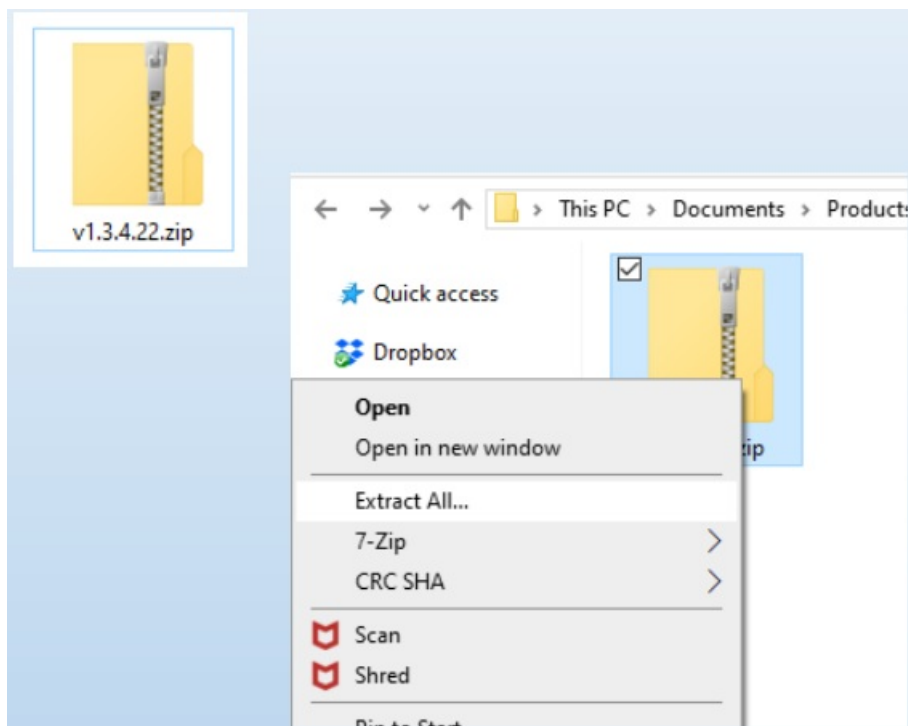

- Right-click on this zip file and select Extract All...
- Select Extract
- The file will unzip revealing a folder
- Open this folder and copy the two files

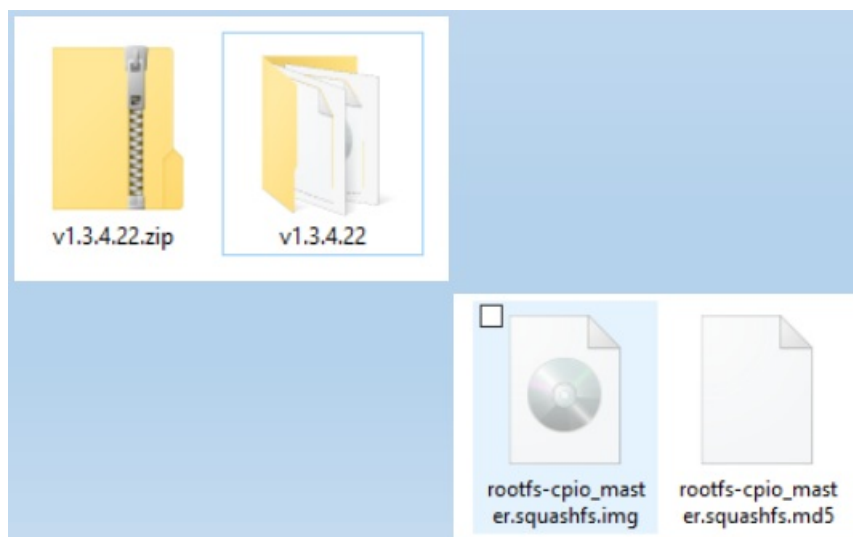

Remove these two screws

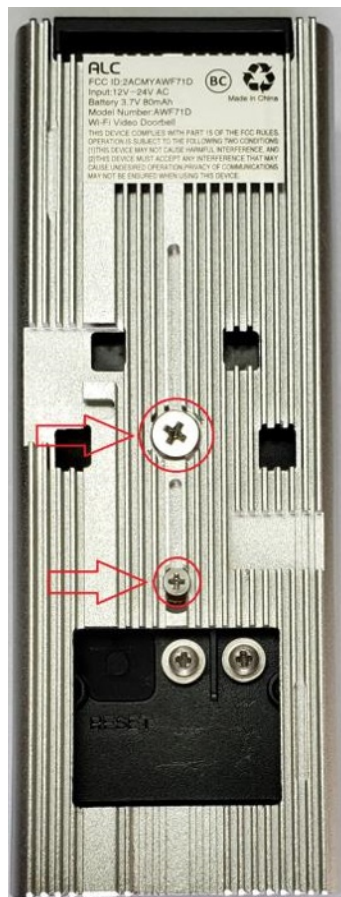

Slide the Doorbell out of the metal bracket

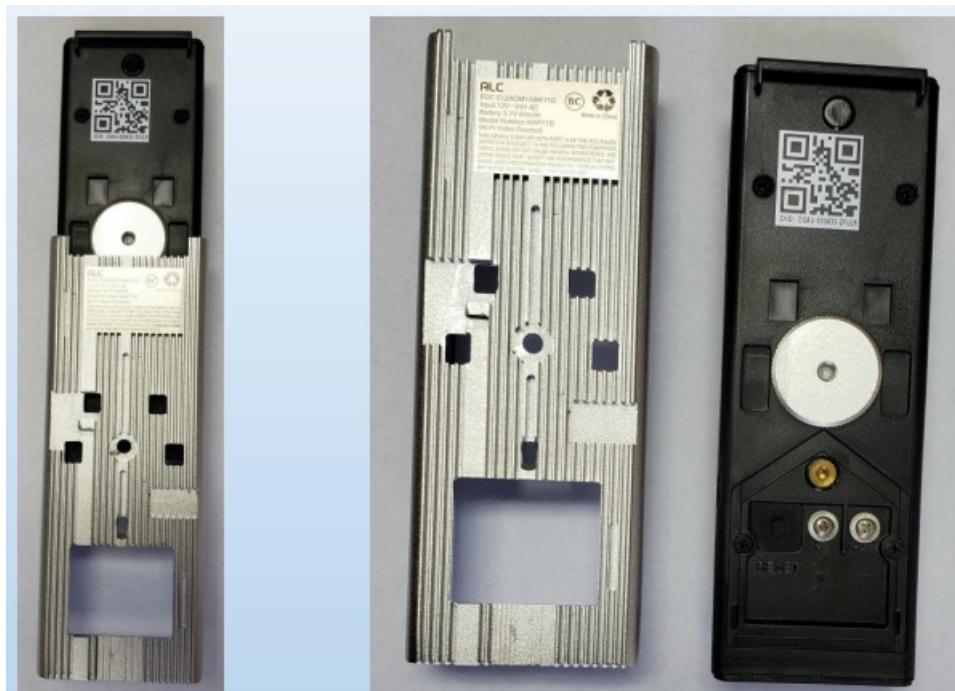

The microSD card slot is on the side



Doorbell Firmware Upgrade (cont.)

- Insert the microSD card (using an SD card adapter) in your computer
- Copy the 2 files to the microSD card. Do not put the files in any folder.
- Remove the microSD card from the computer
- Insert the microSD card back in the Doorbell
- Reinstall the Doorbell and turn the power back on
- The Doorbell will automatically perform the firmware upgrade which will take a couple of minutes
- When it is complete, you should see the LED light around the button flash 3 times and repeat
- This time when adding Device, select Wi-Fi Cameras instead of Doorbell
- Select Next. The SightHD app will search for the Doorbells Wi-Fi signal
- Follow the instructions on the app

Documents / Resources

	<p>ALC ALC SightHD Video Doorbell Upgrade Procedure [pdf] Instructions ALC, SightHD, Video Doorbell, Upgrade, Procedure</p>
-------------------------------------------------------------------------------------	-------------------------------------------------------------------------------------------------------------------------------------------------