



# Alarm Lock PG21 Surface Mounted Microprocessor Controlled Door Alarms Instruction Manual

[Home](#) » [Alarm Lock](#) » Alarm Lock PG21 Surface Mounted Microprocessor Controlled Door Alarms Instruction Manual 

## Contents

- [1 Alarm Lock PG21 Surface Mounted Microprocessor Controlled Door Alarms](#)
- [2 Product Information](#)
- [3 Product Usage Instructions](#)
- [4 DESCRIPTION](#)
- [5 SPECIFICATIONS](#)
- [6 INSTALLATION](#)
- [7 STANDBY MODE](#)
- [8 FIELD TEST](#)
- [9 EXPLODED VIEW](#)
- [10 ALARM LOCK LIMITED WARRANTY](#)
- [11 Documents / Resources](#)
  - [11.1 References](#)
- [12 Related Posts](#)



**Alarm Lock PG21 Surface Mounted Microprocessor Controlled Door Alarms**



## Product Information

The PG21 & PG21E Alarm Lock is a security device designed to provide protection for doors. It is manufactured by Alarm Lock, a company located at 345 Bayview Avenue, Amityville, New York 11701. The lock is available in different finishes: Metallic Silver (PG21 MS, PG21 E); Metallic Bronze (P021MB); Red (PG21RD). It requires a 9-Volt Alkaline Battery for power, which is supplied with the product. The PG21E model can also be used with a Model PP100 power supply or any other power supply providing 9 – 12Vdc at 500mA. The lock features a Piezo electronic sounder with a sweep siren that emits a sound of 110dB at a distance of 10 feet. The shipping weight of the product is 1 lb, 10 oz. The battery life of the lock depends on the number of alarms triggered per year. With the 2-Minute Shutdown option enabled, the battery life ranges from 15.4 months for one alarm per year to 17.6 months for ten alarms per year. The lock has a continuous alarm duration of 3 hours.

## Product Usage Instructions

1. Install the mortise cylinder (Alarm Lock Model CEM) into the cover from the outside, with the key slot at the 6 o'clock position. Use the Spacer (P4607) and Lock Ring (P1267) to secure the cylinder in place.
2. If using a template, select the appropriate template for your door type. If not using a template, proceed to step 6.
3. Mark and drill 9/16 inch holes on the door and jamb according to the template directions. Certain narrow-stile doors may require only two holes for the mounting plate.
4. For Model PG21E only, mark and drill a hole for remote wiring to a control panel, following the template.
5. If outside key control is needed, drill a 1/4 inch hole as shown on the template. Install a rim-type cylinder through the door and tighten the cylinder screws.
6. Knock out the necessary holes from the baseplate and attach it to the door using the supplied #8 sheet-metal screws. Ensure that the rim cylinder tailpiece fits into the cross slot of the ferrule if an outside cylinder is used.
7. Connect the supplied battery to the lock. A chirp will sound to indicate proper power connection. Press the small CLEAR button at the lower-left corner of the circuit board.

8. Remove the jumper on the side of the unit where the magnet will not be installed.
9. Select jumper options (J1-J4) according to your requirements. The default configuration has the Annunciator option enabled (J3 installed) and 2-Minute Shutdown alarm selected (J4 removed).
10. Important: Changes in the jumper configuration will only take effect when the unit is armed.
11. Arm the lock according to the instructions provided in the user manual.

**Note:** The need for a template may be eliminated by using the Magnet Alignment procedure in step 11, but if outside key control or remote wiring is required, the template must be used.

## DESCRIPTION

The PG21 and PG21E are surface-mounted microprocessor-controlled door alarms. The PG21 is a basic battery-operated unit. The P021 E has provisions for an external power supply; external reed-switch contacts for multiple-door monitoring; and a built-in Form-C relay for connection to a fire or burglary alarm panel or other device. The units mount on the interior of the door with a magnetic actuator on the frame; or, if external wiring is required (PG21 E only), vice versa. Full clockwise rotation of the installed standard mortise cylinder (not supplied) will alternately arm and disarm the unit. A selectable Annunciator feature beeps to signal the opening of the door while the unit is disarmed. Opening the door, removal of the cover or any attempt to defeat the device with a second magnet, when armed, will activate the alarm. The units may be operated from outside the door with the addition of a standard rim cylinder. A test button and LED are used to check status; if the unit is armed, pressing the button will light the LED.

## SPECIFICATIONS

- **Dimensions:** 9" x 2 1/2" x 2W8" (22.8cm x 6.3cm x 6.8cm)(LxWxD)
- **Finish:** Metallic Silver (PG21 MS, PG21 E); Metallic Bronze (P021MB); Red (PG21RD)
- **Power Requirements:** 9-Volt Alkaline Battery (supplied).(The PG21E may be used with Model PP100 (optional) or other power supply providing 9 – 12Vdc at 500mA.)
- **Battery Life:** Continuous Alarm, 3 hours; 2-minute Shutdown, see Table 1 below.

| Alarms / Year | Battery Life (Months) |
|---------------|-----------------------|
| 1             | 17.6                  |
| 2             | 17.4                  |
| 3             | 17.1                  |
| 4             | 16.8                  |
| 5             | 16.6                  |
| 6             | 16.3                  |
| 7             | 16.1                  |
| 8             | 15.8                  |
| 9             | 15.6                  |
| 10            | 15.4                  |

- **Sounding Device:** Piezo electronic sounder, sweep siren, 110dB at 10 feet
- **Shipping Weight:** 1 lb, 10 oz.

## INSTALLATION

**Note:** In many applications, the need for a template may be eliminated by using the Magnet Alignment procedure in step 11. If outside key control or remote wiring is required, however, the template must be used.

1. Referring to the illustration at right, (a) install mortise cylinder (Alarm Lock Model CEM, optional) into the cover from the outside with the key slot at the 6 o'clock position; (b) install the Spacer Fig. 1. Installing mortise cylinder.(P4607), then screw the Lock Ring (P1267) onto the Cylinder as shown and tighten using the SpannerWrench (P4577) supplied. Fig. 1. Installing mortise cylinder.

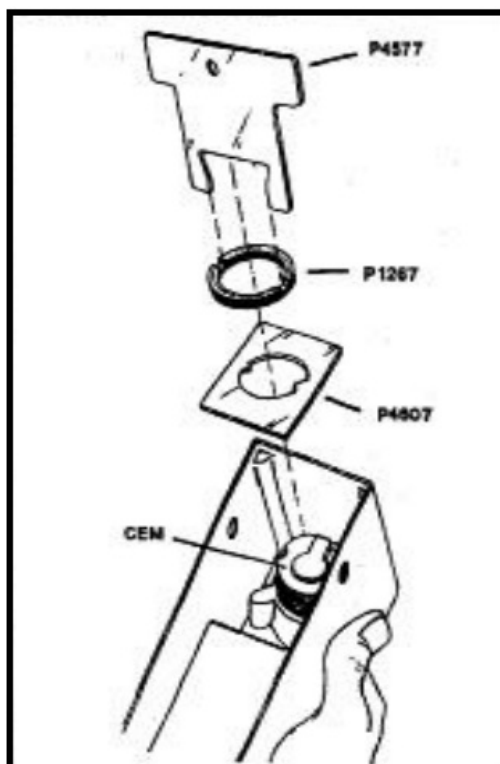

Fig. 1. Installing mortise cylinder.

2. If using a template, select the proper template for the specific type of door. (If not using a template, proceed to step 6.)
3. Mark and drill 9/16" holes per template directions on the door and jamb. (Four holes for the baseplate and two holes for the magnetic actuator.) Note: Certain narrow-stile doors require only two holes for the mounting plate.
4. Model PG21E only: Mark and drill Whole per template for remote wiring to a control panel.
5. For outside key control only: Drill 1/4" hole as shown on template. Install a rim-type cylinder (not supplied) through the door and allow the flat tailpiece to extend 5/16" beyond the door. Position cylinder, keeping key slot point-ing down (6 o'clock position) and tighten cylinder screws.
6. Knock out the necessary holes from the baseplate and install on the door with #8 sheet-metal screws supplied. If an outside cylinder is used, make sure that rim cylinder tailpiece fits into cross slot of ferrule.
7. Connect the battery; a chirp will sound. (This ensures that power is properly connected.) Important: Press the small CLEAR button at the lower-left corner of the circuit board (see Fig. 2).
8. Remove the jumper only on the side of the unit that the magnet will not be installed.
9. Select jumper options (J1- J4) as follows. Refer to Fig. 2. The unit is factory-supplied with the Annunciator option enabled (J3 installed) and a 2-minute Shutdown alarm selected (J4 removed).

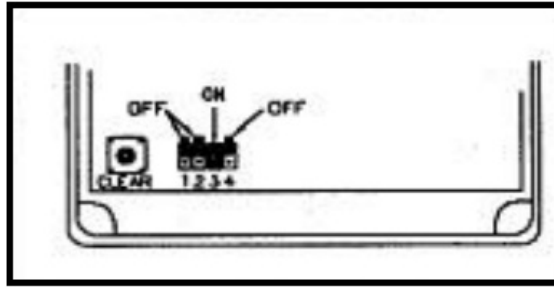

Fig. 2. CLEAR Button and Jumpers.

**Important:** Changes in the jumper configuration do not become effective until the unit is subsequently armed.

- **J1:** Entry Delay. Alarm will sound 15 seconds after any unauthorized entry if unit is armed. This feature is used for authorized entry. Disarming within 15 seconds will prevent an alarm. To enable Entry Delay, install J1 across both pins.
- **J2:** Exit Delay. Unit will be activated after 15 seconds each time unit is armed to allow authorized exit without an alarm. To enable Exit Delay, install J2 across both pins.
- **J3:** Annunciator. Unit will sound for 2 seconds whenever the door is opened while disarmed. To disable the Annunciator, remove J3.
- **J4:** Continuous/2-Minute Shutdown. With J4 on, an alarm will sound continuously until the battery is depleted. With J4 off, the alarm will silence after two minutes and the unit will rearm (if the door is closed). The LED will start flashing to indicate that an alarm has occurred (Alarm Memory). Alarm Memory is cleared after about 4 hours or when the unit is rearmed. Note: If the door is still open after two minutes, the alarm will restart.

**Note:** Jumper J4 is connected at the factory to only one pin of the 2-pin connector (off). To select Continuous alarm, remove J4 and reinstall it across both pins.

10. Install the cover onto the baseplate, checking that the slide switch on the PC board fits into the cam hole. Secure the cover with #6-32 screws supplied. Note: The longest screw is the tamper screw. If not using a template, do not install the tamper screw until the magnet has been aligned and secured as follows.
11. (If the unit has been installed with the aid of a template, proceed to step 12.) After power-up, but before the tamper screw is installed, the unit will be in the Magnet Alignment Mode.
  - **a.** Place the magnet against the wall, adjacent to the bottom of the unit. Slowly slide the magnet upward. The LED will come on, indicating closure of the reed switch, then go out. Mark the door jamb at the bottom of the magnet. (Note: Sliding the magnet still further will cause the LED to light again; ignores subsequent indications.)
  - **b.** Similarly, place the magnet against the wall, adjacent to the top of the unit. Slowly slide the magnet downward. The LED will come on, then go out once again (see Note in step 11a). Mark the doorjamb at the top of the magnet.
12. Install the magnetic actuator so that it is centered between the two marks. Use the two #8 sheet-metal screws supplied. Note: On steel frames, it is sometimes necessary to install a non-magnetic shim between the magnetic actuator and the frame. This is done to prevent the steel frame from absorbing the magnet's magnetic field, which could cause a constant or occasional false alarm condition. The shim should be 1/2" x 2 1/2" x 1/8" thick and non-magnetic material such as plastic, bakelite or rubber.

## STANDBY MODE

After the magnet has been aligned and mounted, the tamper screw may be installed. This will place the unit in its regular Standby Mode (disarmed).

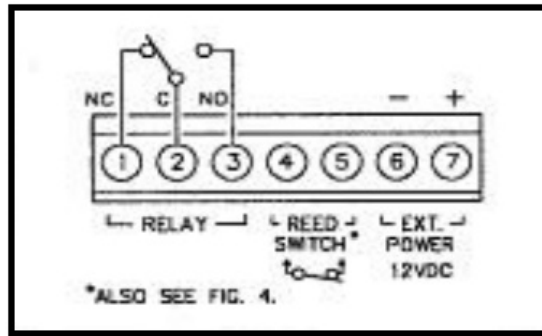

### WIRING (PG1E only)

External wiring to the PG21E requires that the unit be mounted on the frame with the magnet on the adjacent door. (The PG21 E may be mounted on a door with the addition of a Model 271 Flexible Cable.) All wiring is made Fig. 3. Wiring Diagram. at its terminal strip. Wiring connections are summarized in the Wiring Diagram shown in Fig. 3. Relay (Terminals 1-3). Terminal 1 = Normally Closed; Terminal 2 = Common; Terminal 3 = Normally Open. Reed Switch (Terminals 4 & 5). Connect external reed-switch contacts to Terminals 4 and 5 and remove both jumpers. Note: If reed switches are wired in series as shown in Fig. 4, several doors may be monitored simultaneously. Using #22AWG wire, maximum wiring distance should not exceed 50 feet.

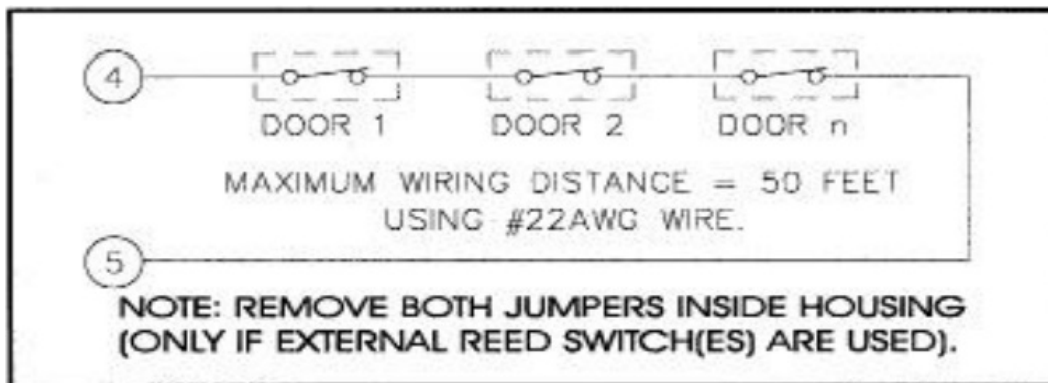

Power (Terminals 6 & 7). Connect an external power supply: positive (+) to Terminal 7; negative (—) to Terminal 6. Leave the internal battery in as a backup battery. If using the Alarm Lock PP100 Power Supply, connect the two battery clips to the unit and the internal battery as labeled.

### FIELD TEST

1. With the door closed, turn the key fully clockwise, then release. A brief tone will sound indicating that the unit is armed (with or without delays, see options in INSTALLATION: step 9).
2. Push test button; the LED will come on for one second verifying that unit is armed. (If unit is disarmed, LED will not come on.) Note: If the test button is held down longer than 2 seconds, the sounder will be tested.
3. Open the door. A sweep siren alarm should sound.
4. Model PG21E only: On alarm, the relay will activate and remain latched for as long as the sounder is on. Relay contacts are rated at 1 25Vac/dc at 1/2A.
5. To reset the alarm, turn key fully clockwise once again, then release. The unit is now disarmed.

**Low Battery.** In operation, whether armed or disarmed, the LED will blink about once every 4 hours when checking battery status. When the battery becomes weak, the unit will chirp and the LED will flash about once per minute to indicate the need for replacement.

### EXPLODED VIEW

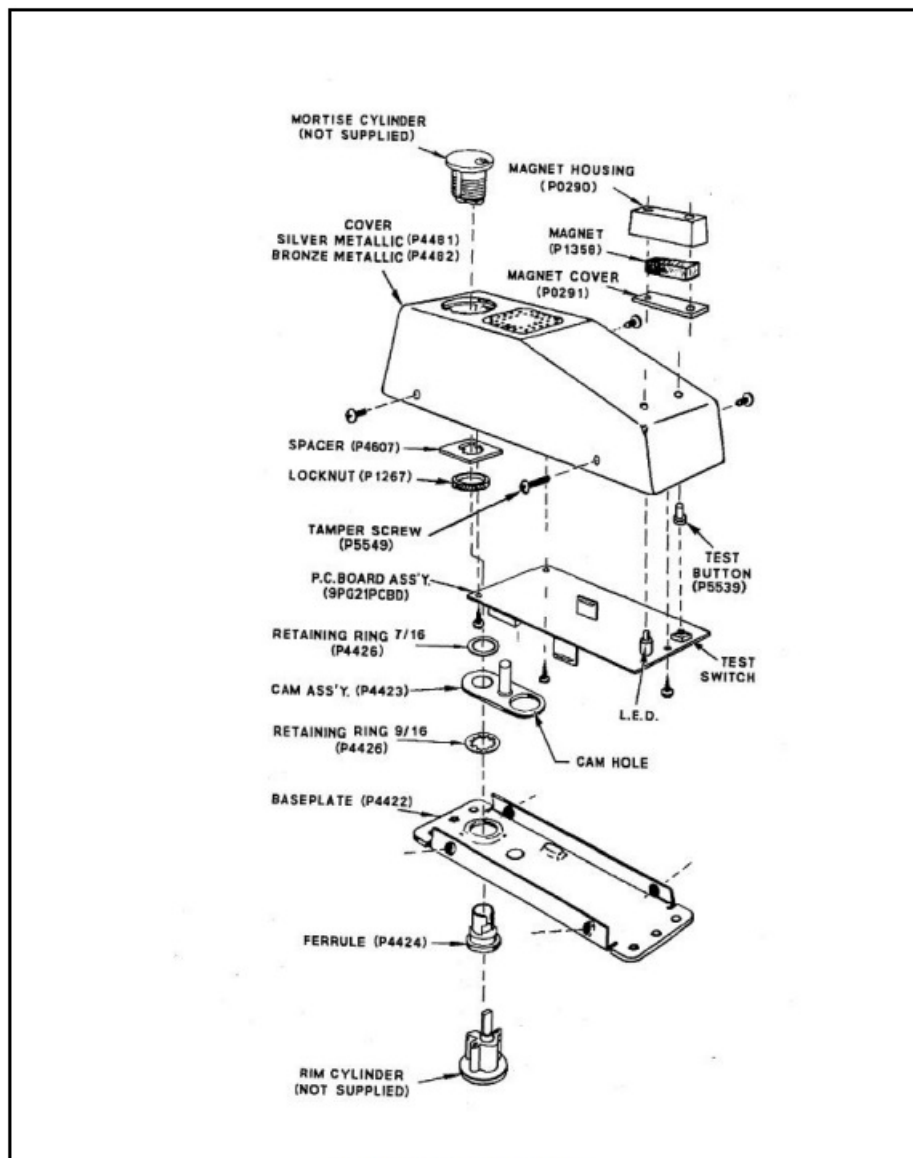

Fig. 5 Exploded view with part numbers

## ALARM LOCK LIMITED WARRANTY

ALARM LOCK SECURITY SYSTEMS, INC. (ALARM LOCK) warrants its products to be free from manufacturing defects in materials and workmanship for 24 months following the date of manufacture. ALARM LOCK will, within said period, at its option, repair or replace any product failing to operate correctly without charge to the original purchaser or user.

This warranty shall not apply to any equipment, or any part thereof, which has been repaired by others, improperly installed, improperly used, abused, altered, damaged, subjected to acts of God, or on which any serial numbers have been altered, defaced or removed. Seller will not be responsible for any dismantling or reinstallation charges.

THERE ARE NO WARRANTIES, EXPRESS OR IMPLIED, WHICH EXTEND BEYOND THE DESCRIPTION ON THE FACE HEREOF. THERE IS NO EXPRESS OR IMPLIED WARRANTY OF MERCHANTABILITY OR A WARRANTY OF FITNESS FOR A PARTICULAR PURPOSE. ADDITIONALLY, THIS WARRANTY IS IN LIEU OF ALL OTHER OBLIGATIONS OR LIABILITIES ON THE PART OF ALARM LOCK. Any action for breach of warranty, including but not limited to any implied warranty of merchantability, must be brought within the six months following the end of the warranty period.

IN NO CASE SHALL ALARM LOCK BE LIABLE TO ANYONE FOR ANY CONSEQUENTIAL OR INCIDENTAL DAMAGES FOR BREACH OF THIS OR ANY OTHER WARRANTY, EXPRESS OR IMPLIED, EVEN IF THE LOSS OR DAMAGE IS CAUSED BY THE SELLER'S OWN NEGLIGENCE OR FAULT.

In case of defect, contact the security professional who installed and maintains your security system. In order to exercise the warranty, the product must be returned by the security professional, shipping costs prepaid and insured to ALARM LOCK. After repair or replacement, ALARM LOCK assumes the cost of returning products under warranty. ALARM LOCK shall have no obligation under this warranty, or otherwise, if the product has been repaired by others, improperly installed, improperly used, abused, altered, damaged, subjected to accident, nuisance, flood, fire or acts of God, or on which any serial numbers have been altered, defaced or removed. ALARM LOCK will not be responsible for any dismantling, reassembly or reinstallation charges. This warranty contains the entire warranty. It is the sole warranty and any prior agreements or representations, whether oral or written, are either merged herein or are expressly canceled. ALARM LOCK neither assumes, nor authorizes any other person purporting to act on its behalf to modify, to change, or to assume for it, any other warranty or liability concerning its products.

In no event shall ALARM LOCK be liable for an amount in excess of ALARM LOCK's original selling price of the product, for any loss or damage, whether direct, indirect, incidental, consequential, or otherwise arising out of any failure of the product. Seller's warranty, as hereinabove set forth, shall not be enlarged, diminished or affected by and no obligation or liability shall arise or grow out of Seller's rendering of technical advice or service in connection with Buyer's order of the goods furnished hereunder. ALARM LOCK RECOMMENDS THAT THE ENTIRE SYSTEM BE COMPLETELY TESTED WEEKLY.

**Warning:** Despite frequent testing, and due to, but not limited to, any or all of the following; criminal tampering, electrical or communications disruption, it is possible for the system to fail to perform as expected. ALARM LOCK does not represent that the product/system may not be compromised or circumvented; or that the product or system will prevent any personal injury or property loss by burglary, robbery, fire or otherwise; nor that the product or system will in all cases provide adequate warning or protection. A properly installed and maintained alarm may only reduce risk of burglary, robbery, fire or otherwise but it is not insurance or a guarantee that these events will not occur. CONSEQUENTLY, SELLER SHALL HAVE NO LIABILITY FOR ANY PERSONAL INJURY, PROPERTY DAMAGE, OR OTHER LOSS BASED ON A CLAIM THE PRODUCT FAILED TO GIVE WARNING. Therefore, the installer should in turn advise the consumer to take any and all precautions for his or her safety including, but not limited to, fleeing the premises and calling police or fire department, in order to mitigate the possibilities of harm and/or damage.

ALARM LOCK is not an insurer of either the property or safety of the user's family or employees and limits its liability for any loss or damage including incidental or consequential damages to ALARM LOCK's original selling price of the product regardless of the cause of such loss or damage.

Some states do not allow limitations on how long an implied warranty lasts or do not allow the exclusion or limitation of incidental or consequential damages, or differentiate in their treatment of limitations of liability for ordinary or gross negligence, so the above limitations or exclusions may not apply to you. This Warranty gives you specific legal rights and you may also have other rights which vary from state to state.

### **345 Bayview Avenue**

Amityville, New York 11701

For Sales and Repairs, (800) 645-9445 For Technical Service, (800) 645-9440

---

## **Documents / Resources**





**[Alarm Lock PG21 Surface Mounted Microprocessor Controlled Door Alarms](#)** [pdf] Instruction Manual  
PG21 Surface Mounted Microprocessor Controlled Door Alarms, PG21, Surface Mounted Microprocessor Controlled Door Alarms, Microprocessor Controlled Door Alarms, Controlled Door Alarms, Door Alarms

## References

- [MH 360 S6 \(01\) PDF MANUAL - Manual-Hub.com](#)
- [MH A-DESIGNS HAMMER 2 EQ \(01\) PDF MANUAL - Manual-Hub.com](#)
- [MH F.U.N.K.E. ATR833-II \(01\) PDF MANUAL - Manual-Hub.com](#)