



ALARM.COM ADC-VC728PF Varifocal Bullet Camera Installation Guide

[Home](#) » [ALARM.COM](#) » ALARM.COM ADC-VC728PF Varifocal Bullet Camera Installation Guide 



Varifocal Bullet Camera Installation Guide ADC-VC728PF

Contents

- [1 Pre-installation checklist](#)
- [2 Overview](#)
- [3 LED reference](#)
- [4 Installation](#)
- [5 Weather-resistant RJ45 cap assembly](#)
- [6 Camera mounting overview](#)
- [7 Camera mounting instructions](#)
- [8 Troubleshooting](#)
- [9 Documents / Resources](#)
 - [9.1 References](#)
- [10 Related Posts](#)

Pre-installation checklist

- ADC-VC728PF camera (included)
- AC power adapter (required for non-PoE connections) (sold separately)
- Router with a broadband Internet connection (Cable, DSL, or Fiber Optic) and an open Ethernet port
- A computer or mobile device with Internet access
- An Ethernet / Cat5e cable
- Username and password for the Alarm.com account to which you will add the camera

Overview

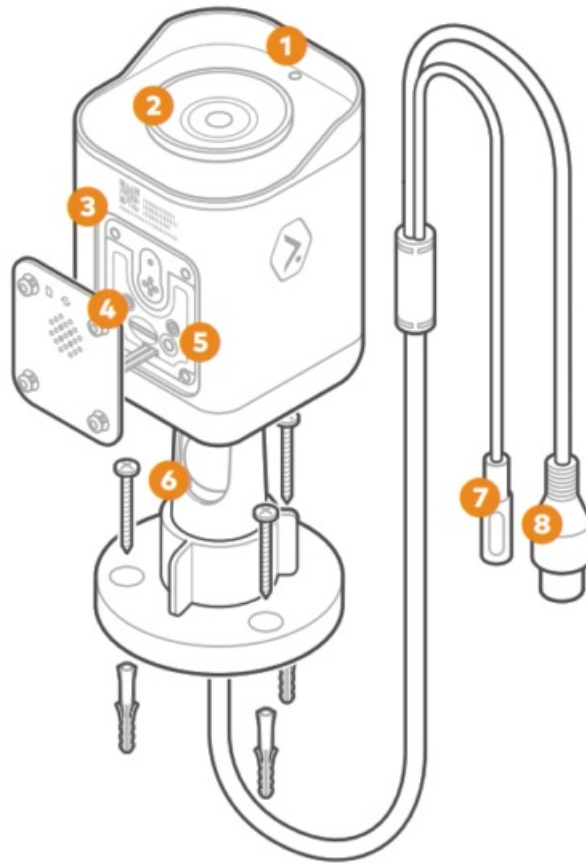

1. LED indicator
2. Varifocal lens
3. Camera label with MAC Address
4. MicroSD card slot
5. Reset button
6. Ball joint mount
7. 12 VDC power connector
8. RJ45 ethernet interface

LED reference



Not illuminated – Power off



Solid green – Connected to Alarm.com



Blinking green – Local network connection



Blinking green and red – Reverting to factory default settings



Blinking red – Power on, camera booting



Solid red – No local or Internet connection

Installation

Service provider technician – MobileTech installation

- ❶ Log in to MobileTech.
- ❷ Select the customer's account.
- ❸ Tap Quick Actions > Add Device > Video.
- ❹ Follow the on-screen instructions.

Ethernet mode

Complete these steps prior to installing the camera in its final location:

- ❶ Connect the camera to the router via an Ethernet cable.
 - ❷ If the Ethernet connection does not provide power, connect the camera to the optional AC power adapter (sold separately) and plug the adapter into a non-switched outlet.
 - ❸ Wait 2 minutes for the camera to boot up and connect to the Internet. The LED will be solid green when this process is complete.
 - ❹ Add the device to the account by either selecting the account in MobileTech or by using a web browser and entering the following URL: www.alarm.com/addcamera (you will need the customer username and password).
 - ❺ Select the camera from the video device list or enter its MAC address to begin adding the camera. The camera's MAC address is located on the bottom of the device or on the packaging.
 - ❻ Follow the on-screen instructions to finish adding the camera.
- You can now power down the camera.

Weather-resistant RJ45 cap assembly

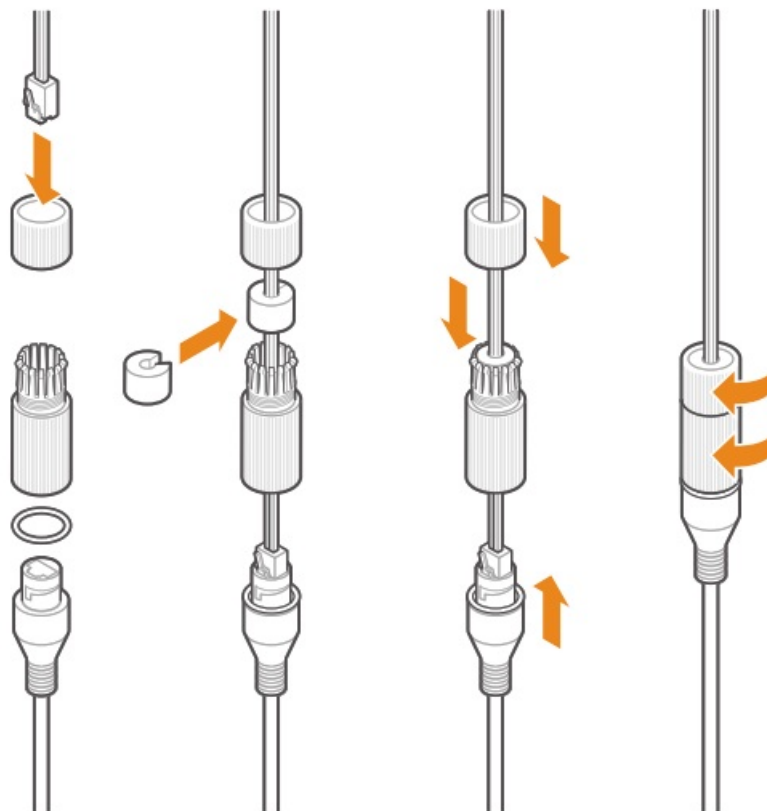

Camera mounting overview

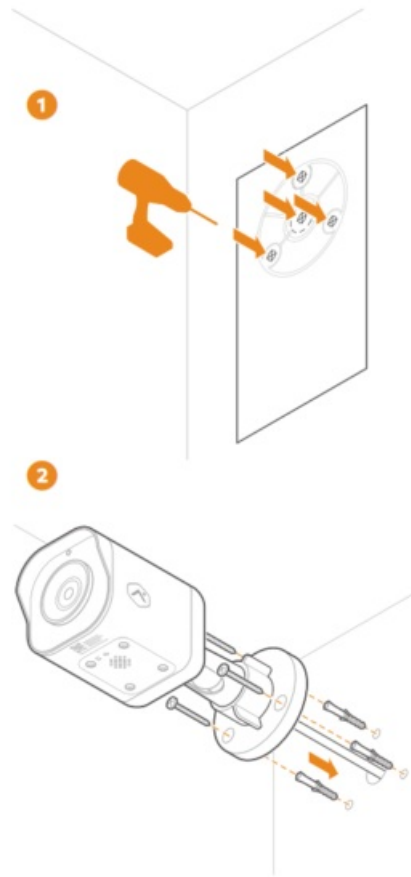

Camera mounting instructions

1. The camera should be mounted 8 feet or more above the ground on a flat surface, like a wall or ceiling.
2. Ensure that there are no obstructions near the camera. Obstructions can lead to poor night vision performance.
3. Use the included drill template to mark the desired location of the holes for the RJ45 ethernet interface and mounting screws. Drill a 1" hole in the center of the template for the RJ45 ethernet interface. If mounting to drywall, drill three 9/32" holes and insert the included M5 wall anchors. If mounting to a solid surface, like wood, drill three 1/8th" pilot holes.
4. Connect the camera to the ground. The ground location is indicated by the ground symbol. To ground the device, use the included nut to connect the ground wire to the camera, then connect the other end of the ground wire to an approved ground according to Article 250 of the National Electrical Code (NEC). If the camera needs to be removed in the future, ensure that the ground wire is removed last.
5. Connect the camera to a properly terminated, unplugged ethernet cable. Seal the connection using the included weather-resistant RJ45 cap. For non-PoE connections, connect the 12VDC connector to an unplugged 12VDC adapter. Insert the cables and ground wire into the RJ45 ethernet interface clearance hole.
6. Line up the camera with the three holes created in step 4. Use the included M5x40mm screws to fasten the camera to the mounting surface.
7. Activate the ethernet connection and connect the device to power.

Troubleshooting

- If you have issues connecting the camera to the account, power cycle the camera and try again.
- If issues persist, reset the camera to factory defaults.

Press and hold the Reset button until the LED is flashing
Green and Red (about 15 seconds), then release the button.
The camera will reboot with factory defaults.

If the camera was previously installed to an [Alarm.com](https://www.alarm.com) account, it will need to be deleted before it can be installed again.

Questions?

Visit answers.alarm.com
or contact your service provider.

Notices

This equipment has been tested and found to comply with the limits for a Class B digital device, pursuant to part 15 of the FCC Rules. These limits are designed to provide reasonable protection against harmful interference in a residential installation. This equipment generates, uses, and can radiate radio frequency energy and, if not installed and used in accordance with the instructions, may cause harmful interference to radio communications. However, there is no guarantee that interference will not occur in a particular installation. If this equipment does cause harmful interference to radio or television reception, which can be determined by turning the equipment off and on, the user is encouraged to try to correct the interference by one or more of the following measures:

- Reorient or relocate the receiving antenna.
- Increase the separation between the equipment and receiver.
- Connect the equipment into an outlet on a circuit different from that to which the receiver is connected.
- Consult the dealer or an experienced radio/TV technician for help.

Changes or modifications not expressly approved by the party responsible for compliance could void the user's authority to operate this equipment.

- Installation and maintenance services shall only be performed by qualified technicians.
- This unit is intended to be supplied by a UL Listed PoE (Power over Ethernet) power source/device suitable for use at Tma 50°C whose output meets LPS (or PS2) and
output is rated: POE DC 37-57 V, 0.35-0.22 A or DC 12V, 1.0 A.
- All cable glands should be properly assembled and protected.
- If using a flexible conduit, ensure that no cable is exposed.
- If using plastic corrugated tubing, ensure that the material has F1 level compliance certified by UL.
- This product does not include flexible steel conduits.

If using flexible metal conduits, use stainless steel, an aluminum alloy, or metal composed with rust protection certified by UL.

- The camera is only to be connected to PoE networks without routing to outside plants.
- For non-PoE installations: only use 12V 1A VDC power supplies certified by Alarm.com for this camera model.

Contact Alarm.com for more information.





8281 Greensboro Drive
Suite 100
Tysons, VA 22102
210218

Documents / Resources

 <p>Varifocal Bullet Camera Installation Guide</p> <p>ADC-VC728PF</p>	<p>ALARM COM ADC-VC728PF Varifocal Bullet Camera [pdf] Installation Guide</p> <p>ADC-VC728PF, Varifocal Bullet Camera, ADC-VC728PF Varifocal Bullet Camera</p>
--	--

References

-  [Home - Knowledge Base](#)
-  [Customer Login](#)