

Akuvox R20K RF Card Reader User Guide

[Home](#) » [Akuvox](#) » **Akuvox R20K RF Card Reader User Guide** 

Contents

- [1 Akuvox R20K RF Card Reader](#)
- [2 Unpacking](#)
- [3 Product Overview](#)
- [4 Installation Environment](#)
- [5 Wall-mounting Installation](#)
- [6 Device Wiring](#)
- [7 Application Network Topology](#)
- [8 IP Announcement](#)
- [9 Configuration](#)
- [10 Operation](#)
- [11 Indicators](#)
- [12 Documents / Resources](#)
- [13 Related Posts](#)

Akuvox

Akuvox R20K RF Card Reader

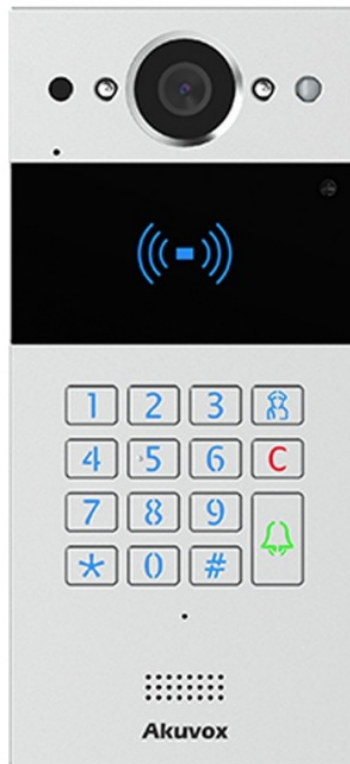

Unpacking

Before you begin using the device, please check the version you got and ensure that the following items are included in the shipped box:

Universal Accessories:

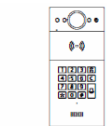

R20K x 1



Back cover x 1



Cable locking plate x 1



Rope x 1



Rubber Plug x 3 (S,M,L)



M2.5x6 screw x 6

Wall-mounting Accessories:

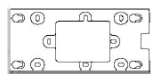

Wall-mounting bracket x 1



M4x30 screw x 2



ST4x20 screw x 4

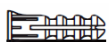

Screw fixing seat x 4



Allen Wrench x 1



M3x6 Allen screw x 2



Wall-mounting template x 1

Product Overview

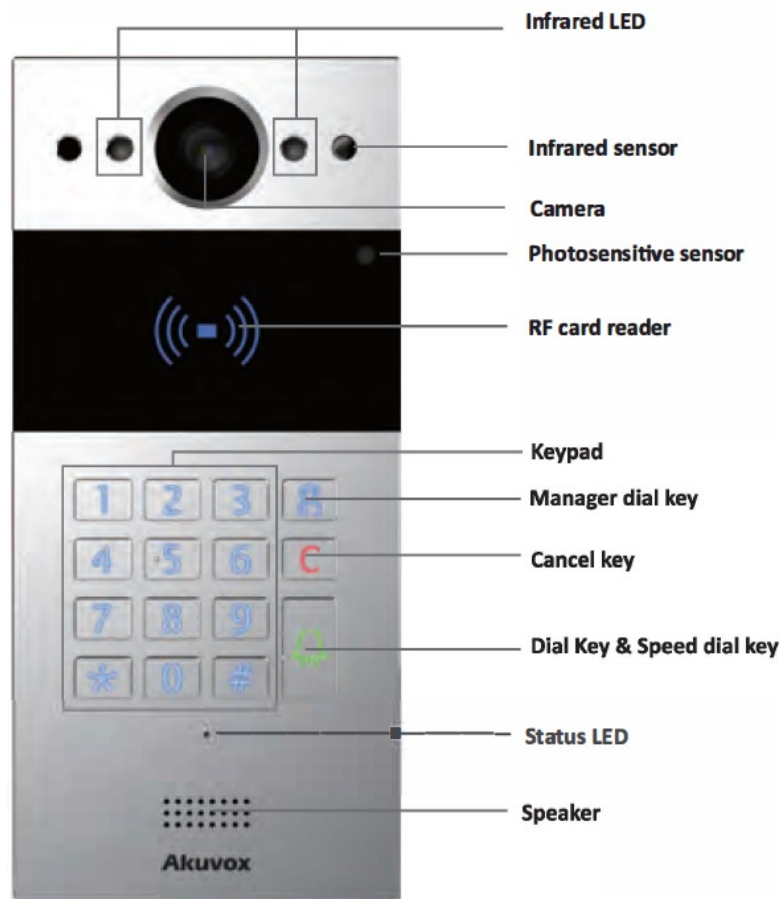

Installation Environment

Indoor and outdoor installation are supported. If installing the device outdoors, please don't place device under direct sunlight, it will bring a bad effect or be broken with the high temperature. If installing the device indoors, please keep device at least 2 meters away from light, and at least 3 meters away from window and door.

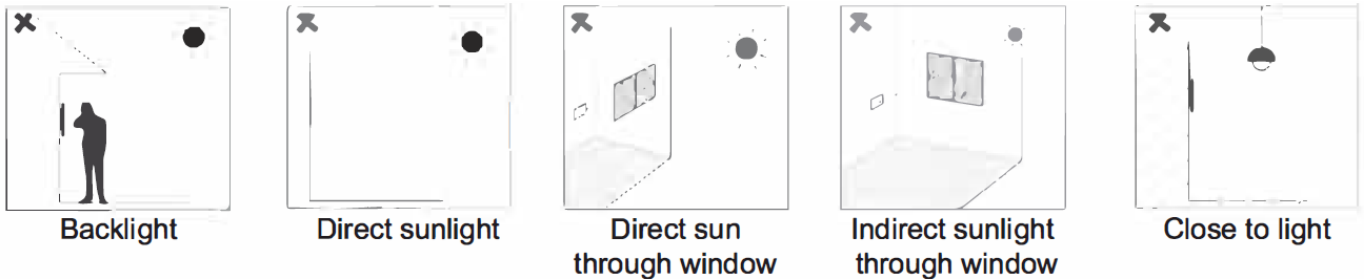

Wall-mounting Installation

Step I: Wall-mounting Bracket Installation

1. With embedded one-gang junction box(86×86 mm or 2×3 inches in size) in the wall.

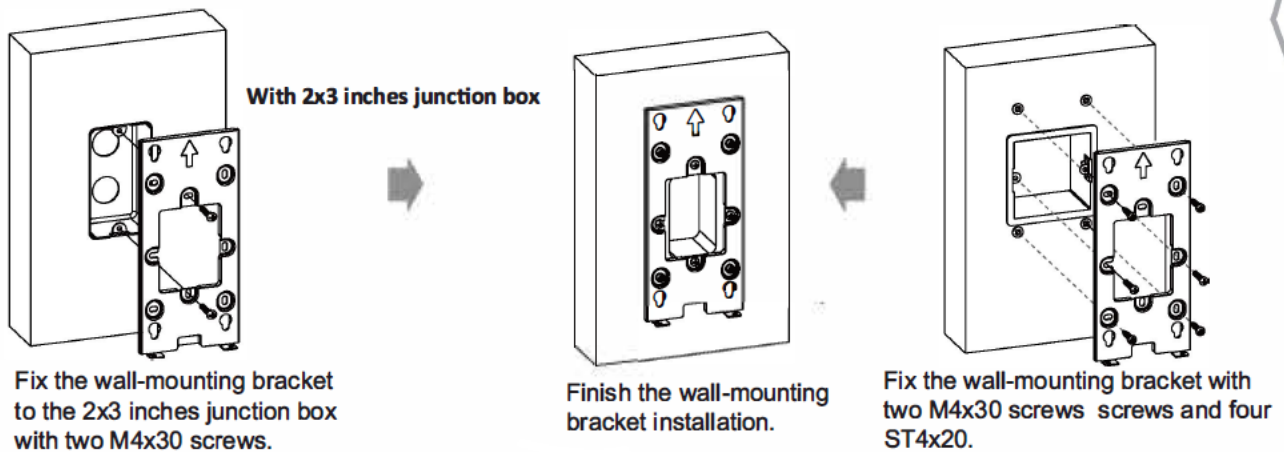
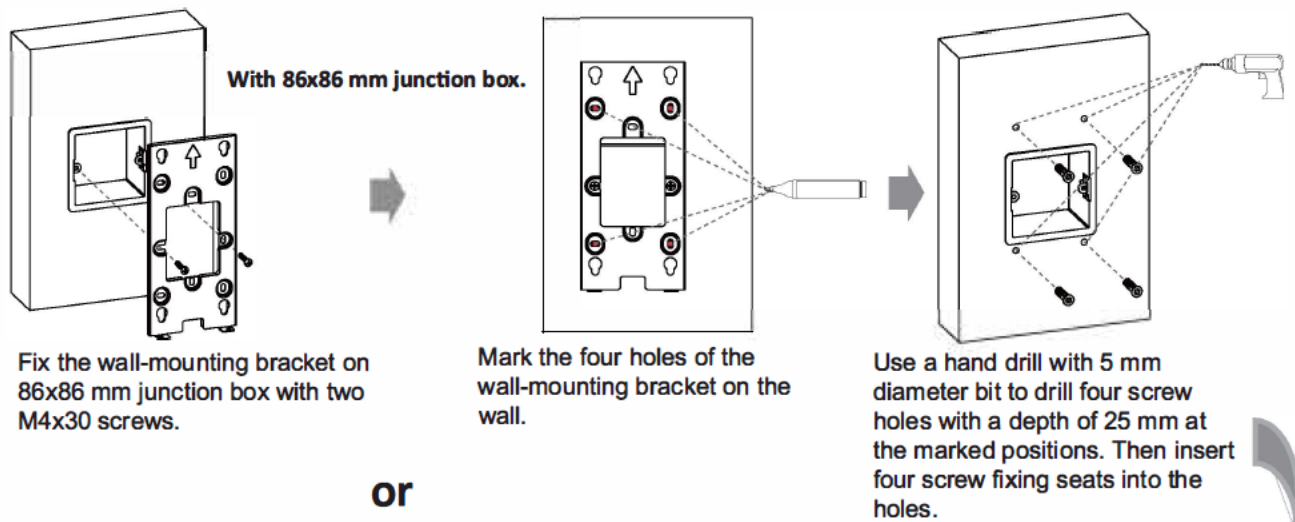

2. Without embedded junction box in the wall.

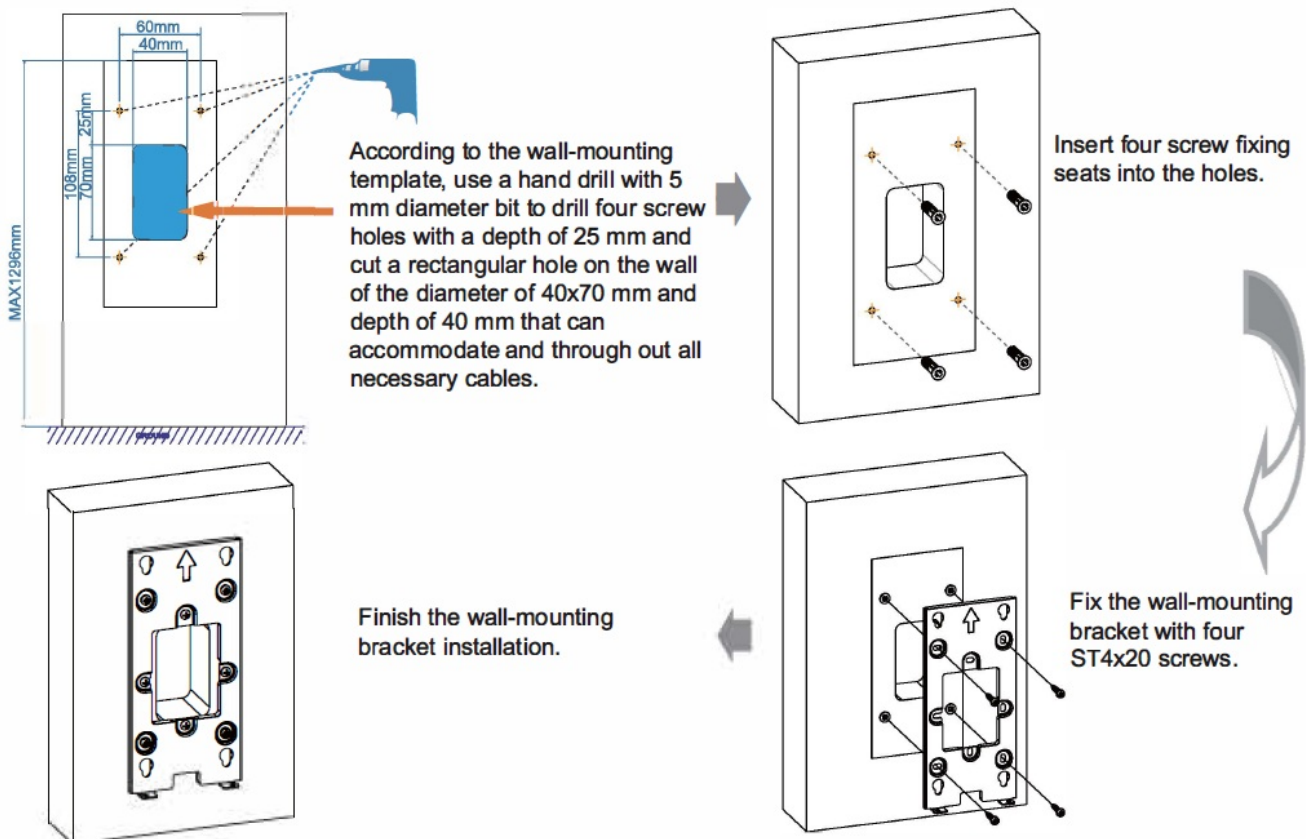

Step 2: Back Cover Installation

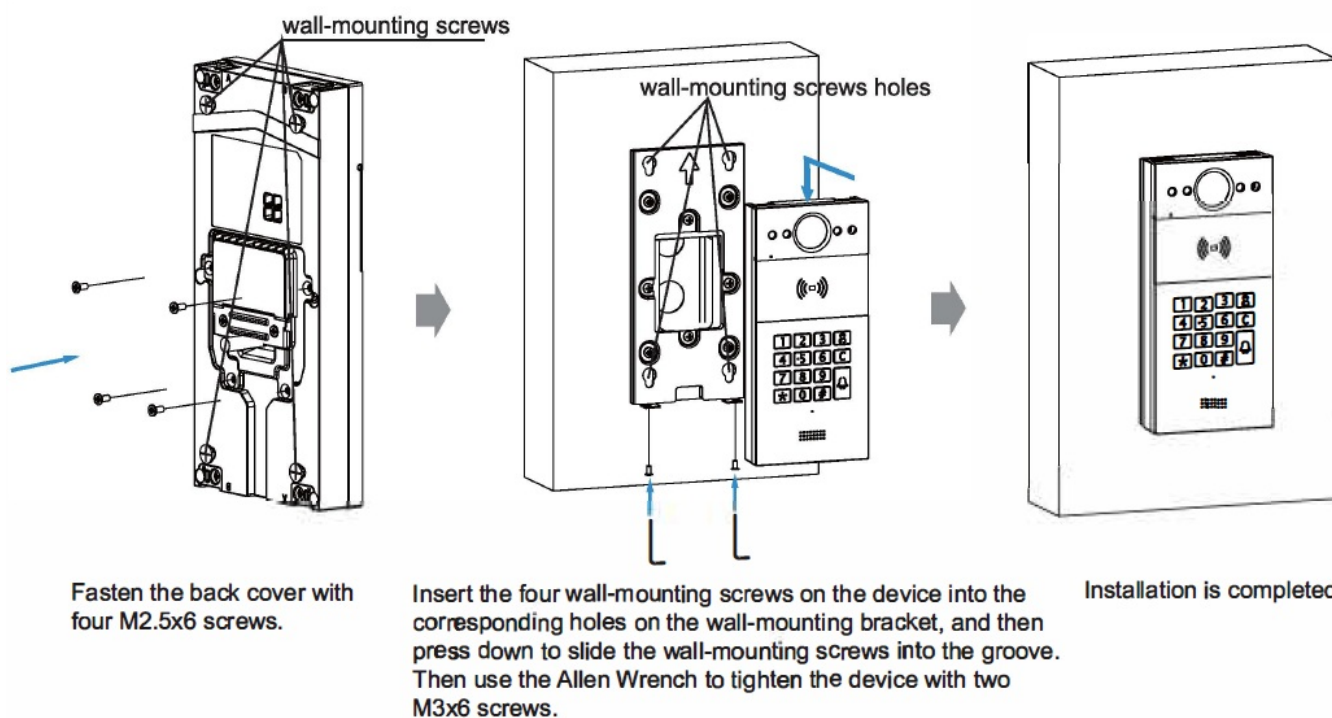
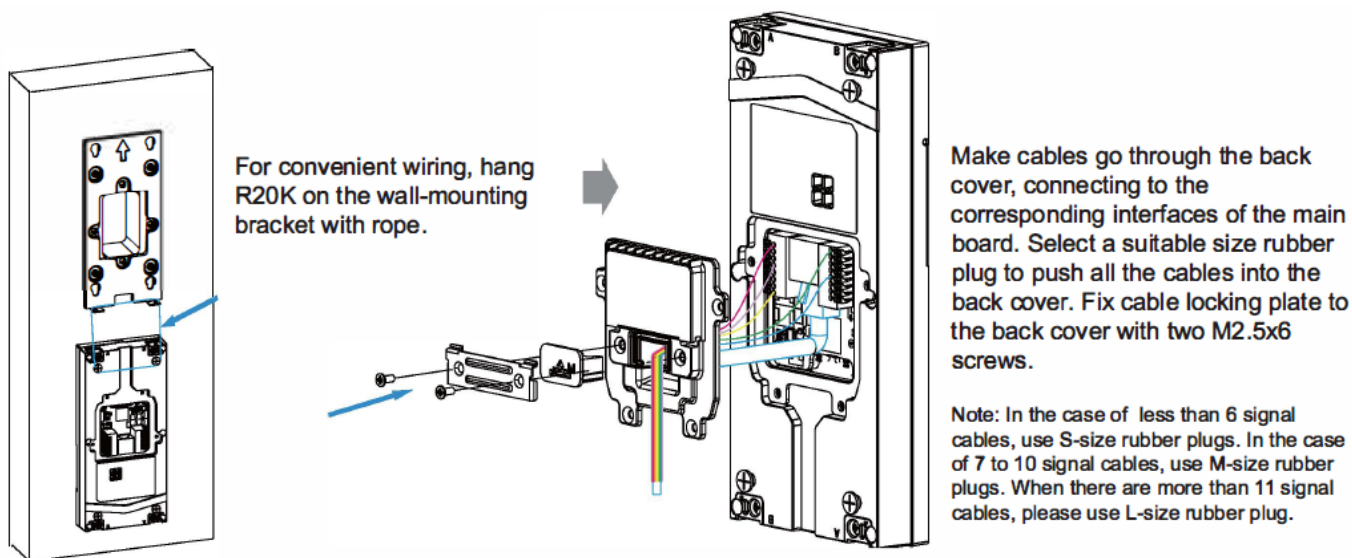

Device Wiring

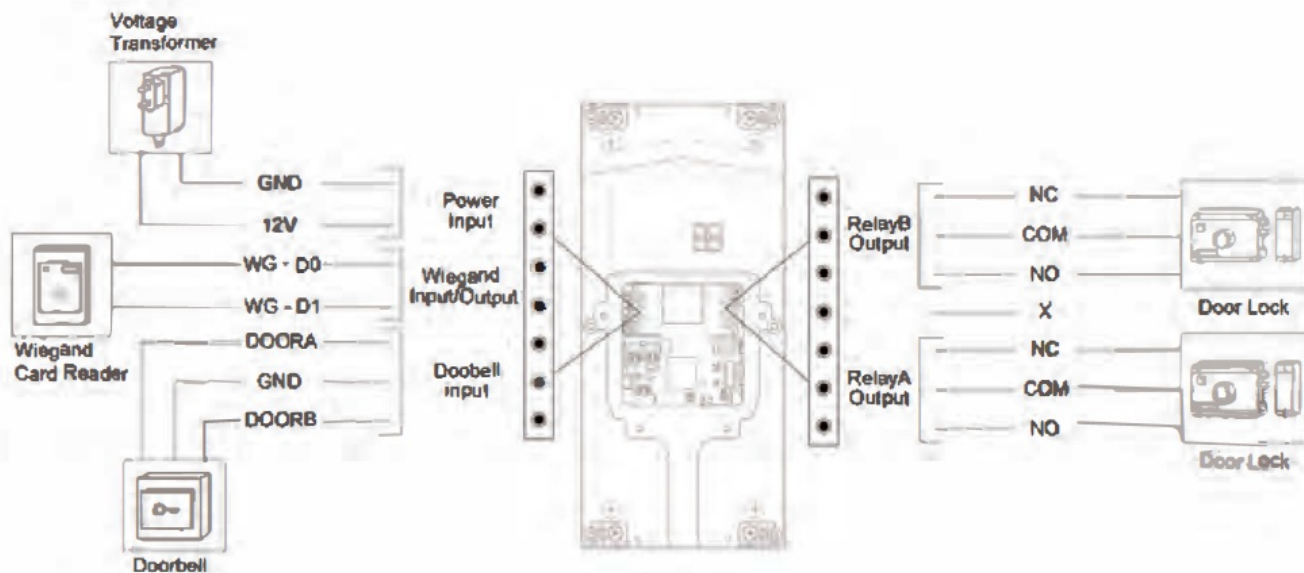

Application Network Topology

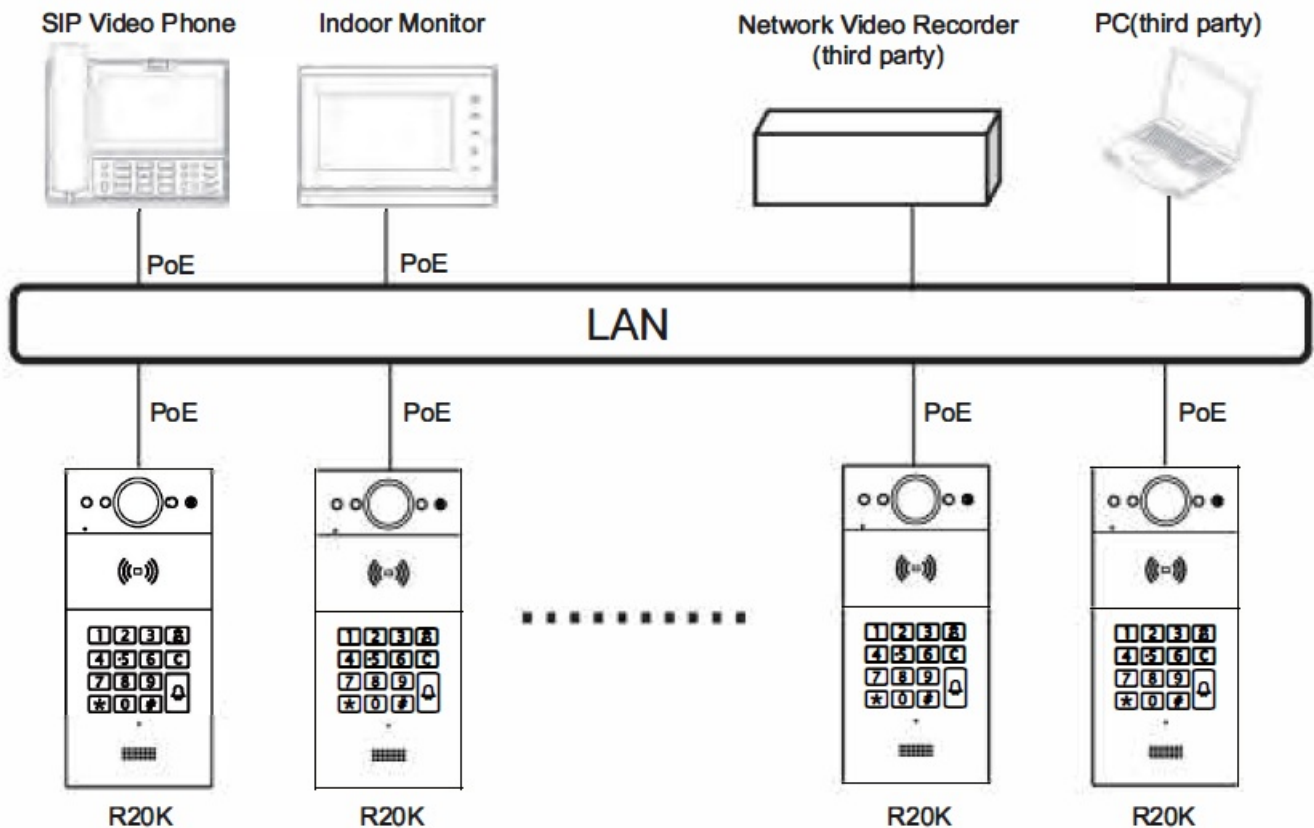

IP Announcement

1. While R20K starts up normally, press *3258*, voice system will enter IP announcement mode.
2. In announcement mode, the IP address will be announced periodically.
3. Press Cancel Button again to quit the announcement mode.
4. In announcement mode, phone announces "IP 0.0.0.0" if no IP address is gained.

Configuration

1. Access the Web UI: Input the IP address into web browser to configure the phone.
2. Account Registration: On web UI, go to the path: Account-> Basic page Register Account and fill in the account information. (Please refer to user manual for more information)
3. Configure the Push Button: On web UI, go to the path: Intercom -> Basic-> Push Button to configure the call number.
4. Configure the code to open the relay: On web UI, go to the path: Intercom-> Relay -> Relay IDIDTMF and choose the DTMF code number in the corresponding area.

Operation



- **Make a call:**
 - Press the SIP number or IP address and dial key to make a call.
- **Receive a call:**







R20K supports Auto Answer by default. Incoming call will be answered automatically.

• Unlock:

1. During the talk, called party can press pre-configured code number to unlock the door;
2. Scan the predefined RFID card nearby the card reader to unlock;
3. Press the predefined pin code to unlock.

Indicators

 Light ON  Light OFF

Name	Status		Description
Status indicator	Blue		Normal status
			Calling
	Red		Restarting
			Network is unavailable
	Green		Initialing/Talking on a call
			Receiving a call
	Red/Blue		Firmware upgrading

Notice Information

Akuvox R20K firmware contains third-party open-source software under the terms of the GNU General Public License (GPL). Akuvox is committed to meeting the requirements of the GNU General Public License (GPL) and will make all required source code available.

The source code of software under the terms of GNU GPL can be downloaded online:

<http://www.akuvox.com/gpl>.

Information contained in this document is believed to be accurate and reliable at the time of printing. This document is subject to change without notice, any update to this document can be viewed on Akuvox's website:

<http://www.akuvox.com> © Copyright 2020 Akuvox Ltd. All rights reserved.

AKUVOX (XIAMEN) NETWORKS CO., LTD.



ADD: 10/F, NO.56 GUANRI ROAD, SOFTWARE PARK II, XIAMEN 361009, CHINA

www.akuvox.com

Documents / Resources



[Akuvox R20K RF Card Reader](#) [pdf] User Guide
R20K RF Card Reader, RF Card Reader, R20K Card Reader, Card Reader, Reader, R20K