



Akuvox R20A IP Calling Panel User Guide

[Home](#) » [Akuvox](#) » Akuvox R20A IP Calling Panel User Guide 

Contents

- [1 Akuvox R20A IP Calling Panel](#)
- [2 Product Information](#)
- [3 Product Usage Instructions](#)
- [4 Unpacking](#)
 - [4.1 Mainframe Accessories](#)
- [5 Installation](#)
- [6 Documents / Resources](#)
 - [6.1 References](#)
- [7 Related Posts](#)

Akuvox

Akuvox R20A IP Calling Panel



Product Information

The R20A/R20A-2 is a device that requires wall mounting and is used for security purposes. The package includes a mainframe and accessories such as a rotary bracket, plastic wall anchors, M3x8 Torx screw, Allen wrench, ST4x20 screw, M4x10 screw, and Torx wrench. The rotary bracket is used to install the device on the wall while the wall-mounting bracket is fixed onto the rotary bracket.

Product Usage Instructions

1. Check the version of the device and ensure that all the accessories are included in the package.
2. Install the rotary bracket by marking the four holes of the rotary bracket on the wall and drilling them using a hand drill with a 5mm diameter bit. Insert four plastic wall anchors into the drilled holes and fix the rotary bracket onto them using four ST4x20 screws. Ensure that the bracket is square to the wall.
3. Install the wall-mounting bracket onto the rotary bracket using four M4x10 screws.
4. Adjust the rotary bracket by fixing the M3x8 Torx screws onto it using the Torx wrench and tightening them at an appropriate angle.
5. Refer to the R20A or R20A-2 quick guide to install the device's back cover and hang the device on the wall-mounting bracket.
6. The installation is now complete.

Notice Information: AKUVOX (XIAMEN) NETWORKS CO., LTD. ADD: 10/F, NO.56 GUANRI ROAD, SOFTWARE PARK II, XIAMEN 361009, CHINA www.akuvox.com

Unpacking

Before you begin using the device, please check the version you got and ensure that the following items are included in the shipped box:

Mainframe Accessories

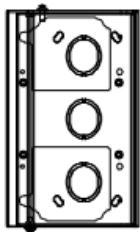

Rotary bracket x 1

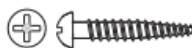

ST4x20 screw x 4



Plastic wall anchor x 4



M4x10 screw x 4



M3x8 Torx screw x 2



Torx wrench x1



Allen wrench x 1

Installation

Step1: Rotary Bracket Installation

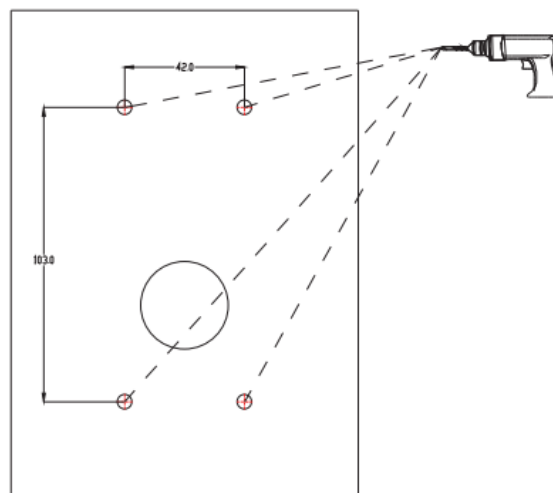
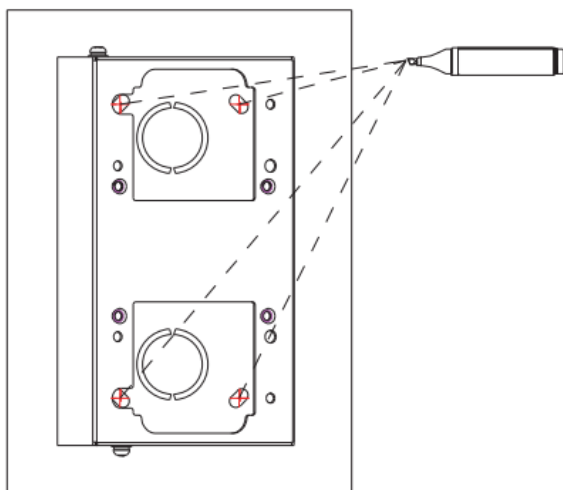

- Mark the four holes of the rotary bracket on the wall.
- Use a hand drill with a 5mm diameter bit to make the holes (20 mm in depth) in the marked positions.

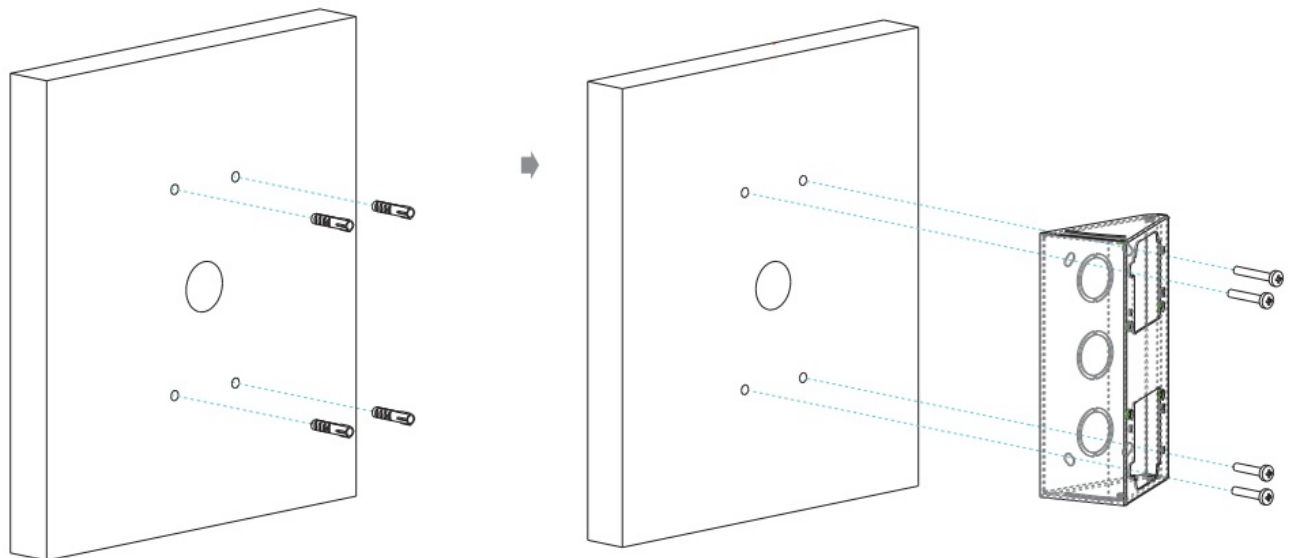

- Insert the four plastic wall anchors into the four drilled holes.
- Fix the rotary bracket onto the four plastics wall anchors using four ST4 x20 screws, and make sure the bracket is square to the wall.

Step2: Wall-mounting Bracket Installation

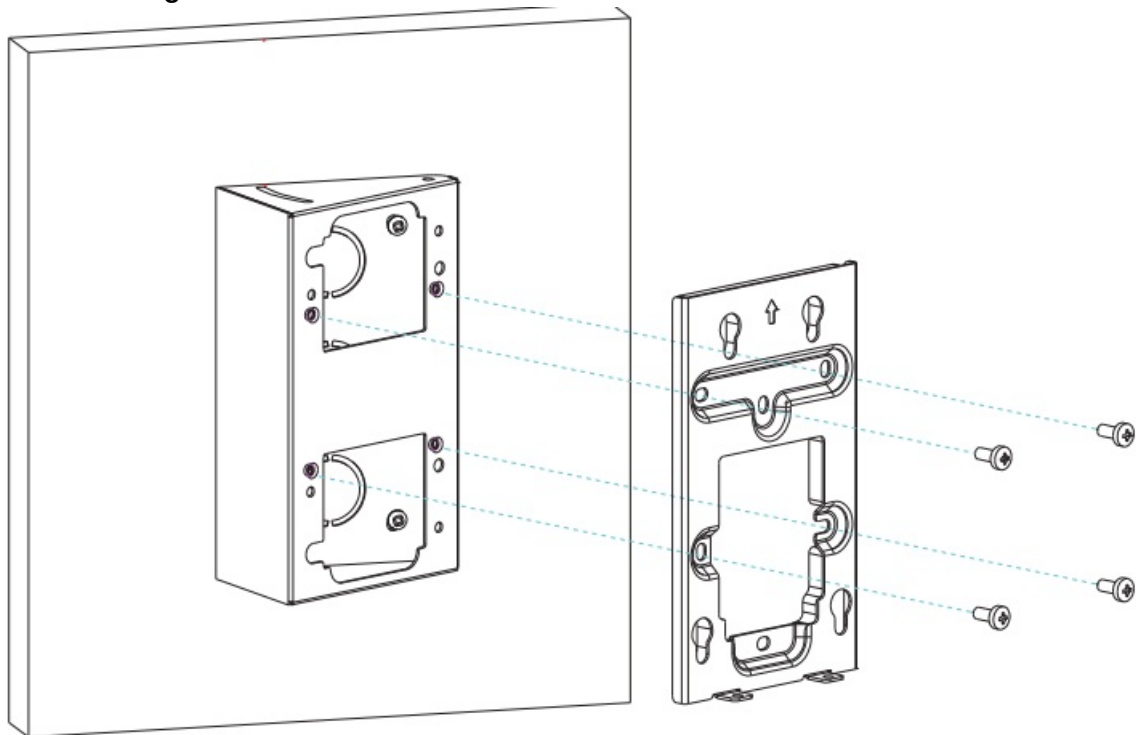

Fix the wall-mounting bracket onto the rotary bracket using four M4x10 screws.

Step3: Rotary Bracket Adjustment

Note: Please refer to R20A or R20A-2 quick guide to install the device back cover and to hang the device on the wall-mounting bracket.

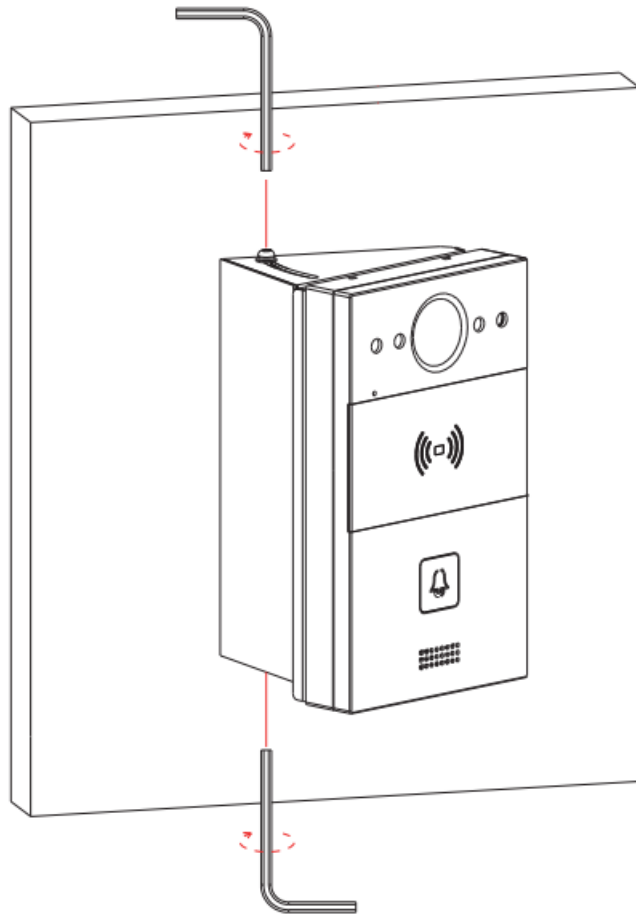

- Fix the M3×8 Torx screws onto the rotary bracket using the Torx wrench, then tighten the screws at the appropriate rotary angle.

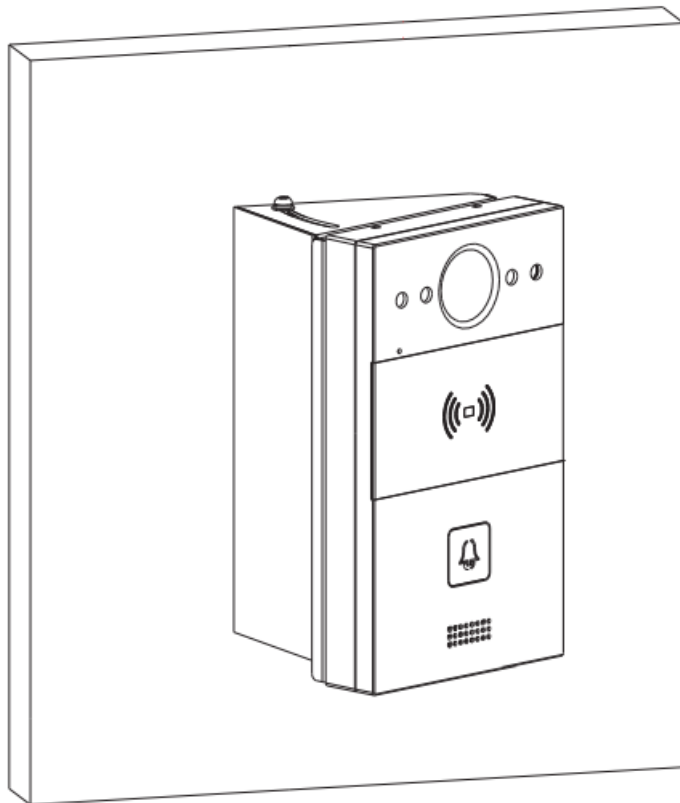

- Installation completed.

Notice Information

- Information contained in this document is believed to be accurate and reliable at the time of printing.
- This document is subject to change without notice, any update to this document can be viewed on Akuvox's website: <http://www.akuvox.com>
- © Copyright 2021 Akuvox Ltd. All rights reserved.
- **AKUVOX (XIAMEN) NETWORKS CO., LTD.**
- **ADD: 10/F, NO.56 GUANRI ROAD, SOFTWARE PARK II, XIAMEN 361009, CHINA** www.akuvox.com



Documents / Resources

	<p>Akuvox R20A IP Calling Panel [pdf] User Guide R20A IP Calling Panel, R20A, IP Calling Panel, Calling Panel, Panel</p>
--	--

References

-  [Akuvox | The Leader in Smart Intercom](#)