



## **AG ONE Multi Modes Mouse**



# **AKKO AG ONE Multi Modes Mouse User Manual**

[Home](#) » [AKKO](#) » AKKO AG ONE Multi Modes Mouse User Manual 

### **Contents**

- [1 AKKO AG ONE Multi Modes Mouse](#)
- [2 Specifications](#)
- [3 AG ONE Bottom Spec](#)
- [4 AG ONE Polling Rate](#)
- [5 AKKO Warranty and Service Statement](#)
- [6 Contact](#)
- [7 Documents / Resources](#)
  - [7.1 References](#)



**AKKO AG ONE Multi Modes Mouse**



**Thank you for supporting Akko.**

To provide you with a better user experience, please read this manual carefully before using the product.

## **Specifications**

The AG ONE features a symmetrical design with a universal grip, making it suitable for most users in both gaming and working environments.

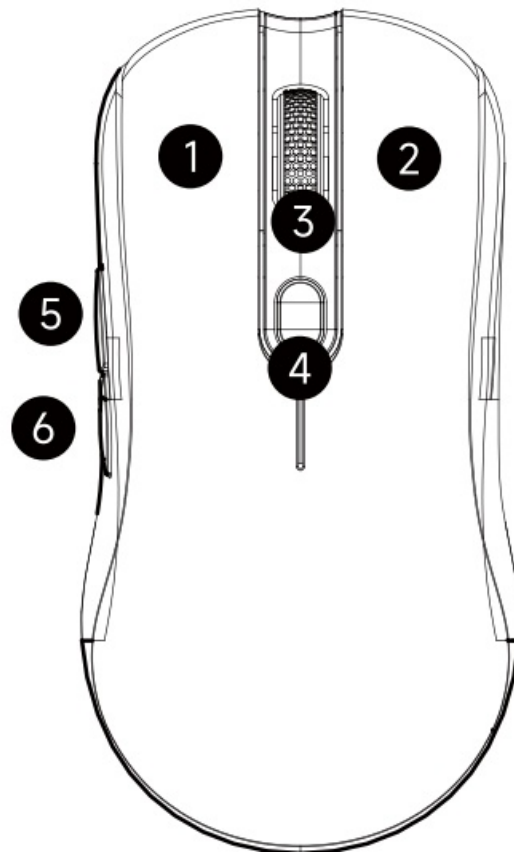

1. Left mouse button
2. Right mouse button
3. Scroll wheel + Middle key
4. DPI button
5. Forward button
6. Back button

Status	Indicator	Re-Connecting	Pairing	Connected
Wired mode	N/A	N/A	N/A	N/A
2.4G	Next to DPI key	Slow flashing	Fast flashing	Steady LED for 2s
BT	Next to DPI key	Slow flashing	Fast flashing	Steady LED for 2s

Status	Indicator	Indicating mode
Low Battery	DPI	Fast flashing
Charging	DPI	Steady
Fully Charged	DPI	OFF
1st DPI Step	DPI	Red LED
2st DPI Step	DPI	Orange LED
3st DPI Step	DPI	Yellow LED
4st DPI Step	DPI	Green LED
5st DPI Step	DPI	Cyan LED
6st DPI Step	DPI	Blue LED
7st DPI Step	DPI	Purple LED
8st DPI Step	DPI	White LED

## AG ONE Bottom Spec

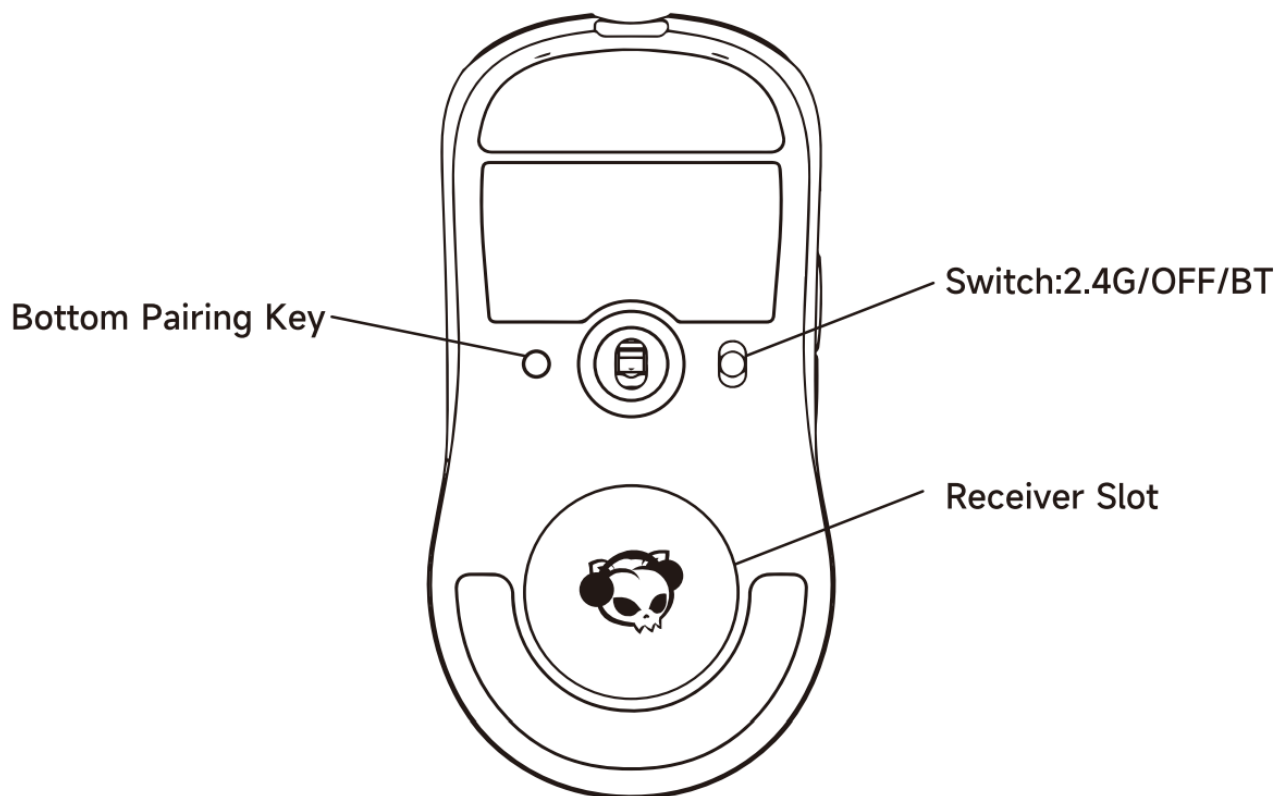

Model	AG ONE	Connection	2.4G+Bluetooth+Wired
Size	≈125*67*37mm	Receiver Interface	USB
Weight	≈65g	Effective Distance	≥10m
Pairing Key	Long press 3S to enter Pairing mode	Battery Capacity	3.7V / 500mAh
Sensor	PAW3395	Rating of Charger	USB 5V
Bottom Switch	2.4G/OFF/BT	Hit left and right key	One hundred million timesn
Polling Rate	Bluetooth 125Hz /2.4G 8000Hz / Wired 8000Hz		
DPI	400/800/1200/1600(Default)/3200/6400/10000/26000		

### AG ONE Polling Rate

Status	Rates	Note
Wired mode	125/500/1000/2000/4000/8000 (Default)	6th Level DPI Adjustable in Software
Bluetooth	125 (Default)	Non-Adjustable
2.4G	125/500/1000/2000/4000/8000 (Default)	6th Level DPI Adjustable in Software

### AKKO Warranty and Service Statement

1. Akko provides One-Year warranty for customers in mainland China. For other regions, please contact your seller (Akko distributor) for specific warranty policy.
2. If the warranty window expires, customers need to pay for repairs. Akko will also provide instructions if users prefer to repair the mouse by themselves. However, users shall take full responsibility for any loss happened during self-repair.
3. Defects resulting from disassembly of our product, improper usage and incorrect installation are not covered by warranty.
4. The return and warranty policy may vary in different platforms and are subject to the specific distributor at the time of purchase.

## Contact

- Company: Shenzhen Yinchen Technology Co., Ltd
- Address: 33 Langbi Rd, Bitou Community 1st Industrial Zone, Bao'an District, Shenzhen, China
- Tel: 0755-23216420
- Website: [www.akkogear.com](http://www.akkogear.com)
- Origin: Shenzhen, China

[www.akkogear.com](http://www.akkogear.com)



@akkogear

## Documents / Resources

	<p><a href="#">AKKO AG ONE Multi Modes Mouse</a> [pdf] User Manual</p> <p>AG ONE Multi Modes Mouse, AG ONE, Multi Modes Mouse, Modes Mouse, Mouse</p>
---	---

## References

- [User Manual](#)

[Manuals+](#), [Privacy Policy](#)

This website is an independent publication and is neither affiliated with nor endorsed by any of the trademark owners. The "Bluetooth®" word mark and logos are registered trademarks owned by Bluetooth SIG, Inc. The "Wi-Fi®" word mark and logos are registered trademarks owned by the Wi-Fi Alliance. Any use of these marks on this website does not imply any affiliation with or endorsement.