



Akiyo B0CLP68G3T Mini Projector with WiFi and Bluetooth User Manual

[Home](#) » [AKIYO](#) » Akiyo B0CLP68G3T Mini Projector with WiFi and Bluetooth User Manual 

Contents

- [1 Akiyo B0CLP68G3T Mini Projector with WiFi and Bluetooth](#)
- [2 Product Information](#)
- [3 Product Usage Instructions](#)
- [4 PACKAGE LISTS](#)
- [5 FUNCTION OVERVIEW](#)
- [6 QUICK START](#)
- [7 CONNECTIONS INSTRUCTIONS](#)
- [8 For iOS System](#)
 - [8.1 For Android System](#)
- [9 HDMI Devices Connection](#)
- [10 Projection Distance and Screen Size](#)
- [11 SPECIFICATION](#)
- [12 TROUBLESHOOTING](#)
- [13 FCC Notice](#)
- [14 PROJECTOR CARE](#)
- [15 WARRANTY](#)
- [16 Documents / Resources](#)
 - [16.1 References](#)
- [17 Related Posts](#)

Akiyo

Akiyo B0CLP68G3T Mini Projector with WiFi and Bluetooth



Product Information

This product is a multi-purpose device designed for various uses. It is equipped with advanced technology to provide optimal performance and convenience.

The product is available in two versions: IT and JP, which cater to the specific needs of different regions.

Key Features

- Advanced technology for improved performance
- Multi-purpose functionality for versatile usage
- Available in two versions: IT and JP

Specifications

Model	Version
34	IT
35	IT
36	IT
37	IT
38	IT
39	IT
40	IT
41	IT
42	JP
43	JP
44	JP
45	JP
46	JP
47	JP
48	JP
49	JP

Product Usage Instructions

To use the product effectively and safely, please follow these instructions:

1. Ensure that the product is placed on a stable surface.
2. Connect the power cable to a suitable power source.
3. Turn on the power button located on the device.
4. Wait for the device to initialize and display the main menu.
5. Use the control buttons or touchscreen (if available) to navigate through the menu options.
6. Select your desired function or mode from the menu.
7. Follow any on-screen prompts or instructions for specific actions.
8. Adjust any necessary settings or parameters according to your preferences.
9. If using external devices, ensure they are properly connected to the product.
10. Refer to the user manual for detailed instructions on specific features or functions.
11. To power off the device, press and hold the power button until it shuts down.
12. Always unplug the power cable before cleaning or performing maintenance on the device.
13. Keep the product away from water, extreme temperatures, and direct sunlight.
14. Do not disassemble or modify the product without proper authorization.
15. If you encounter any issues or have questions, refer to the troubleshooting section of the user manual or contact our customer support.

By following these instructions, you can ensure optimal performance and longevity of the product.

PACKAGE LISTS

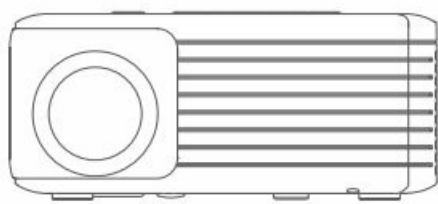

Projector



Tripod



User Manual

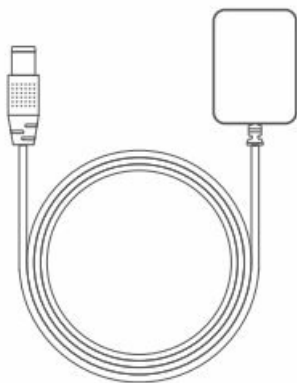

Power Cable



Remote

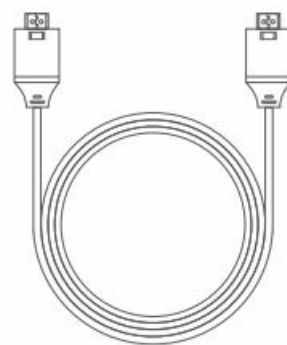

HDMI Cable

FUNCTION OVERVIEW

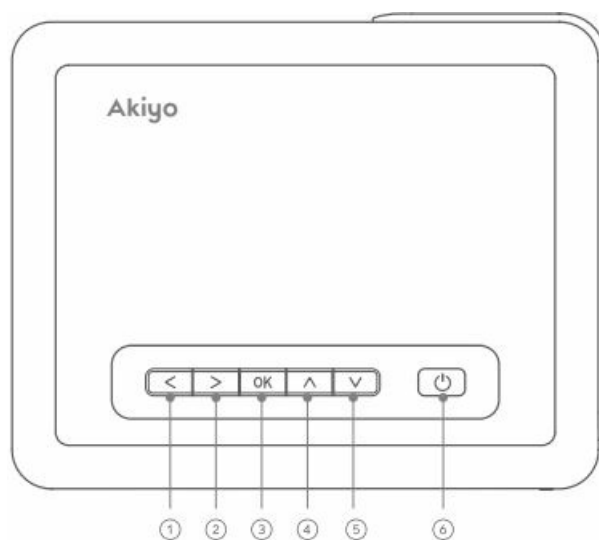

1. Left
2. Right
3. Ok
4. Up/menu
5. Down/source
6. Power

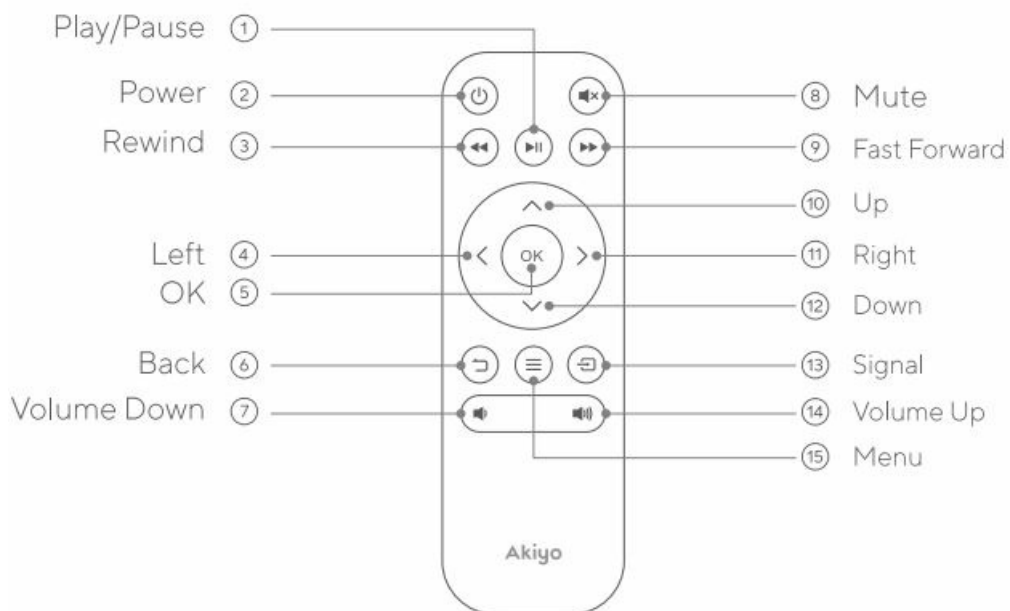

1. IR Receiver
2. Power Supply
3. Audio out
4. HDMI
5. AV
6. USB
7. Keystone correction
8. Focus Wheel

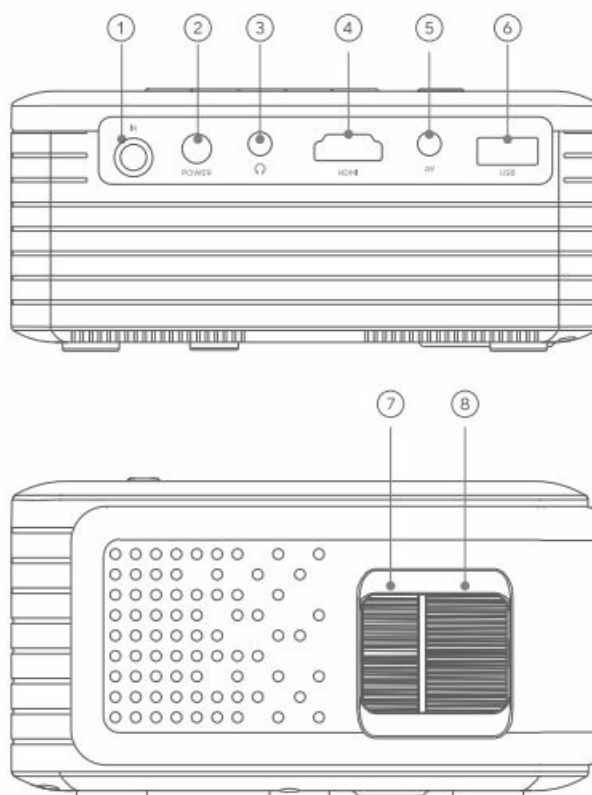

QUICK START

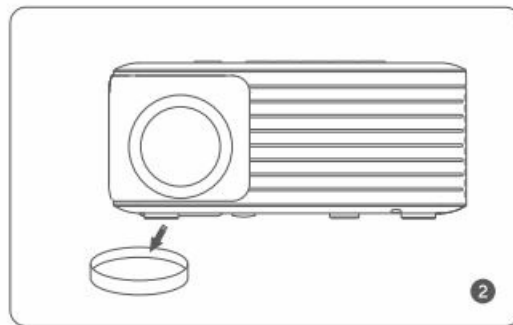
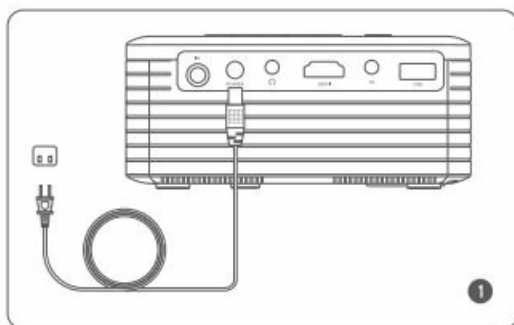

1. Plug the power cord into an outlet.
2. Take off the lens cover.

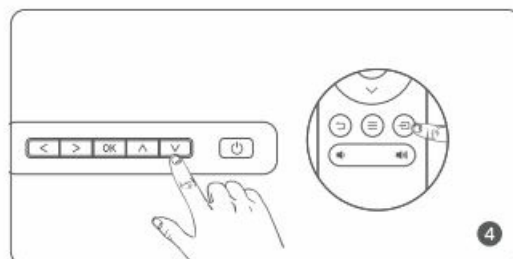
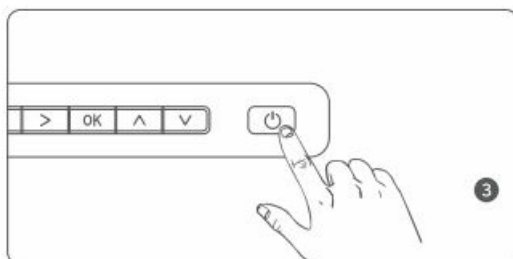

3. Press the power button to turn on the projector.
4. Press the on the remote button or **V** to select the input source.

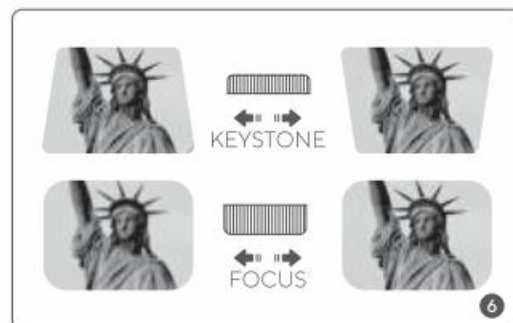
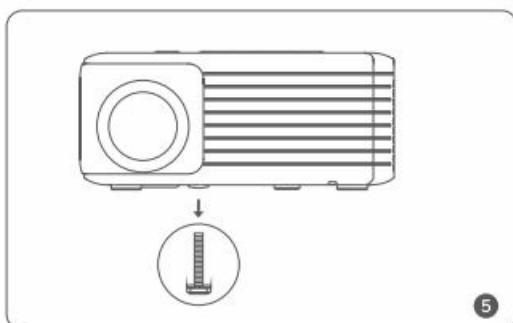

5. Adjust the screw bracket.
6. Adjust the keystone and focus wheel to get a clear image.

CONNECTIONS INSTRUCTIONS

Bluetooth Connection

If you want to use Bluetooth, first connect the projector to a Bluetooth device, and then connect the projector to the other input device (such as a smartphone or computer, etc.). You can set the Bluetooth as below:

1. Click “Setting” on the menu.
2. Choose the “Bluetooth Setting”. Find your Bluetooth device and pair it with the projector.

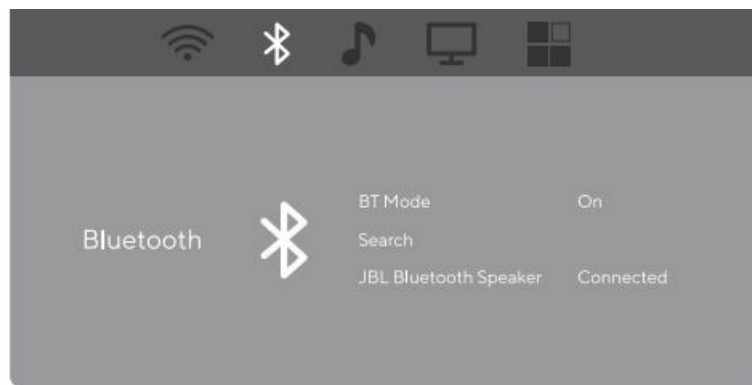

Smartphone Connection

- The wireless connection methods for iOS and Android smartphones are as follows
- **Tip:** Please select “Screen Mirroring” from the home menu, then choose the wireless connection you need.

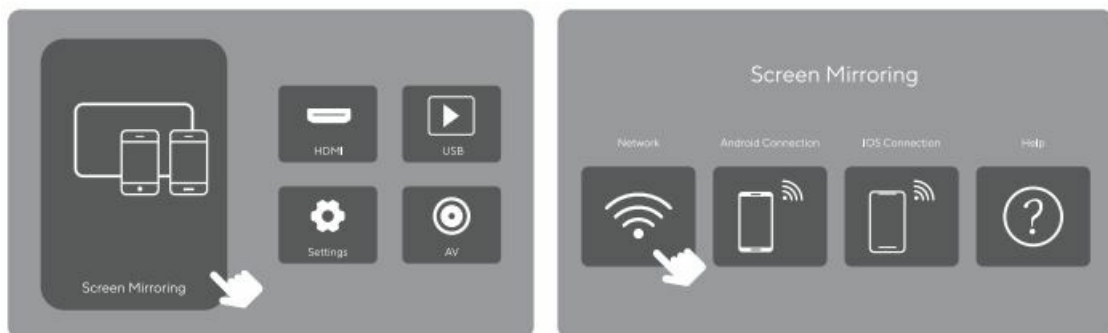

For iOS System

Cellular Connection for iPhone

1. Choose the “iOS Connection” on the interface of Screen Mirroring.
2. Turn on the WLAN of your iOS device and join the network “01 X”.
3. Then go to the “Screen Mirroring” of the iOS device and select “01 X” to connect
4. The connection success.

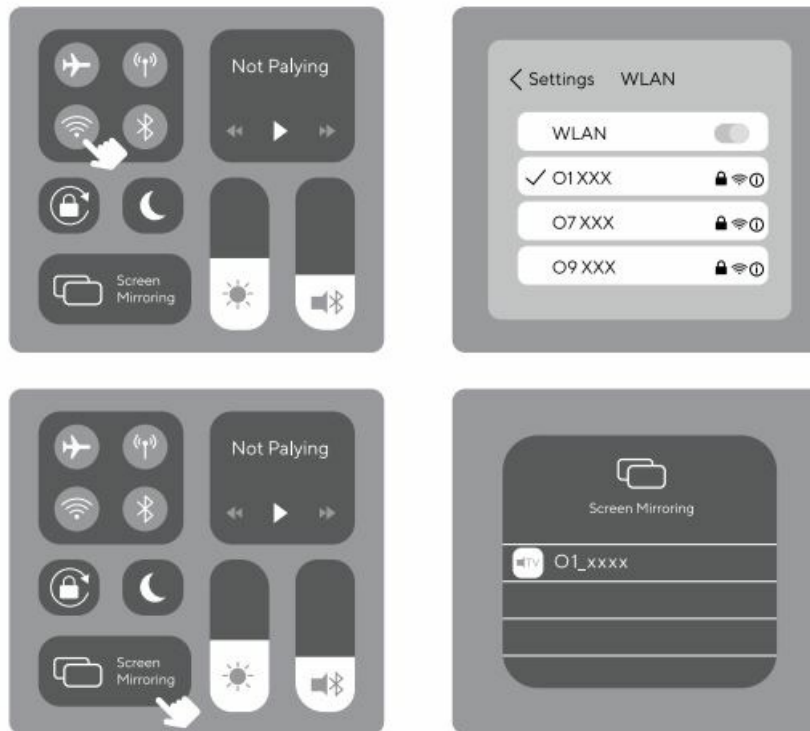

Wi-Fi Connection for iPhone

1. Select "Network from the Screen Mirroring interface and connect your Wi-Fi.
2. Return to the interface and chose the "iOS Connection".
3. Turn on the WLAN of your iOS device and connect to the same Wi-Fi network above.
4. Then go to the "Screen Mirroring" of the iOS device and select "O1 xxxx" to connect.
5. The Wi-Fi connection success.



For Android System

Wireless Connection for Android

1. Please confirm your Android device has the "Screen Casting" function first.
2. Chose the "Android Connection" on the interface of Screen mirroring
3. Turn on the WLAN/Wi-Fi of your Android device.
4. Turn on "Screen Casting" in the phone's Settings, then select "O1 X" to connect. Different phones have different names for the mirroring feature, please refer to the chart in the connection prompt screen.

Tip: You can use both Wi-Fi and the Android phone's data to connect the projector with the above steps.

Notes for Connecting Smartphones to the Projector

1. The smoothness of the projector connection is affected by the strength of your Wi-Fi signal. Please make sure that the Wi-Fi signal is good enough.
2. If you connect the projector via a new Wi-Fi network for the first time, please enter the Wi-Fi password in the projector.
3. The projector can support most of the cell phones in the market for wireless connection. However, due to a special security protocol for Google phones, it cannot connect wirelessly or wired to any projector.
4. Some streaming applications (Netflix, Amazon Prime, Disney+) are copyrighted and so do not support smartphone wireless screen casting. There could be problems with no sound or picture. It is not the projector restricting you, but the wireless screen casting restricting you. You can use a Fire TV Stick or connect with your PC via HDMI cable to watch them.

HDMI Devices Connection

- The projector can be connected to devices via the HDMI port. It is compatible with laptops, DVD players, Chromecast, TV sticks, etc.
- Please go to the main menu and select the HDMI input before connecting.
- **Tip:** The simplest way to connect to your laptop is to use an HDMI cable. It's also a good way to see if the projector is working properly.

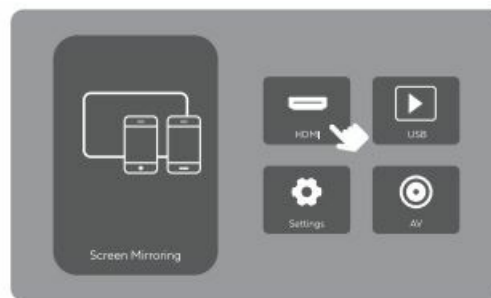

- Connect your device to the projector.
- **iPhone/iPad:** An official Lightning Digital AV adapter is Required (not included).
- **Android:** A USB C to HDMI Adapter/ Miracast/Dongle for a projector is Required (not included).

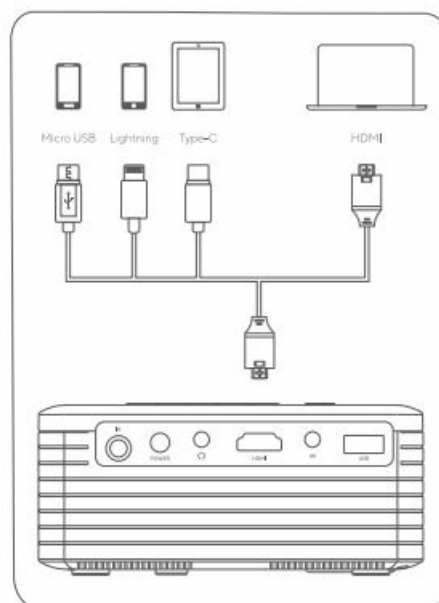

Projection Distance and Screen Size

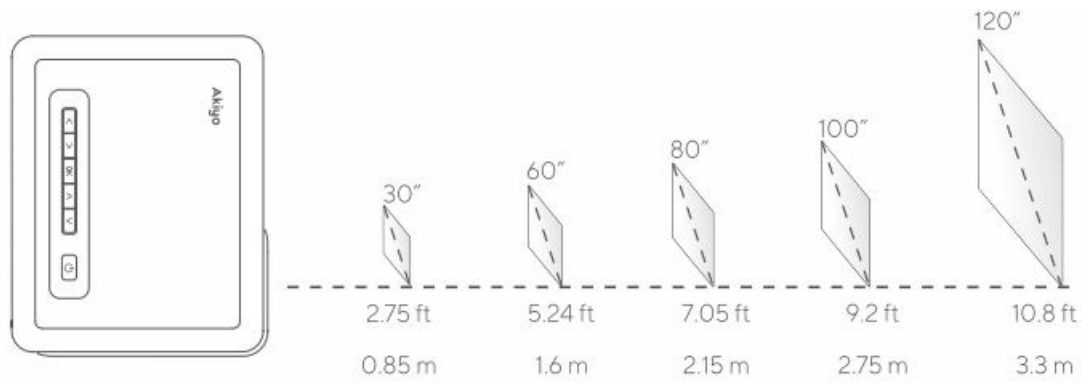

SPECIFICATION

Imaging Technology	LCD
Light Source	LED
Native Resolution	1280'720
Supported Resolution	1080P, 1080i, 720P, 576i, 480P and 480i
Lamp Life	50000 Hours
Aspect Ratio	4:3/169
Throw Ratio	1.1:1
Projection Distance	1-4.5m (1.5-2.5m recommended)
Screen Size	30-180 inch
Focus	Manual
Keystone	±20°
Input	HDMI/USB/AV/Audio out
Built-In Speaker	403W
Projector Input Voltage:	DC21V
Power Adapter Voltage:	AC 100V-240V, 50/60Hz
Net Weight	0.93lb
Dimension	5.4 X 3.5 X 2.8 inch
Image Format	BMP/JPG/JPEG/PNG
Audio Formats	MP2/MP3/PCM/FLAC/WMA/AAC
Video Formats	AVI/MP4/MKV/MOV/3GP/MPEG1/ MPEG2/H264/XVID
Installation Type	Front/Rear/Ceiling
Mounting Screw Size	M4

TROUBLESHOOTING

Q: How to get a clear image quality?

1. **A:** Recommended to use the projector in a relatively dark environment.
2. Place it horizontally, and adjust the focus wheel.
3. If use keystone correction, there might be some slight edge blur.

Q: How to connect a smartphone?

1. **A: iPhone:** an official Lightning digital AV adapter is Required (not included) .
2. **Android:** a USB C to HDMI Adapter/Miracast/Dongle for the projector is Required (not included).
3. If not work, you can contact support by email, We will provide professional services.

Q: There is no sound when playing a video.

1. **A:** Please turn off Dolby Audio on the connected device or App.
2. If not work, you can contact support by email, We are willing to provide professional services. Please contact us via: support.dp@akiyo.co

Q: The remote control does not work.

1. **A:** Check if the battery is in good condition.
2. Point the remote control at "IR Receiver".
3. If not work, you can contact support by email, We are willing to provide professional services. Please contact us via: support.dp@akiyo.co

FCC Notice

This device complies with the FCC rules. Part 15. Operation is subject to the following two conditions:

1. This device may not cause harmful interference,
2. This device must accept any interference received, including interference that may cause undesired operation.

Note: This equipment has been tested and found to comply with the limits for a Class B digital device, pursuant to part 15 of the FCC Rules.

These limits are designed to provide reasonable protection against harmful interference in a residential installation.

If this equipment does cause harmful interference to radio or television reception, which can be determined by turning the equipment off and on, the user is encouraged to try to correct the interference by one Of more of the following measures:

- Reorient or relocate the receiving antenna
- Increase the separation between equipment and receiver
- Connect the equipment to an outlet on a circuit different from that to which the receiver is connected
- Consult the dealer or an experienced radio / TV technician for help

RF Exposure Warning Statements:

This equipment complies with FCC radiation exposure limits set forth for an uncontrolled environment. This equipment shall be installed and operated with a minimum distance of 20cm between the radiator & body.

PROJECTOR CARE

Please use the Akiyo O1 mini projector in a dark environment

1. Do not look straight into the projector lens, Protect eyes from damage.
2. Children should be accompanied by an adult when using the projector.
3. Do not block the vents to prevent the projector from overheating.
4. Do not expose the projector to rain or moisture environment to reduce the risk of fire or electric shock. Objects filled with liquids, such as vases, should not be placed on this device, as it may lead to potential accidents that damage the device.
5. Do not make any repairs to this projector by yourself. Our company will not cover the warranty if self-repair efforts are undertaken.
6. Please only use the included power cable to power the projector.
7. Please keep the projector away from hot environments.
8. Please contact the seller for technical support when the product has any problems.

WARRANTY

- Provide a 2-year warranty and 30-day return or exchange service!
 - Akiyo Projectors Customer Service E-mail Addresses: support.dp@akiyo.co
 - Please use the Akiyo O1 mini WiFi projector in a dark environment.
 - Thank you for your purchase of an Akiyo product. As a trusted brand, we aim for 100% customer satisfaction with both our products and our service. If you feel we have not met that goal, please do contact us and we will meet your expectations.
 - Please inspect the projector immediately after receiving it to check for damage and insure proper working condition. Please contact us if you have any issues or would like to return or exchange the product.
 - Akiyo guarantees a 30-day refund and exchange policy on new projectors, as well as a 2-year warranty, support.dp@akiyo.co
-

Documents / Resources

	<p>Akiyo B0CLP68G3T Mini Projector with WiFi and Bluetooth [pdf] User Manual B0CLP68G3T Mini Projector with WiFi and Bluetooth, B0CLP68G3T, Mini Projector with WiFi and Bluetooth, Projector with WiFi and Bluetooth, WiFi and Bluetooth</p>
--	---

References

- [User Manual](#)