



AJAX WallSwitch Wireless Indoor Power Relay User Manual

[Home](#) » [ajax](#) » AJAX WallSwitch Wireless Indoor Power Relay User Manual 

AJAX WallSwitch Wireless Indoor Power Relay User Manual



Wall Switch is a wireless indoor power relay featuring a power consumption meter. The miniature body of the device is adapted for installation in a European-type socket.



Regardless of the type of electrical circuit, only a qualified electrician should install Wall Switch!

Wall Switch operates only within the Ajax security system (integration into third party security systems is not

provided), communicating with a <https://ajax.systems/products/#block2> via the protected [Jeweler](#) protocol. The communication range is up to 1,000 meters in the line of sight.

Use scenarios to program actions of <https://ajax.systems/products/#block9> (Relay, Wall Switch, or Socket) in response to an alarm, [Button](#) press, or schedule. A scenario can be created remotely in the Ajax app.

[How to create and configure a scenario in the Ajax security system](#)

The Ajax security system can be connected to the central monitoring station of a security company.

[Buy power relay Wall Switch](#)

Contents

- 1 Functional Elements
- 2 Operating Principle
- 3 Connecting to the hub
 - 3.1 States
 - 3.2 Settings
 - 3.3 Indication
 - 3.4 Functionality testing
- 4 Installation of the Device
- 5 Maintenance
- 6 Tech specs
- 7 Complete Set
- 8 Documents / Resources
 - 8.1 References
- 9 Related Posts

Functional Elements

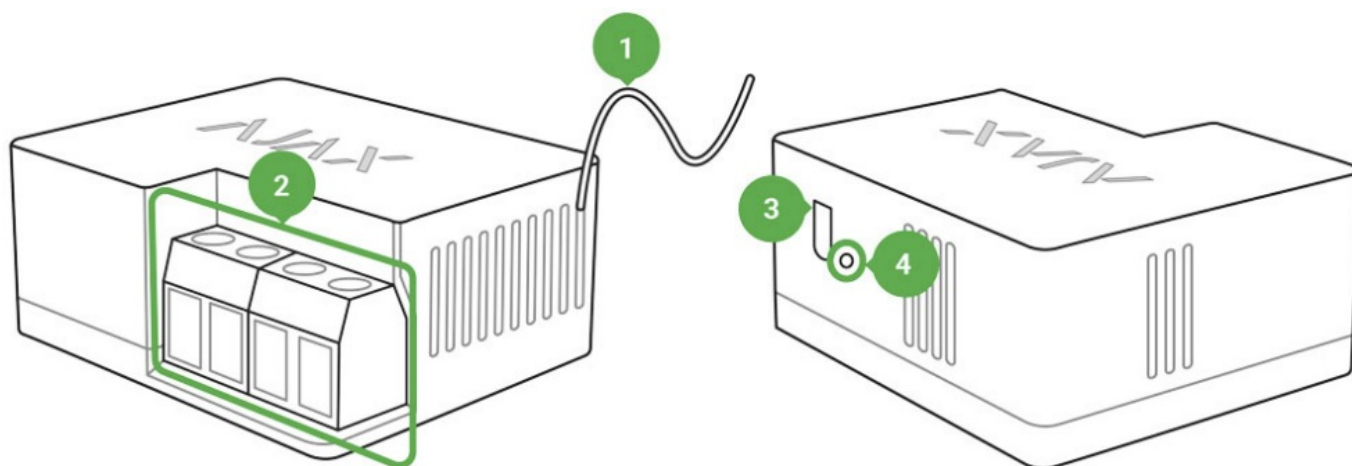

- 1. Antenna
- 2. Terminal blocks
- 3. Functional button
- 4. Light indicator

IN terminals:

- **L terminal** — power supply phase terminal.
- **N terminal** — power supply neutral terminal.

OUT terminals:

- **N terminal** — connected device neutral output contact terminal.
- **L terminal** — connected device phase output contact terminal.

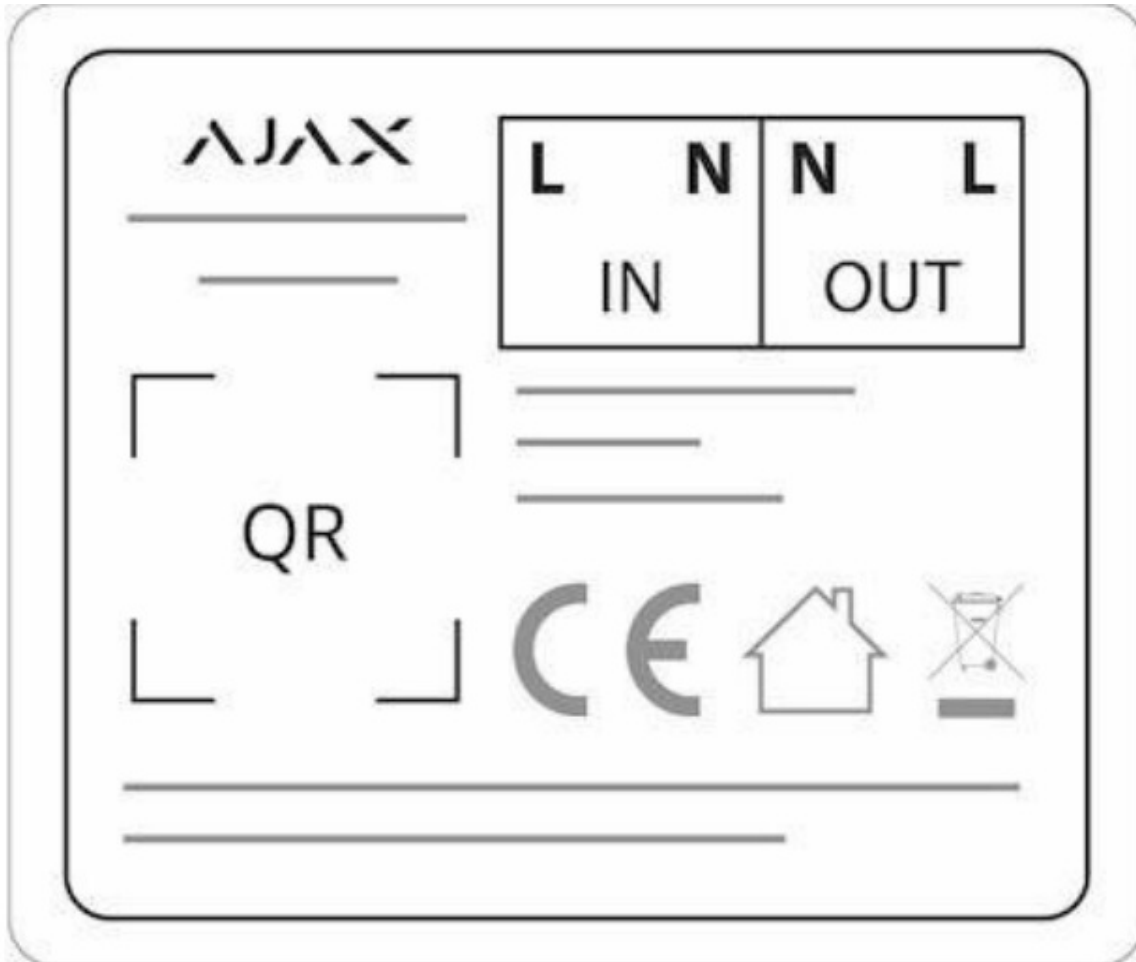

Operating Principle

Wall Switch input terminals are connected to the grid, and the output terminals are connected to the socket or electrical appliance/system. Wall Switch closes/opens the electric circuit, controlling the power supply by the command of the security system user through the [Ajax app](#). The state of Wall Switch contacts can be switched manually: by holding the function button for 2 seconds. To make Wall Switch react to alarm or schedule automatically, you can configure a scenario.

Wall Switch features a protection system against voltage surge beyond the range of 184V – 253V or overcurrent above 13A. In this case, the power supply is interrupted, resuming after normalizing the voltage and current values.

The maximum resistive load on the relay is 3 kW.

You can check the power usage by the electrical appliance connected via Wall Switch through the app. There is a power consumption meter.

Wall Switch, with rewire version 5.54.1.0 and higher, can operate in pulse or biostable mode. With this rewire version, you can also select the normal relay contact state:

- **Normally closed (NC)** — the contacts open when the relay is activated and closed when the relay is inactive.
- **Normally open (NO)** — the contacts close when the relay is activated and open when the relay is inactive.

Wall Switch, with rewire version below 5.54.1.0, only works in biostable mode with a normally open contact.

[How to find out firmware version of the device?](#)



At low loads (up to 25 W), current and power consumption indications may be displayed incorrectly due to hardware limitations.

Connecting to the hub

Before connecting the device:

1. Switch on the hub and check its Internet connection (the logo glows white or green).
2. Install the [Ajax app](#) . Create the account, add the hub to the app, and create at least one room.
3. Make sure that the hub is not armed, and it does not update by checking its status in the Ajax app.



Only users with administrator rights can add a device to the app.

To pair Wall Switch with the hub:

1. Click Add device in the Ajax app.
2. Name the device, scan it, or enter the QR code manually (located on the case and packaging), select the room.

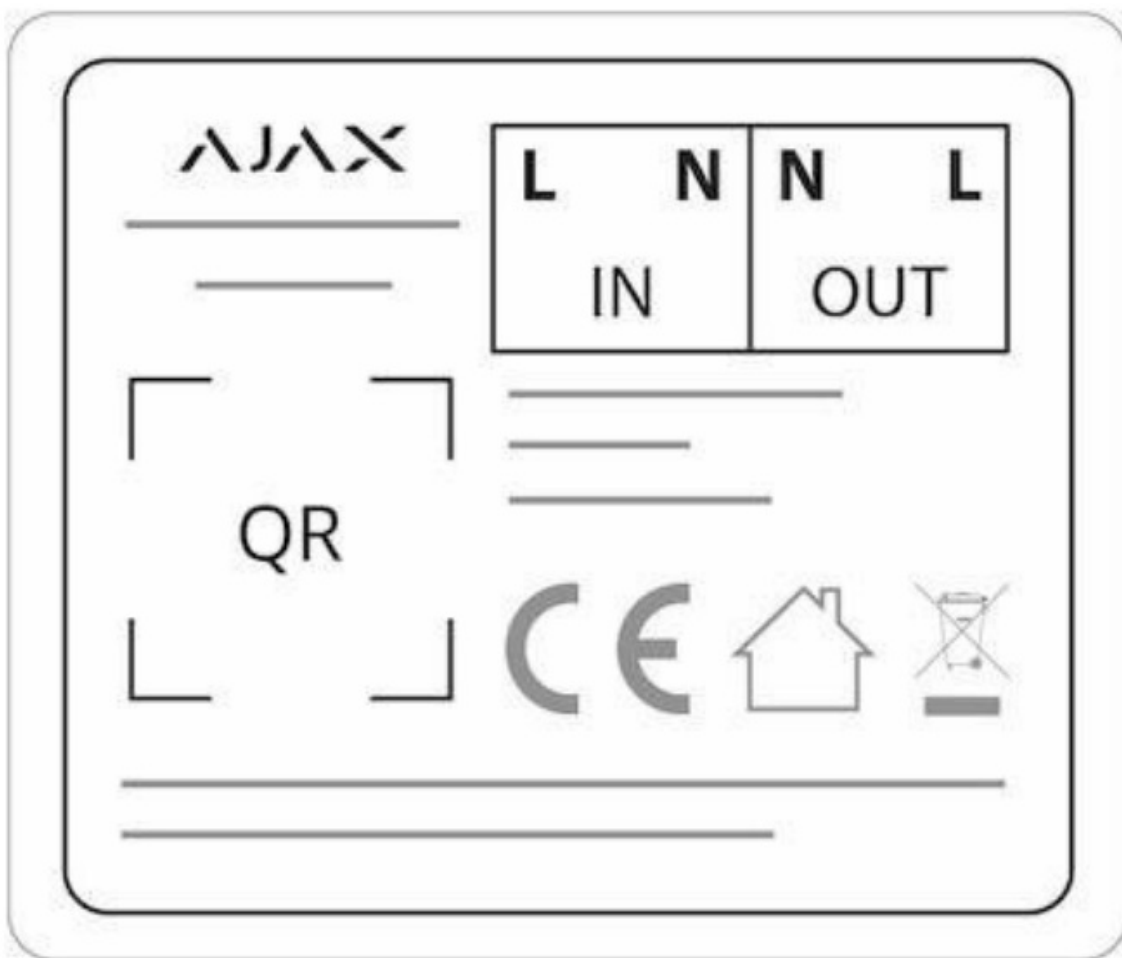

3. Click Add — the countdown will begin.
4. Press the functional button. If you can't do this (the device is mounted in the wall), give Wall Switch at least 20 W load for 5 seconds (by connecting and disconnecting a working kettle or lamp).

i For detection and pairing to occur, the device should be located in the coverage area of the hub's wireless network (at the same object). The connection request is transmitted only at the moment of switching on the device.

If the device failed to pair, wait 30 seconds and then retry. Wall Switch will appear in the list of hub devices. The device statuses update depends on the ping interval set in the hub settings. The default value is 36 seconds.

i When switching on for the first time, Wall Switch contacts are open! When deleting Wall Switch from the system, contacts open!

States

1. Devices
2. Wall Switch

Parameter	Value
Jeweller Signal Strength	Signal strength between hub and device
Connection	Connection status between hub and device
Routed Through ReX	Displays the status of using the ReX range extender
Active	State of the relay (switched on/off)
Voltage	The input voltage of WallSwitch
Current	The input current of WallSwitch
Power	Current consumption in W
Electric energy consumed	The electric power consumed by the device connected to the relay. The counter is reset when the relay loses the power supply
Temporary deactivation	Displays the status of the device: active or completely disabled by the user
Firmware	Device firmware version
Device ID	Device identifier

Settings

1. Devices
2. Wall Switch

3. Settings 

Setting	Value
---------	-------

First field	Device name, can be edited
Room	Selecting the virtual room to which the device is assigned
Relay Mode	<p>Selecting relay operation mode:</p> <ul style="list-style-type: none"> • Pulse — when activated, Wall Switch generates a pulse of a given duration • Bastable — Wall Switch, when activated, changes the state of contacts to the opposite <p>Settings are available with firmware version 5.54.1.0 and higher</p>
Contact status	<p>Normal contact state</p> <ul style="list-style-type: none"> • Normally closed • Normally open
Pulse duration	Selecting the pulse duration in the pulse mode: From 0.5 to 255 seconds
Current protection	If active, power supply will be switched off if current exceeds 13 A, in the inactive state the threshold is 19,8 A (or 16 A, if continues for 5 seconds)
Voltage protection	If active, power supply will be switched off in case of a voltage surge beyond the range of 184 – 253 V, in the inactive state — 0 – 500 V
Scenarios	Opens the menu for creating and configuring scenarios

Jeweler Signal Strength Test	Switches the device to the Jeweler signal strength test mode
User Manual	Opens the Wall Switch User Manual
Temporary deactivation	<p>Allows the user to deactivate the device without removing it from the system. The device will not execute system commands and participate in automation scenarios. All notifications and alarms of the device will be ignored</p> <p>Please note that deactivated device will save it's current state (active or inactive)</p>
Unpair Device	Disconnects the relay from the hub and deletes its settings

Indication

The Wall Switch light indicator can light green depending on the device status. When not paired with the hub, the light indicator blinks periodically. When the functional button is pressed, the light indicator lights up.

Functionality testing

The Ajax security system allows conducting tests for checking the functionality of connected devices. The tests do not start immediately but within a period of 36 seconds when using default settings. The test time start depends on the settings of the detector ping interval (the Jeweler menu in the hub settings)

[Jeweler Signal Strength Test](#)

Installation of the Device



Regardless of the type of electrical circuit, only a qualified electrician should install Wall Switch!

Wall Switch is designed for installation inside a socket box with the diameter 50 mm and more and the depth no less than 70 mm. The relay can also be installed within extension cords and other circuits powered by 230 V.

The communication range with the hub in the line of sight is up to 1,000 meters. Take this into account when choosing the location for Wall Switch.

If the device has a low or unstable signal strength, use the [ReX radio signal range extender](#)

Installation process:

1. De-energize the cable to which Wall Switch will be connected.
2. Connect the grid wire to the Wall Switch terminals according to the following scheme:

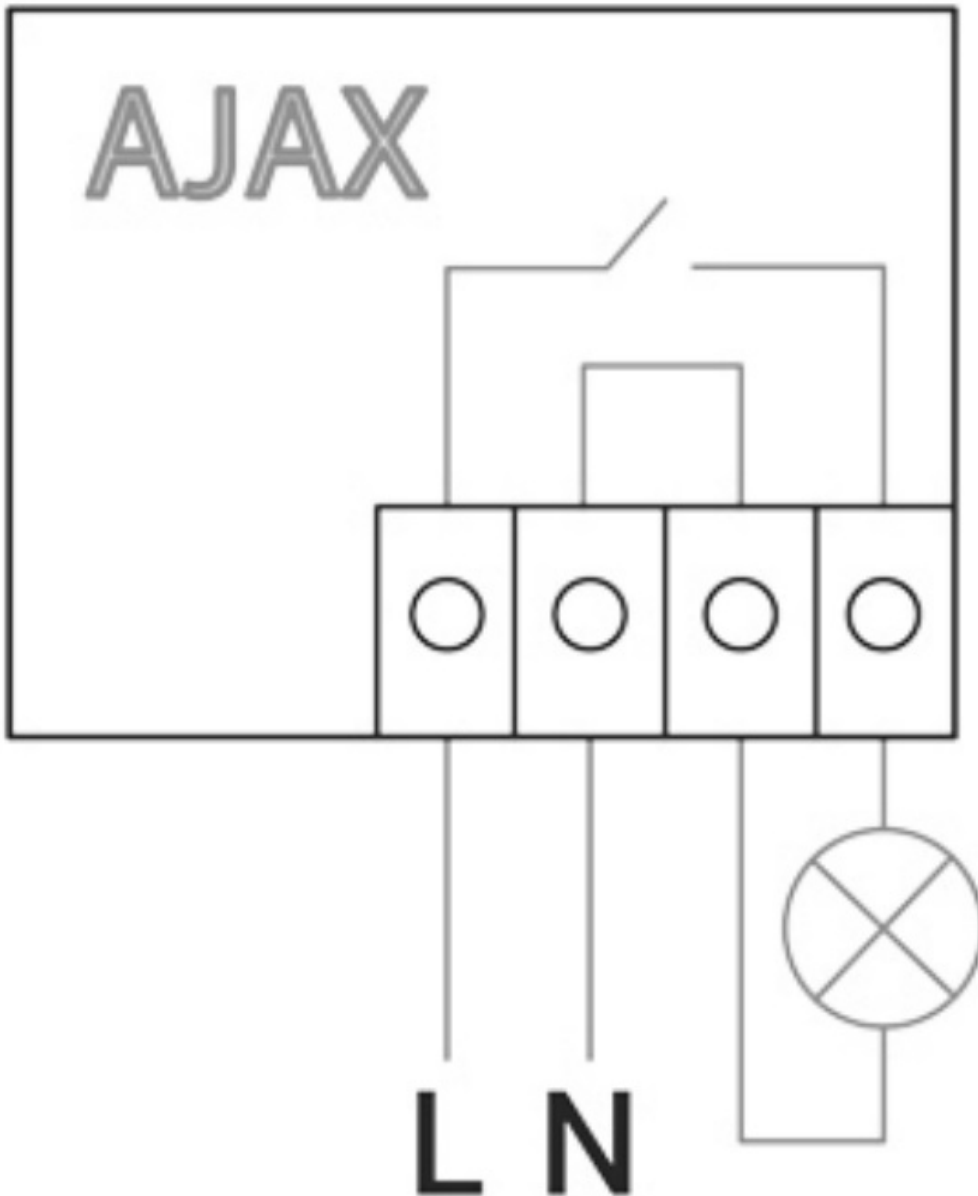



3. Connect a socket using bundled connecting wires or an electrical appliance using a wire with the same cross-section to Wall Switch. It's recommended to use wires with a cross-section of 1.5 – 2 mm²

Do not connect more than 3 kW load to Wall Switch. When connecting the load, strictly observe the connection diagram since an incorrect connection may cause the device to malfunction and/or damage the property.

When installing Wall Switch in the box, lead out the antenna and place it under the plastic frame of the socket. The bigger the distance between the antenna and metal structures, the lower the risk of interfering (and impairment) of the radio signal.

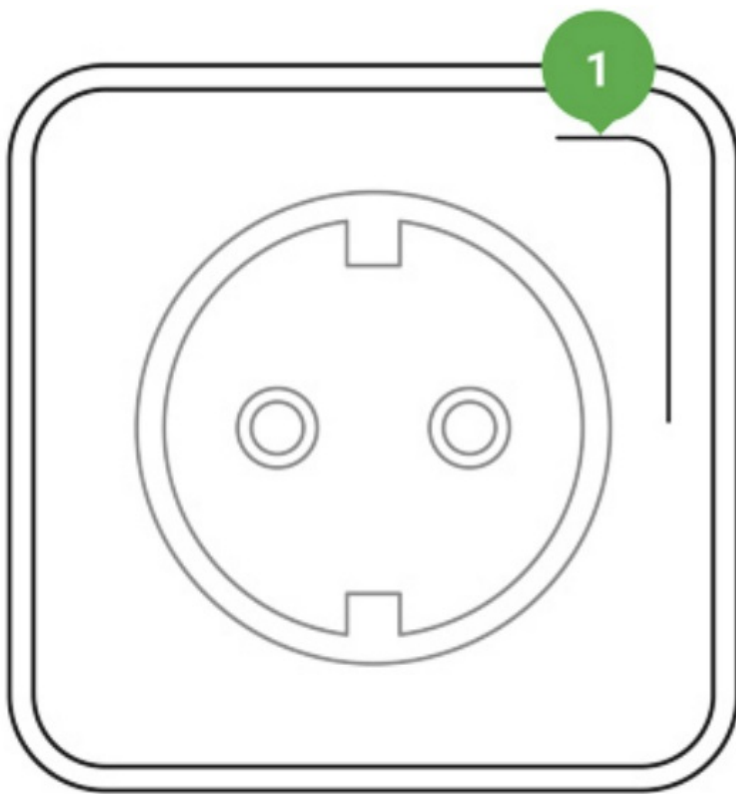
1. recommended antenna location



 Do not shorten the antenna! Its length is optimal for operation within the used radio frequency range

During the installation and operation of Wall Switch, follow the general electrical safety rules and the requirements of electrical safety regulatory acts.

 It is strictly forbidden to disassemble the device. Do not use the device with damaged power cables.

Do not install the relay:

1. Outdoors.
2. In metal wiring boxes and electrical panels.
3. In places with temperature and humidity exceeding the permissible limits.
4. Closer than 1 m to a hub.

Maintenance

The device does not require maintenance.

Tech specs

Actuating element	Electromagnetic relay
The service life of the relay	200,000 switching-ons

Supply voltage	110 – 230 V AC \pm 10% 50/60 Hz
Voltage protection	For 230 V mains: max — 253 V, min — 184 V For 110 V mains: max — 126 V, min — 77 V
Maximum load current	13 A
Maximum current protection	Yes, 13 A
Power output (resistance load 230 V)	Up to 3 kW
Operating modes	Pulse and bistable (firmware version is 5.54.1.0 or higher. Manufacture date from March 5, 2020) Only bistable (firmware version is lower than 5.54.1.0)
Pulse duration	0.5 to 255 seconds (firmware version is 5.54.1.0 or higher)
Electricity meter function	Yes
Power consumption	Yes: current, voltage,
parameters control	consumed power
The power consumption of the device in the standby mode	Less than 1 W·h
Frequency band	868.0 – 868.6 MHz or 868.7 – 869.2 MHz depending on the region of sale

Compatibility	Operates with all Ajax hubs, and range extenders
Maximum RF output power	Up to 25 mW
Modulation	GFSK
Radio signal range	Up to 1,000 m (any obstacles absent)
Shell protection rating	IP20
Operating temperature range	From 0°C to +64°C
Maximum temperature protection	Yes, 65°C
Operating humidity	Up to 75%
Overall dimensions	39 × 33 × 18 mm
Weight	30 g

Complete Set

1. WallSwitch
2. Connecting wires — 2 pcs
3. User Manual

Documents / Resources

	<p>AJAX WallSwitch Wireless Indoor Power Relay [pdf] User Manual</p> <p>WallSwitch, Wireless Indoor Power Relay, WallSwitch Wireless Indoor Power Relay, Indoor Power Relay, Power Relay, Relay</p>
---	--

References

- [Jeweller radio technology | Ajax Systems](#)
- [Current product lines of the Ajax security system](#)
- [Current product lines of the Ajax security system](#)
- [Current product lines of the Ajax security system](#)
- [Wireless panic button with control mode | Ajax Systems](#)
- [ReX — Intelligent radio signal range extender | Ajax Systems](#)
- [Ajax WallSwitch — Wireless power relay with energy monitor](#)
- [Software | Ajax Systems](#)
- [How to find out the device firmware version | Ajax Systems Support](#)
- [How to create and configure a scenario in the Ajax system | Ajax Systems Support](#)
- [What is Jeweller Signal Strength Test | Ajax Systems Support](#)