

**AJAX Dry Contact Relay**



# AJAX Dry Contact Relay User Guide

[Home](#) » [ajax](#) » AJAX Dry Contact Relay User Guide 

## Contents

- 1 [AJAX Dry Contact Relay](#)
- 2 [Product Information](#)
- 3 [Product Usage Instructions](#)
- 4 [Functional elements](#)
- 5 [Operating principle](#)
- 6 [Automation scenarios](#)
- 7 [Control via the app](#)
- 8 [Protection types](#)
  - 8.1 [Jeweller communication protocol](#)
- 9 [Selecting the installation spot](#)
- 10 [Installing](#)
- 11 [Connecting](#)
- 12 [Malfunction counter](#)
- 13 [Settings](#)
- 14 [Indication](#)
- 15 [Technical specifications](#)
- 16 [Warranty](#)
- 17 [Documents / Resources](#)
  - 17.1 [References](#)



**AJAX Dry Contact Relay**



## Product Information

### Specifications

- **Product Name:** Relay
- **Updated:** June 12, 2023
- **Function:** Dry contact relay to control power supply remotely
- **Compatibility:** Low-voltage and domestic power grids
- **Features:** Voltage and temperature protection
- **Communication Range:** Up to 1,000 meters in open space
- **Maximum Resistive Load:** 5 A at 36 V, 13 A at 230 V~

## Product Usage Instructions

### Installation

Only a qualified electrician or installer should install Relay.

### Operating Principle

Relay is installed in the electrical circuit gap to control the power supply of devices connected to the circuit. It can be controlled via the device function button, Ajax app, Button, and automation scenarios.

### Functional Elements

1. Antenna
2. Power supply terminal block
3. Terminal block to connect appliances
4. Function button
5. LED indicator

### Operating Modes

The relay can operate in bistable or pulse mode. In pulse mode, the duration can be set from 0.5 to 255 seconds.

### **Relay Contacts**

The device features potential-free (dry) contacts that are electrically isolated from the power supply. It can be used in low-voltage and household networks to control various systems.

### **Automation Scenarios**

Ajax's scenarios offer enhanced security. Examples include lighting activation when an opening detector triggers an alarm.

### **Control via the App**

In Ajax apps, users can switch on and off electrical appliances connected to the circuit controlled by Relay. By toggling the Relay field in the Devices menu, users can remotely control the power supply of connected devices.

### **FAQ**

- **Q: How far is the communication range of Relay?**

A: The communication range of Relay is up to 1,000 meters in an open space when connected to Ajax radio signal range extenders and hubs.

- **Q: What is the maximum resistive load that Relay can handle?**

A: Relay can handle a maximum resistive load of 5 A at 36 V and 13 A at 230 V~.

- **Q: Can Relay be used to control water shut-off valves?**

A: Yes, Relay can be used to control water shut-off valves along with other systems like electromagnetic locks, gates, barriers, and more.

The relay is a dry contact relay to control a power supply remotely. The relay's dry contacts are electrically isolated to the power supply circuit of the device. Relay can be used in both low-voltage and domestic power grids. The device features two types of protection: voltage and temperature.

- Only a qualified electrician or installer should install Relay.

The relay can control the power supply of electrical appliances connected to the circuit via the Ajax apps, automation scenarios, via the relay function button, or by pressing the Button. Relay is connected to the Ajax security system via the Jeweller radio protocol. The communication range is up to 1,000 meters in an open space. The device works only with Ajax radio signal range extenders and hubs.

### **Buy Relay**

### **Functional elements**

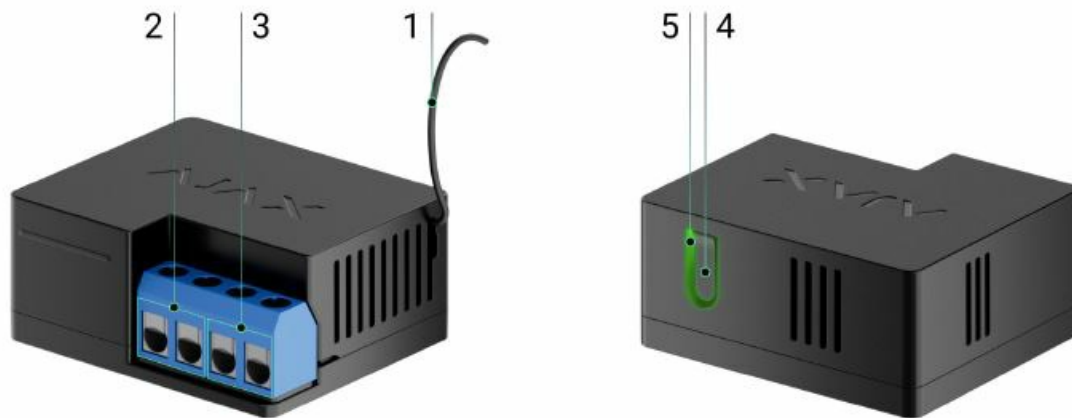

1. Antenna.
2. Power supply terminal block.
3. Terminal block to connect appliances.
4. Function button.
5. LED indicator.



- **PS IN terminals** — “+” and “-” connection terminals of a 7–24 V power supply.
- **Relay terminals** — output potential-free terminals of Relay contacts to connect appliances.

## Operating principle

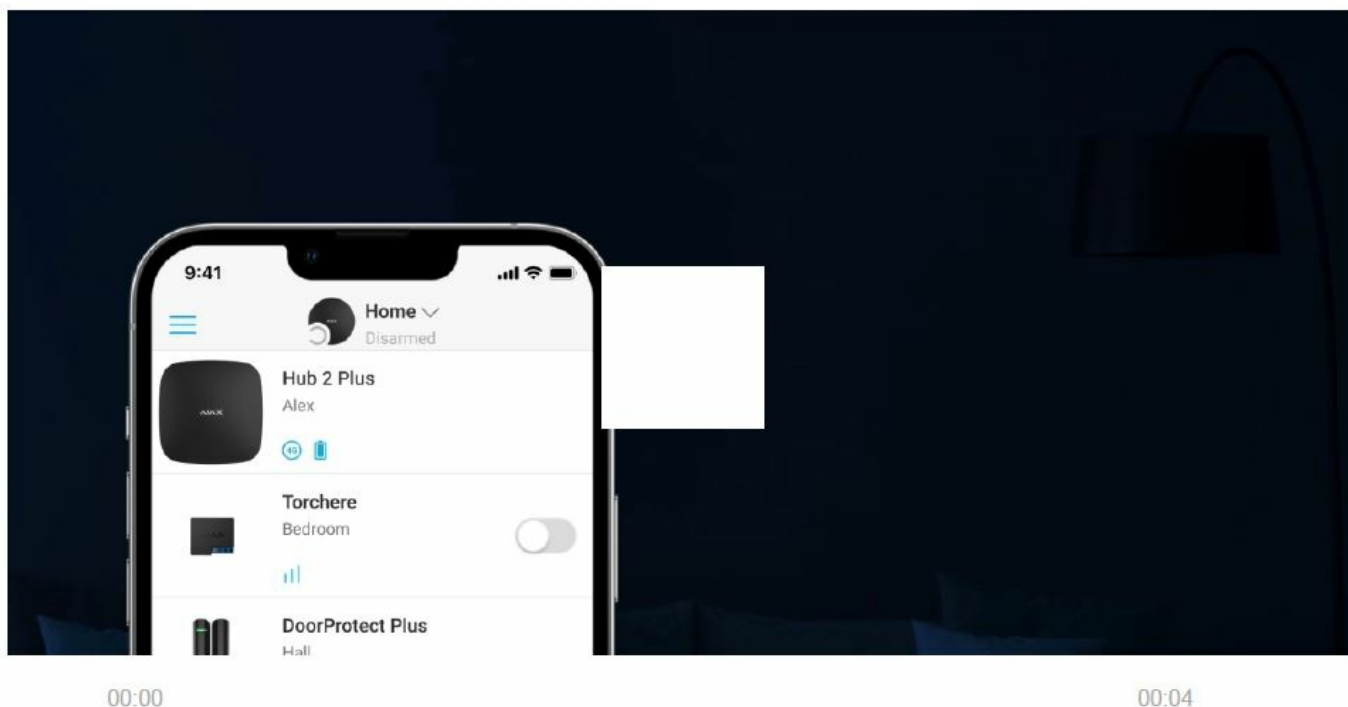

The relay is a dry contact relay to control a power supply remotely. The relay is installed in the electrical circuit gap to control the power supply of devices connected to this circuit. Relay is controlled via the device function button (by pressing and holding it for 2 seconds), the Ajax app, Button, and automation scenarios.

- The relay is powered by a 7–24 V power supply. Recommended power supply voltages: 12 V and 24 V .

Relay features potential-free (dry) contacts. Dry contacts are electrically isolated to the relay's power supply. Thus, this device can be used in low-voltage and household networks, for example, to simulate a button, a toggle switch, or to control water shut-off valves, electromagnetic locks, irrigation systems, gates, barriers, and other systems. Relay commutes one single pole of the electrical circuit. The relay can operate in bistable or pulse mode. In pulse mode, you can set its duration: from 0.5 to 255 seconds. The operating mode is selected by users or PRO with admin rights in the Ajax apps.

**A user or a PRO with admin rights can select the normal state of the relay contacts:**

- **Normally closed** — the relay stops supplying power when activated and resumes when deactivated.
- **Normally open** — the relay supplies power when activated and stops when deactivated.

Relay measures supply voltage. This data, along with other operating parameters of the relay, is available in the device States. Relay status update frequency depends on the Jeweller or Jeweller/Fibra settings. The default value is 36 seconds.

- The relay maximum resistive load is 5 A at 36 V and 13 A at 230 V~.

## Automation scenarios

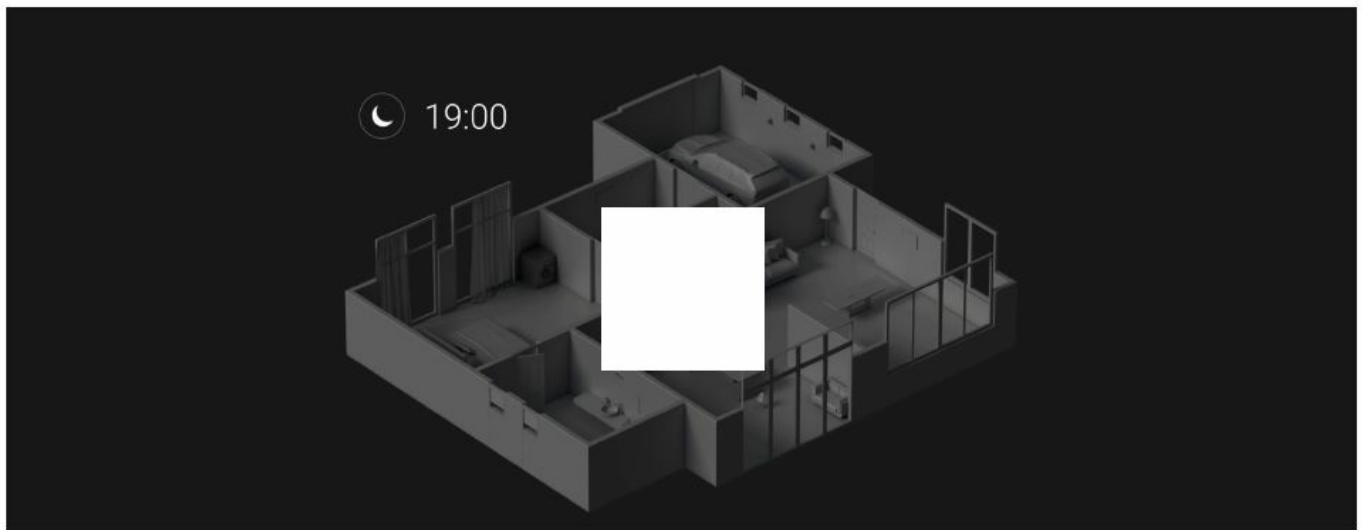

Ajax's scenarios offer a new level of security. With them, the security system not only notifies about threats but also actively resists them.

#### **Scenario types with Relay and examples of usage:**

- By alarm. Lighting is switched on when an opening detector activates the alarm.
- By security mode change. The electric lock is automatically blocked when the object is armed.
- By schedule. The irrigation system in the yard is switched on according to the schedule at the specified time. Lighting and TV are switched on when the owners are away, so the house doesn't seem empty.
- By pressing the Button. Switching on night lighting by pressing the smart button.
- By temperature. The heating is turned on when the temperature in the room is lower than 20°C.
- By humidity. The humidifier is switched on when the humidity level drops below 40%.
- By CO<sub>2</sub> concentration. Supply ventilation is turned on when the carbon dioxide concentration level exceeds 1000 ppm.

Scenarios by the Button pressing are created in the Button settings, and scenarios by the humidity and CO<sub>2</sub> concentration levels are created in the LifeQuality settings.

#### **More about scenarios**

#### **Control via the app**

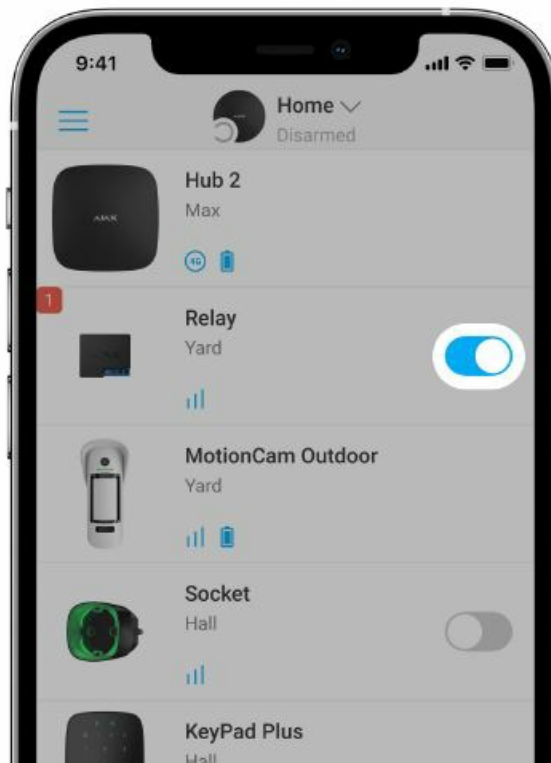

- In Ajax apps, you can switch on and off electrical appliances connected to an electrical circuit controlled by Relay.
- Click the toggle in the Relay field in the Devices  menu: the state of the relay contacts will change to the opposite, and the connected electrical device will switch off or on. This way, a security system user can remotely control the power supply, for example, for lighting or an electric lock.
  - When Relay is in pulse mode, the toggle will change from on/off to pulse.

## Protection types

Relay has two types of protection that operate independently: voltage and temperature.

- **Voltage protection:** is activated if the relay supply voltage exceeds the range of 6.5–36.5 V . Protects Relay from voltage surges.
- **Temperature protection:** is activated if the relay heats up to temperatures above 65°C. Protects relay from overheating.

When voltage or temperature protection is activated, the power supply through Relay is stopped. The power supply resumes automatically when the voltage or temperature parameter returns to normal.

## Jeweller communication protocol

Relay uses the Jeweller radio protocol to transmit alarms and events. This wireless protocol provides fast and reliable two-way communication between the hub and connected devices.

Jeweller supports block encryption with a floating key and authentication of devices at each communication session to prevent sabotage and device spoofing. The protocol involves regular polling of devices by the hub at intervals of 12 to 300 seconds (set in the Ajax app) to monitor communication with all devices and display their statuses in the Ajax apps.

- **Learn more about Jeweller**
- **More about Ajax encryption algorithms**

### **Sending events to the monitoring station**

The Ajax security system can transmit alarms and events to the PRO Desktop monitoring app as well as the central monitoring station (CMS) via SurGard (Contact ID), SIA DC-09 (ADM-CID), ADEMCO 685, and other proprietary protocols.

### **Which CMSs Ajax hubs can be connected to**

- With PRO Desktop, the CMS operator receives all Relay events. In other cases, a monitoring station receives only notification about connection loss between the Relay and the hub (or range extender).
- The addressability of Ajax devices allows sending not only events but also the type of the device, its assigned name, and room to PRO Desktop/CMS (the list of transmitted parameters may vary depending on the type of the CMS and the protocol selected for communication with the CMS).

The device ID and zone number can be found in the Relay States in the Ajax app.

### **Selecting the installation spot**



A 39 × 33 × 18 mm device is connected to the circuit gap. Relay dimensions allow installing the device into the deep junction box, inside the electrical appliance enclosure, or in the distribution board. A flexible external antenna ensures stable communication. To install a Relay on a DIN rail, we recommend using a DIN Holder.

The relay should be installed in a place with a stable Jeweller signal strength of 2–3 bars. To roughly calculate the signal strength at the place of installation, use a radio communication range calculator. Use a radio signal range extender if the signal strength is less than 2 bars at the intended installation location.

- If you install Relay outdoors, place the device in a sealed box. This will protect against condensation, which can damage Relay.

### **Do not place Relay:**

1. In rooms where the humidity and temperature indicators do not correspond to the operating parameters. This



may damage the device or cause it to malfunction.

2. Near sources of radio interference: for example, at a distance of less than 1 meter from a router. This can lead to a loss of connection between Relay and the hub (or range extender).
3. In places with low or unstable signal strength. This can lead to a loss of connection between the relay and the hub (or range extender).

## Installing

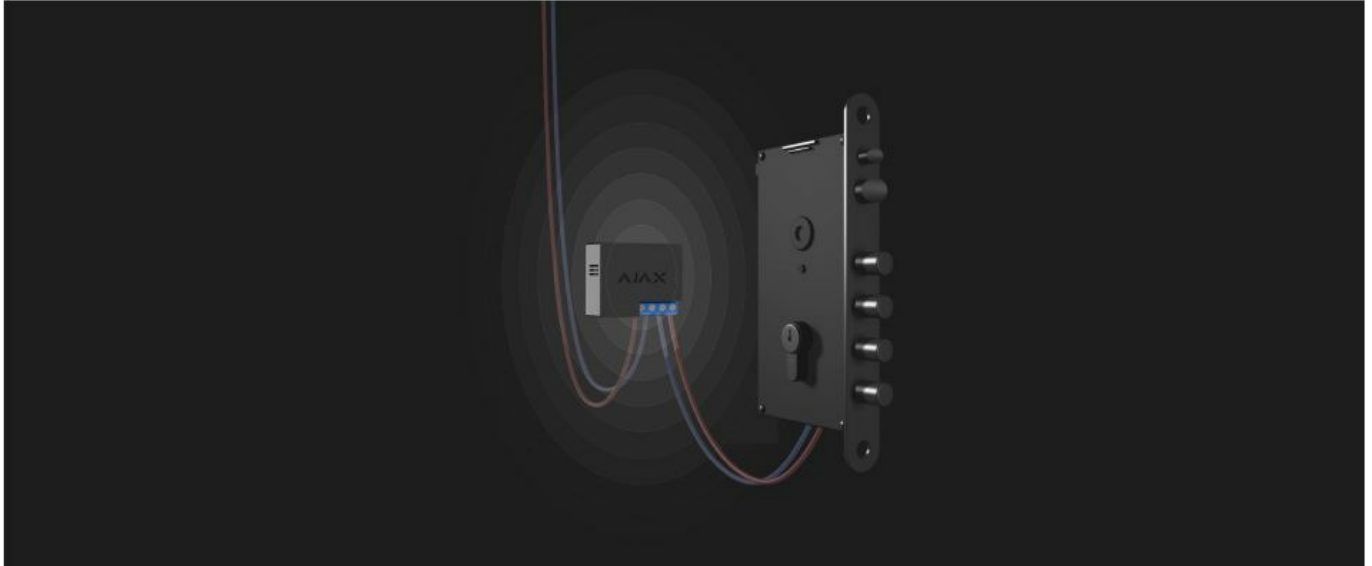

Only a qualified electrician or installer should install Relay.

- Before installing the relay, ensure that you have selected the optimal location and that it complies with the requirements of this manual. When installing and operating the device, follow the general electrical safety rules for using electrical appliances and the requirements of electrical safety regulations.
- It is recommended to use cables with a cross-section of 0.75–1.5 mm<sup>2</sup> (22–14 AWG). The relay should not be connected to circuits with more than 5 A load at 36 V and 13 A at 230 V~.

### To install Relay:

1. If you install a Relay on a DIN rail, fix the DIN Holder on it first.
2. De-energize the power cable to which the Relay will be connected.
3. Connect the “+” and “–” to the power supply terminal block of Relay.
4. Connect the Relay terminals for appliance connection to the circuit. We recommend using cables with a cross-section of 0.75–1.5 mm<sup>2</sup> (22–14 AWG).
5. When installing the device in a distribution box, lead the antenna out. The bigger the distance between the antenna and metal structures, the lower the risk of interfering with the radio signal.
6. Place the relay in the DIN Holder. If the relay is not mounted on the DIN rail, we recommend securing the device with double-sided tape if it's possible.
7. Secure the cables if necessary.

Do not shorten or cut the antenna. Its length is optimal for operation in the Jeweller radio frequency range.

After installing and connecting the relay, be sure to run the Jeweller Signal Strength Test and also test the overall operation of the relay: how it responds to commands and whether it controls the power of the devices.

## Connecting

### Before connecting the device

1. Install the Ajax app. Log in to your account or create a new account if you don't have one.
2. Add a compatible hub to the app, configure the necessary settings, and create at least one virtual room.
3. Ensure that the hub is on and has Internet access via Ethernet, Wi-Fi, and/or cellular network. You can do this in the Ajax app or by checking the hub LED indicator. It should light up white or green.
4. Ensure the hub is not armed and does not start updates by checking its status in the Ajax app.

Only a user or a PRO with admin rights can connect the relay to the hub.

### To pair Relay with the hub

1. Connect Relay to a 7–24 V supply circuit if you haven't done this before.
2. Sign in to the Ajax app.
3. Select a hub if you have several of them or if you are using the PRO app.
4. Go to the Devices  menu and click Add Device.
5. Name the device, select the room, scan the QR code (which can be found on the relay body and packaging), or type the device ID.



6. Click Add. The countdown will begin.
7. Press the Relay function button.

For the relay to connect, it must be within the range of the hub's radio coverage. If the connection fails, try again in 5 seconds. If the maximum number of devices is already added to the hub, you will get a notification about exceeding the device limit in the Ajax app when you try to add the relay. The maximum number of devices connected to the hub depends on the model.

### Hub models and their differences

Relay works with one single hub; when connected to a new hub, it does not send notifications to the previous one. Once added to a new hub, Relay is not removed from the list of devices of the old hub. This has to be done in the Ajax app.

- After pairing with the hub and removing from the hub the relay contacts are open.

## Malfunction counter

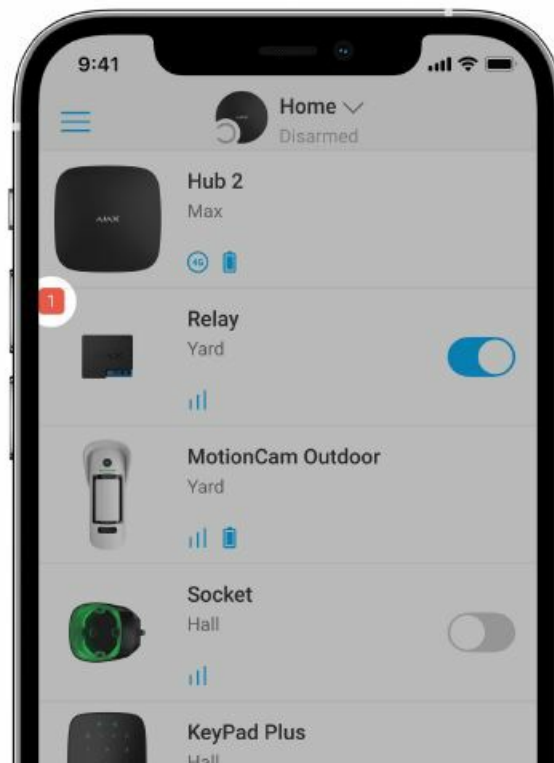





- In case of a Relay fault (e.g., no Jeweller signal between the hub and the relay), the Ajax app displays a malfunction counter in the upper-left corner of the device icon.
- Malfunctions are displayed in the relay States. Fields with malfunctions will be highlighted in red.

### Malfunction is displayed if:

- Temperature protection was activated.
- Voltage protection was activated.
- There is no connection between the Relay and the hub (or radio signal range extender).

### Icons

The icons display some Relay states. You can check them in the Ajax app in the Devices  tab.

Icon	Meaning
	Jeweller signal strength between Relay and the hub or a radio signal range extender. The recommended value is 2–3 bars.  <a href="#">Learn more</a>
	The device is connected via a <a href="#">radio signal range extender</a> . The field is not displayed if Relay works directly with the hub.
	Voltage protection was activated.  <a href="#">Learn more</a>
	Temperature protection was activated.  <a href="#">Learn more</a>

## States

The states include information about the device and its operating parameters. Relay states are available in the Ajax app. To access them:



1. Go to the Devices  tab.
2. Select Relay in the list.

Parameter	Meaning
Jeweller Signal Strength	<p>The signal strength of connection via Jeweller between the hub/range extender and the device. Recommended values: 2–3 bars.</p> <p>Jeweller is the protocol for transmitting events and alarms.</p> <p><a href="#">Learn more about Jeweller</a></p>
Connection via Jeweller	<p>The state of connection via Jeweller between the hub/range extender and the device:</p> <p><b>Online</b> — the relay is connected with the hub or the range extender.</p> <p><b>Offline</b> — no connection with the hub or the range extender.</p>
ReX	<p>Displays the status of the device connection to the <a href="#">radio signal range extender</a>:</p> <p><b>Online</b> — the device is connected.</p> <p><b>Offline</b> — no connection with the device.</p> <p>The field is displayed if the device is operated via the radio signal range extender.</p>
Active	<p>The relay state:</p> <p><b>Yes</b> — relay contacts are closed. The connected electrical appliance is energized.</p> <p><b>No</b> — relay contacts are open. No current is being supplied to the connected appliance.</p> <p>The field is displayed if the Relay operates in the bistable mode.</p>
Voltage	The current-voltage value at the Relay input.

	<p>The frequency of value updates depends on the Jeweller settings. The default value is 36 seconds.</p> <p>The voltage values are displayed in increments of 0.1 V.</p>
Deactivation	<p>Displays the state of the device's permanent deactivation function:</p> <p><b>No</b> — the device operates normally, responds to commands, runs scenarios, and transmits all events.</p> <p><b>Entirely</b> — the device is excluded from the system operation. The device doesn't respond to commands, doesn't run scenarios, and doesn't transmit events.</p> <p><a href="#">Learn more</a></p>
Firmware	Device firmware version.
Device ID	Device identifier. Also available via the QR code applied to the device body and packaging.
Device No	The number of the Relay loop (zone).

## Settings

### To change the Relay settings in the Ajax app:

1. Go to the Devices tab .
2. Select Relay in the list.
3. Go to Settings by clicking on the gear icon .
4. Set the necessary parameters.
5. Click Back to save the new settings.

Settings	Meaning
Name	<p>Device name. It is displayed in notifications in the event feed, the list of hub devices, and SMS texts.</p> <p>Click on the pencil icon  .</p> <p>The name can contain up to 12 Cyrillic characters or 24 Latin characters.</p>
Room	<p>Selecting the virtual room for Relay.</p> <p>The room name is displayed in SMS and notifications in the event feed.</p>
Notifications	<p>Selecting the relay notifications:</p> <p><b>When switched on/off</b> — the user receives notifications from the device switching its state.</p> <p><b>When a scenario is executed</b> — the user receives notifications about the execution of scenarios involving this device.</p> <p>The setting is available when the relay is connected to all hubs (except for the Hub model) with firmware version OS Malevich 2.15 or higher and in apps of the following versions or higher:</p> <p>Ajax Security System 2.23.1 for iOS Ajax Security System 2.26.1 for Android</p> <p>Ajax PRO: Tool for Engineers 1.17.1 for iOS</p> <p>Ajax PRO: Tool for Engineers 1.17.1 for Android</p> <p>Ajax PRO Desktop 3.6.1 for macOS Ajax PRO Desktop 3.6.1 for Windows</p>
Relay Mode	<p>Selecting the Relay operating mode:</p> <p><b>Pulse</b> — Relay generates a pulse of a specified duration when activated.</p> <p><b>Bistable</b> — Relay changes the state of the contacts to the opposite (e.g., closed to open) when activated.</p>

### Pulse Time

- The pulse duration selection: 0.5 to 255 seconds.
- The configuring is available when the Relay operates in the pulse mode.

### Contact State

Selecting the normal state of the relay contacts:

- **Normally closed (NC)** — the relay contacts are closed in the normal state. The connected electric appliance is supplied with current.

- **Normally open (NO)** — the relay contacts are open in the normal state. The connected electric appliance is not supplied with current.

## Scenarios

- Opens the menu for creating and configuring automation scenarios.
- Scenarios offer a brand-new level of property protection. With them, the security system not only notifies about a threat but also actively resists it.
- Use scenarios to automate security. For example, switch on lighting at the facility when an opening detector raises the alarm.
- [Learn more](#)

## Jeweller Signal Strength Test

- Switches the relay to the Jeweller Signal Strength Test mode.
- The test allows checking the Jeweller signal strength and the stability of the connection between a hub or a range extender and a relay to choose the best place for installing the device.

	<a href="#">Learn more</a>
User Guide	Opens the Relay User Manual in the Ajax app.
Deactivation	<p>Allows disable the device without removing it from the system.</p> <p>Two options are available:</p> <p><b>No</b> — the device operates normally, responds to commands, runs scenarios, and transmits all events.</p> <p><b>Entirely</b> — the device is excluded from the system operation. The relay doesn't respond to commands, doesn't run scenarios, and doesn't transmit events.</p> <p><b>After deactivation, Relay will keep the previous state: active or inactive.</b></p> <p><a href="#">Learn more</a></p>
Unpair Device	Remove Relay from a hub and delete its settings.

## Indication



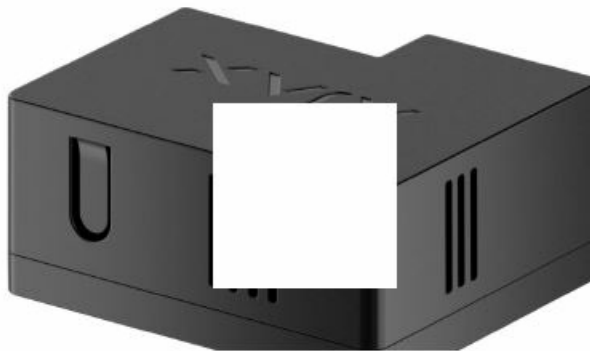



Relay LED indicator flashes periodically if the device is not connected to the hub. When you press the Relay function button, the LED indicator lights up green.

### Functionality testing

Relay functionality tests do not begin immediately but not later than over a single hub—device polling interval (36 seconds with default Jeweller or Jeweller/Fibra settings). You can change the device polling period in the Jeweller or Jeweller/Fibra menu in the hub settings.

### To run a test in the Ajax app:

1. Select the hub if you have several of them or if you are using the PRO app.
2. Go to the Devices  tab.
3. Select Relay.
4. Go to Settings .
5. Select and run the [Jeweller Signal Strength Test](#).

### Maintenance

The device requires no technical maintenance.

### Technical specifications

Actuating element	Electromagnetic relay
Number of switchings	≥ 200,000
Supply voltage range	7 – 24 V
Voltage protection	Minimum — 6.5 V Maximum — 36.5 V
Maximum load current	5 A at 24 V 13 A at 230 V~
Operating mode	Pulse or bistable
Pulse duration	0.5 to 255 s
Maximum current protection	No

Parameter control	Voltage
Energy consumption in standby mode	Up to 1 W
Radio communication protocol	Jeweller  <a href="#">Learn more</a>
Radio frequency band	866.0 – 866.5 MHz 868.0 – 868.6 MHz 868.7 – 869.2 MHz 905.0 – 926.5 MHz 915.85 – 926.5 MHz 921.0 – 922.0 MHz  Depends on the sales region.
Compatibility	All Ajax <a href="#">hubs</a> and <a href="#">radio signal range extenders</a>
Maximum radio signal strength	Up to 25 mW
Radio signal modulation	GFSK
Radio signal range	1,000 m (in an open space)  <a href="#">Learn more</a>
Polling interval	12–300 s (36 s by default)
Protection class	IP20
Operating temperature range	-20°C to +64°C
Maximum temperature protection	Over +65°C at the place of installation Over +85°C inside Relay
Operating humidity	Up to 85% with no condensation
Dimensions	39 × 33 × 18 mm
The cross-sectional area of the cable	0.75–1.5 mm <sup>2</sup> (22–14 AWG)
Weight	25 g
Service life	10 years

If you use inductive or capacitive load, the maximum switching current decreases to 3 A at 24 V and 8 A at 230 V~.

## Compliance with standards

### Complete set

1. Relay.
2. Double-sided tape.
3. Quick Start Guide.

### Warranty

Warranty for the Limited Liability Company “Ajax Systems Manufacturing” products is valid for 2 years after the purchase.

If the device does not function correctly, please contact Ajax Technical Support first. In most cases, technical issues can be resolved remotely.

- Warranty Obligations
- User Agreement

### Contact Technical Support:

- e-mail [support@ajax.systems](mailto:support@ajax.systems)
- Telegram [https://t.me/AjaxSystemsSupport\\_Bot](https://t.me/AjaxSystemsSupport_Bot)
- Phone number: 0 (800) 331 911



Subscribe to the newsletter about safe life. No spam

	<p><b>AJAX Dry Contact Relay</b> [pdf] User Guide</p> <p>Dry Contact Relay, Dry, Contact Relay, Relay</p>
---	---

## References

- [📄 Connecting Ajax to CMS](#)
- [📄 End user agreement - Ajax Systems](#)
- [📄 Hub Differences | Ajax Security System](#)
- [📄 PRO Desktop | Ajax Systems](#)
- [📄 Wireless panic button with control mode | Ajax Systems](#)
- [📄 DIN Holder — Holder for Relay or WallSwitch on DIN rail](#)
- [📄 Security system control panels | Ajax Systems](#)
- [📄 Signal range extenders in the security system | Ajax Systems](#)
- [📄 Relay — Low current remote control relay with dry contact](#)
- [📄 What affects the quality of radio communication between Ajax devices](#)
- [📄 What affects the quality of radio communication between Ajax devices](#)
- [📄 Automation scenarios | Your Ajax security automation](#)
- [📄 Software | Ajax Systems](#)
- [📄 Ajax devices standards compliance list](#)
- [📄 Warranty - Ajax Systems](#)
- [📄 How to create the Ajax account? | Ajax Systems Support](#)
- [📄 How Ajax encrypts communication between the hub and system detectors | Ajax Systems Support](#)
- [📄 How to deactivate a device without removing it from the system | Ajax Systems Support](#)
- [📄 Jeweller radio protocol: technology and capabilities | Ajax Systems Support](#)
- [📄 Button User manual | Ajax Systems Support](#)
- [📄 LifeQuality Jeweller User manual | Ajax Systems Support](#)
- [📄 How to create and configure a scenario in the Ajax system | Ajax Systems Support](#)
- [📄 What is Jeweller Signal Strength Test | Ajax Systems Support](#)
- [📄 support.ajax.systems/wp-content/uploads/2022/06/relay-1-1.jpg](#)
- [📄 User Manual](#)

[Manuals+](#), [Privacy Policy](#)

This website is an independent publication and is neither affiliated with nor endorsed by any of the trademark owners. The "Bluetooth®" word mark and logos are registered trademarks owned by Bluetooth SIG, Inc. The "Wi-Fi®" word mark and logos are registered trademarks owned by the Wi-Fi Alliance. Any use of these marks on this website does not imply any affiliation with or endorsement.