



AJAX AX-COMBIPROTECT-B CombiProtect User Manual

[Home](#) » [ajax](#) » AJAX AX-COMBIPROTECT-B CombiProtect User Manual 

Contents

- [1 AJAX AX-COMBIPROTECT-B CombiProtect](#)
- [2 Product Information](#)
- [3 Product Usage Instructions](#)
- [4 Functional Elements](#)
 - [4.1 Operating Principle](#)
- [5 Before starting](#)
 - [5.1 Setting Up the Detector](#)
- [6 Indication](#)
 - [6.1 Detection Zone Test](#)
- [7 Installing the detector](#)
 - [7.1 Installation of the detector](#)
 - [7.2 Detector Maintenance](#)
- [8 Tech Specs](#)
- [9 Compliance with standards](#)
- [10 Warranty](#)
- [11 Documents / Resources](#)
- [12 Related Posts](#)

AJAX

AJAX AX-COMBIPROTECT-B CombiProtect



Product Information

The CombiProtect is a motion detector that operates within the Ajax security system. It is connected via a protected protocol with a communication range of up to 1200 meters in line of sight. The detector can also be used as part of third-party security central units via integration modules. It has a thermal PIR sensor that detects intrusion into a protected room by detecting moving objects with a temperature close to the temperature of the human body. The electret microphone is responsible for glass break detection. The detector can ignore domestic animals if suitable sensitivity has been chosen in the settings. It immediately transmits an alarm signal to the hub, activating the sirens and notifying the user and security company after actuation.

Product Usage Instructions

1. Arm the Ajax security system (including Ajax CombiProtect detector) using the mobile application, key fob or keypad.
2. Connect the detector to the hub by following these steps:
 1. Install the hub following the manual recommendations and create an account.
 2. Add the hub to the mobile application and create at least one room.
 3. Ensure that the hub is disarmed and does not update by checking its status in the mobile application.
 4. Select the Add Device option in the Ajax app.
 5. Name the device, scan/write manually the QR Code (located on the body and packaging), and select the location room.
 6. Select Add – the countdown will begin.
 7. Switch on the device to establish a connection. The detector should be located within the coverage of the wireless network of the hub (at a single protected object).
3. Set up the detector using the mobile application for iOS and Android based smartphones. The system notifies

user of all events through push notifications, SMS messages and calls (if activated).

- CombiProtect is a device combining a wireless motion detector with the viewing angle of 88.5° and distance up to 12 meters, as well as a glass break detector with the distance up to 9 meters. It can ignore animals and detects a person within the protected zone from the first step. It can operate for up to 5 years from a pre-installed battery and is used inside premises.
- CombiProtect operates within the Ajax security system, connected to the hub via the protected Jeweller protocol. The communication range is up to 1200 meters in the line of sight. In addition, the detector can be used as a part of third-party security central units via the Ajax uartBridge or Ajax ocBridge Plus integration modules.
- The detector is set up via a mobile application for iOS and Android based smartphones. The system notifies user of all events through push notifications, SMS messages and calls (if activated).
- The Ajax security system is self-sustaining, but the user can connect it to the æntral monitoring station of a private security company.

Functional Elements

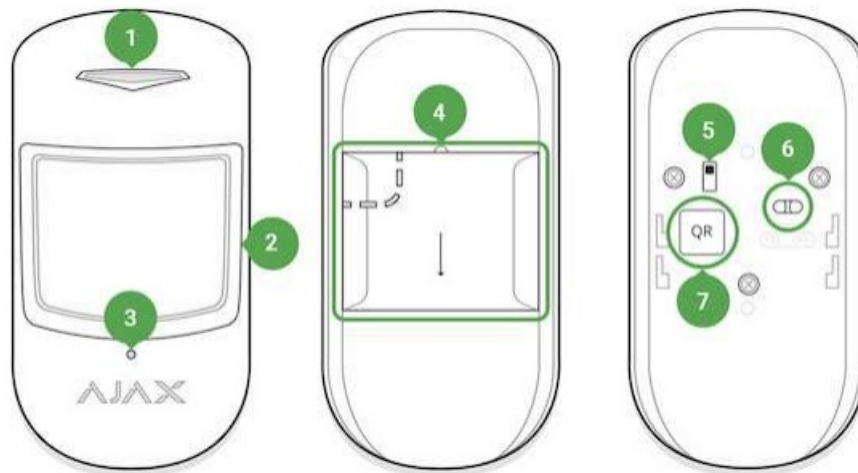

1. LED indicator
2. Motion detector lens
3. Microphone hole
4. SmartBracket attachment panel (perforated part is required for actuating the tamper in case of any attempt to dismantle the detector)
5. Tamper button
6. Device switch
7. QR code

Operating Principle

- CombiProtect combines two types of security devices — motion detector and glass break detector.
- Thermal PIR sensor detects intrusion into a protected room by detecting moving objects with a temperature close to the temperature of the human body.
- However, the detector can ignore domestic animals if the suitable sensitivity has been chosen in the settings.
- The electret microphone is responsible for glass break detection. The intelligent actuation.

- CombiProtect does not detect glass breaking if the glass is covered with any film: shockproof, sunscreen, decorative or other. In order to detect the breaking Of this type glass, we recommend using a DoorProtect Plus wireless opening detector with shock and tilt sensor.
- After actuation, the armed detector immediately transmits an alarm signal to the hub, activating the sirens and notifying the user and security company.
- To arm Ajax security system (including Ajax CombiProtect detector) you can use
- Ajax Security System app, SpaceControl key fob or KeyPad.
- If before arming the system, the detector has detected motion, it will not arm immediately, but during the next inquiry by the hub.

Connecting the Detector to the Ajax security system

- The detector is connected to the hub and set up via the Ajax Security system mobile application. To establish connection please locate the detector and the hub within the communication range and follow the device adding procedure.

Before starting

1. Following the hub manual remix)commendations, install the Ajax application.
 - Create an account, add the hub to the application, and create at least one room.
2. Switch on the hub and check the internet connection (via Ethernet cable and/or GSM network).
3. Ensure that the Hub is disarmed and does not update by checking its status in the mobile application.

Only users with administrator rights can add the device to the hub

1. Select the Add Device option in the Ajax app.
2. Name the device, scan/write manually the QR Code (located on the body and packaging), and select the location room.



3. Select Add — the countdown will begin.
4. Switch on the device.



- For detection and pairing to occur, the detector should be located within the coverage of the wireless network of the hub (at a single protected object).
- Request for connection to the hub is transmitted for a short time at the time of switching on the device.
- The detector connected to the hub will appear in the list of devices of the hub in the application. Update of the detector statuses in the list depends on the device inquiry time set in the hub settings, with the default value — 36 seconds.

Connecting the Detector to Third-Party Security Systems

- To connect the detector to a third-party security central unit using the yprrBridge or ocBridge Ply? integration module, follow the recommendations in the manual of the respective device.



States

1. Devices 
2. CombiProtect

Parameter	Value
Temperature	Temperature of the detector. Measured on the process or and changes gradually
Jeweller Signal Strength	Signal strength between the hub and the detector
Battery Charge	Battery level of the device. Displayed as a percentage
Lid	The tamper mode of the detector, which reacts to the detachment of or damage to the body
Delay When Entering, sec	Delay time when entering
Delay When Leaving, sec	Delay time when exiting
ReX	Displays the status of using the ReX range extender
Motion Detector Sensitivity	Sensitivity level of the motion detector

Glass Detector Always Active	If active, the glass detector is always in the armed mode
Temporary Deactivation	<p>Shows the status of the device temporary deactivation function:</p> <p>No — the device operates normally and transmits all events.</p> <p>Lid only — the hub administrator has disabled notifications about triggering on the device body.</p> <p>Entirely — the device is completely excluded from the system operation by the hub administrator. The device does not follow system commands and does not report alarms or other events.</p> <p>By number of alarms — the device is automatically disabled when the number of alarms is exceeded (specified in the settings for Devices Auto Deactivation). The feature is configured in the Ajax PRO app.</p>
Firmware	Detector firmware version
Device ID	Device identifier

Setting Up the Detector

1. Devices 
2. CombiProtect
3. Settings 

Setting	Value
First field	The detector name can be edited
Room	Selecting the virtual room to which the device is assigned armed mode when using night mode

Alarm LED indication	Allows you to disable the flashing of the LED indicator during an alarm. Available for devices with firmware version 5.55.0.0 or higher
Motion Detector	If active, motion detector will be active
Motion Detector Sensitivity	Choosing the sensitivity level of the motion detector: High Normal Low
Motion Detector Always Active	If active, the detector always registers motion
Glass Detector Enabled	If active, glass breaking detector will be active
Glass Protection Sensitivity	Choosing the sensitivity level of the glass detector: High Normal Low
Glass Protection Always Active	If active, the detector always registers glass breaking
Alert with a siren if motion detected	If active, _____ added to the system are activated when the motion detected
Alert with a siren if glass break detected	If active, _____ added to the system are activated when the glass break detected
Jeweller Signal Strength Test	Switches the detector to the signal strength test mode
Detection Zone Test	Switches the detector to the detection area test

Temporary Deactivation	<p>Two options are available:</p> <p>Entirely — the device will not execute system commands or participate in automation scenarios, and the system will ignore device alarms and other notifications</p> <p>Lid only — the system will ignore only notifications about the triggering of the device tamper button</p> <p>The system can also automatically disable devices when the set number of alarms is exceeded.</p>
User Guide	Opens the detector User Guide
Unpair Device	Disconnects the detector from the hub and deletes its settings

Indication

Event	Indication	Note
Turning on the detector	Lights up green for about one second	
Detector connection to the and	Lights up continuously for a few seconds	
Alarm/tamper activation	Lights up green for about one second	The alarm is sent once in 5 seconds
		Replacement of the detector battery is described in the of connected devices.

- The tests do not start straight away but within a period of 36 seconds when using the standard settings. The time of the start depends on the settings of the detector polling period (the paragraph on “Jeweller” settings in the hub settings).

Jeweller Signal Strength Test

Detection Zone Test

- Glass break detection zone Test
- Motion detection zone Test

Attenuation Test

Installing the detector

Selection of the installation site

- The controlled area and the efficiency of the security system depends on the location of the detector.
- The developed only for indoor use.
- Location of the CombiProtect depends on the remoteness from the hub and presence of any obstacles between the devices hindering the radio signal transmission: walls, inserted floors, large-size objects located within the room quality Of reception.
- If after moving the device still has a low or unstable signal strength, use a radio signal range extender Rex.
- The direction of the detector lens should be perpendicular to the probable way
- Of intrusion into the room. The detector microphone should be positioned at the angle of no more than 90 degrees relative to the window.
- Make sure that any furniture, domestic plants, vases, decorative or glass structures do not block the field of view of the detector.

We recommend installing the detector at a height of 2.4 meters.

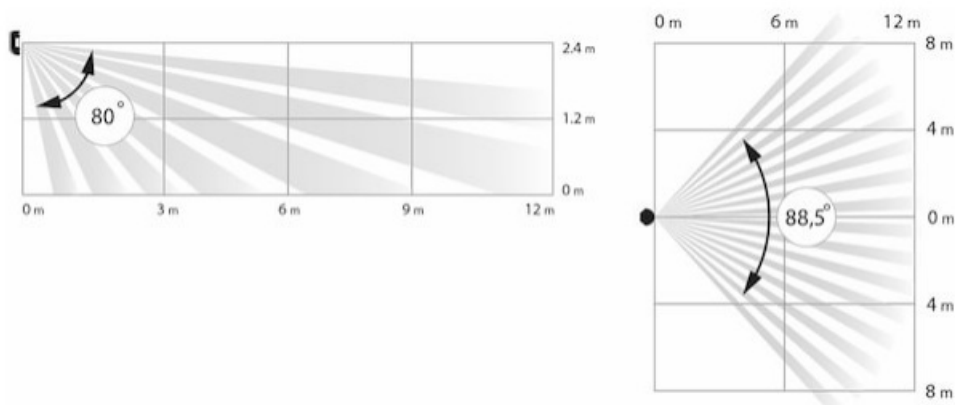

If the detector is not installed at the recommended height, this will reduce the area of the motion detection zone and impair the operation of the function of ignoring animals.

Why motion detectors react to animals and how to avoid it

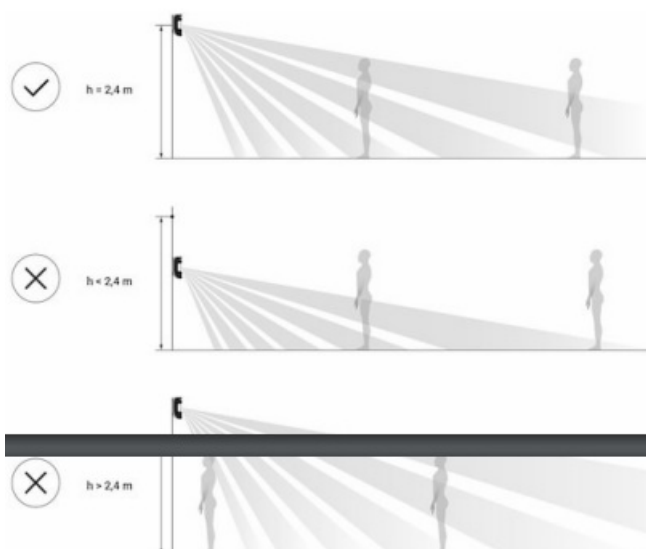

Installation of the detector

Before installing the detector, make sure that you have selected the optimal location and that it is in compliance with the guidelines contained in this manual

CombiProtect detector can be attached to a vertical surface or in a corner.

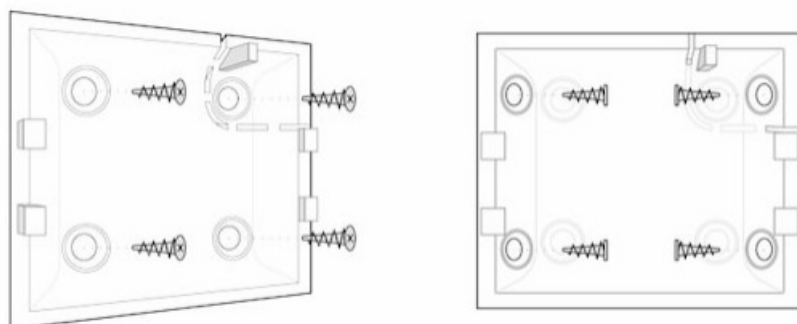

1. Attach the SmartBracket panel to the surface using bundled screws, using at least two fixing points (one of them — above the tamper). If you select other attachment hardware, make sure that they do not damage or deform the panel.

The double-sided adhesive tape may only be used for temporary attachment of the detector. The talk will run dry

in the course of time, which may result in the falling of the detector and the actuation of the security system. Furthermore, the device may fail from a hit, as a result of an impact.

- If the detector is torn off from the surface or removed from the attachment panel, you will receive the notification.

- **Do not install the detector:**

1. outside the premises (outdoors);
2. in the direction of the window, when the detector lens is exposed to direct sunlight;
3. opposite any Object with the rapidly changing temperature (e.g., electrical and gas heaters);
4. opposite any moving objects with the temperature close to that Of the human body (oscillating curtains above the radiator);
5. opposite any reflective surfaces (mirrors);
6. at any places with fast air circulation (air fans, open windows or doors);
7. nearby any metal objects Or mirrors causing attenuation and screening of the signal;
8. within any premises with the temperature and humidity beyond the range of permissible limits;
9. closer than 1 m from the hub.

Detector Maintenance

- Check the operational capability Of the CombiProtect detector on a regular basis.
- Clean the detector body from dust, spider web and other contaminations as they
- smoothly light up and go out, if the detector detects any motion or if the tamper is actuated.
- TO change the battery, switch off the device, loosen three screws and remove the front panel of the detector.
Change the battery for a new one of type CR123A observing the polarity.

How long Ajax devices operate on batteries, and what affects this Battery Replacement

Tech Specs

Sensitive element	PIR sensor (motion) electret microphone (glass break)
Motion detection distance	Up to 12 m
Motion detector viewing angles (H/V)	88.5° / 80°
Time for motion detection	From 0.3 to 2 m/s
Pet immunity	Yes, weight up to 20 kg, height up to 50 cm
Glass break detection distance	Up to 9 m
Microphone coverage angle	180°
Tamper protection	Yes
Frequency band	868.0 – 868.6 MHz or 868.7 – 869.2 MHz depending on the region of sale

Operating temperature range	From -10°C to +40°C
Operating humidity	Up to 75%
Overall dimensions	110 × 65 × 50 mm
Weight	92 g
Service life	10 years
Certification	Security Grade 2, Environmental Class II in conformity with the requirements of EN 50131-1, EN 50131-2-7-1, EN 50131-2-2, EN 50131-5-3

Compliance with standards

1. Complete Set
2. CombiProtect
3. SmartBracket mounting panel
4. Battery CR123A (pre-installed)
5. Installation kit
6. Quick Start Guide

Warranty

warranty for the “AJAX SYSTEMS MANUFACTURING” LIMITED LIABILITY COMPANY products is valid for 2 years after the purchase and does not apply to.

Documents / Resources



The detector is set up via a **mobile application** for iOS and Android-based smartphones. The system notifies user of alerts via push notifications, SMS messages and calls if activated.

[AJAX AX-COMBIPROTECT-B CombiProtect](#) [pdf] User Manual
AX-COMBIPROTECT-B CombiProtect, AX-COMBIPROTECT-B, CombiProtect