



# AJAX 856963007613 Dry Contact Home Automation Module User Manual

[Home](#) » [ajax](#) » AJAX 856963007613 Dry Contact Home Automation Module User Manual 

## Contents

- [1 AJAX 856963007613 Dry Contact Home Automation Module](#)
- [2 Functional Elements](#)
- [3 Operating Principle](#)
- [4 Relay operation modes](#)
- [5 Connecting to the hub](#)
- [6 Indication](#)
- [7 Functionality Testing](#)
- [8 Maintenance](#)
- [9 Compliance with standards](#)
- [10 Warranty](#)
- [11 Documents / Resources](#)
  - [11.1 References](#)
- [12 Related Posts](#)



**AJAX 856963007613 Dry Contact Home Automation Module**



Relay is a wireless, low-voltage relay featuring potential-free (dry) contacts. Use Relay to remotely switch on/off appliances powered by a 7–24 V DC source. Relay can operate both in pulse and bistable mode. The device communicates with a hub via radio protocol. In the line of sight, the communication distance is up to 1,000 m.

### **WARNING**

Regardless of the type of electrical circuit, only a qualified electrician should install Relay!

The Relay contacts are not galvanically connected to the device itself, so they can be connected to the input control circuits of various equipment to imitate a button, toggle switch, etc.

- Use scenarios to program actions of automation devices (Relay, WallSwitch or Socket) in response to an alarm, Button press or schedule. A scenario can be created remotely in the Ajax app.
- How to create and configure a scenario in the Ajax security system
- The Ajax security system can be connected to the central monitoring station of a security company.
- Buy low-tension relay Relay

### **Functional Elements**

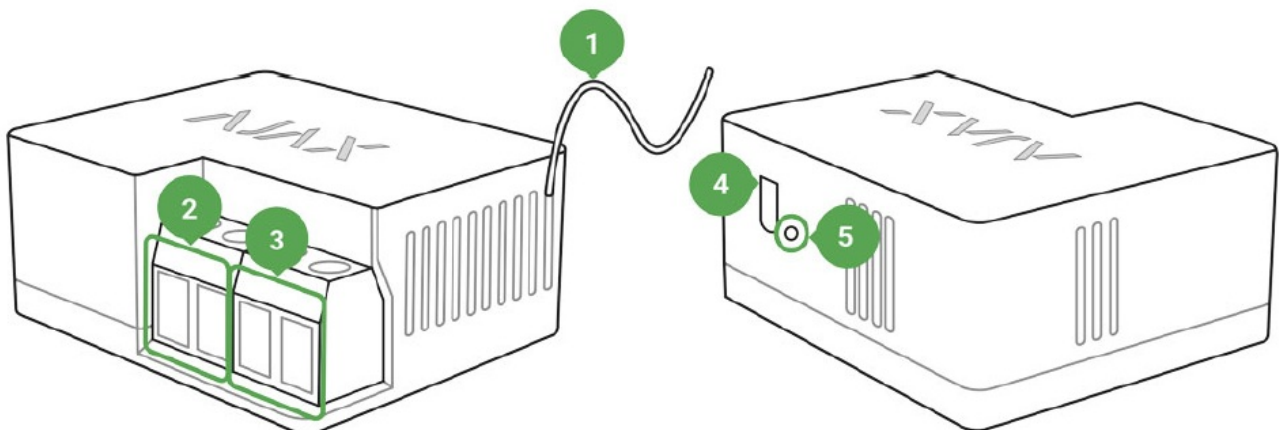

1. Antenna

2. Power supply terminal block
3. Contacts terminal block
4. Function button
5. Light indicator

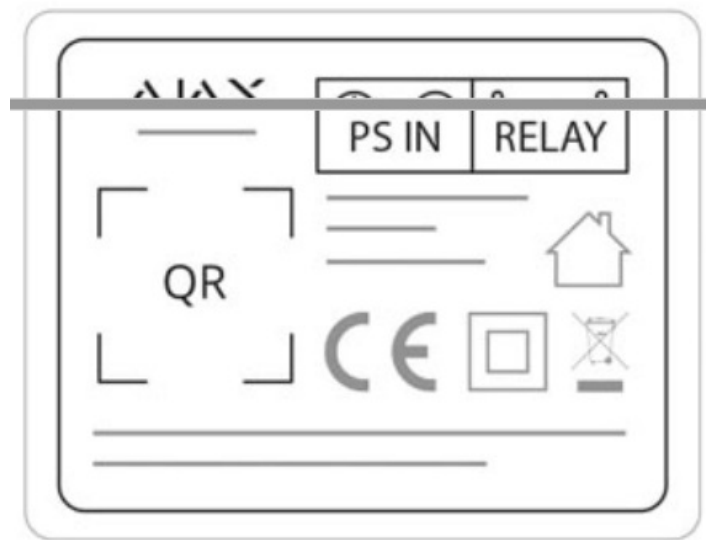

**PS IN terminals**– “+” and “-” contact terminals, 7-24 V DC input power supply.  
**Relay terminals** output potential-free terminals.

## Operating Principle

- Do not connect Relay power supply input terminals to a voltage exceeding 36 V or alternate current sources. It creates a risk of fire and will damage the device!
- Regardless of the type of electrical circuit, only a qualified electrician should install the Relay!
- The relay is powered by a 7-24 V DC source. The recommended voltage values are 12 V, and 24 V. Use the Ajax Security System app to connect and set up Relay.
- Relay features dry (potential-free) contacts. The contacts are not connected to the device galvanically so that Relay can imitate a button, switch, etc. in electrical circuits of various voltages (sirens, electrical valves, electromagnetic locks). The miniature body makes it possible to install a Relay inside a junction box, switchboard, or switch.
- Relay closes and opens the contacts by user command from the app or automatically by scenario.

## Relay operation modes

**Pulse-** Relay opens or closes contacts for a pre-set time (from 0.5 to 255 seconds) then switches back to the initial state.

## Connecting to the hub

### Before connecting the device:

1. Switch on the hub and check its Internet connection (the logo glows white or green).
2. Install the Ajax app. Create the account, add the hub to the app, and create at least one room.

3. Make sure that the hub is not armed, and it does not update by checking its status in the Ajax apPp
4. Connect Relay to 12 or 24 V power supply.

Only users with administrator rights can add a device to the app

### To pair Relay with a hub:

1. Click Add device in the Ajax app.
2. Name the device, scan it, or enter the QR code manually (located on the case and packaging), select the room.

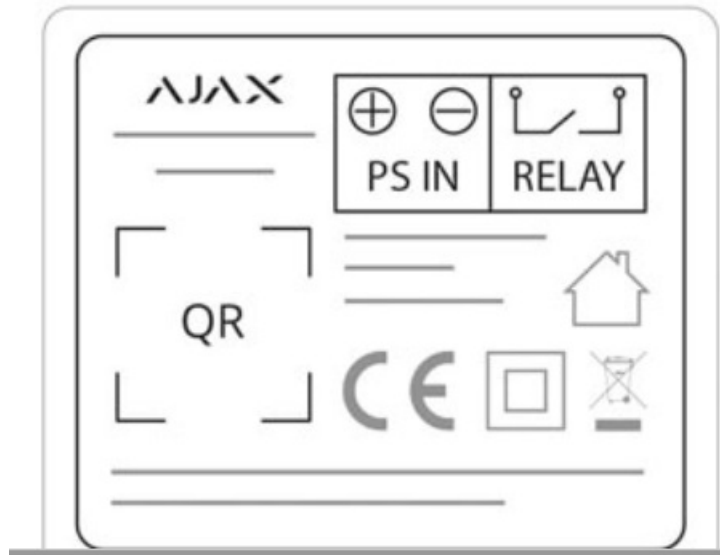

3. Click Add- the countdown will begin.
4. Press the functional button.

For detection and pairing to occur, the device should be located in the coverage area of the hub's wireless network (at the same object). The connection request is transmitted only at the moment of switching on the device. If the device failed to pair, wait 30 seconds and then retry. Relay will appear in the list of hub devices. The device statuses update depends on the ping interval set in the hub settings. The default value is 36 seconds.

### WARNING



When switching on for the first time, Relay contacts are open! When deleting Relay from the system, contacts open!

### States

1. Devices 
2. Relay

Parameter	Value
Jeweller Signal Strength	Signal strength between the hub and Relay
Connection	Connection status between the hub and the relay
Routed Through ReX	Displays the status of using a <u>radio signal range extender</u>
Active	State of the relay contacts (closed / open)
Voltage	The current input voltage

## Settings

1. Devices 
2. Relay
3. Settings 

Settings	Value
First field	Device name, can be edited
Room	Selecting the virtual room to which the device is assigned
Relay Mode	Choosing the relay operation mode <ul style="list-style-type: none"> <li>• Pulse</li> <li>• Bistable</li> </ul>
Contact State	Normal contact state <ul style="list-style-type: none"> <li>• Normally Closed</li> <li>• Normally Open</li> </ul>
Pulse duration, sec	Selecting the pulse duration in the pulse mode: From 0.5 to 255 seconds
Scenarios	Opens the menu for creating and configuring scenarios  <a href="#">Learn more</a>

	<p>removing it from the system. The device will not execute system commands and participate in automation scenarios. All notifications and alarms will be ignored</p> <p><b>Please note that deactivated device will save it's current state (active or inactive)</b></p>
Unpair Device	Disconnect Relay from a hub and delete its settings

**Voltage protection** the contact will open when the voltage exceeds the limits of 6.5-36.5 V.

**Temperature protection**— the contact will be opened when the temperature threshold of 85°C inside Relay is reached.

## Indication

- The Relay light indicator can light green depending on the device status.
- When not paired with the hub, the light indicator blinks periodically. When the functional button is pressed, the light indicator lights up.

## Functionality Testing

- The Ajax security system allows conducting tests for checking the functionality of connected devices.
- The tests do not start immediately but within a period of 36 seconds when using default settings. The test time start depends on the settings of the detector ping interval (the Jeweller menu in the hub settings).

Regardless of the type of electrical circuit, only a qualified electrician should install Relay.

- The communication range with the hub in the line of sight is up to 1,000 meters.
- Take this into account when choosing the location for Relay.
- If the device has a low or unstable signal strength, use a radio signal range extender.

## Installation process:

1. De-energize the cable to which Relay will be connected.
2. Connect the grid wire to the Relay terminals according to the following scheme:

When installing Relay in the box, lead out the antenna and place it under the plastic frame of the socket. The bigger the distance between the antenna and metal structures, the lower the risk of interfering (and impairment) of the radio signal.

Do not shorten the antenna! Its length is optimal for operation within the used radio frequency range!

- During the installation and operation of Relay, follow the general electrical safety rules and the requirements of electrical safety regulatory acts.
- It is strictly forbidden to disassemble the device. Do not use the device with damaged power cables.
- Do not install the relay

## Maintenance

The device does not require maintenance.

## Tech Specs

Actuating element	Electromagnetic relay
The service life of the relay	200,000 switchings
Supply voltage range	7 – 24 V (DC only)
Voltage protection	Yes, min — 6.5 V, max — 36.5 V
Maximum load current*	5 A at 36 V DC, 13 A at 230 V AC
Operating modes	Pulse and bistable
Pulse duration	0.5 to 255 seconds
Maximum current protection	No
Parameter control	Yes (voltage)
Device energy consumption	Less than 1 W
Radio communication protocol	Jeweller  <a href="#">Learn more</a>
Radio frequency band	866.0 – 866.5 MHz 868.0 – 868.6 MHz 868.7 – 869.2 MHz 905.0 – 926.5 MHz 915.85 – 926.5 MHz 921.0 – 922.0 MHz Depends on the region of sale.

Hub	<a href="#">Learn more</a>
Communication ping with the receiver	12 – 300 sec (36 sec default)
Shell protection rating	IP20
Operating temperature range	From 0°C to +64°C (ambient)
Max. temperature protection	Yes, over 65°C at the place of installation or over 85° C inside the Relay
Operating humidity	Up to 75%
Dimensions	39 × 33 × 18 mm
Weight	25 g
Service life	10 years



If using inductive or capacitive load, the maximum commutated current decreases to 3 A at 24 V DC and to 8 A at 230 V AC!

## Compliance with standards

### Complete Set

1. Relay
2. Connecting wires-2 pcs
3. Quick Start Guide

### Warranty

Technical support: [support@ajax.systems](mailto:support@ajax.systems)

### Documents / Resources

	<a href="#">AJAX 856963007613 Dry Contact Home Automation Module</a> [pdf] User Manual 856963007613, Dry Contact Home Automation Module, Home Automation Module, Dry Contact Module, Module
-----------------------------------------------------------------------------------	------------------------------------------------------------------------------------------------------------------------------------------------------------------------------------------------

### References

- [End user agreement - Ajax Systems](#)
- [Jeweller radio technology | Ajax Systems](#)
- [Current product lines of the Ajax security system](#)
- [Current product lines of the Ajax security system](#)
- [Wireless panic button with control mode | Ajax Systems](#)
- [ocBridge Plus — Module for Ajax devices integration with wired systems](#)
- [Signal range extenders in the security system | Ajax Systems](#)
- [Relay — Low current remote control relay with dry contact](#)
- [uartBridge — Module for Ajax devices integration with third-party wireless alarms systems](#)
- [Jeweller and Wings radio protocols in the Ajax security system](#)
- [Software | Ajax Systems](#)
- [Ajax devices standards compliance list](#)
- [Warranty - Ajax Systems](#)
- [Jeweller radio protocol: technology and capabilities | Ajax Systems Support](#)
- [How to create and configure a scenario in the Ajax system | Ajax Systems Support](#)
- [What is Jeweller Signal Strength Test | Ajax Systems Support](#)