

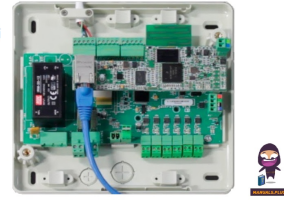

AZX8WS1BWF Webserver Cloud Wi-Fi



AIRZONE AZX8WS1BWF Webserver Airzone Cloud Wi-Fi Owner's Manual

[Home](#) » [AIRZONE](#) » AIRZONE AZX8WS1BWF Webserver Airzone Cloud Wi-Fi Owner's Manual 

Contents

- [1 Airzone AZX8WS1BWF Webserver Cloud Wi-Fi](#)
- [2 Product Usage Instructions](#)
- [3 WEBSERVER AIRZONE CLOUD WI-FI](#)
- [4 TECHNICAL SPECIFICATIONS ASSEMBLY AND CONNECTION](#)
- [5 CONFIGURATION](#)
- [6 SELF DIAGNOSIS](#)
- [7 Frequently Asked Questions](#)
- [8 Documents / Resources](#)
 - [8.1 References](#)



Airzone AZX8WS1BWF Webserver Cloud Wi-Fi

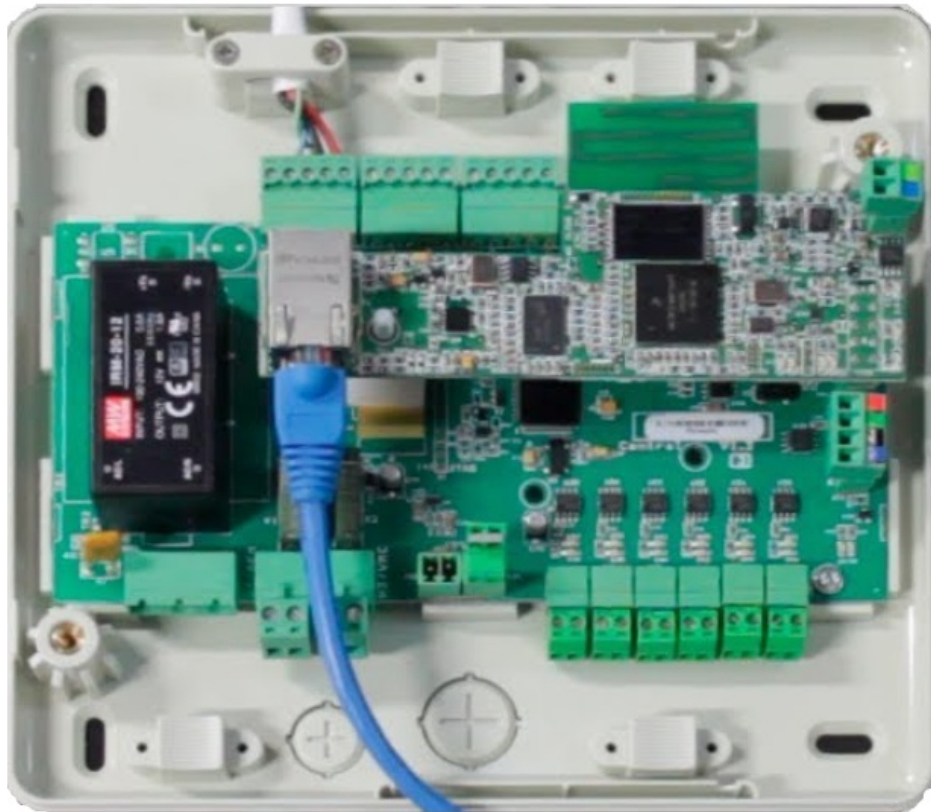

Specifications

- **Voltage:** Max 12 Vdc
- **Current:** Max 200 mA
- **Stand-by Consumption:** 1.8 W
- **Wi-Fi Protocol:** Wi-Fi CERTIFIED TM 802.11a/b/g/n/ac
- **Wi-Fi Frequencies:** 2.4 GHz (max. 150 Mbps), 5 GHz (max. 433 Mbps)
- **Bluetooth Protocol:** Bluetooth v5.0 BR/EDR and BLE specification
- **Operating Humidity Range:** 5% to 90% (non-condensing)
- **Dimensions:** 9.7 mm x 40 mm x 130 mm
- **Model:** LBEE5HY1MW

Product Usage Instructions

- **Power Supply:**
Connect the device to a power source with a maximum voltage of 12 Vdc and a maximum current of 200 mA.
- **Wi-Fi Connection:**
Ensure the device is within the Wi-Fi range and connect it to a Wi-Fi network following the provided Wi-Fi protocol.
- **Accessing the Device:**
Access the device through a browser or the dedicated App available for IOS and Android.
- **System Control:**
You can control Airzone systems and adjust system parameters via the Airzone Cloud platform.
- **Status Indicators:**
Refer to the status indicators (D1 to D15) for information on data transmission, power supply, internet

connection, and network data reception/transmission.

WEBSERVER AIRZONE CLOUD WI-FI

Webserver for controlling Airzone systems through the Airzone Cloud platform. Accessible through browser or App (available for IOS and Android). WiFi connection. Powered through the domotic bus.

Functionalities:

- Configuration and control of zone parameters (Room and set-point temp., operating mode, etc.) and system parameters via Airzone Cloud.
- Associated with the router through the app via Bluetooth.
- Temperature and operating mode time schedules.
- Multi-user and multisession.
- Remote updates of the Webserver firmware and the system connected to it.
- Remote error detection and error resolution.

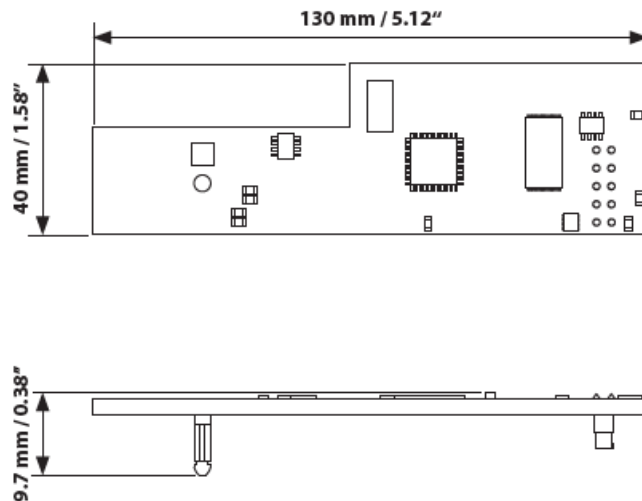

TECHNICAL SPECIFICATIONS

Power supply and consumption		
	V max	12 Vdc
	I max	200 mA
	Consumo Stand-by	
	Stand-by consumption	1.8 W
	Consumo em stand-by	
1	Domotic bus	
	Communications protocol	MODBUS RS-485 Par – 19200 bps
Wi-Fi		
	Protocol	WI-FI CERTIFIED™ 802.11a/b/g/n/ac
	Model	LBEE5HY1MW
	Frequency	2.4 GHz (max. 150 Mbps) 5 GHz (max. 433 Mbps)
	Maximum power	17.93 dBm, 0.1 dBi
	Sensivity	- 82 dBm
	Maximum distance	100 m (328 ft)
	IP address by default	DHCP
Bluetooth		
	Protocol	Bluetooth v5.0 BR/EDR and BL specification
	Bluetooth class	Class-1, class-2 and class-3 transmitter
Operating temperaturass		
	Storage	- 20 ... 70 °C (- 4 ... 158 °F)
	Operation	0 ... 45 °C (32 ... 113 °F)
	Operating humidity range	5 ... 90% (non-condensing)
Mechanical aspects		
	Maximum operating height /	2000 m (6561.68 ft)

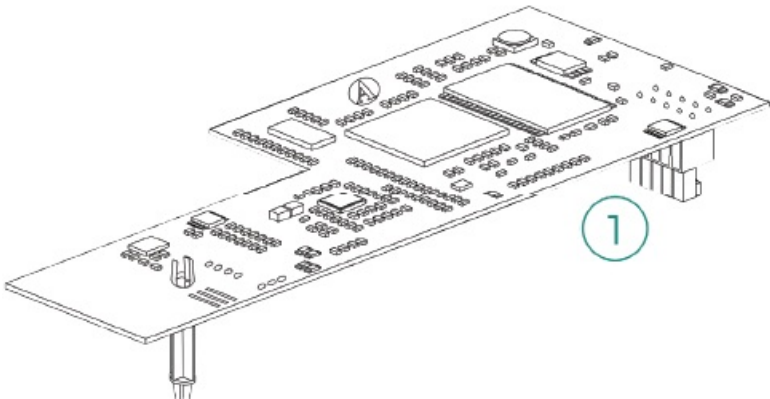

ASSEMBLY AND CONNECTION

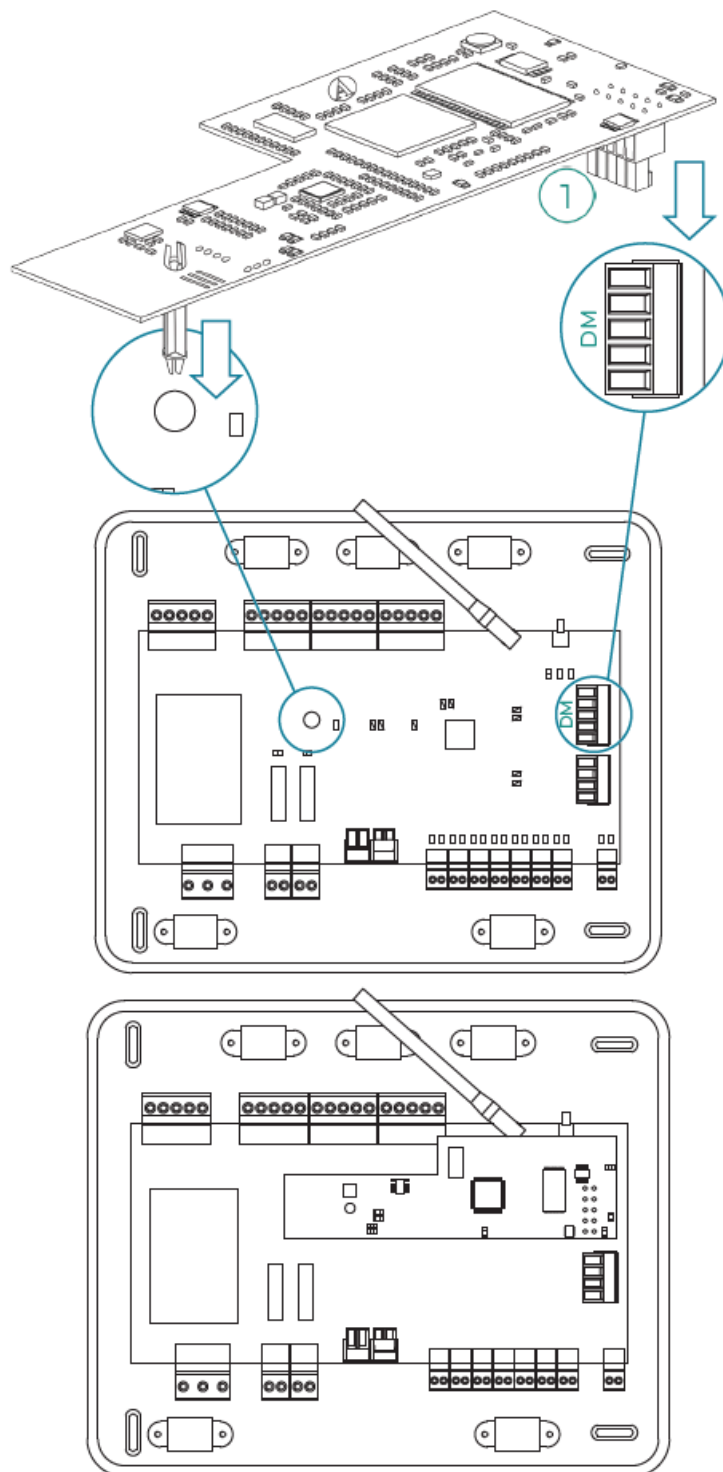

CONFIGURATION

To start up the system and configure it, download:

 App Airzone Cloud



SELF DIAGNOSIS

Meaning			
D1	Data reception from automation bus	Blinking	Green
D2	Data transmission from automation bus	Blinking	Red
D3	Microswitch performance	Blinking	Green
D11	Power supply	Solid	Red
D12	Connected to the Internet	Blinking	Green
D13	Configured as IP address through DHCP	Switch off	Red
	Configured as Solid IP address	Switch off	
D14	Network data transmission	Blinking	Red
D15	Network data reception	Blinking	Green

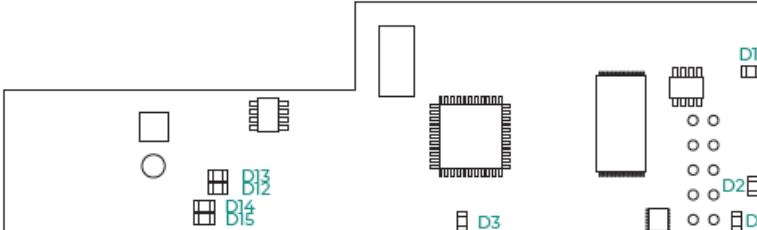

This device complies with the requirements of Directive 2014/53/EU. The full declaration is at www.airzonecontrol.com.

Frequently Asked Questions

- **Q: How do I configure the device with a fixed IP address?**

A: The device can be configured with a fixed IP by accessing the settings and choosing the manual IP configuration option.

- **Q: What is the maximum distance for standard IP addressing?**

A: The maximum distance for standard IP addressing is 100 meters (328 feet) when using DHCP.

Documents / Resources

	<p>AIRZONE AZX8WS1BWF Webserver Airzone Cloud Wi-Fi [pdf] Owner's Manual LBEE5HY1MW, AZX8WS1BWF Webserver Airzone Cloud Wi-Fi, AZX8WS1BWF, Webserver A irzone Cloud Wi-Fi, Airzone Cloud Wi-Fi, Cloud Wi-Fi, Wi-Fi</p>
--	--

References

- [User Manual](#)

Manuals+, Privacy Policy

This website is an independent publication and is neither affiliated with nor endorsed by any of the trademark owners. The "Bluetooth®" word mark and logos are registered trademarks owned by Bluetooth SIG, Inc. The "Wi-Fi®" word mark and logos are registered trademarks owned by the Wi-Fi Alliance. Any use of these marks on this website does not imply any affiliation with or endorsement.