

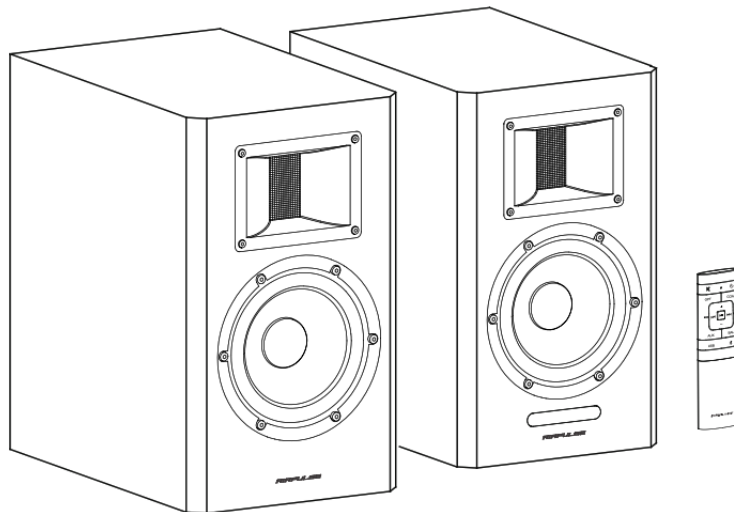

AIRPULSE A300 Active Speaker System User Manual

[Home](#) » [AIRPULSE](#) » AIRPULSE A300 Active Speaker System User Manual 

AIRPULSE



A300
User manual Mode d'emploi
Active Speaker System

Contents

- 1 Important safety instruction
- 2 Box Contents
- 3 Speaker Illustration
- 4 Remote Control Illustration
- 5 Installing Battery in Remote Control
- 6 Preparation
- 7 Balanced Input Mode
- 8 AUX Input Mode
- 9 Optical or coaxial Input Mode
- 10 Bluetooth Input Mode
- 11 Specifications/Statement
- 12 Troubleshooting
- 13 Documents / Resources
 - 13.1 References
- 14 Related Posts

Important safety instruction

Please read the following contents carefully before turning on your equipment; and follow the instructions below. Keep this information around for future reference.

1. Please read the instructions carefully. Keep it in a safe place for future reference
2. Heed all warnings.
3. Follow all instructions.
4. Do not install near any heat sources such as radiators, heat registers, stoves, or other apparatus (including amplifiers) that produce heat.
5. Do not defeat the safety purpose of the polarized or grounding-type plug. A polarized plug has two blades one wider than the other. A grounding type plug has two blades and a third grounding prong. The wide blade or the third prong is provided for your safety. If the provided plug does not fit into your outlet, consult an electrician for the replacement of the obsolete outlet.
6. Protect the power cord from being walked on or pinched particularly at plugs, convenience receptacles, and the point where they exit from the speaker.
7. Only use attachments/accessories specified by the manufacturer.
8. Unplug this speaker during lightning storms or when unused for long periods of time.
9. Before connecting speakers to a power source, please turn off the power switch and make sure the volume is set at a minimum level.
10. Please do not place the power cable and signal cable near the heat source (such as the electric heater and radiator). Do not leave cables where they can easily be stepped on or compressed.
11. Use electric outlets that allow power cables be pulled out easily. When speakers are not being used for an extended period of time, please turn off the power switch and disconnect the power plug.
12. In order to avoid damage from thunder and lightning, turn off the power switch and disconnect the speaker from the power source during a rain storm.
13. Please do not drag the power cable when disconnecting from the wall socket. Hold the power cord firmly at the top to unplug it from the wall socket.
14. Use the speakers only within voltage specifications. Using speakers with a voltage higher than specifications is

dangerous and can cause equipment damage, fire damage or bodily injury.

15. These speakers do not include any self-serviceable parts. Do not attempt to open the speaker to uninstall any parts or do any type of modifications. If problems occur during use please contact professional technicians only for repair.
16. Please refer to the troubleshooting section in the owner's manual for common operation errors and to determine possible malfunctions.
17. Please do not place speakers in places where they can be easily hit by falling objects or dropping and splashing liquid. Do not place any lit fire (such as a candle) on top of the speaker as this may lead to a fire hazard. Do not place any liquid containers on top of the speaker as this may fall on speakers and cause electric shock and damage to the speaker.
18. Place speakers in a stable position so they will not easily fall off causing damage and injury.
19. Place speakers in a well-ventilated and dry position, far from direct sunlight, heat source, vibration, dust, and moist or extremely cold conditions. For optimal performance, please leave at least 20 cm distance space around the speaker.
20. Please do not use the speaker at maximum volume for an extended period of time, This may cause damage to your hearing.
21. Before moving the speakers, please first turn off the power switch and disconnect from the power source.
22. When the following symptoms occur, please turn off the power switch and disconnect from the power source:
— The power cable or plug is worn or damaged. — Abnormal odor or smoke is detected. — Small objects fall inside the speaker. — Sudden break-off while playing music. Consult a professional repair technician to diagnose and repair the speaker.
23. Do not use a chemical solvent to clean the surface of the speaker. To avoid surface damage, use a clean and soft cloth only.
24. Do not use the speakers in proximity closer than 22 cm to individuals wearing cardiac pacemakers or defibrillators.

Warning:

1. Use the same type of battery only to replace the battery in the remote control.
2. Never disassemble, smash, or compress the battery inside the remote control; or toss it into a fire.
3. Please stop using the remote control if it has the appearance of bulging, leaking, discoloring, or any other abnormal symptoms. Improper use of battery can cause explosion or leaking which leads to burning or another bodily injury. Please dispose of the battery by referring to local legislation.



Excessively loud music may lead to hearing loss. Please keep the volume in a safe range.



Correct Disposal of this product. This marking indicates that this product should not be disposed of with other household wastes throughout the EU. To prevent possible harm to the environment or human health from uncontrolled waste disposal, recycle it responsibly to promote the sustainable reuse of material resources. To return your used device, please use the return and collection systems or contact the retailer where the product was purchased. They can take this product for environmentally safe recycling.



Use only with the cart, stand, tripod, bracket, or table specified by the manufacturer, or sold with the speakers. When a cart is used, use caution when moving the cart/speakers combination to avoid injury from tip-over.

Power warning:

1. Place the product near the power outlet for easy use.
2. Before use, make sure that the operating voltage is the same as your local power supply. Correct operating voltage can be found on the product plate.
3. For safety purposes, unplug the product during lightning storms or when unused for extended periods of time.
4. Under normal conditions, the power supply may get hot. Please keep good ventilation in the area and exercise caution.
5. Safety warning labels on the housing or bottom of the product or power adaptor.



This symbol is to alert the user to the presence of an un-insulated dangerous voltage within the product's enclosure that may be of sufficient magnitude to constitute a risk of electric shock to persons.



This symbol is to warn the user not to disassemble the enclosure of the product and there is no user-replaceable part inside. Take the product to an authorized service center for repair.



This symbol indicates that the product is for indoor use only.

WARNING! The unit is of Class I construction and must be connected to a main socket outlet with a protective earthing connection. Where the mains plug is used as the disconnect device, the disconnect device shall remain readily operable.

For wireless products:

1. Wireless products may generate shortwave radio frequencies and interfere with the normal use of other electronic devices or medical equipment.
2. Turn off the product when it's disallowed. Do not use the product in medical facilities, on airplanes, at gas stations, near automatic gates, the automatic fire alarm systems or other automated devices.
3. Do not use the product in the vicinity of a pacemaker within a 20cm range. Radio waves may affect the normal operation of the pacemaker or other medical devices.

FCC Statement

This device complies with part 15 of the FCC Rules. Operation is subject to the following two conditions:

(1) This device may not cause harmful interference, and (2) This device must accept any interference received, including interference that may cause undesired operation.

Any Changes or modifications not expressly approved by the party responsible for compliance could void the user's authority to operate the equipment.

Note: This equipment has been tested and found to comply with the limits for a Class B digital device, pursuant to part 15 of the FCC Rules. These limits are designed to provide reasonable protection against harmful interference in a residential installation.

This equipment generates uses and can radiate radio frequency energy and, if not installed and used in accordance with the instructions, may cause harmful interference to radio communications.

However, there is no guarantee that interference will not occur in a particular installation. If this equipment does

cause harmful interference to radio or television reception, which can be determined by turning the equipment off and on, the user is encouraged to try to correct the interference by one or more of the following measures:

- Reorient or relocating the receiving antenna.
- Increase the separation between the equipment and receiver.
- Connect the equipment into an outlet on a circuit different from that to which the receiver is connected.
- Consult the dealer or an experienced radio/TV technician for help.

This equipment complies with FCC radiation exposure limits set forth for an uncontrolled environment. This equipment should be installed and operated with a minimum distance 26cm between the radiator & your body.

IC Caution

The device meets the exemption from the routine evaluation limits in section 2.5 of RSS 102 and compliance with RSS-102 RF exposure, users can obtain Canadian information on RF exposure and compliance.

This device contains license-exempt transmitter(s)/receiver(s) that comply with Innovation, Science and Economic Development Canada's license-exempt RSS(s). Operation is subject to the following two conditions:

1. This device may not cause interference.
2. This device must accept any interference, including interference that may cause undesired operation of the device.

This equipment should be installed and operated with a minimum distance of 20 cm between the radiator and your body.

Hereby, Edifier International Limited declares that the radio equipment type A300 is in compliance with Directive 2014/53/EU. The full text of the EU declaration of conformity is available at the following internet address:

<https://www.edifier.com/int/eu-doc.html>

Box Contents

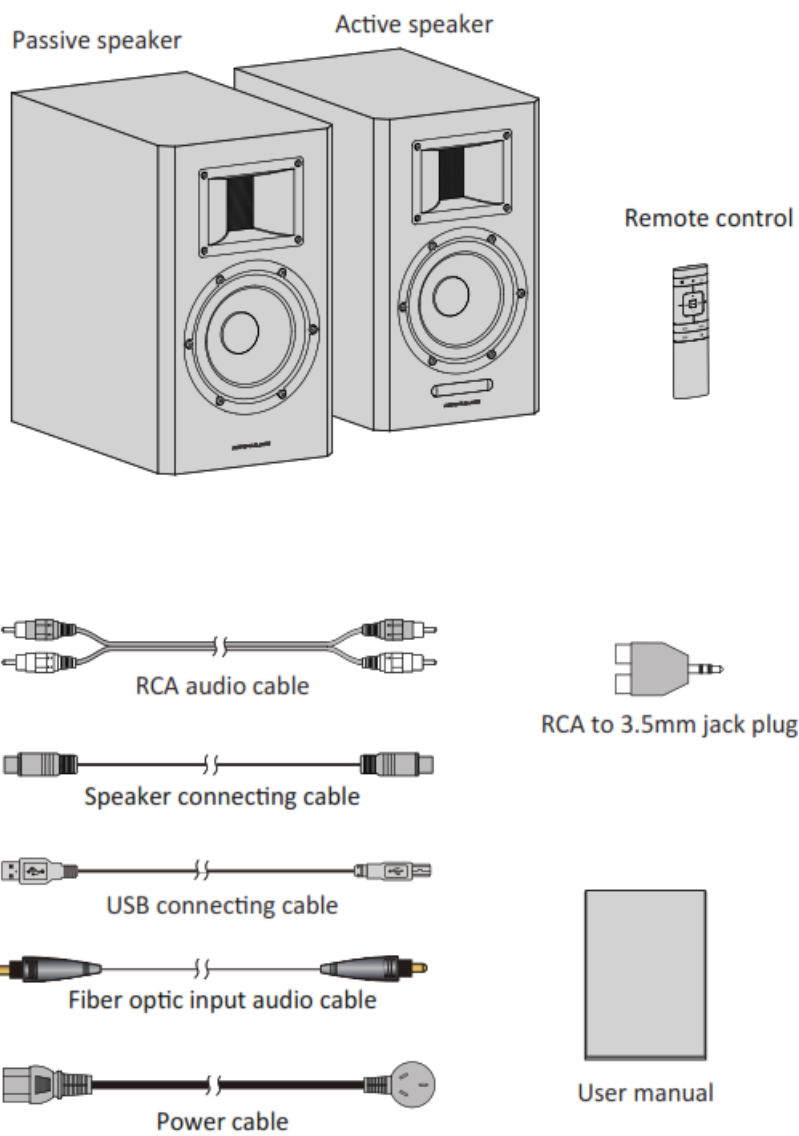

Speaker Illustration

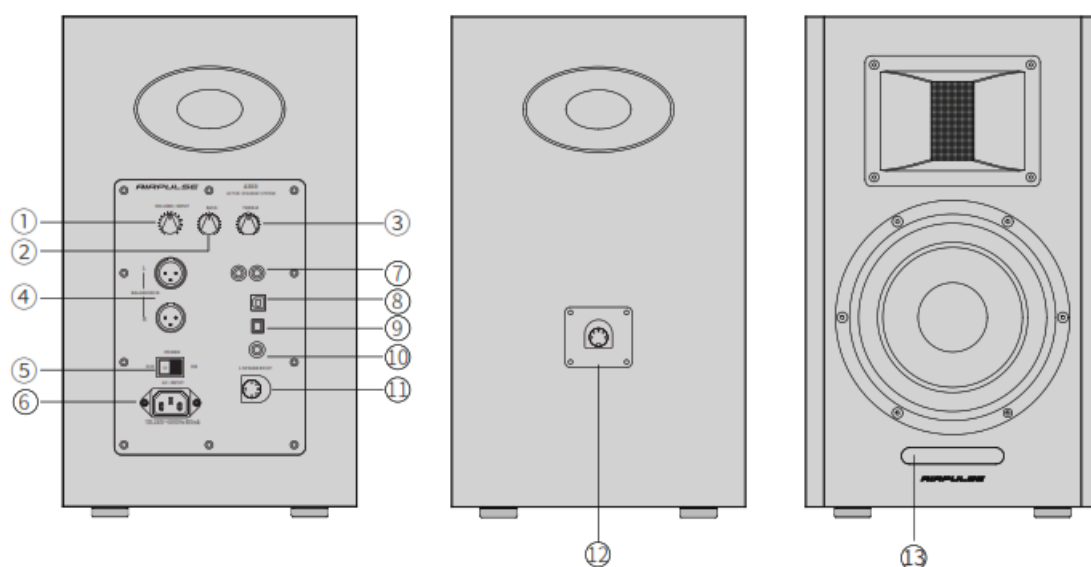

1. Volume control/input selection Volume control

Rotate clockwise to increase volume; rotate counterclockwise to reduce volume.

When reaching maximum volume level, continue to rotate volume control will not change the volume.

Input selection

Press to switch between BAL — AUX — USB — Optical — Coaxial – Bluetooth modes.

{As DSP will be reconfigured when input mode is switched, it is recommended to press after the current mode indicator flashes once.)

Standby control

Press and hold to alternate between Power on and Stand by mode.

2. Bass level adjustment Room acoustics may dictate which type of adjustment you need to make to retain the proper frequency response from the speaker. Turn from “0” to left to reduce low frequencies; Turn from “0” to right to increase low frequencies.
3. Treble level adjustment Room acoustics may dictate which type of adjustment you need to make to retain the Proper frequency response from the speaker. Turn from “0” to left to reduce high frequencies; Tum from “0” to right to increase high frequencies.
4. Balanced input port
Connect to audio source devices with balanced output using XLR cable.
5. Power switch
Turn on/off speaker power.
6. AC input socket
Connect to plug of the power cord.
7. Auxiliary input port
Connect to audio source devices with RCA output port using RCA audio cable.
8. USB B type port
Connect to audio source devices with USB output port using USB connecting cable.
9. Optical input port
Connect to audio source devices with optical output port using fiber optic input audio cable.
10. Coaxial input port
Connect to audio source devices with a coaxial output port using a coaxial cable.
11. Passive speaker connector
Connect to the passive speaker using a speaker connecting cable.
12. Active speaker connector
Connect to the active speaker using speaker connecting cable.
13. LED indicator/remote control receiving window
; Indicates current input mode based on . audio sources and input selection.

Note: Bass and Treble trimmers are automatically bypassed in default when the system is taking the signal from balanced input ports, thus avoiding changes to the input signal.

Remote Control Illustration

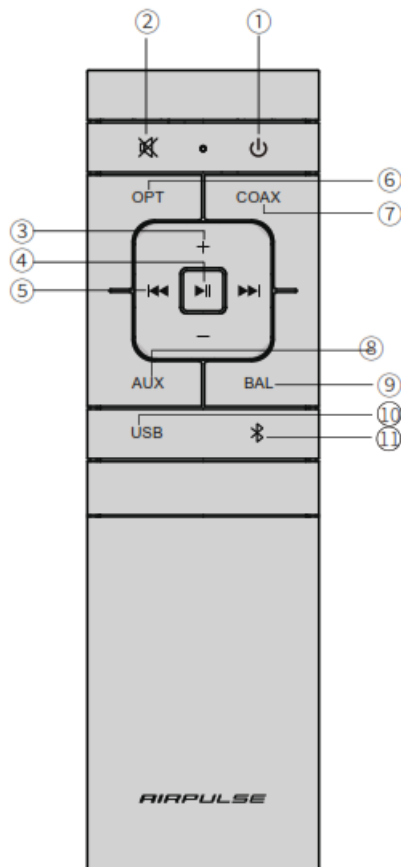





1. Standby button

When powered on, press the “” button to let the speaker enter standby mode. The displayed value of the remote control receiving window on the active speaker will

disappear but internal power is still being connected. Re-press the “()” button or press the “VOLUME/INPUT” knob on the rear panel of the active speaker to power

on the speaker again. Press the “” button on the rear panel to turn on/off the main power.

Volume control buttons

2.  Mute	Mute off speaker output
3. +1— Volume up/down	Adjust playing volume
Playback selection buttons	
4.  Play/Pause	Audio source play/pause in Bluetooth/USB mode
 Previous/ 5. Next track	Previous/next track in Bluetooth/USB mode
Input source selection buttons	
6. OPT	Optical input mode
7. COAX	Coaxial input mode
8. AUX	AUX input mode
9. BAL	Balanced input mode
10. USB	USB input mode
11.  (Bluetooth)	Bluetooth input mode

-  When playing music in Bluetooth mode and switching to other modes, Bluetooth the connection will automatically return if selecting Bluetooth mode again.
- When playing music in USB mode and switching to other modes, PC needs to be reset for USB mode to be selected again.

Please refer to “Set this product as the audio output device of PC”.

How to operate the remote control

Aim the remote control at the remote control receiving window. The optimum operational distance is within 7 meters. When the system receives remote control commands, the display value of the display window will alert or flash.

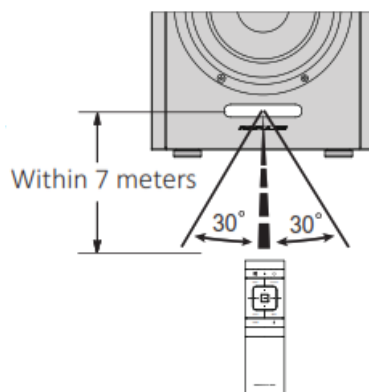

Installing Battery in Remote Control

Install or replace remote control battery

1. As the illustration shows, with a thumb press down the slot of the battery cover and slide to remove the cover

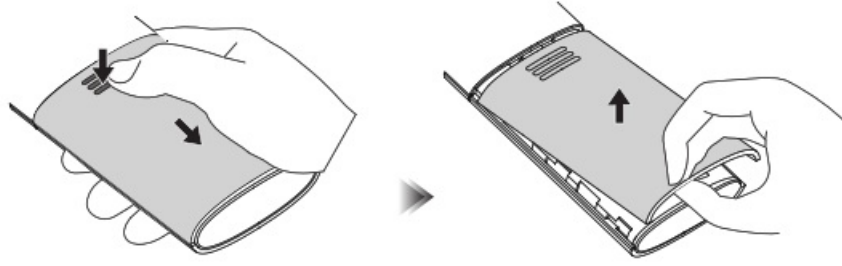

2. Place the two AAA batteries (note the “+” and “-” pole) into the battery compartment and close the battery cover.

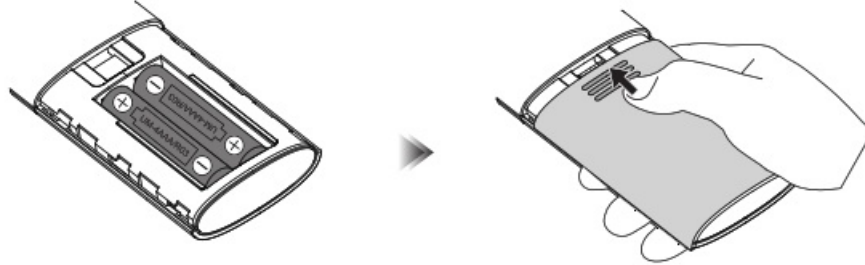

Note

1. The battery life is normally about 6 months; please replace it when the remote control is not sensitive or the control distance to be shortened.
2. Remove the battery immediately when exhausted to avoid explosion or acid leaks.
3. Discard the battery immediately in the event of battery leakage, paying attention not to touch the leaking materials.
If leaking is in contact with skin or gets in the eyes/mouth, rinse immediately and seek emergency treatment immediately. Please clean the battery compartment thoroughly
Prior to installing the new battery.
4. Never use the remote control in the conditions below:
 - Places with high humidity, e.g. a bathroom
 - Places with high temperature, e.g. near a heater or stove
 - Places with extremely low temperature
 - in dusty places
5. Never swallow the batteries in case of chemical burning risk.
6. Never mix old and new batteries. This will shorten the new battery life or cause old battery leakage.
7. Remove the battery when unused for a long period of time to avoid battery leakage.
8. Never use this product when the battery compartment is not securely closed, and keep the remote control away from children. Never let children touch the battery.
9. If the battery is accidentally swallowed, rush to the hospital immediately.
10. The danger of explosion if the battery is incorrectly replaced.
Replace only with the same or equivalent
11. The battery should not be exposed to excessive heat such as direct sun, fire or similar.

Preparation

1. Connect speakers

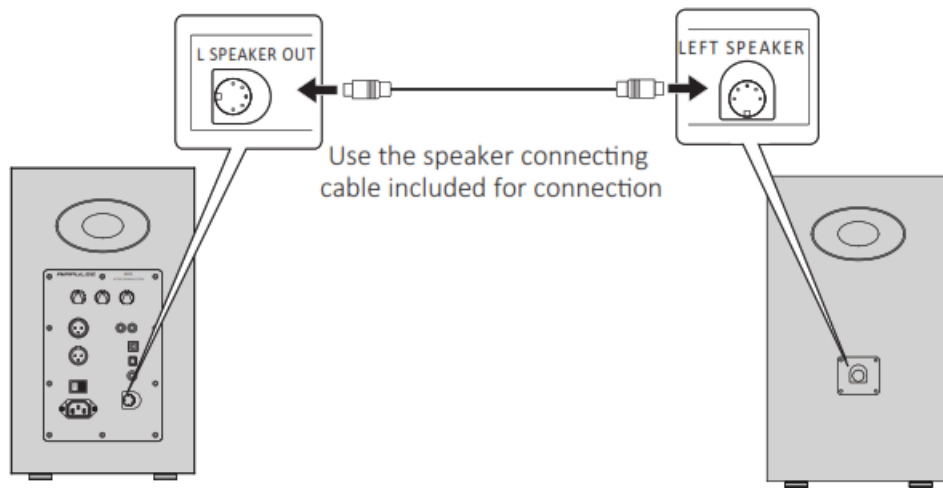

2. Connect to playback devices

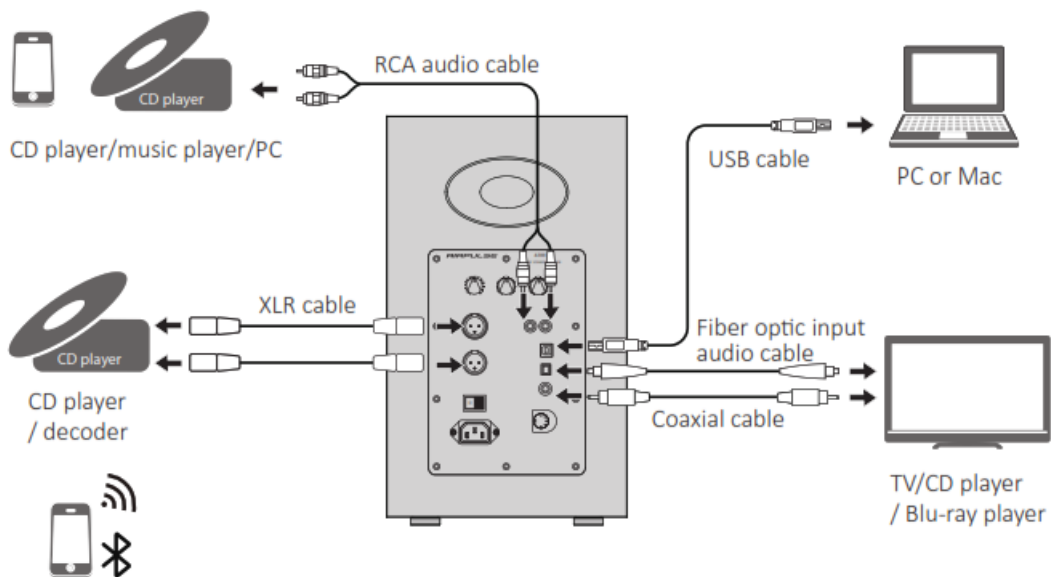

3. Connect to a power source

Connect the power cable included to a power input port on the rear panel, and then insert the power plug into a wall outlet.

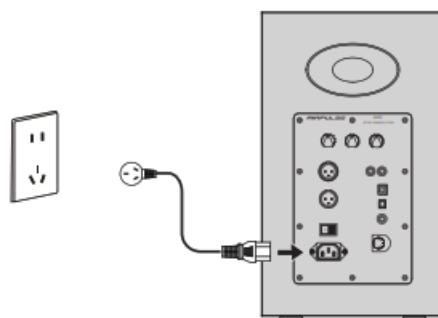

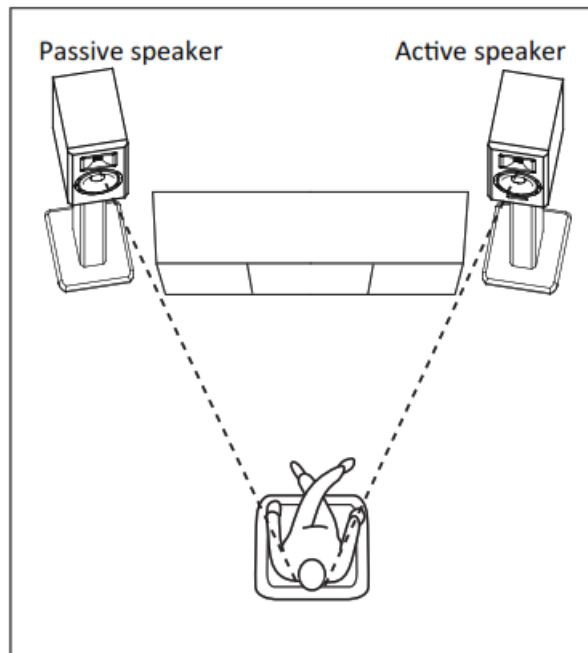

4. Speaker placement

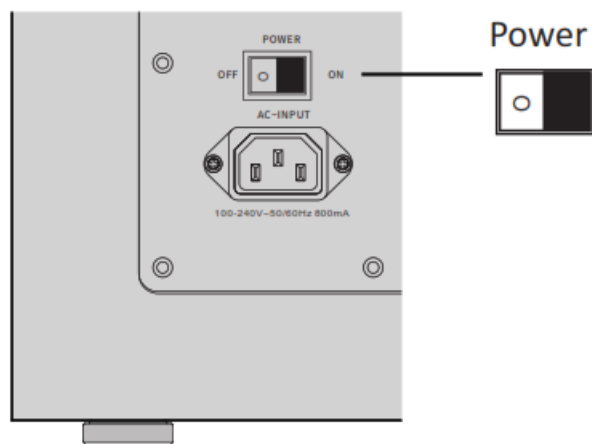

- * Place the passive and active speaker on a solid, leveled, and steady surface. For optimum sound positioning and layering, using the special stands of A300 is recommended.
- * For the optimum stereo sound effect, the listener can slightly adjust speaker angle.
- * For the most accurate sound and balance, the listener should be in the axis of the equilateral triangle formed by the active and passive speakers.
- * High frequency has a much higher directivity, and for more accurate sound effect the speaker's tweeter should be at ear level of the listener.

5. Turn on the main power



- After all cables are connected securely, press the power switch on the rear panel to turn on main power;
- Press the “” on the remote control to turn off the power source or switch to a standby state;
- LED indicator will be lit to show the current audio mode, please select the correct audio source with the corresponding connection.

Balanced Input Mode

1. Connect to audio source devices with balanced output using an XLR cable.

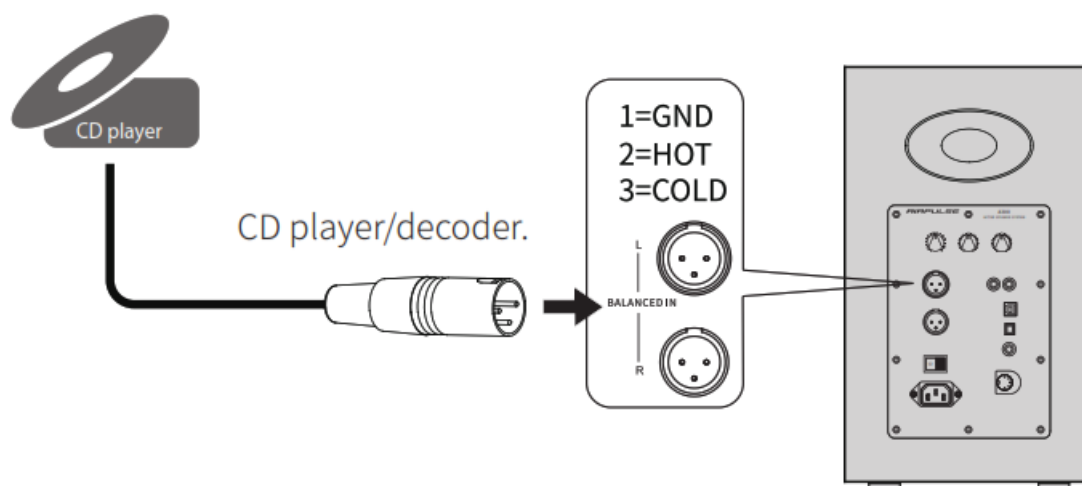

2. Press the “BAL” button on the remote control or press the “VOLUME / INPUT” button on the rear panel of the active speaker to select BAL input mode, LED indicator on the active speaker will display “BAL”.

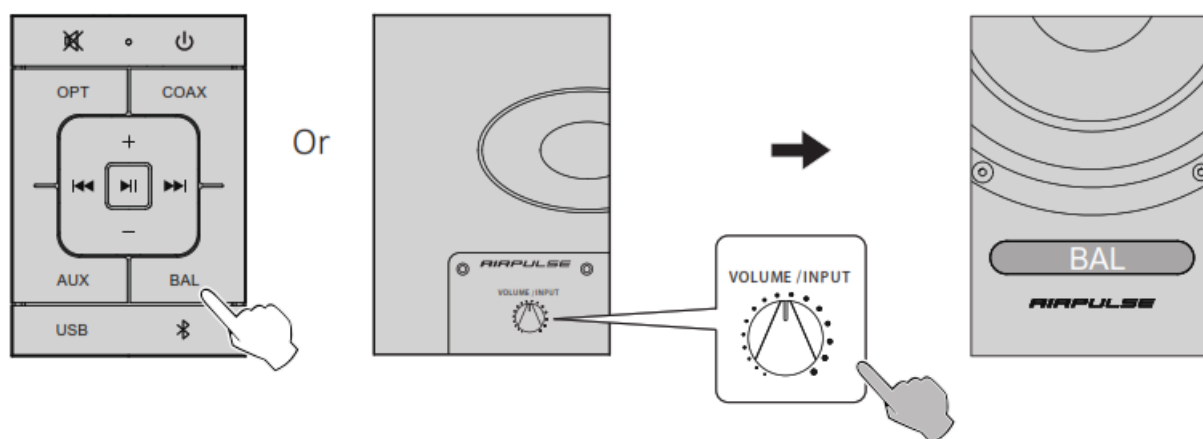

3. Play music on the connected device, press the “+/-” button on the remote control or press the “VOLUME / INPUT” button on the rear panel of the active speaker to adjust the volume to the desired level.

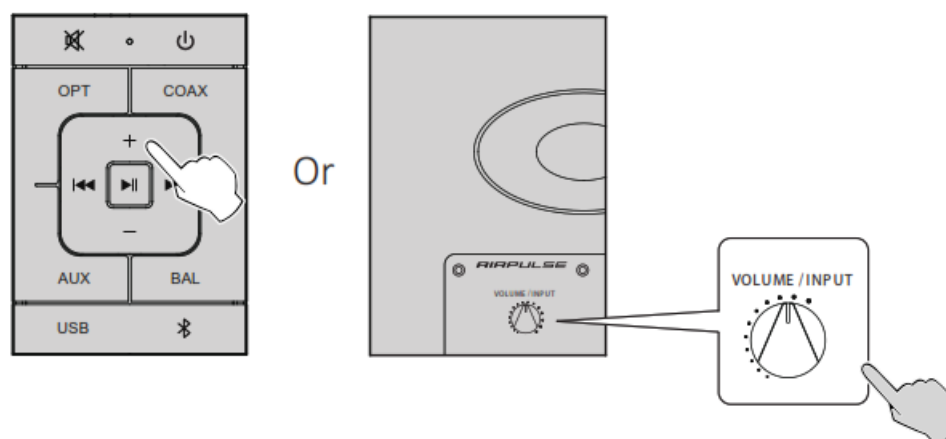

* XLR type interface is widely used in professional audio equipment, XLR interface of A300 can be connected to playing devices with a balanced output port.

* Balanced connection can effectively cancel external noise, support long-distance mline transmission, and reduce noise picked up during transmission.

* There is no XLR cable attached in the package, and the users need to buy it on their

AUX Input Mode

1. Insert RCA audio cable into the AUX input port on the rear panel of the active speaker (pay attention to L/R

connector matching); then connect RCA audio cable to audio source devices with RCA output port (CD player/audio decoder/PC/music player/ mobile phone).

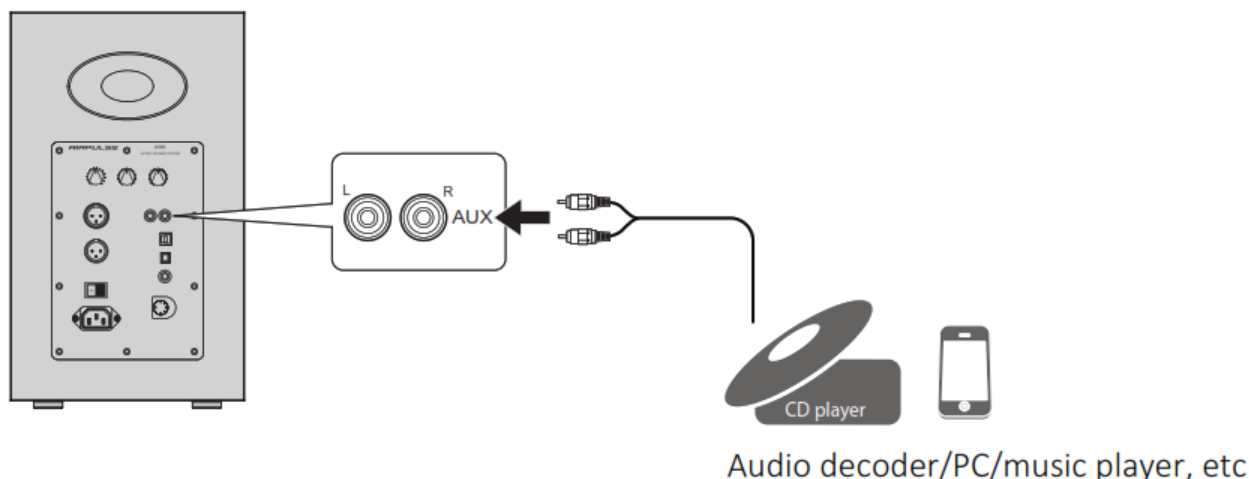

2. Press the “AUX” button on the remote control or press the “VOLUME / INPUT” button on the rear panel of the active speaker to select AUX input mode, LED indicator on the active speaker will display “AUX”.

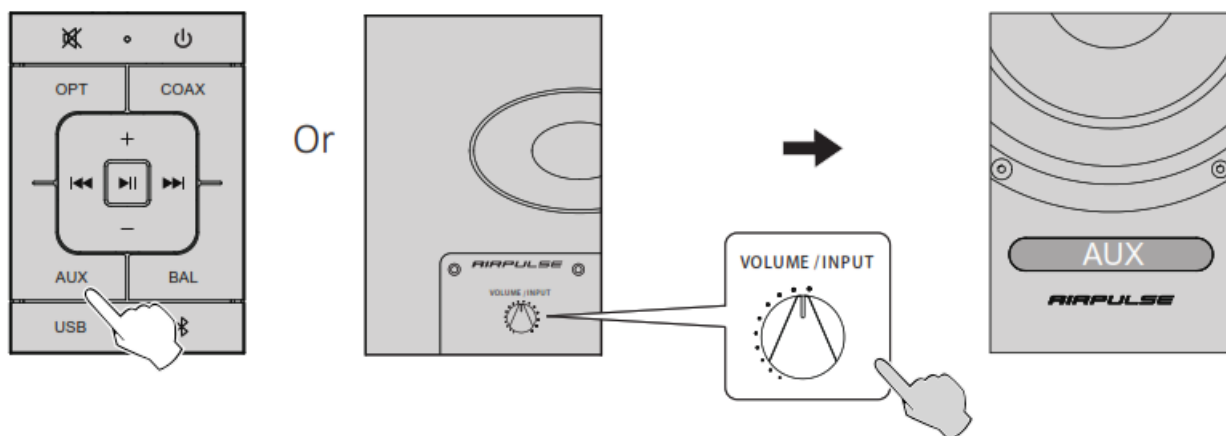

3. Play music on the connected device, press the “+/-” button on the remote control or press the “VOLUME / INPUT” button on the rear panel of the active speaker to adjust the volume to the desired level.

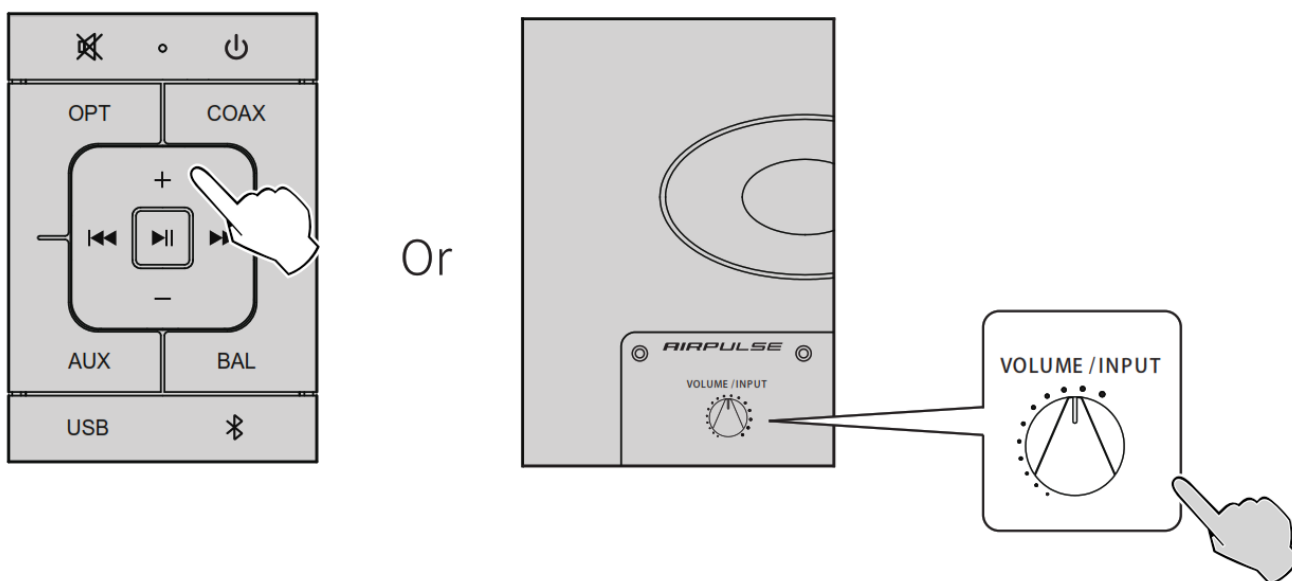

When connecting to audio source devices with 3.5mm headphone jack, user can use the adapter plug for transferring output.

USB Input Mode

The USB interface chip in the A300 is an XMOS chip commonly used by high-end audio equipment. After being

connected to PC, USB interface will directly extract and play the back digital audio signal in a manner similar to the “USB external sound card”, to avoid sound degradation and dynamic range compression caused by digital-to-analog conversion of PC sound cards, and to ensure the restoration of original sound quality.

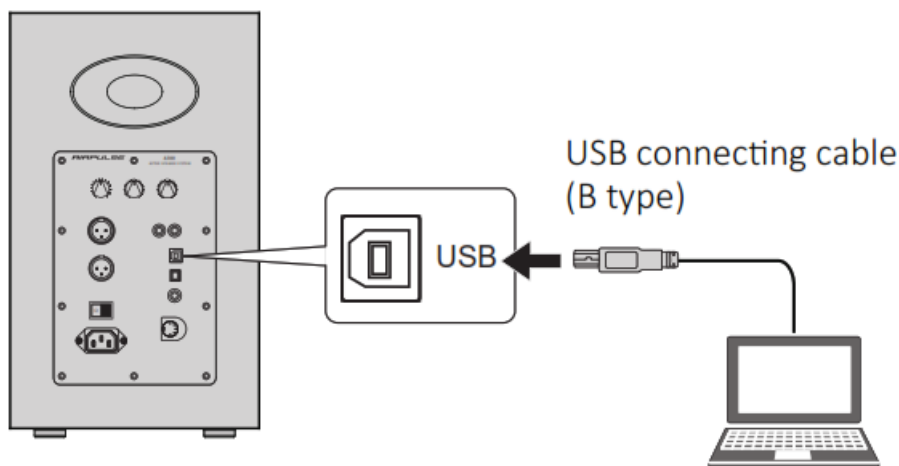

* PCM audio signals (44.1KHz/48KHz/96KHz/192KHz) only functions in USB mode.

* If connecting the speakers to a PC, the driver program must be installed first for the system to perform properly.

* USB driver in Mac operating system supports USB Audio Class 1 and Class 2 audio transmission by default, therefore driver program installation is not needed.

Install the special driver program (only for Windows)

Please install the special driver program on the PC before connecting the PC to this product.

1. Download and extract the special driver program “A300 USB Driver” in the following website:

<http://www.airpulseaudio.com/en/product/a300>

2. Install the driver program “A300 USB Driver” on the PC.

Please refer to the download page or the following link for driver program details:

<https://www.xmos.com/support/usb-audio-driver-support>

3. After installation is complete, exit from all applications.

USB Input Mode

Connect Windows PC already installed with USB driver or Apple Mac to the speakers using a USB connecting cable. Connect PC to speakers

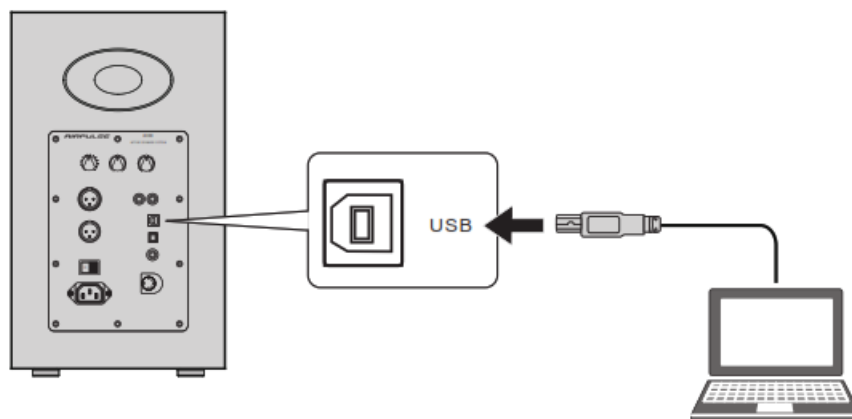

Set this product as the audio output device for the PC

1. Press the “USB” button on the remote control or press the “VOLUME / INPUT” button on the rear panel of the

active speaker to select USB input mode, LED indicator on the active speaker will display “USB”.

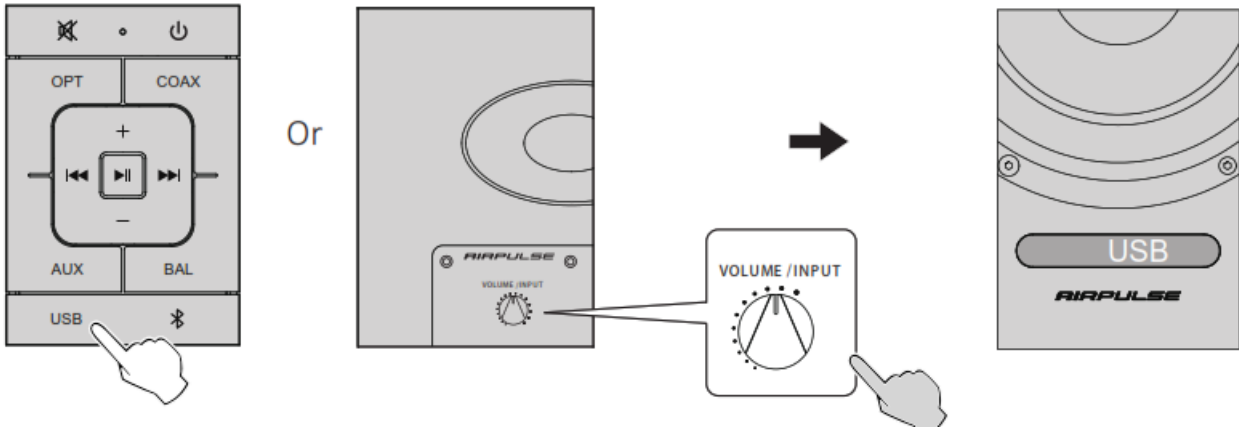

2. Set this product as the audio output device for PC

For Windows users, please open the “Control panel” → “Sound” → “Play” → “Set as Default” Tab to set “XMOS USB Audio” as the current audio output device.

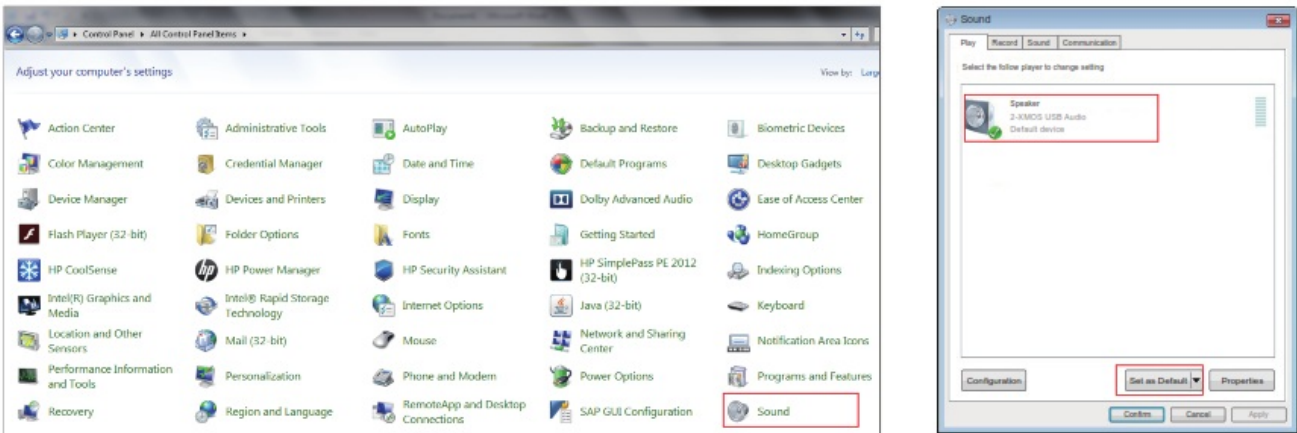

USB Input Mode

For Mac users, please open the “System Preferences” → “Sound” → “Output” Tab to select “AIRPULSE A300” as the current audio output device.

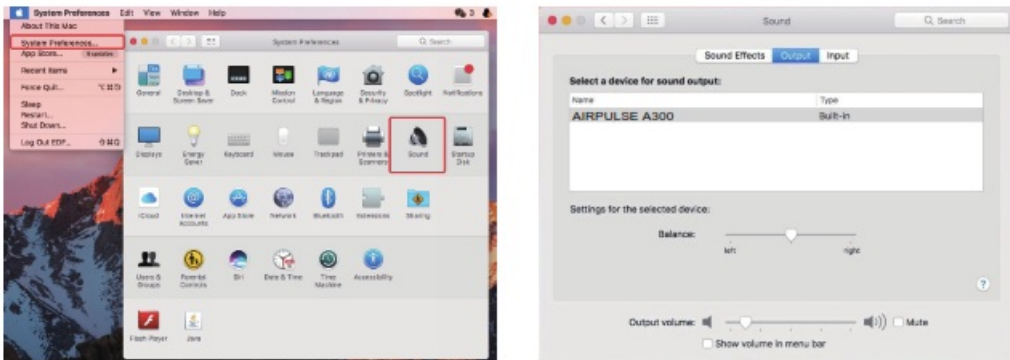

Play music on the PC

1. Play music on the connected device, press the “+/-” button on the remote control or press the “VOLUME / INPUT” button on the rear panel of the active speaker to adjust volume to the desired level.

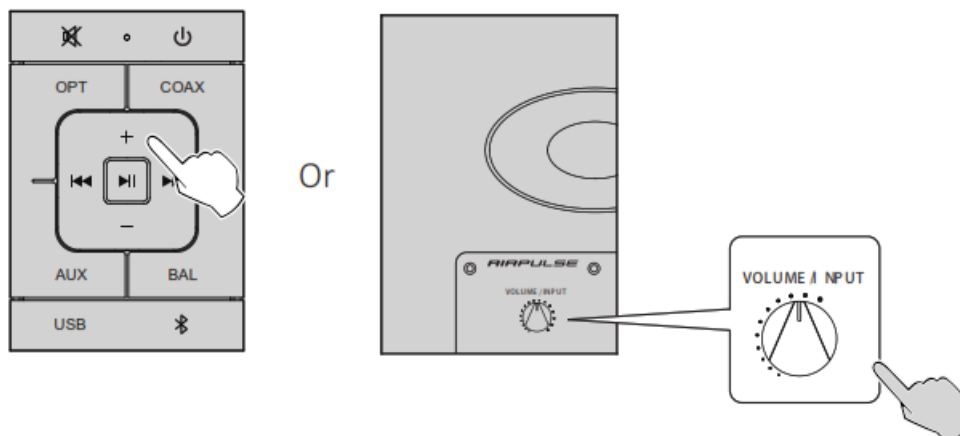

2. In USB mode, press the “◀◀/▶▶” button on the remote control to skip to the previous/next track, and press the “▶▶” button to pause/play songs.



* The play control under USB input belongs to USB HID control. This control needs the support of player software, so there may be compatibility differences for different audio player software.

* USB driver in Mac operating system supports USB Audio Class 1 and Class 2 audio transmission by default, therefore driver program installation is not needed.

* Windows 7/ windows 10 operating system have self USB driver, only support USB Audio Class 1 type USB audio transmission (only support 2 channel audio signal, the highest sampling rate is 96KHz), The USB connecting chip of A300 uses USB Audio Class 2 type audio transmission to support 192KHz audio signal, so for Windows 7/ windows 10 operating system users, using the A300 speaker needs to download the special driver program.

* When USB input is disconnected or in other modes, please reset on the PC to re-select USB input. Please see “Set this device as the audio output device of PC” for details

* As Microsoft Company had stopped maintaining the XP system, we can't provide the driver program with Microsoft digital signed.

* If you need to buy USB A type to B type connecting cable, you can search and buy it on the various e-commerce platforms.

Optical or coaxial Input Mode

1. Connect this product to an audio source device with an optical or coaxial digital output port using fiber optic input audio cable or coaxial cable.

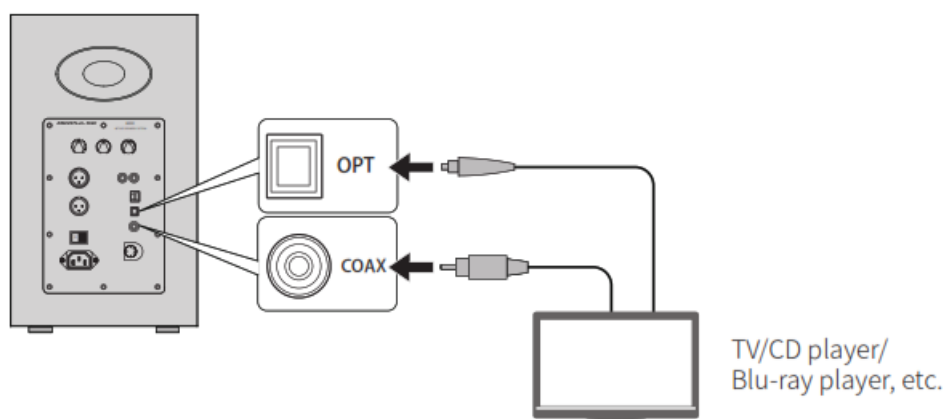

2. Press the “OPT” or “COAX” button on the remote control or press the “VOLUME / INPUT” button on the rear

panel of the active speaker to select optical or coaxial input mode, LED indicator on the active speaker will display “OPT” or “COAX”.

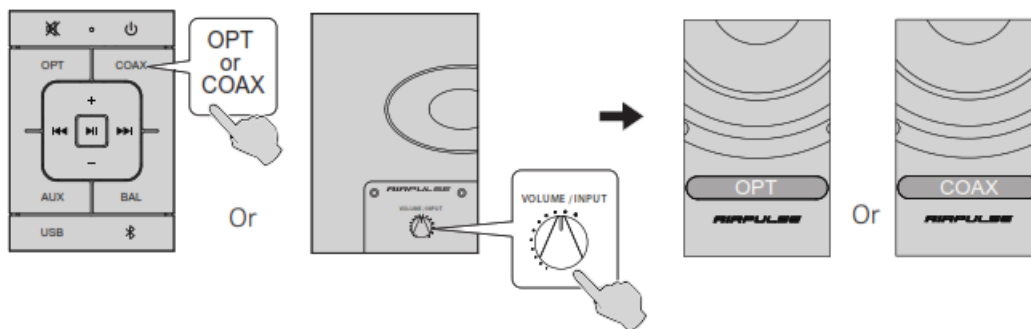

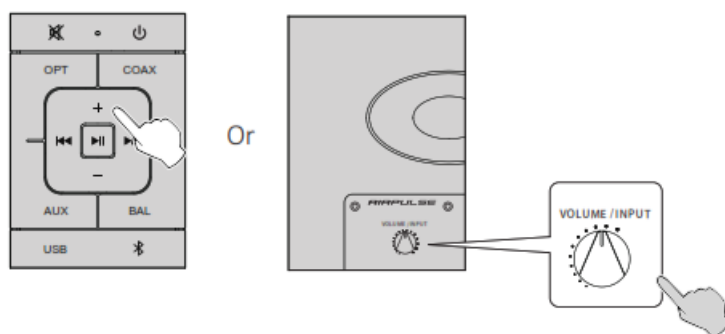

3. Play music on the connected device, press the “+/-” button on the remote control or press the “VOLUME / INPUT” button on the rear panel of the active speaker to adjust the volume to the desired level.



* Only the standard PCM audio signals (44.1KHz/48KHz/96KHz/192KHz) function in optical or coaxial mode.

* If the optical digital output of the playing device is ACC, such as on a TV, please switch it to PCM.

Bluetooth Input Mode

1. Press the *  button on the remote control or press the “VOLUME / INPUT” button on the rear panel of the active speaker to select Bluetooth input mode, LED indicator on the active speaker will display “

The diagram illustrates two ways to select Bluetooth input mode. On the left, a front panel view shows buttons for OPT, COAX, AUX, BAL, and USB. A hand is shown pressing the Bluetooth button. An arrow points to the right, where a rear panel view shows a hand pressing the 'VOLUME / INPUT' button. A final arrow points to a speaker with the Bluetooth symbol displayed on its LED indicator.

2. Set your Bluetooth device to search for and connect to “AIRPULSE A300”; pin code for connection is “0000” if needed.

Operations may be different between different devices, please refer to the operating instructions attached with the devices.

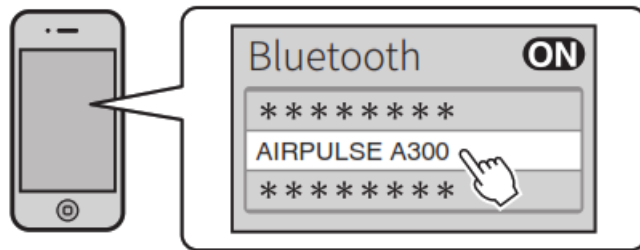

3. Play music on the connected Bluetooth device, press the “+/-” button on the remote control or press the “VOLUME / INPUT” button on the rear panel of the active speaker to adjust the volume to the desired level.

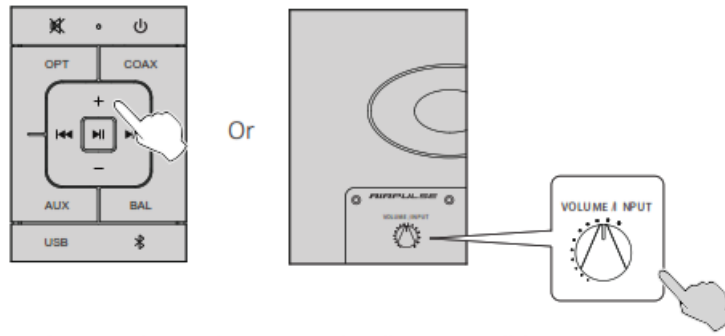

4. In Bluetooth mode, press the “◀▶” button on the remote control can skip to the previous/next track, and press the “⏸” button to pause/play songs.

* Effective Bluetooth connection distance is within 10 meters.

* The Bluetooth of A300 can only be searched and connected in Bluetooth input. The existing Bluetooth connection will be disconnected once the speaker is switched into other audio inputs. When switched to Bluetooth input, the speaker will try to connect to the Bluetooth device connected last time.

* To disconnect Bluetooth, press and hold the “” button on the remote control for above 2 seconds.

* To enjoy all Bluetooth functions please ensure your audio device has AZOP and AVRCP profiles.

* When connected to this product, Bluetooth connectivity and functions may be different between different Bluetooth devices, depending on the software settings of Bluetooth devices.

Specifications/Statement

Tweeter: Horn Loaded Ribbon Tweeter

Mid-Woofer: 6.5inch Aluminum Cone Underhung Design Neodymium Power Mid-Woofer

Amplifier System: Digital Amplifier with Xmas Processor

Power Output: L/R (Treble): 10W+10W,

L/R (Woofer): 70W+70W

Frequency Range: 40Hz-40KHz

Signal-Noise Ratio: L/R: 190dB(A)

Input Mode: AUX, Balance Input, USB, Optical, Coaxial, Bluetooth. The USB, Optical and Coaxial inputs support up to 192KHz input sample rate

Input Sensitivity: AUX: 700±50mV, Balance: 1150±50mV, USB: 550±50mFFs, Optical: 500±50mFFs Coaxial: 500±50mFFs, Bluetooth: 500±50mFFs

Mains Voltage: 100-240V AC 50/60Hz

Cabinet Size (WxHxD):

Net Weight: 225 x 385 x 340 (mm) 24 Kg (53 Pounds) / Set

NOTICE: For the need of technical improvement and system upgrade, the information contained herein may be subject to change from time to time without prior notice.



Qualcomm aptX is a product of Qualcomm Technologies, Inc. and/or its subsidiaries.

Qualcomm is a trademark of Qualcomm Incorporated, registered in the United States and other countries. aptX is a trademark of Qualcomm Technologies International, Ltd., registered in the United States and other countries.

Troubleshooting

Problem	Solution
No sound	•Check if the power indicator light is ON
	•Try to turn up the volume using either the master volume control or remote control.
	•Ensure the audio cables are firmly connected and the input is set correctly on the speakers.
	•Check if there is signal output from the audio source.
Cannot connect via Bluetooth	•Make sure the speaker is switched to Bluetooth input, in other audio input modes Bluetooth can not be paired or connected. Disconnect from any Bluetooth device by pressing and holding the volume dial in Bluetooth mode, and then try again.
	•Effective Bluetooth transmission range is 10 meters, please make sure operation is within the range.
	•Try another Bluetooth device for connection.
The A300 does not turn on	•Check if mains power is connected -or if the wall outlet is switched on.

If you want to find out more about AIRPULSE, please visit our website at

www.airpulseaudio.com

Dongguan Platinum Audio Systems Co., LTD

No. 2 East Industry Road, Songshan Lake National High-tech Industrial Development Zone, Dongguan 523808

China www.airpulseaudio.com Printed in China

Documents / Resources

	AIRPULSE A300 Active Speaker System [pdf] User Manual EDF171, Z9G-EDF171, Z9GEDF171, A300 Active Speaker System, Active Speaker System
---	---

References

- [Home - Airpulse](#)
- [A300 - Airpulse](#)
- [X USB Audio Driver Support | XMOS](#)