

AIPER SG 800B Cordless Robotic Pool Cleaner



AIPER SG 800B Cordless Robotic Pool Cleaner User Manual

[Home](#) » [AIPER](#) » AIPER SG 800B Cordless Robotic Pool Cleaner User Manual 

Contents

- [1 AIPER SG 800B Cordless Robotic Pool Cleaner](#)
- [2 Instructions](#)
- [3 FCC Statement](#)
- [4 Introduction](#)
- [5 Using Your Device](#)
- [6 Maintenance](#)
- [7 STORAGE](#)
- [8 Warranty](#)
- [9 Documents / Resources](#)
 - [9.1 References](#)

AIPER

AIPER SG 800B Cordless Robotic Pool Cleaner



Thank you for choosing Aiper. You've now joined a family of millions who have already put their trust in Aiper to take care of their pools and are enjoying the convenience of a pristinely clean pool. This user manual will help you maintain your Aiper pool cleaner and ensure it performs at its maximum efficiency for years to come.

Please take a few minutes to read through this manual. If you have any questions, please visit our website at www.Aiper.com and contact our customer service team for assistance or more information.

Aiper Customer Service:

US Toll-Free: 1-866-850-0666

Email: Service01@Aiper.com

Facebook: AiperOfficial



Scan for
Video Guide

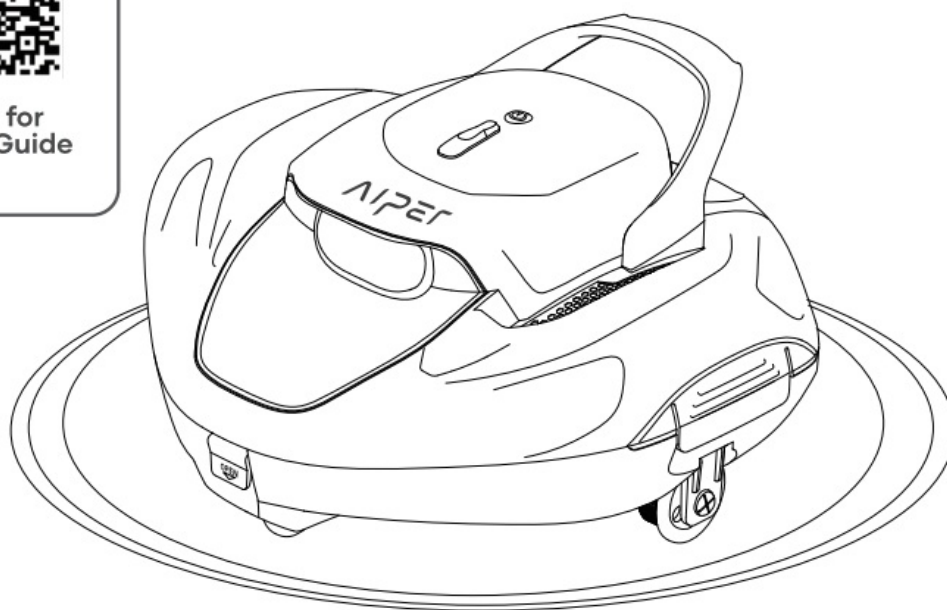

Important Safety Precautions

Read this manual carefully and use your device according to the instructions. Aiper is not liable for any damages or injuries caused by improper use.

Instructions

1. Do not operate the device when people or animals are in the pool.
2. Ensure the device is turned off when conducting maintenance, cleaning, or when not in use.
3. Do not allow children to ride the device or play operate it without adult supervision.
4. Only use the original, authorized power adapter.
5. The adapter cord should only be replaced by a qualified electrician.
6. It is strongly recommended to connect the charger to a surge protector when charging.
7. Ensure the charging port is completely dry before charging your device.
8. While charging, the device should be kept in a cool, well-ventilated place. Customers should not over the device while charging as this may lead to overheating or hardware malfunctions.
9. Do not operate the device out of the water, as this may lead to hardware malfunctions or overheating.
10. Only certified professionals should disassemble the (driving kit) of the device.
11. Do not operate the device while running your pool filter.
12. Avoid puncturing the oil sealing of the motor, as this contains grease. If punctured, this may cause a small grease leakage into your pool.
13. Do not store or use the device near anything that generates extreme heat.
14. Do not pierce or bludgeon the device's shell, as this will cause irreparable damage. Additionally, the device should not be thrown.

FCC Statement

NOTE: This equipment has been tested and found to comply with the limits for a Class B digital device, under Part 15 of the FCC Rules. These limits are designed to provide reasonable protection against harmful interference in a residential installation. This equipment generated uses and can radiate radio frequency energy and, if not installed and used by the instructions, may cause harmful reference to radio communications. However, there is no guarantee that

interference will not occur in a particular installation. If this equipment does cause harmful interference to radio or television reception, which can be determined by turning the equipment off and on, the user is encouraged to try to correct the interference by one or more of the following measures:

- Reorient or relocate the receiving antenna.
- Increase the separation between the equipment and the receiver.
- Connect the equipment to an outlet on a circuit different from that to which the receiver is connected.
- Consult the dealer or an experienced radio/TV technician for help.

Please note that changes or modifications to this product are not expressly approved by the party responsible for compliance (Aiper) and could void the user's authority to operate the equipment.

Compliance Declaration

This device complies with Part 15 of the FCC Rules. Operation is sub-get to the following two conditions: (1) this device may not cause harmful interference, and (2) this device must accept any interference- once received, including interference that may cause undesired operation.

Importer: Aiper Intelligent, LLC.

Address: Suite 350, 2700 Cumberland Parkway, Atlanta, Georgia 30339 Telephone: +1 866-850-0666

Introduction

The environmentally friendly Aiper Seagull 800B is a rechargeable device that cleans and filters your pool's water without needing to replace it.

Please read this user manual carefully before using it.

Structure

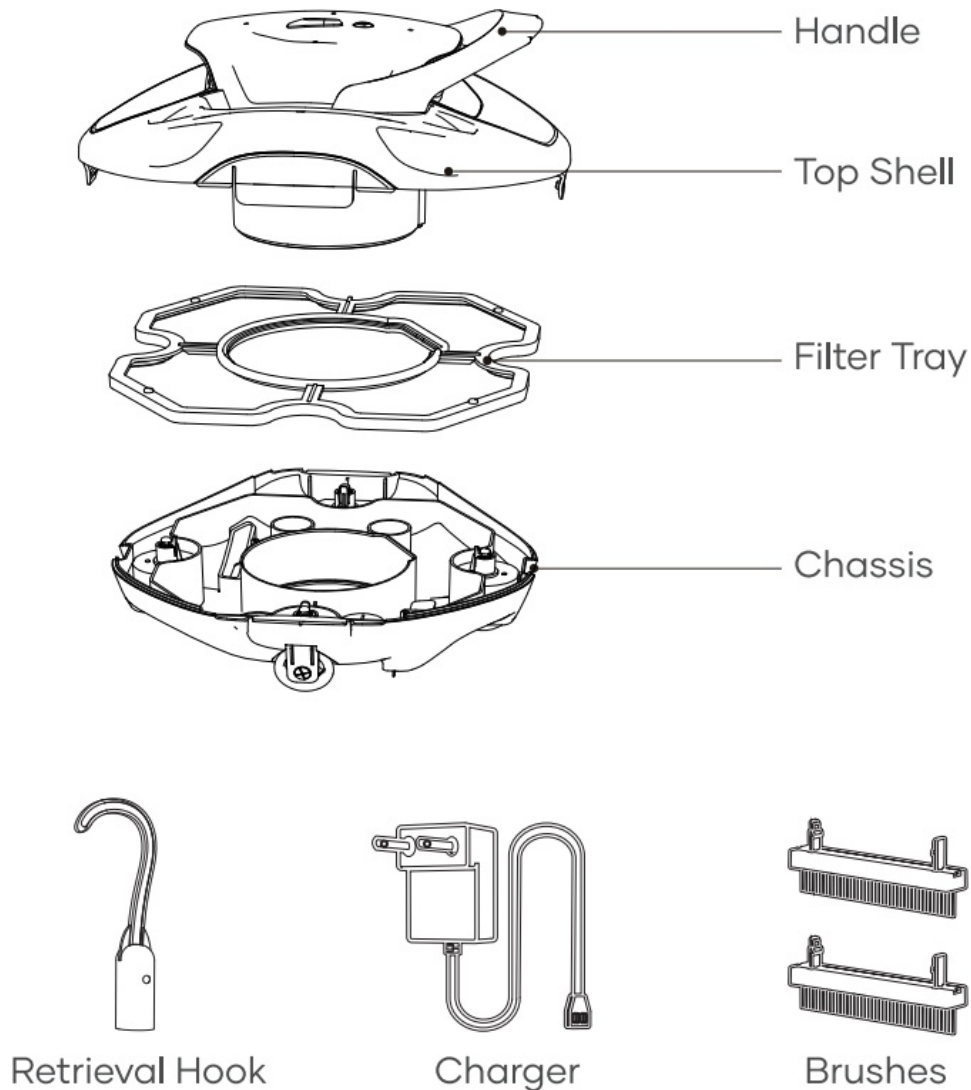

Specifications & Working Conditions

1. Pool Size: 850sq.ft/80m², Compatible with Flat Floor Pools
2. Charger Input: 100~240V, 50/60Hz
3. Charger Output: 12.6V/1.8A
4. Charging Time: 2.5 Hours
5. Battery Life: Up to 90 Minutes
6. IP Grade: IPX8 Waterproof
7. Max Water Depth: 10ft (3m)

Precautions

For optimal performance, Aiper recommends using your device in the following water conditions.

- Temperature: 50–95°F (10–35°C)
- pH Value: 7.0–7.4
- Chlorine: Maximum 4 ppm
- NaCl: Maximum 5000 ppm

Using Your Device

Important Precautions

- This model is compatible with flat-floored pools up to 850sq.ft/80m'.

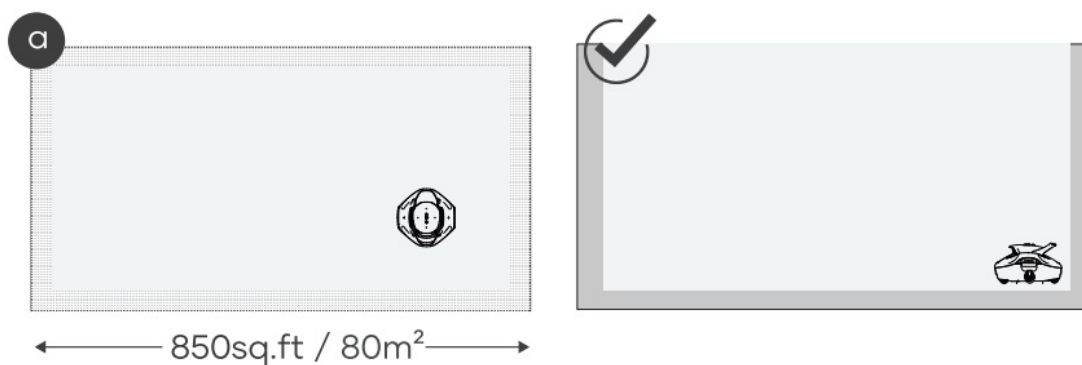

- Attach the two included brushes to the bottom of the device by inserting each brush into an available slot and pressing firmly until you hear a clicking sound.

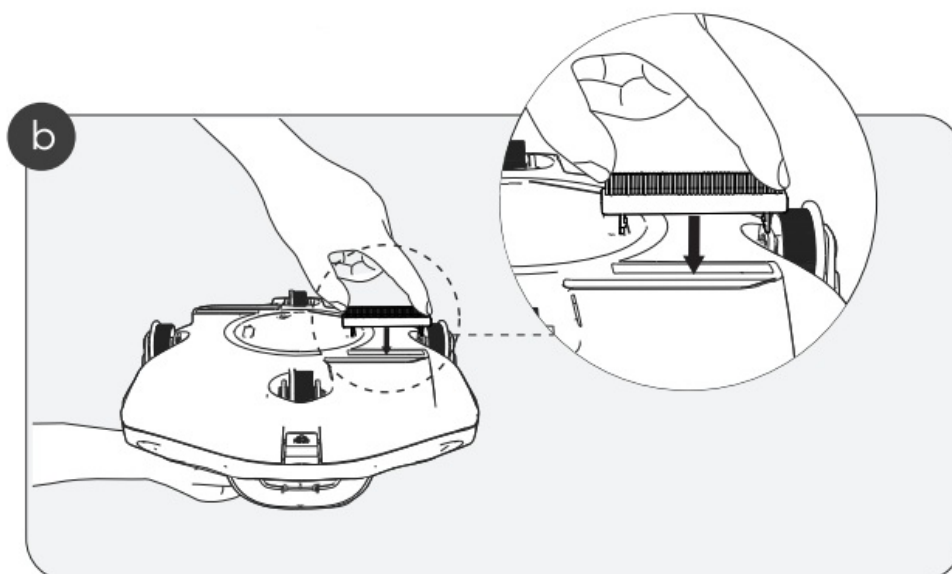

- Customers should place/remove the device into/from the pool with the bottom of the device facing the wall to avoid damaging or scratching the shell of the device or your pool's wall.

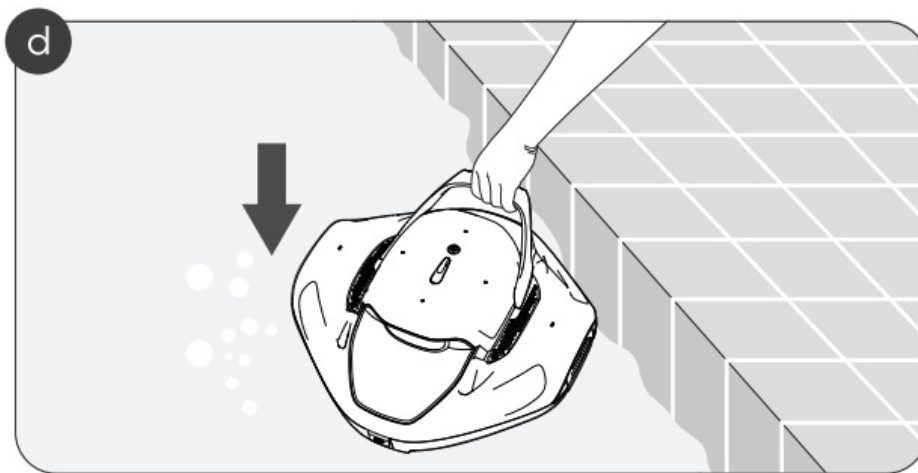

- Power off the device after each use.

Charging

- Fully charge the device before each use.

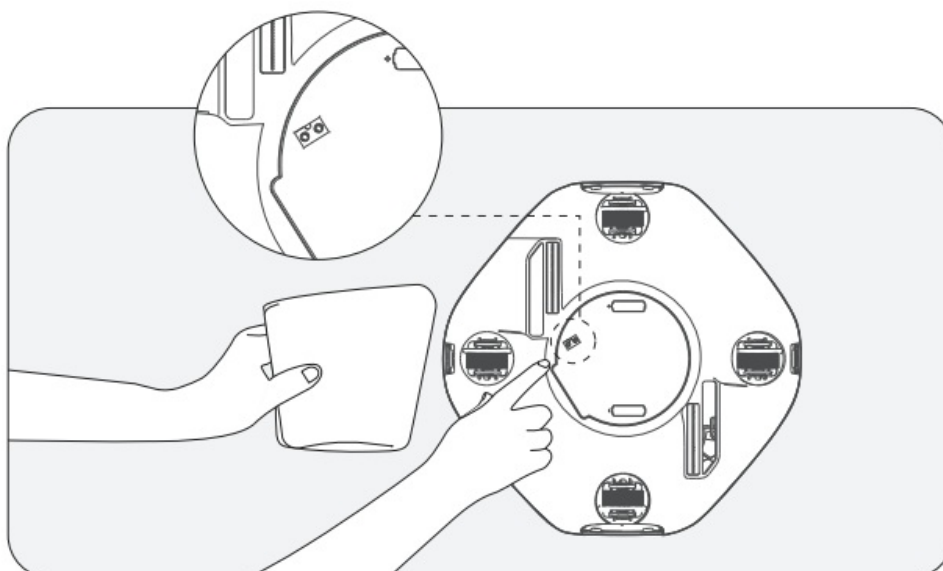

- Power off the device before charging.
- Dry the charging port before charging.
- When charging, do not leave the machine upside down.

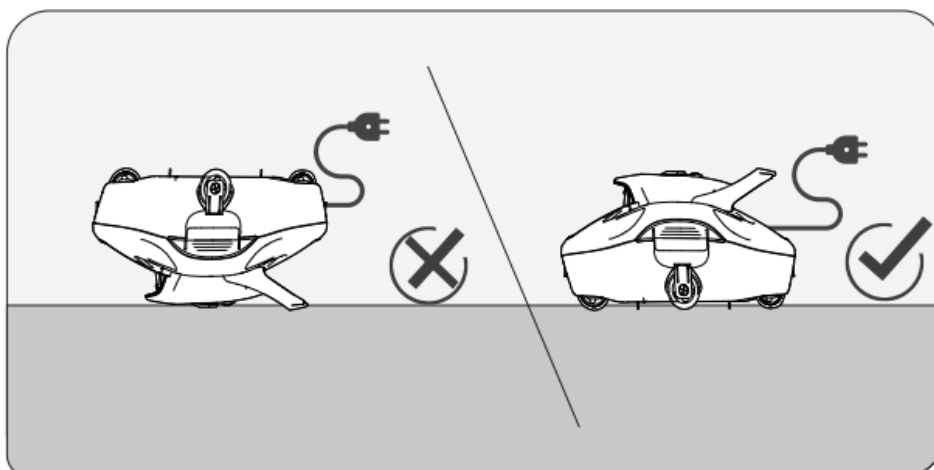

- Battery Charging: The LED indicator will produce a blue flashing light.
- Battery Fully Charged: The LED indicator will produce a solid blue light.

Operating the Device

- A. Press and hold the power button until the blue light turns and stays on, and you hear a beeping sound. Place the device into the water within 30 seconds of turning it on.
- The device will begin working within seconds of reaching your pool's floor.

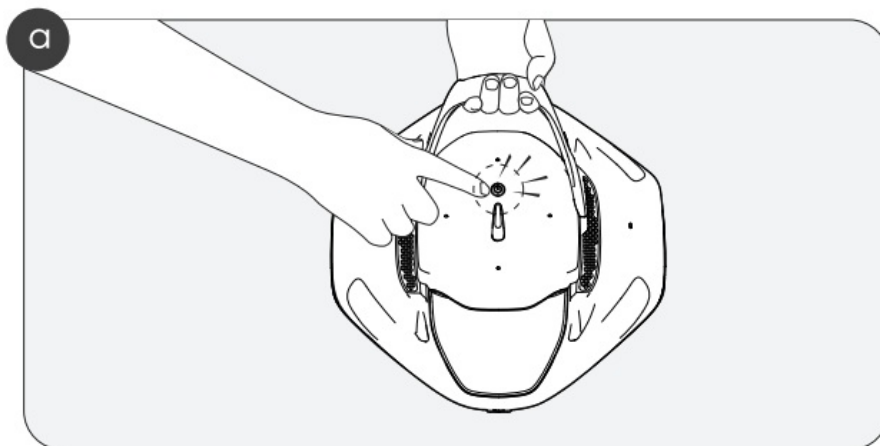

- When the battery is low, the LED indicator will produce a slow flashing red light before stopping near your pool's wall.

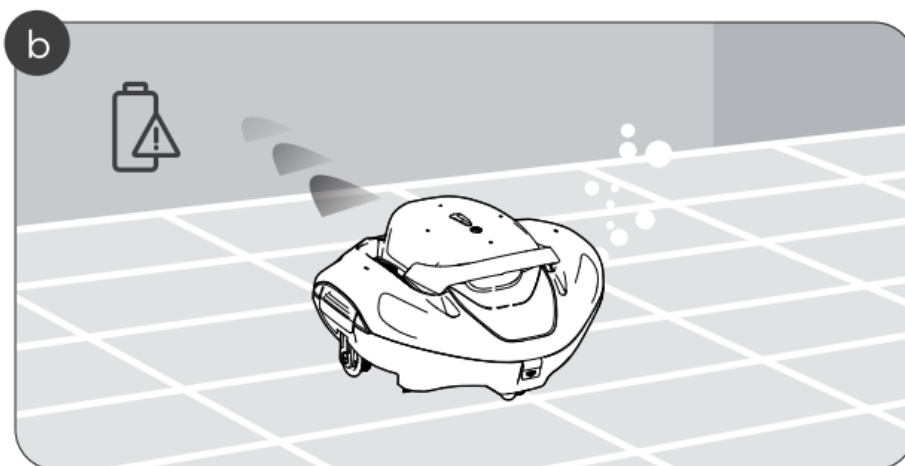

- The light will flash for 60 seconds before the device powers off.

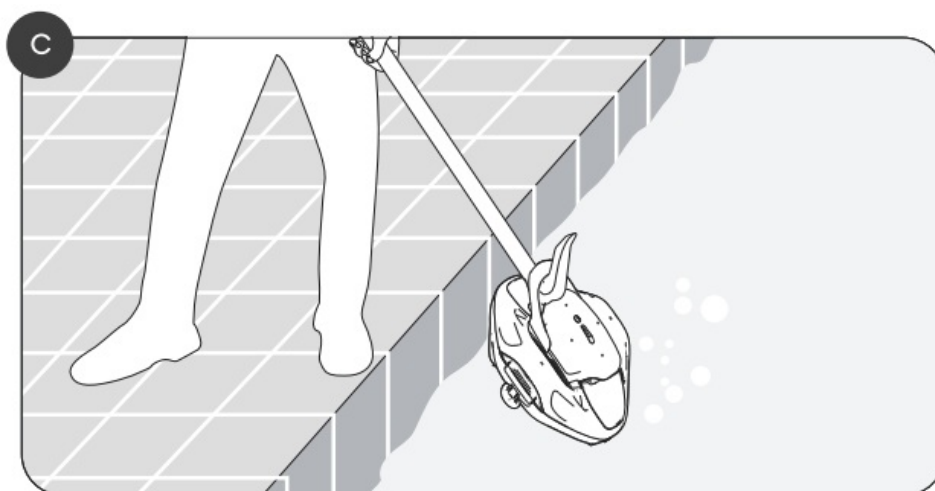

- Attach the included hook onto your pool pole and lift the device out of the water.

Clean the Filter Tray

- Lift the two smaller buckles on the front and back of the device, then one of the two buckles at the side of the

device.

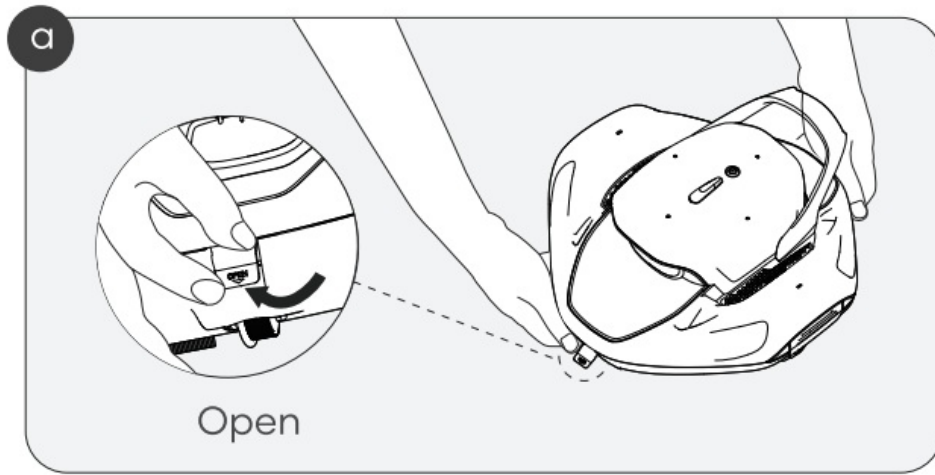

- Remove the top shell of the device to access and remove the filter tray.

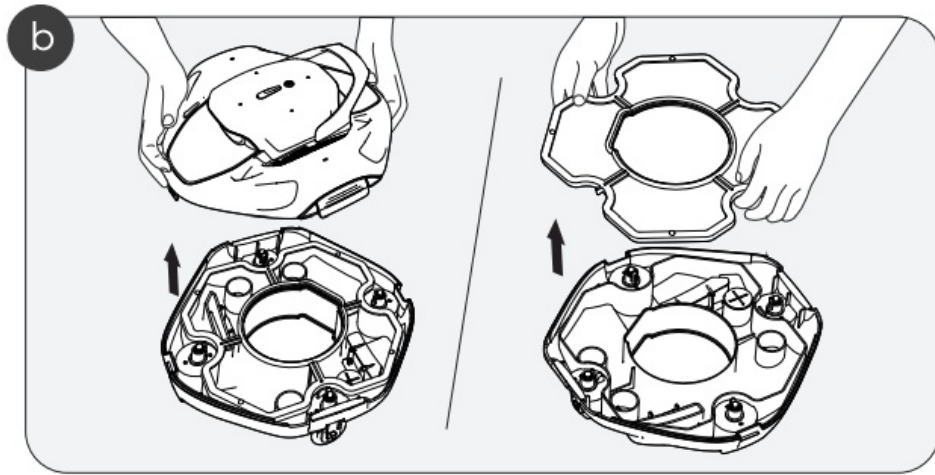

- Empty the filter tray from and bottom shell of any dirt and debris before washing both with water.

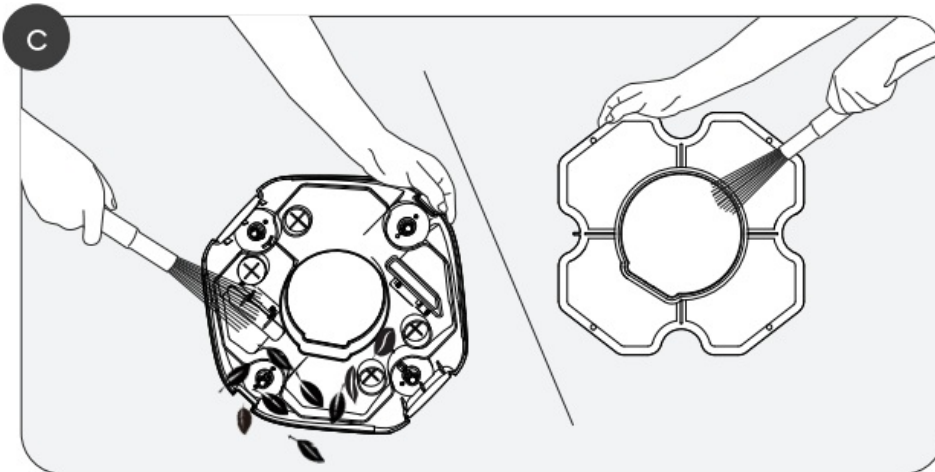

- After cleaning is complete, replace the filter tray and top shell with their positions and secure the shell by locking all the buckles on the outer shell.

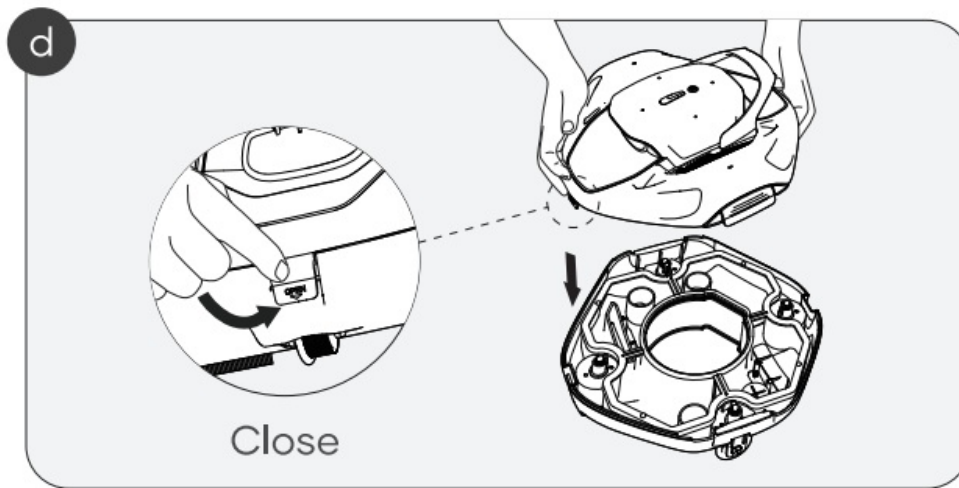

Maintenance

- Always wash the filter tray immediately after use.

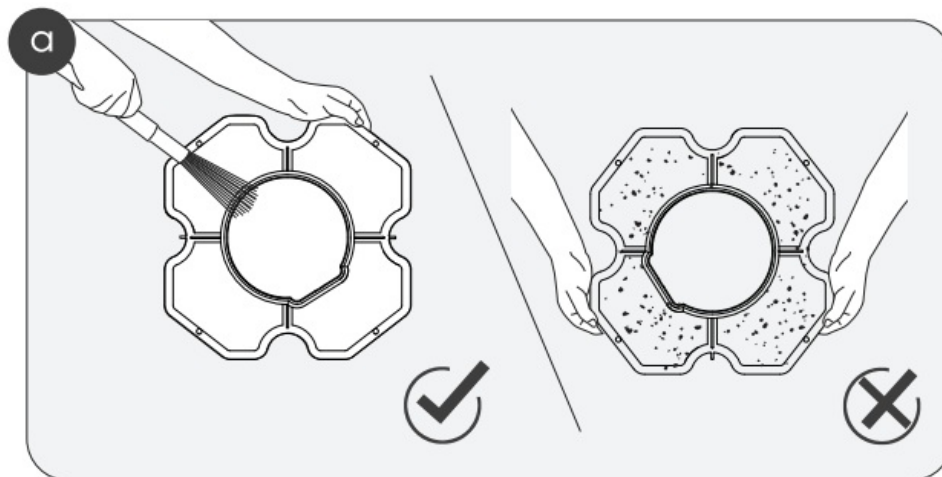

- If left uncleaned, debris may harden and block or damage the filter tray causing cleaning to become more difficult later.
- Brush Replacement.
 1. Remove the top shell of the device to expose the brushes.

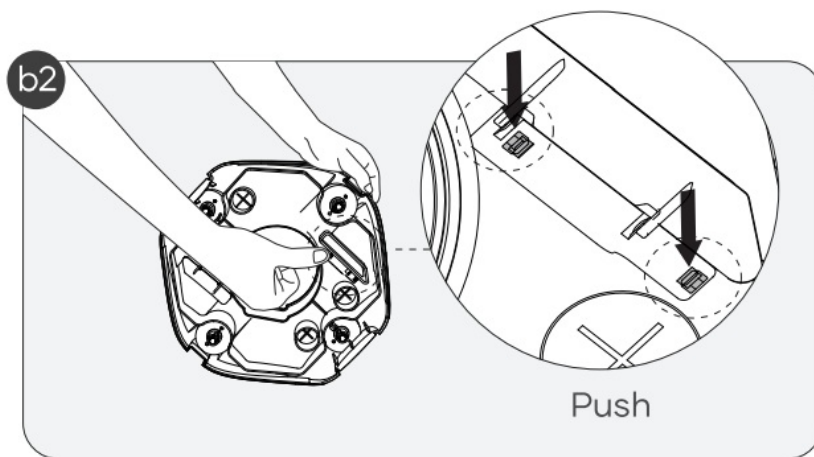
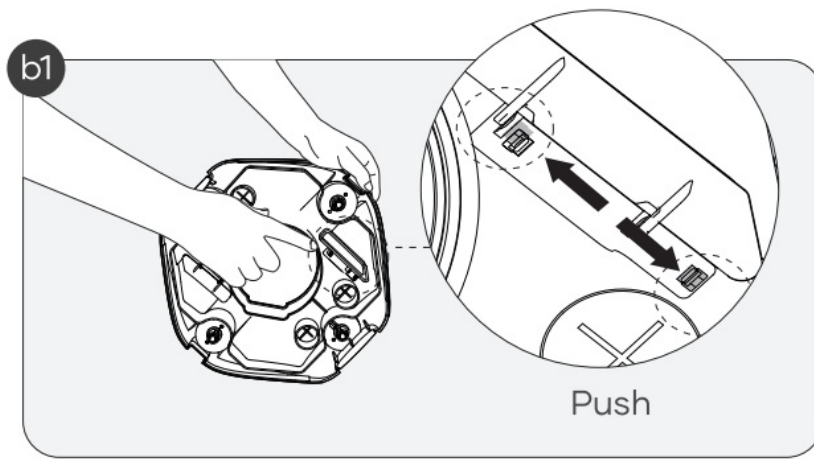

2. Using your fingers or a small tool, press the two small locking bars according to the image below.

Wheel Replacement

1. Remove the top shell of the device to expose the wheels.

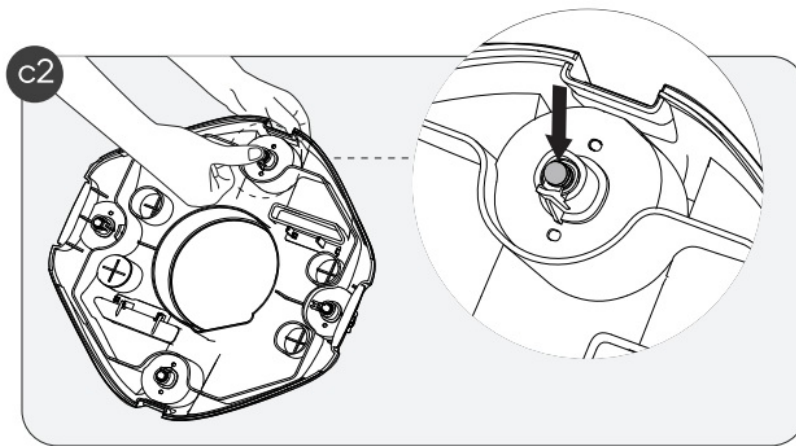
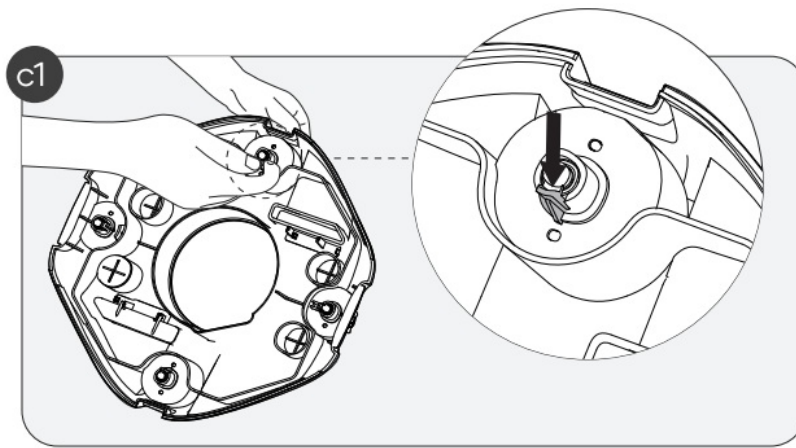

2. Use a finger or small tool to push the wheel's buckle till it bends and then push down to pop the wheel out.
3. Insert the spare wheel from the bottom of the device by aligning it with the two small holes on the wheelbase, and twist or press if necessary until you hear a clicking sound.

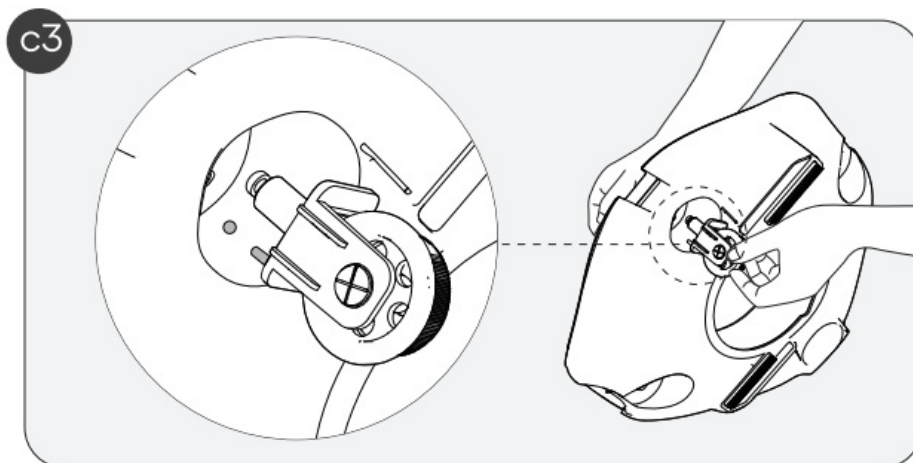

4. The wheel should now be locked into place.

STORAGE

The device should be stored in a cool, well-ventilated place away from direct sunlight. If the device needs to be stored for a long period, Aiper recommends charging it every three months to maintain battery health. Remember to use only the original, authorized power adapter. If the device is not charged routinely, this may affect battery voltage and cause a risk of an electrical discharge, which may be fatal.

LED Indicator

NO.	Working Status	LED Indicator
1	Power ON/Battery Level	Solid Blue Light/Blue Numbers
2	Power OFF	No Lights
3	Turned On (Cleaning)	Solid White Light
4	Charging	Slow Flashing Blue Light
5	Fully Charged	Solid Blue Light
6	Low Battery	Slow Flashing Red Light
7	Rotor Blocked	Red and Green Flashing Lights
8	Water Flooding	Red and Blue Flashing Lights
9	Power Failure	Rapid Blue lights

Packing List

NO.	Name	Model	QTY(pc)
1	Cleaner	Aiper Seagull 800B	1
2	Charger		1
3	Retrieval Hook		1
4	User Manual		1
5	Brushes		2
6	Spare Wheels		2

Warranty

This product has passed all quality control and safety tests, conducted by the technical department of the factory.

1. This product comes with a warranty that covers your item's battery and motor from the date of purchase. The respective country's legal provisions for warranty conditions shall apply accordingly.
2. This warranty is voided if the product has been altered, misused, or has been repaired by unauthorized personnel.
3. The warranty extends only to manufacturing defects and does not cover any damage resulting from the

- mishandling of the product by the owner.
- 4. The order number or record must be presented for any claim or repair during the warranty period.
 - 5. This is an additional warranty offered by Aiper Intelligent, LLC. at Suite 350, 2700 Cumberland Parkway, Atlanta, Georgia 30339,

The USA. This warranty does not affect the free-of-charge remedies for lack of conformity that the consumer holds against the seller, according to law.

Warranty Email: Service01@Aiper.com

Documents / Resources

	<p>AIPER SG 800B Cordless Robotic Pool Cleaner [pdf] User Manual</p> <p>SG 800B Cordless Robotic Pool Cleaner, SG 800B, Cordless Robotic Pool Cleaner, Robotic Pool Cleaner, Pool Cleaner, Cleaner</p>
---	--

References

- [User Manual](#)

[Manuals+](#), [Privacy Policy](#)

This website is an independent publication and is neither affiliated with nor endorsed by any of the trademark owners. The "Bluetooth®" word mark and logos are registered trademarks owned by Bluetooth SIG, Inc. The "Wi-Fi®" word mark and logos are registered trademarks owned by the Wi-Fi Alliance. Any use of these marks on this website does not imply any affiliation with or endorsement.