



aidapt VR231 Lenham Mobile Commode Adjustable Mobile Instruction Manual

[Home](#) » [Aidapt](#) » aidapt VR231 Lenham Mobile Commode Adjustable Mobile Instruction Manual 

Contents

- 1 aidapt VR231 Lenham Mobile Commode Adjustable Mobile
- 2 INTRODUCTION
- 3 BEFORE USE
- 4 ASSEMBLY
- 5 FOOTRESTS (IF REQUIRED)
- 6 USE OF THE COMMODO
- 7 HEIGHT ADJUSTMENT
- 8 COMMODO BUCKET
- 9 CLEANING
- 10 REISSUE
- 11 CARE & MAINTENANCE
- 12 IMPORTANT INFORMATION
- 13 Documents / Resources
- 14 Related Posts



aidapt VR231 Lenham Mobile Commode Adjustable Mobile



Fixing and Maintenance Instructions

This file is available to view and download as a PDF at www.aidapt.co.uk. Sight impaired customers can use a free PDF Reader (such as adobe.com/reader) to zoom in and increase the text size for improved readability.

INTRODUCTION

Thank you for deciding to purchase the Lenham Mobile Commode from Aidapt. The Lenham Mobile Commode is manufactured from the finest materials and components available, when used correctly it is designed to give many years of reliable trouble-free service.

NB. This equipment must be installed by a competent person and a risk assessment may be needed as to the suitability of the chair for the particular user.

- **Weight Limit:** 165kg (26 stone)
- **Turning Circle** – 800mm diameter
- **Do not exceed the weight limit stated-** doing so could put the user at risk.

BEFORE USE

Carefully remove all packaging. Avoid using any knives or other sharp instruments as this may damage the surface of the product.

The commode is provided to you packed in cube form. Please examine all components for any visible damage before use. If you see any damage or suspect a fault, please contact your supplier immediately.

NB. In this case, please do not use your product as it may compromise your safety.

ASSEMBLY

The package contains the following components:

- The main frame with four brake castors attached
- White commode plastic aperture seat (attached to the main frame)
- Grey commode seat cover
- A pair of detachable arms
- Detachable back

Please read the following installation instructions carefully:

1. Remove all contents from the box
2. Place the assembled base on a level floor
3. At the rear of the commode you will see two black threaded wheel nuts; undo the wheel nuts so that the locking holes are clear
4. Place the two back legs into the locating holes on the back edge of the commode frame
5. Secure the back by turning the black lock nuts until you feel the nut biting against the back leg.
6. Do not over tighten
7. Do not use tools as it is only necessary to have the back secured finger tight
8. Place the two detachable arms into the four locating holes featured two each side of the commode

COMPOSITION

The frame is made from chromium-plated mild steel. You must not, under any circumstances, use any abrasive cleaners or cleaners which attack chromium plating.

FOOTRESTS (IF REQUIRED)

Footrests are supplied separately to the main commode. Please examine your footrests for any visible damage before use. If you see any damage or suspect a fault, please contact your supplier immediately.

In this case, please do not use your product as it may compromise your safety.

1. Remove the commode footrests from their packaging
2. You will see on each of the front legs of the commode main frame about 150 mm high from the castor 2 retaining lugs either side
3. Take the footrests and align the holes in the inverted 'U' section with the lugs and lower down into place.
4. Rotate the footrests towards the commode so that they clip into place.

WARNING

Footrests are only for use to support the feet e.g when moving the user over short distances. They should not be used to stand on while getting in or out of the commode as this may cause a tipping hazard. If the user, whilst sitting in the chair, has their feet in the footrests then they must remain upright as to lean forward with their feet in the footrests will cause a tipping hazard. Please note that the footrests can be easily folded away.

USE OF THE COMMODE

When moving always lift the commode by placing your hands on the tubular metal frame beneath the seat.

- Do not allow children or unauthorised persons to play with or use the commode.
- Do not rock back and forth or sideways when using the commode as this will cause excessive stress and possible damage and failure which may cause injury.
- Do not use the commode outside the home or on uneven surfaces (such as in the garden) as this will cause stress to the legs and possible damage which may cause injury. It is not intended as a wheelchair.
- Do not place fingers or foreign objects into any of the exposed tubular sections as this can lead to serious injury.
- When operating the brake mechanism, do not stamp on the lever as this may cause damage to the mechanism and possible failure.
- Not for use in the shower. Dry immediately if the Lenham becomes wet.

HEIGHT ADJUSTMENT

NB. Before attempting to adjust the height of your commode, always ensure that the commode pail is removed. To adjust the height of your Lenham, carefully lay the commode on its side. Remove all the e-clips and adjust all four legs equally to the desired height.

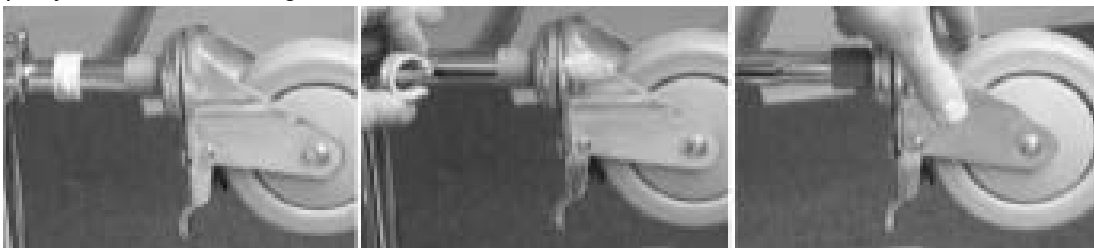

Re-insert the e-clips ensuring that each one passes through the frame and the correct hole in the extension leg.



Return the commode to the upright position and make sure that all wheels are sitting evenly on the floor.

NB. Never extend the legs in a manner that the commode is slanting, this will compromise the safety of the user.

COMMUNE BUCKET

To remove the commode bucket, simply slide the bucket out from the chrome runners at the rear of the commode. Cover the top of the bucket to avoid splashing, carefully dispose of the contents into a proper sluice or WC.

NB. Never use an open drain, sink or basin. This could cause a serious health risk.

Clean out the residue with a suitable disinfectant and refit to the commode after use.

CLEANING

A useful guide to decontamination is MHRA leaflet DB2003(06).

Do not use abrasive cleaners as this could damage the surface of the equipment. For cleaning, wipe with a clean cloth soaked in detergent solution and wring out. Depending on the detergent manufacturer's instructions the solution may be heated.

Wipe all surfaces of the equipment and the cloth should be re-immersed periodically and the detergent changed frequently. The detergent should be rinsed or wiped off using a clean cloth immersed in clean water and wrung out.

To disinfect make sure the equipment has been cleaned and dried and then wipe over with a clean cloth and a compatible liquid disinfectant. After disinfecting clean with clean water and dry.

When using detergent or disinfectants then please refer to manufacturers' instructions and if unsure then consult your local Infection Control Specialist for advice.

This equipment can be cleaned/disinfected by moist heat at 80°C for a minimum of 10 minutes or autoclaved at 80°C for at least 10 minutes. After cleaning or disinfecting dry and treat all joints with a water dispersing agent, e.g. WD40.

REISSUE

If you reissue or are about to reissue this product, please thoroughly check all components for their safety. This includes:

- PAT test for electrical items
- Tightness of all nuts/bolts/castors and other screw-in/bolt-in/push-in components
- Also check all upholstery for security, splits, etc.

If in any doubt, please do not issue or use, but immediately contact your supplier for service support. When reissuing, a risk assessment may be required as to the suitability of the chair for a particular user.

CARE & MAINTENANCE

Please make a safety check of the product at regular intervals or if you have any concerns.

IMPORTANT INFORMATION

The information given in this instruction booklet must not be taken as forming part of or establishing any contractual or other commitment by Aidapt Bathrooms Limited, Aidapt (Wales) Ltd or its agents or its subsidiaries and no warranty or representation concerning the information is given.

Please exercise common sense and do not take any unnecessary risks when using this product; as the user you must accept liability for safety when using the product.

Please do not hesitate to contact the person who issued this product to you or the manufacturer (detailed below) if you have any queries concerning the assembly/use of your product.

- Aidapt Bathrooms Ltd, Lancots Lane, Sutton Oak, St Helens, WA9 3EX
- Telephone: +44 (0) 1744 745 020

- Fax: +44 (0) 1744 745 001
- Web: www.aidapt.co.uk
- Email: accounts@aidapt.co.uk
- adaptations@aidapt.co.uk
- sales@aidapt.co.uk

Documents / Resources



Fixing and Maintenance Instructions

This file is available to view and download as a PDF at www.adapt.co.uk. Sight impaired customers can use a PDF Reader (such as adobe.com/reader) to zoom in or increase the text size for improved readability.

[aidapt VR231 Lenham Mobile Commode Adjustable Mobile](#) [pdf] Instruction Manual
VR231, Lenham Mobile Commode, Adjustable Mobile, VR231 Lenham Mobile Commode Adjust
table Mobile