



AI VIEW S201-0803F 4k Bullet Ai-Based Camera Installation Guide

[Home](#) » [AI VIEW](#) » AI VIEW S201-0803F 4k Bullet Ai-Based Camera Installation Guide 

Contents

- 1 AI VIEW S201-0803F 4k Bullet Ai-Based Camera
- 2 PRODUCT KIT
- 3 TECHNICAL SPECIFICATIONS
- 4 PRODUCT OVERVIEW
- 5 INSTALLATION GUIDE
- 6 GPS ANTENNA INSTALLATION
- 7 THE MEMORY CARD AND RESET INSTALLATION
- 8 ACCESSING THE CAMERA
 - 8.1 SOFTWARE INSTALLATION
- 9 SAFETY INFORMATION
- 10 WARRANTY INFORMATION
- 11 BKAV CORPORATION
- 12 Documents / Resources
 - 12.1 References
- 13 Related Posts



AI VIEW S201-0803F 4k Bullet Ai-Based Camera



Model: S201-0803F/S201-0802N

PRODUCT KIT

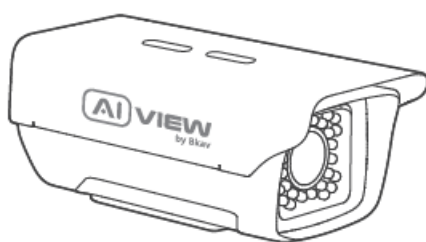

Camera

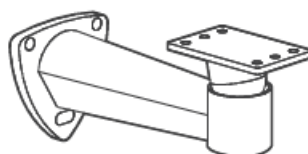

Wall bracket



Rubber pad



Installation guide



Thank you letter

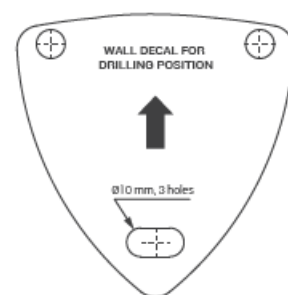

Drilling position decal

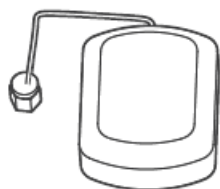

GPS antenna

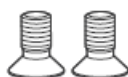

Hex socket head screws

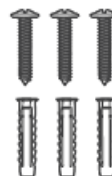
Set 3 of screws
and anchors

Hex tool



Waterproof couplings



Safety cable & screws

TECHNICAL SPECIFICATIONS

Power	PoE (IEEE802.3at/af)
Power consumption	PoE: Max 16W (no Heater)
	PoE: Max 27.5W (with Heater)
Protection standards	IP66, IK10
Resolution, frame rate	UHD 3840 x 2160, Max 60fps
Digital zoom	S201-0802N/S201-0803F : 8x
Optical zoom	S201-0803F: 3x
	S201-0802N: 2x
Focal length	S201-0803F: 10.9 - 29mm
	S201-0802N: 4.36 - 9.33mm
Field of view (horizontal - vertical)	S201-0803F: Near: 42° - 22.8° / Far: 15° - 8.4°
	S201-0802N: Near: 87.06° - 58.11° / Far: 41.62° - 26.53°
Micro SD card	External, up to 256GB
Operating temperature	-40°C - 60°C (-40°F - 140°F)
	Humidity 10 - 100%
Dimensions (L x W x H)	L340 x W157 x H130mm
Weight	3.35kg

PRODUCT OVERVIEW

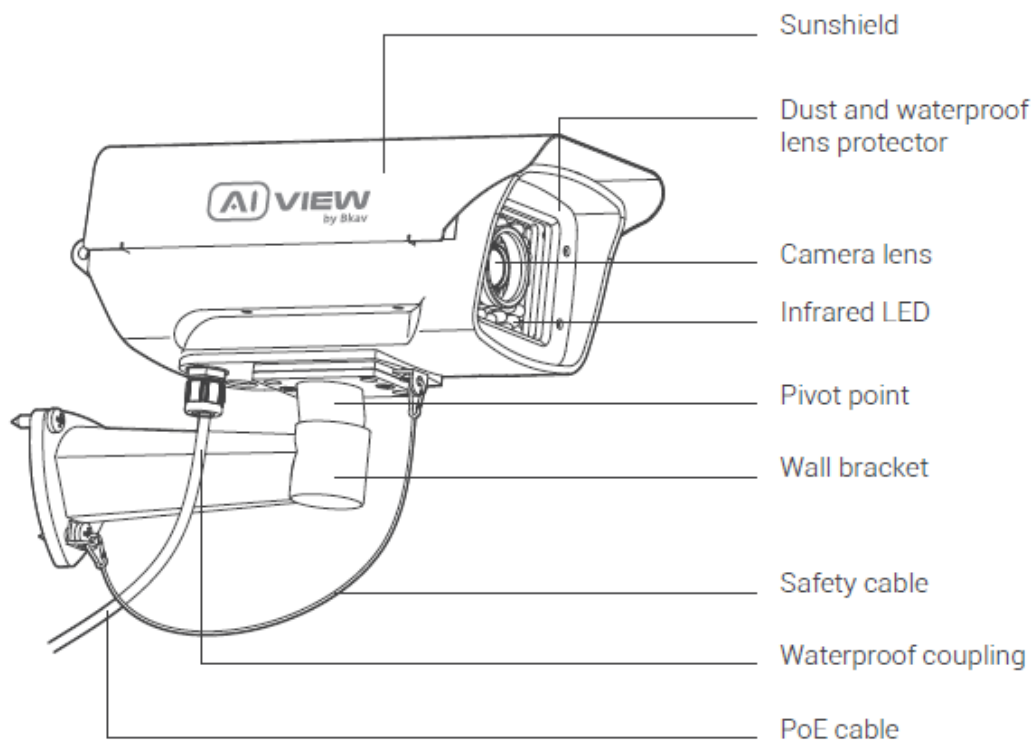

INSTALLATION GUIDE

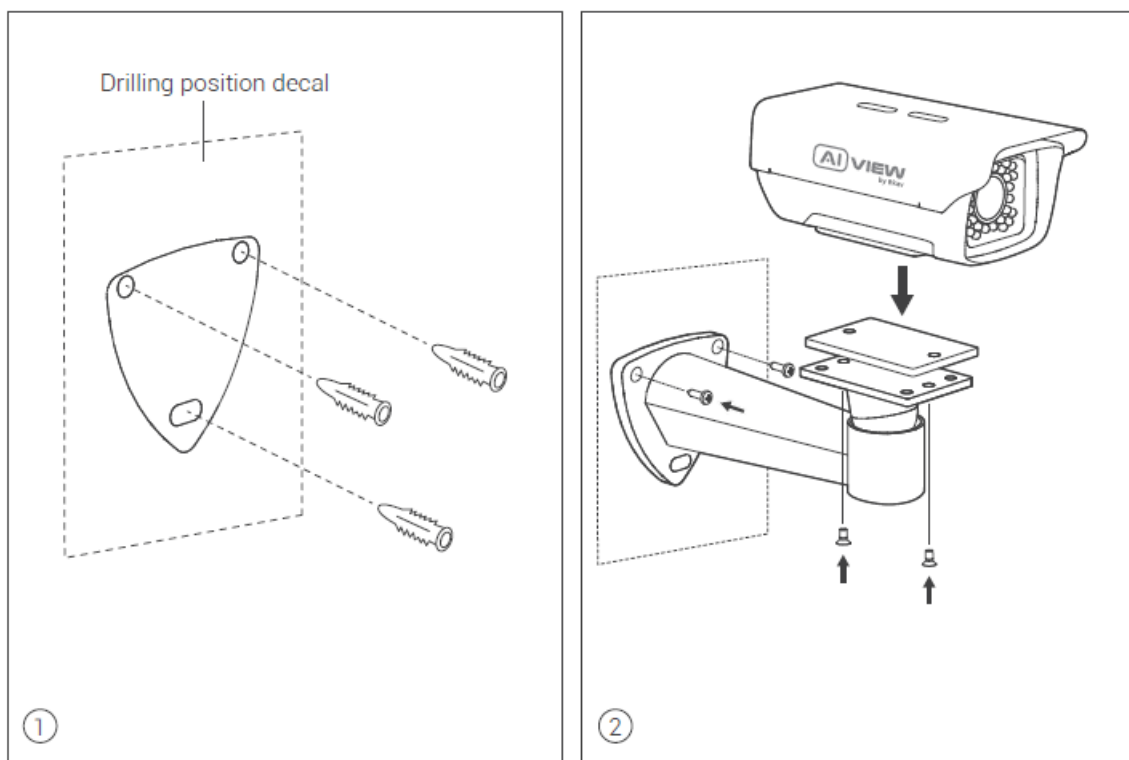

- **Step 1:** Fix the bracket onto the wall with the anchors and screws (Figure 1).
- **Step 2:** Fix the camera onto the bracket and screw it in the place (Figure 2).

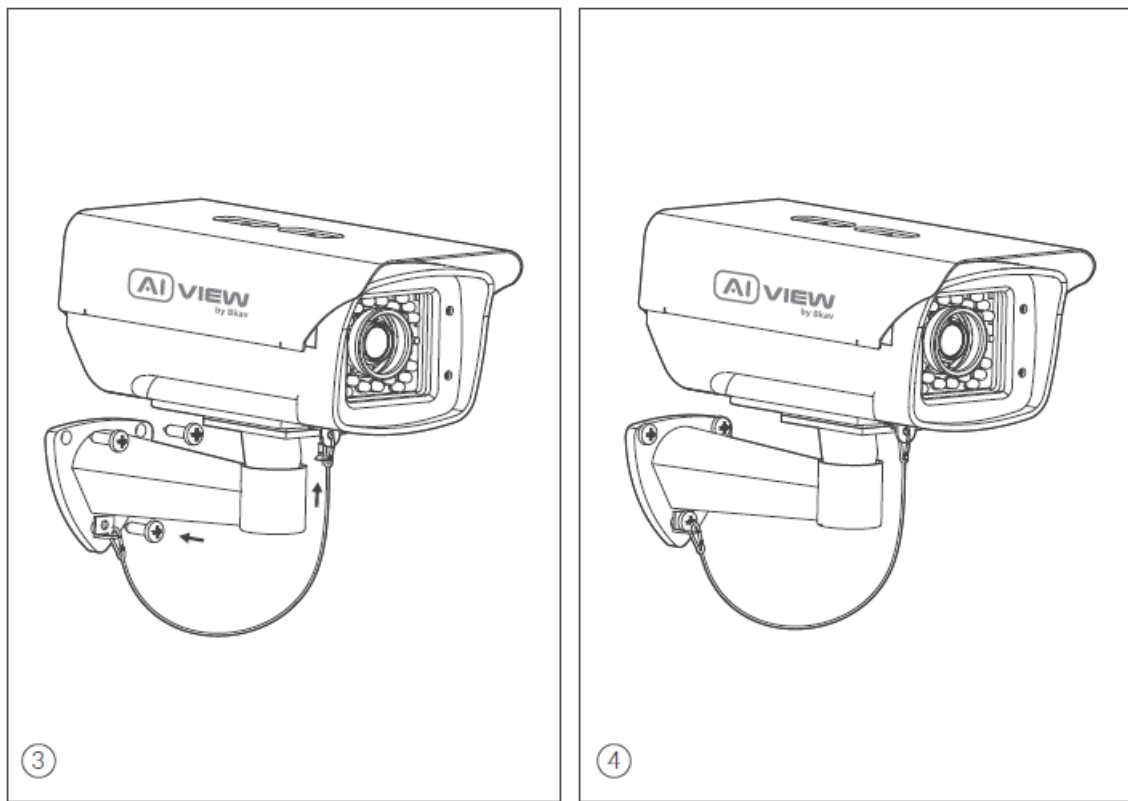

- **Step 3:** Insert safety cable onto bracket and camera (Figure 3).
- **Step 4:** Fix the safety cable with screw onto bracket and camera (Figure 4).

GPS ANTENNA INSTALLATION

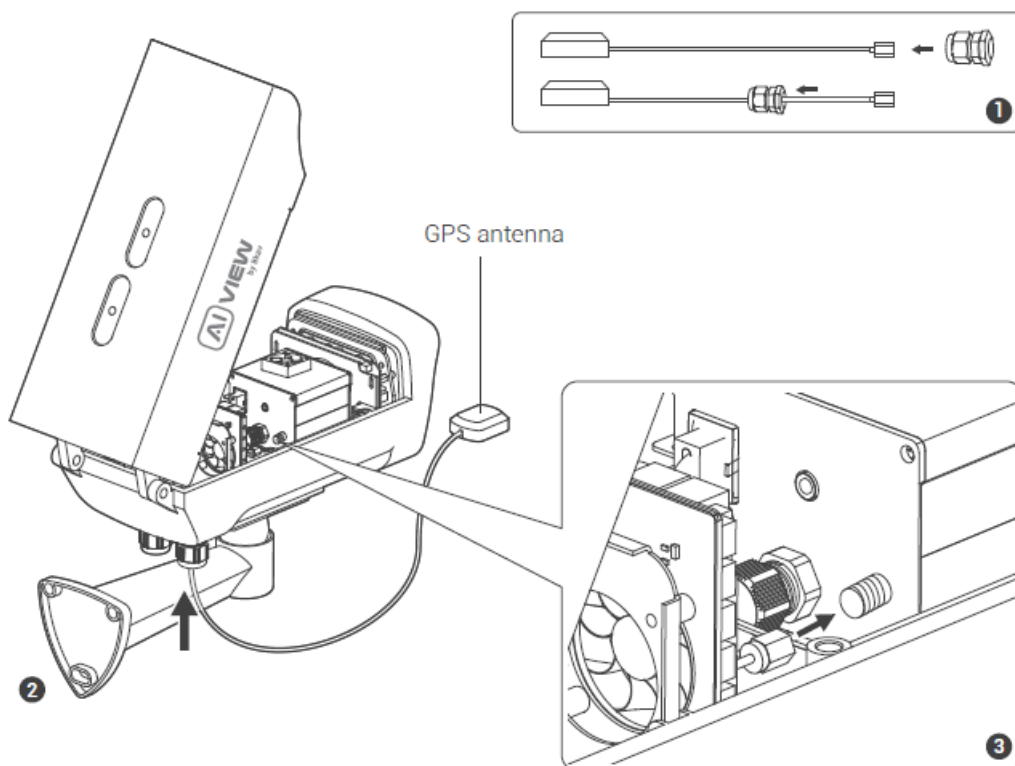

- Fix the GPS antenna onto the camera protective case using silicone glue, as in the figure below.

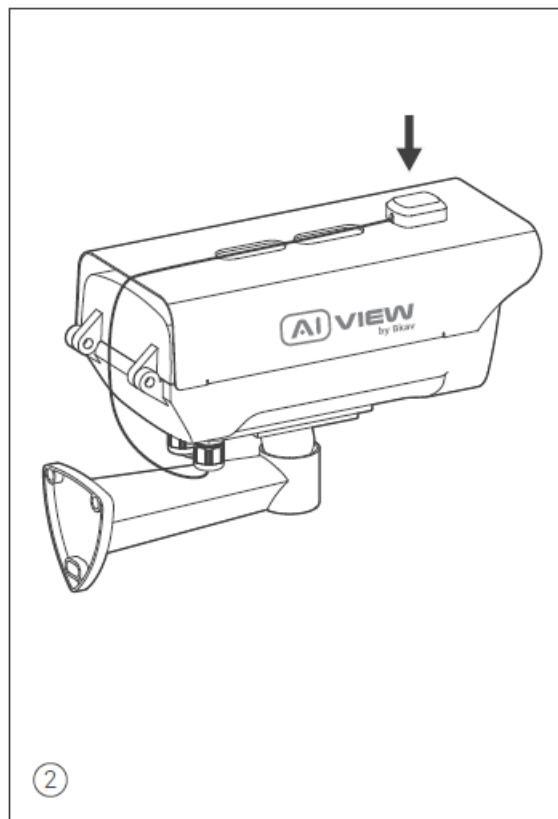
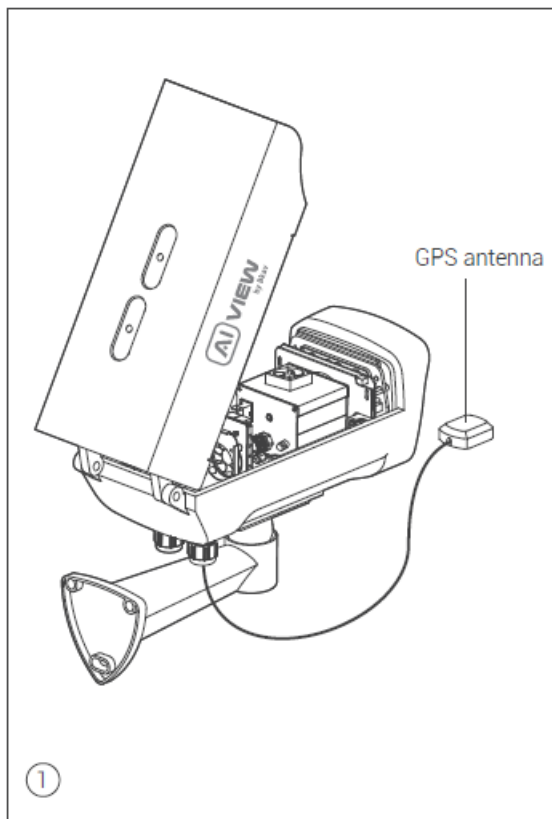

CONNECTING THE SIGNAL WIRE

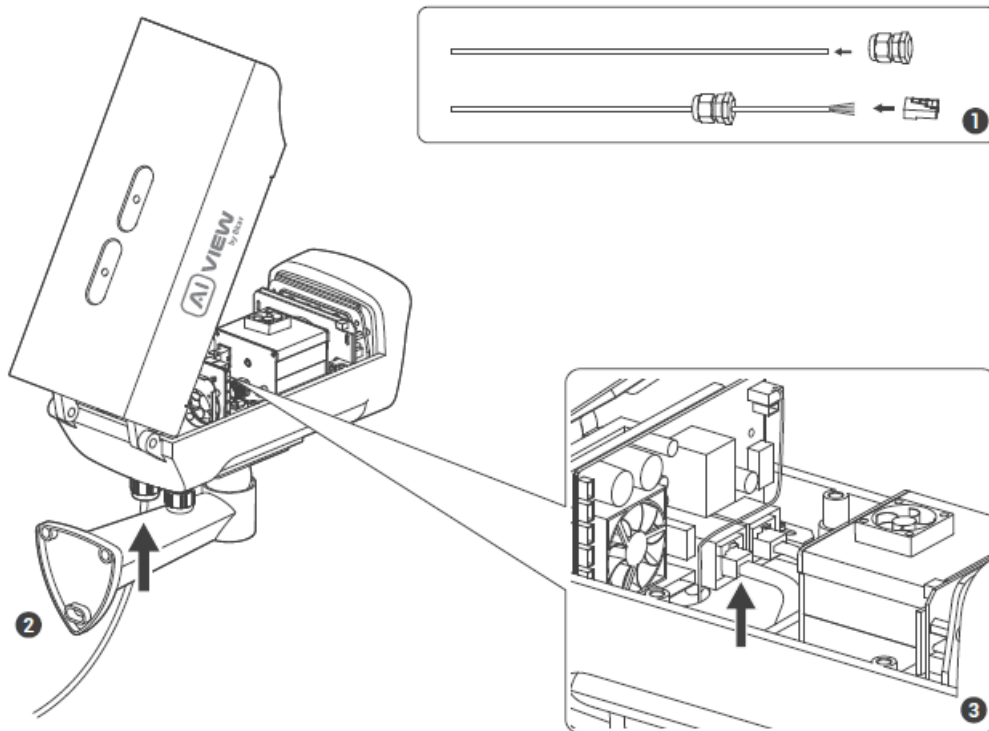

- Connect the PoE cable. Insert the cable into the waterproof coupling before connecting the wires into the terminal.

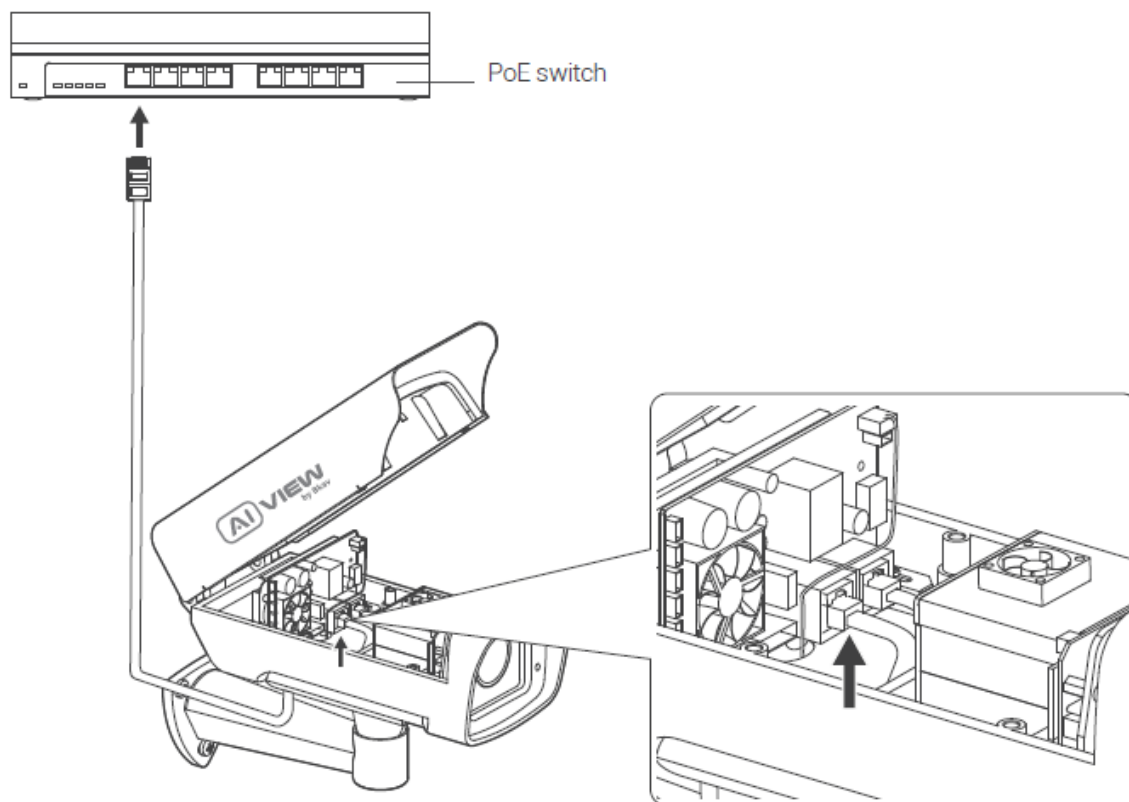

- Connect the PoE cable to the PoE terminal inside the camera.

ADJUSTING THE CAMERA VIEWING ANGLE

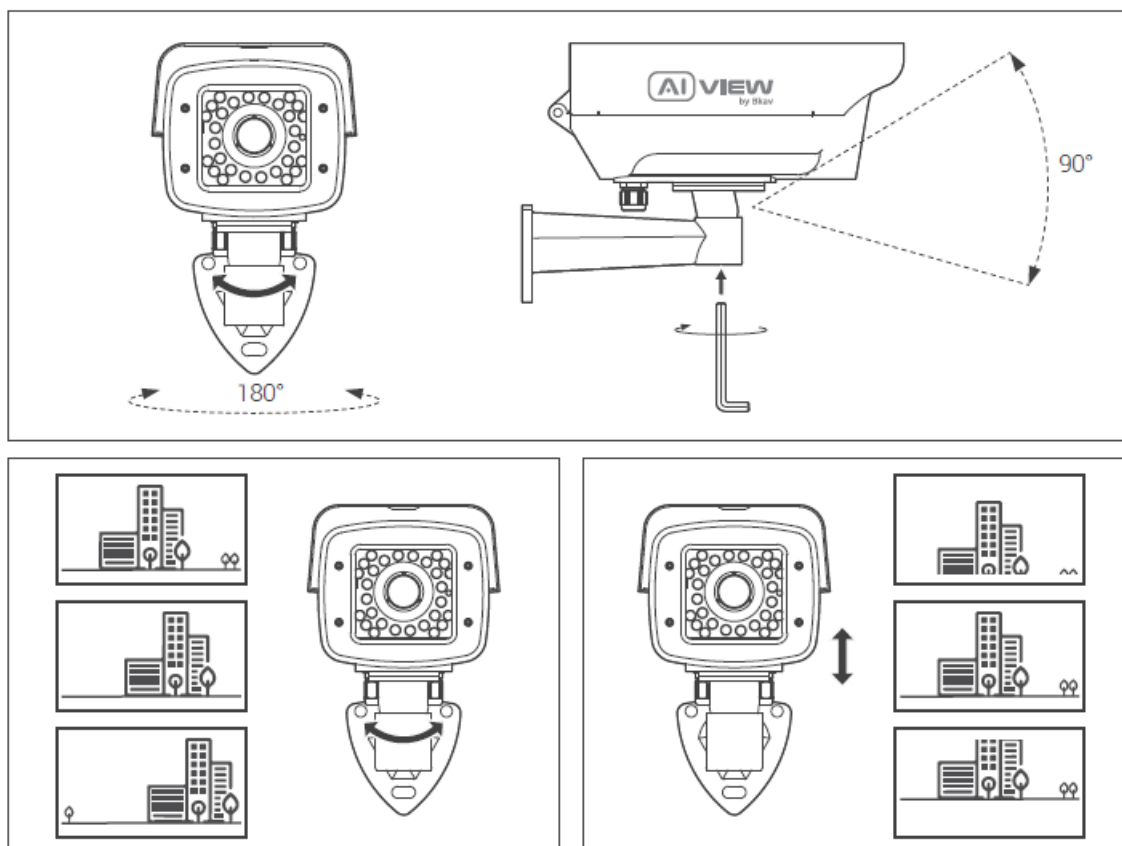

- Use hex tool to loose the screw on camera bracket to adjust the camera's angle.

THE MEMORY CARD AND RESET INSTALLATION

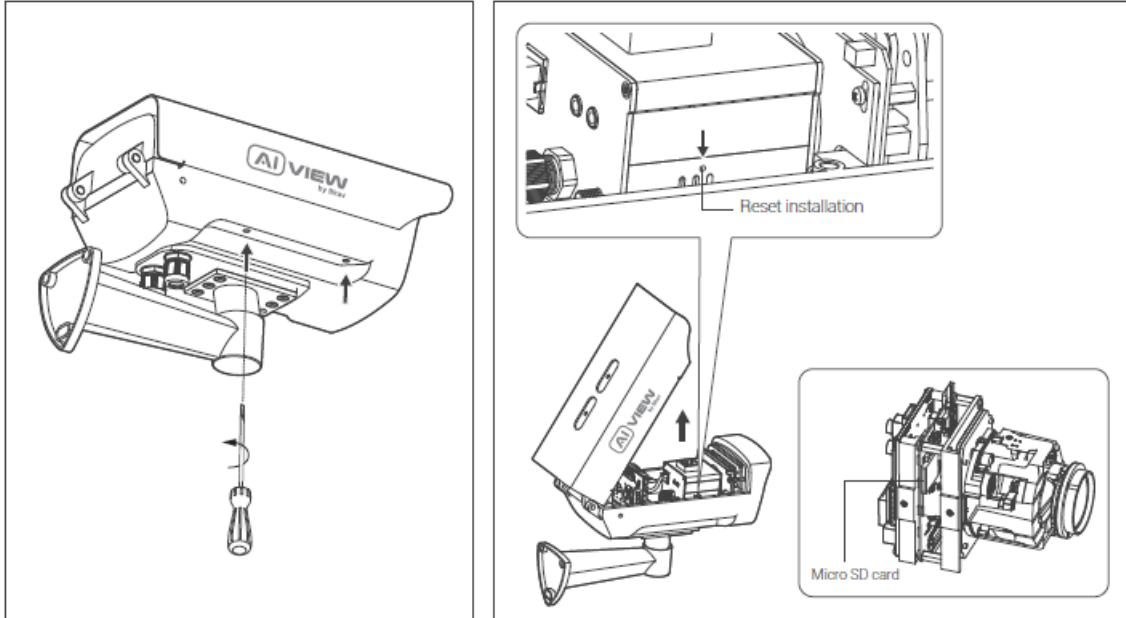

- **Reset installation:** Open the protective cover that protects the camera against dust and water to reset the device.
- **Memory card:** Open the protective cover, you can find the location of Micro SD card.

Note: Power off the camera, press and hold the factory reset button. Continue to hold the factory reset button for another 10 seconds while powering the camera, the camera will be restored to factory settings.

ACCESSING THE CAMERA

Password setting

The IP address of camera is set to DHCP mode by default. For the camera enables the DHCP by default, you need to use the AI View Scanner App to scan IP.

Note: To complete the installation steps for the camera, refer to the User Manual. The system will ask you to reset the password on your initial access. When the “Administrator password change” window appears, enter a new password.

- For passwords using eight or nine characters, you need to use at least three of the following types of characters: uppercase and lowercase letters, numbers, and special characters.
- For passwords using 10 to 15 characters, you need to use at least two of the character types.

Special characters include: ~ ` ! @ # \$ % ^ & * () _ - = + | { } [] . ? /

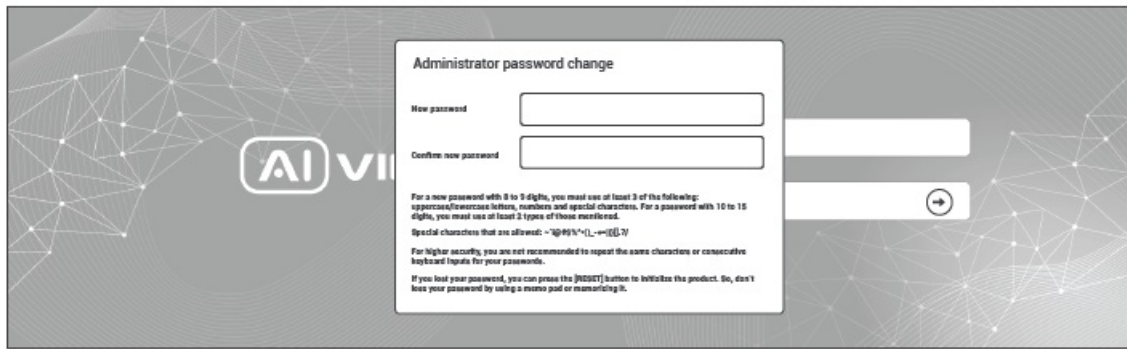

NOTE

- For additional security, please do not repeat any characters in your password.
- If you forget your password, you can hold the [RESET] button to return the product to its factory settings.

SOFTWARE INSTALLATION

Login screen

When accessing the camera, a login window will appear. Enter your user name and password to access the camera.



1. Enter "admin" in the <User name> box.
2. Enter your chosen password in <Password> box.
3. Click 

SAFETY INFORMATION

Be sure to follow this advice to ensure the device works properly.

Precautions

- Installation instruction: Concrete, brick, column, wood... are all suitable. Make sure the wall is strong enough.
- The torque forces of screws securing IP enclosure: 1.3 – 1.4Nm.
- It is recommended to use shielded network cables (STP) during set-up.
- It is recommended to use CAT5e or higher network cables.
- Store the camera in a cool and dry environment.
- Shield the camera from potential impact from heavy objects.
- Do not install the camera on unstable pillars, brackets, surfaces, or walls.

- Do not use chemicals or detergents to clean the camera or housing.
- To clean, use a damp cloth.
- Only use standard tools and accessories when installing the camera equipment. The manufacturer recommends using the manufacturer's power supply equipment or a corresponding source for the camera. Improper installation may cause damage to the product.
- Contact Bkav's customer support or authorized Bkav agents if you experience any problems.
- This equipment has been tested and found to comply with the limits for a Class A digital device, pursuant to part 15 of the FCC rules. These limits are designed to provide reasonable protection against harmful interference when the equipment is operated in a commercial environment.
- This equipment generates, uses, and can radiate radio frequency energy and, if not installed and used in accordance with the instruction manual, may cause harmful interference to radio communications.
- Operations of this equipment in a residential area is likely to cause harmful interference in which case the user will be required to correct the interference at his own expense.

Transportation:

- Use the original packaging, or equivalent, to avoid damaging the product during transportation.

WARRANTY INFORMATION

For information about AI View product warranty and thereto related information, go to aiview.ai/warranty.

BKAV CORPORATION

- **Address:** 2nd Floor, HH1 Building, Yen Hoa Urban Area, Yen Hoa Ward, Cau Giay District, Hanoi City, Vietnam
- **Website:** www.aiview.ai
- **Email:** aiview@bkav.com

Qualcomm products contained here in are products of Qualcomm Technologies, Inc. and/or its subsidiaries. Qualcomm is a trademark of Qualcomm Incorporated, registered in the United States and other countries. The Made with Qualcomm Technologies logo is a trademark of Qualcomm Incorporated.

Documents / Resources

	<p>AI VIEW S201-0803F 4k Bullet Ai-Based Camera [pdf] Installation Guide</p> <p>S201-0803F 4k Bullet Ai-Based Camera, S201-0803F, 4k Bullet Ai-Based Camera, Ai-Based Camera, Camera</p>
---	--

References

- [Bkav AI View | Camera AI | Giá và địa chỉ phân phối chính hãng tại các trung tâm phân phối AI trong nước và các quốc gia khác, và những nhà sản xuất Camera | Bkav Corporation](#)

