



Aeropulse Fusion Apollo Marine Amplifier Unbox Installation Guide

[Home](#) » [Aeropulse](#) » Aeropulse Fusion Apollo Marine Amplifier Unbox Installation Guide 

Aeropulse Fusion Apollo Marine Amplifier Unbox Installation Guide



Step 1

Insert the sensor or battery capsule at a 30-degree angle into the designated slot. Once aligned, press down on the top side of the capsule to secure it in place.

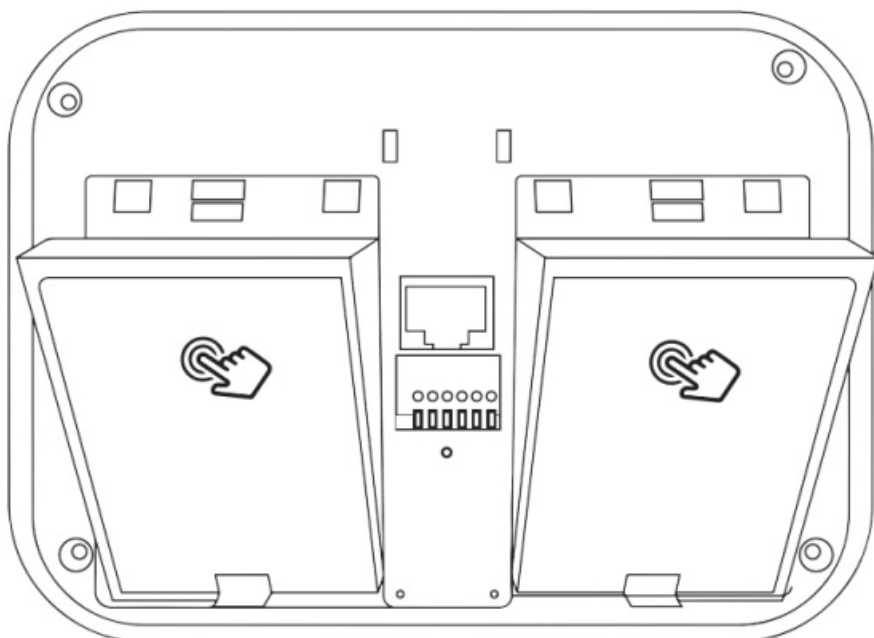

Step 2

Position the cover over the capsules and press down firmly on the upper part to ensure a secure fit.

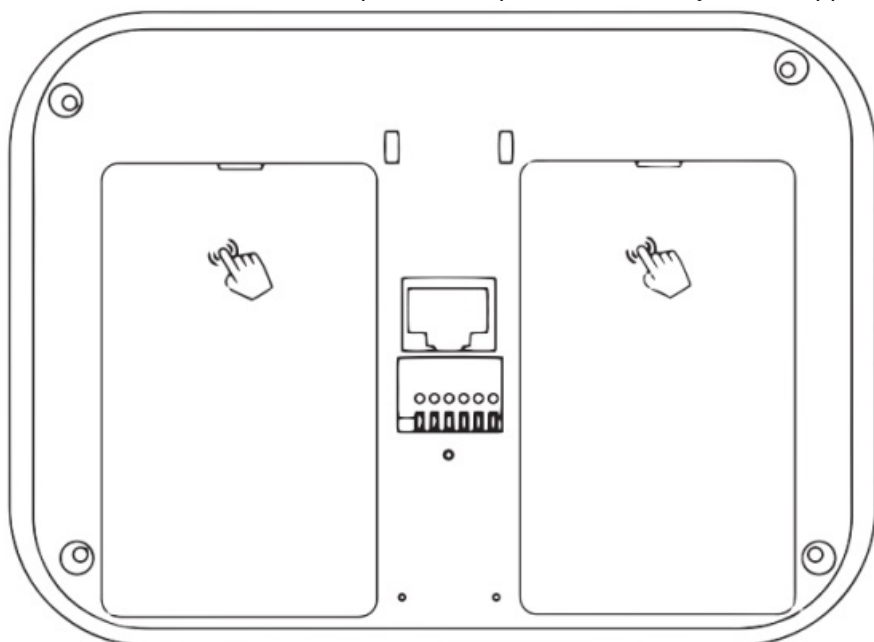

Step 3

Attach the small bracket onto the device and secure it using three screws.

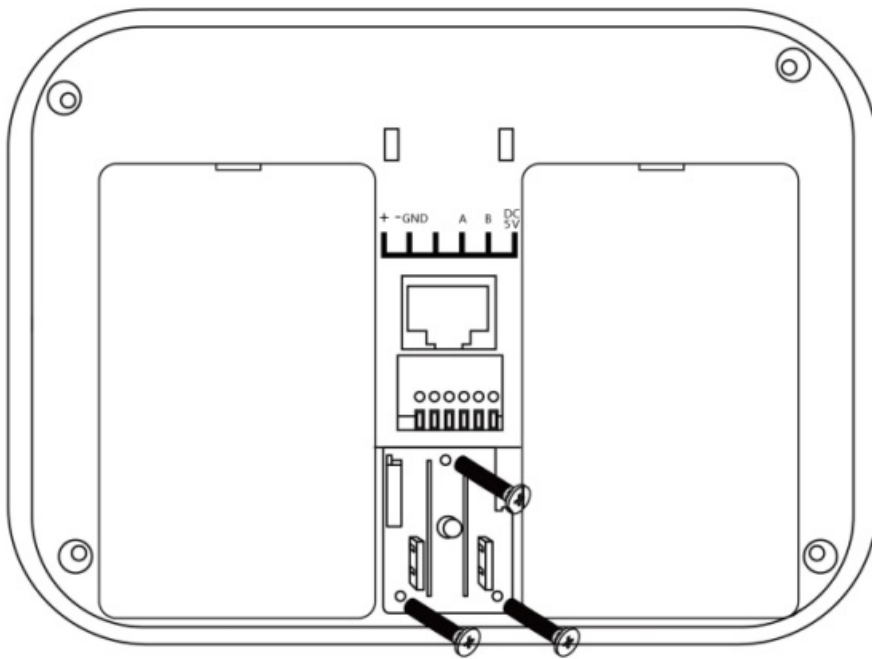

Step 4

Mount the larger bracket onto the wall and secure it with screws

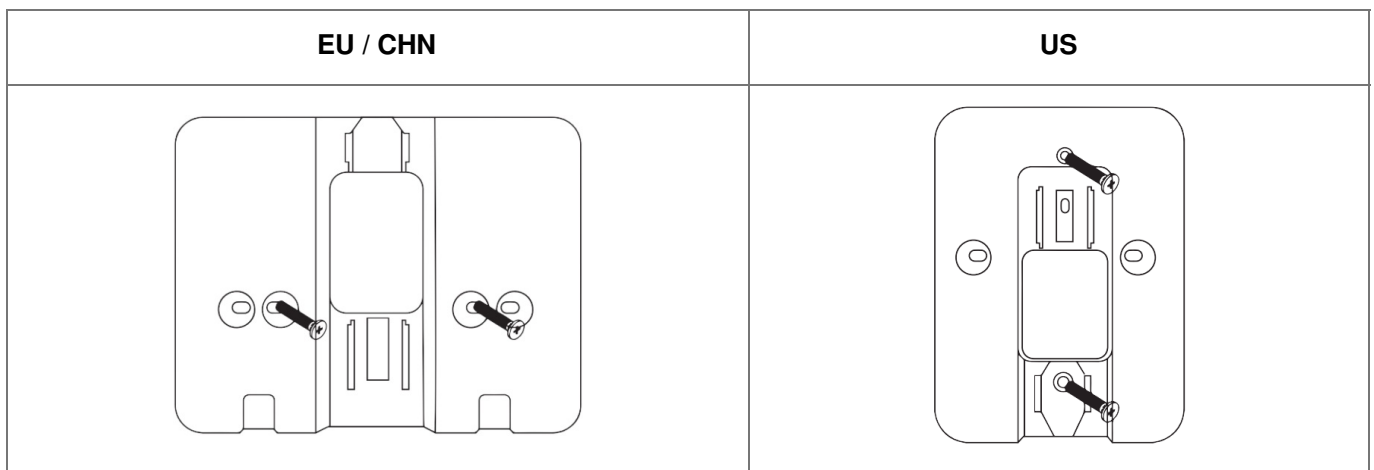

Step 5

Connect the necessary power and connectivity cables:

- **Power Cable**

- Connect 10-30V DC or 24V AC to the +/- terminals on the connectivity port.
- For Poe, connect to the Ethernet port

- **Connectivity Cables**

- Connect Modbus or BACnet cables to the A/B terminals on the connectivity port.
- Connect the Ethernet cable to the Ethernet port.

Step 6

Slide the device vertically into the wall-mounted brackets until securely positioned.

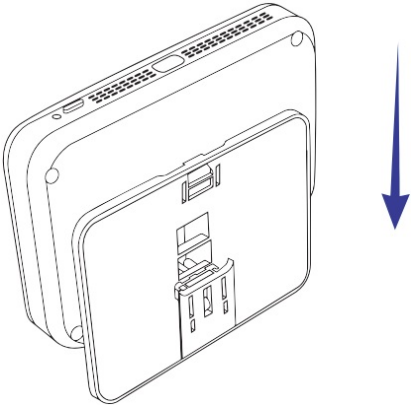
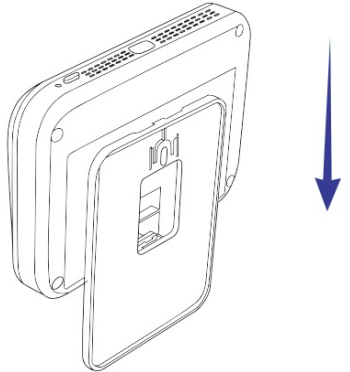
EU / CHN	US
	

Contents

- 1 Documents / Resources
 - 1.1 References
 - 2 Related Posts

Documents / Resources

	<p>Aeropulse Fusion Apollo Marine Amplifier Unbox [pdf] Installation Guide Fusion Apollo Marine Amplifier Unbox, Apollo Marine Amplifier Unbox, Marine Amplifier Unbox, Amplifier Unbox</p>
---	---

References

- [User Manual](#)

[Manuals+.](#) [Privacy Policy](#)

This website is an independent publication and is neither affiliated with nor endorsed by any of the trademark owners. The "Bluetooth®" word mark and logos are registered trademarks owned by Bluetooth SIG, Inc. The "Wi-Fi®" word mark and logos are registered trademarks owned by the Wi-Fi Alliance. Any use of these marks on this website does not imply any affiliation with or endorsement.