



# AeroCool Bionic ATX Mid Tower Case User Manual

[Home](#) » [AeroCool](#) » AeroCool Bionic ATX Mid Tower Case User Manual 

## Contents

- [1 AeroCool Bionic ATX Mid Tower Case](#)
- [2 Front I/O Cable Connection](#)
- [3 Accessory Bag Contents](#)
- [4 How to Install](#)
- [5 Install Rear Fan](#)
- [6 I/O Panel](#)
- [7 Documents / Resources](#)
  - [7.1 References](#)
- [8 Related Posts](#)



**AeroCool Bionic ATX Mid Tower Case**



- Technoteka is an online destination for comparing prices and features of white goods, consumer electronics and IT devices at retail chains and online stores in Serbia.
- Our site allows you to explore the latest information, detailed features and competitive product prices.
- Visit us and enjoy an exclusive smart shopping experience by clicking on the link:
- <https://tehnoteka.rs/p/aerocool-kuciste-bionic-atx-akcija-cena/>.

## Front I/O Cable Connection

### Front I/O Connectors

- (Please refer to the motherboard's manual for further instructions).

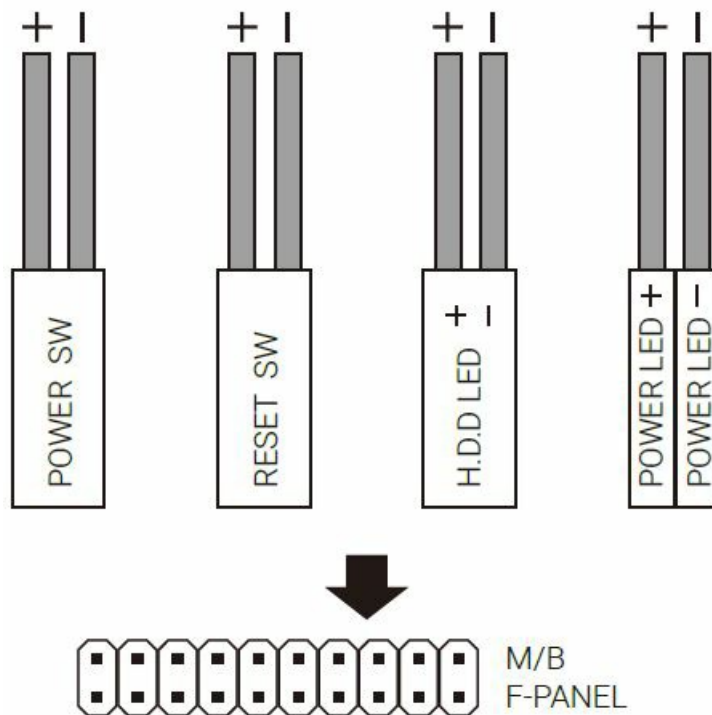

**Note:** Specifications may vary depending on y our region.  
Contact your local retailer for more information.

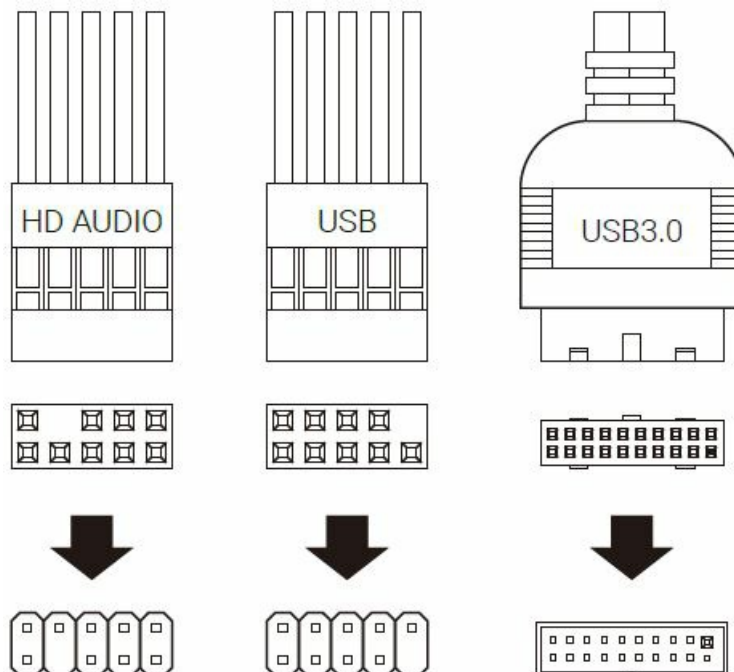

## Accessory Bag Contents

- |  |  |  |  |
|--|--|--|--|
| <b>1</b>  X14   SSD Screw<br>MB Screw | <b>2</b>  X8   PSU Screw<br>PCI Screw | <b>3</b>  X8   HDD Screw  | <b>4</b>  X2   3.5" HDD<br>Sliding Screw<br>For (4b) <b>A</b> |
| <b>5</b>  X3   MB Standoff            | <b>6</b>  X1   Standoff<br>Socket     | <b>7</b>  X4   Cable tie |  |

## How to Install

- (1a) Install Motherboard \*(for coolers that require backplate, we recommend mounting the cooler before motherboard installation)

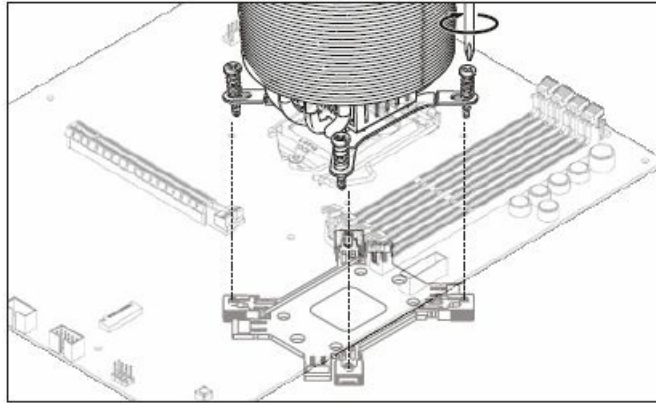

- (1b) Install Motherboard

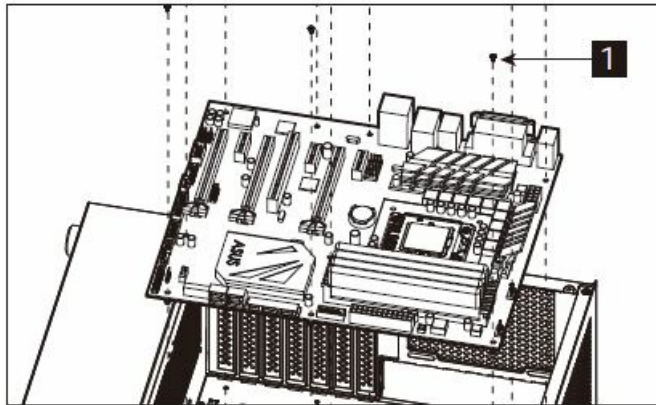

## Install PSU

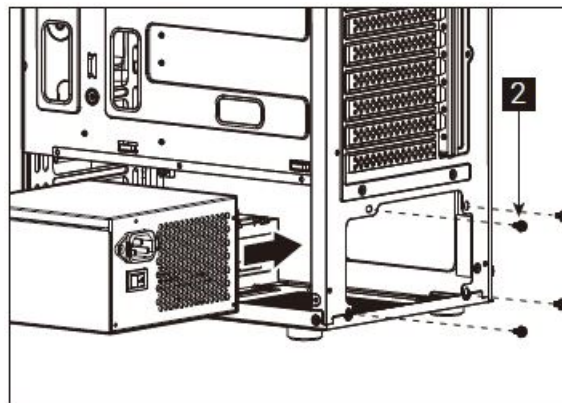

## Install Add-on Card

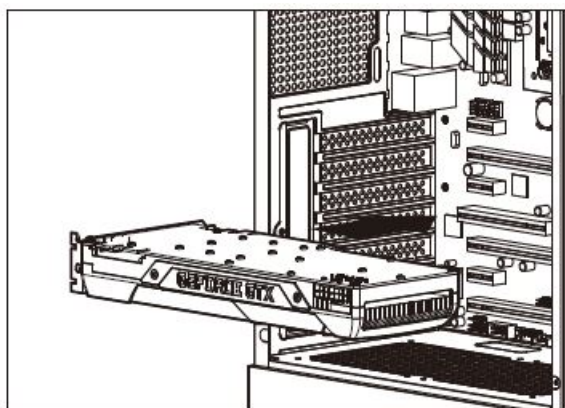

- Install 3.5" HDD x 1

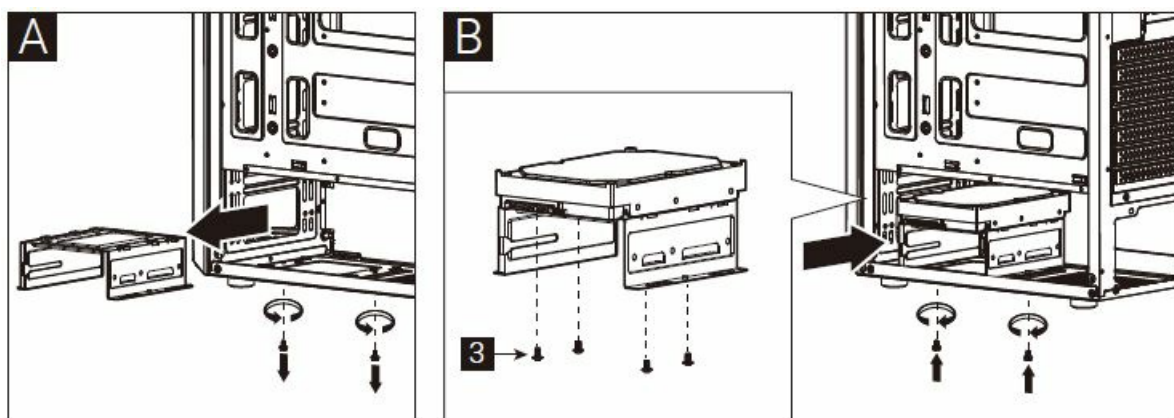

- Install 3.5" HDD x 1

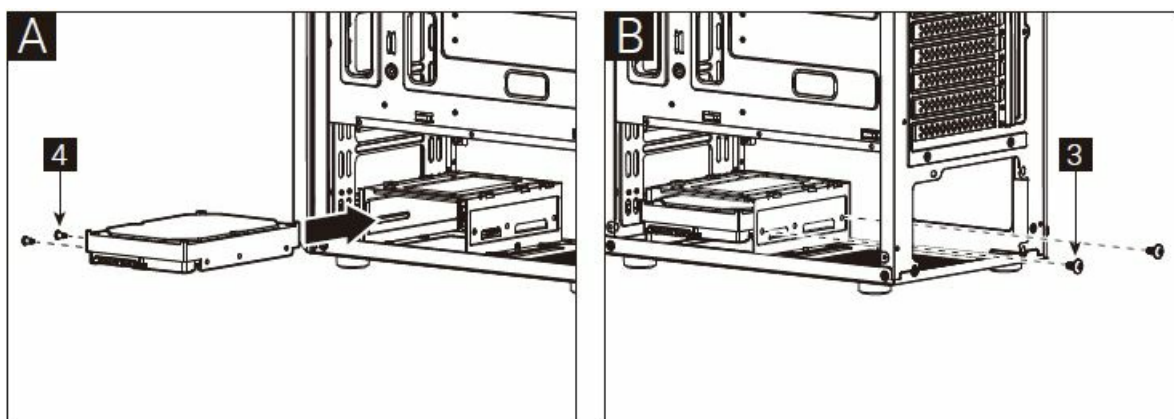

- Install 2.5" SSD x 2

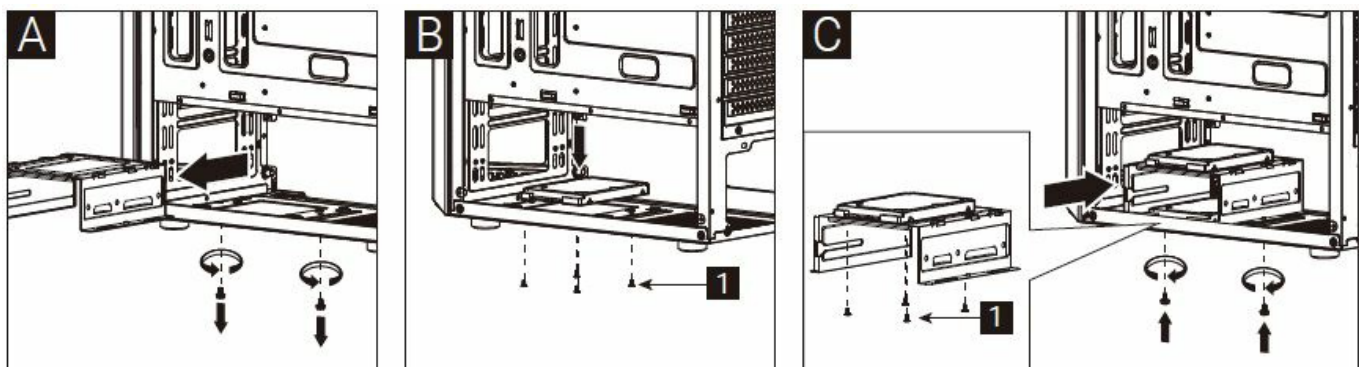



- Install 2.5" SSD x 2 (only for Mini-ITX M/B)

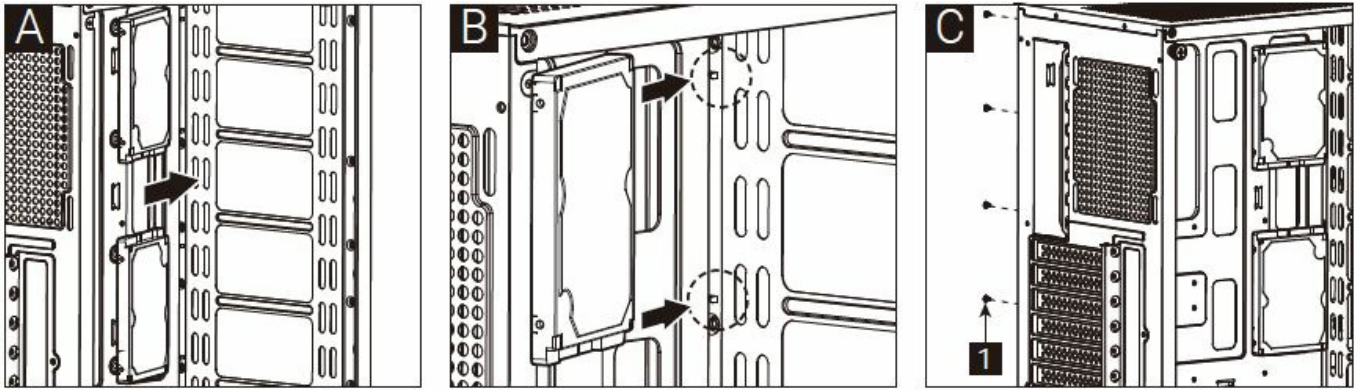

## Install 2.5" SSD

- Install Front Radiator

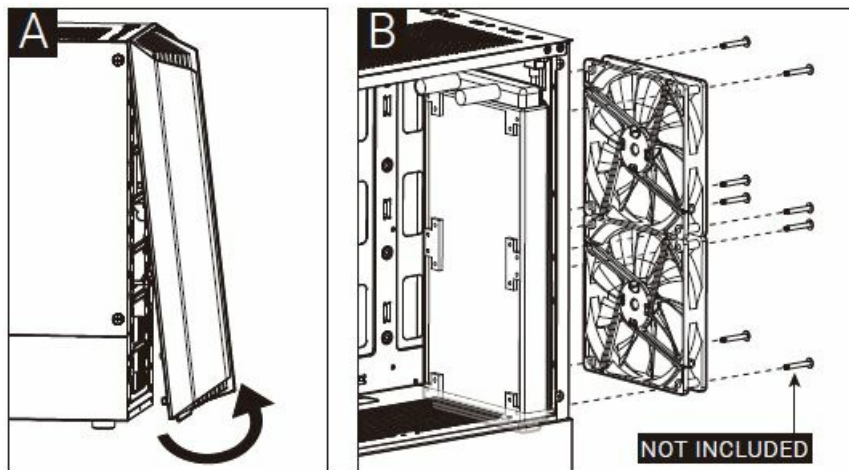

- Install Rear Radiator

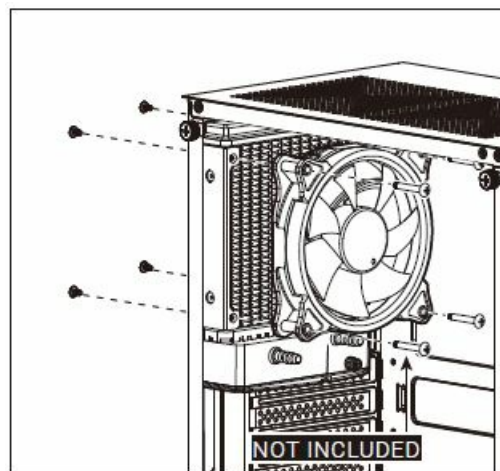

- Install Front Fans

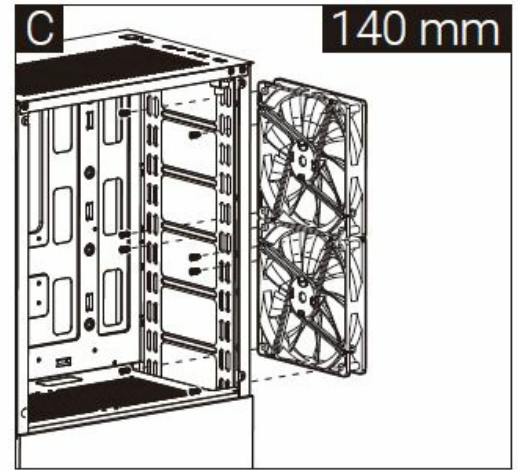
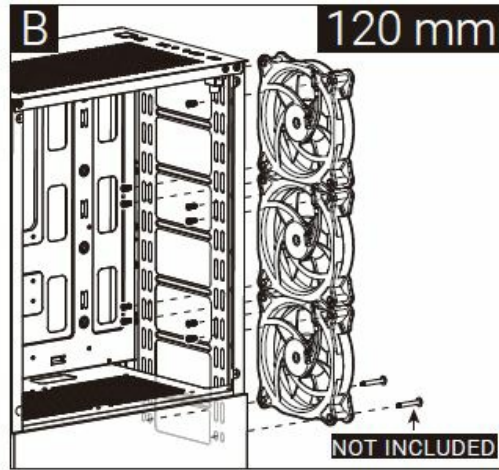

## Install Rear Fan

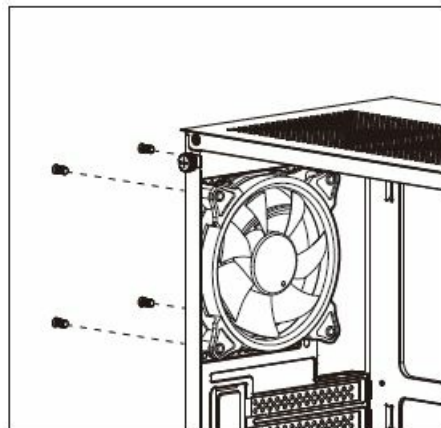

## Install Top Fans

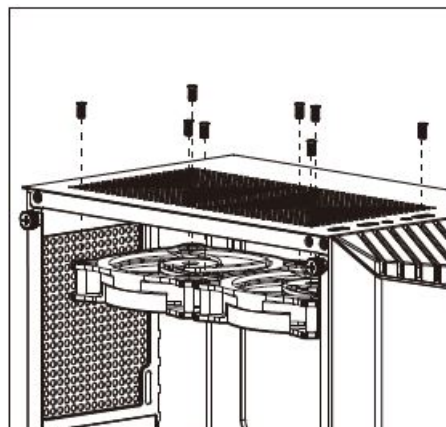

## Install PSU Fans

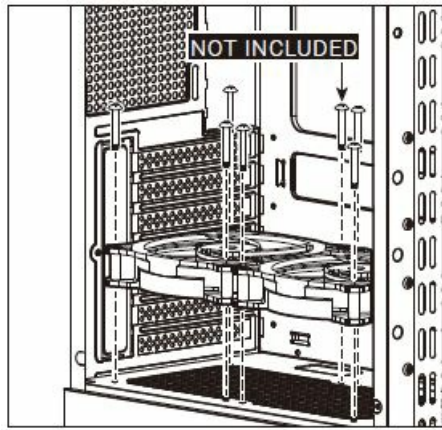

## I/O Panel

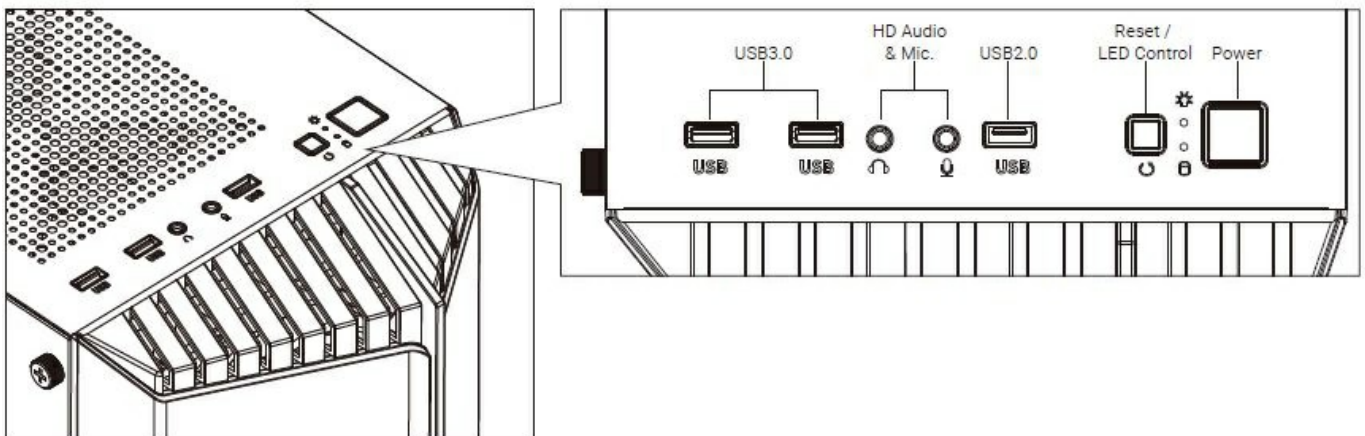

- Press and hold the LED Control Button for 3 sec to turn off the LED. (For RGB Version Only)
- **Note:** Specifications may vary depending on your region.
- Contact your local retailer for more information.

This document was originally produced and published by the manufacturer, brand AeroCool, and was downloaded from their site. Considering this article, Technoteka claims that it does not take responsibility for the accuracy, completeness or reliability of information, data, opinions, advice or statements contained in this document. Please note that Technoteka does not have the authority to make any changes or additions to this document, therefore we are not responsible for any errors, omissions or inaccuracies that may be found within it. Technothèque does not is responsible for damage caused to users when using incorrect data. If you have additional questions about the product, please kindly ask the contact directly to get all the details information.

For the latest price information, available promotions and technical information characteristics of the product mentioned in this document, please visit our page by clicking on the following link:

<https://tehnoteka.rs/p/aerocool-kuciste-bionic-atx-akcija-cena/>.





<https://tehnoteka.rs>.





[AeroCool Bionic ATX Mid Tower Case](#) [pdf] User Manual  
Bionic ATX, Bionic ATX Mid Tower Case, Mid Tower Case, Tower Case, Case

## References

-  [TCPDF](#)
-  [Tehnoteka - Poređenje cena i karakteristika - Kupujte pametno](#)
-  [Tehnoteka - Poređenje cena i karakteristika - Kupujte pametno](#)
-  [AeroCool kućište Bionic ATX - Cene i Akcije - Tehnoteka](#)
-  [AeroCool kućište Bionic ATX - Cene i Akcije - Tehnoteka](#)
- [User Manual](#)