



**ARGB_V2 Designer
V1 Black Mid
Tower Case**



AeroCool ARGB_V2 Designer V1 Black Mid Tower Case Installation Guide

[Home](#) » [AeroCool](#) » AeroCool ARGB_V2 Designer V1 Black Mid Tower Case Installation Guide 

Contents

- [1 AeroCool ARGB_V2 Designer V1 Black Mid Tower Case](#)
- [2 Front I/O Cable Connection](#)
- [3 Accessory Bag Contents](#)
- [4 How to Install](#)
- [5 For ARGB Version \(RGB Fan Hub\)](#)
- [6 Connection Set Up User Guide](#)
- [7 Documents / Resources](#)
 - [7.1 References](#)



AeroCool ARGB_V2 Designer V1 Black Mid Tower Case



Front I/O Cable Connection

Front I/O Connectors

(Please refer to the motherboard's manual for further instructions).

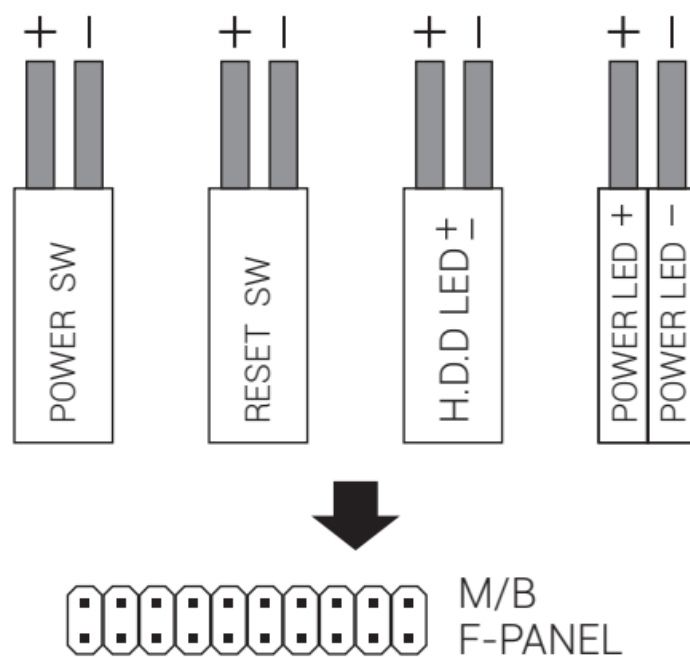

Note: Specifications may vary depending on your region. Contact your local retailer for more information.

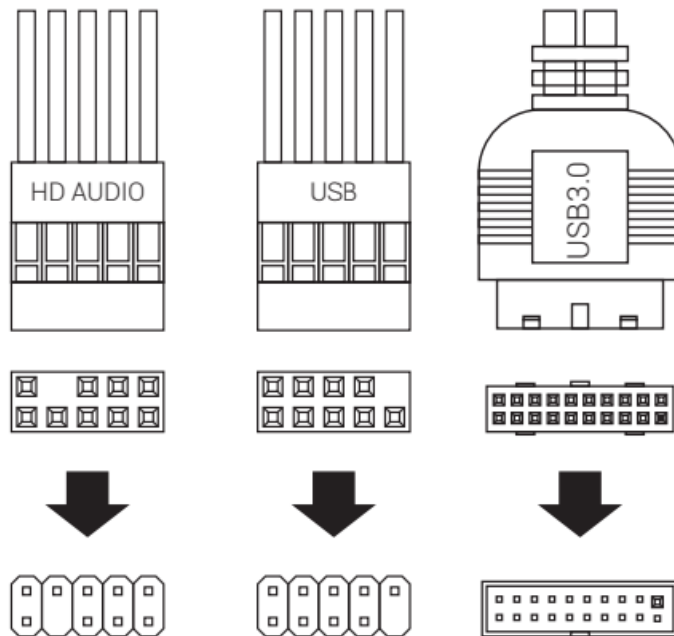

Accessory Bag Contents

1  x 18 | SSD Screw
MB Screw

2  x 6 | PSU Screw
PCI Screw

3  x 9 | HDD Screw

4  x 3 | MB Standoff

5  x 8 | Fan Screw

6  x 5 | Cable Tie

How to Install

(1) Install Motherboard

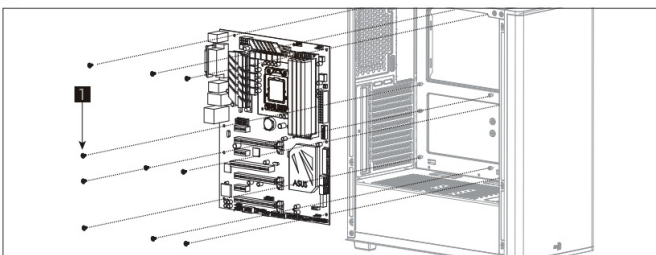

(2) Install PSU

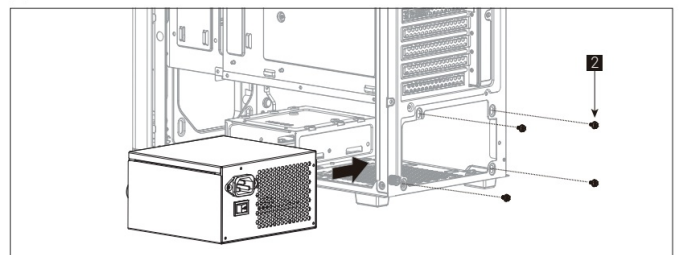

(3) Install Add-on Card

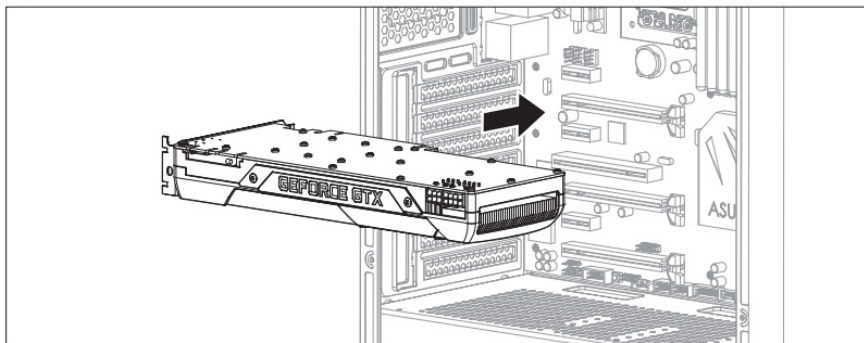

(4a) Install 3.5" HDD x1

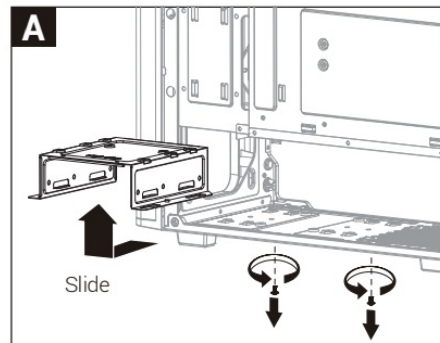

(4b) Install 3.5" HDD x1

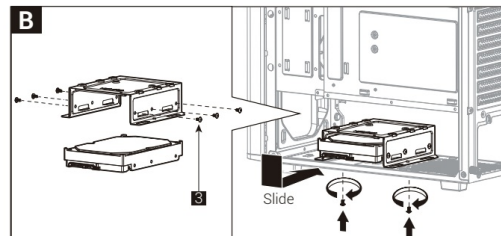
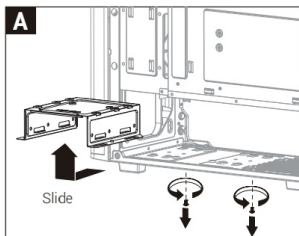
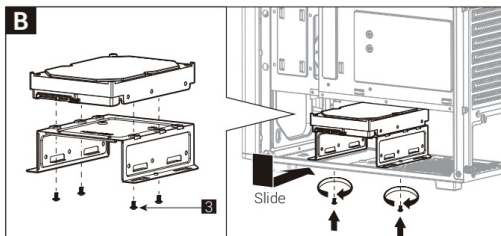

(5a) Install 2.5" SSD x1

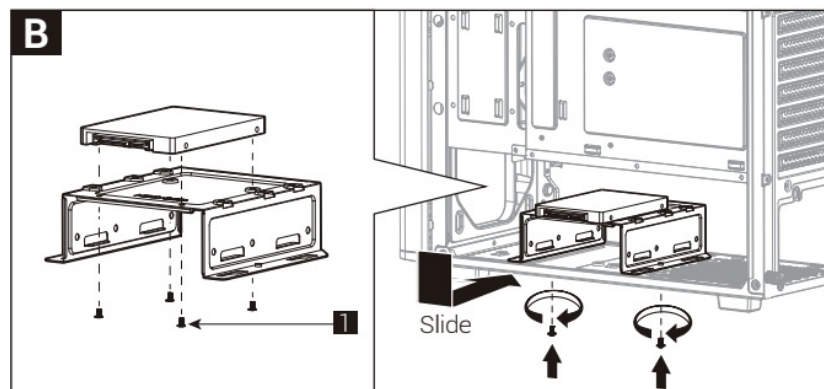
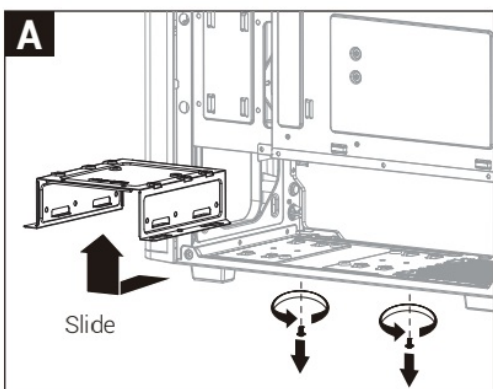

(5b) Install 2.5" SSD x1

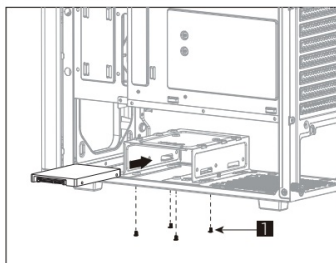

(5c) Install 2.5" SSD x2

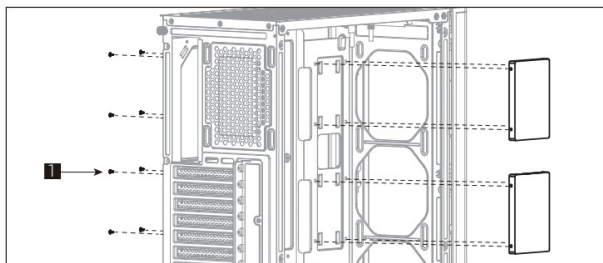

(6) Install Front Fan

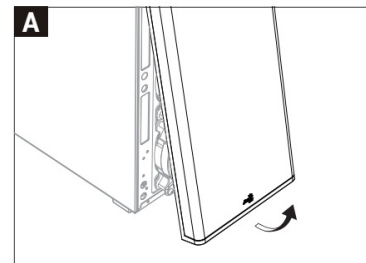

(7) Install Top Fans

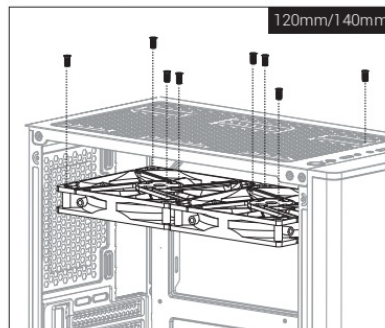
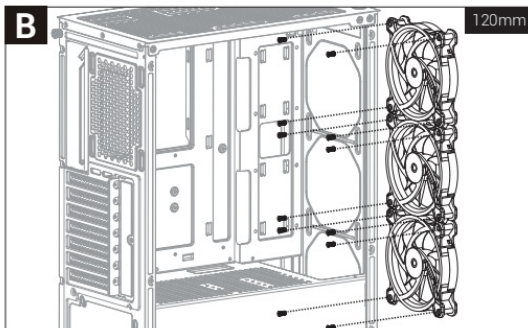

(8) Install Rear Fan

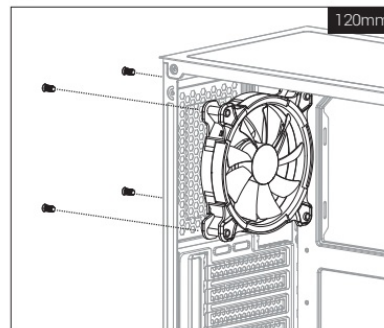

(9) Install PSU Fan

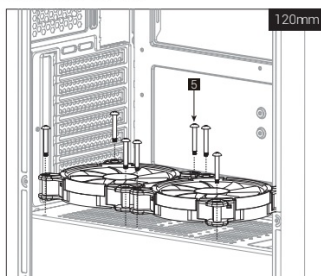

(10) Install Front Radiator

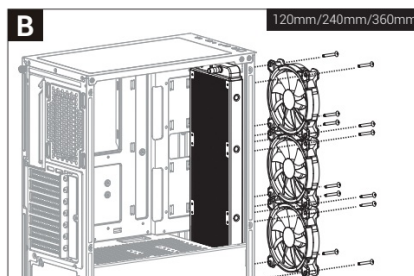
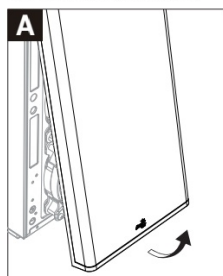

(11) Install Rear Radiator

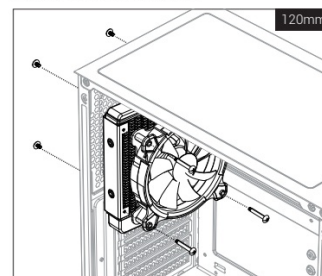

(12) I/O Panel

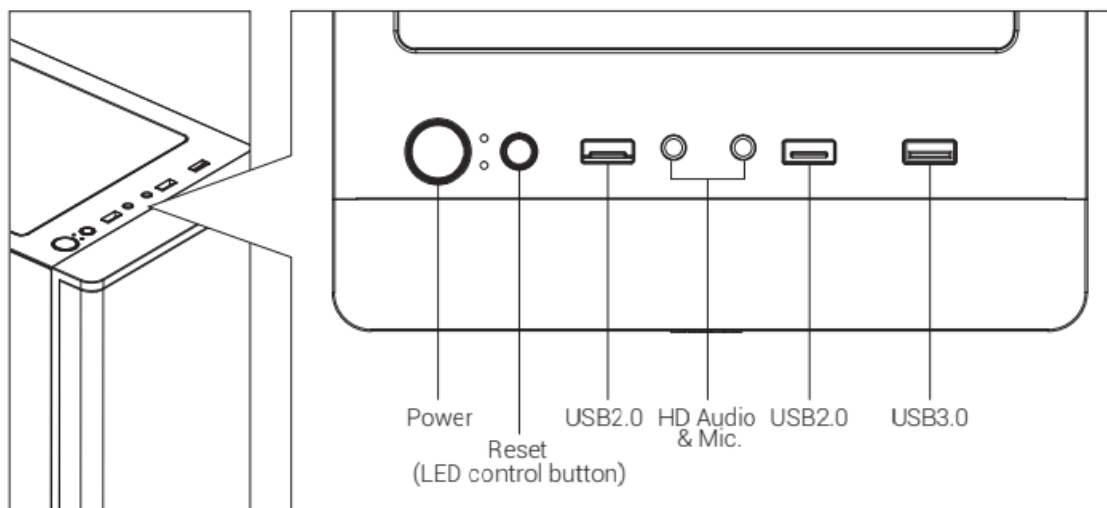

Hold LED control button for 3 sec to switch between the motherboard and button control Hold LED control button for 6 secs to turn off LED and press once to turn it back on

Note :

Specifications may vary depending on your region Contact your local retailer for more information. To learn more about how to connect your ARGB, please visit the product page at aerocool.io

For ARGB Version (RGB Fan Hub)

(12) I/O Panel

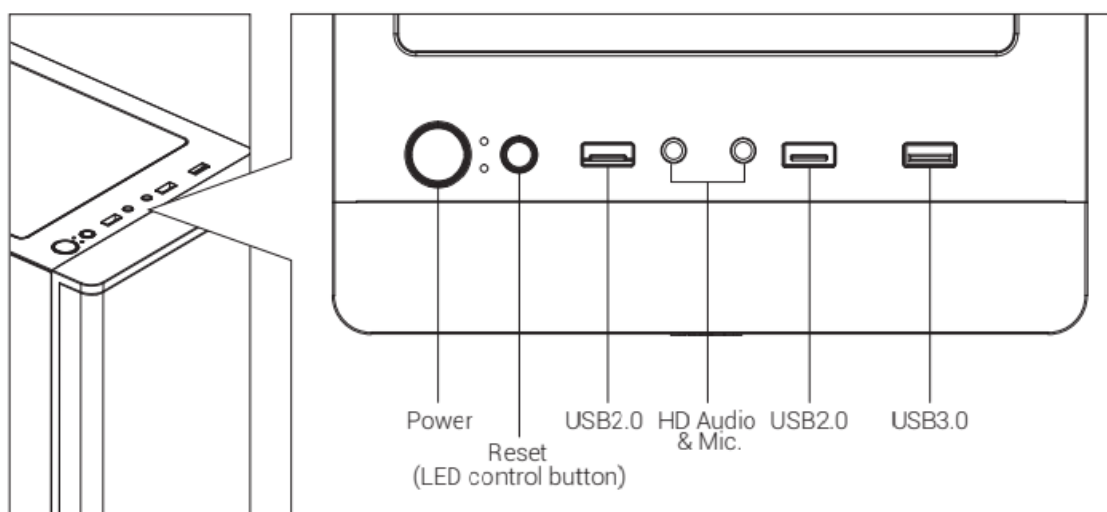

Connection Set Up User Guide

For ASUS Aura Sync, MSI Mystic Light Sync, and GIGABYTE

RGB Fusion Motherboards

1. Connect (A) to the motherboard's PWM socket
2. Connect (B) to the motherboard's Addressable RGB socket
3. Connect (C) to the PSU's SATA connector

For Non-Addressable RGB Motherboards

1. Connect (A) to the motherboard's PWM socket
2. Connect the 2-pin LED button connector (E) with your hub.
3. Connect (C) to the PSU's SATA connector

Use the RGB fan connectors (F) to connect the Addressable RGB fans with your hub.

Documents / Resources

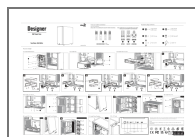

[AeroCool ARGB_V2 Designer V1 Black Mid Tower Case](#) [pdf] Installation Guide
ARGB_V2, ARGB_V2 Designer V1 Black Mid Tower Case, Designer V1 Black Mid Tower Case,
Black Mid Tower Case, Mid Tower Case, Tower Case, Case

References

- [User Manual](#)

[Manuals+](#), [Privacy Policy](#)

This website is an independent publication and is neither affiliated with nor endorsed by any of the trademark owners. The "Bluetooth®" word mark and logos are registered trademarks owned by Bluetooth SIG, Inc. The "Wi-Fi®" word mark and logos are registered trademarks owned by the Wi-Fi Alliance. Any use of these marks on this website does not imply any affiliation with or endorsement.