



## AERMEC Remote Controller User Manual

[Home](#) » [AERMEC](#) » AERMEC Remote Controller User Manual 

### Contents

- [1 AERMEC Remote Controller](#)
- [2 REMOTE CONTROL](#)
- [3 FUNCTIONS AVAILABLE THROUGH THE REMOTE CONTROL](#)
- [4 Documents / Resources](#)
- [5 Related Posts](#)



**AERMEC Remote Controller**



**Dear customer,**

Thank you for choosing an AERMEC product. It is the fruit of many years of experience and special design studies and has been made of the highest-grade materials and with cutting-edge technology. In addition, all our products bear the EC mark indicating that they meet the requirements of the European Machine Directive regarding safety. The quality level is constantly monitored, so AERMEC products are synonymous with Safety, Quality, and Reliability.

The data may undergo modifications considered necessary for the improvement of the product, at any time and without the obligation for any notice thereof.

Thank you once again. AERMEC S.p.A

**INFORMATION FOR USER**

**This device is universal.**

By pressing a key for a function that is not available, the unit will not change the operating status. Never install the device in a damp area and do not expose it to direct sunlight.

Do not bump, throw or disassemble the device frequently. Never use the device with wet hands. Carefully read the manual before using and installing the device.

This marking indicates that this product should not be disposed with other household wastes throughout the EU. To prevent possible harm to the environment or human health from uncontrolled disposal of Waste Electrical and Electronic Equipment (WEEE), please return the device using appropriate collection systems, or contact the retailer where the product was purchased. Please contact your local authority for further details. Illegal dumping of the product by the user entails the application of administrative sanctions provided by law. All specifications are subject to change without prior notice. Although every effort has been made to ensure accuracy, Aermec shall not be held liable for any errors or omissions.

## REMOTE CONTROL

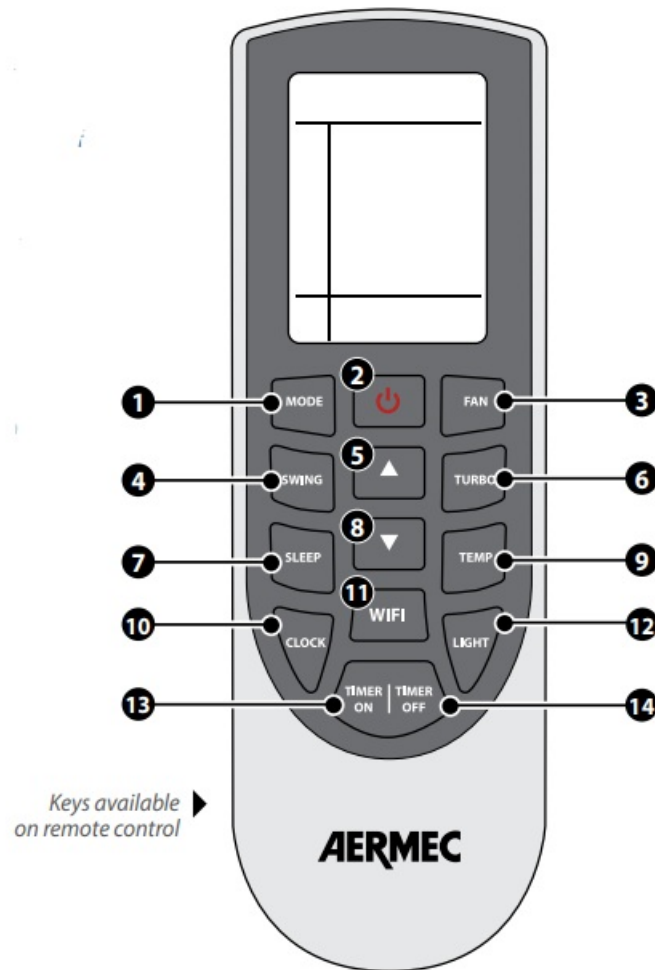

- Some of the buttons of the remote control are not used for the required air conditioner and are therefore not described in these instructions. Pressing of these keys will not affect the operation of the air conditioner.
- Check there are no obstructions between the receiver and the remote control.
- The maximum distance between the IR receiver and the remote control is 8 metres, to ensure the signal is correctly received.
- Position the remote control at least 1 metre away from TVs, radios, stereos, etc. There may be some audio and video interference.
- Do not drop or throw the remote control.
- Do not let liquids enter the remote control, and do not leave it in direct sunlight or in hot places.
- When the remote control sends a signal the symbol appears on the display, the receiver of the indoor unit emits a sound to confirm reception of the signal.

Index	Function of the button:			
1	Operating mode selection			
2	Switches the unit on or off	8	Decreases value (operating setpoint, timer, etc.)	
3	Sets the fan speed			
4	Sets the operation of the motorised air discharge fin (swing function)	9	It displays in the indoor unit's monitor the set temperature and the room air temperature (or the external air temperature)	
5	Increases value (operating setpoint, timer, etc.)			
6	Activates or deactivates the maximum fan speed (TURBO)	10	Sets the time on the system clock	
7	Activates or deactivates the SLEEP function (this function is applicable to the cooling and heating modes). Once activated this function will control the unit in order to maintain an ideal temperature (this temperature is automatically calculated and cannot be set)	11	Activates or deactivates the WIFI card (available with accessory WIFIKIT/WIFIKIT10)	
		12	Activates or deactivates the display of information of the indoor unit	
		13	Activates, deactivates or changes the programmed switch on timer	
		14	Activates, deactivates or changes the programmed switch off timer	

Index	Functions represented by the icons:
1	Indicates the AUTOMATIC mode is active

<b>2</b>	Indicates the COOLING mode is active
<b>3</b>	Indicates the DEHUMIDIFICATION mode is active
<b>4</b>	Indicates the VENTILATION mode is active
<b>5</b>	Indicates the HEATING mode is active
<b>6</b>	Indicates the SLEEP function is active
<b>7</b>	Indicates the room air and setpoint temperatures are active on the display of the indoor unit
<b>8</b>	Indicates which temperature is shown on the display of the indoor unit (internal temperature or setpoint temperature)
<b>9</b>	Indicates the state of the SWING function
<b>10</b>	Indicates that all the buttons of the remote control are locked
<b>11</b>	Indicates that the IFEEL function is activated.
<b>12</b>	Indicates the actual fan speed

<b>13</b>	Indicates the TURBO function is active (the fan speed is forced by this function)
<b>14</b>	Indicates the setting has been transmitted to the receiver located on the indoor unit
<b>15</b>	Indicates that the anti-freeze function is activated (set temperature 8°C)
<b>16</b>	Indicates the extended ventilation function is active (only in cooling or dehumidification)
<b>17</b>	Not available
<b>18</b>	Not available
<b>19</b>	Indicates the operating setpoint temperature in the various modes
<b>20</b>	Indicates that the figures displayed next to the icon represent the current system time
<b>21</b>	Indicates the system time, or the start and switch off timer
<b>22</b>	Indicates if a timer is set for starting
<b>23</b>	Indicates if a timer is set for switching off
<b>24</b>	Indicates the unit of measurement for the temperature setpoints ( °C or °F)

Indicates that the WIFI function is activated (available with the dedicated accessory WIFI I)

#### remote control display icons available

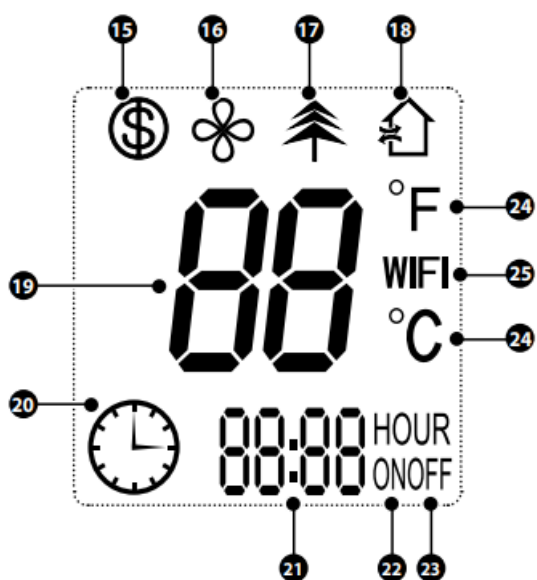
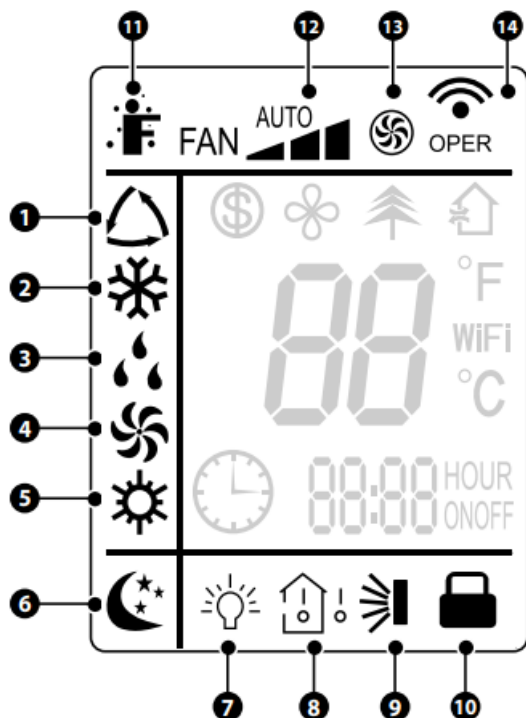

## FUNCTIONS AVAILABLE THROUGH THE REMOTE CONTROL



### SWITCHING THE UNIT ON OR OFF

By pressing the button it is possible to switch the unit on or off. When off some information is still displayed on the remote controlled: the operating setpoint of the last operating mode used, and switch on timers programmed ( ) and any icons tied to the function active last switch on of the unit (enabling indoor unit, etc.) Once switched during the display of the on the unit uses the settings selected during the last operating session.

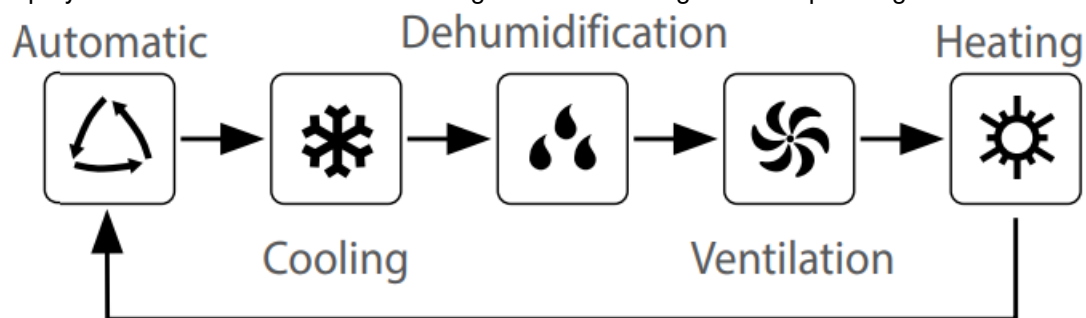

### SELECTING AN OPERATING MODE

If the unit is on, pressing the button allows passing from one operating mode to the next, in this sequence The various operating modes have different features and ranges:





- **AUTOMATIC mode:** in this mode, no setpoint value is displayed on the remote control and the fan speed setting is AUTO (as default). During the AUTOMATIC mode the unit calculates whether to cool (room temperature > 25°C), heat (room temperature < 23°C), or just ventilate (room temperature between 23°C and 25°C);
- **COOLING mode:** in this mode, the user must set the operating setpoint and a fan speed. If the room air temperature is higher than the setpoint the unit is switched on until the room temperature drops below the setpoint value.
- **DEHUMIDIFICATION mode:** in this mode, the user must set the operating setpoint but not the fan speed (which remains fixed at a minimum). If the room air temperature is higher than the setpoint the unit is switched on until the room temperature drops below the setpoint value.
- **VENTILATION mode:** in this mode, the user must set only the fan speed. This mode provides no heating or cooling but only uses the internal fan to ventilate the space.
- **HEATING mode:** in this mode, the user must set the operating setpoint and a fan speed. If the room air temperature is lower than the setpoint the unit is switched on until the room temperature rises above the setpoint value.

### SETTING THE OPERATING SETPOINT

All the operating modes (except the automatic one) require an room air temperature value to control to: this is called the operating setpoint. If the unit is on (and the automatic mode is not selected), pressing the  $\uparrow$  and  $\downarrow$  buttons allows decreasing or increasing the operating setpoint. The setpoint value is displayed in the central part of the remote control's display.



### SETTING THE FAN SPEED

If the unit is on (and the automatic or dehumidification modes are not selected), pressing the button allows the selection of the fan speed. Pressing the button allows changing the fan speeds as shown in the icons below, in the following sequence:

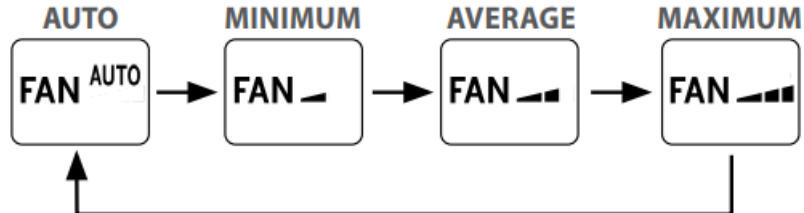

### NOTE:

Besides the three speeds (AUTO automatically selects the best speed based on the room temperature), there is a function called TURBO (explained earlier) which adds a further speed above the maximum speed.



#### SETTING THE MOTORISED DISCHARGE FIN (SWING)



If the unit is on, while pressing the button it activates the swing of the motorized supply air fin. The fin allows to change the air flow in the room depending on the set position; The logic where this function is managed:

**When the unit is on, while pressing the button it's possible to set one by one the following steps:**

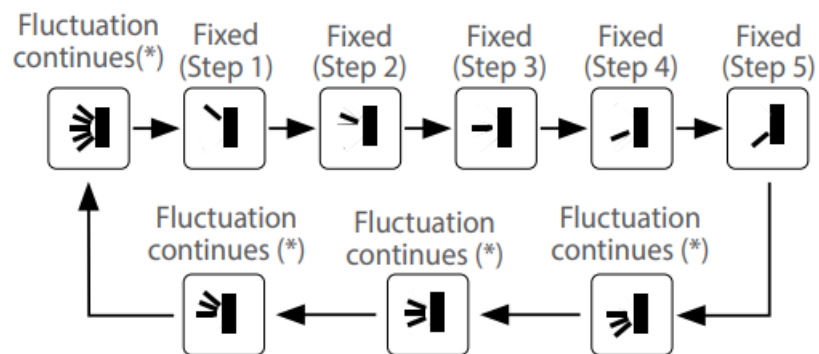

Are present in spite of different icons for continuous oscillation, all 4 trigger the same mode: fluctuation continues from the lowest point to the highest point

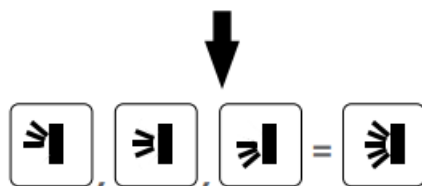

#### NOTE:

In order to block in a precise position the fin during the swing mode, keep the button , pressed for at least 2 seconds, and release it once the fin reaches the desired position.

#### SETTING A SYSTEM TIME



These units are equipped with an internal clock which can display the current time; by pressing on the key the clock icon will start to flash (this flashing will last 5 seconds, after this if no key is pressed you automatically exit the time modification mode); while the clock icon is flashing it is possible to change the system time using the keys and to increase or decrease the displayed time; once the desired value is set you need to wait 5 seconds or

press the key again to confirm the value (once confirmed the clock icon will stop flashing)

### SETTING OR CANCELLING A PROGRAMMED SWITCH OFF (TIMER OFF)

The units possess a timer used to program switching off by specifying the time that you want the unit to deactivate. If the unit is switched off (and no other programmed switch off times are present), by pressing the key you enter the time programming mode (in this mode the "OFF" icon to the right of the time flashes) and by pressing the keys and it is possible to set the switch off time;

Pressing the button again confirms the time and activates the timer programme. If you want to cancel a programmed switch off, just press the key to cancel the previous programming

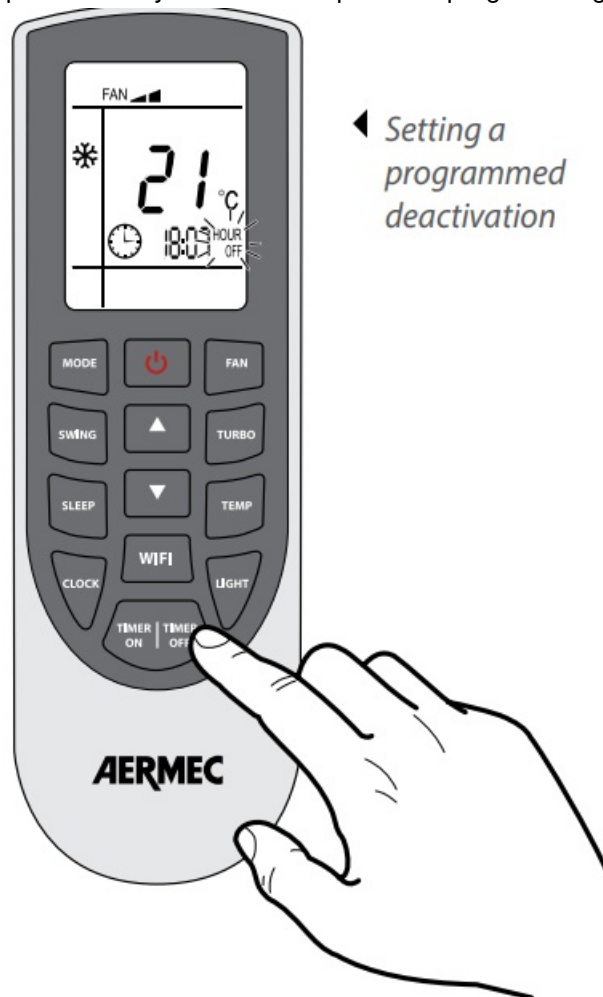

### ATTENTION:

The units can simultaneously manage an ignition timer and one-off, so as to provide a time slot within which allow operation of the unit

### SETTING OR CANCELLING A PROGRAMMED SWITCH ON (TIMER ON)

The units possess a timer used to program switching on by specifying the time that you want the unit to start. If the unit is switched off (and no other programmed switch on is present), by pressing the key you enter the time programming mode (in this mode the "ON" icon to the right of the time flashes) and by pressing the keys and it is possible to set the switch on time;

Pressing the button again confirms the time and activates the timer programme. If you want to cancel a programmed switch on, just press the key to cancel the previous programming

Setting a programmed switch▶  
on

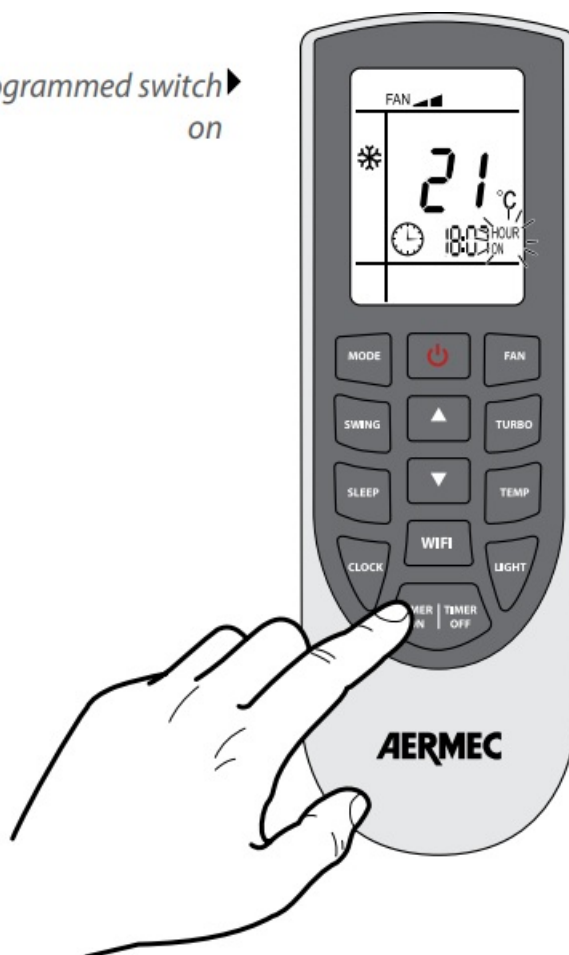

**NOTE:**

Once a programmed switch on is set, the operating mode, the working setpoint and fan speed, will be the same as those present when the unit stops.

**ACTIVATING / DEACTIVATING THE EXTENDED VENTILATION**

During the operation in cooling or dehumidification mode the condensate caused by the humidity in the air is formed on the heat exchanger within the unit. This function allows the ventilation to be extended for two minutes after the unit is switched off, thereby drying the heat exchanger. If the unit is on (and the cooling or dehumidification mode is selected), pressing the for at least 2 seconds, allows activating or deactivating of this function. On the remote control the display the icon will appear or disappear to indicate if the function is activated or deactivated.

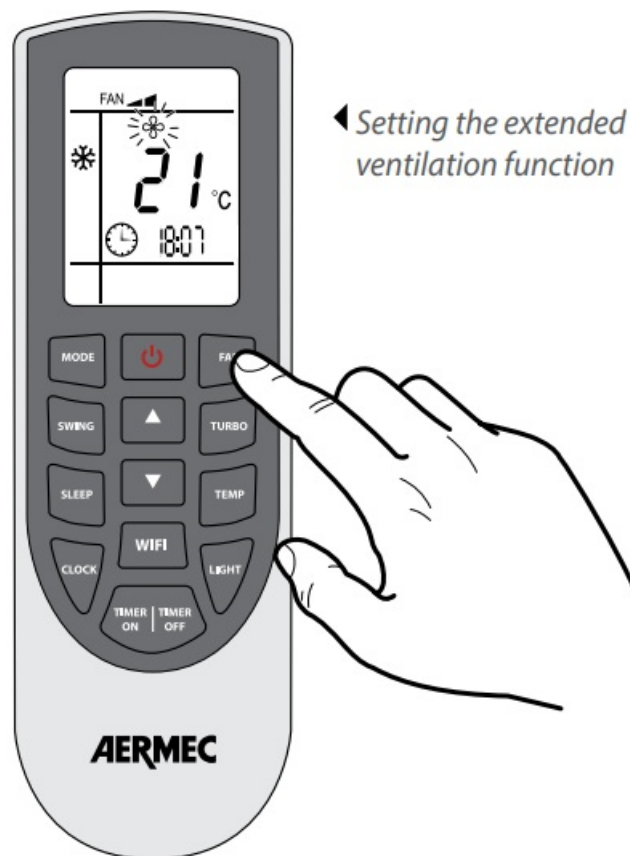

**NOTE:**

Every time the unit is turned off, the function deactivates automatically.

**VIEW THE AMBIENT AIR, SET POINT OR OUTDOOR AIR (IN THE DISPLAY OF THE INDOOR UNIT)**

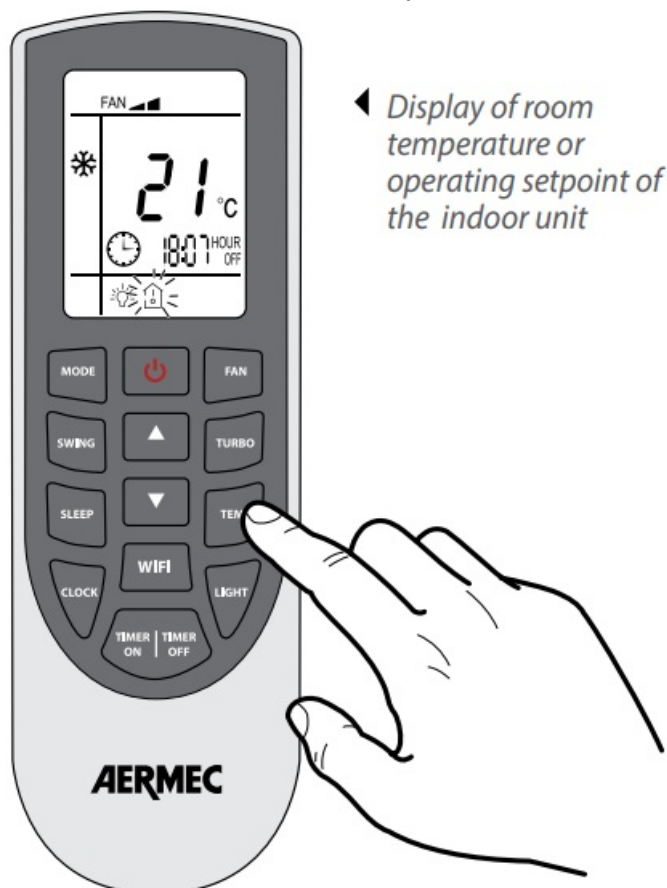

Through the use of the remote control it is possible to display the room temperature value read by the indoor unit, or display the current operating setpoint used by the unit. This information is displayed on board the indoor unit's

display. If the unit is on and if the indoor unit display is enabled, pressing the key allows the display of the following values on the indoor unit's display (successive pressing passes from one to the next):

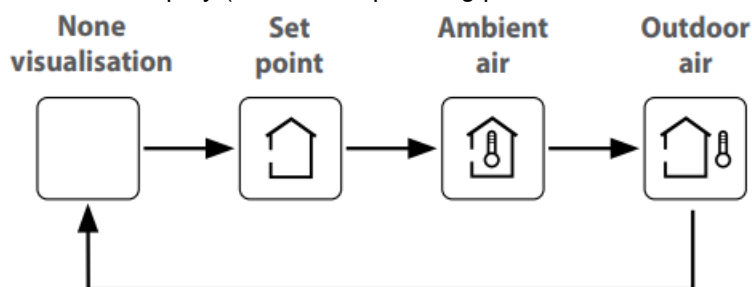

**NOTE:**

The default display on the indoor unit's display is the operating setpoint; the room temperature value is displayed for 3 seconds after which the display returns to the operating setpoint. To display the room temperature again it is necessary to select the corresponding symbol on the remote control.

On some models there is no external air reading (), in these cases the working set () will be displayed again.

**ACTIVATING / DEACTIVATING THE TURBO FUNCTION**



The unit allows the setting of three fan speeds during the various operating modes (except the automatic mode and the dehumidification mode). There is an additional speed called turbo. If the unit is on, pressing the button activates or deactivates this function. If the function is active the icon is shown on the remote control's display.

**ACTIVATING / DEACTIVATING THE NIGHT-TIME COMFORT FUNCTION**

The night-time comfort function controls the air conditioner in an optimal way during the night. The following logic is applied:





- In cooling or dehumidification: the temperature setpoint is gradually increased to guarantee maximum comfort combined with energy saving;
- In heating: the temperature setpoint is gradually decreased to guarantee maximum comfort combined with energy saving;
- If the unit is on (except in automatic or ventilation mode), pressing the activates or deactivates the night time health function. If the function is active the icon is displayed on the remote control.

**NOTE:**

The night time health function is deactivated by switching off the unit, and on restarting will not be active; this function can be activated at any time.

**ACTIVATING / DEACTIVATING THE INDOOR UNIT'S DISPLAY**

*Activating the display on board  
of the indoor unit ▶*



The display on the indoor unit must be activated using the remote control; To activate the display on the front panel of the indoor unit press the button on the remote control.

Once the button is pressed the symbol will appear on the remote control's display, indicating the activation of the display on board of the indoor unit. Pressing the button again deactivates the display.

#### **SETTING OR REMOVING THE BUTTON LOCK**

To lock or remove the lock of the buttons on the remote control, press the and ; buttons simultaneously. The icon on the remote control's display shows that the keypad of the remote control is locked.

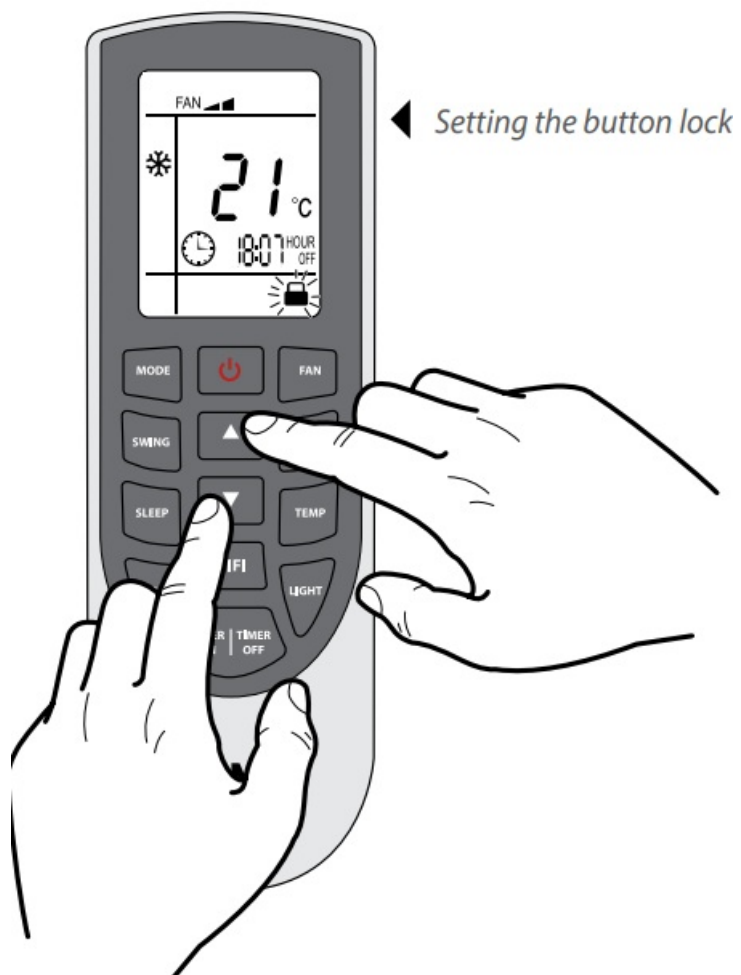

### SETTING THE UNIT OF MEASUREMENT

The unit can display the temperature values in °C or in °F. To change the unit of measurement simultaneously press the and ; buttons with the unit switched off. The temperature value on the remote control's display is automatically converted.



### **ACTIVATING/DEACTIVATING THE ANTI-FREEZE FUNCTION**

In the event that is sought to keep a safety temperature during winter (e.g. a prolonged absence in the place where the unit is installed) the unit has the anti-freeze function, where it keeps the room temperature within the 8°C (during heating mode); while pressing the buttons and the function activates and the icon ( ) shows in the display; in order to deactivate the function press the buttons and at the same time.

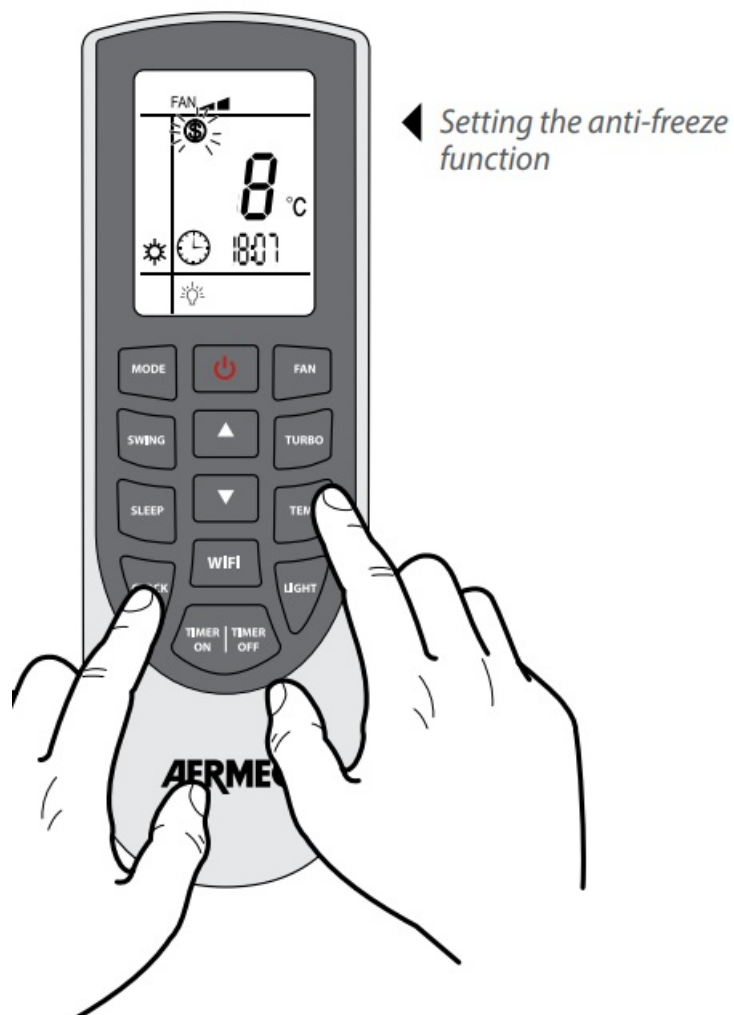

### **ACTIVATING OR DEACTIVATING THE ENERGY SAVING FUNCTION**

The ENERGY SAVING function makes it possible to reach the set temperature with lower energy consumption.

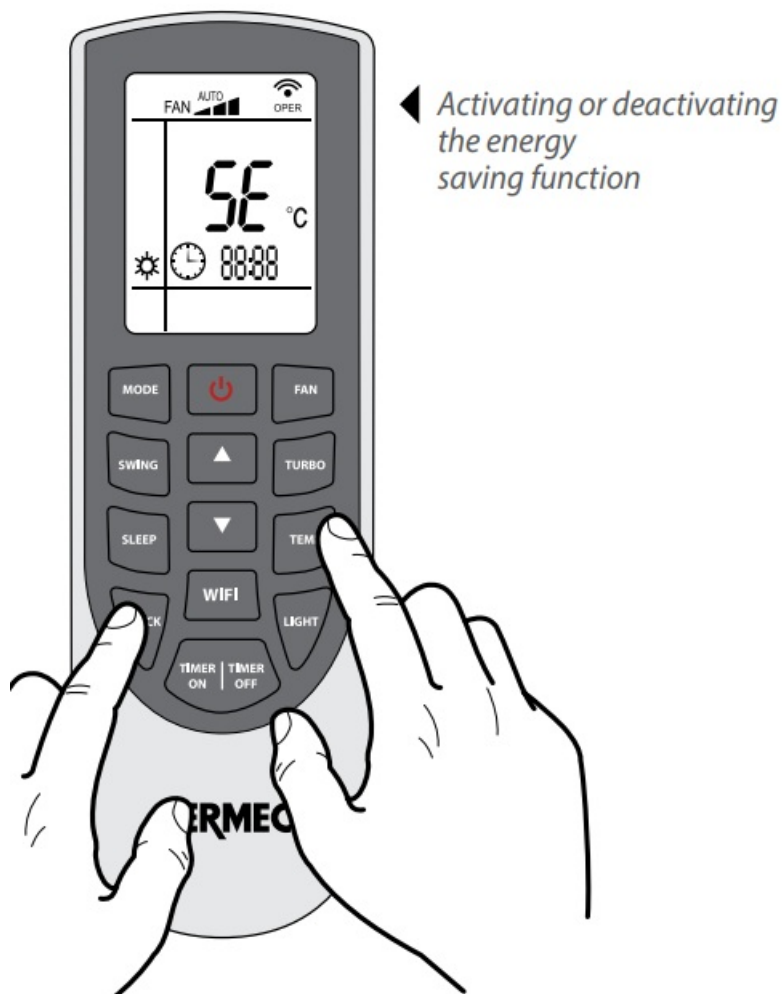

**In COOLING mode:**

simultaneously press + to set the ENERGY SAVING function.

On the remote control display, the icon will appear or disappear to indicate whether the function is activated or deactivated.

**NOTA:**

In ENERGY SAVING mode, the fan speed (set on AUTO) and set temperature cannot be altered. The TURBO and ENERGY SAVING functions cannot work at the same time.

**ACTIVATING/DEACTIVATING THE IFEEL FUNCTION**

The IFEEL function uses a temperature probe inside the infrared remote control in order to communicate the room temperature to the unit and therefore it sets the operation of the unit, to give the maximum comfort to the user. While the unit is on, press at the same time the buttons and to activate and deactivate this function; the display will show or hide the icon (·IF), to indicate whether the function is activated or deactivated.



**NOTE:**

The function uses the set chose by the user, and guarantees a higher comfort if the remote controller is placed near the user (within the maximum distance of 8 meters).

During this function is it recommended to keep the remote away from heating sources that could change the real room temperature reading

**ACTIVATE OR DEACTIVATE THE WIFI FUNCTION (ONLY WITH THE WIFI ACCESSORY INSTALLED)**

The units can be controlled by a **WIFI** system, if the accessory **WIFI** has been planned; to activate or deactivate the **WIFI** function, press the button ; the display shows the icon (  ) indicating that the function is now active.

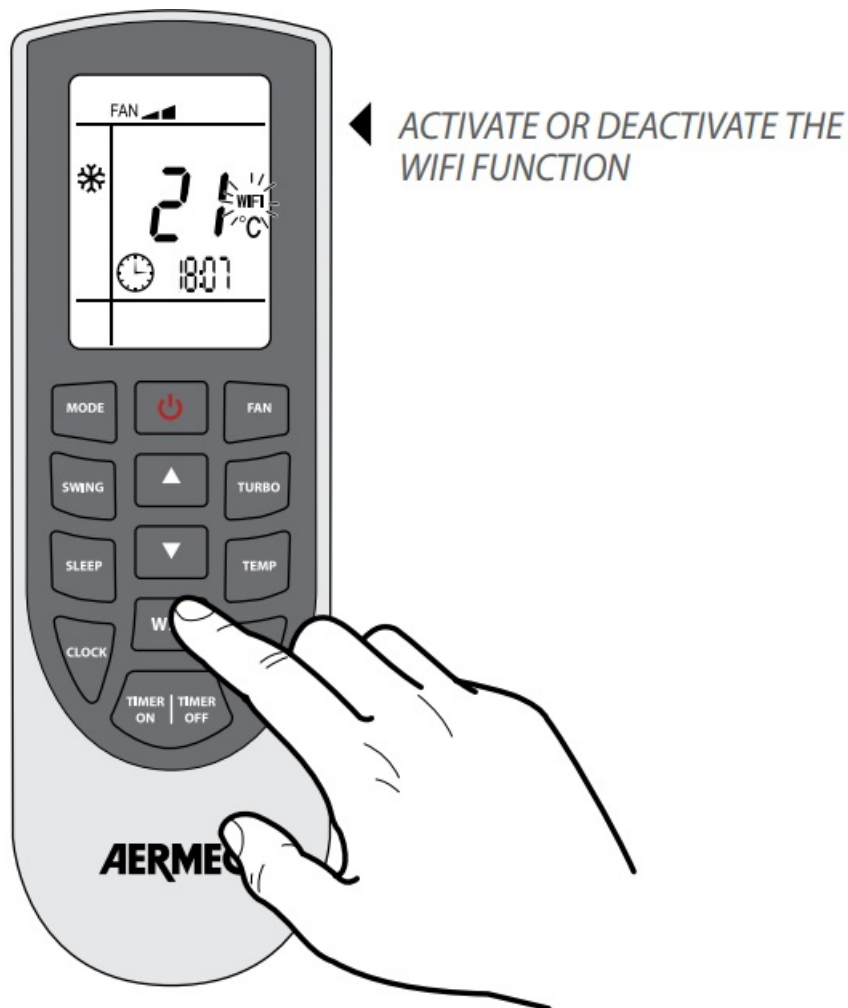

**ATTENTION:**

in order to use this function it's **MANDATORY** to install in the unit the specific accessory **WIFI**.

**WIFI RESET**

To reset the WIFI device with the factory values, while the unit is OFF, press at the same time (for at least one second) the buttons **MODE** and **WIFI** .

**REPLACING THE REMOTE CONTROL'S BATTERIES**

To replace the batteries of the infra-red remote control proceed as follows:

1. Open the battery cover by sliding it in the direction of the arrow.

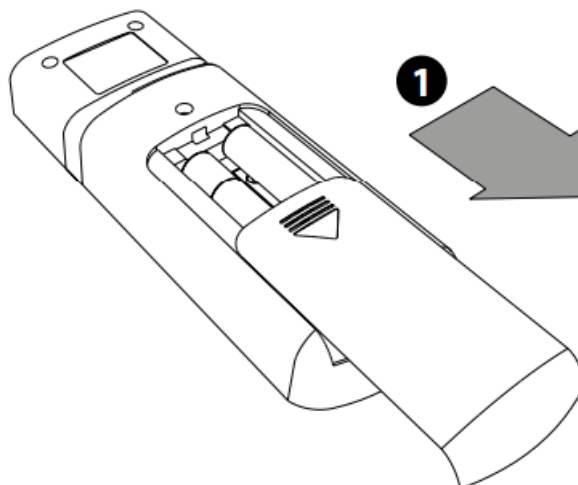

2. Remove the old batteries.



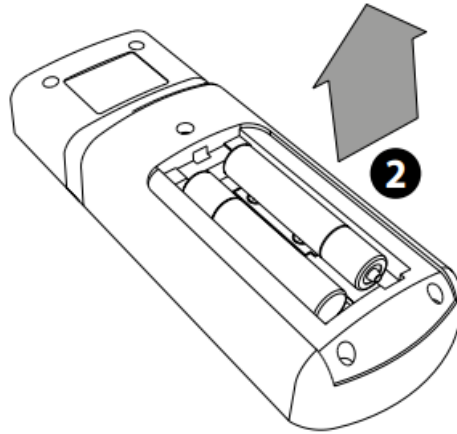

3. Insert two new 1.5V alkaline high performance batteries, type LR03 (AAA), taking care not to reverse the polarity.

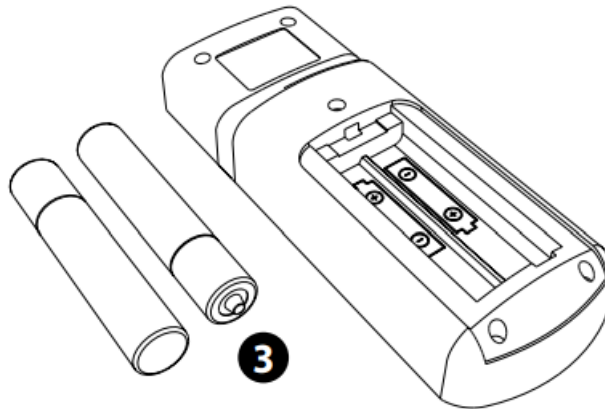

4. Close the battery cover.

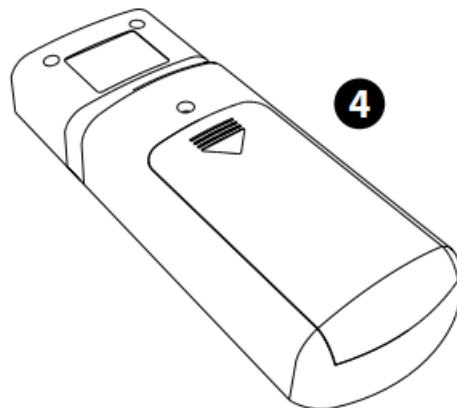

**NOTE:**

- When batteries are replaced use new batteries of the recommended type.
- Remove the batteries if the remote control is not used for extended periods.
- The remote control can emit a signal up to a maximum distance of 7 metres.
- The unit can be affected by signals transmitted by remote controls for televisions, video recorders, or other devices used in the same room.

**WARNING:**

- In the event of loss or damage of the remote control the unit can be started and stopped using the emergency

button.

DODOWNLWNLOOADAD THE THE LA LATETESSTT VER VERSION.



<http://www.aermec.com/qrcode.asp?q=13757>

**AERMEC S.p.A.**

Via Roma, 996 – 37040 Bevilacqua (VR) – Italy

**Tel.** +39 0442 633111 – **Fax** +39 0442 93577

[sales@aermec.com](mailto:sales@aermec.com) – [www.aermec.com](http://www.aermec.com)

**Documents / Resources**

	<p><a href="#">AERMEC Remote Controller</a> [pdf] User Manual Remote Controller, Controller, Remote</p>
-------------------------------------------------------------------------------------	-------------------------------------------------------------------------------------------------------------