



aerauliqa QX Centrifugal Extract Fan Instruction Manual

[Home](#) » [aerauliqa](#) » aerauliqa QX Centrifugal Extract Fan Instruction Manual 



Read this manual carefully before using the product and keep it in a safe place for reference. This product was constructed up to standard and in compliance with regulations relating to electrical equipment and must be installed by technically qualified personnel.

The manufacturer assumes no responsibility for damage to persons or property resulting from failure to observe the regulations contained in this booklet.

Contents

1 Precautions For Installation, use and maintenance

2 INTRODUCTION

3 TECHNICAL SPECIFICATIONS

4 Installation

5 MOUNTING

6 ELECTRICAL WARNING

7 MAINTENANCE/CLEANING

8 DISPOSAL AND RECYCLING

9 Documents / Resources

9.1 References

Precautions For Installation, use and maintenance

- The device should not be used for applications other than those specified in this manual.
- After removing the product from its packaging, verify its condition. In case of doubt, contact a qualified technician. Do not leave packaging within the reach of small children or people with disabilities.
- Do not touch the appliance with wet or damp hands/feet.
- This appliance can be used by children aged from 8 years and above and persons with reduced physical, sensory or mental capabilities or lack of experience and knowledge if they have been given supervision or instruction concerning use of the appliance in a safe way and understand the hazards involved. Children shall not play with the appliance. Cleaning and user maintenance shall not be made by children without supervision.
- Do not use the product in the presence of flammable vapours, such as alcohol, insecticides, gasoline, etc.
- If any abnormalities in operation are detected, disconnect the device from the mains supply and contact a qualified technician immediately. Use original spare parts only for repairs.
- The electrical system to which the device is connected must comply with regulations.
- Before connecting the product to the power supply or the power outlet, ensure that: – the data plate (voltage and frequency) correspond to those of the electrical mains – the electrical power supply/socket is adequate for maximum device power. If not, contact a qualified technician.
- The device should not be used as an activator for water heaters, stoves, etc., nor should it discharge into hot air/fume vent ducts deriving from any type of combustion unit. It must expel air outside via its own special duct.
- Operating temperature: 0°C up to +50°C.
- The device is designed to extract clean air only, i.e. without grease, soot, chemical or corrosive agents, or flammable or explosive mixtures.
- Do not leave the device exposed to atmospheric agents (rain, sun, snow, etc.).
- Do not immerse the device or its parts in water or other liquids.
- Turn off the main switch whenever a malfunction is detected or when cleaning.

- For installation an omnipolar switch should be incorporated in the fixed wiring, in accordance with the wiring regulations, to provide a full disconnection under overvoltage category III conditions (contact opening distance equal to or greater than 3mm).
- If the supply cord is damaged, it must be replaced by the manufacturer, its service agent or similarly qualified persons in order to avoid a hazard.
- Do not obstruct the fan or exhaust grille to ensure optimum air passage.
- Ensure adequate air return into the room in compliance with existing regulations in order to ensure proper device operation.
- If the environment in which the product is installed also houses a fuel-operating device (water heater, methane stove etc., that is not a “sealed chamber” type), it is essential to ensure adequate air intake, to ensure good combustion and proper equipment operation.
- Install the product so that the impeller is not accessible from the air outlet side as verified by contact with the Test Finger (test probe “B” of the norm EN61032) in compliance with the current safety regulations.
- Ceiling installation In order to guarantee the IPX4 degree of protection against moisture in case of ceiling installation, use the appropriate ceiling mount kit, which is not included. Use only the rear entry hole for supply cables. If there is a possibility of condensation along the air discharge duct, provide a drainage system to prevent condensation from discharging into the environment through the fan. Attention: do not mount the product on the ceiling without this kit.
- Recessed installation In case of recessed installation in plasterboard walls, the specific fixing kit must be used (accessory on request).

INTRODUCTION

QX is a centrifugal fan designed to ensure air extraction in small/medium-sized rooms such as bathrooms, toilets and kitchens. Suitable for air discharge through long length ducting. Wall or ceiling installation, surface or recessed in plasterboard walls (fig. 1).

TECHNICAL SPECIFICATIONS

- Material: High quality, impact and UV-resistant ABS colour RAL 9010.
- Design front cover removable for cleaning without the use of tools
- Removable filter in PP to protect the impeller and the motor from dust.
- Highly quality forward-curved impeller for high performance and top silence.
- Single phase 2-speed motor with integral thermal protection.
- Motor mounted on ball bearings that guarantee a longer product life cycle (30,000h) and suitable for cold climates.
- The fan is double insulated: no earth connection is required.
- Suitable for continuous or intermittent operation.
- IPX4 degree of protection.
- Power supply 220V to 240V- 50/60Hz.

VERSIONS

STANDARD

The fan is operated using a separate ON/OFF switch or via a light switch (fig. 48A).

WITH TIMER (over-run)

The fan is provided with a timer circuit which is adjustable from approx. 1 minute to 25 minutes via trimmer (fig. 49A). Operation: connected according to the diagram in fig. 48B, after the light is switched on, the fan activates with a delay of max 1.5 seconds. After the light is switched off, the fan continues to function for a pre-set period of

time.

STANDARD

The fan is operated using a separate ON/OFF switch or via a light switch (fig. 48A). WITH TIMER (over-run) The fan is provided with a timer circuit which is adjustable from aprox. 1 minute to 25 minutes via trimmer (fig. 49A). Operation: connected according to the diagram in fig. 48B, after the light is switched on, the fan activates with a delay of max 1.5 seconds. After the light is switched off, the fan continues to function for a pre-set period of time.

WITH HUMIDISTAT & TIMER

The fan is equipped with a humidity detector, whose threshold is adjustable from 50% to 95% Relative Humidity, and with a timer which is adjustable from aprox. 1 minute to 25 minutes via corresponding trimmer (fig. 49B). Turn the trimmer HY completely clockwise and the humidistat function is deactivated. Automatic humidistat operation: connected according to the diagram in fig. 48B, when the percentage of Relative Humidity exceeds the pre-set intervention threshold, the fan starts up automatically. When the percentage of Relative Humidity goes below the threshold, the fan continues to function for a pre-set period of time. Operation with switch connection: connected according to the diagram in fig. 48B, after the light is switched on, the fan activates with a delay of aprox. 1.5 seconds. After it is switched off, the fan continues to function for a pre-set period of time.

Attention: when the relative humidity level is higher than the pre-set threshold, automatic operation with humidistat has priority over manual operation, or rather the fan cannot be stopped via switch.

Installation

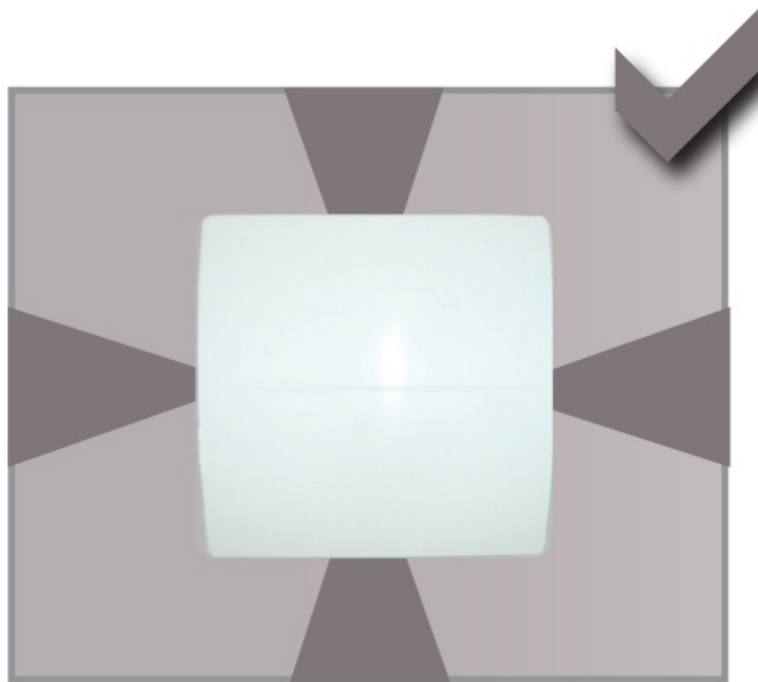

perimetrical exhausting

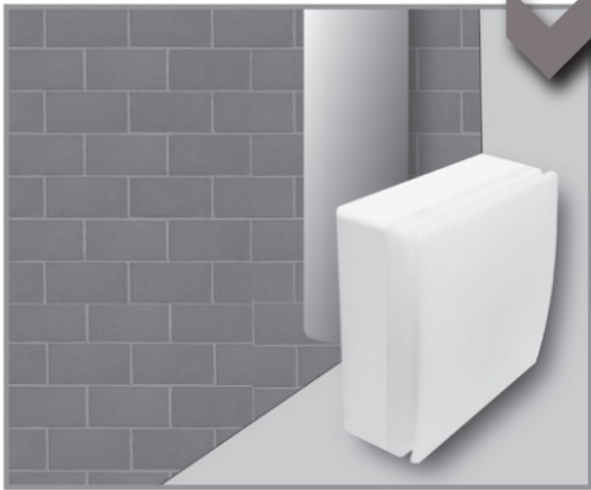

wall – surface

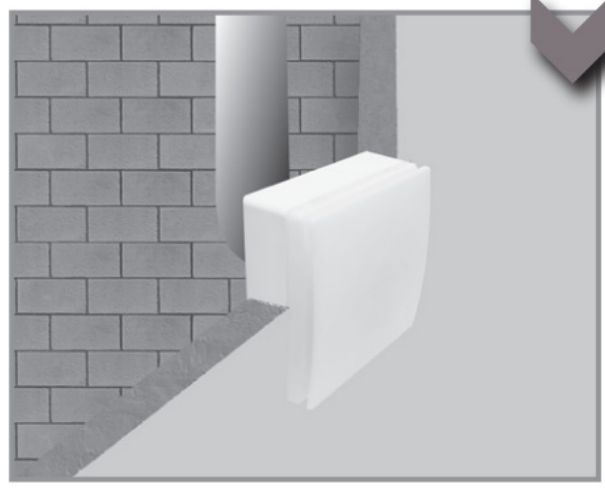

wall – recessed (accessory on demand)

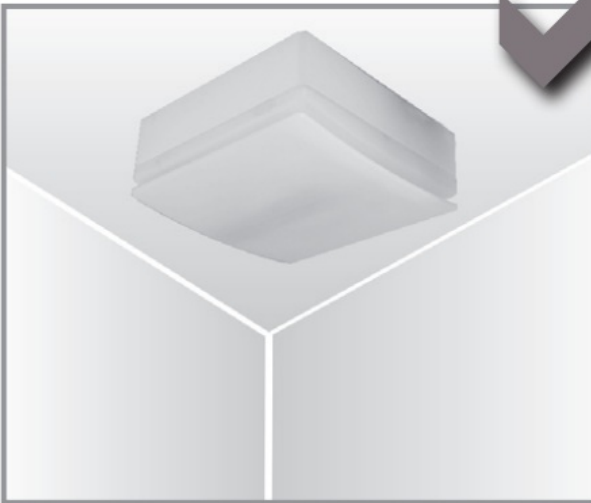

ceiling – surface (accessory on demand)

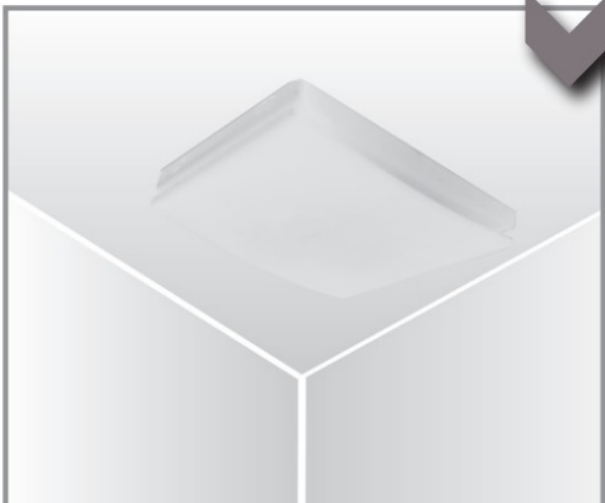

ceiling – recessed (accessory on demand)

MOUNTING

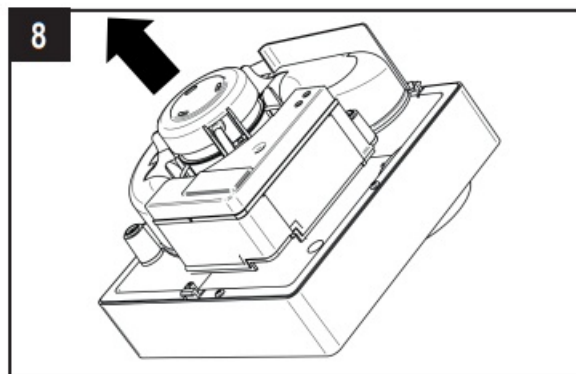
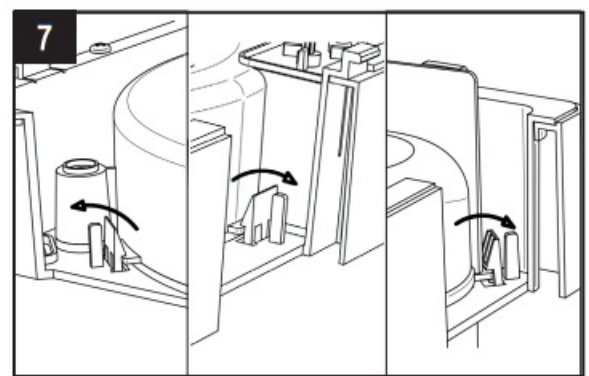
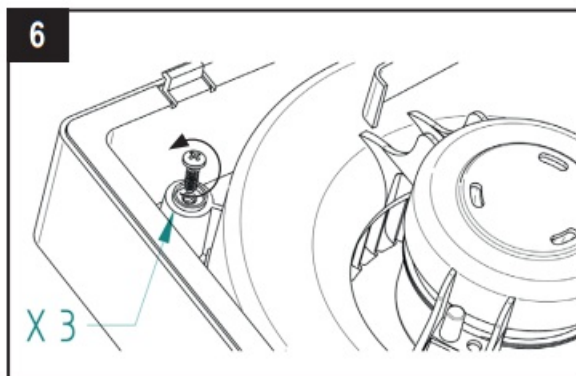
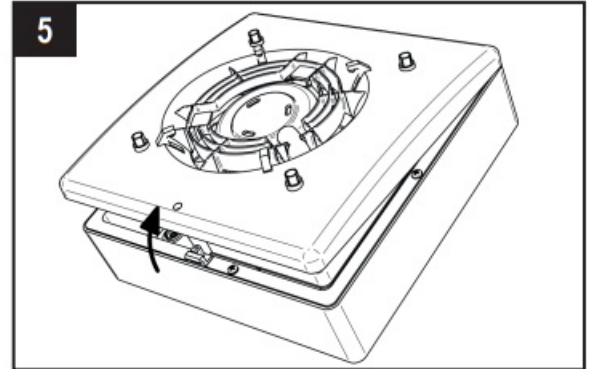
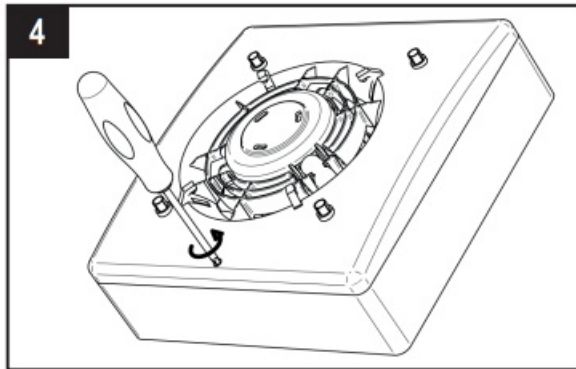
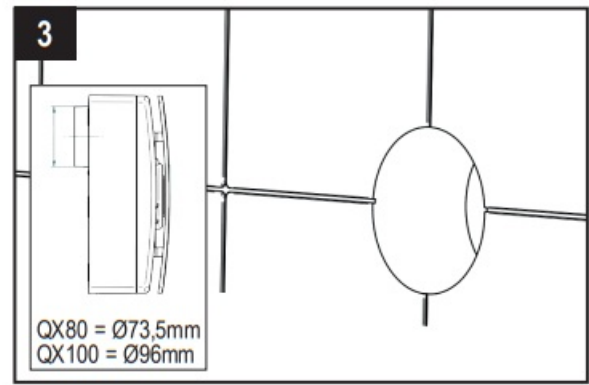
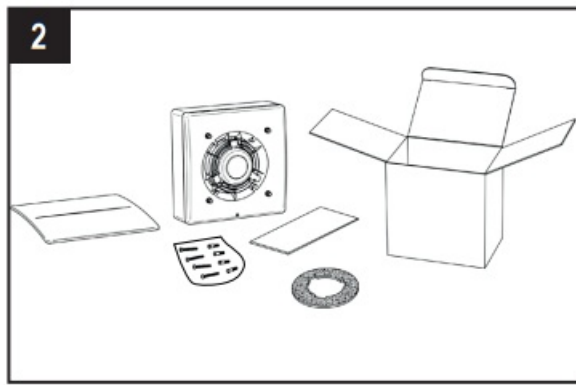

KABEL POWIERZCHNIOWY

A

H03VV-F ; H05VV-F

BASE/STD $\begin{cases} 2 \times 0,5 \div 1,5 \text{ mm}^2 \\ 3 \times 0,5 \div 1,5 \text{ mm}^2 \end{cases}$
T-HT $\begin{cases} 3 \times 0,5 \div 1,5 \text{ mm}^2 \\ 4 \times 0,5 \div 1 \text{ mm}^2 \end{cases}$

9A

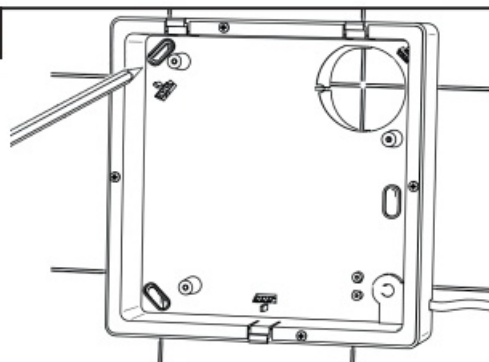

10A

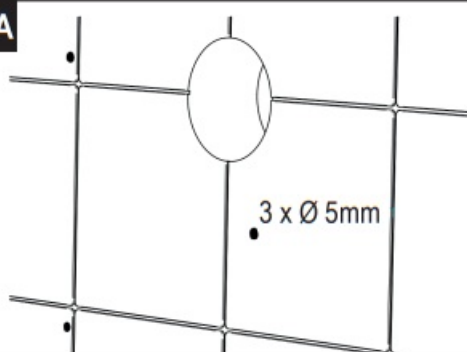

11A

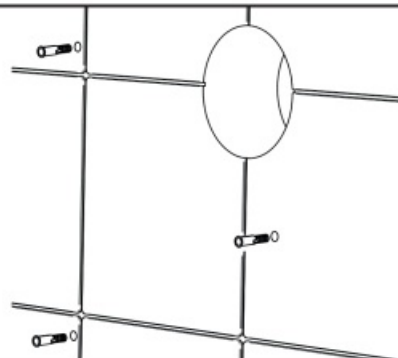

12A

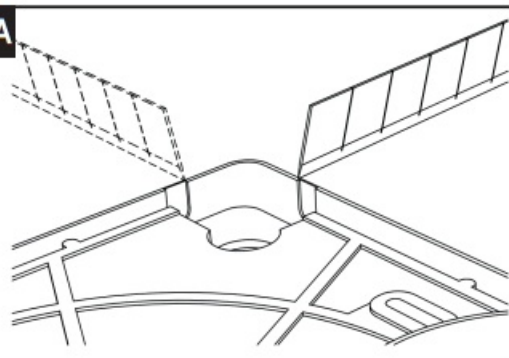

13A

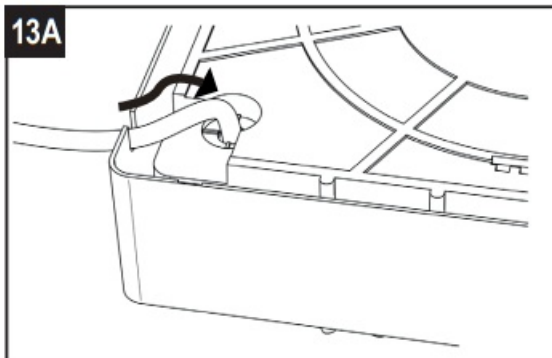

14A

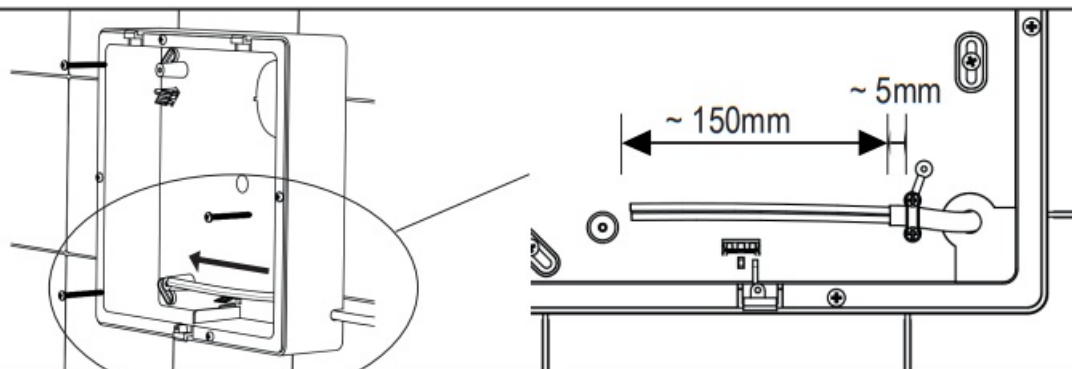

RECESSED CABLE ENTRY

B

H03VV-F ; H05VV-F

BASE/STD $\left\{ \begin{array}{l} 2 \times 0,5 \div 1,5 \text{ mm}^2 \\ 3 \times 0,5 \div 1,5 \text{ mm}^2 \end{array} \right.$
T-HT $\left\{ \begin{array}{l} 3 \times 0,5 \div 1,5 \text{ mm}^2 \\ 4 \times 0,5 \div 1 \text{ mm}^2 \end{array} \right.$

9B

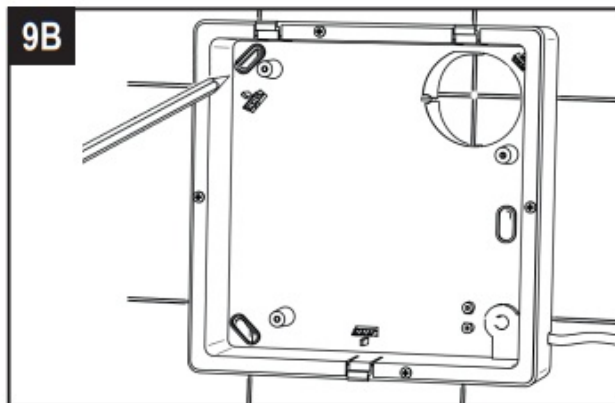

10B

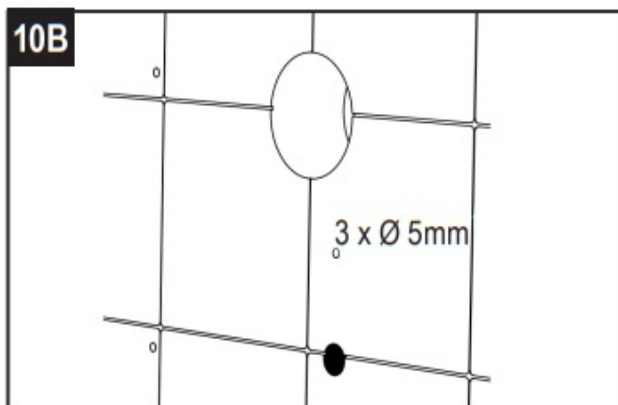

11B

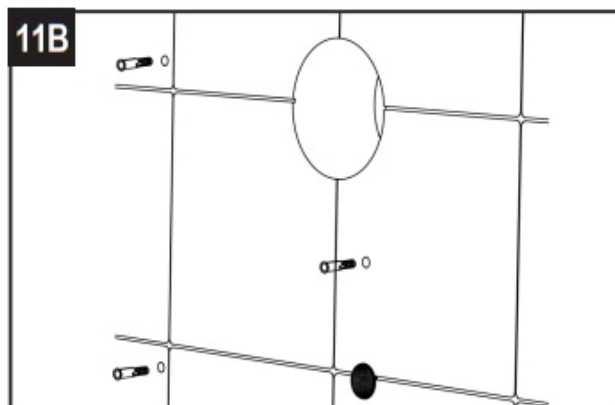

12B

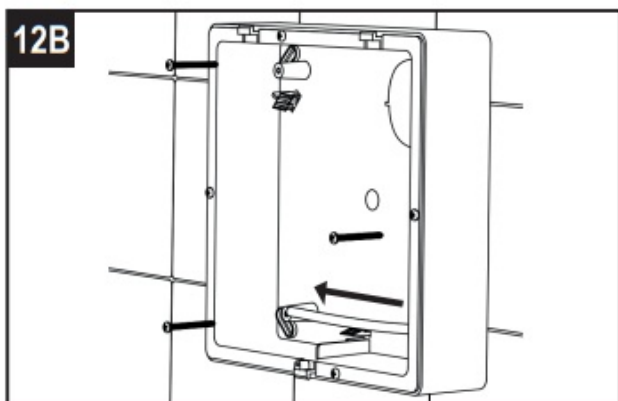

13B

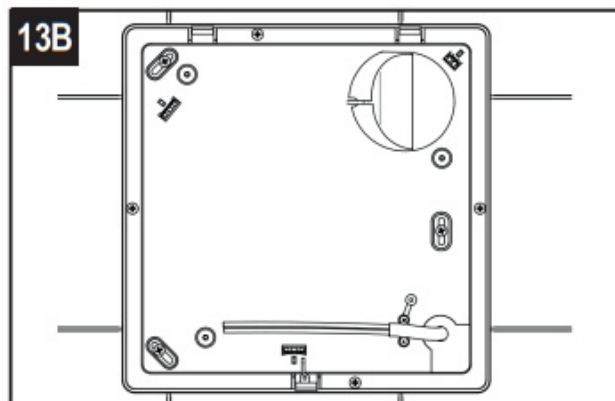

14B

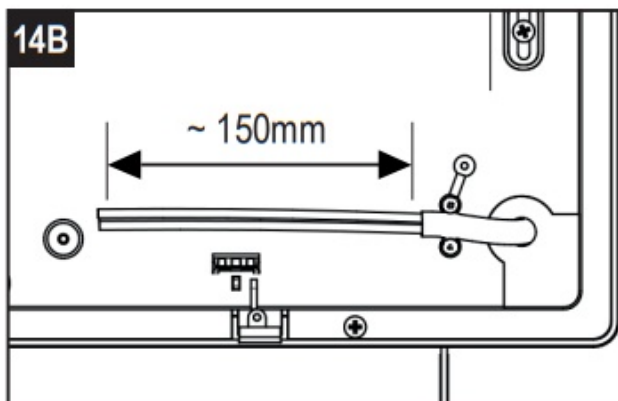

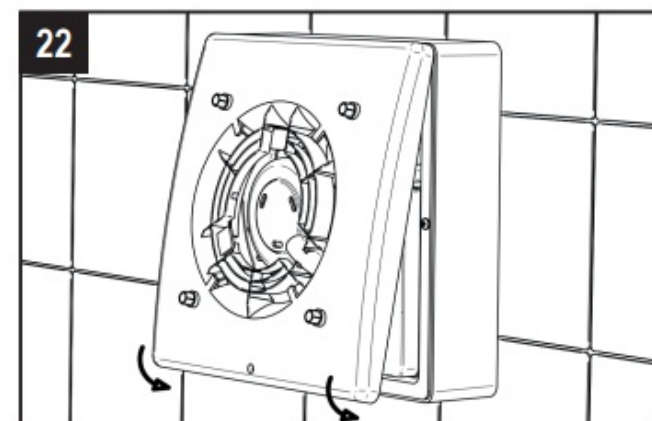
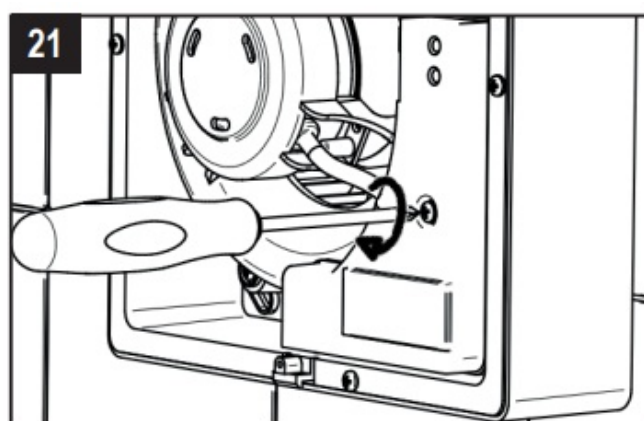
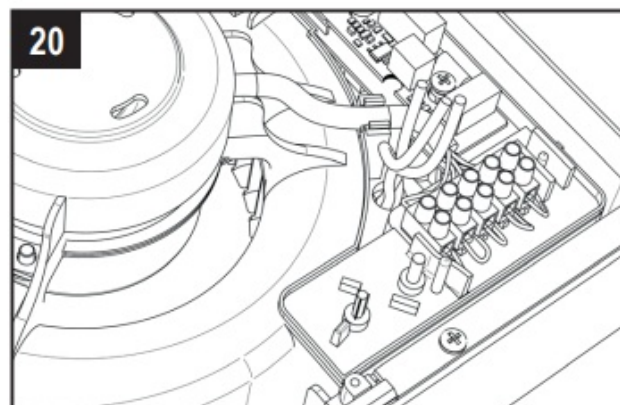
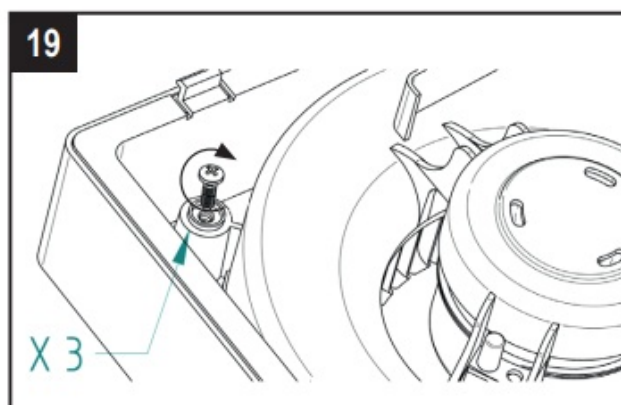
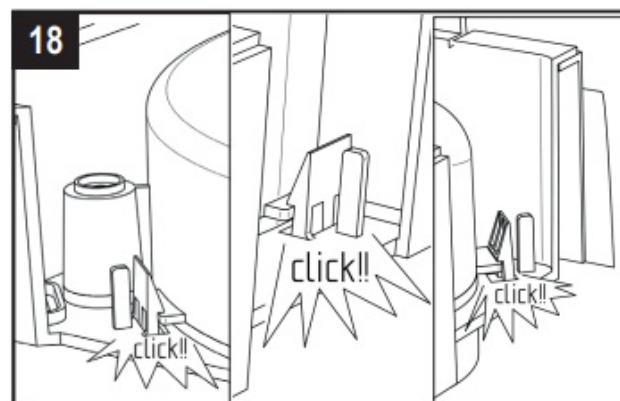
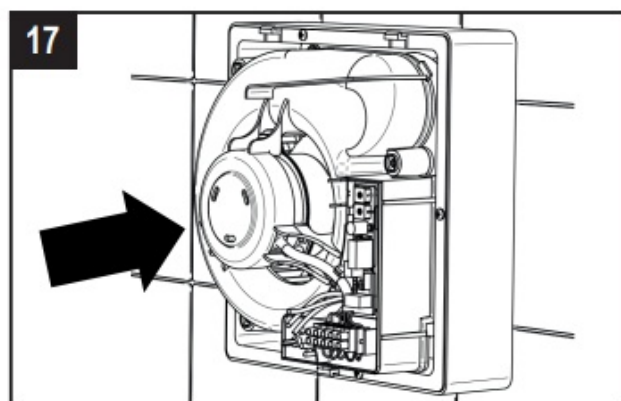
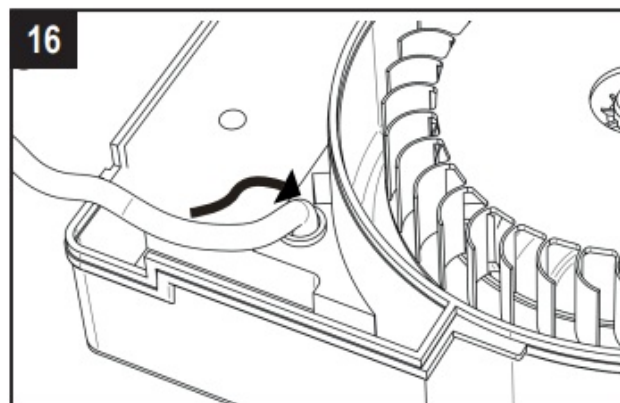
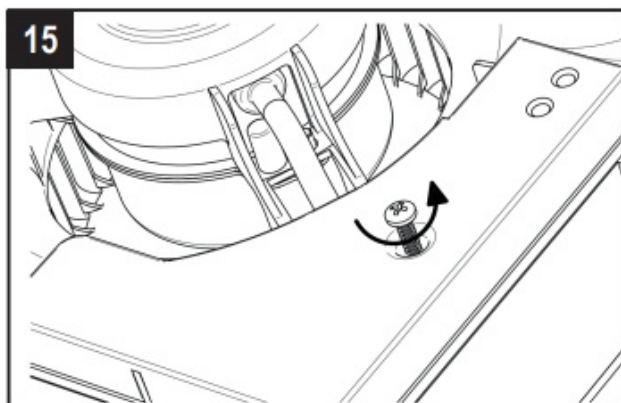

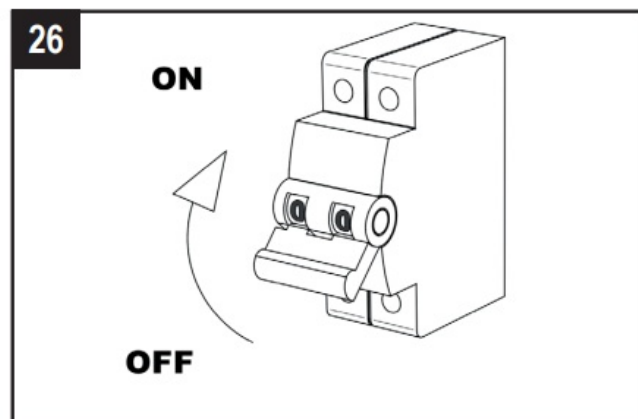
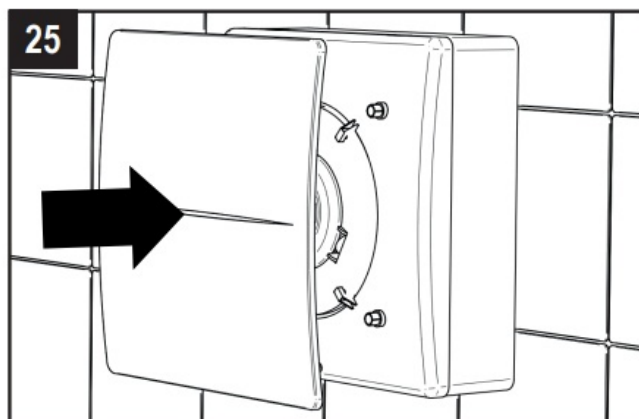
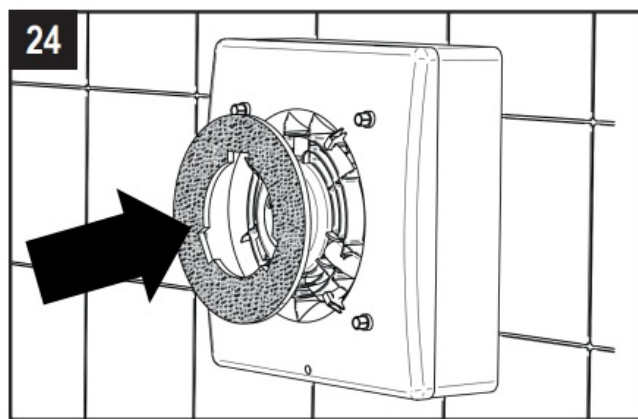
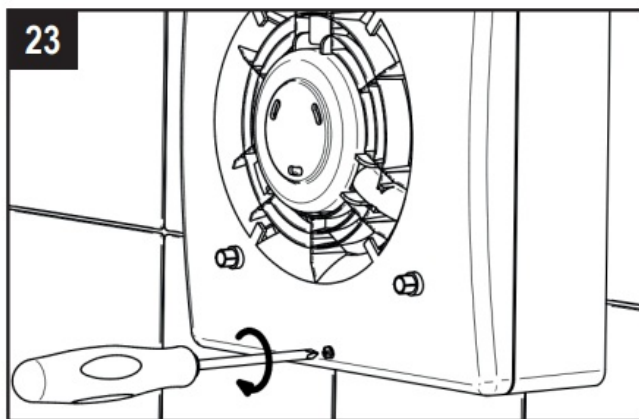

PLASTERBOARD FIXING KIT (ACCESSORY ON REQUEST) – KIT DE FIXATION PLAQUE DE PLATRE
(ACCESSOIRE SUR

RECESSED CABLE ENTRY

H03VV-F ; H05VV-F

BASE/STD $\begin{cases} 2 \times 0,5 \div 1,5 \text{ mm}^2 \\ 3 \times 0,5 \div 1,5 \text{ mm}^2 \end{cases}$

T-HT $\begin{cases} 3 \times 0,5 \div 1,5 \text{ mm}^2 \\ 4 \times 0,5 \div 1 \text{ mm}^2 \end{cases}$

27

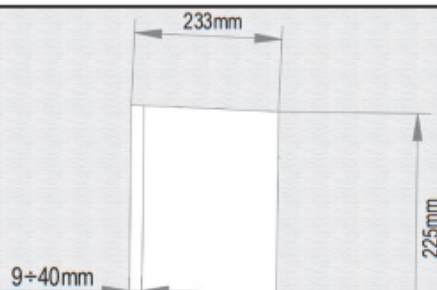

28

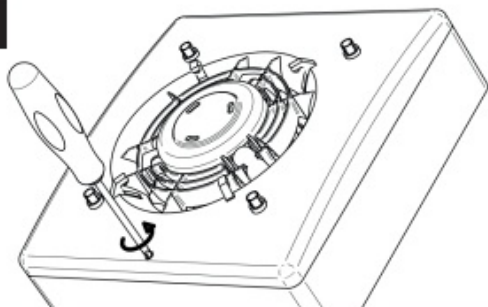

29

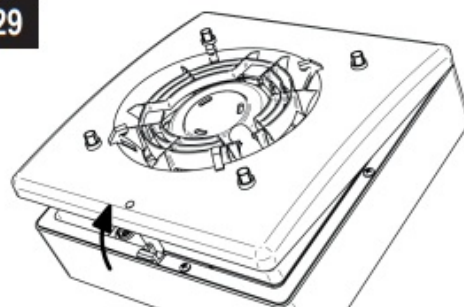

30

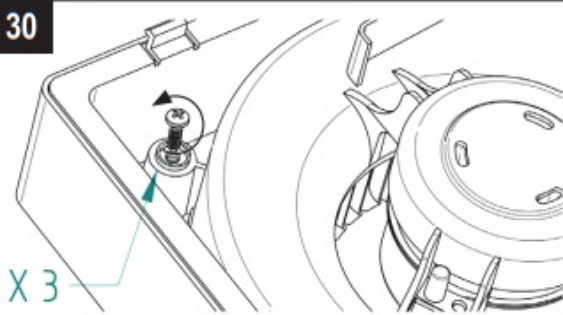

31

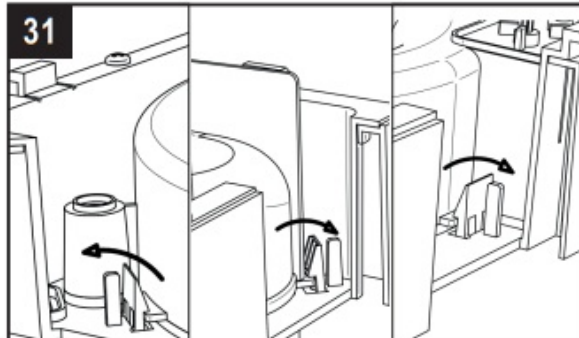

32

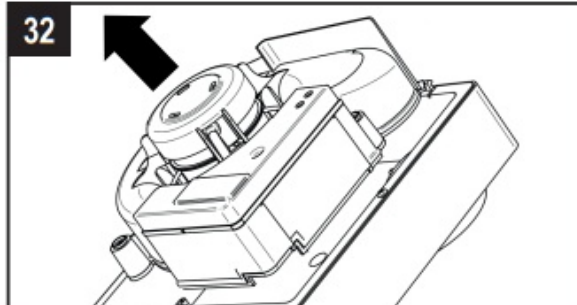

33

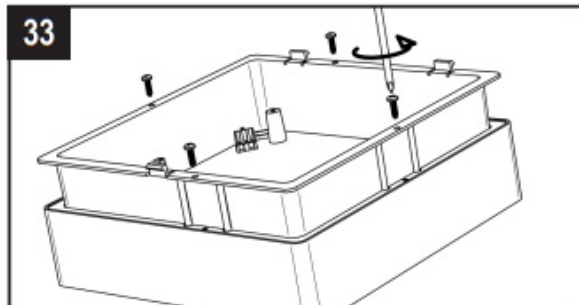

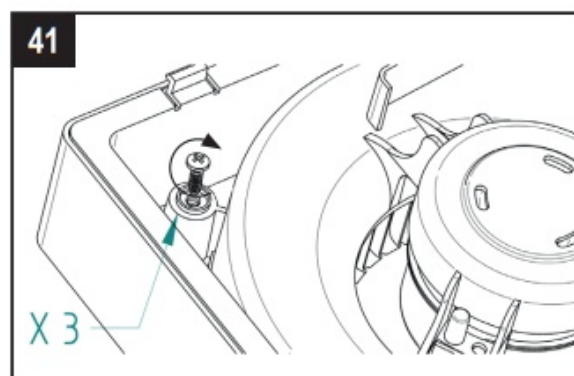
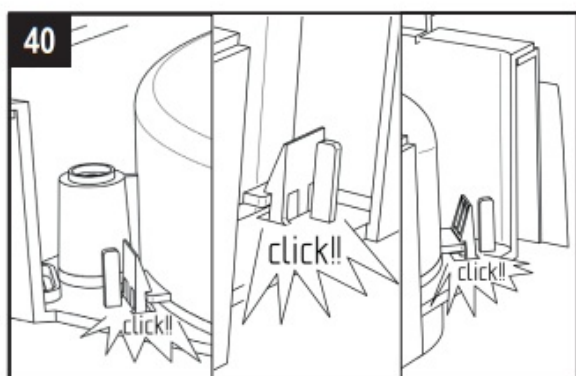
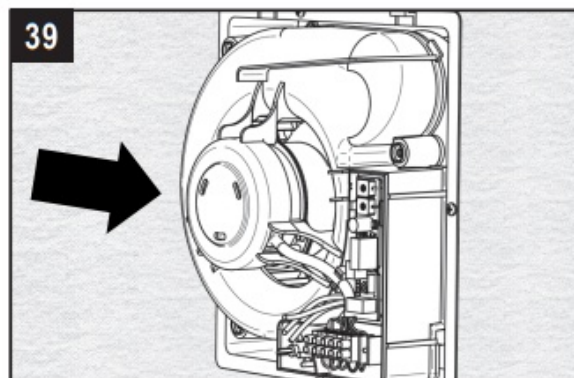
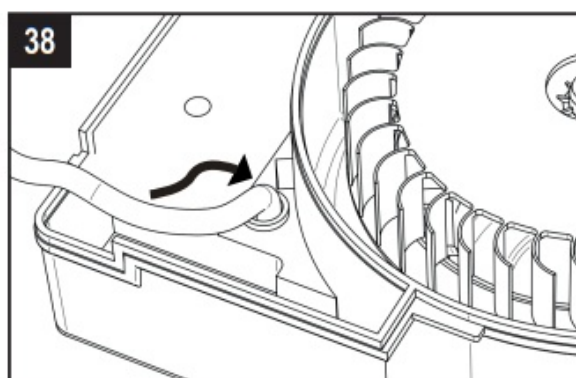
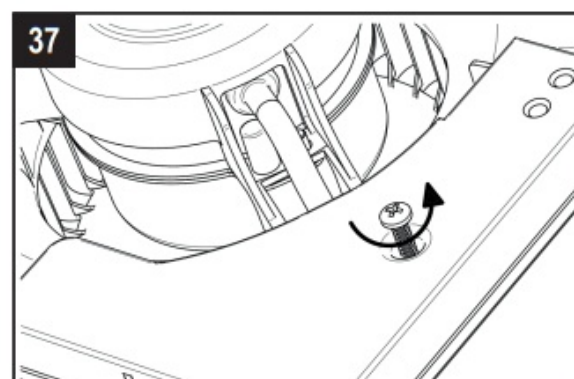
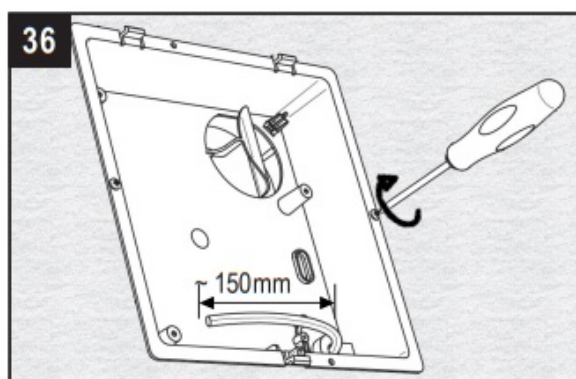
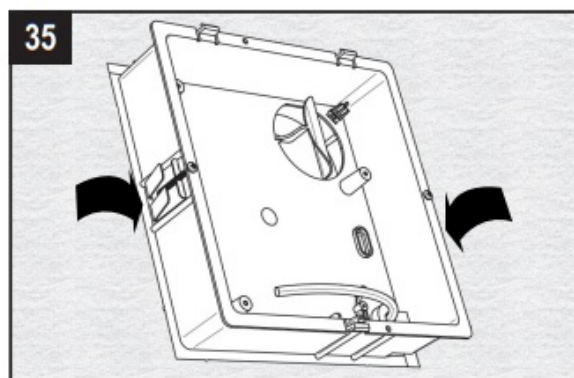
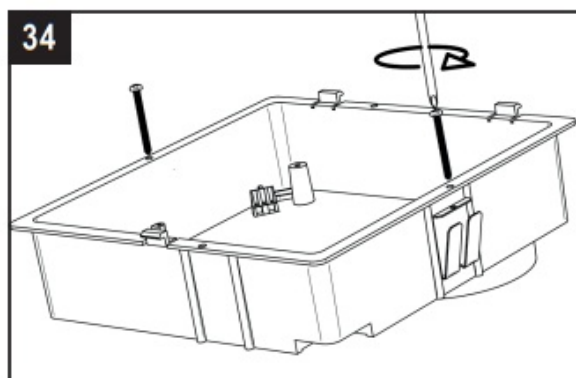

WIRING DIAGRAM: PAGE 40

42

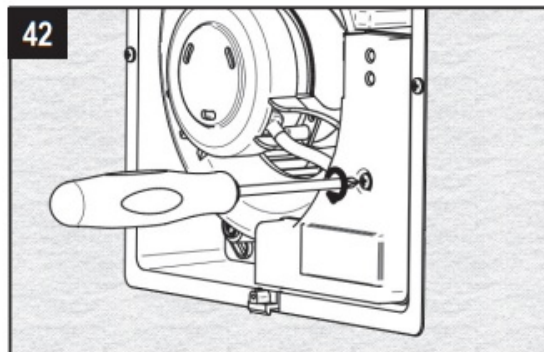

43

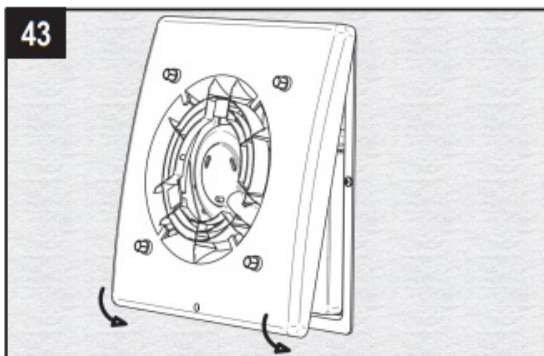

44

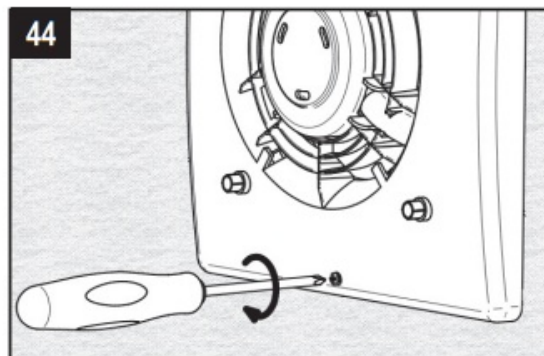

45

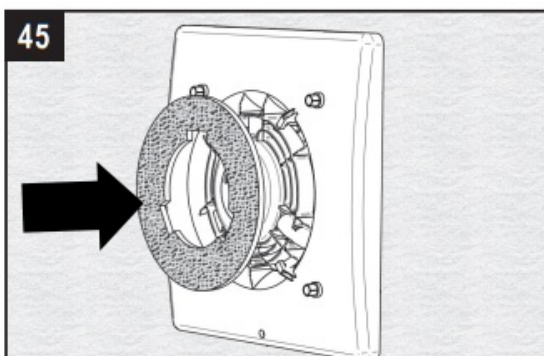

46

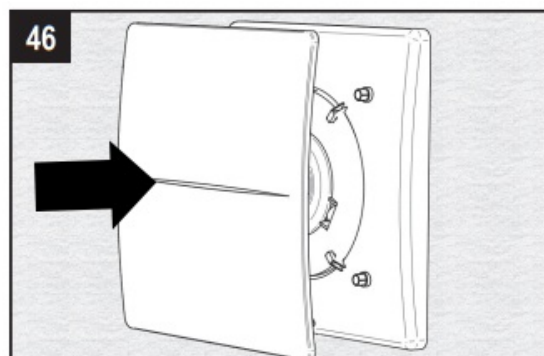

47

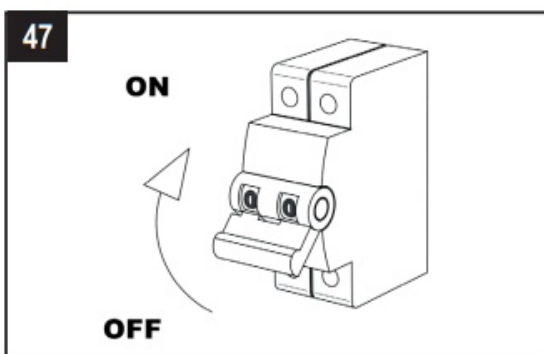

ELECTRICAL WARNING

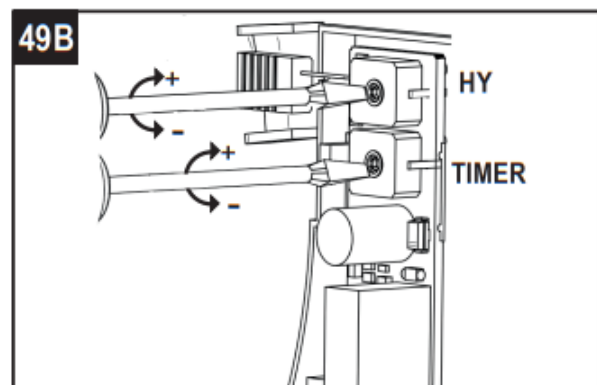
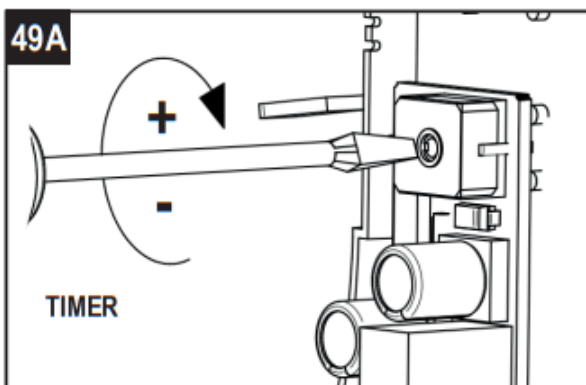
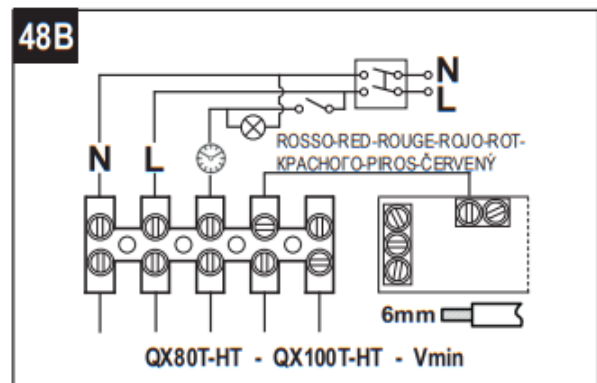
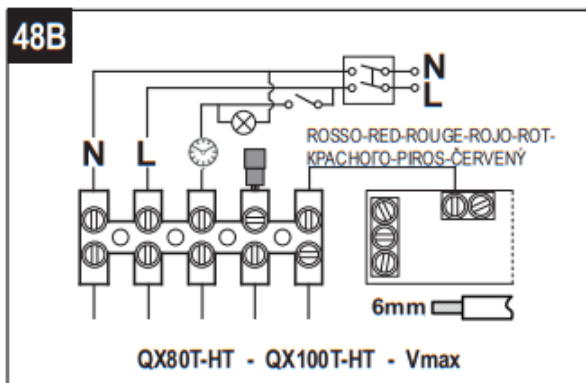
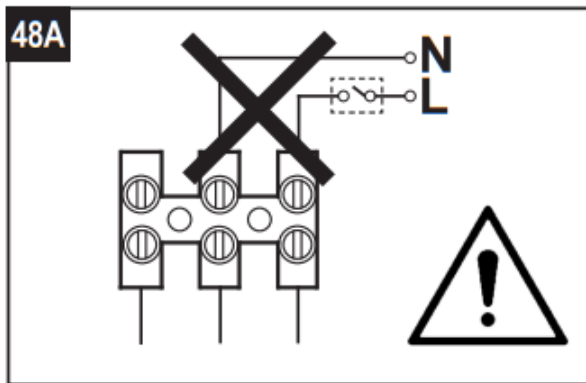
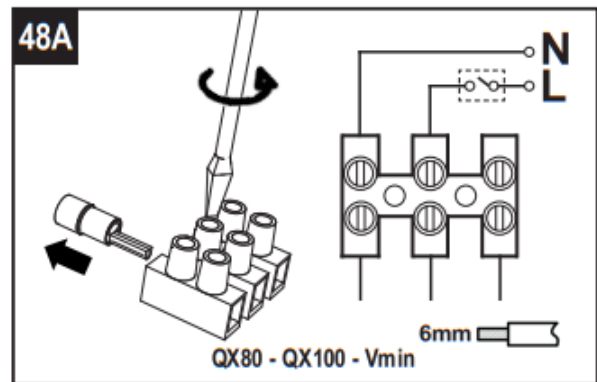
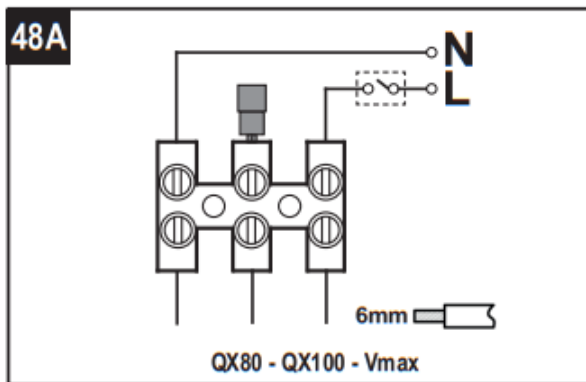

MAINTENANCE/CLEANING

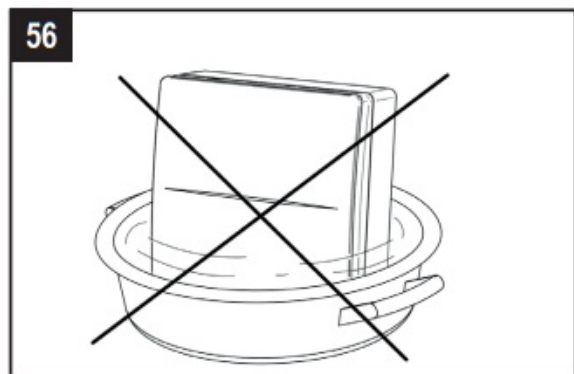
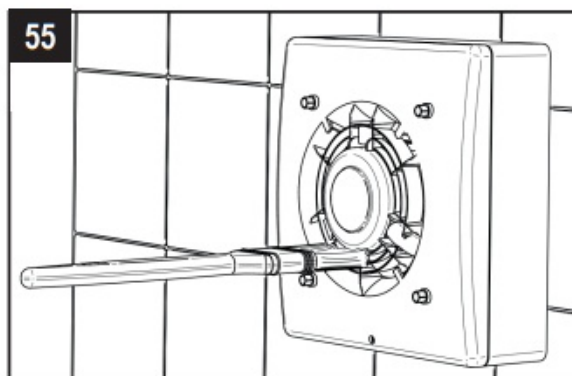
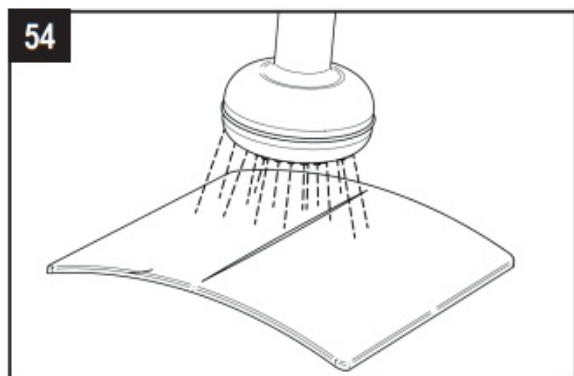
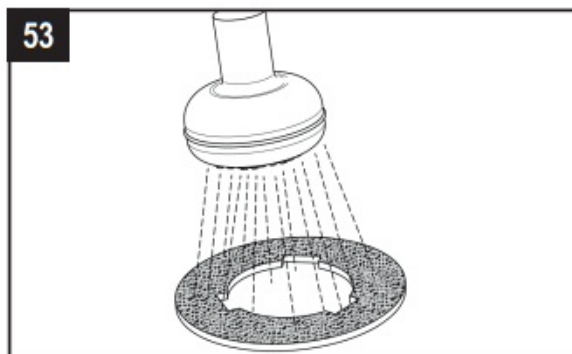
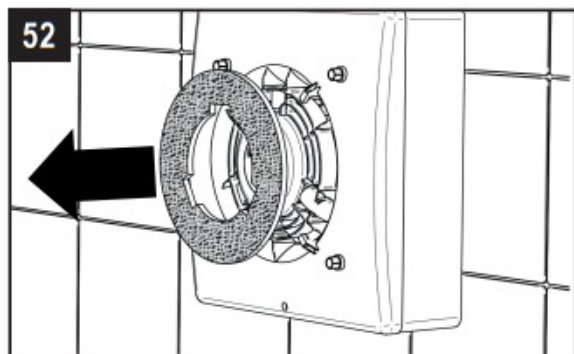
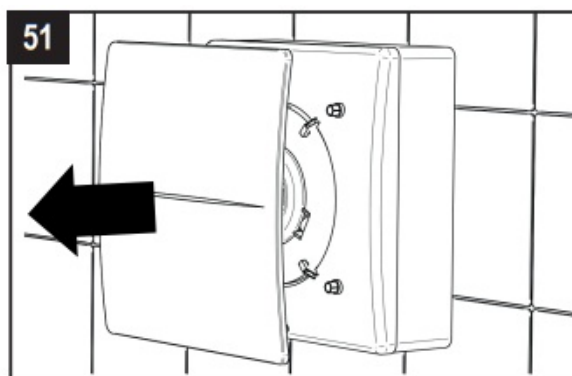
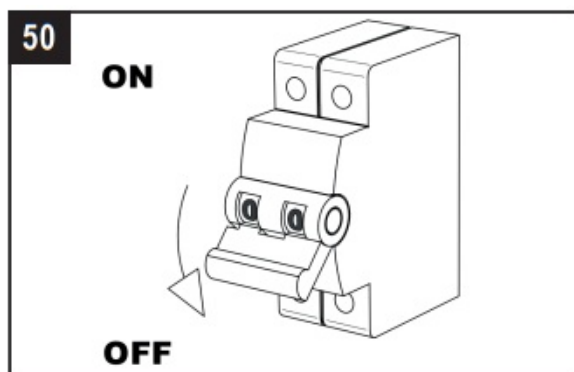

DISPOSAL AND RECYCLING

Information on disposal of units at the end of life. This product complies with EU Directive 2002/96/EC. The symbol of the crossed-out dustbin indicates that this product must be collected separately from other waste at the end of its life. The user must, therefore, dispose of the product in question at suitable electronic and electro-technical waste disposal collection centres, or else send the product back to the retailer when purchasing a new, equivalent type device. Separate collection of decommissioned equipment for recycling, treatment and environmentally compatible disposal helps to prevent negative effects on the environment and on health and promotes the recycling of the materials that make up the equipment. Improper disposal of the product by the user may result in administrative sanctions as provided by law.

a)	Mark	—
b)	Model	—
c)	SEC class	—
c1)	SEC warm climates	kWh/m ² .a κBт/м ² .a
c2)	SEC average climates e	kWh/m ² .a κBт/м ² .a
c3)	SEC cold climates	kWh/m ² .a κBт/м ² .a
	Energy label	—
d)	Unit typology	—
e)	Type of drive	—
f)	Type of Heat Recovery System	—
g)	Thermal efficiency of heat recovery	%
h)	Maximum flow rate	m ³ /h м ³ /час
i)	Electric power input at maximum flow rate –	W Bт
j)	Sound power level (LWA)	dBA Дб
k)	Reference flow rate	m ³ /h м ³ /час
l)	Reference pressure difference	Pa Па
m)	Specific power input (SPI)	W/m ³ /h Bт/м ³ /час
n1)	Control factor	—
n2)	Control typology	—
o1)	Maximum internal leakage rate	%

Dirctive

AERAULIKA	
QX80, QX80T QX100, QX100T	QX80HT QX100HT
F	C
0,8	-7,7
-8,6	-23,2
-25	-50,2
Het	
Residential	
single speed drive	
absent	
N/A; –	
104	104
28	28
59	59
104	104
10	10
0,274	0,274
1	0,65
Manual control	Manual control (no DCV)
N/A; –	

o2)	Maximum external leakage rate	%
p1)	Internal mixing rate	%
p2)	External mixing rate	%
q)	Visual filter warning	—
r)	Instructions to install regulated grilles	—
s)	Internet address for pre/disassembly instructions	—
t)	Airflow sensitivity to pressure variations	%
u)	Indoor/outdoor air tightness	m ³ /h m ³ /час
v1)	AEC – Annual electricity consumption	kWh кВт *ч
v2)	AEC – Annual electricity consumption	kWh кВт *ч
v3)	AEC – Annual electricity consumption	kWh кВт *ч
w1)	Annual heating saved – warm climates	kWh кВт *ч

AERAULIQA	
QX80, QX80T QX100, QX100T	QX80HT QX100HT
F	C
0,8	-7,7
-8,6	-23,2
-25	-50,2
Het	
Residential –	
single speed drive	
absent	
N/A; –	
104	104
28	28
59	59
104	104
10	10
0,274	0,274
1	0,65
Manual control (no DCV)	Manual control (no DCV)
N/A; –	



Registered office

C.F. e P.IVANAT 03369930981 – REA BS-528635

Tel: +39 030 674681 –

Fax: +39 030 6872149 – www.aerauliqa.com – info@aerauliqa.it

Aerauliqa sri reserves the right to modify/make improvements to products and/or this instruction manual at any time and without prior notice.

CFI0002Q – 12 – 0323

Documents / Resources

 <p>QX</p> <p>CEC 100</p> <p>INDICE</p> <ul style="list-style-type: none">1. INFORMAZIONI GENERALI2. INFORMAZIONI TECNICHE3. INFORMAZIONI DI SICUREZZA4. INFORMAZIONI DI INSTALLAZIONE5. INFORMAZIONI DI MANUTENZIONE6. INFORMAZIONI DI SMONTAGGIO7. INFORMAZIONI DI IMBALLAGGIO8. INFORMAZIONI DI TRASPORTO9. INFORMAZIONI DI CONSEGNA10. INFORMAZIONI DI GARANZIA11. INFORMAZIONI DI RITORNO12. INFORMAZIONI DI RIFIUTO	<p>aerauliqa QX Centrifugal Extract Fan [pdf] Instruction Manual</p> <p>QX Centrifugal Extract Fan, QX, Centrifugal Extract Fan, Extract Fan, Fan</p>
---	---

References

- [AERAULIQA – Air & Life Quality](#)

Manuals+.