

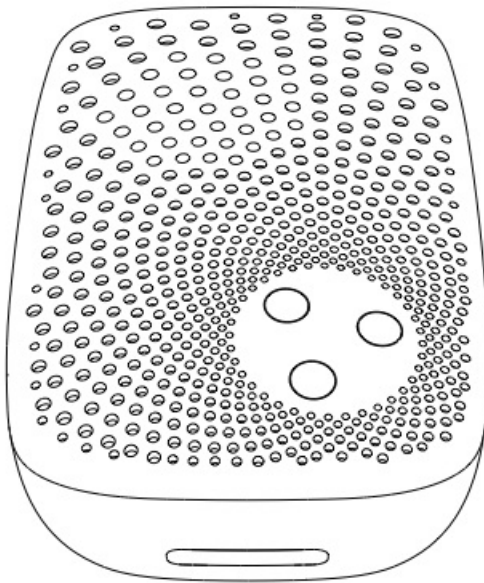

## Siren Gen 5 user guide. Print

[Home](#) » [Aeotec](#) » Siren Gen 5 user guide. Print 

### Aeotec Siren Gen5.



Aeotec Siren Gen5 has been crafted to power connected lighting using [Z-Wave Plus](#). It is powered by Aeotec's [Gen5](#) technology. You can find out more about [Siren Gen5](#) by following that link.

To see whether Siren Gen5 is known to be compatible with your Z-Wave system or not, please reference our [Z-Wave gateway comparison](#) listing. The [technical specifications of Siren Gen5](#) can be viewed at that link.

### Get to Know your Siren.

- Action Button
- 106dB speaker system
- Safety LEDs
- Network LED

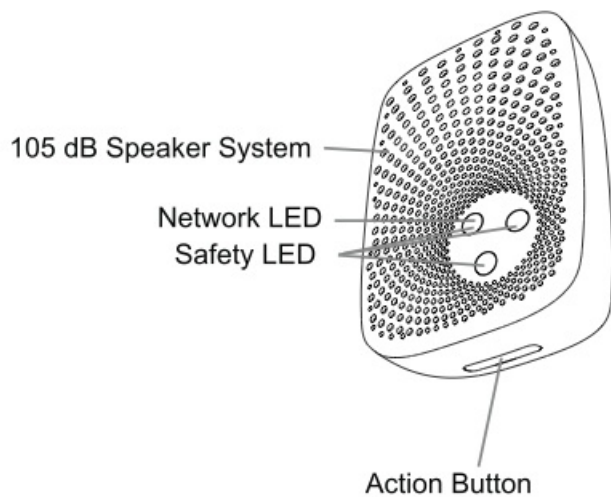

### **Important safety information.**

Please read this and other device guides carefully. Failure to follow the recommendations set forth by Aeotec Limited may be dangerous or cause a violation of the law. The manufacturer, importer, distributor, and / or reseller will not be held responsible for any loss or damage resulting from not following any instructions in this guide or in other materials.

Keep product away from open flames and extreme heat. Avoid direct sun light or heat exposure.

Siren Gen5 is intended for indoor use in dry locations only. Do not use in damp, moist, and / or wet locations.

### **Quick Start.**

Getting your Siren up and running is as simple as plugging it into a wall socket and linking it to your existing Z-Wave network. The following instructions tell you how to link your Siren to your Z-Wave network.

### **Pairing your Siren Gen5 into your existing Z-Wave network.**

1. Place your gateway or controller into Z-Wave pair or inclusion mode. (Please refer to your controller/gateway manual on how to do this)
2. Press the Action Button on your Siren Gen5, and its LED will blink rapidly to indicate that it is communicating.
3. If your Siren has been successfully linked to your network, its LED will become solid for 2 seconds, then stop. If linking was unsuccessful, the LED will blink when you tap its button.

### **If you're using a Z-Stick.**

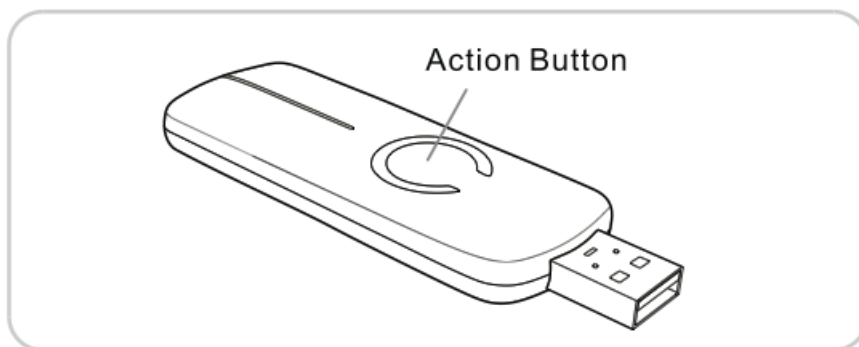

1. Decide on where you want your Siren to be placed and plug it into a wall outlet. Its Network LED will begin to blink.
2. If your Z-Stick is plugged into a gateway or a computer, unplug it.
3. Take your Z-Stick to your Siren.
4. Press the Action Button on your Z-Stick.
5. If Siren has been successfully linked to your Z-Wave network, its Network LED will no longer blink when you short press the Action button on Siren. If the linking was unsuccessful and the Network LED continues to blink repeat the above steps.
6. Press the Action Button on the Z-Stick to take it out of installation mode and return it to your gateway or computer.

**If you're using a Minimote.**

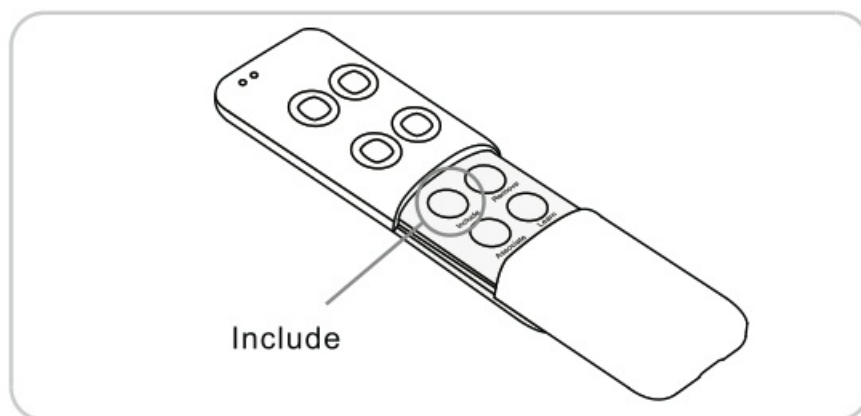

1. Decide on where you want your Siren to be placed and plug it in to a wall socket. Its Network LED will begin to blink.
  2. Take your Minimote to your Siren.
  3. Press the Include button on your Minimote.
  4. If Siren has been successfully linked to your Z-Wave network, its Network LED will no longer blink when you short press the Action button on Siren. If the linking was unsuccessful and the Network LED continues to blink repeat the above steps.
  5. Press any button on your Minimote to take it out of installation mode.
- With your Siren now working as a part of your smart home, you'll be able to configure it from your home control software. Please refer to your software's user guide for precise instructions on configuring Siren to your needs.

You're able to test your Siren's speaker system manually. Please note that the speaker system is 106dB and very loud – we recommend only testing your Siren while wearing the necessary ear protection given you'll need to be next to your Siren while manually testing it. To manually test Siren, press and hold the Action Button for 5 seconds.

**Advanced.**

**Removing your Siren from a Z-Wave network.**

Your Siren can be removed from your Z-Wave network at any time. It is always advised that you use your gateway

to perform an unpair in order to avoid leaving phantom / failed nodes that become difficult to remove. To do so, follow the steps below:

### **Unpairing your Siren Gen5 from your existing Z-Wave network.**

1. Place your gateway or controller into Z-Wave unpair or exclusion mode. (Please refer to your controller/gateway manual on how to do this)
2. Press the Action Button on your Siren.
3. If your Siren has been successfully unlinked to your network, its LED will begin to blink.

### **If you're using a Z-Stick.**

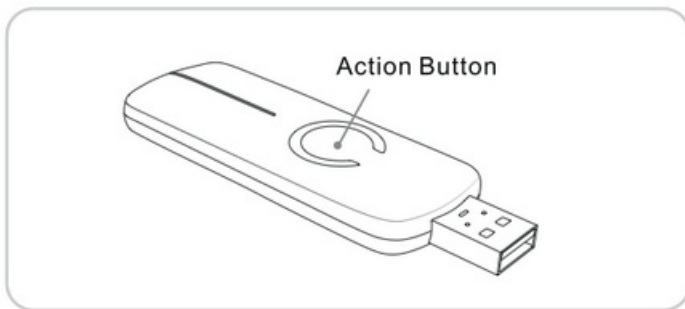

1. If your Z-Stick is plugged into a gateway or a computer, unplug it.
2. Take your Z-Stick to your Siren.
3. Press the Action Button on your Z-Stick.
4. Press the Action Button on your Siren.
5. If your Siren has been successfully removed from your network, its Network LED will blink when you press and release the Siren's Action Button. If the removal was unsuccessful, the Network LED will not blink.
6. Press the Action Button on the Z-Stick to take it out of removal mode.

### **If you're using a Minimote.**

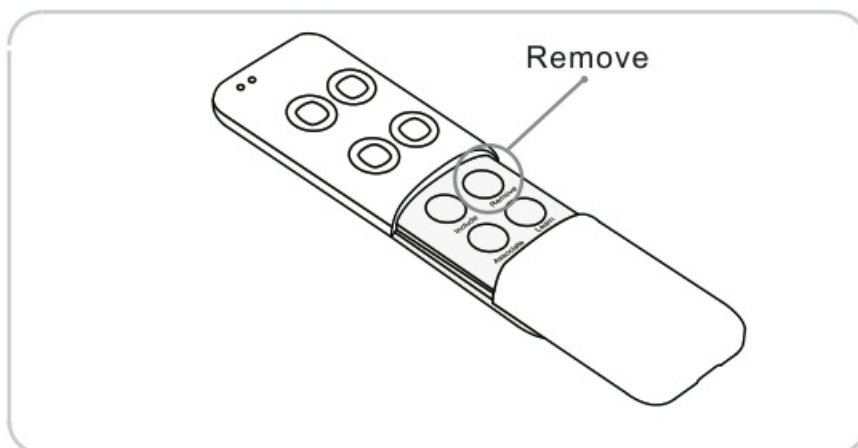

1. Take your Minimote to your Siren.
2. Press the Remove Button on your Minimote.

3. Press the Action Button on your Siren.
4. If your Siren has been successfully removed from your network, its Network LED will blink when you press and release the Siren's Action Button. If the removal was unsuccessful, the Network LED will not blink.
5. Press any button on your Minimote to take it out of removal mode

### **Changing Sounds and Volume.**

You may want to change your sound and volume of your Siren Gen5 to cater to your application. There are 5 separate sounds, and 3 volume settings. You can find more information on how to change them here: <https://aeotec.freshdesk.com/solution/articles/6000120761-changing-sound-and-volume-of-siren-gen5-parameter-37->

### **Reset your Siren.**

This method is not fully advised unless your gateway has failed, and you do not yet have another gateway to perform a general unpair on Siren Gen5.

To do this, follow the steps below:

1. Press and hold the Action button for 20 seconds
2. At 8 seconds, the Siren will sound for 1 second, then stop
3. The LED will continue to blink faster and faster
4. The LED will then become solid for 2 seconds to indicate a successful factory reset
5. You may let go of its Action button, and the Siren Gen5 factory reset is complete.

### **More Advanced Configurations.**

You can find more advanced configurations for Siren Gen5 in our Engineering Sheet section on our Freshdesk which can be used to integrate Siren Gen5 into a new gateway or software, or use it as a reference for configurations.

1. [ES – Siren Gen5 V3.25](#) [PDF]