

## AENO ATB0003 Table Blender User Guide

[Home](#) » [AENO](#) » AENO ATB0003 Table Blender User Guide 

**AENO ATB0003 Table Blender**



AENO TB3 electric blender is designed for chopping food, making smoothies, purees, drinks and other product.

## Contents

- 1 Specifications
- 2 Package Contents
- 3 Limitations and Warning
- 4 Preparing for operation
- 5 Operating the device
- 6 Device mode indication table
- 7 Troubleshooting
- 8 Recycling information
- 9 SAFETY PRECAUTIONS
- 10 Documents / Resources
  - 10.1 References
- 11 Related Posts

## Specifications

**Supply voltage:** 220–240 V (AC);

**Frequency:** 50/60 Hz. **Power:** 800.0 W. **Bowl Capacity:** 1.75 L.  
**Measuring cup capacity:** 80 ml.  
**Dimensions (L×W×H):** 230 mm × 200 mm × 420 mm.  
**Weight:** 4.7 kg.  
**Power cord length:** 1 m.

## Package Contents

AENO TB3 blender, measuring cup, brush, quick start guide, warranty card.

## Limitations and Warning

Children and persons with disabilities may use the device only under the supervision of adults experienced in its use. Keep the device out of the reach of children. During the operation of the device the surface of its bowl heats up. Do not touch it. Do not touch the device housing while it is operating. Do not disassemble or repair the blender on your own. Do not wash the bowl base with the electrical contacts and the clutch shaft with water. Place the blender only on a firm and stable surface. The distance from the operating device to other objects should be at least 15 centimeters. Do not store the blender cup in the refrigerator: short circuit of electrical contacts may occur due to condensation. Do not touch the blender blade.

**WARNING!** The min product level in the blender is 750ml. Do not exceed the max level for hot liquids (1200ml) and cold liquids (1500ml), it may cause overflow. Do not open the lid of the blender cup while the blender is in operation. If you hear an intermittent sound of the blade turning when chopping food, this is normal. If you lift the bowl or open the lid of the blender while it is running, the protection will be triggered, and the motor will stop. Do not add sugar, plant stems or legumes (beans, peas, chickpeas, lentils) to the bowl, as the blade can jam, and it can cause damage to the device. To clean the blender blade © use the brush . Before plugging in, make sure that the bowl is securely seated on the blender base and that the bowl lid is closed.

## Preparing for operation

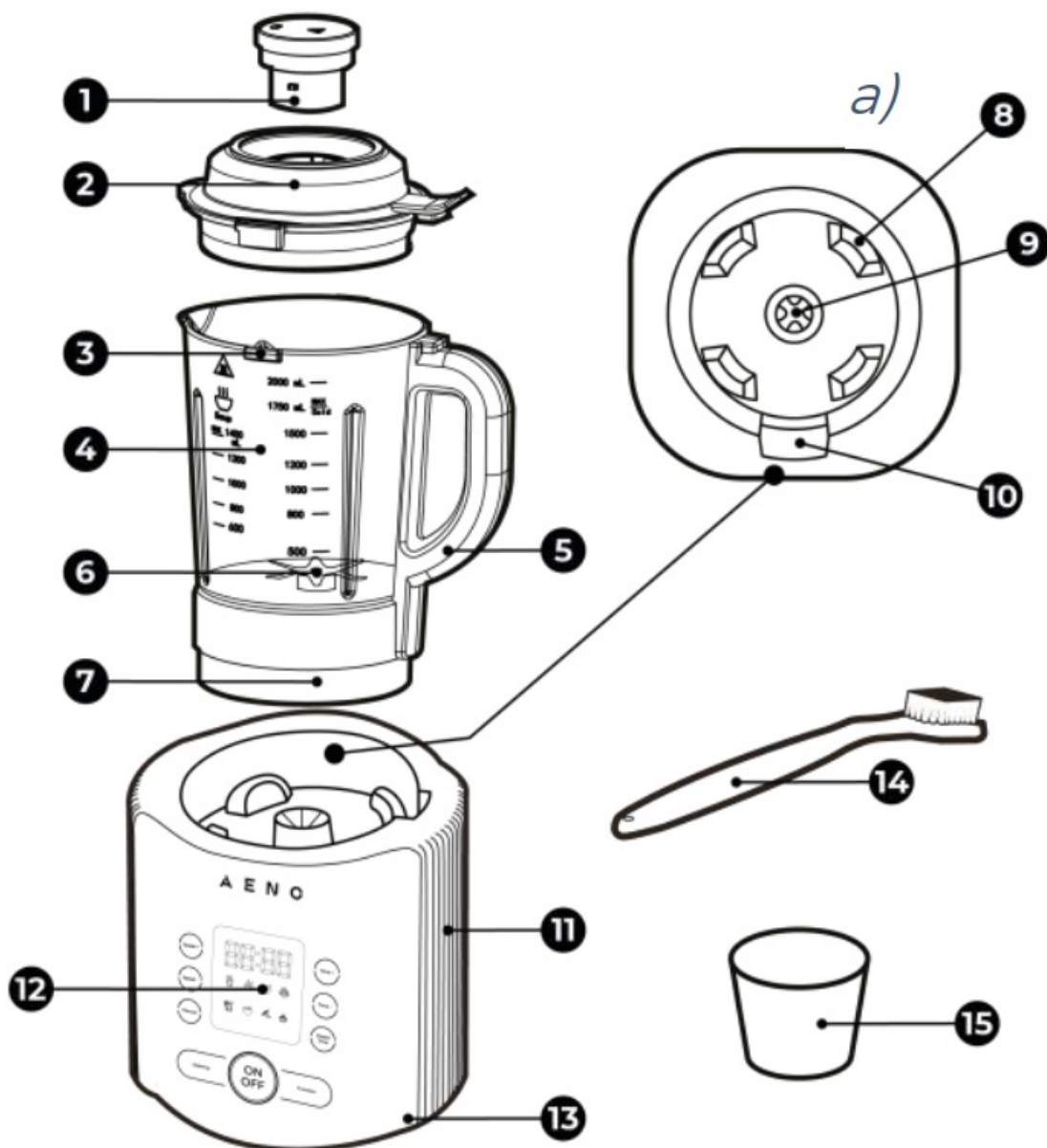

Wash the blender bowl ④ , the large lid ② and the small lid ① with warm soapy water and wipe it dry before the first use and each subsequent use.

**WARNING!** Never allow water to get to the bottom of the blender bowl base ⑦ . Short circuit of electrical contacts will occur and the device will break down. Place the bowl ③ on the blender housing (See picture d). The bowl connector ⑤ must fit into the groove of the blender body ⑩ . The motor shaft connector ⑨ must fit into the blade shaft connector on the bottom of the bowl base ⑦. The rubber compensators must fit into the recesses of the bowl base.

**NOTE.** If the bowl can not be installed on the blender housing, remove it from the base and twist the motor shaft connector ⑨ in the blender housing by hand half a turn in either direction.

## Operating the device

b)

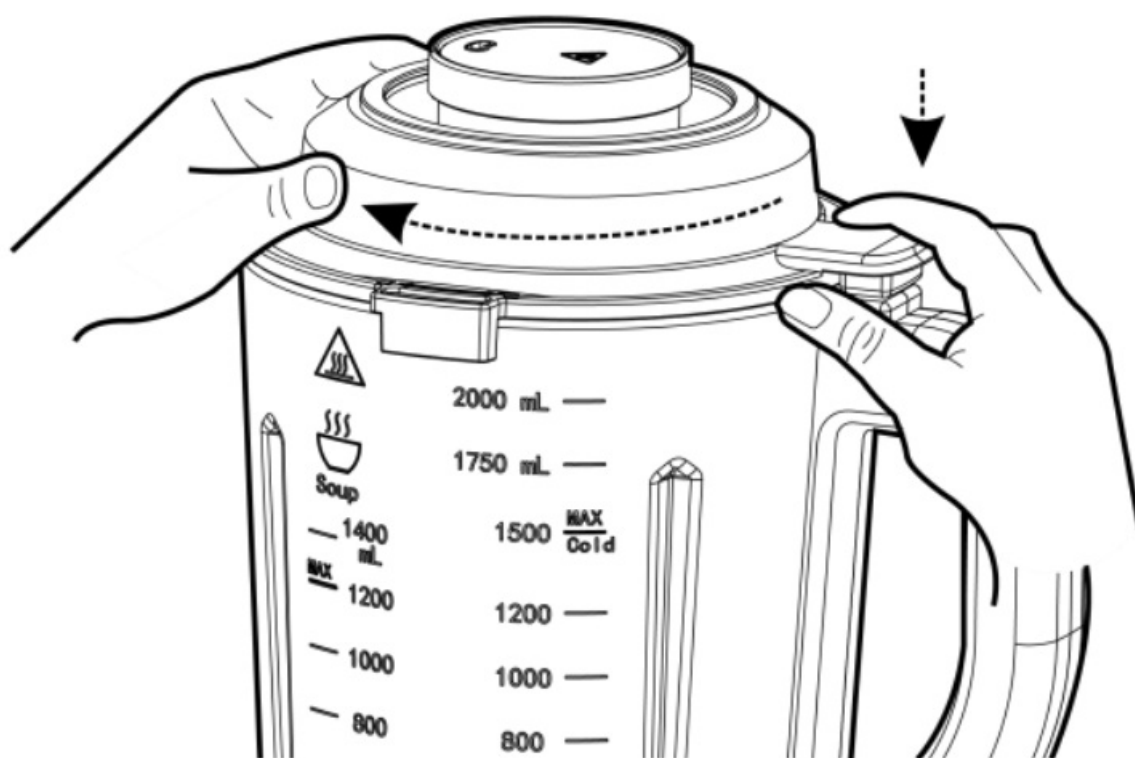

c)

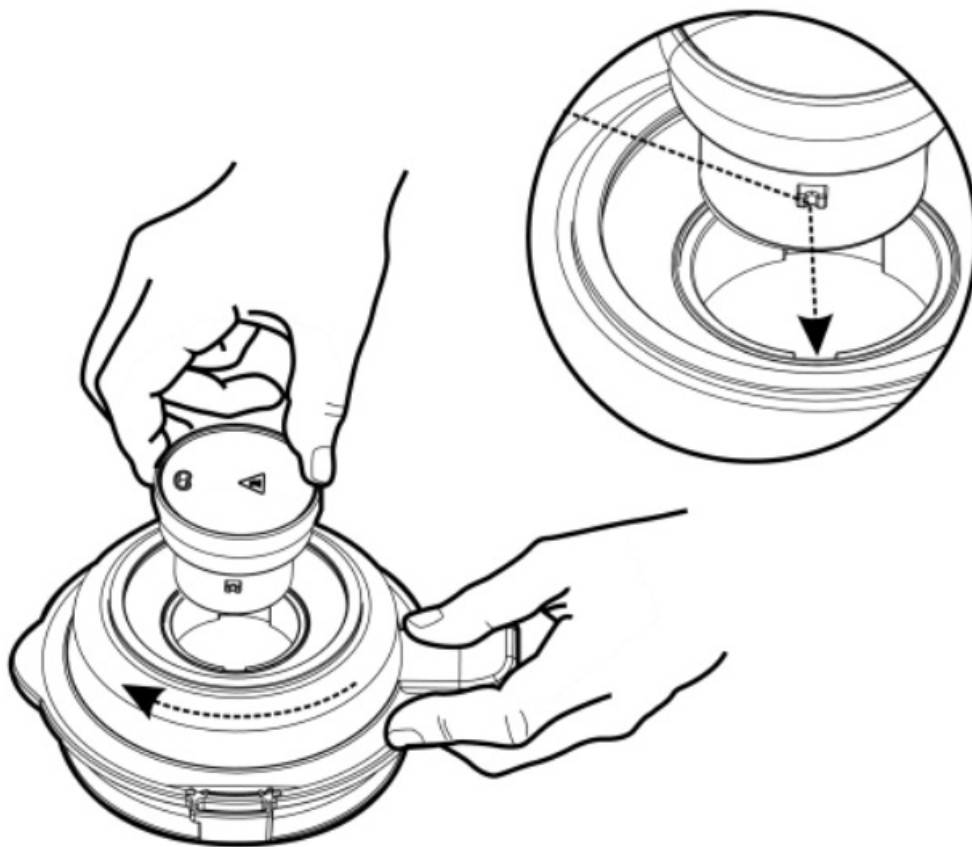

d)

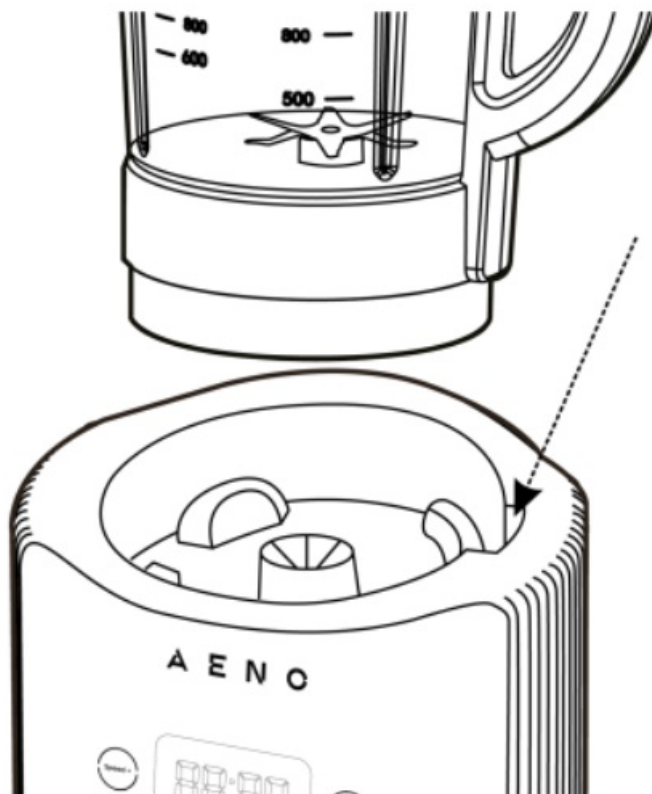

Place food in the bowl ④. Then place the large lid ② on the bowl ③ and turn it clockwise until the grooves on the large lid align with the protrusions on the bowl (**See figure b**). After that insert the small cap ① into the large cap ② and turn it clockwise (See picture c). To open the large and small lids turn them counterclockwise.

**NOTE.** The device will immediately stop working if you open the large lid. If you need to add food or spices while the blender is running, you can open the small lid to do so. Use the measuring cup to dose spices and other products. You can find recipes of various dishes in the full instructions at [aeno.com/documents](http://aeno.com/documents).

Plug the device into a power outlet. Power control mode will turn on. Press the **“ON/OFF”** button to switch to standby mode. Select one of the eight blender programs by pressing the **“FUNCTION”** button. Then press the **“Start/Stop”** button (if you do not press the button within 30 seconds, the blender will go into standby mode). After that the selected program will start. When the process is finished, press the **“ON/OFF”** button and unplug the blender. **NOTE.** The maximum continuous operation time is 5 cycles. In case of longer use, engine will be automatically blocked. To resume work, you must disconnect the device from the power supply, remove the bowl and wait for no longer than 10 minutes. After this time, the device will be ready for use again.

You can also turn on the blender in delayed start mode. To do this in standby mode you must first set the desired time before the program starts. To do this, first press the **“PRESET TIME”** button. Then use the **“TIME+”** and **“TIME-”** buttons to set the time required before the device starts. Each press of the Increase Time and Decrease Time button changes the time until the blender starts by 10 minutes. Then select the desired program with the **“Program Selection”** button and then press the **“Start/Stop”** button. The blender will start itself after a set period of time, work the selected program, and then go into standby mode.

**NOTE.** If you set the wrong time before the blender starts, you can cancel the setting with the **“START/STOP”** button.

The manual mode allows you to set the duration of operation and rotation speed of the blade by yourself. To do this, press the **“MANUAL”** button in standby mode and then use the **“SPEED+”** and **“SPEED-”** buttons to set the desired speed. Then use buttons **“TIME+”** and **“TIME-”** to set the required operating time of the device in minutes and seconds. Then press the **“START/STOP”** button.

The self-cleaning mode helps to clean the blade from stuck pieces of food. To do this, you need to remove food from the blender, pour 500ml of warm water with a little dishwashing detergent into the blender and press the **“CLEANING”** button. The blade will rotate as long as you hold down the button. When the cleaning is finished, rinse the blender bowl with warm running water.

## Device mode indication table

(See figure e).

e)



LED indicator, blinking	LED indicator, lights up	Digital display	Mode
"ON/OFF"	—	—:—	Power control
—	All indicators	00:00	Standby mode
One program indicator: soy milk, rice paste, oatmeal, soup, fruits and vegetables, smoothies, mashing, boiling	"ON/OFF", "FUNCTION"	01:00 Product preparation time	Program selection
—	"PRESET TIME" + one of the program indicators	01:00	Delayed start
—	"MANUAL ."	01:00	Manual control
—	"CLEANING"	G" Operating time in seconds 01:00	Self-Cleaning

## Troubleshooting

**The smell of burning plastic or rubber.** Possible causes: the device motor is inside the housing under strong rubber materials to reduce noise and vibration. The first few starts the parts of the device will be hot and emit an unpleasant odor. Later on, the smell will disappear. Solution: It is recommended to install the blender in a well-ventilated room.

**The products are not well chopped.** Possible causes: low mains voltage; too much or too little food in the bowl;



not enough water in the bowl. Solution: plug the device into an outlet with a supply voltage of at least 220V, use a voltage regulator; remove excess food from the bowl or add water to it.

**The liquid pours over the edge of the blender bowl.** Possible causes: too much liquid. Solution: make sure that the amount of liquid does not exceed the maximum level specified in the instructions.

**Errors E1 and E2.** Possible causes: large lid and/or blender cup is installed incorrectly, with misalignment. Solution: remove the large lid and/or blender bowl and reinstall them again.

**Error E3.** Possible causes: no liquid and/or food in the bowl, temperature sensors turn off the device due to overheating.

**Solution:** add liquid or food to the bowl.

**The blender heats up, the blade does not rotate.** Possible causes: short circuit. Solution: contact the service center.

**WARNING!** If your problem persists, please contact your local supplier or the service center for support. Please do not disassemble the device or try to repair it on your own.

## Recycling information



That symbol indicates that you must follow the Waste Electrical and Electronic Equipment (WEEE) and Waste Battery and Battery Regulations when disposing of the device, its batteries and accumulators, and its electrical and electronic accessories. According to the rules, this equipment must be disposed of separately at the end of its service life.

Do not dispose of the device, its batteries and accumulators, or its electrical and electronic accessories together with unsorted municipal waste, as this will harm the environment.

To dispose of this equipment, it must be returned to the point of sale or turned in to a local recycling facility.

You should contact your local household waste disposal service for details.

ASBISc reserves the right to modify the device and to make edits and changes to this document without prior notice to users.

The warranty period and service life shall be 2 years as from the date of purchase of the device.

Manufacturer: ASBISc Enterprises PLC, Iapetou, 1, Agios Athanasios, 4101 Limassol, Cyprus. Made in China.

For current information and details on the device description and specification, as well as connection process, certificates, warranty, and quality issues, see relevant Installation and Operation Manuals available for downloading at [aeno.com/documents](https://aeno.com/documents).

All trademarks and names herein are the property of their respective owners.

## SAFETY PRECAUTIONS

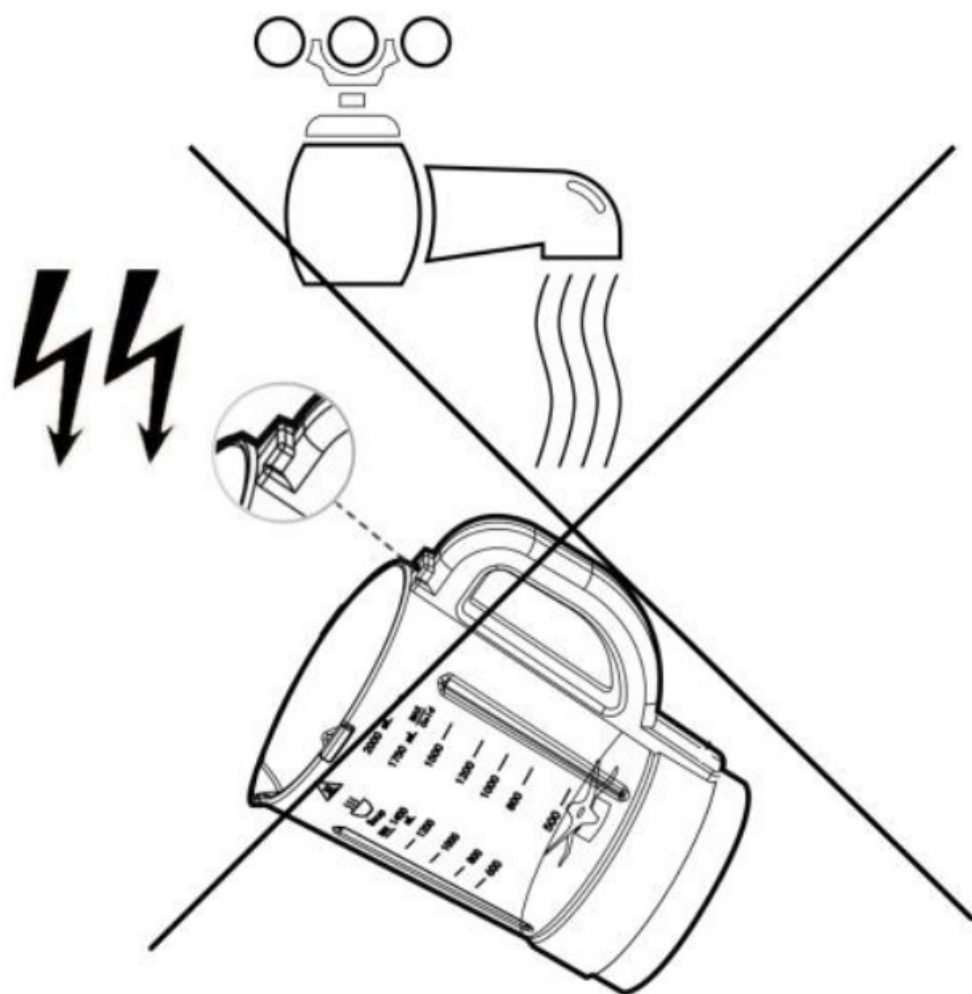

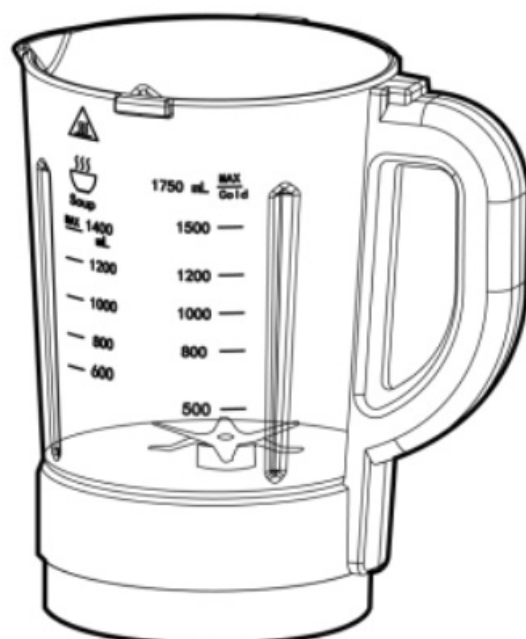
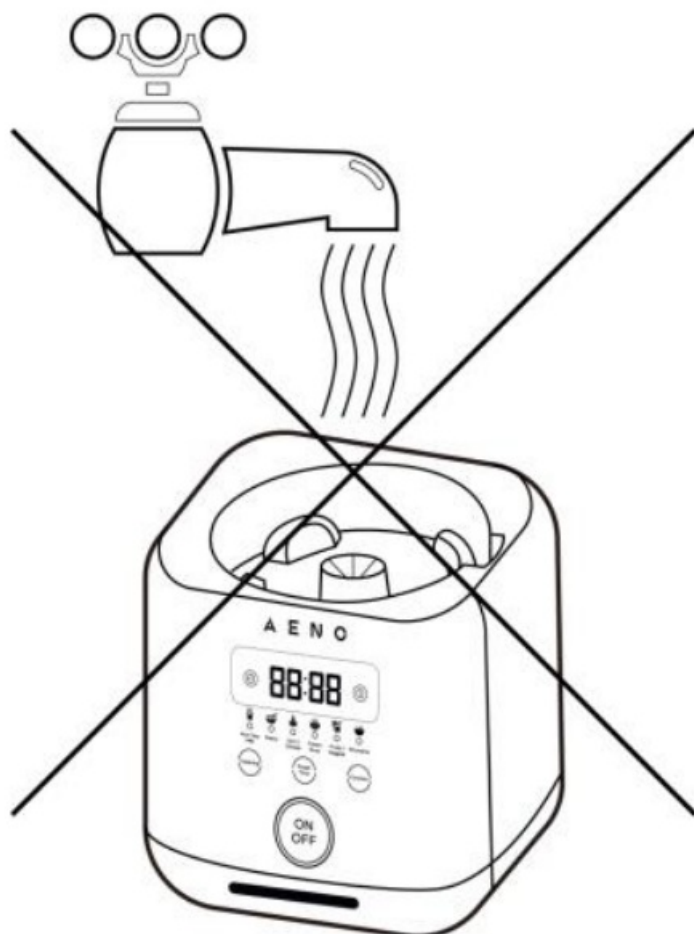



[aeno.com/documents](https://aeno.com/documents)  
[aeno.com](https://aeno.com)



## Documents / Resources



[AENO ATB0003 Table Blender](#) [pdf] User Guide  
ATB0003, TB3, ATB0003 Table Blender, Table Blender, Blender

## References

- [A Documents | AENO in Europe](#)
- [Paramètres manuels - Перевод на русский - примеры французский | Reverso Context](#)
- [réduction - Перевод на русский - примеры французский | Reverso Context](#)