



AE Systems NES100CKT NeoS Chain Drive Kit Instruction Manual

[Home](#) » [AE Systems](#) » AE Systems NES100CKT NeoS Chain Drive Kit Instruction Manual

Contents [[hide](#)]

- [1 AE Systems NES100CKT NeoS Chain Drive Kit](#)
- [2 Chain drive kit installation](#)
- [3 Documents / Resources](#)
- [4 Related Posts](#)



AE Systems NES100CKT NeoS Chain Drive Kit



Chain drive kit installation

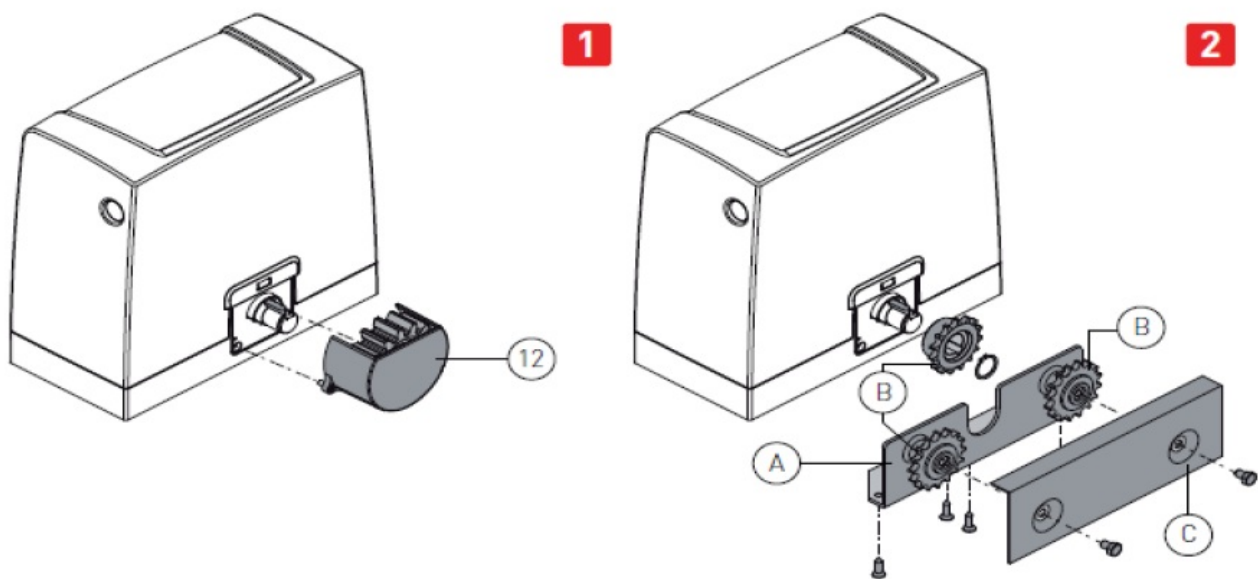

NB: Install the chain drive kit before securing the gear motor to the base plate.
Release the gear motor (see OPERATING INSTRUCTIONS).

1. Remove the pinion [12].
2. Fix the pinion supporting plate [A] to the Gearmotor.
3. Insert pinions [B] as illustrated in the diagram.
4. Pass the chain between the pinions by hand.
5. Fix cover plate C.

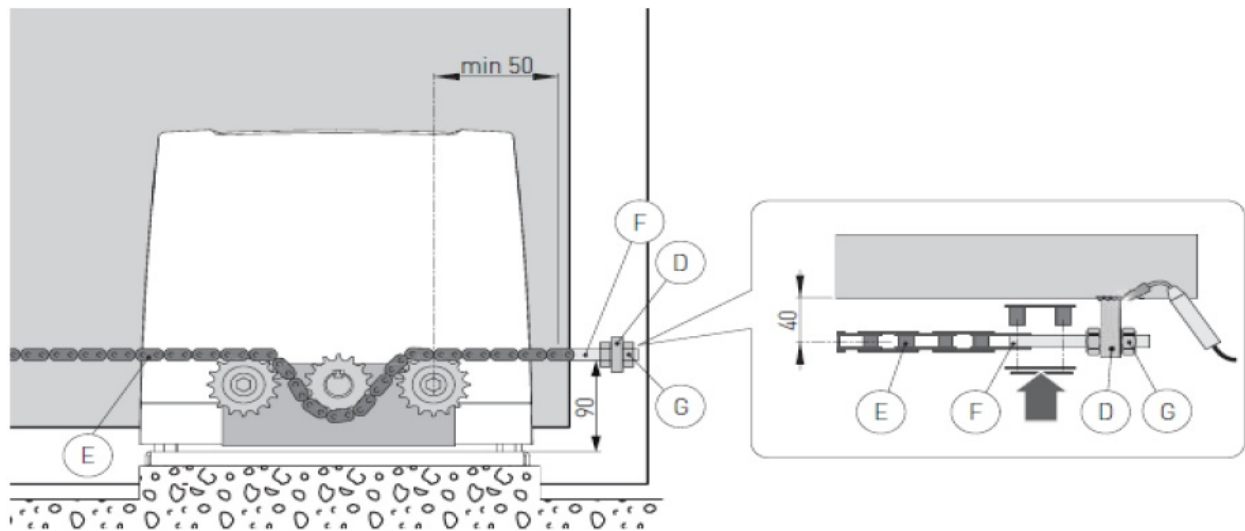

6. Move the wing into the open position by hand and fix brackets IDJ on the wing as illustrated in the diagram.
7. Connect chain [E], which was previously assembled on the gear motor, to tie rod [F] and fix it to bracket [D].
8. Fix bracket [D] on the opposite side of the gate. Connect chain [E] to tie rod [F] and fix it to bracket [D] cut the excess chain).

NB: Make sure that the distance between the pinion center and tie rod [F] is correct when the gate is fully open and closed.

- Secure the chain with nuts [G].
- Tighten the chain [E] with the tie rods [F].
- Slightly lubricate the chain (E) and the pinions after assembly.

WARNING: when the chain traction kit is fitted, the gear motor drive direction is inverted.

- Right-hand opening



- Left-hand opening

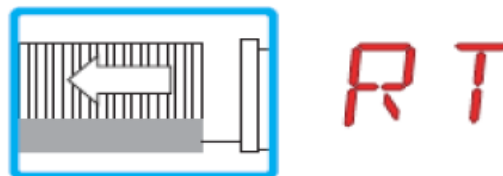

Documents / Resources

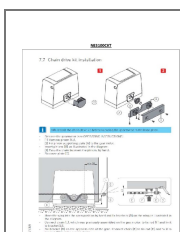

[AE Systems NES100CKT NeoS Chain Drive Kit](#) [pdf] Instruction Manual
NES100CKT NeoS Chain Drive Kit, NES100CKT, NeoS Chain Drive Kit, Chain Drive Kit, Drive Kit

